



Philips CarStudio  
Car audio system

- Bluetooth
- USB/SDHC

**CarStudio**

**CE151**

# Experience live music in car

## Obsessed with sound

Enjoy multiple source music in your car with the Philips CE151. Stay connected to your music on your mobile & important calls, thanks to the built-in Bluetooth® receiver. Also features anti-theft detachable front panels for security.

### Enjoy superior sound

- MAX Sound for instant power boost
- Music Zone for adjustable sweet spots
- Dynamic Bass Boost electronically enhances the low tones
- 2-band parametric equalizer with 8 presets
- Super anti-shock protection for smooth music enjoyment
- Built-in 50W x 4 amplifiers for excellent sound quality

### Design that blends into your car

- High contrast LCD for perfect viewing
- Detachable front panel for anti-theft security

### Easy to use

- USB Direct and SDHC card slots for MP3/WMA playback
- Built-in Bluetooth receiver for call and music streaming
- Browse by folder or song for instant search or quick access
- Audio out for amplifier addition

# PHILIPS

# Highlights

## Music Zone

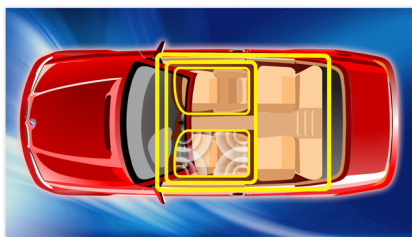

Philips' innovative Music Zone technology lets the driver and the passengers enjoy their music with more vivid spatial effect, just as the artist intended it to be heard. Users can easily switch the music listening zones from the driver to the passengers and back again to get the best sonic focus in the car. A dedicated zone control button provides three pre-defined settings - Left, Right and Front (and All) - so you can best match your listening needs easily and dynamically alone or with your passengers.

## DBB Dynamic Bass Boost



Activate the Dynamic Bass Boost (DBB), and the low-end bass frequencies are electronically enhanced to achieve consistent sound reproduction, especially when the speaker volume is set at a low level. You hear impressive bass at all times.

## USB Direct and SDHC card slots

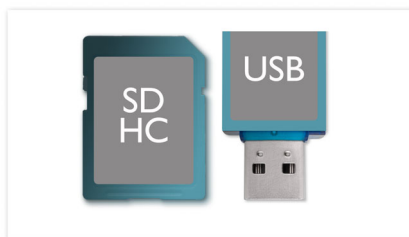

Thanks to the complete file transferability, you can easily enjoy the convenience and fun of accessing more digital music via the built-in USB Direct and SDHC card slots.

## Built-in Bluetooth receiver



The Bluetooth hands-free feature lets you use your mobile phone safely while driving and you don't have to miss any important calls. With the built-in Bluetooth® receiver, you can also conveniently stream your music files from your phone to your car entertainment system.

## Browse by folder or song

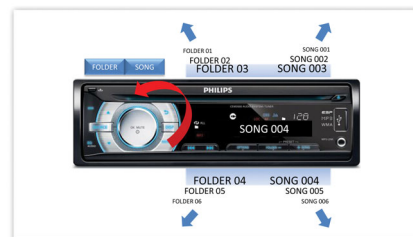

This function allows you to find a track or album much faster by letting you browse through songs and folders, which are the usual contents of USB/SDHC devices. With the dedicated folder/song button, only three simple steps are needed to make a search – press folder/song, rotate the volume knob and push to select. This simple process lets you search through your music quickly and easily, letting you to focus on your driving.

## MAX Sound



MAX Sound technology produces an instant boost in bass and treble, maximizing volume performance and instantly creating the most impressive listening experience with just the touch of a button. Its sophisticated electronic circuitry calibrates existing sound and volume settings, instantly boosting bass, treble and volume beyond original maximum levels without distortion. The end result is a noticeable amplifying of both sound spectrum and volume and a potent audio boost that will add mileage to any music.

# Specifications

## Display

- Type: High contrast B/W LCD (9 characters)
- Key illumination: Red

## Playback media

- USB flash drive
- SD/SDHC card
- MP3 Link: for portable MP3 music playback
- Music devices via Rear Aux
- Bluetooth streaming music

## Audio Playback

- Compression format: MP3, WMA
- ID3 Tag support: Song title, artist, album
- MP3 bit rates: 32-320kbps and variable bit rate
- USB Direct / SD Modes: Play/Pause, Fast Backward/Fast Forward, Previous/Next, Repeat, Shuffle

## Tuner/Reception/Transmission

- Tuner Bands: AM, FM Stereo
- Auto digital tuning
- Tuner Enhancements: Auto search and store
- No. of preset stations: 18(FM), 12(AM)

## Sound

- Equalizer: 2-bands
- Equalizer settings: Classic, Jazz, Pop, Rock, Flat, Optimal, Techno, User defined
- Sound Enhancement: MAX Sound, Dynamic Bass

Boost, Music zone

- Output power (MAX): 50Wx4 channels
- Output power (RMS): 22Wx4 channels (4 ohms, 10% T.H.D.)

## Connectivity

- Microphone: Built-in microphone
- Preamp output: 2 pairs RCA(L/R)
- Bluetooth profiles: A2DP, AVRCP, Handsfree
- Bluetooth version: 2.0+EDR
- Hard-wired audio mute
- Hard-wired remote input

## Security/Anti-theft

- Front panel: Detachable

## Accessories

- Remote control: Slim remote with battery
- User Manual: Brazilian Portuguese, English, Spanish, Simplified Chinese, Traditional Chinese
- Quick start guide: Brazilian Portuguese, English, Spanish, Chinese

## Power

- Power supply: 12V DC

## Dimensions

- Product dimensions (W x H x D):  
188 x 58 x 140 mm
- Chassis: 1 Din



Issue date 2013-05-10

Version: 1.2.2

12 NC: 8670 000 76303  
EAN: 69 23410 70980 3

© 2013 Koninklijke Philips Electronics N.V.  
All Rights reserved.

Specifications are subject to change without notice.  
Trademarks are the property of Koninklijke Philips  
Electronics N.V. or their respective owners.

[www.philips.com](http://www.philips.com)