

Register your product and get support at
Registre su producto y obtenga asistencia en
Cadastre seu produto e obtenha suporte em
www.philips.com/welcome

MCD135



EN	User manual	3
ES	Manual del usuario	25
PT-BR	Manual do Usuário	51

PHILIPS

Contents

1	Congratulations	4	8	Setup	19
	Feature introduction	4		Interface for setup menu	19
	What's in the box	5		Change a setting	19
	Overview of the main unit	6		System setup	19
	Overview of the remote control	7		Language setup	20
2	Important	8		Audio setup	20
	Safety	8		Video setup	20
	Notice	8	9	Product information	20
3	Before use	10		Specifications	20
	Place the product	10		Supported disc formats	21
	Install/replace the battery of remote control	10		USB playability information	21
4	Connect	11	10	Troubleshooting	22
	Connect speakers	11			
	Connect TV	11			
	Connect a USB storage device	12			
	Connect power	12			
5	Get started	13			
	Turn on	13			
	Set the clock	13			
	Find the correct viewing channel	13			
	Select the correct TV system	13			
	Select a language for on-screen-display messages	13			
6	Play	14			
	Basic operation	14			
	Play a disc	14			
	Play recorded files	14			
	Play control	16			
7	Other features	17			
	Listen to FM radio	17			
	Play audio from an external device	18			
	Listen through headphone	18			
	Turn on/off automatically	18			

1 Congratulations

Congratulations on your purchase, and welcome to Philips! To fully benefit from the support that Philips offers, register your product at www.philips.com/welcome.

If you contact Philips, you will be asked for the model and serial number of this apparatus. The model number and serial number are on the back of the apparatus. Write the numbers here:

Model No. _____

Serial No. _____

Any changes or modifications made to this device that are not expressly approved by Philips Consumer Lifestyle may void the user's authority to operate the equipment.

Caution

- Use of controls or adjustments or performance of procedures other than herein may result in hazardous radiation exposure or other unsafe operation.

This apparatus includes this label:



Class II equipment symbol:



This symbol indicates that this product has a double insulation system.

Feature introduction

This product can play videos and audios, and display pictures from discs and USB storage devices.

For the details of supported media, refer to "Specifications".



DVD region code	Countries
	Latin America

Sound effect

This product supports the sound output by DSC (Digital Sound Effect) and DBB (Dynamic Bass Boost).

What's in the box

Check and identify the contents of your package:

- Main unit
- 2 speakers
- Remote control
- Audio and video cables (white, red and yellow connectors)
- USB cable (100 mm)
- MP3 link cable (3.5 mm plug)
- Power cord
- User manual
- Quick start guide





To fully enjoy the features of this product, you need the following cables.

- Component video cables

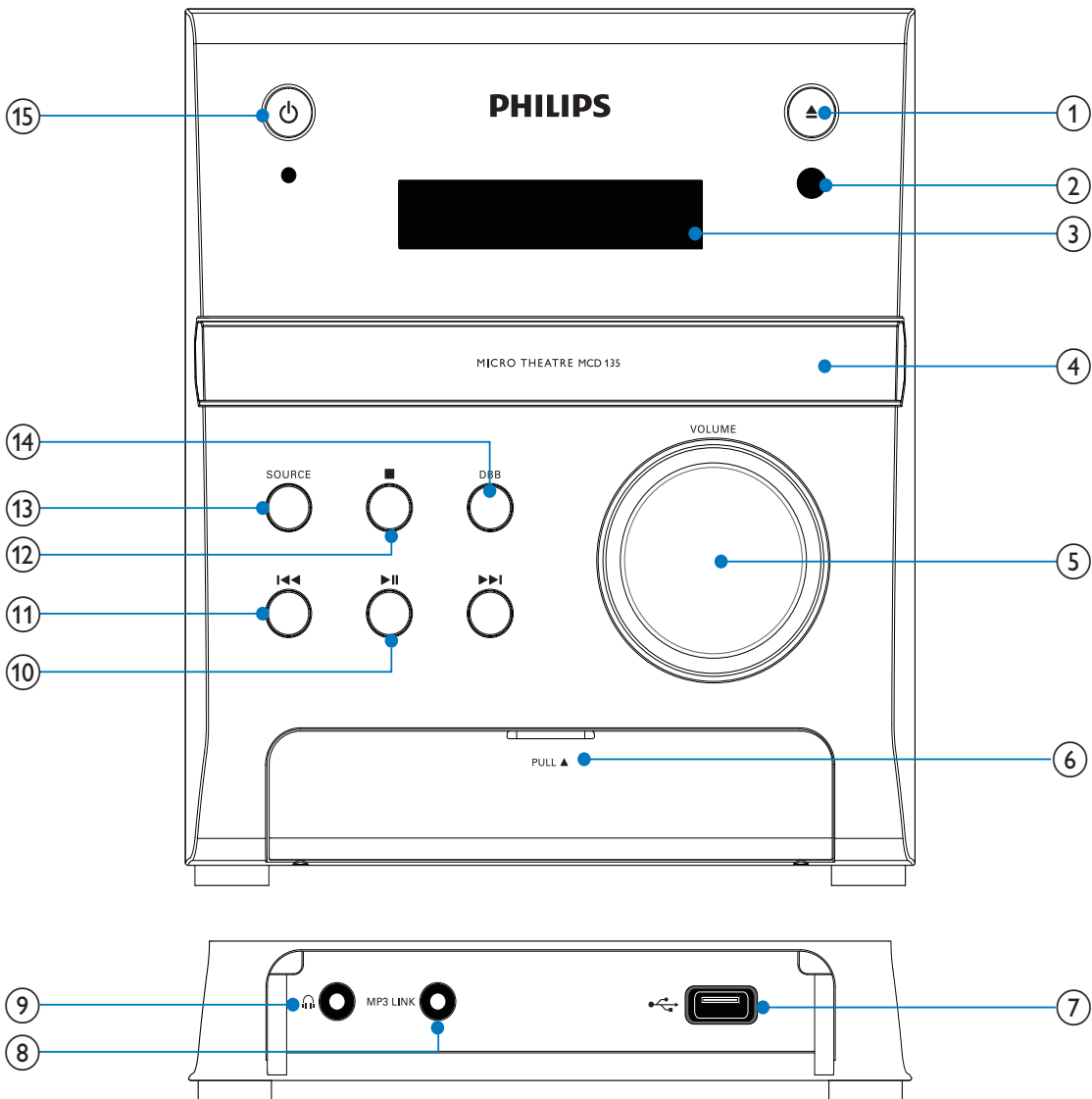
Contact local retailers to purchase these additional cables.

Overview of the main unit



- ① ▲
 - Eject or close the disc compartment.
- ② IR sensor
- ③ VFD display
- ④ Disc compartment
- ⑤ VOLUME
 - Increase/decrease the volume level.
- ⑥ Pull to open
- ⑦ 
 - Connect a USB storage device.
- ⑧ MP3 LINK
 - Connect an MP3 link cable (3.5 mm plug).
- ⑨ 
 - Socket for headphones.
- ⑩ 
 - Start, pause or resume the play.
- ⑪ 
 - Skip to the previous or next title, chapter, track, or file.
 - Search fast backward or forward.
- ⑫ 
 - Stop the play.
- ⑬ SOURCE
 - Select a media source (disc, USB storage device, FM tuner, or external device connected through MP3 link cable).

- ⑭ **DBB**
 - Enable or disable the DBB (Dynamic Bass Boost) feature.
- ⑮ **⏻**
 - Turn on or off the unit.
 - Switch to standby mode.

Overview of the remote control

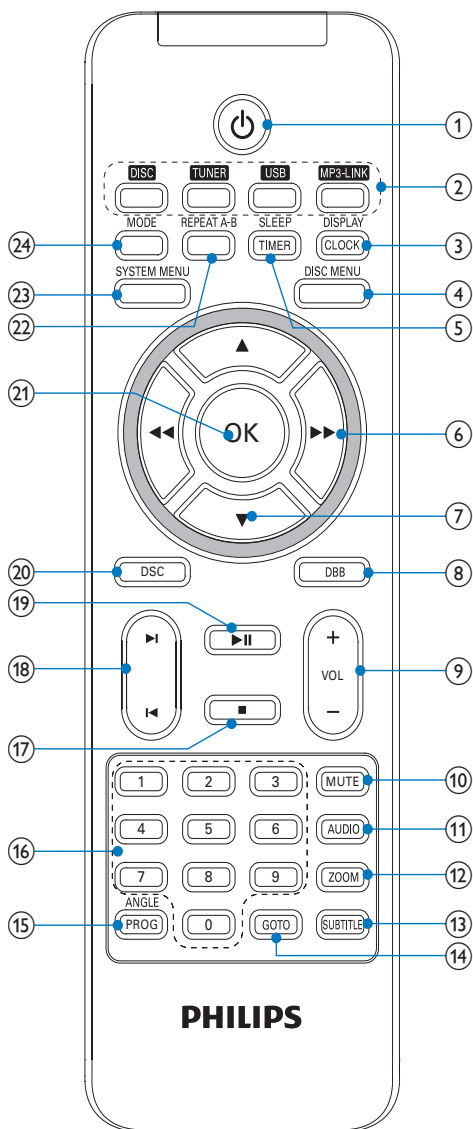

- ⑤ **SLEEP/TIMER**
- ⑥ **◀▶▶▶**
- ⑦ **▲/▼**
- ⑧ **DBB**
- ⑨ **VOL +/-**
- ⑩ **MUTE**
- ⑪ **AUDIO**
- ⑫ **ZOOM**
- ⑬ **SUBTITLE**
- ⑭ **GOTO**
- ⑮ **ANGLE/PROG**
- ⑯ **Numeric buttons**
- ⑰ **■**
- ⑱ **◀▶▶▶**
- ⑲ **▶||**
- ⑳ **DSC**
- ㉑ **OK**
- ㉒ **REPEAT A-B**
- ㉓ **SYSTEM MENU**
- ㉔ **MODE**

- ① **⏻**
- ② **Source selection keys**
- ③ **DISPLAY/CLOCK**
- ④ **DISC MENU**

2 Important

Safety

Know these safety symbols

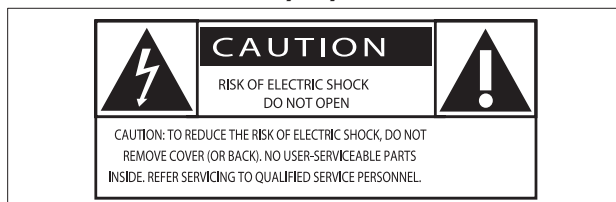

This 'bolt of lightning' indicates uninsulated material within your unit may cause an electrical shock. For the safety of everyone in your household, please do not remove product covering.

The 'exclamation point' calls attention to features for which you should read the enclosed literature closely to prevent operating and maintenance problems. **WARNING:** To reduce the risk of fire or electric shock, this apparatus should not be exposed to rain or moisture and objects filled with liquids, such as vases, should not be placed on this apparatus.

CAUTION: To prevent electric shock, match wide blade of plug to wide slot, fully insert.

Hearing safety

Listen at a moderate volume.

- Using headphones at a high volume can impair your hearing. This product can produce sounds in decibel ranges that may cause hearing loss for a normal person, even for exposure less than a minute. The higher decibel ranges are offered for those that may have already experienced some hearing loss.

- Sound can be deceiving. Over time your hearing 'comfort level' adapts to higher volumes of sound. So after prolonged listening, what sounds 'normal' can actually be loud and harmful to your hearing. To guard against this, set your volume to a safe level before your hearing adapts and leave it there.

To establish a safe volume level:

- Set your volume control at a low setting.
- Slowly increase the sound until you can hear it comfortably and clearly, without distortion.

Listen for reasonable periods of time:

- Prolonged exposure to sound, even at normally 'safe' levels, can also cause hearing loss.
- Be sure to use your equipment reasonably and take appropriate breaks.

Be sure to observe the following guidelines when using your headphones.

- Listen at reasonable volumes for reasonable periods of time.
- Be careful not to adjust the volume as your hearing adapts.
- Do not turn up the volume so high that you can't hear what's around you.
- You should use caution or temporarily discontinue use in potentially hazardous situations. Do not use headphones while operating a motorized vehicle, cycling, skateboarding, etc.; it may create a traffic hazard and is illegal in many areas.

Notice



This product complies with the radio interference requirements of the European Community.



Your product is designed and manufactured with high quality materials and components, which can be recycled and reused.



When this crossed-out wheeled bin symbol is attached to a product it means that the product is covered by the European Directive 2002/96/EC.

Please inform yourself about the local separate collection system for electrical and electronic products.

Please act according to your local rules and do not dispose of your old products with your normal household waste. Correct disposal of your old product helps to prevent potential negative consequences for the environment and human health.



Your product contains batteries covered by the European Directive 2006/66/EC, which cannot be disposed with normal household waste. Please inform yourself about the local rules on separate collection of batteries because correct disposal helps to prevent negative consequences for the environmental and human health.

Environmental information

All unnecessary packaging has been omitted. We have tried to make the packaging easy to separate into three materials: cardboard (box), polystyrene foam (buffer) and polyethylene (bags, protective foam sheet.)

Your system consists of materials which can be recycled and reused if disassembled by a specialized company. Please observe the local regulations regarding the disposal of packaging materials, exhausted batteries and old equipment.

Copyright notice



**Be responsible
Respect copyrights**

This item incorporates copy protection technology that is protected by U.S. patents and other intellectual property rights of Rovi Corporation. Reverse engineering and disassembly are prohibited.

Trademark notice



Manufactured under license from Dolby Laboratories. Dolby and the double-D symbol are trademarks of Dolby Laboratories.



'DVD Video' is a trademark of DVD Format/ Logo Licensing Corporation.



ABOUT DIVX VIDEO: DivX[®] is a digital video format created by DivX, Inc. This is an official DivX Certified[®] device that plays DivX video. Visit divx.com for more information and software tools to convert your files into DivX video.

ABOUT DIVX VIDEO-ON-DEMAND: This DivX Certified[®] device must be registered in order to play purchased DivX Video-on-Demand (VOD) movies. To obtain your registration code, locate the DivX VOD section in your device setup menu. Go to vod.divx.com for more information on how to complete your registration.

DivX[®], DivX Certified[®] and associated logos are trademarks of DivX, Inc. and are used under license.

DivX Certified[®] to play DivX video, including premium content.

3 Before use

Place the product

Note

- Place this product on a flat, hard, and stable surface.
- Never place this product in an enclosed cabinet.
- Never place this product on other electrical equipment.
- Keep this product away from direct sunlight, naked flames, or heat.
- Do not block any ventilation openings.
- Apparatus shall not be exposed to dripping or splashing.
- Do not place any sources of danger on the product (for example, liquid filled objects, lighted candles).
- Install this product near the AC outlet where the AC power plug can be easily reached.
- To avoid magnetic interference or unwanted noise, never place the main unit and speakers too close to any radiation devices.

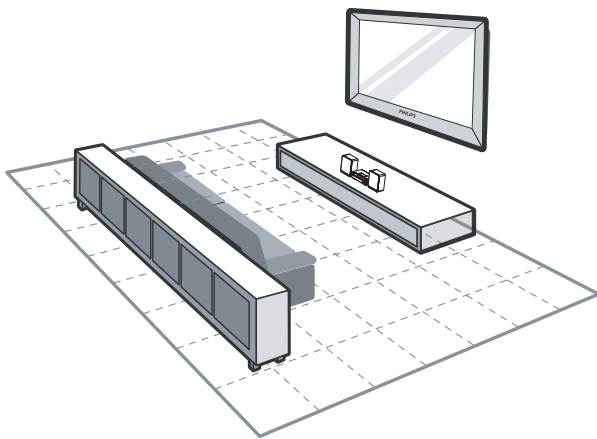

- 1 Place the product near to the TV.
- 2 Place the left and right speakers at equal distance from the TV and at an angle of approximately 45 degrees from the listening position.

Install/replace the battery of remote control

Note

- Risk of explosion! Keep batteries away from heat, sunshine or fire. Never discard batteries in fire.
- If you are not going to use the remote control for a long time, remove the battery.

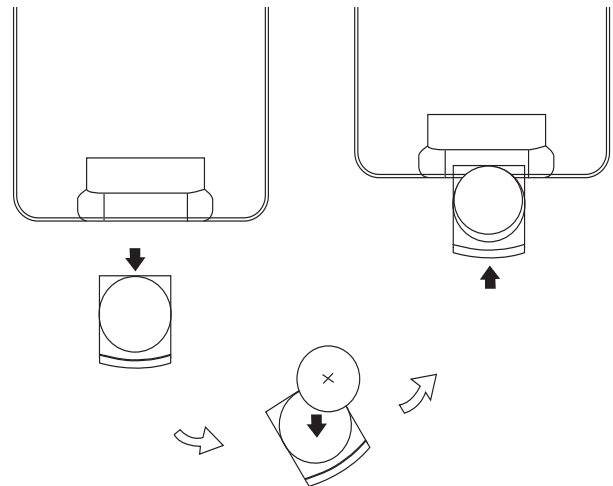

- 1 Open the battery compartment.
- 2 Insert one lithium CR2025 battery with correct polarity (+/-) as indicated.
- 3 Close the battery compartment.

4 Connect

Connect speakers

Note

- For the best sound quality, use the supplied speakers only.
- Connect only speakers with the same or higher impedance. Refer to "Product information" > "Specifications" for the impedance of the supplied speakers.

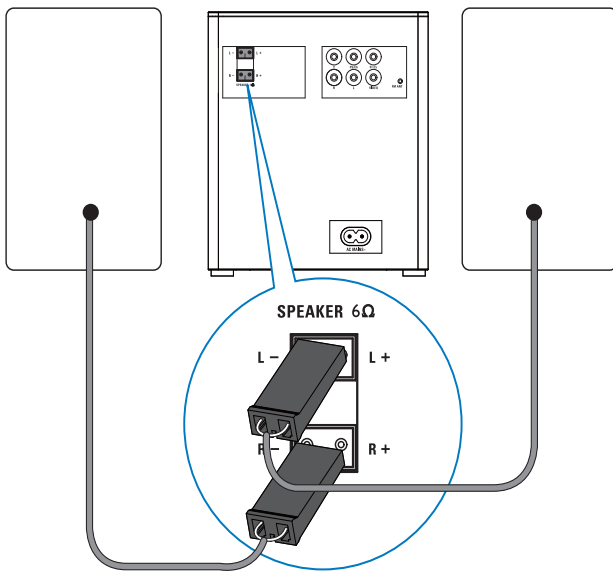

- 1 Connect the speaker plugs to the main unit:
 - the plug of left speaker to **L+** and **L-**.
 - the plug of right speaker to **R+** and **R-**.

Connect TV

To enjoy audio only from the supplied speakers, connect the video cables only. Select the best video connection that your TV supports.

- **Option 1:** Connect through a composite video (CVBS) cable (for a standard TV).
- **Option 2:** Connect through component video cables (for a Progressive Scan TV).

Option 1: Connect through a composite video cable

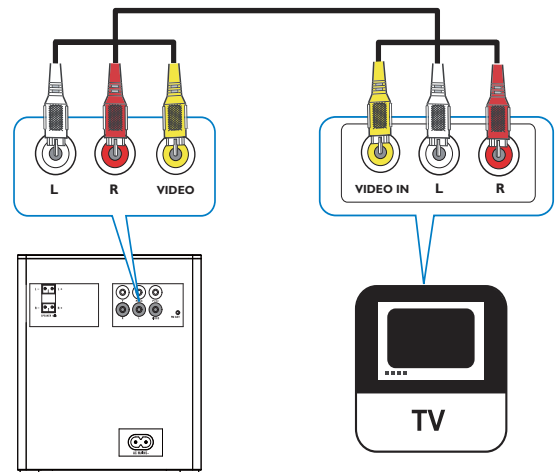

- 1 Connect the composite video cable to:
 - the **VIDEO** socket on this product.
 - the video input socket on the TV.
- 2 Connect the audio cables to:
 - the **L** and **R** sockets on this product.
 - the audio input sockets grouped with the video input socket that is mentioned in step 1.

Option 2: Connect through component video cables

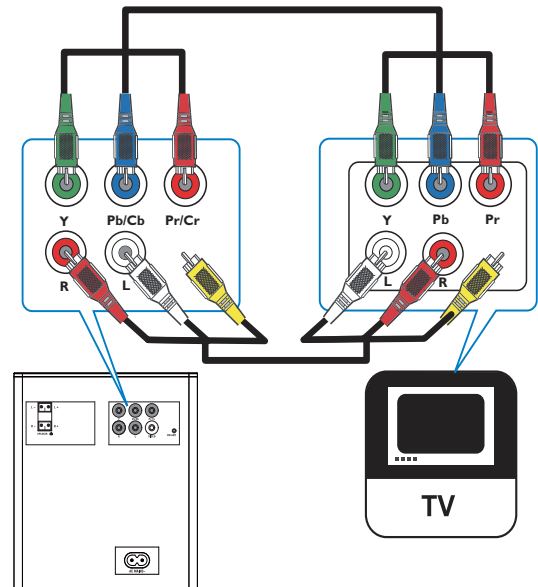

Connect a progressive scan TV through component video cables for higher quality video.

- 1 Connect the component video cables to:
 - the **Y Pb/Cb Pr/Cr** sockets on this product.
 - the component input sockets on the TV.
- 2 Connect the audio cables to:
 - the **L** and **R** sockets on this product.
 - the audio input sockets grouped with the component input socket that is mentioned in step 1.

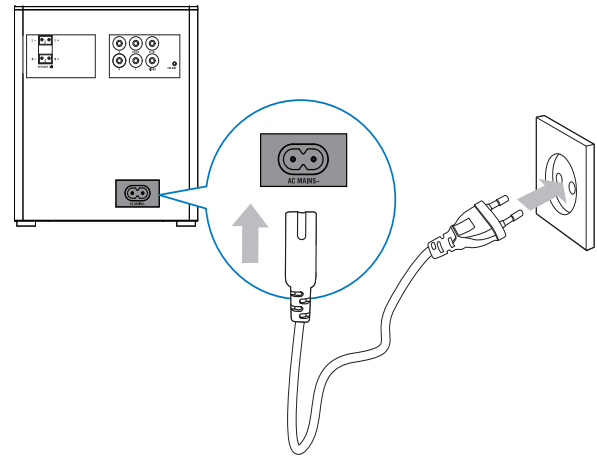

Connect a USB storage device

Note

- For the best data transmission, use the supplied USB cable only.

- 1 Connect the supplied USB cable to:
 - the  jack on this product.
 - the plug of your USB storage device.

Connect power

Note

- Where the MAINS plug or an appliance coupler is used as the disconnect device, the disconnect device shall remain readily operable.
- Risk of product damage! Make sure that the power supply voltage corresponds to the voltage printed on the back of the main unit.
- Before you connect the AC power cord, make sure that you have complete all other connections.
- Protect the power cord from being walked on or pinched, particularly at plugs, convenience receptacles, and the points where they exit from the apparatus.
- Unplug this apparatus during lightning storms or when unused for long periods of time.

- 1 Connect the AC power cord to
 - the **AC MAINS** socket on this product.
 - the power supply.

5 Get started

Turn on

- 1 Press .
 - ↳ The unit switches to the last selected source.

Switch to standby mode



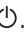

If no source is played within 15 minutes, the product switches to standby mode.

If no operation is performed within 15 minutes in standby mode, the product switches to Eco-power standby mode.

To manually switch the product to standby mode, press .

Set the clock

The unit uses the 24-hour time format.

- 1 In standby mode, press and hold **DISPLAY/CLOCK** for 2 seconds.
 - ↳ The hour digits blinks.
- 2 Press   to set the hour.
- 3 Press **DISPLAY/CLOCK**.
 - ↳ The minute digits blinks.
- 4 Press   to set the minute.
- 5 Press **DISPLAY/CLOCK**.

Find the correct viewing channel

- 1 Press  to turn on the unit.
- 2 Press **DISC** to switch to disc mode.
- 3 Turn on the TV and switch to the correct video-in channel in one of the following ways:
 - Go to the lowest channel on your TV, then press the Channel Down button until you see the blue screen.
 - Press the source button repeatedly on the remote control of your TV.



Tip

- The video-in channel is between the lowest and highest channels and may be called FRONT, A/V IN, VIDEO etc. See the TV user manual on how to select the correct input on the TV.

Select the correct TV system

This product is compatible with both NTSC and PAL. If the picture is abnormally displayed with the default setting, select a TV system that matches your TV.

See "Setup" > "System setup" > **[TV SYSTEM]** for details.

Select a language for on-screen-display messages

English, Portuguese and Spanish are optional for this setting. See "Setup" > "Language setup" > **[OSD LANGUAGE]** for details.

6 Play

! Caution

- Risk of damage to the unit! During play, never move the unit.
- Never put any objects other than discs into the disc compartment.
- Never look at the laser beam inside the unit.
- Never play discs with accessories such as disc stabilizer rings or disc treatment sheets.

When “[INVALID KEY]” is displayed after an operation, it indicates that this operation is unavailable for the current media or at the current time.

Basic operation

The listed operations are applicable for all supported media.

Function	Action
Stop play	Press ■ .
Pause or resume play	Press ▶ .
Skip to the previous/next title, chapter, track, or file	Press ◀▶ .

Play a disc

- 1 Press **DISC** to select the disc source.
- 2 Press **▲** to open the disc compartment.
- 3 Place a disc onto the tray with the printed side upward, and then press **▲**.
- 4 Play starts automatically.
 - To start play manually, press **▶||**.
 - To play a DVD that you set a rating level, enter the 4-digit parental control password first (Refer to “Setup” > “System setup” > **[PASSWORD]** and **[RATING]**).

Play recorded files

You can play DivX/MP3/WMA/JPEG picture files copied onto a CD-R/RW, recordable DVD or USB storage device.

≡ Note

- You can only play DivX videos rented or purchased through the DivX registration code of this unit.
- Subtitle files with the following filename extensions (.srt, .smi, .sub, .ssa, .ass) are supported but do not appear on the file navigation menu.
- The subtitle filename has to be the same as the file name of the video.

- 1 Select a source.
 - For a USB storage device, press **USB**.
 - For a disc, press **DISC**.
- 2 Insert the USB storage device or disc.
 - ↳ The play starts automatically.
 - ↳ The play interface is displayed.

You can see from the interface

- On the top: the name of current file and the name of current folder
- On the left: the folder list
- On the right: the file list
- At the bottom: the category icons (🎵 for music, 🖼️ for photos, and 🎬 for videos)

Access a category

- 1 Press **◀◀** (or **▶▶**) repeatedly until a category icon is highlighted.
 - when a certain category of files are not included, the category icon cannot be highlighted.
- 2 Press **▶▶** (or **◀◀**) to highlight the wanted category icon.
- 3 Press **OK** to confirm.
 - ↳ The folders that contain the files of this category are listed.
 - ↳ The files of this category in the first folder are listed.

Access a folder

- 1 Press ◀ repeatedly until a folder name is highlighted.
- 2 Press ▲▼ to highlight the wanted folder name.
- 3 Press OK to confirm.
 - ↳ The files of the selected category in the folder are listed.

Play a file

- 1 Access a folder.
- 2 Press ▶▶ to highlight a file name.
- 3 Press ▲▼ to highlight the wanted file name.
- 4 Press OK to confirm.
 - ↳ The selected file starts play.
 - ↳ The play stops automatically at the end of the last file of same category.

Play slideshow and music simultaneously

Note

- Make sure that the USB storage device or the disc contains both WMA/MP3 files and JPEG photos.
- See "Setup" > "System setup" for slideshow settings.

- 1 Play a WMA/MP3 file.
- 2 Access the photo category.
- 3 Access a photo folder.
- 4 Select a photo file.
- 5 Press OK to start the slideshow.
 - The slideshow stops after all photos are displayed for one time.
 - To stop the slideshow, press ■.

Play control

During play, follow the control instructions.

Function	Applicable Media	Action
Return to the disc menu	DVD	Press MENU repeatedly.
Enable/disable the PBC (playback control) feature	SVCD, VCD 2.0	Press MENU repeatedly. <ul style="list-style-type: none"> Disable the PBC feature to display the PBC menu, and then use the numeric buttons to enter your choice.
Select an audio language	DVD with multiple sound tracks, VCD with multiple audio channels	Press AUDIO repeatedly.
Select a subtitle language	DVD, DivX video	Press SUBTITLE repeatedly.
Select a camera angle	DVD recorded with multiple camera angles	Press ANGLE repeatedly.
Select a play mode (repeat and random play)	All supported	Press MODE repeatedly.
Repeat a specific section within a chapter or track	Audio, video	<ol style="list-style-type: none"> Press REPEAT A-B to select the start point. Press REPEAT A-B again to select the end point. <ul style="list-style-type: none"> ↳ The selected section starts play repeatedly. To resume normal play, press REPEAT A-B until [REP OFF] is displayed.
Display the play information	All supported	Press DISPLAY .
Zoom in or out	Video images, photos	Press ZOOM repeatedly. <ul style="list-style-type: none"> To pan through an enlarged image, press ▲/▼/◀◀▶▶.
Slow down the play	Video	Press ▼ repeatedly to select a play speed.
Search backward/forward fast	Audio, video	Press and hold ◀◀/▶▶ for 2 seconds to select a speed.
Preview photos	Photos	Press ▲/▼ to highlight a file name in the file list.
Rotate a photo	Photos	Press ▲/▼/◀◀▶▶ .

Search by time or title/chapter/track number

- 1 During play, press **GOTO**.
- 2 Press **◀▶** to highlight the title number, chapter number, track number, or time field.
- 3 Use the **numeric buttons** to enter the number or time digits.
- 4 Press **OK** to confirm.
 - ↳ **[GOTO]** is displayed.
 - ↳ Play starts automatically.

Adjust sound

You can adjust the volume level and select sound effects.

Function	Action
Increase/decrease the volume level	Press + VOL - ; turn VOLUME clockwise or anti-clockwise.
Select a preset sound effect (FLAT , POP , ROCK , JAZZ , and CLASSIC)	Press DSC repeatedly.
Enable/disable the DBB (Dynamic Bass Boost) feature	Press DBB . <ul style="list-style-type: none"> • When DBB is disabled, FLAT is selected automatically.
Mute/unmute the speakers	Press MUTE .

7 Other features

Listen to FM radio

Note

- A maximum of 10 radio stations can be stored.
- Fully extend the FM antenna for better reception.

Program radio stations automatically

- 1 Press **TUNER**.
- 2 Press and hold **ANGLE/PROG** for 2 seconds.
 - ↳ **AUTO** blinks.
 - ↳ Available stations are programmed.
 - ↳ The first programmed radio station is broadcast automatically.

Program radio stations manually

- 1 Press **TUNER**.
- 2 Press **◀▶** repeatedly to tune to a radio station.
- 3 Press **ANGLE/PROG**.
 - ↳ The sequence number blinks with the current frequency displayed.
- 4 Press **◀▶** to allocate a sequence number from **01** to **10** to this radio station.
- 5 Press **ANGLE/PROG** to confirm.
 - ↳ The sequence number and the current frequency are displayed.
- 6 Repeat steps 2-5 to program more stations.

Note

- To overwrite a programmed station, store another station with its sequence number.

Tune to a stored radio station

- 1 Press **TUNER**.
- 2 Press **◀▶** (or **▲▼**) repeatedly to select your radio station.

Play audio from an external device

You can use this unit to play audio from an external device.

- 1 Connect the MP3 link cable to
 - the **MP3 LINK** jack of this unit
 - the audio output jack (usually headphone jack) of the external device.
- 2 Press **MP3-LINK**.
- 3 Play the external device (see the user manual of this device for details).

Listen through headphone

- 1 Plug a headphone into the  socket.

Turn on/off automatically

You can set a time for automatic power on and another time for power off.

Before the setup, make sure that you have set the clock.

- 1 In standby mode, press and hold **SLEEP/TIMER**.
 - ↳ **ON TIME** (time for power on) blinks.
- 2 Press **SLEEP/TIMER**.
 - ↳ The hour digits blink.
- 3 Press **◀▶** to set the hour.
- 4 Press **SLEEP/TIMER**.
 - ↳ The minute digits blink.
- 5 Press **◀▶** to set the minute.

- 6 Press **SLEEP/TIMER**.
 - ↳ **ON TIME** blinks.
 - ↳ If you want to set the power-off time, press **◀▶** to select **OFF TIME** (time for power off), and then repeat steps 2-6.
- 7 Press **◀▶** to select **SOURCE**.
- 8 Press **SLEEP/TIMER**.
- 9 Press **◀▶** to select a media source (**DISC**, **TUNER** or **USB**).
 - For the tuner source, you still need to press **◀▶** to select a programmed radio station.
- 10 Press **SLEEP/TIMER**.
 - ↳ The clock time is displayed.
- 11 Press **SLEEP/TIMER** to activate the timer.
 - ↳ A clock icon is displayed.
 - ↳ The product turns on/off at the set time.
 - To deactivate the timer, press **SLEEP/TIMER** again.

Use the sleep timer

The unit can also turn off automatically after a preset period (10-90 minutes with an interval of 10 minutes).

- 1 During play, press **SLEEP/TIMER** repeatedly to select a period.
 - ↳ **SLEEP** is displayed.
 - To deactivate the sleep timer, press **SLEEP/TIMER** repeatedly until **SLEEP OFF** is displayed.

8 Setup

Interface for setup menu

After you press **SETUP**, the interface for setup menu is displayed as follows.

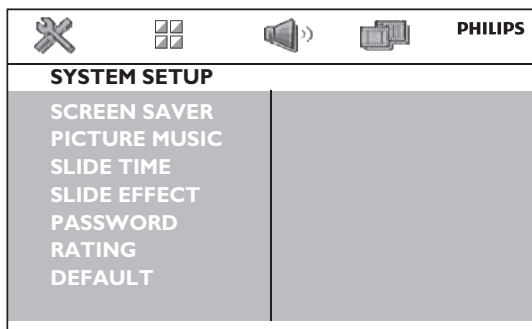

On the top: Icons for main menus

- for **[SYSTEM SETUP]** menu
- for **[LANGUAGE SETUP]** menu
- for **[AUDIO SETUP]** menu
- for **[VIDEO SETUP]** menu

In the middle: Name of the current main menu

On the left: Items under the current menu

On the right: Setting options

Change a setting

Note

- If a menu item or setting option is grayed out, it means that the setting cannot be changed at the current state.

- 1 Press **SETUP**.
 - To access another main menu, press **◀▶▶▶** to select its icon.
- 2 Press **▲▼** to select a menu item.
- 3 Press **OK**.
 - If a dialog box is displayed, follow the instructions to operate.
- 4 Press **▲▼** to select your setting option.
- 5 Press **OK** to confirm.
 - To exit the menu, press **SETUP**.

System setup

[SCREEN SAVER]

Protect the TV screen from damage due to over exposure to static image.

- **[ON]** - Enable the screen saver.
- **[OFF]** - Disable the screen saver.

[PICTURE MUSIC]

The product can play a slideshow and music simultaneously.

- **[ON]** - Enable this feature.
- **[OFF]** - Disable this feature.

[SLIDE TIME]

Set the time interval (15 seconds, 30 seconds, or 45 seconds) between two slides.

[SLIDE EFFECT]

Select an effect for slide display.

[PASSWORD]

Set a password to restrict the play of rated discs to children. The default password is "0000". You can change the 4-digit password.

- 1 Press **SETUP**.
- 2 Select **[SYSTEM SETUP]** > **[PASSWORD]**, and then press **OK**.
- 3 Enter the current password with the numeric keys (0-9), and then press **OK**.
 - If you forget the password, enter "0000".
- 4 Enter the new password.
- 5 Press **OK** to confirm.

[RATING]

Set the rating level for a disc. Restrict the play of the disc to children. These discs must be recorded with rating levels.

[DEFAULT]

Reset all settings to factory default, except for the settings of **[PASSWORD]** and **[RATING]**.

Language setup

[OSD LANGUAGE]

Select a language for on-screen-display messages.

[MENU LANG]

Select a language for disc menu.

[DIVX SUBTITLE]

Select a character set that supports the subtitle of your DivX video.

[DIVX[R] VOD]

Display the registration code. Use the code behind **[REGISTER CODE]** to register your product on the website <http://VOD.DivX.com>.

Audio setup

[DOWNMIX]

Compress multi-channel Dolby digital sound to 2-channel surround sound (**[LT/RT]**) or stereophonic sound (**[STEREO]**).

[NIGHT MODE]

Equalize loud sound and soft sound. Enable this feature to watch DVD movies at a low volume at night.

[DYNAMIC RANGE]

Set a dynamic range for sound output.

Video setup

[TV SYSTEM]

Select a TV system that matches your TV.

[TV TYPE]

Select a display ratio that matches your TV screen.

9 Product information



Note

- Product information is subject to change without prior notice.

Specifications

Amplifier

Rated Output Power	2 X 25 W RMS
Frequency Response	40 Hz - 20000 Hz, ± 3 dB
Signal to Noise Ratio	> 65 dB
Aux Input	500 mV RMS 600 ohm

Disc

Laser Type	Semiconductor
Disc Diameter	12 cm/8 cm
Video Decoding	MPEG-1 / MPEG-2 / DivX
Video DAC	12 Bits
Signal System	PAL / NTSC
Video Format	4:3 / 16:9
Video S/N	> 48 dB
Audio DAC	24 Bits / 96 kHz
Total Harmonic Distortion	< 0.8% (1 kHz)
Frequency Response	4 Hz - 20 kHz (44.1 kHz) 4 Hz - 22 kHz (48 kHz) 4 Hz - 24 kHz (96 kHz)
S/N Ratio	> 65 dBA
Video resolution	720 X 480 X 30; 720 X 576 X 25

Tuner (FM)

Tuning Range	87.5 - 108MHz
Tuning grid	50KHz
Sensitivity - Mono, 26dB S/N Ratio	<22 dBf
Sensitivity - Stereo, 46dB S/N Ratio	<43 dBf
Search Selectivity	>28dBf
Total Harmonic Distortion	<2%
Signal to Noise Ratio	>55dB

Speakers

Speaker Impedance	6 ohm
Speaker Driver	Full range speaker
Sensitivity	> 80 dB/m/W \pm 4dB/ m/W

General information

AC power	110 - 240 V, 50/60 Hz
Operation Power Consumption	25 W
Eco Standby Power Consumption	< 1 W
Composite Video Output	1.0 Vp-p, 75 ohm
Headphone output	2 X 15 mW, 32 ohm
USB Direct	Version 2.0
Dimensions	
- Main Unit (W x H x D)	152 X 170 X 210 mm
- Speaker Box (W x H x D)	152 X 170 X 200 mm
Weight	
- With Packing	5.3 kg
- Net weight	3.9 kg

Supported disc formats

- Digital Video Discs (DVDs)
- Video CDs (VCDs)
- Super Video CDs (SVCDs)
- Digital Video Discs + Rewritable (DVD+RW)
- Compact Discs (CDs)
- Picture (Kodak, JPEG) files on CDR(W)
- DivX(R) disc on CD-R(W):
- DivX 3.11
- WMA

Supported MP3-CD formats:

- ISO 9660
- Max. title/album name: 24 characters
- Max. title number plus album: 255.
- Max. nested directory: 8 levels
- Max. album number: 130
- Max. MP3 track number: 5000
- Supported sampling frequencies for MP3 disc: 32 kHz, 44.1 kHz, 48 kHz
- Supported Bit-rates of MP3 disc are: 32, 64, 96, 128, 192, 256 (kbps)
- The following formats are not supported:
 - Files like *.VMA, *.AAC, *.DLF, *.M3U
 - *.PLS, *.WAV
 - Discs recorded in Joliet format
 - MP3 Pro and MP3 with ID3 tag

USB playability information

Compatible USB devices:

- USB flash memory (USB 2.0 or USB1.1)
- USB flash players (USB 2.0 or USB1.1)
- memory cards (requires an additional card reader to work with this apparatus)

Supported formats:

- USB or memory file format FAT12, FAT16, FAT32 (sector size: 512 bytes)
- MP3 bit rate (data rate): 32-320 Kbps and variable bit rate
- WMA v9 or earlier
- Directory nesting up to a maximum of 8 levels
- Number of albums/ folders: maximum 99
- Number of tracks/titles: maximum 999
- ID3 tag v2.0 or later
- File name in Unicode UTF8 (maximum length: 128 bytes)

Unsupported formats:

- Empty albums: an empty album is an album that does not contain MP3/WMA files, and is not be shown in the display.
- Unsupported file formats are skipped. For example, Word documents (.doc) or MP3 files with extension .dlf are ignored and not played.
- AAC, WAV, PCM audio files
- DRM protected WMA files (.wav, .m4a, .m4p, .mp4, .aac)
- WMA files in Lossless format

10 Troubleshooting



Caution

- Never remove the casing of this apparatus.

To keep the warranty valid, never try to repair the system yourself.

If you encounter problems when using this apparatus, check the following points before requesting service. If the problem remains unsolved, go to the Philips web site (www.Philips.com/support). When you contact Philips, ensure that your apparatus is nearby and the model number and serial number are available.

No power

- Ensure that the AC cord of the apparatus is connected properly.
- Ensure that there is power at the AC outlet.
- As a power-saving feature, the system switches off automatically 15 minutes after track play reaches the end and no control is operated.

No disc detected

- Insert a disc.
- Check if the disc is inserted upside down.
- Wait until the moisture condensation at the lens has cleared.
- Replace or clean the disc.
- Use a finalized CD or correct format disc.

No picture

- Check the video connection.
- Turn on the TV to the correct Video-In channel.
- Progressive scan is activated but the TV does not support progressive scan.

Black and white or distorted picture

- The disc does not match the TV color system standard (PAL/NTSC).
- Sometimes a slight picture distortion may appear. This is not a malfunction.
- Clean the disc.

- A distorted picture may appear during progressive scan setup.

The aspect ratio of the TV screen cannot be changed even though you have set the TV display format.

- The aspect ratio is fixed on the loaded DVD disc.
- The aspect ratio may not be changed for some TV systems.

No sound or poor sound

- Adjust the volume.
- Disconnect the headphones.
- Check that the speakers are connected correctly.

Remote control does not work

- Before you press any function button, first select the correct source with the remote control instead of the main unit.
- Reduce the distance between the remote control and the unit.
- Insert the battery with its polarities (+/- signs) aligned as indicated.
- Replace the battery.
- Aim the remote control directly at the sensor on the front of the unit.

Disc does not play

- Insert a readable disc with the label side facing you.
- Check the disc type, color system and regional code. Check for any scratches or smudges on the disc.
- Press **SYSTEM MENU** to exit the system setup menu.
- Disable the password for parental control or change the rating level.
- Moisture has condensed inside the system. Remove the disc and leave the system turned on for about an hour. Disconnect and reconnect the AC power plug, and then turn on the system again.
- As a power-saving feature, the system turns off automatically 15 minutes after disc play reaches the end and no control is operated.

DivX video files cannot be played.

- Ensure that the DivX video file is complete.
- Ensure that the file extension is correct.
- Due to Digital Rights issue, the DRM-protected video files cannot be played through an analog video connection (e.g. composite, component and scart). Transfer the video content onto the Disc Media and play these files.

Poor radio reception

- Increase the distance between the apparatus and your TV or VCR.
- Fully extend the FM antenna.
- Connect an outdoor FM antenna instead.

Audio or subtitle languages cannot be set

- The disc is not recorded with sound or subtitles in multiple languages.
- The audio or subtitle language setting is prohibited on the disc.

Cannot display some files in USB device

- The number of folders or files in the USB device has exceeded a certain limit. This phenomenon is not a malfunction.
- The formats of these files are not supported.

USB device not supported

- The USB device is incompatible with the unit. Try another one.

Timer does not work

- Set the clock correctly.
- Switch on the timer.

Clock/timer setting erased

- Power has been interrupted or the power cord has been disconnected.
- Reset the clock/timer.

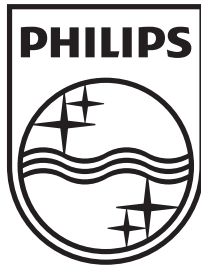

© 2010 Koninklijke Philips Electronics N.V.

All rights reserved.

MCD135_78_UM_V1.3

