

.....	58
.....	58
.....	58
.....	58
.....	58
.....	59
.....	60-62
.....	62
.....	63-67
.....	63
.....	64
VIDEO	64
S-Video	64
.....	65
HDMI	65
.....	66
FM AMW	67
.....	67
.....	68
.....	68
/ /	68
.....	69-73
.....	69
.....	69
.....	70
DVD (CSD)	70
.....	70-71
.....	71
.....	72
.....	73
.....	74-82
.....	74
.....	74
.....	75
/	75
.....	76
(DVD/VCD/SVCD)	76-79
.....	76
.....	77
/	77
.....	77
.....	77

	78
	78
VCD )	78
VCD/SVCD	79
MP3/WMA	80
JPEG	81
	81
	81
/	81
MP3/WMA	82
JPEG	82
DvX	82

USB	83
USB	83
USB	84
-	84
CK	85
CK	85

	86-93
	86
	87
	88-89
	90-91
	92-93

	94-95
	94
	94
	94-95
	94
	95
	95
	95
	95

	96
	96
	96
	96
	97
	97
	98-100
(USB)	101
	102-103
	104



-

-

-

CD

-

-

10 4  
5 2

-

-



- 1

- 2

- 2

- 1

- 1

- 1

- 1 FM

- 1 AMMV

- 1 MP3 LINE-IN

- 1

-



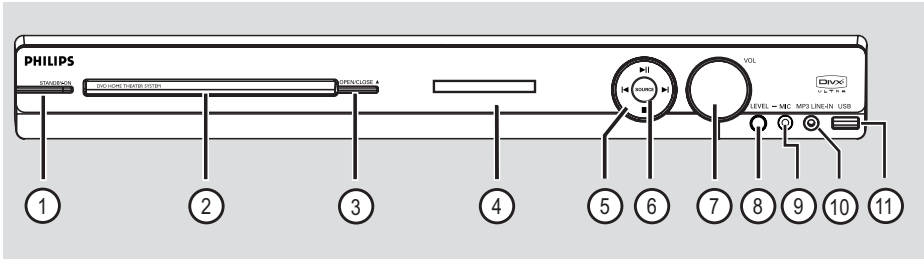

中文(简体)

① **STANDBY-ON**

-

②

③ **OPEN/CLOSE ▲**

- /

④

⑤ **▶|| ( / )**

- DISC ( ) /  
- RADIO ( )

◀ / ▶

-

/ /

-

-

■ ( )

-

-

-

⑥ **SOURCE ( )**

-

DISC FM AM MW TV AUX DI  
MP3 LINE-IN

⑦ **VOL**

-

⑧ **LEVEL**

-

⑨ **MIC**

-

⑩ **MP3 LINE-IN**

-

⑪ **USB**

- USB USB

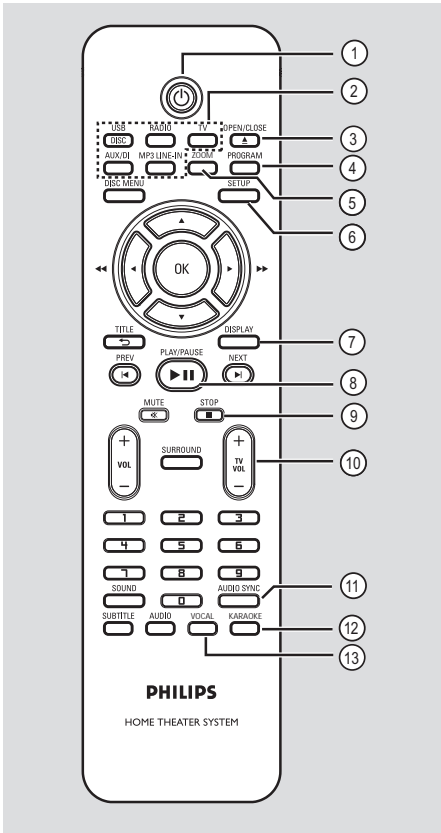

①

-

②

- DISC/USB    DISC    USB

RADIO    FM    AM/MW

TV

AUX/DI    AUX    DIGITAL IN

MP3 LINE-IN

MP3 LINE-IN

③ OPEN/CLOSE ▲

-

④ PROGRAM

-

⑤ ZOOM

-

⑥ SETUP

-

⑦ DISPLAY

-

DVD

⑧ PLAY/PAUSE ►||

-

⑨ STOP ■

-

⑩ TV VOL +/-

-

⑪ AUDIO SYNC

-

⑫ KARAOKE

-

⑬ VOCAL

-

⑭ DISC MENU

- DVD
- VCD/SVCD

⑮ OK

- 
- ⑮ ▲▼◀▶

⑰ TITLE C

- DVD
- VCD 2 0

⑱ PREV ◀ / NEXT ▶

⑲ MUTE 静音

⑳ VOL + / -

㉑ SURROUND

㉒ 0-9

㉓ SOUND

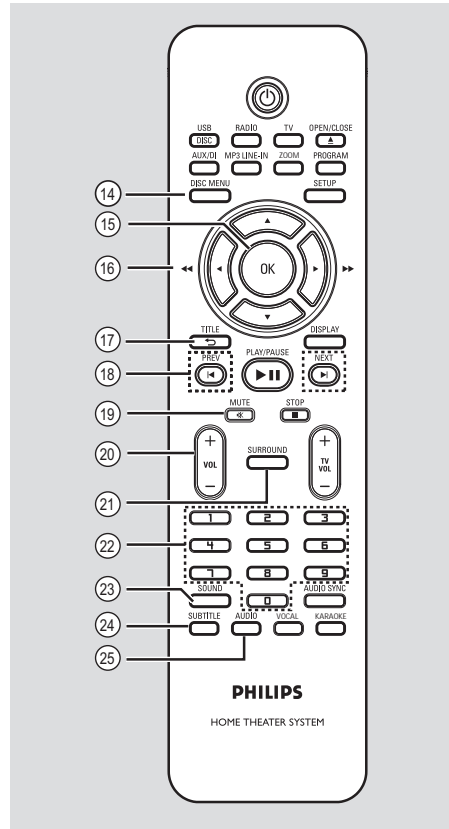

中文(简体)

⑳ SUBTITLE

㉑ AUDIO

( )

中文(简体)

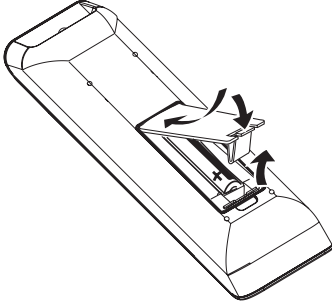

①

②

(+ -)  
R03 AAA

③

④

⑤

DISC/USB  
RADIO TV AUX/DI MP3 LINE-IN

⑥

( ◀ ▶ )

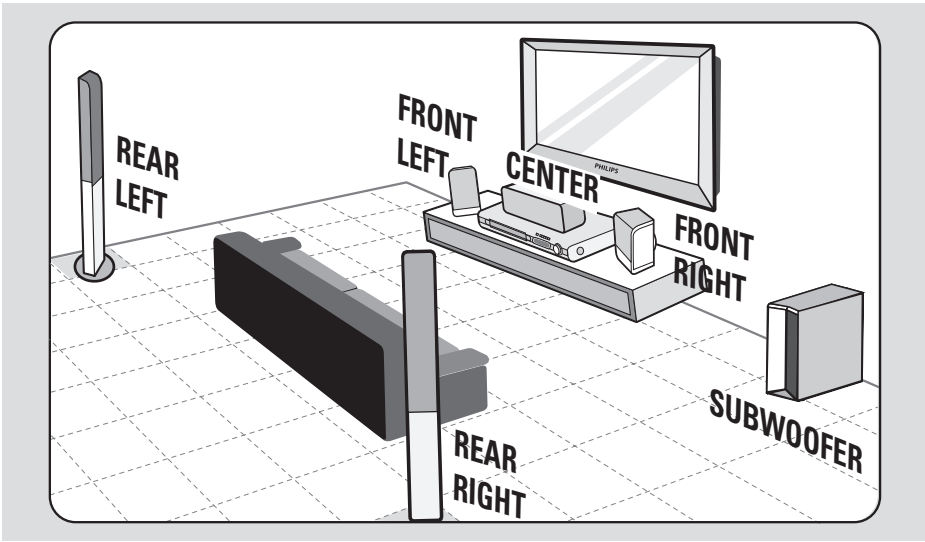

①

45

②

③

④

-  
-  
-  
-  
-

*REAR LEFT*  
*REAR RIGHT*  
*FRONT*  
*LEFT*                      *FRONT RIGHT*

“



( )

中文(简体)

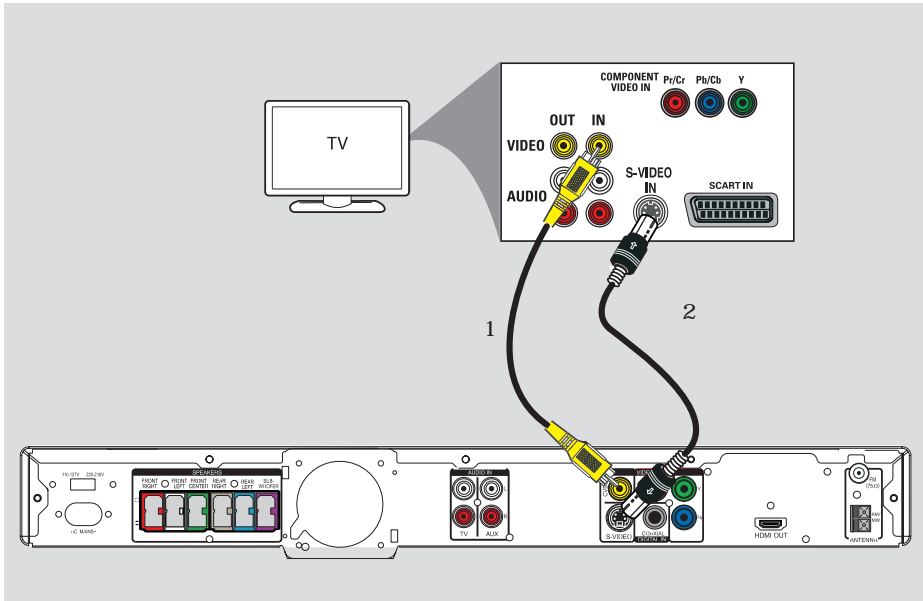

VI DEO

CVBS

A/V In Video In Composite

Baseband

- 1 2
- 3
- HDM 4

S- Vi deo

S- vi deo

S- VI DEO

S- Vi deo

S- VIF

Y/C

è

AUDIO IN  
AUDIO

TV

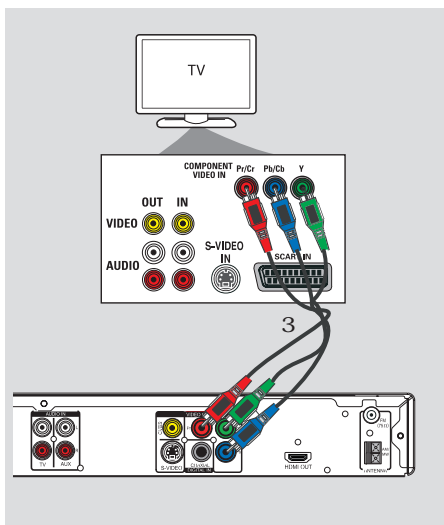

Y Pb Pr

DVD

①

-

YUV

②

“

/ /  
Y Pb Pr  
Y Pb/Cb Pr/Cr

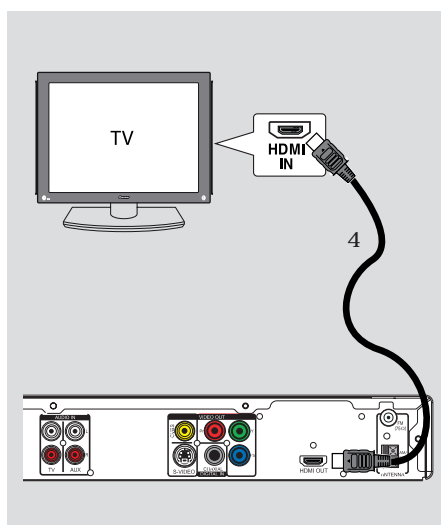

HDMI

HDM

①

HDMI  
HDMI OUT HDMI  
HDMI HDCP DM  
HDMI IN HDMI

②

HDM

“

- HDM

DM  
DM

中文(简体)

( )

中文(简体)

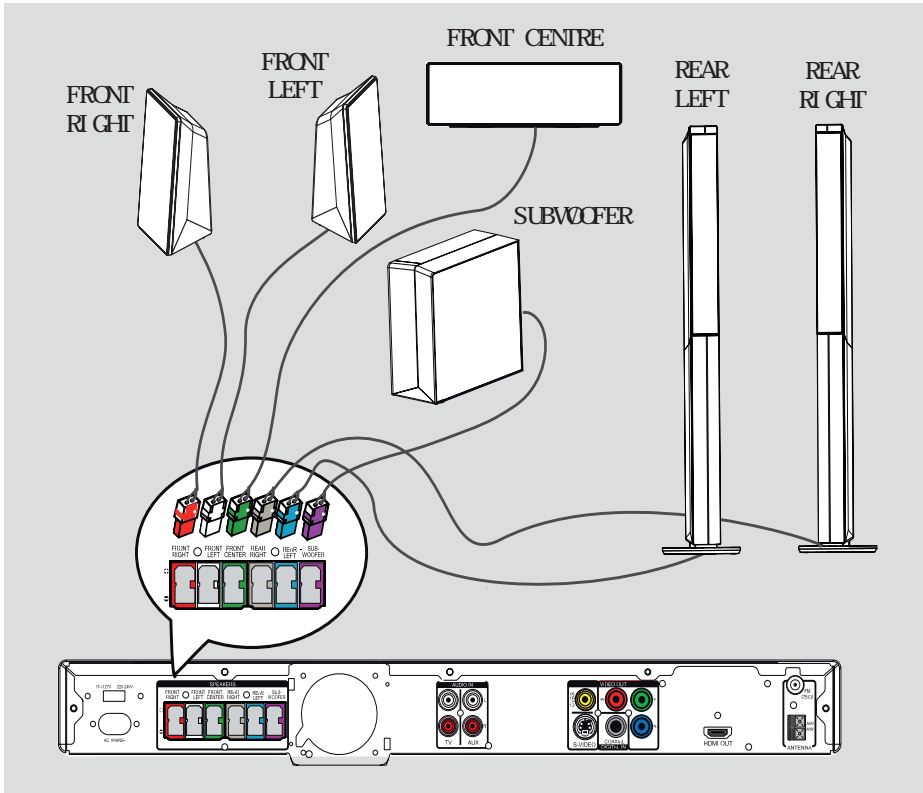

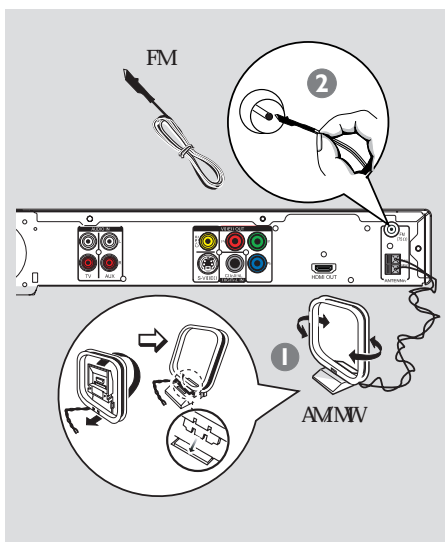

FM AMMW

① AMMW AMMW

② FM FM FM 75 Ω

FM FM

VCR

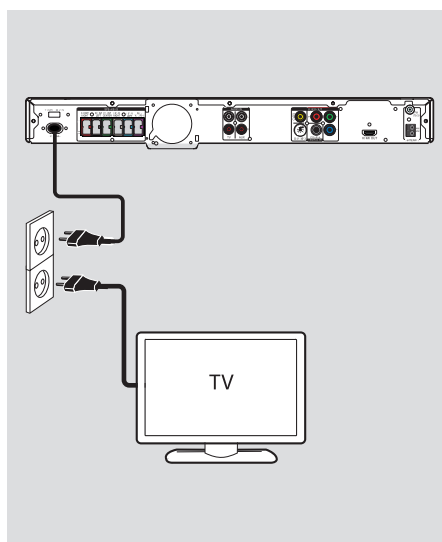

中文(简体)

①



②  
è

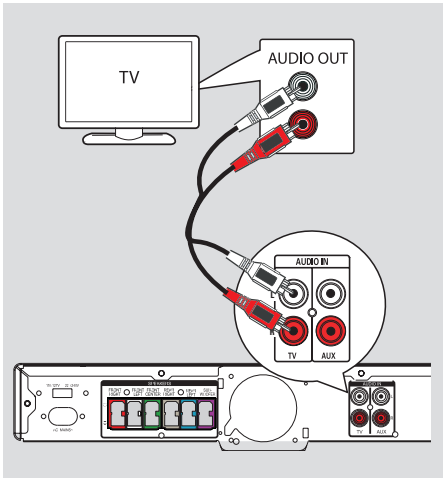

AUDIO IN-TV  
AUDIO OUT

TV

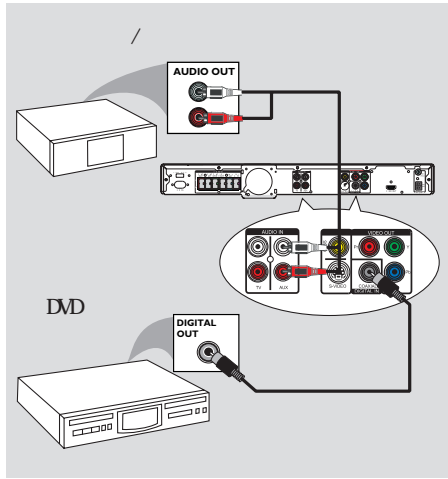

DVD

AUDIO IN-AUX  
AUDIO OUT

AUX/DI

“AUX

COAXIAL DIGITAL IN  
DIGITAL

AUX/DI

“DI

1 SOURCE  
 “ DISC  
 DI SC/USB

2  
 è  
 Down  
 è  
 è  
 VIDEO  
 è

SOURCE

DISC → FM → AMMW  
 → TV → AUX → DI  
 → MP3 LINE-IN MP3  
 → DISC . . . .

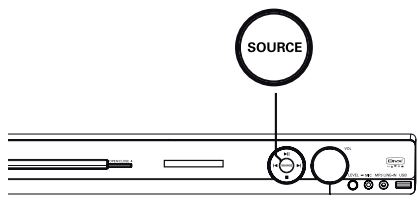

DISC/USB RADIO  
 TV AUX/DI MP3 LINE-IN  
 è DI SC/USB DISC USB  
 è RADIO FM AMMW  
 è  
 TV  
 è AUX/DI  
 AUDIO IN AUX COAXIAL  
 DIGITAL IN  
 è MP3 LINE-IN  
 MP3

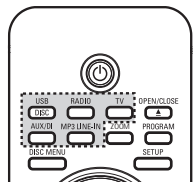

( )



DVD

DVD

中文(简体)



DVD

1

SETUP

è { }

2

e { i }



3

d e  
OK

1

>  
SETUP

2

i { }

3

d e  
i

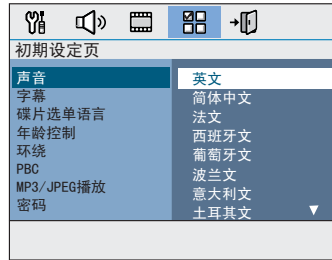

{  
DVD }

{  
DVD }

{  
DVD }

4

d e  
OK

( )

{ }

4 " XXXX 0-9 4  
OK

5

3 ~ 4

- DVD  
AUDIO SUBTITLE

- DVD / /  
DVD

1

SETUP

2

i { }

3

e } i { }

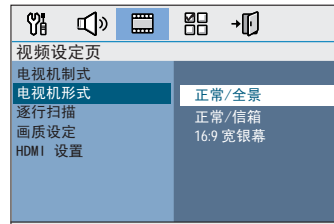

{ \_\_\_ / \_\_\_ }



{ / }



{ 16:9 }



4

OK

中文(简体)



( )

中文(简体)



6

OK

OK

...

Y Pb Pr

“

3

7

è

8

OK

OK

è

1

è

1

OPEN/CLOSE ▲

2

DI SC/USB

2

h

3

SETUP

3

AUDI O

4

i

{

}

-

15

5

{ } CK

{

}

>

-

DVD

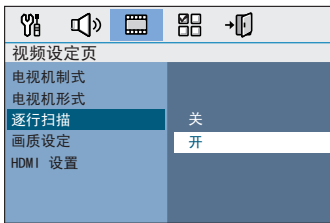



5 d e {  
} i

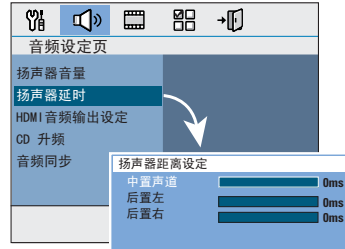

中文(简体)

STOP

1 SETUP

2 i { }

3 e { }

6 h i  
(0 ms ~ 15 ms)

7 OK

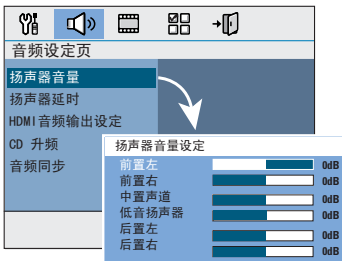

- 1 /  
- 30 /  
-

4 h i  
(-6dB ~ +6dB) OK



DVD

- (DVD)
- (VCD)
- (SVCD)
- DVD (DVD±R)
- DVD (DVD±RW)
- (CD)
- MP3/ Windows Media CD-R(W) (Kodak, JPEG)
- ISO9660/UDF
- JPEG 3072 x 2048
- 32 44.1 48
- 32~256 (kbps) (128 kbps)
- CD-R(W)/DVD±R(W) DivX
- DivX 3/4/5/6 DivX Ultra

DVD  
DVD

0 X

- 1 SOURCE " DI SC DI SC/
- 2 USB
- è DVD
- 3 OPEN/CLOSE ▲
- 4 OPEN/CLOSE ▲
- è
- 5 è

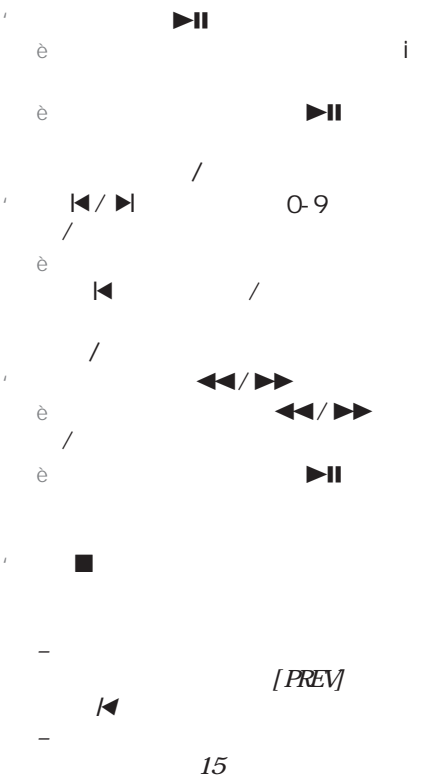
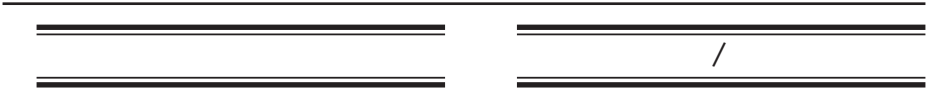

- DVD/SVCD/VCD
- DI SPLAY
- ① è
- ② e “
- ③ i
- DI SPLAY
- DVD
- “ RPT ONE
- “ RPT TT
- “ SHUFFLE
- “ RPT SHF
- “ RPT OFF
- VCD/SVCD/CD
- “ RPT ONE
- “ RPT ALL
- “ SHUFFLE
- “ RPT SHF
- “ RPT OFF
- MP3/DivX/Windows Media™
- “ RPT ONE
- “ RPT ALL/FLD
- “ SHUFFLE
- “ RPT OFF

中文(简体)

( )

(DVD/VCD/SVCD)

Picture CD/MP3

中文(简体)

1

è

PROGRAM

编程: 曲目 (01-16)			
1	04	6	--
2	10	7	--
3	12	8	--
4	--	9	--
5	--	10	--
退出 开始 后页 ▶			

2

/

0-9

2

hide

{ } OK  
▶

/ OK /

4

OK { } /

è

5

{ } OK

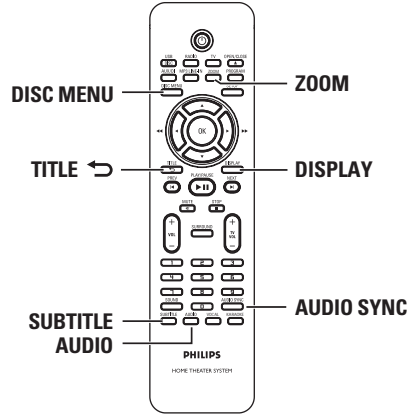

0-9 hide OK

DISC MENU



/

①

è

DI SPLAY

DVD

菜单	▶
标题	01/01
章节	02/99
声音	2ch 中
字幕	关 ▼
位率	播放时间 0:29:17

VCD/SVCD

菜单	▶
曲目	09/16
全碟时间	1:16:05
曲目时间	0:04:32
重复播放	关 ▼
位率 8	全碟时间 0:29:17

②

d e

OK

③

d e

0-9

/

④

è

OK

/

①

ZOOM

è

②

h i d e

③

ZOOM



DVD

DVD

/

SUBTI TLE



DVD

①

DI SPLAY

è

②

e

“ ANGLE

③

i

中文(简体)

( )



DVD  
VCD

(PBC)

VCD

PBC

AUDI O

(PBC)

VCD

2.0

VCD -  
AUDI O

TITLE C

中文(简体)



-  
- { PBC } "

" Lip

" Lip

① AUDI O SYNC

② VCL + -  
0~ 200

è

-  
" - { } "

VCD/SVCD  
VCD/SVCD

⏮ / ⏭

① DISC MENU

选择摘要类型:

- 曲目摘要
- 盘片间隔
- 曲目间隔

{ } OK

OK

③

{ } OK

② d e  
OK

{ }

{ }

{ }

01 A	02 B	03 C
04 D	05 E	06 F
退出		菜单

中文(简体)



( )

MP3/WMA

Windows Media CD MP3

⏪ / ⏩

⏮ / ⏭

OK

DISPLAY

中文(简体)

1

MP3/WMA

è /

30

è

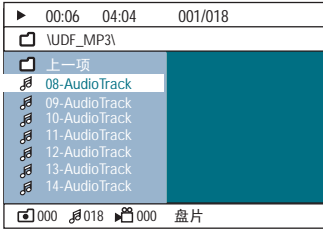

4

MP3/JPEG

JPEG NAV { }

MP3/WMA

MP3/WMA

(ID3)

2

d e  
OK

3

d e /

OK

è

JPEG

①  
è 12

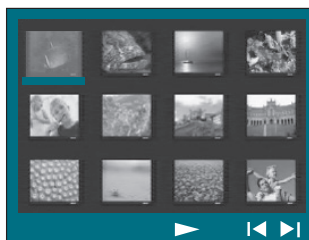

中文(简体)

JPEG CD Picture  
CD JPEG

JPEG  
▶▶

② ◀/▶ /

③ h i d e  
O K

④ D I S C M E N U

\*.JPG  
\*.JPEG  
JPEG-EXIF

① ZOOM

② h i d e

JPEG JPEG  
JPEG JPEG

h i d e /

d  
e  
h  
i

( )

中文(简体)

MP3/VMA

---

JPEG

---

MP3/VMA      JPEG

DvX

---

DVD

---

CD-R/RW   DVD+R/RW   DvX

{ DvX(R) VCD code } (DVX(R))

- ① VMA      MP3/
- ②              OK
- ③              de      OK
- è
- è
- ④ MENU ■      DI SC

- ① DvX
- ② h i d e
- ③ OK
- è      DvX
- è      SUBTI TLE
- è      DvX
- è      AUDI O
- è      ◀▶/▶▶
- è      DI SPLAY      “
- è
- è      . srt .
- è      . sni . . sub . . ssa . . ass
- è
- è
- è      45

# USB

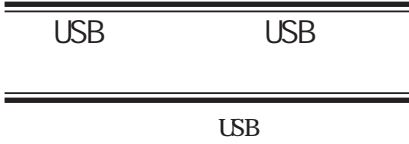

USB  
JPEG MP3 Windows Media  
DivX

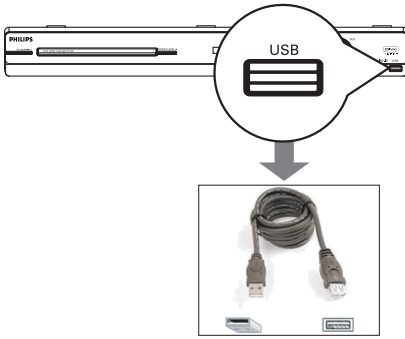

4



MP3/WMA

“

JPEG

“ DivX

DI SC/USB

5

USB

DI SC/USB



- USB  
USB /USB

- USB  
USB USB

- USB  
USB

-

1

USB

/USB

USB

2

5



3

DI SC/USB

è

è

中文(简体)

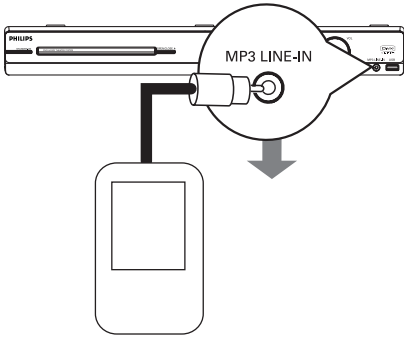

① MP3 LINE-IN

MP3 LINE-IN

② MP3 LINE-IN

③

④ STOP

*DISC/USB RADIO*

*STOP*

OK

1

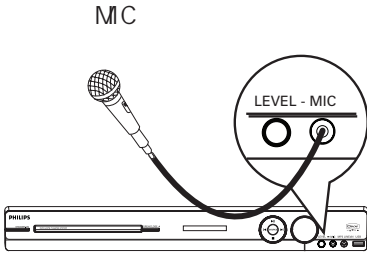

1

KARAOKE

麦克风设定页	
麦克风	开
麦克风音量	关
回音级数	
音调	
记分	

2

d e OK

中文(简体)

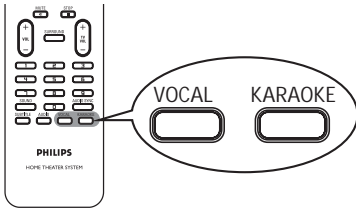

2

OK

d e

OK

3

OK  
VOCAL

4

LEVEL

{ } - -	OK
{ } }	(0 ~ 20) 10
{ } }	(0 ~ 20) 10
{ } - - -	(- 10- +10) " - 10 " +10 " 00
{ } - - - -	{ } OK

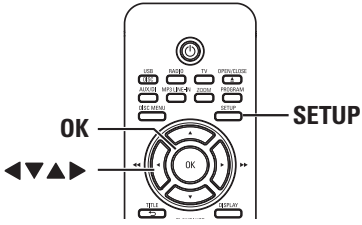

1 SETUP

2 h i

OK

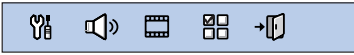

SETUP

SETUP

STOP ■

3 d e

4 OK

è

è

5 SETUP

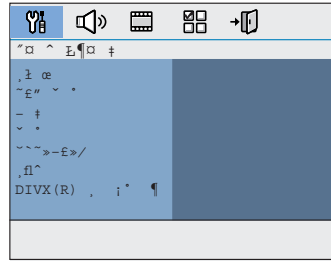

87

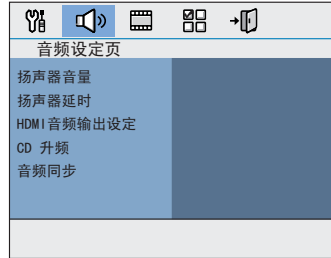

88-89

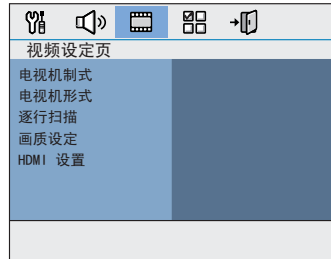

90-91

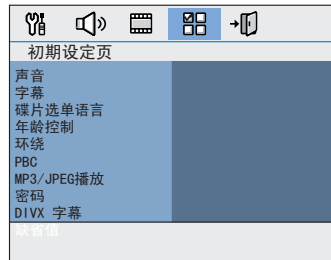

92-93

( )

( )

40

{ } -

“ 136900  
} ”

6

{

-

{ \_\_\_ } -

{ 100% } -

{ 70% } -

{ 40% } -

“

{ \_ } -

5

{ } -

{ 15/30/45/60 } -

{ \_ } -

Di vX(R)

Di vX® VCD  
Di vX® VCD  
Di vX® VCD

www.di.vx.com/vod

i

OK

中文(简体)



( )

( )

h i -6dB

+6dB

“

-

h i

“

-

1

/

(1)

HDMI

HDMI CUT

“

4

HDMI

{ }

-

HDMI

{ }

-

HDMI

PCM

{ PCM}

-

linear-PCM

-

-

HDMI  
CPM

SACD

DVD

( )

( )

CD

CD

{ } - CD  
{ 88.2 kHz (X2) } - CD

- CD

- CD SURROUND

h i 0-200

中文(简体)

( )

( )

中文(简体)



PAL NISC

{ PAL }

- PAL

{ NTSC }

- NISC

{ \_\_\_\_ }

- PAL NISC



{ \_\_\_\_ / \_\_\_\_ }

-



{ \_\_\_\_ / \_\_\_\_ }

-

“



{ 16:9 }

-

16:9

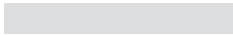

Y Pb Pr

“ -

{ \_\_\_\_ }

-

OK

{ \_\_\_\_ }

-

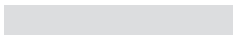

{ \_\_\_\_ }

-

{ \_\_\_\_ }

-

{ \_\_\_\_ }

-

{ \_\_\_\_ }

-

h i

个性化图像设定

亮度		0
对比度		0
色调		0
饱和度		0

OK  
{ 0 }

HMI

( )

( )

HDMI

HDMI

/

{ } -

{ 16:9 } { }

{ }

4:3

{ 4:3 }

4:3

{ \_ }

{ 720p 1080i }

{ HDMI } - /

HDMI

{ 480p }

NTSC 480

{ 576p }

PAL 576

{ 720p } -

HDMI  
720

{ 1080i } -

HDMI  
1080

{ \_\_\_\_ }

480p/576p

中文(简体)

( )

( )

DMD

DMD

DMD

/ /

DMD

DMD

1) d e 1 8

2) CK 0-9 6

- " 8 / (" 1

- " 8

DMD

VCD SVCD CD

- 6 DMD

{ \_ } -  
{ } -

PBC

VCD/SVCD  
VCD (2.0)

{ \_ } - VCD/SVCD

{ } - VCD/SVCD

( )

( )

MP3/JPEG

MP3/JPEG

{ } - MP3/

{ } - MP3/

650 /

“ 136900

1) OK

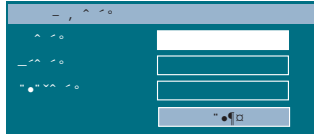

2) 0-9 { }

6

“ 136900

3) { } 6

4) { } 6

5) OK

Di vX

Di vX

{ } -

{ } -

{ } -

{ } -

Ronan

{ } -

{ } -

{ } -

OK

中文(简体)

... FM AMMW



20 AMMW

40 FM

① SOURCE " FM RADIO

② h / i è

③ ②

④ d / e

-  
-  
- 20  
-  
" 5



/ (AMMW/ FM 9 kHz/ 10 kHz/100 kHz)

① SOURCE " FM " AMMW

② ■

③ ►|| " GRID 9 " GRID 10

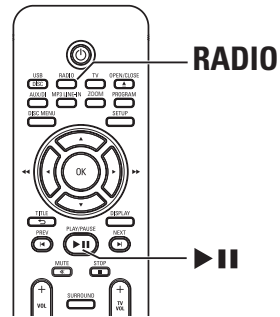

① RADIO " RADIO " AUTO I INSTALL ... PRESS PLAY ( ... PLAY)

② ►|| " FM AMMW

è  
è  
è

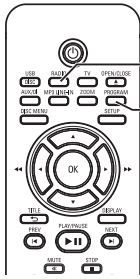

**RADIO**  
**PROGRAM**

① RADIO “ FM “ AMMW

② ⏮ / ⏭

è

① RADIO “ FM “ AMMW

② PROGRAM  
“ START ... ( ... )

è

① ⏮ / ⏭

② ■ “ FMAMMWX  
DELETED ( )

è X

è

è

①

② PROGRAM

③ ⏮ / ⏭

④ PROGRAM

中文(简体)



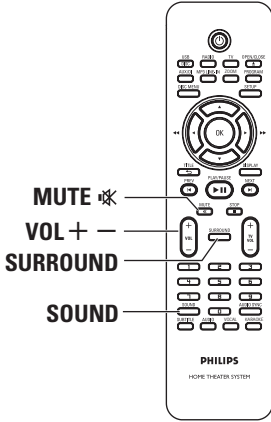

VOL +/-

è “ VOL MIN  
“ VOL MAX

MUTE 静音

è “ MUTE ( )

è MUTE 静音

SURROUND

è

è

DTS

II

è

( )

## SOUND

CONCERT	CLASSIC	DVD
DRAMA	JAZZ	
ACTION	ROCK	/
MTV	RnB	MTV
GAMING	PARTY	
CARTOON	LOUNGE	
SPORTS	SPORTS	
NEWS	NEWS	/
NIGHT	NIGHT	



( )

STANDBY- ON

DVD

DISC/USB

15

1) OPEN/CLOSE ▲  
2) h  
3) AUDIO

/

SOURCE

TV AUX/DI

SURROUND

DTS

i , ⏪ / ⏩

DISC/USB RADIO

IR

DVD+R/CD-R

SETUP

1

DVD

DVD  
DVD

STOP

DvX “  
DvX  
DvX

DvX

/

中文(简体)

( )

USB/HDMI

中文(简体)

USB

USB

HDMI

HDMI

- USB  
-  
NIFS  
- USB  
- DM /HDCP  
HDMI  
- HDMI SACP  
DVD  
- “ - { - HDMI  
}  
- HDMI HACP  
DM HDMI HACP  
DM HDMI  
- HDMI  
- { - HDMI - HDMI  
}

(USB)

USB  
" Good Bye. j pg"  
500 " Good\_B~1. j pg" (FAT16)  
1MB / (8)

USB

USB

中文(简体)

USB  
(j pg) (mp3) USB EXI F  
EXI F  
USB

MP

NIFS FAT16 FAT32

中文(简体)

AUDIO LEFT/RIGHT

16:9

4:3

4:3

11

11

11

/ kbps

DTS

DVD

HDMI

(HDMI)

(CVBS)

HDMI

HDMI

DM

HDCP

DVD

HDMI

DM

HDCP

D1 vX D1 vX

D1 vX Networks  
MPEG-4

JPEG

" JPG JPEG

DVD

MP3

" MP3

1

MPEG 1 Audio Layer 3

MP3

CD R

CD RW

CD

VVA Windows Media

Microsoft Corporation

VVA

Windows Media Player 9

Windows XP Windows Media

Player

" VVA

MPEG

DVD

PBC

VCD/SVD

中文(简体)



					110-127 V / 220-240 V~
		600			50-60
		180 -14	/ ±3 dB		100
		> 60 dB	A	x x	435 x 55 x 367
					4.04
	- AUX	500 mV			
	-	250 mV			
	- MP3	500 mV			
					3 Ω
					3"
					150 - 20
				x x	95.5 x 198.3 x 75
		FM 87.5-108			
		(50/100 )			
		AM 531-1602			0.62 /
		(9 )			
		AM 530-1700			
		(10 )			
26 dB		FM 22 dBf,			3 Ω
		AM 5000 μV/m			3"
IF		FM 60 dB, AM 24 dB			150 - 20
		FM 50 dB, AM 30 dB		x x	95 x 1184 x 73.7
AM		FM 30 dB			
		FM 3%			5.99 /
		FM 3%			
		AM 5%			
		FM 180 -10	/		
		±6 dB			
		FM 26 dB (1 )			6 Ω
		FM 23.5 dB			2 x 2.5 +
					2
				x x	150 - 20
					435 x 93.5 x 67
		12 /8			
		MPEG-1 / MPEG-2			1.34
		DivX 3/4/5/6, Ultra			
DAC		12			
		PAL / NTSC			6 Ω
		4:3 / 16:9			203 (8")
S/N		56 dB			
		1.0 Vp-p, 75Ω			40 - 150
		(Y) 1.0 Vp-p, 75Ω		x x	159.5 x 355.5 x 370
		(Pb) 0.7 Vp-p, 75Ω			
		(Pr) 0.7 Vp-p, 75Ω			4.75
DAC		24 / 96			
		4 -20			
		(44.1 )			
		4 -22 (48 )			
		4 -44 (96 )			
PCM		IEC 60958			
		IEC 60958, IEC 61937			
DTS		IEC 60958, IEC 61937			

