

Register your product and get support at  
[www.philips.com/welcome](http://www.philips.com/welcome)

MC155



---

EN User manual

---

**PHILIPS**

# Contents

---

<b>1 Important</b>	4
Safety	4
Notice	6

---

<b>2 Your Micro Hi-Fi System</b>	7
Introduction	7
What's in the box	7
Overview of the main unit	8
Overview of the remote control	9

---

<b>3 Connect</b>	10
Connect speakers	10
Connect power	11

---

<b>4 Get started</b>	11
Prepare the remote control	11
Set clock	12
Turn on	12

---

<b>5 Play disc</b>	13
Play options	13

---

<b>6 Adjust volume level and sound effect</b>	14
Adjust volume level	14
Select a preset sound effect	14
Enhance bass	14
Mute sound	14

---

<b>7 Listen to radio</b>	15
Tune to a radio station	15
Program radio stations automatically	15
Program radio stations manually	15
Select a preset radio station	15

---

<b>8 Other features</b>	16
Set the alarm timer	16
Set the sleep timer	16
Listen to an external device	16

---

<b>9 Product information</b>	17
Specifications	17

---

<b>10 Troubleshooting</b>	18
---------------------------	----

# 1 Important

## Safety

Know these safety symbols



This 'bolt of lightning' indicates uninsulated material within your unit may cause an electrical shock. For the safety of everyone in your household, please do not remove product covering.

The 'exclamation mark' calls attention to features for which you should read the enclosed literature closely to prevent operating and maintenance problems.

**WARNING:** To reduce the risk of fire or electric shock, this apparatus should not be exposed to rain or moisture and objects filled with liquids, such as vases, should not be placed on this apparatus.

**CAUTION:** To prevent electric shock, fully insert the plug. (For regions with polarized plugs: To prevent electric shock, match wide blade to wide slot.)

## Important Safety Instructions

- ① Read these instructions.
- ② Keep these instructions.
- ③ Heed all warnings.
- ④ Follow all instructions.
- ⑤ Do not use this apparatus near water.
- ⑥ Clean only with dry cloth.
- ⑦ Do not block any ventilation openings. Install in accordance with the manufacturer's instructions.

- ⑧ Do not install near any heat sources such as radiators, heat registers, stoves, or other apparatus (including amplifiers) that produce heat.
- ⑨ Protect the power cord from being walked on or pinched, particularly at plugs, convenience receptacles, and the point where they exit from the apparatus.
- ⑩ Only use attachments/accessories specified by the manufacturer.
- ⑪ Use only with the cart, stand, tripod, bracket, or table specified by the manufacturer or sold with the apparatus. When a cart is used, use caution when moving the cart/apparatus combination to avoid injury from tip-over.



- ⑫ Unplug this apparatus during lightning storms or when unused for long periods of time.
- ⑬ Refer all servicing to qualified service personnel. Servicing is required when the apparatus has been damaged in any way, such as power-supply cord or plug is damaged, liquid has been spilled or objects have fallen into the apparatus, the apparatus has been exposed to rain or moisture, does not operate normally, or has been dropped.
- ⑭ Battery usage **CAUTION** – To prevent battery leakage which may result in bodily injury, property damage, or damage to the unit:
  - Install all batteries correctly, + and - as marked on the unit.
  - Do not mix batteries (old and new or carbon and alkaline, etc.).

- Remove batteries when the unit is not used for a long time.
- Batteries (battery pack or batteries installed) shall not be exposed to excessive heat such as sunshine, fire or the like.

- ⑮ **Apparatus shall not be exposed to dripping or splashing.**
- ⑯ **Do not place any sources of danger on the apparatus (e.g. liquid filled objects, lighted candles).**
- ⑰ **Where the MAINS plug or an appliance coupler is used as the disconnect device, the disconnect device shall remain readily operable.**



#### Warning

- Never remove the casing of this apparatus.
- Never lubricate any part of this apparatus.
- Never place this apparatus on other electrical equipment.
- Keep this apparatus away from direct sunlight, naked flames or heat.
- Never look into the laser beam inside the apparatus.
- Ensure that you always have easy access to the power cord, plug or adaptor to disconnect the apparatus from the power.



#### Caution

- Use of controls or adjustments or performance of procedures other than herein may result in hazardous radiation exposure or other unsafe operation.

- Sound can be deceiving. Over time your hearing 'comfort level' adapts to higher volumes of sound. So after prolonged listening, what sounds 'normal' can actually be loud and harmful to your hearing. To guard against this, set your volume to a safe level before your hearing adapts and leave it there.

#### To establish a safe volume level:

- Set your volume control at a low setting.
- Slowly increase the sound until you can hear it comfortably and clearly, without distortion.

#### Listen for reasonable periods of time:

- Prolonged exposure to sound, even at normally 'safe' levels, can also cause hearing loss.
- Be sure to use your equipment reasonably and take appropriate breaks.

#### Be sure to observe the following guidelines when using your headphones.

- Listen at reasonable volumes for reasonable periods of time.
- Be careful not to adjust the volume as your hearing adapts.
- Do not turn up the volume so high that you can't hear what's around you.
- You should use caution or temporarily discontinue use in potentially hazardous situations. Do not use headphones while operating a motorized vehicle, cycling, skateboarding, etc.; it may create a traffic hazard and is illegal in many areas.

## Hearing safety

### Listen at a moderate volume.

- Using headphones at a high volume can impair your hearing. This product can produce sounds in decibel ranges that may cause hearing loss for a normal person, even for exposure less than a minute. The higher decibel ranges are offered for those that may have already experienced some hearing loss.

## Notice

Any changes or modifications made to this device that are not expressly approved by Philips Consumer Lifestyle may void the user's authority to operate the equipment.



This product complies with the radio interference requirements of the European Community.



Your product is designed and manufactured with high quality materials and components, which can be recycled and reused.



When this crossed-out wheeled bin symbol is attached to a product it means that the product is covered by the European Directive 2002/96/EC.

Please inform yourself about the local separate collection system for electrical and electronic products.

Please act according to your local rules and do not dispose of your old products with your normal household waste. Correct disposal of your old product helps to prevent potential negative consequences for the environment and human health.



Your product contains batteries covered by the European Directive 2006/66/EC, which cannot be disposed with normal household waste. Please inform yourself about the local rules on separate collection of batteries because correct disposal helps to prevent negative consequences for the environmental and human health.

## Environmental information

All unnecessary packaging has been omitted. We have tried to make the packaging easy to separate into three materials: cardboard (box), polystyrene foam (buffer) and polyethylene (bags, protective foam sheet.)

Your system consists of materials which can be recycled and reused if disassembled by a specialized company. Please observe the local regulations regarding the disposal of packaging materials, exhausted batteries and old equipment.



The making of unauthorized copies of copy-protected material, including computer programs, files, broadcasts and sound recordings, may be an infringement of copyrights and constitute a criminal offence. This equipment should not be used for such purposes.

## Class II equipment symbol



This symbol indicates that the unit has a double insulation system.



### Note

- The type plate is located at the rear of the apparatus.

## 2 Your Micro Hi-Fi System

Congratulations on your purchase, and welcome to Philips! To fully benefit from the support that Philips offers, register your product at [www.Philips.com/welcome](http://www.Philips.com/welcome).

---

### Introduction

With this unit, you can enjoy music from audio discs, external devices, or radio stations.

To enrich sound, the unit offers you multiple sound effects:

- Digital Sound Control (DSC)
- Dynamic Bass Boost (DBB)

The unit supports the following media format:



---

### What's in the box

Check and identify the contents of your package:

- Main unit
- Loudspeaker boxes x 2
- Remote control
- MP3 link cable
- User manual
- Quick start guide

# Overview of the main unit

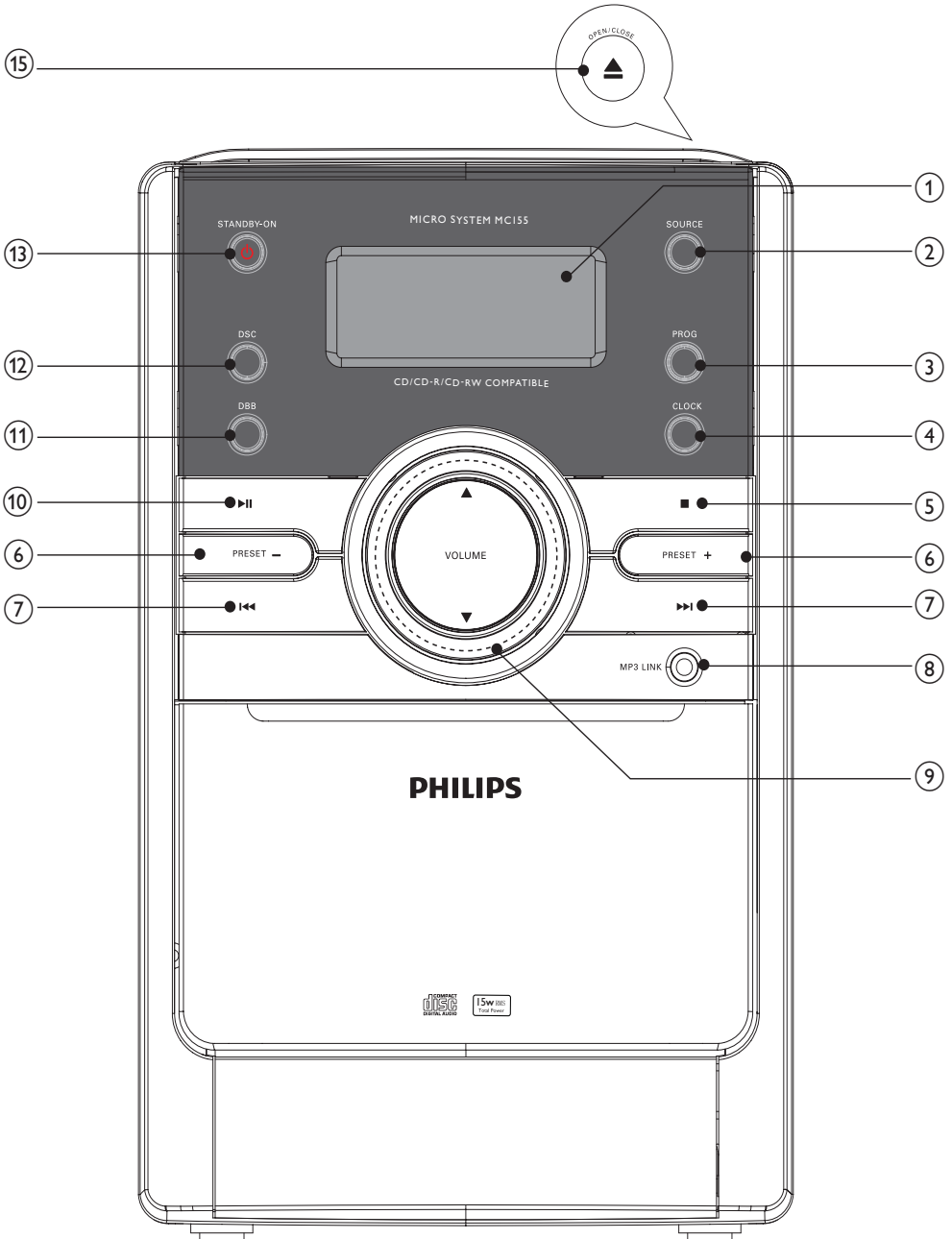

## Overview of the remote control

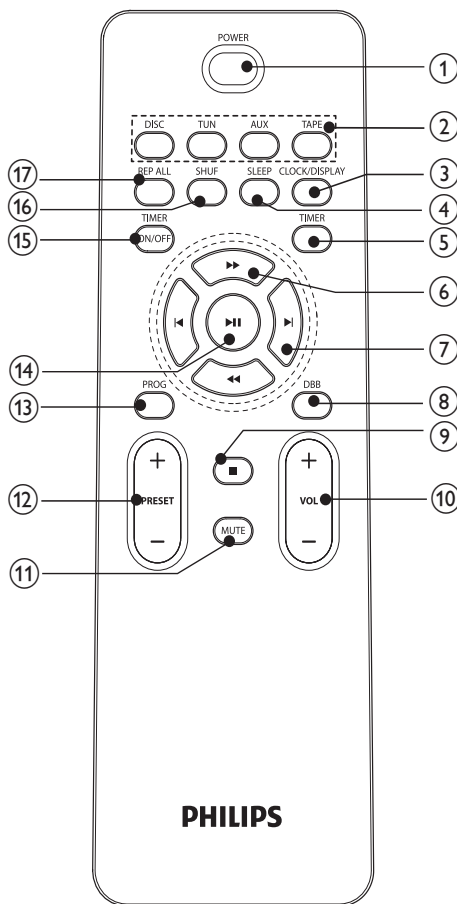

- ① **Display panel**
  - Show current status.
- ② **SOURCE**
  - Select a source: disc, tuner, or MP3 LINK.
- ③ **PROG**
  - Program tracks.
  - Program radio stations.
  - Select 12 hour or 24 hour format.
- ④ **CLOCK**
  - Set the clock.
  - View the clock.
- ⑤ **■**
  - Stop play or erase a program.
- ⑥ **PRESET +/-**
  - Select a preset radio station.
  - Skip to the previous/next album.
- ⑦ **⏮⏪⏩⏭**
  - Skip to the previous/next track.
  - Search within a track or disc.
  - Tune to a radio station.
  - Adjust time.
- ⑧ **MP3 LINK**
  - Jack for an external audio device.
- ⑨ **VOLUME▲▼**
  - Adjust volume.
- ⑩ **▶||**
  - Start or pause play.
- ⑪ **DBB**
  - Turns on or off dynamic bass enhancement.
- ⑫ **DSC**
  - Select a preset sound setting: POP, JAZZ, CLASSIC or ROCK.
- ⑬ **STANDBY-ON**
  - Turn on the unit, switch to standby mode.
- ⑭ **OPEN/CLOSE▲**
  - Open or close the disc tray.

- ① **POWER**
  - Switch on the unit
  - Switch to standby mode.
- ② **Source selection keys (DISC, TUN, AUX)**
  - Please note that the **TAPE** button is not applicable for this model.
- ③ **CLOCK/DISPLAY**
  - Set the clock.
  - View the clock.



- ④ **SLEEP**
  - Set the sleep timer.
- ⑤ **TIMER**
  - Set the alarm timer.
- ⑥ **◀▶▶**
  - Search within a track/ disc.
  - Tune to a radio station.
- ⑦ **⏮▶**
  - Skip to the previous/next track.
  - Adjust time.
- ⑧ **DBB**
  - Turns on or off dynamic bass enhancement.
- ⑨ **■**
  - Stop play or erase a program.
- ⑩ **VOL +/-**
  - Adjust volume.
- ⑪ **MUTE**
  - Mute volume.
- ⑫ **PRESET +/-**
  - Select a preset radio station.
- ⑬ **PROG**
  - Program tracks.
  - Program radio stations.
  - Select 12 hour or 24 hour format.
- ⑭ **▶||**
  - Start or pause play.
- ⑮ **TIMER ON/OFF**
  - Turn on or off alarm timer.
- ⑯ **SHUF**
  - Play tracks randomly.
- ⑰ **REP ALL**
  - Play all tracks repeatedly.

## 3 Connect

### Connect speakers

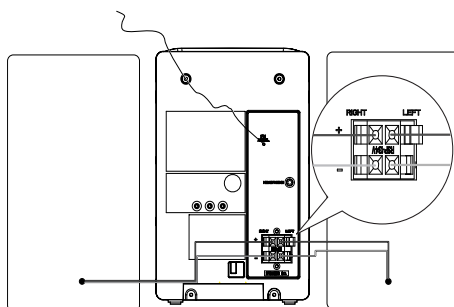

#### Note

- Insert the stripped portion of each speaker wire into the socket completely.
- For optimal sound, use the supplied speakers only.
- Connect only speakers with impedance that is the same or higher than the supplied speakers. Refer to the Specifications section of this manual.

- 1 For the right speaker, find the sockets on the main unit marked 'RIGHT'.
- 2 Insert the red wire to the red (+) socket. To insert each speaker wire:
  - ① Hold down the socket flap.
  - ② Insert the speaker wire fully.
  - ③ Release the socket flap.

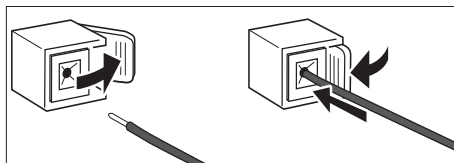

- 3 Insert the black wire into the black (-) socket.
- 4 For the left speaker, find the sockets on the main unit marked 'LEFT'.

5 Repeat steps 2-3.

## Connect power

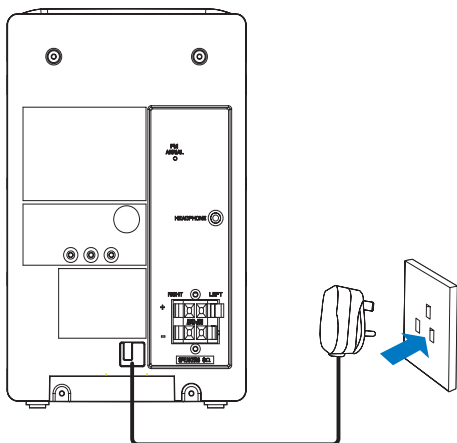

### ! Caution

- Risk of product damage! Make sure that the power supply voltage corresponds to the voltage printed on the back or the underside of the Micro Hi-Fi system.
- Before connecting the AC power cord, make sure that you have completed all other connections.

1 Connect the AC power cord to the power outlet.

## 4 Get started

### ! Caution

- Use the controls only as stated in this user manual.
- Always follow the instructions in this chapter in sequence.

If you contact Philips, you will be asked for the model and serial number of your apparatus. The model number and serial number are on the back of the apparatus. Write the numbers here:  
 Model No. \_\_\_\_\_  
 Serial No. \_\_\_\_\_

## Prepare the remote control

### ! Caution

- Risk of explosion! Keep batteries away from heat, sunshine or fire. Never discard batteries in fire.

To insert the remote control battery:

- 1 Open the battery compartment.
- 2 Insert 2 AAA batteries (not supplied) with correct polarity (+/-) as indicated.
- 3 Close the battery compartment.

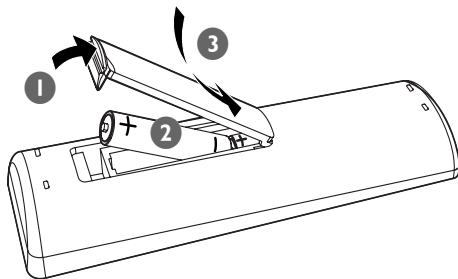



## Note

- If you are not going to use the remote control for a long time, remove the batteries.
- Do not use old and new or different types of batteries in combination.
- Batteries contain chemical substances, so they should be disposed of properly.

---

## Switch to standby

- 1 Press **POWER** to switch the unit to standby mode.
  - ↳ The backlight on the display panel is dimmed.
  - ↳ The clock (if set) appears on the display panel.

---

## Set clock

- 1 Press and hold **CLOCK/DISPLAY** to activate the clock setting mode.
  - ↳ The 12 hour or 24 hour format is displayed.
- 2 Press **PROG** repeatedly to select 12 hour or 24 hour format.
- 3 Press **CLOCK/DISPLAY** to confirm.
  - ↳ The hour digits are displayed and begin to blink.
- 4 Press **◀▶** to set the hour.
- 5 Press **CLOCK/DISPLAY** to confirm.
  - ↳ The minute digits are displayed and begin to blink.
- 6 Press **◀▶** to set the minute.
- 7 Press **CLOCK/DISPLAY** to confirm.



## Tip

- To view the clock during play, press **CLOCK/DISPLAY** repeatedly until the clock is displayed.

---

## Turn on

- 1 Press **POWER**.
  - ↳ The product switches to the last selected source.

## 5 Play disc

- 1 Press **DISC** to select the disc source.
- 2 Press **OPEN/CLOSE▲** on the top panel to open the disc tray.
- 3 Insert a disc with the printed side facing up, then close the disc tray.
- 4 Press **▶||** to start play.
  - To pause/resume play, press **▶||**.
  - To stop play, press **■**.

---

### Play options

---

#### Skip to a track

- 1 During disc playback, press **◀▶** to select another track.

---

#### Search within a track

- 1 During play, press and hold **◀◀▶▶**.
- 2 Release to resume normal play.

---

#### Repeat play

#### Play all tracks or an album repeatedly

- 1 During play, press **REP ALL** repeatedly to select:
  - **[REP]**: Play the current track repeatedly.
  - **[REP ALL]**: all tracks are played repeatedly.
- 2 To return to normal play, press **REP ALL** repeatedly until repeat mode is no longer displayed.

---

#### Random play

- 1 Press **SHUF**.
  - ↳ **[SHUF]** (shuffle) is displayed: all tracks are played randomly.

- 2 To return to normal play, press **SHUF** again.



#### Note

- The repeat and shuffle functions cannot be activated at the same time.
- Shuffle play cannot be selected when you play programmed tracks.

---

### Program tracks

You can program a maximum of 20 tracks.

- 1 At CD mode, in the stop position, press **PROG** to activate the program mode.
  - ↳ **[PROG]** (program) blinks on the display.
- 2 Press **◀▶** to select a track number, then press **PROG** to confirm.
- 3 Repeat steps 2 to 3 to select and store all tracks to program.
- 4 Press **▶||** to play the programmed tracks.
  - ↳ During play, **[PROG]** (program) is displayed.
    - To erase the program, in the stop position, press **■**.

# 6 Adjust volume level and sound effect

---

## Adjust volume level

- 1 During play, press **VOL +/-** to increase/decrease the volume level.

---

## Select a preset sound effect

- 1 During play, press **DSC** repeatedly to select:
  - [POP]
  - [JAZZ]
  - [CLASSIC]
  - [ROCK]

---

## Enhance bass

- 1 During play, press **DBB** to turn on or off dynamic bass enhancement.  
↳ If DBB is activated, DBB is displayed.

---

## Mute sound

- 1 During play, press **MUTE** to mute/unmute sound.

# 7 Listen to radio

## Tune to a radio station

- 1 Press **TUN** to select radio source.
- 2 Press and hold **◀▶** for more than 2 seconds.
  - ↳ **[SEARCH]** is displayed.
  - ↳ The radio tunes to a station with strong reception automatically.
- 3 Repeat step 2 to tune to more stations.
  - To tune to a weak station, press **◀▶** repeatedly until you find optimal reception.

## Program radio stations automatically

You can program a maximum of 20 preset FM radio stations.

- 1 In the tuner mode, press and hold **PROG** for 2 seconds to activate automatic program mode.
  - ↳ **[AUTO]** is displayed.
  - ↳ All available stations are programmed in the order of waveband reception strength.
  - ↳ The first programmed radio station is broadcast automatically.

## Program radio stations manually

You can program a maximum of 20 preset radio stations.

- 1 Tune to a radio station. (See "Tune to a radio station" section.)
- 2 Press **PROG** to activate program mode.
  - ↳ **[PROG]** blinks on the display.

- 3 Press **PRESET +/-** to allocate a number to this radio station, then press **PROG** to confirm.
  - ↳ The preset number and the frequency of the preset station are displayed.
- 4 Repeat the above steps to program other stations.



### Tip

- To overwrite a programmed station, store another station in its place.

## Select a preset radio station

- 1 In tuner mode, press **PRESET +/-** to select a preset number.



### Tip

- Position the antenna as far as possible from TV, VCR or other radiation source.
- For optimal reception, fully extend and adjust the position of the antenna.

# 8 Other features

---



## Set the alarm timer

This Micro Hi-Fi can be used as an alarm clock. The disc or tuner is activated to play at a preset time.

- 1 Ensure that you have set the clock correctly.
- 2 Press and hold **TIMER**.
- 3 Press **DISC** or **TUN** to select a source.
- 4 Press **TIMER** to confirm.  
↳ The hour digits are displayed and begin to blink.
- 5 Press **◀▶** to set the hour.
- 6 Press **TIMER** to confirm.  
↳ The minute digits are displayed and begin to blink.
- 7 Press **◀▶** to set the minute.
- 8 Press **TIMER** to confirm.  
↳ The timer is set and activated.

---

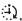
## Activate and deactivate alarm timer

- 1 Press **TIMER ON/OFF** repeatedly to activate or deactivate timer.  
↳ If timer is activated, the display shows .  
↳ If timer is deactivated,  disappears.



### Note

- Alarm timer is not available in MP3 LINK mode.
- If DISC source is selected and the track cannot be played, tuner is activated automatically.

- 1 When the unit is turned on, press **SLEEP** repeatedly to select a set period of time (in minutes).  
↳ When sleep timer is activated, the display shows **zz**.

### To deactivate sleep timer

- 1 Press **SLEEP** repeatedly until "0" is displayed.  
↳ When sleep timer is deactivated, **zz** disappears.

---

## Listen to an external device

You can listen to an MP3 player through this unit.

- 1 Press **AUX** to select MP3 LINK source.
- 2 Connect the supplied MP3 link cable to:
  - **MP3 LINK** jack (3.5 mm) on the unit
  - the headphone jack on an external device
- 3 Start to play the device (see the device user manual).

---

## Set the sleep timer

This unit can switch to standby automatically after a set period of time.

# 9 Product information

## Note

- Product information is subject to change without prior notice.

## Specifications

### Amplifier

Rated Output Power	15W RMS
Frequency Response	60 - 16kHz, $\pm 3$ dB
Signal to Noise Ratio	>65dB
Aux Input	0.5 V RMS 20kohm

### Disc

Laser Type	Semiconductor
Disc Diameter	12cm/8cm
Support Disc	CD-DA, CD-R, CD-RW
Audio DAC	24Bits / 44.1kHz
Total Harmonic Distortion	<1%
Frequency Response	60Hz -16kHz (44.1kHz)
S/N Ratio	>65dBA

### Tuner

Tuning Range	FM: 87.5 - 108MHz;
Tuning grid	50KHz

### FM

Sensitivity	
- Mono, 26dB S/N Ratio	<22 dBf
- Stereo, 46dB S/N Ratio	<43 dBf
Search Selectivity	>28dBf
Total Harmonic Distortion	<3%
Signal to Noise Ratio	>55dB

### Speakers

Speaker Impedance	4ohm
Speaker Driver	3" full range
Sensitivity	>82dB/m/W

### General information

AC power	220 - 230V, 50Hz
Operation Power Consumption	25W
Standby Power Consumption	<2W
Dimensions	
- Main Unit (W x H x D)	147 x 231 x 209mm
- Speaker Box (W x H x D)	134 x 233 x 153mm
Weight	
- With Packing	4.75 kg
- Main Unit	1.95 kg
- Speaker Box	2 x 1.2 kg



# 10 Troubleshooting



## Caution

- Never remove the casing of this apparatus.

To keep the warranty valid, never try to repair the system yourself.

If you encounter problems when using this apparatus, check the following points before requesting service. If the problem remains unresolved, go to the Philips web site ([www.philips.com/welcome](http://www.philips.com/welcome)). When you contact Philips, ensure that the apparatus is nearby and the model number and serial number are available.

### No power

- Ensure that the AC power cord of the unit is connected properly.
- Ensure that there is power at the AC outlet.
- As a power-saving feature, the system switches off automatically 15 minutes after track play reaches the end and no control is operated.

### No sound or poor sound

- Adjust the volume.
- Disconnect the headphones.
- Check that the speakers are connected correctly.
- Check if the stripped speaker wires are clamped.

### Left and right sound outputs reversed

- Check the speaker connections and location.

### No response from the unit

- Disconnect and reconnect the AC power plug, then turn on the system again.

### Remote control does not work

- Before you press any function button, first select the correct source with the remote control instead of the main unit.
- Reduce the distance between the remote control and the unit.
- Insert the battery with its polarities (+/- signs) aligned as indicated.
- Replace the battery.
- Aim the remote control directly at the sensor on the front of the unit.

### No disc detected

- Insert a disc.
- Check if the disc is inserted upside down.
- Wait until the moisture condensation at the lens has cleared.
- Replace or clean the disc.
- Use a finalized CD or correct format disc.

### Poor radio reception

- Increase the distance between the unit and your TV or VCR.
- Fully extend the antenna.

### Timer does not work

- Set the clock correctly.
- Switch on the timer.

### Clock/timer setting erased

- Power has been interrupted or the power cord has been disconnected.
- Reset the clock/timer.

