

Quick start guide



Step A *Connect*

Step B *Setup*

Step C *Enjoy*

What's in the Box?

You should find these items upon opening the box.

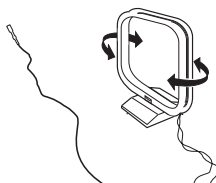

FM / MW antenna



Power cord / AC adaptor

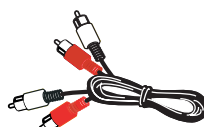

RCA cable



Microphone



Quick Start Guide

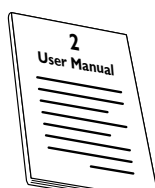

User manual



Warranty Card



Remote control and AAA battery

PHILIPS

Step A *Connect*

- 1 Connect the speaker cables.
- 2 Connect the MW and FM antennas.
- 3 Connect the power cable of the system.

Tip

See the User Manual for how to connect other equipment to this system.

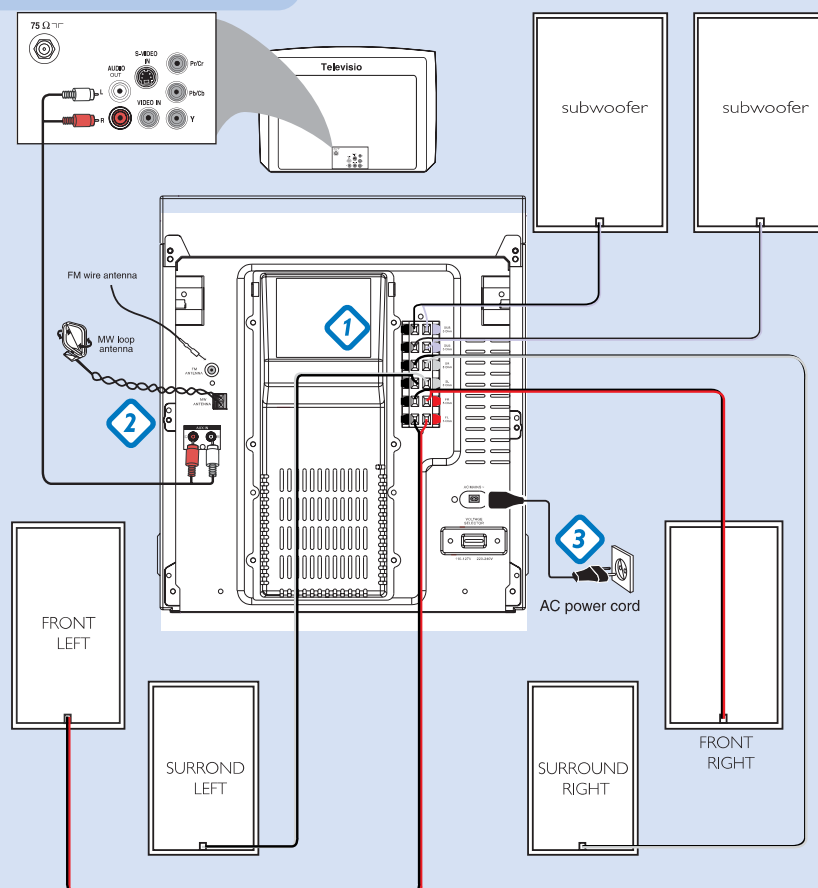

Step B *Setup*

Setting the clock

- 1 In standby mode, press **CLOCK•TIMER** once.
- 2 Press ◀ or ▶ repeatedly to set the hour.
- 3 Press ⏮ or ⏭ repeatedly to set the minute.
- 4 Press **CLOCK•TIMER** again to store the setting.

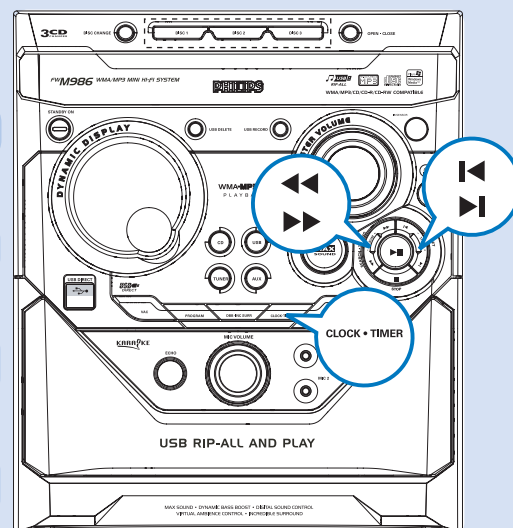

Playing a disc

- 1 Press **OPEN•CLOSE** to open the disc tray and load up to two discs on the individual disc trays. To load the third disc, press **DISC CHANGE**.
→ Make sure the label side of each loaded disc is facing up.
- 2 Press **OPEN•CLOSE** again to close the disc tray.
- 3 Use **DSC 1/2/3** (or **CD 1/2/3** on the remote control) to select a disc for playback.
- 4 To stop playback, press **STOP ■**.

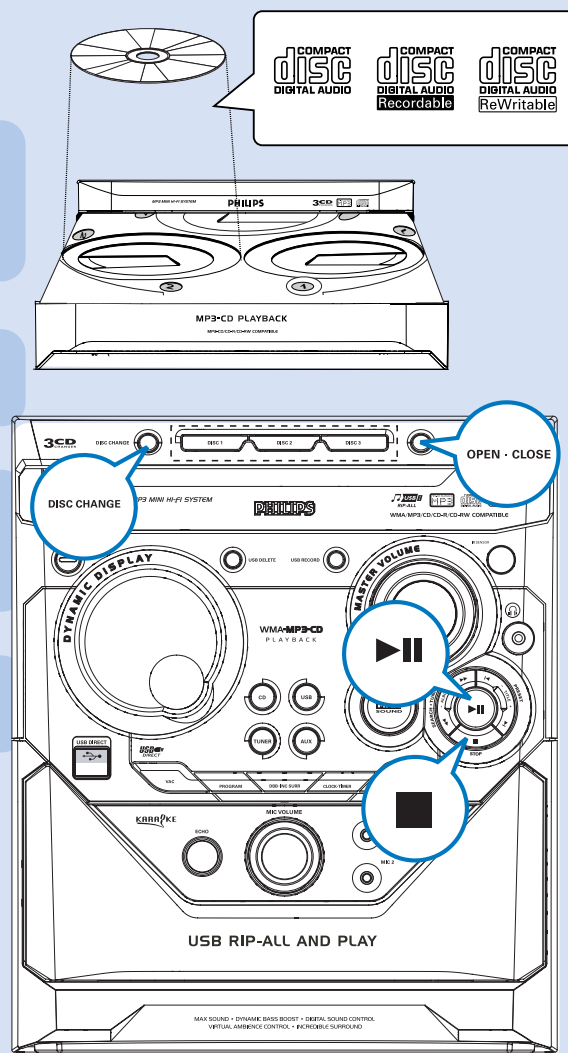

Programming and tuning to radio stations

- 1 Press **TUNER** to select the tuner source.
- 2 Press **PROGRAM** for more than two seconds to program all available stations in order of waveband.
- 3 Press **◀** or **▶** until the desired preset station is displayed.

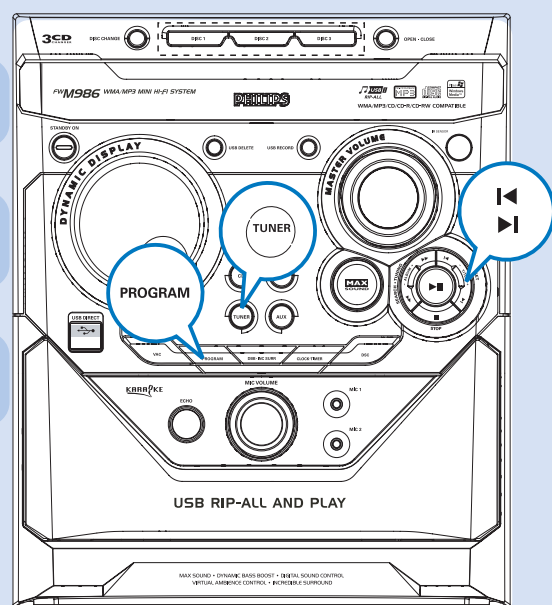

Playing a USB mass storage device

With the Hi-Fi system, you can use USB flash memory (USB 2.0 or USB1.1), USB flash players (USB 2.0 or USB1.1), memory cards (requires an additional card reader to work with this Hi-Fi system).

- 1 Insert the USB device's USB plug into the **USB DIRECT**  socket on the set.
- 2 Press **USB** to select the USB source.
- 3 Play the USB's audio files as you do with the albums/tracks on a CD.

Ripping function

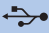
- 1 Insert a USB device with sufficient free space to the **USB DIRECT**  socket on the set.
- 2 Prepare the source to record from.
- 3 Press **USB RECORD** to start ripping.
- 4 At any moment, simply press **STOP**  to stop ripping.

Tip

Detailed playback features and additional functions are described in the accompany owner's manual.

