

Register your product and get support at
www.philips.com/welcome

DS9000



EN User manual

DA Brugervejledning

DE Benutzerhandbuch

ES Manual del usuario

FR Mode d'emploi

IT Manuale utente

NL Gebruiksaanwijzing

SV Användarhandbok

PHILIPS

Contents

| | | |
|----------|------------------|----------|
| 1 | Important | 4 |
| | Safety | 4 |
| | Notice | 8 |

| | | |
|----------|--|-----------|
| 2 | Your Docking Entertainment System | 11 |
| | Introduction | 11 |
| | What's in the box | 11 |
| | Overview of the main unit | 11 |
| | Overview of the remote control | 13 |

| | | |
|----------|----------------------------|-----------|
| 3 | Get started | 15 |
| | Prepare the remote control | 15 |
| | Connect power | 16 |
| | Turn on | 17 |

| | | |
|----------|------------------------------|-----------|
| 4 | Play | 18 |
| | Play from iPod/iPhone | 18 |
| | Play from an external device | 19 |
| | Adjust volume level | 20 |
| | Mute sound | 20 |

| | | |
|----------|----------------------------|-----------|
| 5 | Product information | 21 |
| | Specifications | 21 |

| | | |
|----------|------------------------|-----------|
| 6 | Troubleshooting | 22 |
|----------|------------------------|-----------|

1 Important

Safety



This 'bolt of lightning' indicates uninsulated material within your unit may cause an electrical shock. For the safety of everyone in your household, please do not remove product covering.

The 'exclamation point' calls attention to features for which you should read the enclosed literature closely to prevent operating and maintenance problems.

WARNING: To reduce the risk of fire or electric shock, this apparatus should not be exposed to rain or moisture and objects filled with liquids, such as vases, should not be placed on this apparatus.

CAUTION: To prevent electric shock, match wide blade of plug to wide slot, fully insert.

Important Safety Instructions

- ① Read these instructions.
- ② Keep these instructions.
- ③ Heed all warnings.

- ④ Follow all instructions.
- ⑤ Do not use this apparatus near water.
- ⑥ Clean only with dry cloth.
- ⑦ Do not block any ventilation openings. Install in accordance with the manufacturer's instructions.
- ⑧ Do not install near any heat sources such as radiators, heat registers, stoves, or other apparatus (including amplifiers) that produce heat.
- ⑨ Protect the power cord from being walked on or pinched, particularly at plugs, convenience receptacles, and the point where they exit from the apparatus.
- ⑩ Only use attachments/accessories specified by the manufacturer.
- ⑪ Use only with the cart, stand, tripod, bracket, or table specified by the manufacturer or sold with the apparatus. When a cart is used, use caution when moving the cart/apparatus combination to avoid injury from tip-over.



- ⑫ Unplug this apparatus during lightning storms or when unused for long periods of time.
- ⑬ Refer all servicing to qualified service personnel. Servicing is required when the apparatus has been damaged in any way, such as power-supply cord or plug is damaged, liquid has been spilled or objects have fallen into the apparatus, the apparatus has been exposed to rain or moisture, does not operate normally, or has been dropped.

- ⑭ **Battery usage CAUTION – To prevent battery leakage which may result in bodily injury, property damage, or damage to the unit:**
- Install all batteries correctly, + and - as marked on the unit.
 - Do not mix batteries (old and new or carbon and alkaline, etc.).
 - Remove batteries when the unit is not used for a long time.
- ⑮ **Apparatus shall not be exposed to dripping or splashing.**
- ⑯ **Do not place any sources of danger on the apparatus (e.g. liquid filled objects, lighted candles).**
-

Safety-Important notes for users in the U.K.

Mains plug

This apparatus is fitted with an approved 13 Amp plug. To change a fuse in this type of plug proceed as follows:

- ① **Remove fuse cover and fuse.**
- ② **Fix new fuse which should be a BS1362 5 Amp, A.S.T.A. or BSI approved type.**
- ③ **Refit the fuse cover.**

If the fitted plug is not suitable for your socket outlets, it should be cut off and an appropriate plug fitted in its place. If the mains plug contains a fuse, this should have a value of 5 Amp. If a plug without a fuse is used, the fuse at the distribution board should not be greater than 5 Amp. Note: The severed plug must be disposed off to avoid a possible shock hazard should it be inserted into a 13 Amp socket elsewhere.

How to connect a plug

The wires in the mains lead are coloured with the following code: blue = neutral (N), brown = live (L).

As these colours may not correspond with the colour markings identifying the terminals in your plug, proceed as follows:

- Connect the blue wire to the terminal marked N or coloured black.
- Connect the brown wire to the terminal marked L or coloured red.
- Do not connect either wire to the earth terminal in the plug, marked E (or \perp) or coloured green (or green and yellow).

Before replacing the plug cover, make certain that the cord grip is clamped over the sheath of the lead - not simply over the two wires.

Copyright in the U.K.

Recording and playback of material may require consent. see Copyright Act 1956 and The performer's Protection Acts 1958 to 1972.



Warning

- Where the MAINS plug or an appliance coupler is used as the disconnect device, the disconnect device shall remain readily operable.



Warning

- Never remove the casing of this apparatus.
- Never lubricate any part of this apparatus.
- Never place this apparatus on other electrical equipment.
- Keep this apparatus away from direct sunlight, naked flames or heat.
- Ensure that you always have easy access to the power cord, plug or adaptor to disconnect the apparatus from the power.

Notice

Any changes or modifications made to this device that are not expressly approved by Philips Consumer Lifestyle may void the user's authority to operate the equipment.



This product complies with the radio interference requirements of the European Community.

Recycling



Your product is designed and manufactured with high quality materials and components, which can be recycled and reused.

When you see the crossed-out wheel bin symbol attached to a product, it means the product is covered by the European Directive 2002/96/EC:



Never dispose of your product with other household waste. Please inform yourself about the local rules on the separate collection of electrical and electronic products. The correct disposal of your old product helps prevent potentially negative consequences on the environment and human health.

Your product contains batteries covered by the European Directive 2006/66/EC, which cannot be disposed of with normal household waste.



Please inform yourself about the local rules on separate collection of batteries. The correct disposal of batteries helps prevent potentially negative consequences on the environment and human health.

Environmental information

All unnecessary packaging has been omitted. We have tried to make the packaging easy to separate into three materials: cardboard (box), polystyrene foam (buffer) and polyethylene (bags, protective foam sheet.)

Your system consists of materials which can be recycled and reused if disassembled by a specialized company. Please observe the local regulations regarding the disposal of packaging materials, exhausted batteries and old equipment.

CE-TM-iPod, iPhone and iPad



“Made for iPod”, “Works with iPhone” and “Made for iPad” mean that an electronic accessory has been designed to connect

specifically to iPod, iPhone and iPad and has been certified by the developer to meet Apple performance standards.

Apple is not responsible for the operation of this device or its compliance with safety and regulatory standards.

iPod is a trademark of Apple Inc., registered in the U.S. and other countries.



Note

- The type plate is located on the bottom of the apparatus.

2 Your Docking Entertainment System

Congratulations on your purchase, and welcome to Philips! To fully benefit from the support that Philips offers, register your product at www.philips.com/welcome.

Introduction

With this unit, you can enjoy audio from the iPod/iPhone/iPad and other audio devices.

What's in the box

Check and identify the contents of your package:

- Main unit
- Remote control
- 1 x VDE AC power cord
- 1 x BS AC power cord
- 1 x MP3 link cable
- User manual

Overview of the main unit

Front View

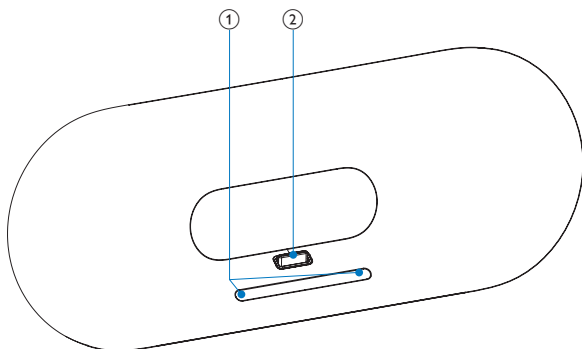

① - VOL +

- Adjust volume.

② iPod/iPhone/iPad dock

Back View

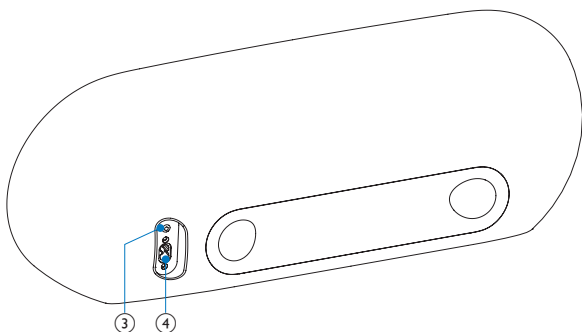

③ AUX IN

- Jack for an external audio device.

④ Power supply socket

Overview of the remote control

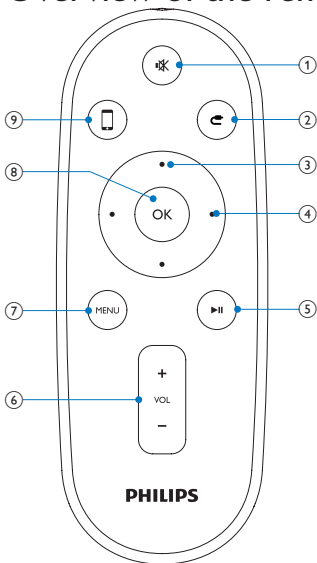

1

- Mute or restore volume.

2

- Select the MP3 link mode.

3 Up/down keys

- Navigate through the iPod/iPhone/iPad menu.

- 4 Fast forward/backward keys**
 - Fast reverse or fast forward within a track or iPhone/iPod.
 - Skip to the previous/next track.
- 5 ►||**
 - Start or pause play.
- 6 VOL +/-**
 - Adjust volume.
- 7 MENU**
 - Access the iPod menu.
- 8 OK**
 - Confirm a selection.
- 9 □**
 - Select the iPod/iPhone/iPad dock mode

3 Get started



Caution

- Use of controls or adjustments or performance of procedures other than herein may result in hazardous radiation exposure or other unsafe operation.

Always follow the instructions in this chapter in sequence.

If you contact Philips, you will be asked for the model and serial number of this apparatus. The model number and serial number are on the bottom of the apparatus. Write the numbers here:

Model No. _____

Serial No. _____

Prepare the remote control



Caution

- Risk of explosion! Keep batteries away from heat, sunshine or fire. Never discard batteries in fire.

For first-time use:

- 1 Remove the protective tab to activate the remote control battery.

To replace the remote control battery:

- 1 Open the battery compartment.
- 2 Insert one CR2032 battery with correct polarity (+/-) as indicated.

3 Close the battery compartment.

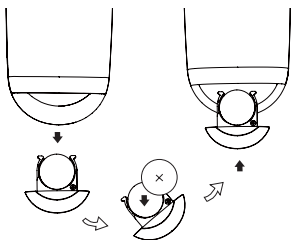

Note

- Before pressing any function button on the remote control, first select the correct source with the remote control instead of the main unit.
- If you are not going to use the remote control for a long time, remove the battery.

Connect power



Caution

- Risk of product damage! Ensure that the power supply voltage corresponds to the voltage printed on the bottom of the unit.
- Risk of electric shock! When you unplug the AC power cord, always pull the plug from the socket. Never pull the cord.
- Before connecting the AC power cord, ensure you have completed all other connections.

- 1 Connect the AC power cord to the wall outlet.

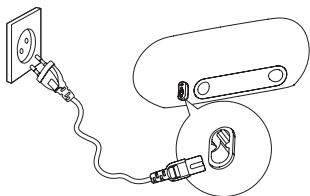

Turn on

- 1 The unit turns on automatically after power connection.
 - ➔ When the user approaches the unit, the LED light under the volume button on the main unit turns on automatically.

Switch to Eco Power Standby

The unit switches to the Eco Power Standby mode automatically when:

- the iPod/iPhone is disconnected from the unit for more than 15 minutes in the dock mode.
- the connected device stops music play for more than 15 minutes in the MP3 link mode.

4 Play

Play from iPod/iPhone/iPad

You can enjoy audio from iPod/iPhone/iPad through this unit.

Compatible iPod/iPhone/iPad

Apple iPod, iPhone and iPad models with a 30-pin dock connector:

Made for:

- iPod nano (2nd generation)
- iPod nano (3rd generation)
- iPod nano (4th generation)
- iPod classic
- iPod touch (1st generation)
- iPod touch (2nd generation)

Works with:

- iPhone
- iPhone 3G
- iPhone 3GS
- iPad

Load the iPod/iPhone/iPad

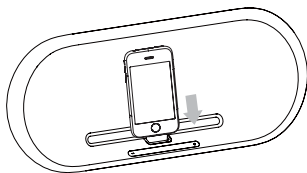

- 1 Place the iPod/iPhone/iPad in the dock.



To remove the iPod/iPhone/iPad

- 1 Pull the iPod/iPhone/iPad out of the dock.

Listen to the iPod/iPhone/iPad

- 1 Ensure that the iPod/iPhone/iPad has been loaded correctly.
- 2 Press  to select the dock mode.
- 3 Press .
 - ↳ The connected iPod/iPhone/iPad starts to play.
 - To pause/resume play, press .
 - To skip to a track, press the fast forward/backward keys.
 - To search during play, press and hold the fast forward/backward keys, then release to resume normal play.
 - To navigate through the menu, press **MENU**, then press the up/down key to select, and press **OK** to confirm.

Charge the iPod/iPhone/iPad

The docked iPod/iPhone/iPad begins to charge as soon as the unit is connected to AC power.

Play from an external device

You can also listen to an external audio device through this unit.

- 1 Press  to select the MP3 link mode.
- 2 Connect the supplied MP3 link cable to:
 - the **AUX IN** jack (3.5mm) on the back of the unit.
 - the headphone jack on an external device.
- 3 Start to play the device (see the device user manual).

Adjust volume level

- 1 During play, press **VOL +/-** to increase/decrease the volume level.

Mute sound

- 1 During play, press **MUTE** to mute/unmute sound.

5 Product information



Note

- Product information is subject to change without prior notice.

Specifications

Amplifier

| | |
|-----------------------|-------------------|
| Rated Output Power | 2X50 W RMS |
| Signal to Noise Ratio | 85 dB |
| MP3 Link | 0.6 V RMS 10 kohm |

General information

| | |
|-------------------------------|--------------------|
| AC power | 100~240V, 50/60Hz |
| Operation Power Consumption | <35W |
| Eco Standby Power Consumption | <1W |
| Dimensions | |
| - Main Unit (W x H x D) | 562 x 219 x 180 mm |
| Weight | |
| - Main Unit | 6.4 kg |

6 Troubleshooting



Warning

- Never remove the casing of this apparatus.

To keep the warranty valid, never try to repair the system yourself. If you encounter problems when using this apparatus, check the following points before requesting service. If the problem remains unsolved, go to the Philips web site (www.philips.com/welcome). When you contact Philips, ensure that the apparatus is nearby and the model number and serial number are available.

No power

- Ensure that the AC power plug of the unit is connected properly.
- Ensure that there is power at the AC outlet.

No sound

- Adjust the volume.

No response from the unit

- Disconnect and reconnect the AC power plug, then turn on the unit again.



© 2010 Koninklijke Philips Electronics N.V.

All rights reserved.

DS9000_12_UM_V1.0

