

~ EXPLANATION ~

- 1. Power On/Off**
To switch On or Off power (blue LED indicates that the power is on)
- 2. Rotary Master Volume Control**
To adjust the volume higher or lower
- 3. Bass Control**
To adjust bass level to desired volume.
- 4. Remote Control**
To connect wired remote control.
- 5. Speaker Out**
To connect the satellite speakers.

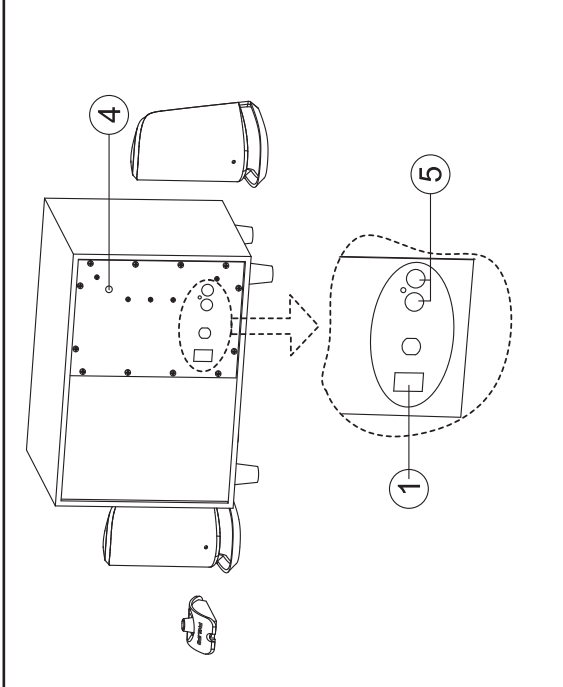
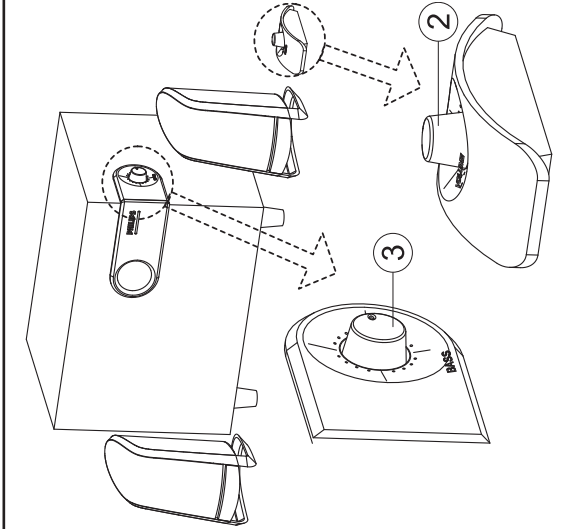

For US/Canada only IMPORTANT SAFETY INSTRUCTIONS - Read before operating equipment

- This product was designed and manufactured to meet strict quality and safety standards. There are, however, some installation and operation precautions which you should be particularly aware of:
- 1. Read these instructions** - All the safety and operating instructions should be read before the appliance is operated.
 - 2. Keep these instructions** - The safety and operating instructions should be retained for future reference.
 - 3. Heed all warnings** - All warnings on the appliance and in the operating instructions should be adhered to.
 - 4. Follow all instructions** - All operating and use instructions should be followed.
 - 5. Do not use this apparatus near water** - (for example, near a bathtub, washbowl, kitchen sink, laundry tub, in a wet basement or near a swimming pool, etc.)
 - 6. Clean only with a damp cloth.** The appliance should be cleaned only as recommended by the manufacturer.
 - 7. Install in accordance with the manufacturers instructions.** Do not block any of the ventilation openings. For example, the appliance should not be placed in a built-in installation, such as a bookcase or cabinet that may impede the flow of air through the ventilation openings.
 - 8. Do not install near any heat sources** such as radiators, heat registers, stoves, or other apparatus (including amplifiers) that produce heat.
 - 9. Do not defeat the safety purpose of** a polarized or grounding-type plug. A polarized plug has two blades with one wider than the other. Match wide blade with the wider outlet. **Grounding-type plug** has two blades and a third grounding prong. The wide blade or the third prong does not fit into your outlet. When the provided plug does not fit into your outlet, consult an electrician for replacement of the obsolete outlet.
 - 10. Protect the power cord** from being walked on or pinched particularly at plugs, convenience receptacles, and the point where they exit from the apparatus.
 - 11. Only use attachments/accessories** specified by the manufacturer.
 - 12. Use only with a cart, stand, tripod, bracket, or table** specified by the manufacturer, or sold with the apparatus. When a cart is used, use caution to avoid tipping or overturning. Do not use in combination to avoid injury from tip-over.
 - 13. Unplug this apparatus** during lightning storms or when unused for long periods of time.
 - 14. Refer all servicing** to qualified service personnel. Servicing is required when the apparatus has been damaged (for example when liquid has been spilled on cord or plug is damaged, liquid has been spilled on or objects have fallen into the apparatus, the apparatus has been exposed to rain or moisture, does not operate normally, or has been dropped).
 - 15. Warning!** To reduce the risk of fire or electric shock, do not expose this appliance to rain or moisture.

EL 4562-E004, 99/3

<http://www.philips.com>

The socket-outlet shall be installed near the equipment and shall be easily accessible.

Multimedia High Quality Speaker System SPA 2300



PHILIPS



PHILIPS

4399 294 SPA2300

