

PHILIPS

Headphones

6000 Series

TAH6206



User manual

Register your product and get support at
www.philips.com/support

Contents

1	Important safety instructions	2
	Hearing Safety	2
	General information	2

2	Your wireless headphones	3
	What's in the box	3
	Overview of your wireless headphones	4

3	Get started	5
	Charge the headphones	5
	Use with TV	5
	Adjust the volume	6
	Disconnect headphones from TV	6

4	Pair the headphones with your mobile phone	7
	Manage your calls and music	7
	Switch between TV (dongle) and mobile phone	8

5	Use with PC	9
---	-------------	---

6	Replace ear cushion	9
---	---------------------	---

7	Technical data	10
---	----------------	----

8	Notice	11
	Declaration of conformity	11
	Dispose of your old product and battery	11
	Remove the integrated battery	11
	Compliance with EMF	11
	Environmental information	12
	Notice of compliance	12

9	Trademarks	13
---	------------	----

10	Frequently asked questions	14
----	----------------------------	----

1 Important safety instructions

Hearing safety



Danger

- To avoid hearing damage, limit the time you use headphones at high volume and set the volume to a safe level. The louder the volume, the shorter the safe listening time is.

Be sure to observe the following guidelines when using your headphones.

- Listen at reasonable volumes for reasonable periods of time.
- Be careful not to adjust the volume continuously upwards as your hearing adapts.
- Do not turn up the volume so high that you cannot hear what's around you.
- You should use caution or temporarily discontinue use in potentially hazardous situations.
- Excessive sound pressure from earpieces and headphones can cause hearing loss.
- Using headphones with both ears covered while driving is not recommended and may be illegal in some areas.
- For your safety, avoid distractions from music or phone calls while in traffic or other potentially dangerous environments.

General information

To avoid damage or malfunction:

Caution

- Do not expose headphones to excessive heat.
- Do not drop your headphones.
- Headphones shall not be exposed to dripping or splashing. (Refer to the IP rating of specific product)
- Do not allow your headphones to be submerged in water.
- Do not charge your headphones when the connector or socket is wet.
- Do not use any cleaning agents containing alcohol, ammonia, benzene, or abrasives.
- If cleaning is required, use a soft cloth, if necessary dampened with a minimum amount of water or diluted mild soap, to clean the product.
- The integrated battery shall not be exposed to excessive heat such as sunshine, fire or the like.
- Danger of explosion if battery is incorrectly replaced. Replace only with the same or equivalent type.
- To achieve the specific IP rating, the charging slot cover must be closed.
- Disposal of a battery into fire or a hot oven, or mechanically crushing or cutting a battery, can result in an explosion.
- Leaving a battery in an extremely high temperature surrounding environment can result in an explosion or the leakage of flammable liquid or gas.
- A battery subjected to extremely low air pressure may result in an explosion or the leakage of flammable liquid or gas.

Operating and storage temperatures and humidity

- Store in a place where the temperature is between -20°C (-4°F) and 50°C (122°F) with up to 90% relative humidity.
- Operate in a place where the temperature is between 0°C (32°F) and 45°C (113°F) with up to 90% relative humidity.
- Battery life may be shorter in high or low temperature conditions.
- Replacement of a battery with an incorrect type risks severely damaging the headphones and the battery (for example, in the case of some lithium battery types).

2 Your wireless headphones

Congratulations on your purchase, and welcome to Philips! To fully benefit from the support that Philips offers, register your product at www.philips.com/support. With these Philips wireless headphones you can:

- Enjoy convenient wireless TV sound
- Enjoy and control music wirelessly



USB-C charging cable

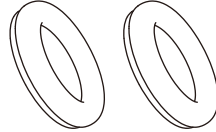

Cloth ear pads (one pair)

What's in the box

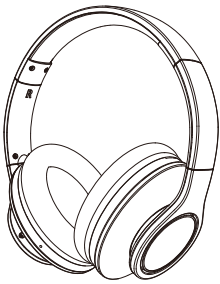

Headphones



USB dongle

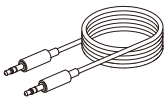

3.5 mm audio cable



Quick start guide



Global Warranty



Safety leaflet

Overview of your wireless headphones

Headphones

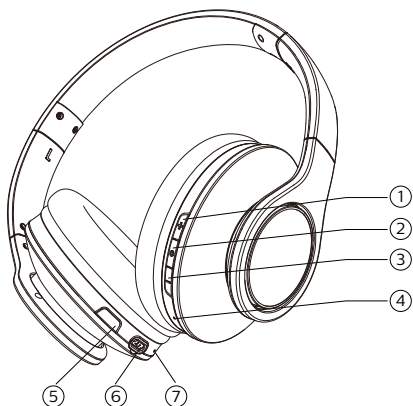

- ① Volume +
- ② Multi-function button (MFB)
- ③ Volume -
- ④ LED (Signal indicator, Blue/White)
- ⑤ Dongle/Mobile selection button (D/M button)
- ⑥ USB-C socket (for charging)
- ⑦ LED (Charging indicator, Amber/White)

USB Dongle

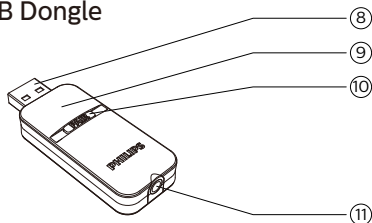

- ⑧ USB plug
- ⑨ LED (status indicator)
- ⑩ PAIR button
- ⑪ Aux jack

3 Get started

Charge the headphones

Note

- Charge the headphones with the supplied USB-C cable for two hours for optimum battery capacity and lifetime.
- Use only the original USB-C charging cable to avoid any damage.
- It is highly recommended to power off the headphones before battery charging.

Plug one end of the USB-C cable into the headphones and the other end into a powered USB port. The LED turns amber during charging and turns white when the headphones are fully charged.

Tip

- Normally, a full charge takes 2 hours.

Use on TV

- 1 Connect the dongle to the TV as below:

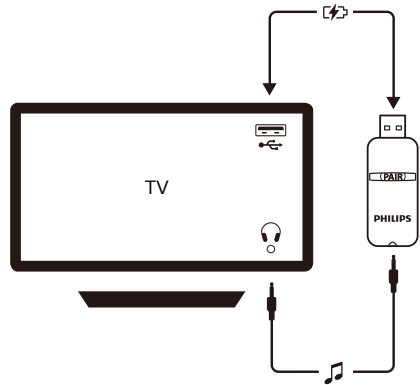

- 2 Power on the headphones.

Note

- If your TV does not have a USB socket, plug the dongle into a USB charger and connect to your TV's headphones jack using the audio cable provided.

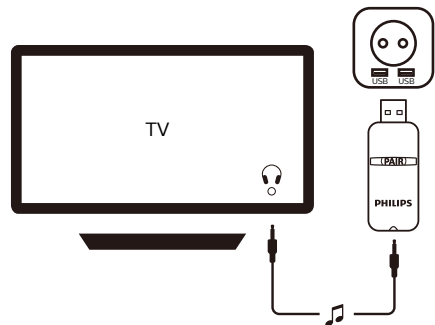

Note

- If your TV does not have a USB socket or a headphones jack, connect the dongle to a USB adapter (not included) and connect to the RCA output on your TV.

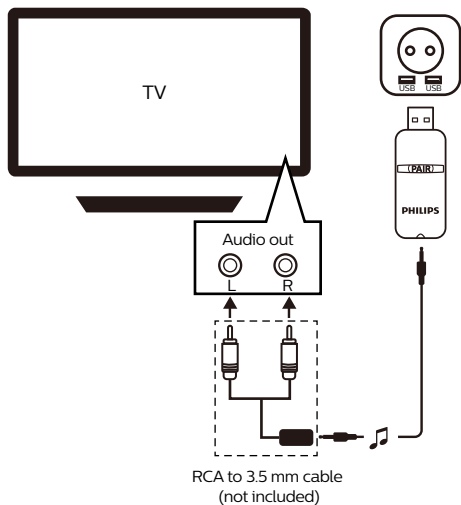

Disconnect headphones from TV

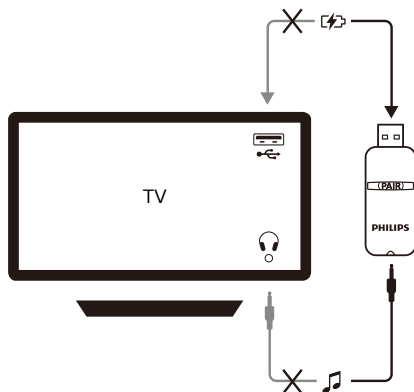

- Disconnect the dongle and aux cable from your TV.
- Turn off the headphones and charge using the USB cable.

Adjust the volume of the headphones

- On the headphones:
 - Use the volume + / - buttons
- On the TV
 - Some TVs will automatically mute the TV speaker and output the sound through the headphones. In this case, you can use the TV remote control to control the volume of your headphones.
 - Some TVs separate the TV speaker volume and headphones volume control. In this case, mute the TV speaker when using the headphones. Use the headphones volume buttons to adjust the volume.

4 Pair the headphones with your mobile phone

Before using your headphones with your mobile phone, you must pair them. A successful pairing establishes a unique encrypted link between the headphones and the mobile phone.

- 1 Make sure that the mobile phone is turned on and its Bluetooth feature is activated.
- 2 Make sure that the headphones are charged and turned off.
- 3 Press and hold "MFB" Button for 4 seconds until the LED starts flashing white and blue alternately. The headphones are in pairing mode. This will last for five minutes.
- 4 The Bluetooth list on the mobile phone will show "TAH6206". Simply select "TAH6206" to pair the headphones.



TAH6206

Manage your calls and music

On/off

Task	Button	Operation
Turn the headphones on	MFB	Press and hold for 2 seconds
Turn the headphones off	MFB	Press and hold for 4 seconds ↳ The blue LED is on and fades out
BT pairing mode	MFB	Power on and keep pressed down for 4 seconds

Music control

Task	Button	Operation
Play or pause music	MFB	Press once
Volume up	+	Press once
Volume down	-	Press once
Next track	+	Press and hold for 2 seconds
Previous track	-	Press and hold for 2 seconds

Call control

Task	Button	Operation
Pick up/ hang up a call	MFB	Press once
Reject call	MFB	Press and hold for 2 seconds
Recall	MFB	Press twice

Smartphone voice assistant (e.g. Google App, Siri)

Task	Button	Operation
Wake up smartphone voice assistant	MFB	Press and hold for 1 second

 Note

- Please refer to the operating instructions of the smartphone.

Switch between TV (dongle) and mobile phone

- Make sure your headphones are paired with your mobile phone and connect the dongle.
- Press the "D/M" button on the headphones to select between connection to the dongle or to your mobile phone.

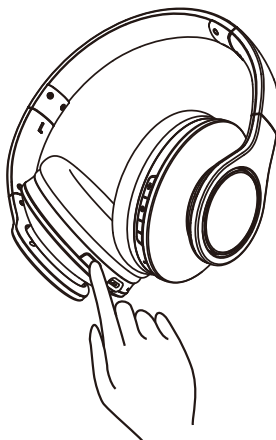

5 Use with PC

Plug the dongle into a USB port on your PC and use your headphones as usual.

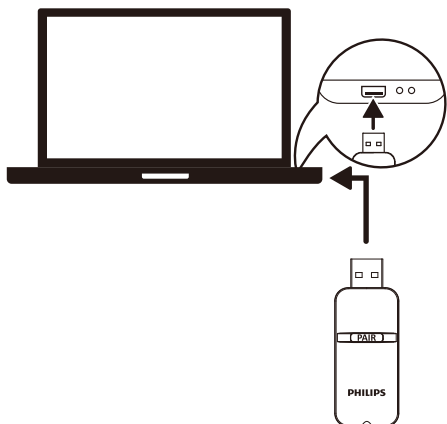

6 Replace ear cushion

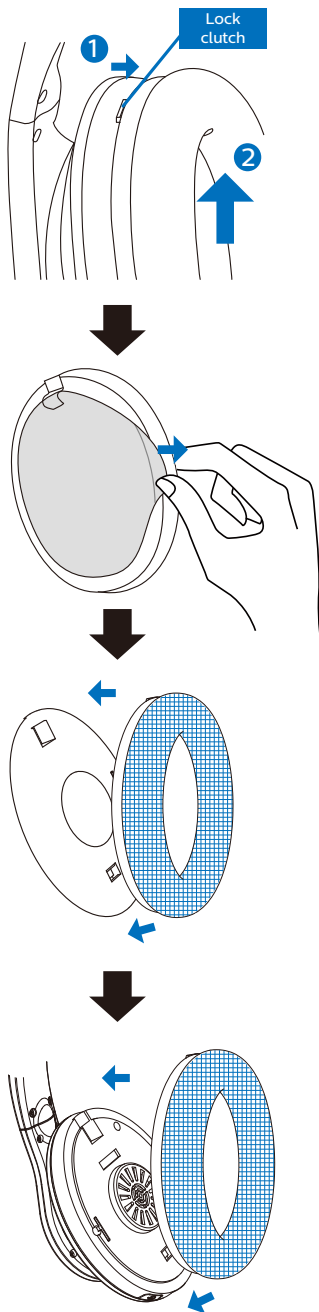

7 Technical data

USB dongle

- Frequency range: 2.402–2.480 GHz
- Transmitter power: < 10 dBm
- Operating range (paired with TAH6206 headphones):
Up to 20 meters (66 feet)

Headphones

- Play time: 18 hours
- Talk time: 20 hours
- Standby time: 150 hours
- Fast charging time: 15 minutes gives 1 hour of play time
- Charging time: 2 hours
- Rechargeable lithium polymer battery (750 mAh)
- Bluetooth version: 5.1
- Compatible Bluetooth profiles:
 - HFP (Hands-Free Profile)
 - A2DP (Advanced Audio Distribution Profile)
 - AVRCP (Audio Video Remote Control Profile)
- Supported audio codec: SBC
- Frequency range: 2.402–2.480 GHz
- Transmitter power: < 10 dBm
- Operating range (paired with mobile phone):
Up to 10 meters (33 feet)
- Auto power off
- USB-C port for charging
- Supports SBC



Tip

For further product support, please visit
www.philips.com/support.

8 Notice

Declaration of conformity

Hereby, MMD Hong Kong Holding Limited declares that this product is in compliance with the essential requirements and other relevant provisions of Directive 2014/53/EU. You can find the Declaration of Conformity on www.p4c.philips.com.

Dispose of your old product and battery



Your product is designed and manufactured with high quality materials and components which can be recycled and reused.



This symbol on a product means that the product is covered by European Directive 2012/19/EU.



This symbol means that the product contains a built-in rechargeable battery covered by European Directive 2013/56/EU which cannot be disposed of with normal household waste. We strongly advise you to take your product to an official collection point or a Philips service centre to have a professional remove the rechargeable battery. Inform yourself about the local separate collection system for electrical and electronic products and rechargeable batteries. Follow local rules and never dispose of the product and rechargeable batteries with normal household waste.

Correct disposal of old products and rechargeable batteries helps prevent negative consequences for the environment and human health.

Remove the integrated battery

If there is no collection/recycling system for electronic products in your country, you can protect the environment by removing and recycling the battery before disposing of the headphones.

- Make sure the headphones are not charging before removing the battery.

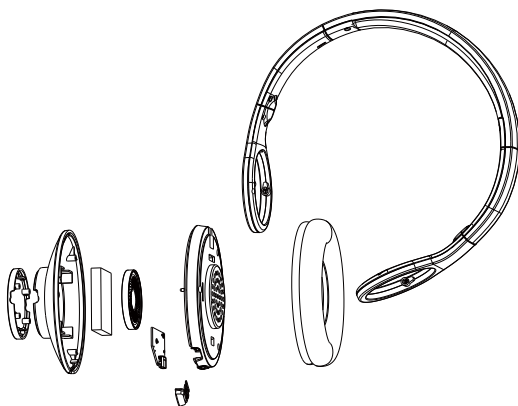

Compliance with EMF

This product complies with all applicable standards and regulations regarding exposure to electromagnetic fields.

Environmental information

All unnecessary packaging has been omitted. We have tried to make the packaging easy to separate into three materials: cardboard (box), polystyrene foam (buffer) and polyethylene (bags, protective foam sheet).

Your system consists of materials which can be recycled and reused if disassembled by a specialized company. Please observe the local regulations regarding the disposal of packaging materials, exhausted batteries and old equipment.

Notice of compliance

The device complies with the FCC rules, Part 15. Operation is subject to the following two conditions:

1. **This device may not cause harmful interference, and**
2. **This device must accept any interference received, including interference that may cause undesired operation.**

FCC rules

This equipment has been tested and found to comply with the limits for a Class B digital device, pursuant to part 15 of the FCC Rules. These limits are designed to provide reasonable protection against harmful interference in a residential installation. This equipment generates, uses and can radiate radio frequency energy and, if not installed and used in accordance with the instruction manual, may cause harmful interference to radio communications. However, there is no guarantee that interference will not occur in a particular installation. If this equipment does cause harmful interference to radio or

television reception, which can be determined by turning the equipment off and on, the user is encouraged to try to correct the interference by one or more of the following measures:

- Reorient or relocate the receiving antenna.
- Increase the separation between equipment and receiver.
- Plug the equipment into an outlet on a circuit different from that to which the receiver is connected.
- Consult the dealer or an experienced radio/TV technician for help.

FCC Radiation Exposure Statement:

This equipment complies with FCC radiation exposure limits set forth for an uncontrolled environment.

This transmitter must not be co-located or operated in conjunction with any other antenna or transmitter.

Caution: The user is cautioned that changes or modifications not expressly approved by the party responsible for compliance could void the user's authority to operate the equipment.

Canada:

This device contains license-exempt transmitter(s)/receiver(s) that comply with Innovation, Science and Economic Development Canada's license-exempt RSS(s). Operation is subject to the following two conditions: (1) this device may not cause harmful interference, and (2) this device must accept any interference received, including interference that may cause undesired operation of the device.

CAN ICES-3(B)/NMB-3(B)

IC Radiation Exposure Statement:

This equipment complies with Canada radiation exposure limits set forth for uncontrolled environments.

This transmitter must not be co-located or operated in conjunction with any other antenna or transmitter.

9 Trademarks

Bluetooth

The Bluetooth® word mark and logos are registered trademarks owned by Bluetooth SIG, Inc. and any use of such marks by Top Victory Investment Limited is under license. Other trademarks and trade names are those of their respective owners.

Siri

Siri is a trademark of Apple Inc., registered in the U.S. and other countries.

Google

Google and Google Play are trademarks of Google LLC.

10 Frequently asked questions

My Bluetooth headphones do not turn on.

The battery level is low. Charge the headphones.

I cannot pair my Bluetooth headphones with my Bluetooth device.

Bluetooth is disabled. Turn on your device and enable the Bluetooth function before you turn on your headphones.

How to reset the headphones.

If the headphones will not turn on or will not respond while operating, push the "MFB" and "Volume +" buttons simultaneously for 1 second.

I can hear but cannot control music on my Bluetooth device (e.g. play/pause/skip forward/backward).

Make sure the Bluetooth audio source supports AVRCP (see 'Technical data' on page 10).

The volume level of the headphones is too low.

Some Bluetooth devices are unable to automatically sync the volume level with your headphones. In this case, adjust the volume on your Bluetooth device separately to achieve an appropriate volume level.

The Bluetooth device cannot find the headphones.

- The headphones may be connected to a previously paired device. Turn off the connected device or move it out of range.
- Pairing may have been reset or the headphones have been previously paired with another device. Pair the headphones with the Bluetooth device again as described in the user manual. (See 'Pair the headphones with your mobile phone' on page 7.)

My Bluetooth headphones are connected to a Bluetooth stereo-enabled mobile phone, but music only plays on the mobile phone speaker. Refer to the user manual of your mobile phone. Select to listen to music through the headphones.

The audio quality is poor and a crackling noise can be heard.

- The Bluetooth device is out of range. Reduce the distance between your headphones and Bluetooth device, or remove obstacles between them.
- Charge your headphones.

The audio quality is poor when streaming from a mobile phone, is very slow or streaming does not work at all.

Make sure your mobile phone not only supports (mono) HFP but also supports A2DP and is BT4.0x (or higher) compatible (see 'Technical data' on page 10).

The dongle does not connect to the headphones.

The wireless connection between the dongle and the headphone may lose connectivity. To repair this follow the steps below:

1. Plug the dongle into a USB charger to power it on.
2. Press the PAIR button for two seconds and you will see the dongle's LED blinking.
3. Power off the headphones and then press the MFB button for four seconds. You will see the headphones' LED blinking blue and white.
4. Press the PAIR button on the dongle once. When successfully paired, the headphones' LED will slowly blink blue.

For further support, visit www.philips.com/support.



2021 © MMD Hong Kong Holding Limited. All rights reserved. Specifications are subject to change without notice. Philips and the Philips Shield Emblem are registered trademarks of Koninklijke Philips N.V. and are used under license. This product has been manufactured by and is sold under the responsibility of MMD Hong Kong Holding Limited or one of its affiliates, and MMD Hong Kong Holding Limited is the warrantor in relation to this product. All other company and product names may be trademarks of its respective companies with which they are associated.

