

Quick Start Guide



Step A **Connect**

Step B **Setup**

Step C **Enjoy**

What's in the Box?

You should find these items upon opening the box.

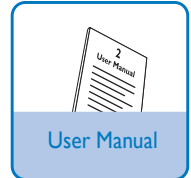
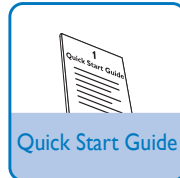
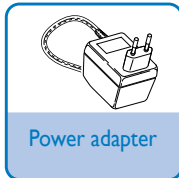
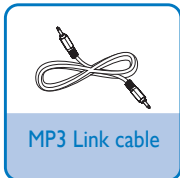

Step A *Connect*

1 Connect the speaker cables.

2 Connect the AC power adapter to the wall socket.

Tip
See the User Manual for how to connect other equipment to this system.

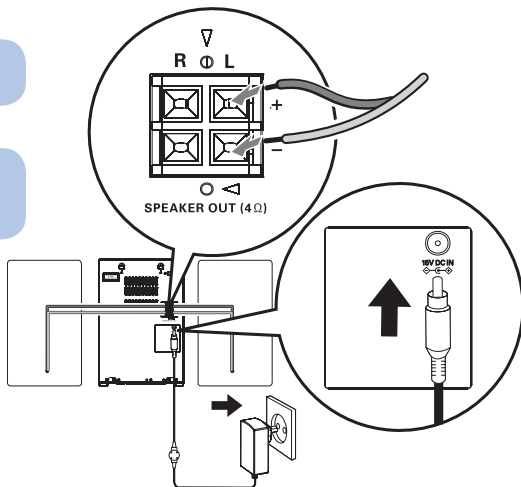

Step B *Setup*

Set clock

Important!

– In Eco Power Standby mode, press **CLOCK** to show clock first, then press and hold **CLOCK** to proceed clock setting.

1 In standby mode, press and hold **CLOCK** on the main unit.

2 Press **■** on the main unit to select 12 hour or 24 hour format.

3 Turn **-VOLUME +** to set the hour.

4 Press **CLOCK** to confirm.
→ The minute digits are displayed and begin to blink.

5 Turn **-VOLUME +** to set the minute.

6 Press **CLOCK** to confirm.

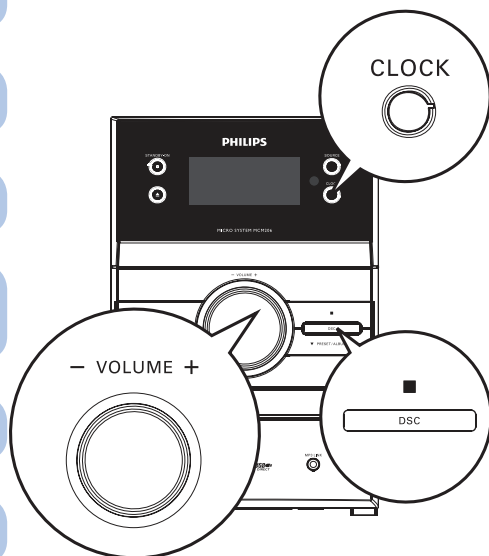

Play disc

- 1 Press **SOURCE** to select the disc source.
- 2 Press **▲** to open the disc tray.
- 3 Insert a disc with the printed side facing up, then close the disc tray.
- 4 To pause/resume play, press **▶||**.
- 5 To stop play, press **■**.

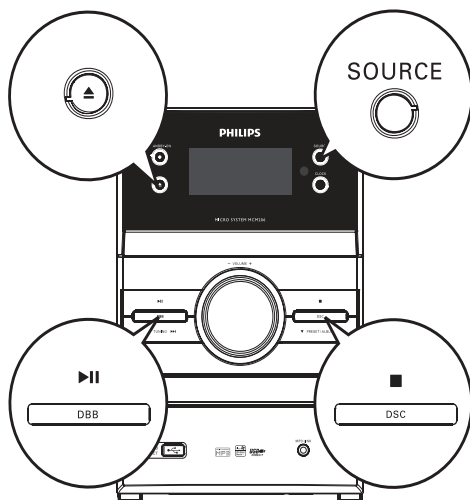

Play from USB

With the micro system, you can use USB flash memory (USB 2.0 or USB1.1), USB flash players (USB 2.0 or USB1.1), memory cards (requires an additional card reader to work with this micro system).

- 1 Insert the USB device's USB plug into the socket  on the main unit.
- 2 Press **USB** repeatedly to select the USB device source.
- 3 Play the USB's audio files as you do with the albums/tracks on a CD.

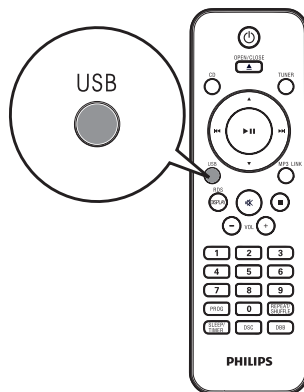

Program and tune to radio stations

1 Press **TUNER** repeatedly to select FM or MW.

2 Press **PROG** for more than two seconds to program all available stations in order of waveband.

3 Press **▲▼** to select a preset number.

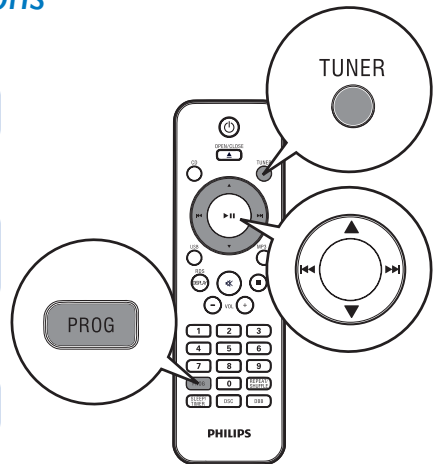

Tip

Detailed playback features and additional functions are described in the accompany owner's manual.

