

# Always there to help you

Register your product and get support at  
[www.philips.com/welcome](http://www.philips.com/welcome)



AEM120BLU



## User Manual

# PHILIPS

# Contents

---

<b>1</b>	<b>Important</b>	<b>3</b>
----------	------------------	----------

---

<b>2</b>	<b>Your Portable Speaker</b>	<b>4</b>
	Introduction	4
	What's in the box	4
	Overview of the speaker	5

---

<b>3</b>	<b>Get started</b>	<b>6</b>
	Power supply	6
	Turn on/off	6
	Select a source	6

---

<b>4</b>	<b>Play</b>	<b>7</b>
	Play from Micro SD card	7
	Play from USB device	7
	Control play	7
	Play from an external device	8
	Listen to FM radio	8
	Listen through the headphone	9
	Adjust volume	9

---

<b>5</b>	<b>Product information</b>	<b>9</b>
	General information	9
	Tuner (FM)	9
	Amplifier	9
	Supported MP3 disc formats	9
	USB playability information	10

---

<b>6</b>	<b>Troubleshooting</b>	<b>10</b>
----------	------------------------	-----------

---

<b>7</b>	<b>Notice</b>	<b>11</b>
	Compliance	11
	Care of the environment	11
	Copyright	11

# 1 Important

- Read these instructions.
- Follow all instructions.
- Do not use this apparatus near water.
- Do not block any ventilation openings. Install in accordance with the manufacturer's instructions.
- Do not install near any heat sources such as radiators, heat registers, stoves, or other apparatus (including amplifiers) that produce heat.
- Only use attachments/accessories specified by the manufacturer.
- Refer all servicing to qualified service personnel. Servicing is required when the apparatus has been damaged in any way, such as liquid has been spilled or objects have fallen into the apparatus, the apparatus has been exposed to rain or moisture, does not operate normally, or has been dropped.
- The battery shall not be exposed to excessive heat such as sunshine, fire or the like.
- Apparatus shall not be exposed to dripping or splashing.
- Do not place any sources of danger on the apparatus (e.g. liquid filled objects, lighted candles).
- Due to different materials and product techniques, it cannot be guaranteed that all Micro SD cards work with this speaker.
- The  socket is for playing music from a USB storage device, not for battery charging.

## Hearing safety



### Caution

- To prevent possible hearing damage, do not listen at high volume levels for long periods. Set the volume to a safe level. The louder the volume, the shorter is the safe listening time.

### Be sure to observe the following guidelines when using your headphones.

- Listen at reasonable volumes for reasonable periods of time.
- Be careful not to adjust the volume continuously upwards as your hearing adapts.
- Do not turn up the volume so high that you can't hear what's around you.
- You should use caution or temporarily discontinue use in potentially hazardous situations.
- Excessive sound pressure from earphones and headphones can cause hearing loss.



### Caution

- Removal of the built-in battery invalidates the warranty and may destroy the product.

Always bring your product to a professional to remove the built-in battery.

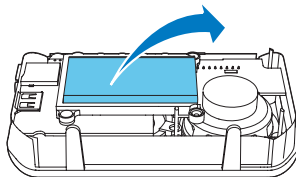

### Note

- The type plate is located on the bottom of the apparatus.

## 2 Your Portable Speaker

Congratulations on your purchase, and welcome to Philips! To fully benefit from the support that Philips offers, register your product at [www.philips.com/welcome](http://www.philips.com/welcome).

---

### Introduction

With this speaker, you can:

- listen to FM radio;
- enjoy audio from Micro SD card, USB devices, and other external devices.

---

### What's in the box

Check and identify the contents of your package:

- Main unit
- USB cable X 1
- Aux-in cable X 1
- Quick start guide

## Overview of the speaker

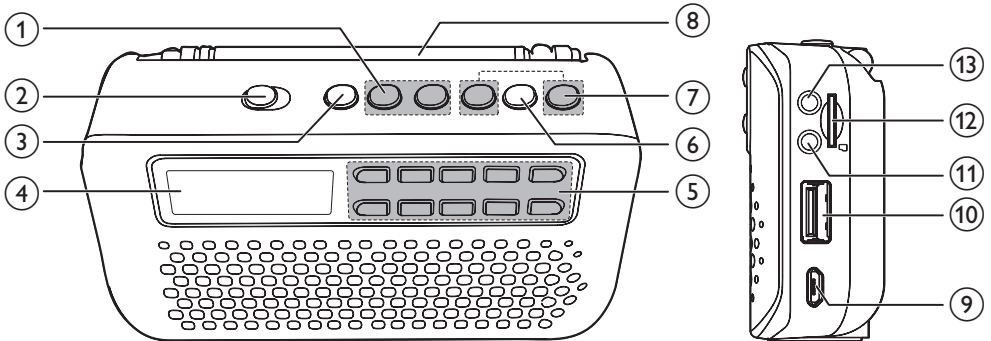

- ① **-/+**
  - Adjust volume.
- ② **ON/OFF**
  - Turn the speaker on or off.
- ③ **S**
  - Select a source.
- ④ **Display panel**
- ⑤ **0 - 9**
  - Numeric buttons: select a track or preset radio station.
- ⑥ **▶||**
  - Start or pause play.
  - Store FM radio stations.
  - Enable folder selection.
- ⑦ **|◀◀ / ▶▶|**
  - Select a track or folder.
  - Search within play.
  - Tune to FM radio stations.
- ⑧ **FM antenna**
- ⑨ **DC 5V**
  - Recharge the built-in battery.
- ⑩ **↔**
  - Connect a USB storage device.
- ⑪ **AUX**
  - Connect an external device.
- ⑫ **MICRO SD**
  - Micro SD card slot.
- ⑬ **🎧**
  - Headphone socket.

## 3 Get started

Always follow the instructions in this chapter in sequence.

If you contact the Consumer Care, you will be asked for the model and serial number of this apparatus. The model number and serial number are on the bottom of the apparatus. Write the numbers here:

Model No. \_\_\_\_\_

Serial No. \_\_\_\_\_

---

### Power supply



#### Caution

- Danger of explosion if battery is incorrectly replaced. Replace only with the same or equivalent type.
- Risk of damage to the speaker. Charge through the USB socket of a computer only.

The speaker is powered by the built-in rechargeable battery.

#### To recharge the built-in battery:

Connect the supplied USB cable to:

- the **DC 5V** socket on the speaker.
- the USB socket on a computer.

↳ The charging icon is displayed.

↳ When the battery is fully charged, the charging icon disappears.

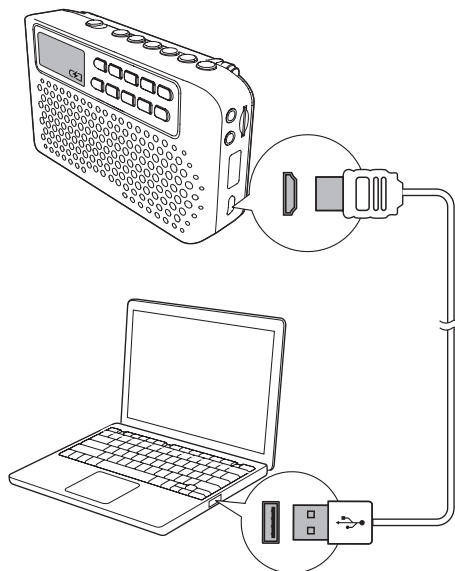

---

### Turn on/off

- 1 Slide **ON/OFF** switch to right.  
↳ The speaker switches to the last selected source.
- 2 To turn the speaker off, slide **ON/OFF** switch to left.

---

### Select a source

Press **S** repeatedly to select an audio source: FM tuner, Aux, USB device, or Micro SD card.

# 4 Play

## Play from Micro SD card

### Note

- Make sure that the Micro SD card contains playable audio content.

- 1 Press **S** repeatedly to select the Micro SD card source.  
↳ **[SD]** is displayed.
- 2 Insert a Micro SD card into the card slot.  
↳ Play starts automatically.

### Note

- Due to different materials and product techniques, it cannot be guaranteed that all Micro SD cards will work with this speaker.

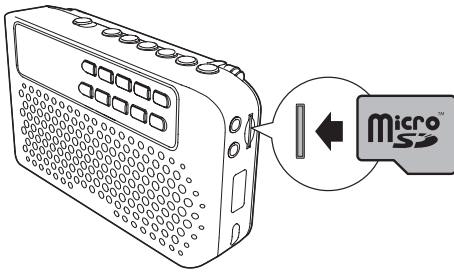

## Play from USB device

### Note

- Make sure that the USB storage device contains playable audio content.

Insert the USB device into the  socket.  
↳ **[USB]** is displayed.  
↳ Play starts automatically.

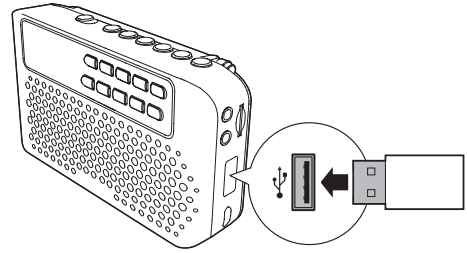

## Control play

In USB or Micro SD mode, you can control play through the following operations.

<b>⏮ / ⏭</b>	Select an audio file; Press and hold to fast-forward or fast-reverse the track during playback, then release to resume play.
<b>▶   </b>	Start or pause play.
<b>Numeric buttons</b>	Press 0-9 to select the first 9 tracks directly. To select 2-digit or 3-digit track number; press the corresponding numeric buttons (e.g., press 4 and 5 to select Track 45; press 1, 3, and 2 to select Track 132).

If the USB device or Micro SD card contains several folders, you can select a folder to play music.

- 1 Press and hold **▶ ||** for 2 seconds.  
↳ The current folder **[F X]** (X stands for the folder number) is displayed.
- 2 Press **⏮ / ⏭** repeatedly to select a folder.  
↳ The first track in the folder is played automatically.

### Note

- All the root directories and sub-folders can be selected to play music.

## Play from an external device

With this speaker, you can also enjoy audio from an external device such as an MP3 player.

- 1 Press **S** repeatedly to select Aux-in source.
- 2 Connect the supplied Aux-in cable to:
  - the **AUX** socket on the speaker.
  - the headphone socket on an external device.
- 3 Play audio on the device (see the device's user manual).

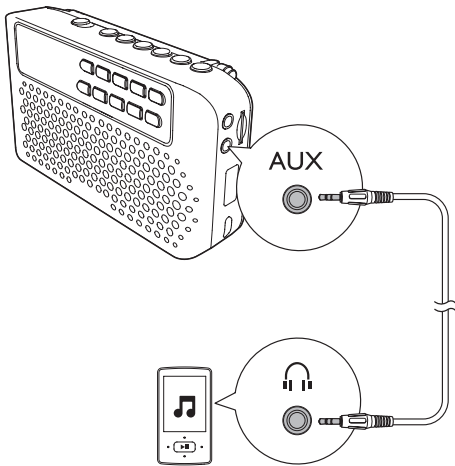

## Listen to FM radio

### Tune to FM radio stations

#### Note

- Keep the portable speaker away from other electronic devices to avoid radio interference.
- For better reception, fully extend and adjust the position of the FM antenna.

- 1 Press **S** repeatedly to select FM tuner source.

- 2 Press and hold **◀◀** / **▶▶** for two seconds.
  - ↳ The speaker tunes to a station with strong reception automatically.
- 3 Repeat step 2 to tune to more radio stations.

#### To tune to a station manually:

Press **◀◀** / **▶▶** repeatedly until you find better reception.

### Store FM radio stations automatically

In FM tuner mode, press and hold **▶▶** for two seconds.

- ↳ The speaker stores all the FM radio stations automatically and then broadcasts the first preset radio station.

### Store FM radio stations manually

You can store up to 30 FM radio stations.

- 1 Tune to an FM radio station.
- 2 Press **▶▶** to activate storing.
- 3 Select a preset number:
  - To store the station in the first 9 positions, press the numeric buttons **1-9** directly;
  - To store the station in other positions, press the two corresponding numeric buttons (e.g., press **1** and **5** to store the station in the 15th channel);
  - You may also press **◀◀** or **▶▶** to select a number.
- 4 Press **▶▶** to confirm.
  - ↳ The station is stored in the selected channel.
- 5 Repeat steps 1 - 4 to store more FM stations.



#### Tip

- To overwrite a preset station, store another station in its place.



## Select a preset FM radio station

In FM tuner mode:

- To select the preset station 1 - 9, press the numeric button **1- 9** directly;
- To select the preset station 10 - 30, press the two corresponding numeric buttons (e.g., **1** and **5** for the Preset Station 15).

## Listen through the headphone

Plug a headphone into the  socket on the speaker.



Tip

- When some headphone with Mic is plugged, you may hear audio from both the speaker and the headphone. If so, try another headphone.

## Adjust volume

During play, press **-/+** to adjust volume.

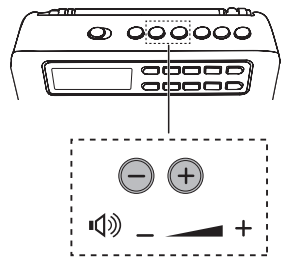

# 5 Product information



Note

- Product information is subject to change without prior notice.

## General information

Power Supply	5V $\equiv$ 0.6A
Built-in Battery	Lithium battery
Dimensions - Main Unit (W x H x D)	118 x 67 x 31 mm
Weight - Main Unit	0.15 kg

## Tuner (FM)

Tuning Range	87.5-108 MHz
--------------	--------------

## Amplifier

Max Output Power	1.5 W
Signal to Noise Ratio	50 dBA
Aux Input	600mV RMS, 22 kohm

## Supported MP3 disc formats

- ISO9660, Joliet
- Maximum title number: 512 (depending on file name length)
- Maximum album number: 255
- Supported sampling frequencies: 32 kHz, 44.1kHz, 48 kHz
- Supported Bit-rates: 32~256 (kbps), variable bit rates

## USB playability information

### Compatible USB devices:

- USB flash memory (USB1.1)
- USB flash players (USB1.1)
- memory cards (An additional card reader is required to work with this unit. Some multi-card USB reader may not be supported.)

### Supported formats:

- USB or memory file format: FAT12, FAT16, FAT32 (sector size: 512 bytes)
- MP3 bit rate (data rate): 32-320 Kbps and variable bit rate
- WMA v9 or earlier
- Directory nesting up to a maximum of 8 levels
- Number of albums/ folders: maximum 99
- Number of tracks/titles: maximum 999
- ID3 tag v2.0 or later
- File name in Unicode UTF8 (maximum length: 16 bytes)

### Unsupported formats:

- Empty albums: an empty album is an album that does not contain MP3/WMA files, and will not be shown in the display.
- Unsupported file formats are skipped. For example, Word documents (.doc) or MP3 files with extension .dlf are ignored and not played.
- AAC, WAV, PCM audio files
- DRM protected WMA files (.wav, .m4a, .m4p, .mp4, .aac)
- WMA files in Lossless format

## 6 Troubleshooting



### Warning

- Never remove the casing of this device.

To keep the warranty valid, never try to repair the system yourself.

If you encounter problems when using this device, check the following points before requesting service. If the problem remains unsolved, go to the Philips Web page ([www.philips.com/support](http://www.philips.com/support)). When you contact the Consumer Care, make sure that the product is nearby and the model number and serial number are available.

### No power

- Recharge the battery.

### No sound

- Adjust volume.
- Check if you have selected the correct audio source.
- Disconnect the headphones.

### No response from the speaker

- Turn on the speaker.
- Recharge the battery.

### Poor radio reception

- Increase the distance between the unit and your TV or VCR.
- Fully extend the FM antenna.

### USB device not supported

- The USB device is incompatible with the unit. Try another one.

# 7 Notice

Any changes or modifications made to this device that are not expressly approved by WOOX Innovations may void the user's authority to operate the equipment.

---

## Compliance



This product complies with the radio interference requirements of the European Community.

---

## Care of the environment



Your product is designed and manufactured with high quality materials and components, which can be recycled and reused.



When this crossed-out wheeled bin symbol is attached to a product it means that the product is covered by the European Directive 2002/96/EC.

Please inform yourself about the local separate collection system for electrical and electronic products.

Please act according to your local rules and do not dispose of your old products with your normal household waste. Correct disposal of your old product helps to prevent potential negative consequences for the environment and human health.



Your product contains batteries covered by the European Directive 2006/66/EC, which cannot be disposed with normal household waste. Please inform yourself about the local rules on separate collection of batteries because correct disposal helps to prevent negative consequences for the environmental and human health.

### Environmental information

All unnecessary packaging has been omitted. We have tried to make the packaging easy to separate into three materials: cardboard (box), polystyrene foam (buffer) and polyethylene (bags, protective foam sheet.)

Your system consists of materials which can be recycled and reused if disassembled by a specialized company. Please observe the local regulations regarding the disposal of packaging materials, exhausted batteries and old equipment.

---

## Copyright

2014 © WOOX Innovations Limited. All rights reserved.

Philips and the Philips' Shield Emblem are registered trademarks of Koninklijke Philips N.V. and are used by WOOX Innovations Limited under license from Koninklijke Philips N.V."

Specifications are subject to change without notice. WOOX reserves the right to change products at any time without being obliged to adjust earlier supplies accordingly.



2014 © WOOX Innovations Limited. All rights reserved.

This product was brought to the market by WOOX Innovations Limited or one of its affiliates, further referred to in this document as WOOX Innovations, and is the manufacturer of the product. WOOX Innovations is the warrantor in relation to the product with which this booklet was packaged. Philips and the Philips Shield Emblem are registered trademarks of Koninklijke Philips N.V.

AEM120BLU\_00\_UM\_V2.0

