

# Always there to help you

Register your product and get support at  
[www.philips.com/support](http://www.philips.com/support)



SRP6013



## User manual

**PHILIPS**



# Contents

---

<b>1</b>	<b>Your universal remote</b>	<b>2</b>
	Introduction	2
	Overview of the universal remote	2
	Supported devices	3

---

<b>2</b>	<b>Get started</b>	<b>4</b>
	Insert batteries (not included)	4
	Set up the universal remote	4

---

<b>3</b>	<b>Notice</b>	<b>7</b>
	Disposal of your old product and battery	7

---

<b>4</b>	<b>Service and support</b>	<b>8</b>
	Frequently asked questions	8
	Need help?	8

# 1 Your universal remote

Congratulations on your purchase, and welcome to Philips! To fully benefit from the support that Philips offers, register your product at [www.philips.com/welcome](http://www.philips.com/welcome)







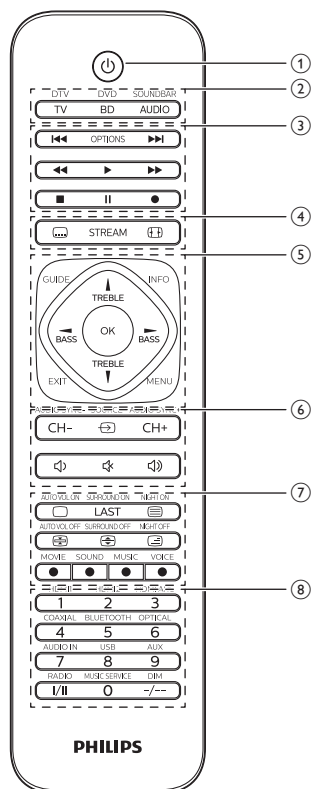

## Introduction

With the universal remote, you can operate up to 3 different devices.

## Overview of the universal remote

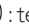

- ① : power on or off.
- ② Device selection buttons
- ③ : next track  
**OPTIONS**: access the options menu.  
 : previous track  
 : rewind  
 : play  
 : fast forward  
 : stop  
 : pause  
 : record
- ④ : subtitle  
**STREAM**: shortcut to Netflix.

-  : screen format
- ⑤ **INFO**: displays on-screen channel information.  
**GUIDE**: displays the program guide.  
**OK**: confirm your selection.  
**EXIT**: exit from the menu.  
**MENU**: menu on or off.  
▲ / ▼ / ◀ / ▶ : up/down/left/right.
- ⑥ **CH+/CH-**: go to the next/previous channel.  
 : select available source inputs (antenna, cable, etc.).  
 : volume down  
 : mute  
 : volume up
- ⑦  /  /  /  /  : teletext off/teletext on/teletext hold/teletext expand/teletext mix  
**LAST**: return to the previous tuned channel.  
Red/Green/Yellow/Blue: context sensitivity buttons.
- ⑧ Digit buttons  
**I/II**: select the audio channel.  
**-/--**: select between one and two-figure channel numbers.

## Supported devices

Device name	Description
<b>TV</b>	TV, DTV
<b>BD</b>	DVD player/recorder; Blu-ray player
<b>AUDIO</b>	Sound bar; home theater; audio system



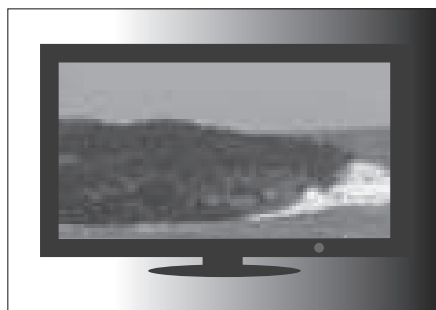
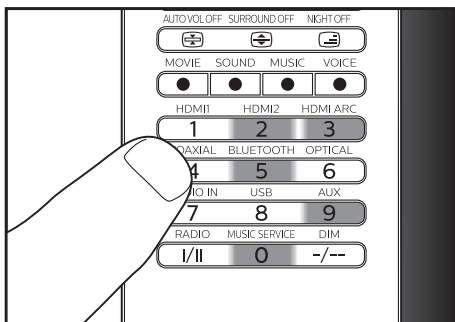

- 5 If the light is off, a valid code is saved. Otherwise, the light will flash once, and then remains on for code re-entry.

- 2 Press and hold the device selection button (e.g. TV) for 5 seconds until the red LED is on.

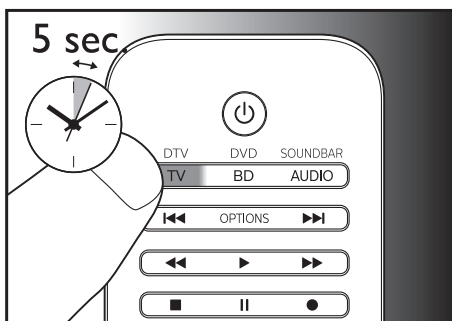
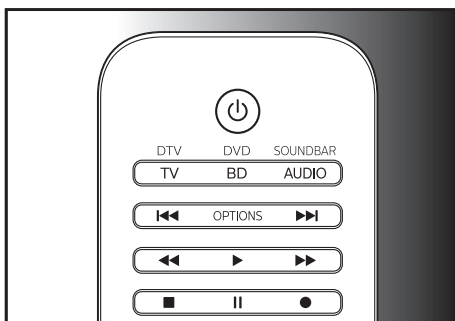

- 6 Operate the device with the universal remote. If your device responds correctly, it means you have entered the right code. Otherwise, repeat from step 2, and enter the second code on the list.

- 3 Point at your device with the universal remote. Then press and release **⏻** to start searching the code for your brand. A different infrared signal is sent every 2 seconds as the universal remote searches, indicated by a red flash.

#### Note

- It is possible sometimes that your device only responds to some of the buttons. In such case, set up with the next code in the code list, and try operating your device again.
- Each device button can be used to set up any device. Eg. you may setup a TV using the **BD** device button.

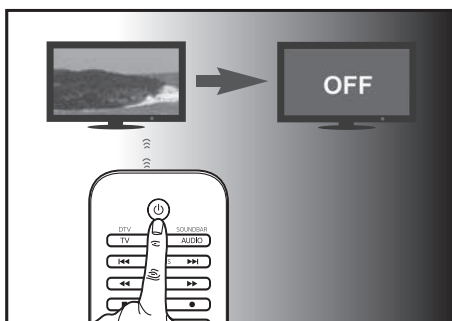

## Auto registration

- 1 Switch on your device.

- 4 When the device is off, **immediately** press and release **OK** to save the code. The red LED indicator will turn off.

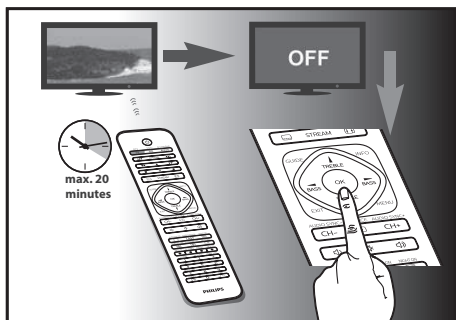

- 5 Operate the device with the universal remote. If your device responds correctly, it means you have saved the right code.

#### Note

- Auto registration can be reversed, by pressing and releasing **Power** once more during the auto registration process. This is helpful if you missed out the chance to press **OK** within 2 seconds. Make sure that the device is first powered on again.
- Repeat the same procedures to set up other devices.
- It is possible sometimes that your device only responds to some of the buttons. In such case, set up with the next code in the code list, and try operating your device again.



# 3 Notice

## Disposal of your old product and battery



Your product is designed and manufactured with high quality materials and components, which can be recycled and reused.



This symbol on a product means that the product is covered by European Directive 2012/19/EU.



This symbol means that the product contains batteries covered by European Directive 2013/56/EU which cannot be disposed of with normal household waste.

Inform yourself about the local separate collection system for electrical and electronic products and batteries. Follow local rules and never dispose of the product and batteries with normal household waste. Correct disposal of old products and batteries helps prevent negative consequences for the environment and human health.

### Removing the disposable batteries

To remove the disposable batteries, see section 'Insert batteries'.



When this logo is attached to a product, it means a financial contribution has been paid to the associated national recovery and recycling system.

### Environmental information

All unnecessary packaging has been omitted. We have tried to make the packaging easy to separate into three materials: cardboard (box), polystyrene foam (buffer) and polyethylene (bags, protective foam sheet.) Your system consists of materials which can be recycled and reused if disassembled by a specialized company. Please observe the local regulations regarding the disposal of packaging materials, exhausted batteries and old equipment.

## 4 Service and support

---

You will find our contact details at the end of this user manual.

For online support, visit [www.philips.com/support](http://www.philips.com/support)

### Frequently asked questions

#### **My universal remote does not work at all.**

- Check if you have correctly setup the device with the right code.
- Check if you have pressed the corresponding device key for your device.
- Check if the batteries are inserted properly. If the battery level is low, replace the batteries.
- Check if your device is powered on.

#### **If several device codes are listed under the brand of my device, how can I select the correct device code?**

To seek the correct device code, test the codes one by one. The codes are sorted by popularity, and the most popular code is listed first.

#### **My device responds only to some of the commands.**

You have set a code for which only some commands work properly but some do not. Try other codes until most keys work properly.

---

### Need help?

We advise you to first read this user manual carefully. It helps you set up and use the universal remote.

If, however, you require extra information or have additional questions about setup, usage, warranty, etc of the SRP6013, you can always contact us.

When calling our helpline, make sure to have the SRP6013 at hand when you call, so that our operators can help you determine whether SRP6013 is working properly.





2015 © Gibson Innovations Limited. All rights reserved.  
This product has been manufactured by, and is sold  
under the responsibility of Gibson Innovations Ltd., and  
Gibson Innovations Ltd. is the warrantor in relation to  
this product.

Philips and the Philips Shield Emblem are  
registered trademarks of Koninklijke Philips  
N.V. and are used under license from  
Koninklijke Philips N.V.

UM\_SRP6013\_10\_EN\_V1.0  
wk1549

