

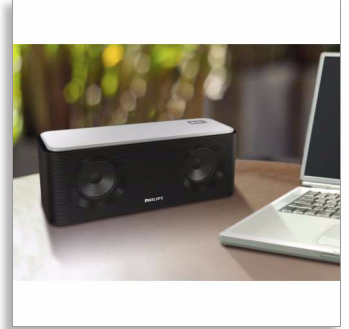

Philips  
Wireless stereo speaker

Bluetooth® and NFC

USB port for charging  
Battery or AC operated



SB365

## Stream your music and charge your smartphone

This speaker, SB365, delivers superb sound in great style. Stream music from your phone wirelessly over Bluetooth for effortless enjoyment. It also charges any smart device using USB.

### Crystal clear sound

- Wireless music streaming via Bluetooth
- Bass Reflex Speaker System delivers a powerful, deeper bass
- High fidelity Bluetooth® (aptX® and AAC) music streaming

### Advanced versatility

- Battery or AC power option for music enjoyment anywhere
- USB port for charging other devices

### Simplicity in use

- Audio-in for easy connection to almost any electronic device
- One-Touch with NFC-enabled smartphones for Bluetooth pairing

# PHILIPS

Wireless stereo speaker  
Bluetooth® and NFC USB port for charging, Battery or AC operated

# Highlights

## Bass Reflex Speaker System

Bass Reflex Speaker System delivers a deep bass experience from a compact loudspeaker box system. It differs from a conventional loudspeaker box system in the addition of a bass pipe that is acoustically aligned to the woofer to optimize the low frequency roll-off of the system. The result is deeper controlled bass and lower distortion. The system works by resonating the air mass in the bass pipe to vibrate like a conventional woofer. Combined with the response of the woofer, the system extends the overall low frequency sounds to create a whole new dimension of deep bass.

## Wireless music streaming

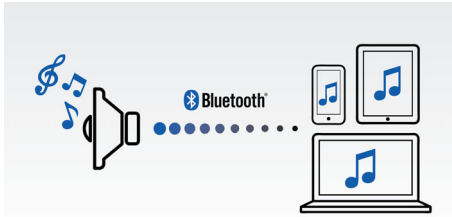

Bluetooth is a short range wireless communication technology that is both robust and energy-efficient. The technology allows easy wireless connection to iPod/iPhone/iPad or other Bluetooth devices, such as smartphones, tablets or even laptops. So you can enjoy your favorite music, sound from video or game wireless on this speaker easily.

## High fidelity Bluetooth®



With advanced technology, sound streamed via Bluetooth® is brought to the next level. Standard Bluetooth® audio uses SBC codec that is built for basic audio transmission, leaving listeners sometimes disappointed and dissatisfied. The Philips speaker, however, is armed with high fidelity (aptX® and AAC) Bluetooth® wireless technology – giving you rich, powerful and crystal clear sound. Compatible with both latest Android™ and Apple iOS smartphones, tablets and other devices, Philips now

delivers the audio quality you have come to expect. Wireless music never sounded this good.

## NFC technology

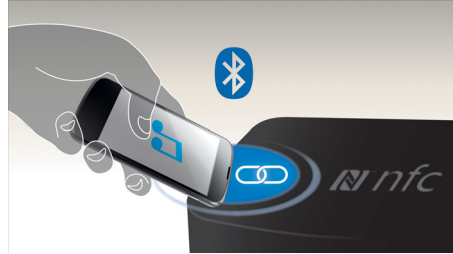

Pair Bluetooth devices easily with one-touch NFC (Near Field Communications) technology. Just tap the NFC enabled smartphone or tablet on the NFC area of a speaker to turn the speaker on, start Bluetooth pairing, and begin streaming music.

## Built-in USB port



This speaker comes with a USB port, allowing you to conveniently charge your device. Simply connect your device with its USB cable to the back of the speaker.

## Battery or AC powered

Battery or AC power option for music enjoyment anywhere

## Audio-in



Audio-in for easy connection to almost any electronic device



Issue date 2017-05-07

Version: 3.0.15

12 NC: 8670 001 13732  
UPC: 6 09585 24238 8

© 2017 Koninklijke Philips N.V.  
All Rights reserved.

Specifications are subject to change without notice.  
Trademarks are the property of Koninklijke Philips N.V.  
or their respective owners.

[www.philips.com](http://www.philips.com)

SB365/37

# Specifications

## Compatibility

- iPad: iPad 4, iPad mini, new iPad, iPad 2, iPad 1
- iPhone: iPhone 5S, iPhone 5C, iPhone 5, iPhone 4S, iPhone 4, iPhone 3GS, iPhone 3
- iPod touch: 3rd generation or later
- Android tablets & smartphones: with Android 2.1 and Bluetooth 2.1 or above
- work with: Bluetooth 4.0 and below
- other Bluetooth-enabled device

## Sound

- Output power (RMS): 8W
- Sound System: Stereo
- Volume Control: Volume Control up/down

## Connectivity

- Bluetooth version: 2.1
- Bluetooth profiles: A2DP, AVRCP
- Bluetooth range: Line of sight, 10M or 30FT
- Audio in (3.5mm)
- Connector: USB port for charging smartphones / tablets

## Dimensions

- Weight incl. Packaging: 0.65 kg
- Packaging dimensions (WxDxH): 219 x 116 x 156 mm

## Power

- Power supply: 110-240V, Battery
- Battery type: AA
- Number of batteries: 4
- Operating time on battery: 8 hr

## Loudspeakers

- Speaker drivers: 2 x 2.5" full-range woofer