

Always there to help you

Register your product and get support at
www.philips.com/welcome



HTL1100



User manual

PHILIPS

Contents

1	Important	2
	Safety	2
	Care for your product	3
	Care of the environment	3
	Help and support	3

2	Your SoundBar	4
	Main unit	4
	Remote control	4
	Connectors	5

3	Connect	6
	MP3 player	6
	Connect audio from TV and other devices	6

4	Use your SoundBar	7
	Adjust the volume	7
	Choose your sound	7
	Auto standby	7
	Apply factory settings	7

5	Wall mount	8
----------	-------------------	----------

6	Product specifications	8
----------	-------------------------------	----------

7	Troubleshooting	9
----------	------------------------	----------

1 Important

Read and understand all instructions before you use your product. If damage is caused by failure to follow instructions, the warranty does not apply.

Safety

Risk of electric shock or fire!

- Never expose the product and accessories to rain or water. Never place liquid containers, such as vases, near the product. If liquids are spilt on or into the product, disconnect it from the power outlet immediately. Contact Consumer Care to have the product checked before use.
- Never place the product and accessories near naked flames or other heat sources, including direct sunlight.
- Never insert objects into the ventilation slots or other openings on the product.
- Where the mains plug or an appliance coupler is used as the disconnect device, the disconnect device shall remain readily operable.
- Disconnect the product from the power outlet before lightning storms.
- When you disconnect the power cord, always pull the plug, never the cable.

Risk of short circuit or fire!

- Before you connect the product to the power outlet, ensure that the power voltage matches the value printed on the back or bottom of the product. Never connect the product to the power outlet if the voltage is different.

Risk of injury or damage to the SoundBar!

- Never place the product or any objects on power cords or on other electrical equipment.
- If the product is transported in temperatures below 5°C, unpack the product and wait until its temperature

matches room temperature before connecting it to the power outlet.

- Parts of this product can be made of glass. Handle with care to avoid injury and damage.

Risk of overheating!

- Never install this product in a confined space. Always leave a space of at least four inches around the product for ventilation. Ensure curtains or other objects never cover the ventilation slots on the product.

Risk of contamination!

- Do not mix batteries (old and new or carbon and alkaline, etc.).
- Danger of explosion if batteries are incorrectly replaced. Replace only with the same or equivalent type.
- Remove batteries if they are exhausted or if the remote control is not to be used for a long time.
- Batteries contain chemical substances, they should be disposed of properly.

Risk of swallowing batteries!

- The product/remote control may contain a coin/button type battery, which can be swallowed. Keep the battery out of reach of children at all times! If swallowed, the battery can cause serious injury or death. Severe internal burns can occur within two hours of ingestion.
- If you suspect that a battery has been swallowed or placed inside any part of the body, seek immediate medical attention.
- When you change the batteries, always keep all new and used batteries out of reach of children. Ensure that the battery compartment is completely secure after you replace the battery.
- If the battery compartment cannot be completely secured, discontinue use of the product. Keep out of reach of children and contact the manufacturer.



This is CLASS II apparatus with double insulation, and no protective earth provided.

Care for your product

Use only microfiber cloth to clean the product.

Care of the environment



Your product is designed and manufactured with high quality materials and components, which can be recycled and reused. Never dispose of your product with other household waste. Please inform yourself about the local rules on the separate collection of electrical and electronic products and batteries. The correct disposal of these products helps prevent potentially negative consequences on the environment and human health. Your product contains batteries, which cannot be disposed of with normal household waste. Please inform yourself about the local rules on separate collection of batteries. The correct disposal of batteries helps prevent potentially negative consequences on the environment and human health. Please visit www.recycle.philips.com for additional information on a recycling center in your area.

Help and support

For extensive online support, visit www.philips.com/support to:

- download the user manual and the quick start guide
- watch video tutorials (available only for selected models)
- find answers to frequently answered questions (FAQs)
- email us a question
- chat with our support representative.

Follow the instructions on the website to select your language, and then enter your product model number:

Alternatively, you can contact Consumer Care in your country. Before you contact, note down the model number and serial number of your product. You can find this information on the back or bottom of your product.

2 Your SoundBar

Congratulations on your purchase, and welcome to Philips! To fully benefit from the support that Philips offers, register your SoundBar at www.philips.com/welcome.

Main unit

This section includes an overview of the main unit.

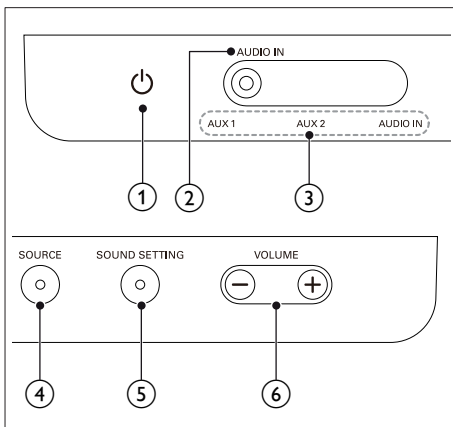

- ① **⏻ (Standby-On)**
 - Switch the SoundBar on or to standby.
- ② **AUDIO IN**
 - Audio input from an external audio device (3.5mm jack).
- ③ **Source indicators**

Source indicator lights up when a source is selected.

 - AUX 1 / AUX 2:** Lights up when you switch to analog input source.
 - AUDIO IN:** Lights up when you switch to audio input source (3.5mm jack).
- ④ **SOURCE**
 - Select an input source: AUX 1 / AUX 2 / AUDIO IN.

- ⑤ **SOUND SETTING**
 - Press to toggle among balance, powerful, and bright sound settings.
 - Press and hold to turn **SURR** on or off.
- ⑥ **VOLUME + / -**
 - Increase or decrease volume.

Remote control

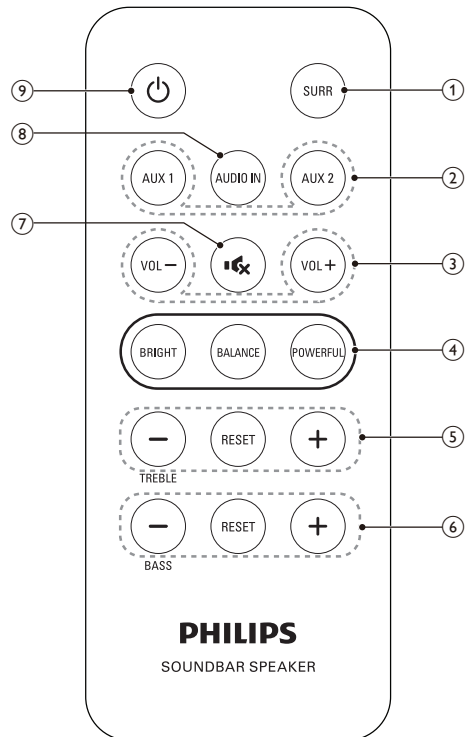

This section includes an overview of the remote control.



- ① **SURR**

Toggle between stereo and virtual surround sound.
- ② **AUX 1 / AUX 2**

Switch your audio source to the AUX connection.

- ③ **VOLUME +/-**
Increase or decrease volume.
- ④ **BRIGHT / BALANCE / POWERFUL**
Select the preset sound setting.
- ⑤ **TREBLE +/- / RESET**
 - Increase or decrease treble.
 - Reset your treble level to the default settings programmed at the factory.
- ⑥ **BASS +/- / RESET**
 - Increase or decrease bass.
 - Reset your bass level to the default settings programmed at the factory.
- ⑦  **Mute**
Mute or restore volume.
- ⑧ **AUDIO IN**
Switch your audio source to audio input connection (3.5mm jack).
- ⑨  **(Standby-On)**
Switch the SoundBar on or to standby.

② AUX 1 / AUX 2

Connect to an audio output on the TV or other devices.

Connectors

This section includes an overview of the connectors available on your SoundBar:

Rear connectors

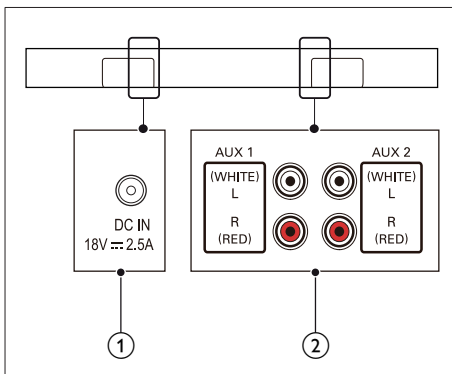

- ① **DC IN 18V 2.5A**
Connect to the power supply.

3 Connect

This section helps you connect your SoundBar to a TV and other devices.

For information about the basic connections of your SoundBar and accessories, see the quick start guide.

Note

- For identification and supply ratings, refer to the type plate at the back or bottom of the product.
- Before you make or change any connections, make sure that all devices are disconnected from the power outlet.

Connect audio through analog audio cables

Basic quality audio

- 1 Using an analog cable, connect the **AUX 1** or **AUX 2** connectors on your SoundBar to the **AUDIO OUT** connectors on the TV or other device.

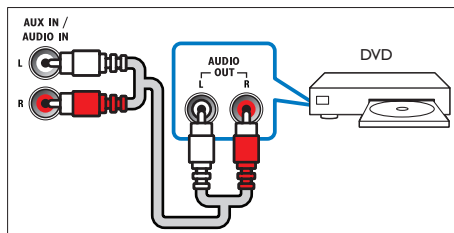

MP3 player

Connect your MP3 player to play your audio files or music.

What you need

- An MP3 player.
- A 3.5mm stereo audio cable.

- 1 Using the 3.5mm stereo audio cable, connect the MP3 player to the **AUDIO IN** connector on your SoundBar.
- 2 Press **AUDIO IN**.
- 3 Press the buttons on the MP3 player to select and play audio files or music.

Connect audio from TV and other devices

Play audio from TV or other devices through your Soundbar.



4 Use your SoundBar

This section helps you use the SoundBar to play audio from connected devices.

Before you start

- Make the necessary connections described in the quick start guide and the user manual.
- Switch the SoundBar to the correct source for other devices.

Adjust the volume

- 1 Press **VOLUME +/-** to increase or decrease a volume level.
 - To mute sound, press .
 - To restore the sound, press  again or press **VOLUME +/-**.

↳ All source indicators on the main unit blink once when a volume is set to the maximum or minimum value.

Choose your sound

This section helps you choose the ideal sound for your video or music.

Surround sound mode

Experience an immersive audio experience with surround sound modes.

- 1 Press **SURR** to select a surround mode.
 - **[Virtual Surround]**: Creates a highly surround listening experience.
 - **[Stereo]**: Two-channel stereo sound. Ideal for listening to music.

Equalizer

Change the high frequency (treble) and low frequency (bass) settings of the SoundBar.

- 1 Press **TREBLE +/-** or **BASS +/-** to change the frequency.

↳ All source indicators on the main unit blink once when treble or bass is set to the maximum or minimum value.
- Press **RESET** to reset your treble or bass level to the default settings programmed at the factory.

Sound mode

Select predefined sound modes to suit your video or music.

- 1 Press **SOUND SETTING** repeatedly on the main unit or press **BRIGHT**, **BALANCE** or **POWERFUL** on remote control to select a preferred sound setting:
 - **BRIGHT**: Spice up your dull movies and music with added sound effects.
 - **BALANCE**: Experience the original sound of your movies and music, without added sound effects.
 - **POWERFUL**: Enjoy thrilling arcade sounds, ideal for action-packed videos and loud parties.

Auto standby

When playing media from a connected device, the SoundBar automatically switches to standby if no audio input for 15 minutes.

Apply factory settings

You can reset your SoundBar to factory default settings.

- 1 Press  on remote control.
- 2 Press **AUX 1** twice.

↳ The factory default settings are restored.

5 Wall mount

Note

- Improper wall mounting may result in accident, injury or damage. If you have any query, contact Consumer Care in your country.
- Before wall mounting, make sure the wall can support the weight of your SoundBar.

Screw length / diameter

Depending on the type of wall mounting your SoundBar, make sure that you use screws of a suitable length and diameter:

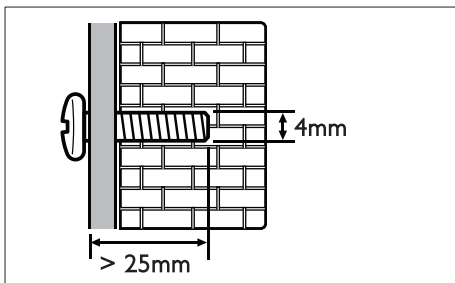

For information about how to wall mount your SoundBar, see the quick start guide.

6 Product specifications

Note

- Specifications and design are subject to change without notice.

Amplifier

Maxim output power	2 x 20 W RMS (± 0.5 dB, 30% THD)
Frequency response	30 Hz - 20 kHz / ± 3 dB
Signal-to-noise ratio	>77 dB (CCIR) / (A-weighted)
Input sensitivity	<ul style="list-style-type: none"> • Aux: 1,500 mV (± 100 mV) • AUDIO-IN: 600 mV (± 100 mV)

Main unit

Power supply (AC power adaptor)	<ul style="list-style-type: none"> • Model: GFP451-1825BX-1 (Philips) • Input: 100-240 V~, 50/60 Hz 1.2 A • Output: 18 V \equiv 2.5 A • Operation power consumption: < 50 W
Standby power consumption	≤ 0.5 W
Speaker impedance	6 ohm (full range)
Speaker drivers	2 x 63.5 mm (2.5")
Dimensions (W x H x D)	845 x 80 x 84 mm
Weight	1.9 kg

Remote control batteries

- 1 x CR2025

7 Troubleshooting



Warning

- Risk of electric shock. Never remove the casing of the product.

To keep the warranty valid, never try to repair the product yourself.

If you have problems using this product, check the following points before you request service.

If you still have a problem, get support at www.philips.com/support.

Sound

No sound from SoundBar speakers.

- Connect the audio cable from your SoundBar to your TV or other devices.
- Reset your SoundBar to its factory settings.
- On the remote control, select the correct audio input.
- Make sure that the SoundBar is not muted.

Distorted sound or echo.

- If you play audio from the TV through the SoundBar, make sure that the TV is muted.

部件名称 Name of the Parts	有毒有害物质或元素 Hazardous/Toxic Substance					
	铅 (Pb, Lead)	汞 (Hg, Mercury)	镉 (Cd, Cadmium)	六价铬 (Chromium 6+)	多溴联苯 (PBB)	多溴二苯醚 (PBDE)
Housing 外壳	O	O	O	O	O	O
Loudspeakers 喇叭单元	O	O	O	O	O	O
PWBs 电路板组件	X	O	O	O	O	O
Accessories (Remote control & cables) 附件（遥控器， 电源线，连接线）	X	O	O	O	O	O
Batteries in Remote Control (ZnC) 遥控器电池	X	O	O	O	O	O

O：表示该有毒有害物质在该部件所有均质材料中的含量均在SJ/T11363 - 2006 标准规定的限量要求以下。
O: Indicates that this toxic or hazardous substance contained in all of the homogeneous materials for this part is below the limit requirement in SJ/T11363 - 2006.

×：表示该有毒有害物质至少在该部件的某一均质材料中的含量超出SJ/T11363 - 2006 标准规定的限量要求。
X: Indicates that this toxic or hazardous substance contained in at least one of the homogeneous materials used for this part is above the limit requirement in SJ/T11363 - 2006.



环保使用期限 Environmental Protection Use Period

此标识指期限（十年），电子信息产品中含有的有毒有害物质或元素在正常使用的条件下不会发生外泄或突变，用户使用该电子信息产品不会对环境造成严重污染或对其人身、财产造成严重损害的期限。

This logo refers to the period (10 years) during which the toxic or hazardous substances or elements contained in electronic information products will not leak or mutate so that the use of these [substances or elements] will not result in any severe environmental pollution, any bodily injury or damage to any assets.

电池标识 Battery labeling logo



环保使用期限 Environmental Protection Use Period

此标识指期限（五年），电池中含有的有毒有害物质或元素在正常使用的条件下不会发生外泄或突变，用户使用该电池产品不会对环境造成严重污染或对其人身、财产造成严重损害的期限。

This logo refers to the period (5 years) during which the toxic or hazardous substances or elements contained in the **battery** will not leak or mutate so that the use of these [substances or elements] will not result in any severe environmental pollution, any bodily injury or damage to any assets.



2013 © WOOX Innovations Limited. All rights reserved.

Philips and the Philips' Shield Emblem are registered trademarks of Koninklijke Philips N.V. and are used by WOOX Innovations Limited under license from Koninklijke Philips N.V.

HTL1100_93_UM_V2.0

