



THANK YOU FOR CHOOSING PHILIPS!

## NEED HELP FAST?

Read your Quick-Use guide and/or owner's manual first for quick tips that make using your Philips product more enjoyable. If you have read your instructions and still need assistance,

you may access our online help at [www.usasupport.philips.com](http://www.usasupport.philips.com)

or call **1-888-PHILIPS(744-5477)** while with your product, (and model/serial number).

User manual

Manuel d'utilisation

Manual del usuario



# PHILIPS

## **Canada**

### **English:**

This digital apparatus does not exceed the Class B limits for radio noise emissions from digital apparatus as set out in the Radio Interference Regulations of the Canadian Department of Communications.

### **Français:**

Cet appareil numérique n'émet pas de bruits radioélectriques dépassant les limites applicables aux appareils numériques de Class B prescrites dans le Règlement sur le Brouillage Radioélectrique édicté par le Ministère des Communications du Canada.

## **CAUTION**

*Use of controls or adjustments or performance of procedures other than herein may result in hazardous radiation exposure or other unsafe operation.*

## **ATTENTION**

*L'utilisation des commandes ou réglages ou le non-respect des procédures ci-incluses peuvent se traduire par une exposition dangereuse à l'irradiation.*

## **ATENCIÓN**

*El uso de mando o ajustes o la ejecución de métodos que no sean los aquí descritos puede ocasionar peligro de exposición a radiación.*

# Return your Product Registration Card today to get the very most from your purchase.

Registering your model with PHILIPS makes you eligible for all of the valuable benefits listed below, so don't miss out. Complete and return your Product Registration Card at once to ensure:

## \*Proof of Purchase

Returning the enclosed card guarantees that your date of purchase will be on file, so no additional paperwork will be required from you to obtain warranty service.

## \*Product Safety Notification

By registering your product, you'll receive notification - directly from the manufacturer - in the rare case of a product recall or safety defect.

## \*Additional Benefits of Product Ownership

Registering your product guarantees that you'll receive all of the privileges to which you're entitled, including special money-saving offers.

## Know these safety symbols



 This "bolt of lightning" indicates uninsulated material within your unit may cause an electrical shock. For the safety of everyone in your household, please do not remove product covering.

 The "exclamation point" calls attention to features for which you should read the enclosed literature closely to prevent operating and maintenance problems.

## For Customer Use

Enter below the Serial No. which is located on the rear of the cabinet. Retain this information for future reference.

Model No. \_\_\_\_\_

Serial No. \_\_\_\_\_

**WARNING:** TO PREVENT FIRE OR SHOCK HAZARD, DO NOT EXPOSE THIS EQUIPMENT TO RAIN OR MOISTURE.

**CAUTION:** To prevent electric shock, match wide blade of plug to wide slot, fully insert.

# PHILIPS

***Congratulations on your purchase,  
and welcome to the “family!”***

**Dear PHILIPS product owner:**

Thank you for your confidence in PHILIPS. You've selected one of the best-built, best-backed products available today. We'll do everything in our power to keep you happy with your purchase for many years to come.

As a member of the PHILIPS “family,” you're entitled to protection by one of the most comprehensive warranties and outstanding service networks in the industry. What's more, your purchase guarantees you'll receive all the information and special offers for which you qualify, plus easy access to accessories from our convenient home shopping network.

Most importantly, you can count on our uncompromising commitment to your total satisfaction.

All of this is our way of saying welcome - and thanks for investing in a PHILIPS product.

**P.S. To get the most from your PHILIPS purchase, be sure to complete and return your Product Registration Card at once.**

# IMPORTANT SAFETY INSTRUCTIONS

1. **Read these instructions.**
2. **Keep these instructions.**
3. **Heed all warnings.**
4. **Follow all instructions.**
5. **Do not use this apparatus near water.**
6. **Clean only with a piece of dry cloth.**
7. **Do not block any ventilation openings. Install in accordance with the manufacturer's instructions.**
8. **Do not install near any heat sources** such as radiators, heat registers, stoves, or other apparatus (including amplifiers) that produce heat.
9. **Do not defeat the safety purpose** of the polarized or grounding-type plug. A polarized plug has two blades with one wider than the other. A grounding type plug has two blades and a third grounding prong. The wide blade or the third prong are provided for your safety. If the provided plug does not fit into your outlet, consult an electrician for replacement of the obsolete outlet.
10. **Protect the power cord** from being walked on or pinched, particularly at plugs, convenience receptacles, and the point where they exit from the apparatus.
11. **Only use attachments/accessories** specified by the manufacturer.

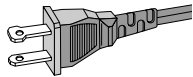

**AC Polarized Plug**

12.  **Use only with the cart**, stand, tripod, bracket, or table specified by the manufacturer or sold with the apparatus. When a cart is used, use caution when moving the cart /apparatus combination to avoid injury from tip-over.

13. **Unplug this apparatus** during lightning storms or when unused for long periods of time.
14. **Refer all servicing** to qualified service personnel. Servicing is required when the apparatus has been damaged in any way, such as power-supply cord or plug is damaged, liquid has been spilled or objects have fallen into the apparatus, the apparatus has been exposed to rain or moisture, does not operate normally, or has been dropped.
15. **Battery usage CAUTION** – To prevent battery leakage which may result in bodily injury, property damage, or damage to the unit:  
Install **all** batteries correctly, + and - as marked on the unit.  
Do not mix batteries (**old** and **new** or **carbon** and **alkaline**, etc.).  
Remove batteries when the unit is not used for a long time.
16. **Apparatus shall not be exposed to dripping or splashing.**
17. **Do not place any sources of danger on the apparatus** (e.g. liquid filled objects, lighted candles).

18. This product may contain lead and mercury. Disposal of these materials may be regulated due to environment considerations.

**For disposal or recycling information, please contact your local authorities or the Electronic Industries Alliance: [www.eiae.org](http://www.eiae.org).**

**EL 6475-S004: 03/12**

**Class II equipment symbol**   
This symbol indicates that the unit has a double insulation system

*Manufactured under license from Dolby Laboratories. "Dolby", "Pro-logic" and the double-D symbol are trademarks of dolby Laboratories.*

*MANUFACTURED UNDER LICENSE FROM DIGITAL THEATER SYSTEMS, INC. US PAT. NO 5,451,942, 5,956,674, 5,974,380, 5,978,762 AND OTHER WORLD-WIDE PATENTS ISSUED AND PENDING. "DTS" AND "DTS DIGITAL SURROUND" ARE REGISTERED TRADEMARKS OF DIGITAL THEATER SYSTEMS, INC. COPYRIGHT 1996, 2000 DIGITAL THEATER SYSTEMS, INC. ALL RIGHTS RESERVED.*

*This product incorporates copyright protection technology that is protected by method claims of certain U.S. patents and other intellectual property rights owned by Macrovision Corporation and other rights owners. Use of this copyright protection technology must be authorized by Macrovision Corporation, and is intended for home and other limited viewing uses only unless otherwise authorized by Macrovision Corporation. Reserve engineering or disassembly is prohibited.*

English ----- 4

Français ----- xx

Español ----- xx

English

Français

Español

## General Information

Features .....	10
Supplied accessories .....	10
Environment information .....	10
Installation .....	10
Maintenance .....	10

## Connections

Connecting the speakers .....	11
Connecting antennas .....	12
Connecting the control cable .....	12
Connecting a TV .....	12
Connecting the power cord .....	12
Connecting additional equipment .....	13

## Functional Overview

DVD player and power amplifier .....	14~15
Remote control .....	15~16

## Getting Started

Step 1: Inserting batteries into the Remote Control .....	17
Using the Remote Control to operate the Player .....	
Step 2: Setting up the TV .....	17
Step 3: Setting language preference .....	18
Setting the OSD Language .....	
Setting the Audio, Subtitle and Disc Menu language .....	

## Basic Functions

Switching on/off the system .....	19
Volume control .....	19
Sound Control .....	19
DBB (Dynamic Bass Boost) .....	
DSC (Digital Sound Control) .....	
LOUDNESS .....	
Dimming the display screen .....	19

## Disc Operations

Playable Discs .....	20
Playing discs .....	20
Using the Disc Menu .....	20~21
Basic playback controls .....	21~22
Pausing playback (DVD/VCD/CD/MP3/WMA) .....	
Selecting a track/chapter/title (DVD/VCD/CD/MP3/WMA) .....	
Resuming playback from the last stopped point (DVD/VCD/CD/MP3/WMA) .....	
Zoom (DVD/VCD/JPEG) .....	
Repeat (DVD/VCD/CD/MP3/WMA) .....	
Repeat A-B (DVD/VCD/CD/MP3/WMA) .....	
Slow Motion (DVD/VCD) .....	
Program (not for Picture CD) .....	
Forward/Reverse Searching (DVD/VCD/CD/MP3/WMA) .....	
Time search & search by chapter/track number (DVD/VCD/CD/MP3/WMA) .....	
Information display during playback (not for Picture CD) .....	
Special disc features .....	22~23
Playing a Title (DVD) .....	
Camera Angle (DVD) .....	
Changing the Audio Language (for DVD recorded with multiple languages) .....	
Changing the Audio Channel (for VCD only) .....	
Subtitles (DVD) .....	
Playing MP3/WMA/JPEG Picture disc .....	23
Playing MP3/WMA disc .....	23
General operation .....	
Playback selection .....	
Playing JPEG Picture CD .....	23~24
General operation .....	
Playback selection .....	
Special JPEG features .....	24
Preview function (JPEG) .....	
Zoom picture (JPEG) .....	
Slide show playback modes (JPEG) .....	
Playback with multi-angles (JPEG) .....	



---

## System Menu Options

Basic Operations .....	25
General Setup Page .....	25~26
TV Display	
Closed Captions	
Screen Saver	
Audio Setup Page .....	26~27
SPDIF Setup	
Dolby Digital Setup	
3D Processing	
HDCD	
D.R.C	
Video Setup Page .....	27~28
Component	
TV Mode	
Quality	
Preference Page .....	28~29
Parental	
Default	
Password Setup Page .....	29
Password mode	
Password	

---

## Other Functions

Radio reception .....	30
Tuning to radio stations	
Presetting radio stations	
Listening to preset radio stations	
Setting the clock .....	30
Setting sleep/wake-up timer .....	31
Sleep timer setting	
Wake-up timer setting	

---

<b>Specifications</b> .....	32
-----------------------------	----

---

<b>Troubleshooting</b> .....	33~34
------------------------------	-------

---

<b>Glossary</b> .....	35
-----------------------	----

# General Information

## Features

Built-in DTS and Dolby® Digital decoder; 2.0-channel amplifier

### Additional Component Connections

Lets you connect other audio and audio/visual components to the DVD micro system.

### Night Mode

Lets you compress the dynamic range, reducing the difference in loudness between different sounds in Dolby Digital mode.

### Parental Control (Rating Level)

Lets you set a ratings level so that your children cannot watch a DVD that has a rating higher than you set.

### Sleep/Wake-up Timer

Enables the system to switch on/off automatically at a preset time.

## Supplied accessories

- Remote control with two AAA batteries
- AM antenna
- FM wire antenna
- 2 loudspeaker boxes including 2 speaker cables
- Composite video cable (yellow)
- Control cable
- Stand

**If any item is damaged or missing, contact your retailer or Philips.**

## Environmental information

All unnecessary packaging has been omitted. We have tried to make the packaging easy to separate into three materials: cardboard (box), polystyrene foam (buffer) and polyethylene (bags, protective foam sheet).

Your system consists of materials which can be recycled and reused if disassembled by a specialised company. Please observe the local regulations regarding the disposal of packaging materials, exhausted batteries and old equipment.

## Installation

- Place the player on a flat, hard, and stable surface.
- In a cabinet, allow about 10cm (4 inches) of free space all around the player for adequate ventilation.
- Do not expose your player to extreme temperatures or humidity.
- The apparatus shall not be exposed to dripping or splashing and that no objects filled with liquid such as vase shall be placed on the apparatus.
- No naked flame sources, such as lighted candles, shall be placed on the apparatus.
- The ventilation should not be impeded by covering the ventilation openings with items, such as newspapers, table-cloths, curtains, etc.

## Maintenance

- When a disc becomes dirty, clean it with a cleaning cloth. Wipe the disc from the center out, in a straight line.
- Do not expose the player, batteries or discs to humidity, rain, sand or excessive heat (caused by heating equipment or direct sunlight). Always keep the disc tray closed to avoid dust on the lens.
- Do not use solvents such as benzene, thinner, commercially available cleaners, or anti-static spray intended for colour discs.
- The lens may cloud over when the player is suddenly moved from cold to warm surroundings, making it impossible to play a disc. Leave the player in the warm environment until the moisture evaporates.



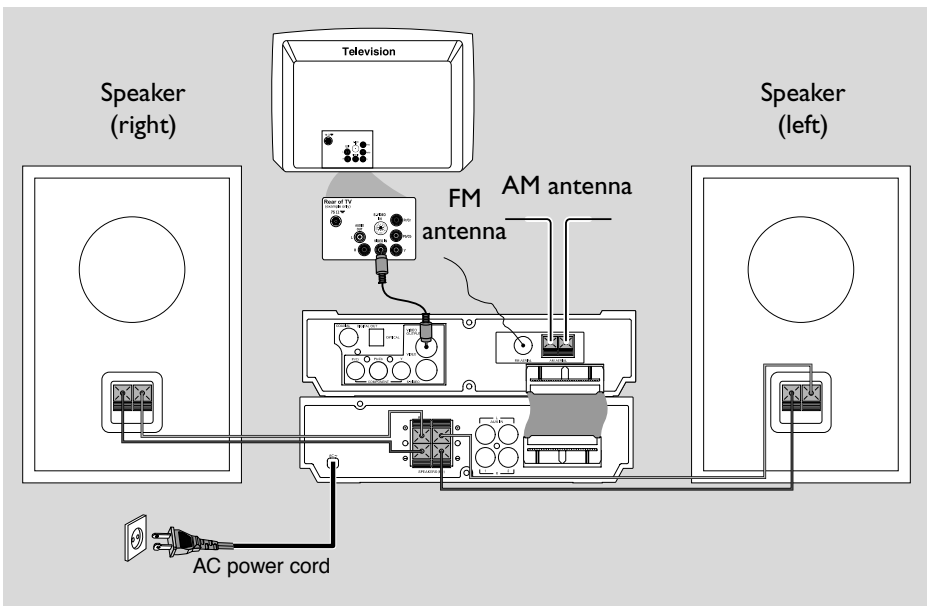

## IMPORTANT!

- The type plate is located at the bottom of the system.
- Before connecting the AC power cord to the wall outlet, ensure that all other connections have been made.
- Never make or change any connections with the power switched on.

## Connecting the speakers

Connect the speakers to the SPEAKERS (8Ω) terminals with two speaker cables. Right speaker to "R" and left speaker to "L", red wire to "+" and silver wire to "-". Fully insert the stripped portion of the speaker wire into the terminal as shown.

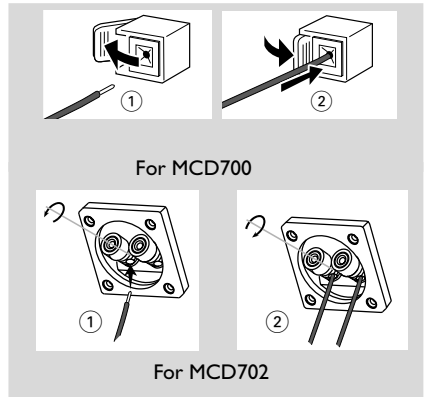

## Notes:

- Ensure that the speaker cables are correctly connected. Improper connections may damage the system due to short-circuit.
- For optimal sound performance, use the supplied speakers.
- Do not connect more than one speaker to any one pair of +/- speaker jacks.
- Do not connect speakers with an impedance lower than the speakers supplied. Please refer to the SPECIFICATIONS section of this manual.

# Connections

## Connecting antennas

Connect the supplied AM antenna and FM antenna to the respective terminals. Adjust the position of the antenna for optimal reception.

### AM Indoor Antenna

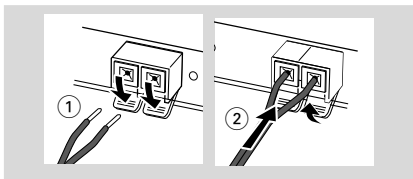

- Position the antenna as far as possible from a TV, VCR or other radiation source.

### FM Indoor Antenna

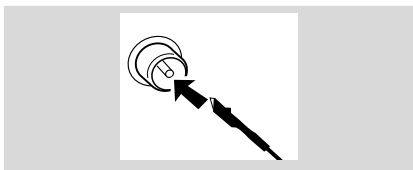

- For better FM stereo reception, connect an outdoor FM antenna to the FM AERIAL (FM ANTENNA) terminal.

## Connecting the control cable

Connect the serial port marked "**CONTROL CABLE**" at the rear of the DVD player to the same port at the rear of the power amplifier with the supplied flat control cable.

## Connecting a TV

You must connect a TV to your DVD micro system in order to view the DVD/VCD playback.

### IMPORTANT!

– There are various ways to connect the system to a TV. You only need to make one of the best connections, depending on the capabilities of your TV system.

– If **COMPONENT** video output jacks or **S-Video** jack is used for video connection, the system's Component setting will need to be set accordingly. Details are shown under "**Video Setup Page**".

- Connect the **VIDEO OUTPUT** jack to the video input jack on the TV using a video cable (yellow).

### OR

#### Option 1

Connect the **S-VIDEO** output jack to the S-Video input jack on the TV using an S-Video cable (not supplied).

### OR

#### Option 2

Use the component video cables (red/blue/green) to connect the DVD micro system's **COMPONENT** video output jacks to the corresponding component video input jacks (or labeled as **Pri/Cr Pb/Cb Y** or **YUV**) on the TV.

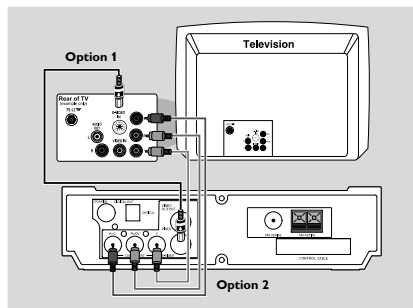

### Note:

– To avoid magnetic interference, do not position the front speakers too close to your TV.

## Connecting the power cord

**After everything is connected properly, plug in the AC power cord to the power outlet.**

Never make or change any connection with the power switched on.

## Connecting additional equipment

### IMPORTANT!

- Some discs are **copy-protected**. You cannot record the disc through a **VCR or digital recording device**.
- **When making connections, make sure the colour of cables matches the colour of jacks.**
- **Always refer to the owner's manual of the other equipment for complete connection and usage details.**

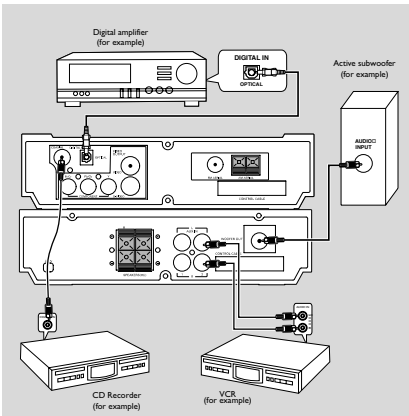

## Viewing and listening to the playback of other equipment

- Connect the system's **AUX IN (R/L)** jacks to the **AUDIO OUT** jacks on the other audio/visual device (such as a TV, VCR, Laser Disc player or cassette deck).  
Before starting operation, press **AUX** on the remote repeatedly in order to activate the input source (**AUX1** or **AUX2**).

### Connecting an active subwoofer

- Connect the DVD micro system's **WOOFER OUT** jack to the **AUDIO INPUT** jack on an active woofer (not supplied).

### Recording (digital)

- Connect the system's **DIGITAL OUT (COAXIAL or OPTICAL)** jack to the **DIGITAL IN** jack on a digital recording device (such as DTS-Digital Theatre compatible, with Dolby Digital decoder).  
**Before starting operation**, set **SPDIF** according to the audio connection. (See "**SPDIF Setup**").

### Connecting a digital amplifier

- Connect the **DIGITAL OUT (COAXIAL or OPTICAL)** port to the coaxial/optical input jack of a digital amplifier with a coaxial/optical cable (not supplied) for superior digital sound effect.

# Functional Overview

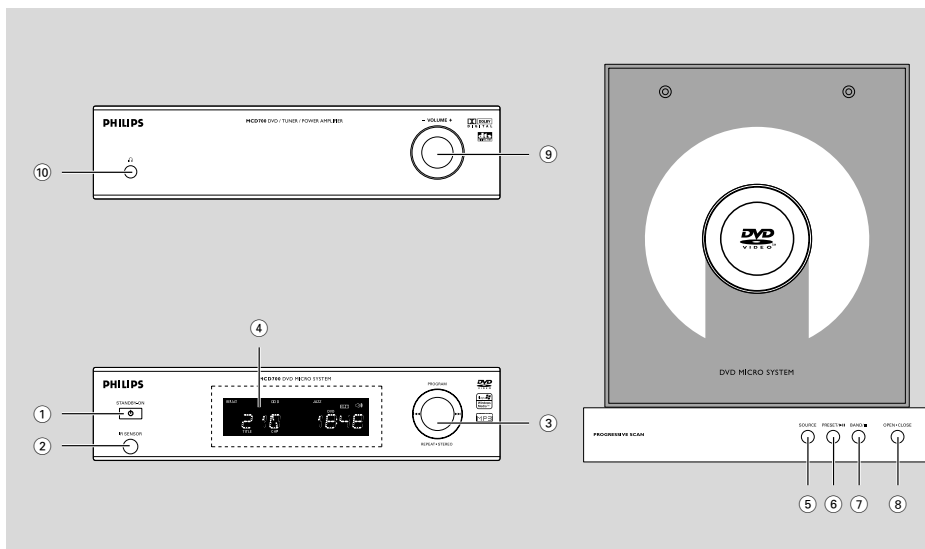

## DVD player and power amplifier

### ① STANDBY ON

- switches the system on or to standby mode.

### ② IR SENSOR

- point the remote control towards this sensor.

### ③ Control knob



Disc ..... press the control knob to the left/right to skip to the previous/next chapter/title/track.

Tuner ..... press the control knob to the left/right to tune to a higher/lower radio frequency.

..... press and hold, then release the key to start automatic search for a radio frequency downward/upward.

### PROGRAM

DVD/VCD/CD press the control knob upward to enter the program menu.

MP3/WMA-CD

..... press the control knob upward to add/delete a programmed track to/from the program list.

Picture CD ..... **during playback**, press the control knob upward to select a slide show mode.

Tuner ..... press the control knob upward to program preset radio stations.

### REPEAT•STEREO

Disc ..... press the control knob downward to repeat a track or disc.

FM ..... press the control knob downward to set stereo or mono sound mode.

### ④ Display

- shows the current status of the DVD player.

### ⑤ SOURCE

- selects the respective sound source: DVD/AUX1/AUX2/TUNER.
- switches the system on.

### ⑥ PRESET/

- **Disc:** starts or interrupts disc playback
- **TUNER:** selects a preset radio station

- ⑦ **BAND/■**
  - **Disc:** disc playback or erases a program.
  - **TUNER:** switches between AM and FM.
- ⑧ **OPEN•CLOSE**
  - opens or closes the disc compartment.
- ⑨ **VOLUME -/+**
  - adjusts the volume upward/downward.
  - adjusts the hours and minutes in clock/timer setting mode.
  - switches the set timer ON or OFF.
- ⑩ **🎧**
  - connect a headphone

## Remote control

- ① **⏻**
  - switches the system on/ off.
- ② **▲**
  - opens or closes the disc compartment
- ③ **Numeric Keypad (0-9)**
  - inputs a track/title/chapter number of the disc.
  - inputs the number of a preset radio station.
- ④ **PROG**
  - **DVD/VCD/CD:** enters the program menu.
  - **MP3/WMA-CD:** adds/deletes a programmed track to/from the program list.
  - **Picture CD: during playback,** to select a slide show mode.
  - **Tuner:** programs preset radio stations.
- ⑤ **GOTO/ST**
  - **Disc:** fast searches in a disc by entering a time, title, chapter or track.
  - **FM:** sets stereo or mono sound mode.
- ⑥ **SYSTEM (disc mode only)**
  - enters or exits the system menu.
- ⑦ **DISC MENU (disc mode only)**
  - DVD/VCD: enters or exits the disc contents menu.
  - VCD2.0: switches the playback control mode on or off.
  - MP3/WMA: switches between Album and Filelist.
- ⑧ **▼ / ▲ / ► / ◀**
  - selects an item in a menu.
  - moves an enlarged picture up/down/left/right.
- ⑨ **OK**
  - confirms a selection.
- ⑩ **ZOOM**
  - DVD/VCD/Picture CD: enlarges or reduces a picture or active image on the TV screen.
- ⑪ **MUTE**
  - disables or enables sound output.

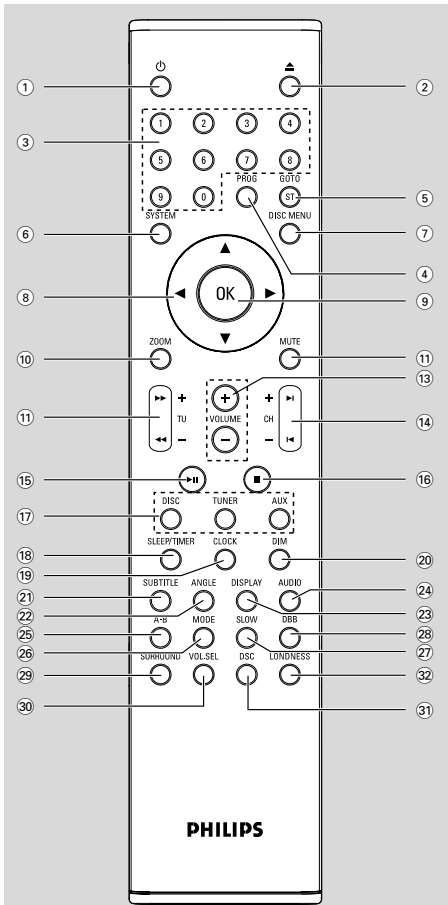

# Functional Overview

## 12 TU +/- (◀◀ / ▶▶)

### Tuner

- press to tune to a lower/higher radio frequency gradually.
- press and hold, then release the key to start automatic search for a radio frequency downward/upward.

### Disc

- searches backward/forward in a disc at different speeds.

## 13 VOLUME +/-

- adjusts the volume upward/downward.
- adjusts the hours and minutes in clock/timer setting mode.
- switches the set timer ON or OFF.

## 14 CH +/- (◀ / ▶)

- **Disc:** skips to the previous/next chapter/title/track
- **Tuner:** selects a preset radio station.

## 15 ▶ II

- starts or interrupts disc playback.

## 16 ■

- stops disc playback or erases a program.

## 17 DISC/TUNER/AUX

- selects the respective sound source for DVD/TUNER/AUX1/AUX2.
- exits P-SCAN (progressive scan). (for **DISC** only)

## 18 SLEEP/TIMER

### Standby mode

- sets a time for switching on the system automatically.

### Power-on mode

- sets the sleep timer function (auto off).

## 19 CLOCK

### Standby mode

- sets the system clock.

### Playback mode

- displays the system clock.

## 20 DIM

- selects different levels of brightness for the display screen in standby mode.

## 21 SUBTITLE

- selects a subtitle language.

## 22 ANGLE

- selects a DVD camera angle.

## 23 DISPLAY

- displays information on TV screen during playback

## 24 AUDIO

### for VCD

- sets Stereo, Mono-Left or Mono-Right sound mode.

### for DVD

- selects an audio language.

## 25 A-B

- repeats playback of a specific section on a disc.

## 26 MODE

- selects various repeat modes or the shuffle play mode for a disc.

## 27 SLOW

- selects different slow playback modes for a VCD/SVCD/DVD.

## 28 DBB

- enables or disables bass enhancement.

## 29 SURROUND (unavailable for this version)

- selects surround (Dolby Digital, DTS-Digital Theatre Systems or VSS-Virtual Surround Sound) or stereo sound effect.

## 30 VOL.SEL (unavailable for this version)

- selects different speaker modes.

## 31 DSC

- selects different types of preset sound equalizer settings (CLASSIC, JAZZ, POP or ROCK).

## 32 LOUDNESS

- enables or disables automatic loudness adjustment.



## Step 1: Inserting batteries into the Remote Control

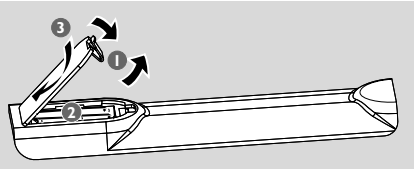

- 1 Open the battery compartment.
- 2 Insert two AAA batteries following the indications (+/-) inside the compartment.
- 3 Close the cover.

### Using the Remote Control to operate the Player

- 1 Aim the Remote Control directly at the remote sensor (IR) on the front panel.
- 2 Do not put any objects between the Remote Control and the DVD Player while operating the DVD Player:

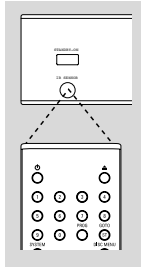

### CAUTION!

- Remove batteries if they are exhausted or if the Remote Control is not being used for a long time.
- Do not use old and new or different types of batteries in combination.
- Batteries contain chemical substances, so they should be disposed of properly.

## Step 2: Setting up the TV

### IMPORTANT!

- Make sure you have completed all the necessary connections. (See "Connecting TV").
- In order for a DVD disc to play on this Player, the colour system of the Disc, the TV and the DVD Player should match.

- 1 Switch the DVD system on and then select DISC source. (See "Switching the system on/off").
- 2 Turn on the TV and set to the correct video-in channel. You should see the blue Philips DVD background screen on the TV.
  - Usually these channels are between the lowest and highest channels and may be called FRONT, A/V IN, or VIDEO. See your TV manual for more details.
  - Or, you may go to channel 1 on your TV, then press the Channel down button repeatedly until you see the Video In channel.
  - Or, the TV Remote Control may have a button or switch that chooses different video modes.
  - Or, set the TV to channel 3 or 4 if you are using an RF modulator.

# Getting Started

## Step 3: Setting language preference

You can select your own preferred language settings. This DVD system will automatically switch to the selected language whenever you load a disc. If the language selected is not available on the disc, the disc's default language will be used instead. The OSD language in the system menu will remain once selected.

### Setting the OSD Language

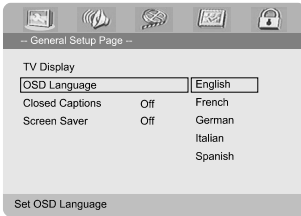

- 1 Press **SYSTEM**.
- 2 Press ◀▶ to select "General Setup Page".
- 3 Use ◀▶ ▲▼ on the remote to navigate in the menu.  
Move to "OSD Language" and press ▶.

- 4 Select a language and press **OK**.

#### To exit from the menu

- Press **SYSTEM** again.

### Setting the Audio, Subtitle and Disc Menu language

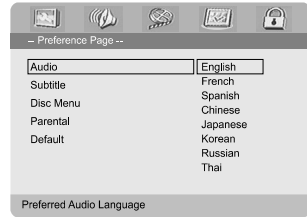

- 1 Press **SYSTEM** in stop mode.
- 2 Press ◀▶ to select "Preference Page".
- 3 Press ▲▼ to highlight the following in the Preference Page.
  - "Audio" (disc's soundtrack)
  - "Subtitle" (disc's subtitles)
  - "Disc Menu" (disc's menu)
- 4 Enter its submenu by pressing ▶.
- 5 Select a language and press **OK**.
- 6 Repeat steps 3~5 for other language settings.

#### To exit from the menu

- Press **SYSTEM** again.

#### If you choose **OTHERS** in Audio, Subtitle or Disc Menu,

- 1 Press ▲▼ to highlight "Others".
- 2 Press **OK**.
- 3 When you are asked to enter a language code, input a language code by using the **Numeric Keypad (0-9)**.
- 4 Press **OK** to confirm.

## Switching the system on/off

- Press **STANDBY ON**  (⏻ on the remote).  
→ "HELLO" is displayed briefly. The system will switch to the last selected source.
- Press **DISC, TUNER** or **AUX** on the remote.  
→ The system will switch to the selected source.

### To switch the system to standby mode

- Press **STANDBY ON**  (⏻ on the remote).  
→ "BYE BYE" is displayed briefly. The interactive sound settings, last selected source and tuner presets will be retained in the player's memory.

## Volume control

Turn **VOLUME (-/+)** clockwise or anticlockwise (or press **VOLUME +/-** on the remote) to increase or decrease the volume level.  
→ "VOL XX" is displayed on the display panel.  
"XX" denotes the volume level.

### To listen through the headphone

- Connect the headphone plug to the  socket at the front of the amplifier.  
→ The speakers will be muted.

### To switch off the volume temporarily

- Press **MUTE** on the remote.  
→ Playback will continue without sound and "MUTING" flashes.
- To activate sound reproduction, you can:
  - press **MUTE** again;
  - adjust the volume controls;
  - change source.

## Sound Control

**DBB, DSC and LOUDNESS sound features cannot be activated at the same time.**

### DBB (Dynamic Bass Boost)

DBB enhances the bass response.

- Press **DBB** on the remote to enable/disable DBB feature.  
→ Some discs might be recorded in high modulation, which causes a distortion at high volume. If this occurs, switch off DBB or reduce the volume.

### DSC (Digital Sound Control)

DSC provides a different type of preset sound equalizer setting.

- Press **DSC** on the remote repeatedly to select: CLASSIC, JAZZ, POP or ROCK.

### LOUDNESS

LOUDNESS feature enables the system to automatically increase the treble and bass sound effect at low volume (the higher the volume, the lower the treble and bass increase).

- Press **LOUDNESS** on the remote to enable or disable LOUDNESS feature.  
→  icon appears/disappears after this feature is enabled/disabled.

## Dimming the display screen

- In standby mode only, press **DIM** repeatedly to select different levels of brightness for the display screen.

# Disc Operations

## IMPORTANT!

- Depending on the DVD or VIDEO CD, some operations may be different or restricted.
- Do not push on the disc tray or put any objects other than disc on the disc tray. Doing so may cause the disc player malfunction.
- If the inhibit icon (⊘) appears on the TV screen when a button is pressed, it means the function is not available on the current disc or at the current time.

## Playable Discs

Your DVD Player will play:

- Digital Versatile Discs (DVDs)
- Video CDs (VCDs)
- Super Video CDs (SVCDs)
- Digital Versatile Discs + Recordable (DVD+R)
- Digital Versatile Discs + Rewritable (DVD+RW)
- Compact Discs (CDs)
- MP3 disc on CD-R(W):
  - Supported sampling frequencies: 8 kHz~48 kHz
  - Supported Bit-rates: 8~320 kbps, variable bitrates
- WMA-CDs (CD-ROMs with WMA tracks)
- Picture (JPEG) files on CD-R(W)



## Region Codes

DVDs must be labeled for ALL regions or Region 1 in order to play on this DVD system. You cannot play discs that are labeled for other regions.



Note:

- If you are having trouble playing a certain disc, remove the disc and try a different one. Improper formatted disc will not play on this DVD Player.

## Playing discs

- 1 Connect the power cords of the system and TV (or any optional stereo or AV receiver) to a power outlet.
- 2 Turn on the TV power and set to the correct Video In channel. (See "Setting up the TV").
- 3 Press **STANDBY-ON** (⏻) on the DVD Player front panel or (⏻) on the remote.  
→ You should see the blue Philips DVD background screen on the TV.
- 4 Press **OPEN-CLOSE** to open the disc tray and load in a disc, then press the same button again to close the disc tray.  
→ Make sure the label side is facing up.
- 5 Playback will start automatically (depending on the disc type).  
→ If a disc menu appears on the TV, see "Using the Disc Menu".  
→ If the disc is locked by parental control, you must enter your four-digit password. (See "Password Setup Page").
- 6 At any time, simply press **BAND/■** (or ■ on the remote) to stop playback.

## Using the Disc Menu

Depending on the disc, a menu may appear on the TV screen once you load the disc.

### To select a playback feature or item

- Use ◀ ▶ ▲ ▼ and **OK** or **Numeric Keypad (0-9)** on the remote.  
→ Playback will start automatically.

### To access or exit from the menu

- Press **DISC MENU** on the remote.

### For VCD with Playback Control (PBC) feature (version 2.0 only)

PBC playback allows you to play Video CDs interactively, following the menu on the display.

# Disc Operations

- During playback, press **DISC MENU**.  
→ If PBC was ON, it will switch to OFF and continue playback.  
→ If PBC was OFF, it will switch to ON and return to menu screen.

## Basic playback controls

### Pausing playback (DVD/VCD/CD/MP3/WMA)

- 1 During playback, press **PRESET/ ▶ II** (or **▶ II** on the remote).  
→ Playback will pause and sound will be muted.
- 2 Press **PRESET/ ▶ II** (or **▶ II** on the remote) again to resume.

### Selecting a track/chapter/title (DVD/VCD/CD)

- 1 Press the control knob to the right (corresponding to **▶▶▶**) or press **CH + ▶** on the remote during playback to go to the next chapter/track
- 2 Press the control knob to the left (corresponding to **◀◀◀**) or press **CH - ◀** on the remote to go to the previous chapter/track.
- 3 To go directly to any chapter/track/title, enter the chapter/track/title number using the **Numeric Keypad (0-9)**.

### Resuming playback from the last stopped point (DVD/VCD/CD/MP3/WMA)

- In stop mode and when a disc has not been removed, press **PRESET/ ▶ II** (or **▶ II** on the remote).

### To cancel resume mode

- In stop mode, press **BAND/■** (or **■** on the remote) again.

### Zoom (DVD/VCD/JPEG)

Zooming allows you to enlarge or reduce the video image during playback.

- 1 Press **ZOOM** repeatedly to enlarge or reduce the playback video image.
- 2 Press **◀ ▶ ▲ ▼** to pan across the TV screen.

### Repeat (DVD/VCD/CD/MP3/WMA)

#### For DVD/VCD/CD

- Press the control knob downward (corresponding to **REPEAT•STEREO**) or press **MODE** repeatedly to choose a repeat mode during playback.

#### CHAPTER (DVD)

- to repeat playback of the current chapter.

#### TRACK (CD/VCD)/TITLE (DVD)

- to repeat playback of the current track (CD/SVCD/VCD)/title (DVD).

#### ALL

- to repeat playback of all the disc.

#### SHUFFLE

- to repeat playback at random order.

#### For MP3/WMA

- Press the control knob downward (corresponding to **REPEAT•STEREO**) or press **MODE** continuously to access different repeat modes.  
→ **Shuffle**: play all files in the selected folder in random order.  
→ **Repeat One**: play an MP3/WMA file repeatedly.  
→ **Repeat All**: play all files repeatedly.  
→ **Off**: switches off the shuffle or repeat mode.

### Repeat A-B (DVD/VCD/CD/MP3/WMA)

- 1 Press **A-B** at your chosen starting point.
- 2 Press **A-B** again at your chosen end point.  
→ The section A and B can be set only within the same chapter/track.  
→ The section will now repeat continuously.
- 3 To exit the sequence, press **A-B** again.

### Slow Motion (DVD/VCD)

- 1 Press **SLOW** during playback to select the required speed: 1/2, 1/4, 1/8 or 1/16 (backward or forward).  
→ Sound will be muted.
- 2 To return to normal speed, press **PRESET/ ▶ II** (or **▶ II** on the remote).

#### Note:

- *Slow backward is not possible on VCDs.*

# Disc Operations

## Program (not for Picture CD)

To select favourite tracks/chapters for playback in preferred sequence.

### For DVD/VCD/CD

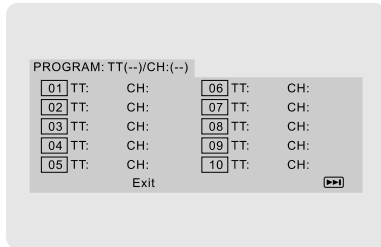

(DVD program for example)

- 1 Press the control knob upward (corresponding to **PROGRAM**) or press **PROG** on the remote to enter the program mode.
- 2 Use the **Numerical Keypad (0-9)** to directly input the tracks or chapters (single track number with digit "0" in front, for example "05").
- 3 Move the cursor by pressing ◀ ▶ ▲ ▼ to select **START**.
- 4 Press **OK** to start playback.

### For MP3/WMA

- 1 In Stop mode, press **PRESET/▶▶** (or **DISC MENU** on the remote) to switch the menu between Album and Filelist.
- 2 When Filelist is on the screen, press ▲ ▼ to select the files and press the control knob upward (corresponding to **PROGRAM**) or press **PROG** on the remote to add the files to the program list.
- 3 Press **DISC MENU** to display the program list.
- 4 Press the control knob upward (corresponding to **PROGRAM**) or press **PROG** on the remote to delete unwanted files from the program list.

## Forward/Reverse Searching (DVD/VCD/CD/MP3/WMA)

- 1 Press **TU +/- (◀▶▶)** during playback to select the required speed: 2X, 4X, 8X, 16X or 32X (backward or forward).

→ Sound will be muted.

- 2 To return to normal speed, press **PRESET/▶▶** (or ▶▶ on the remote).

## Time search & search by chapter/track number (DVD/VCD/CD/MP3/WMA)

- 1 Press **GOTO/ST** until the time or chapter/track edit box appears.
- 2 Enter hours, minutes and seconds from left to right in the time edit box using remote control numerical keypad.

### OR

Enter your desired chapter/track number in the chapter/track edit box using remote control numerical keypad.

## Information display during playback (not for Picture CD)

- 1 During playback, press **DISPLAY** to show disc information on the TV screen.

### For DVD

- **Title/Chapter Elapsed**: displays the elapsed time of the current title/chapter.
- **Title/Chapter Remain**: displays the remaining time of the current title/chapter.
- **Display Off**: switches time display off.

### For Super VCD/VCD/CD

- **Single/Total Elapsed**: displays the elapsed time of the current single/total track.
- **Single/Total Remain**: displays the remaining time of the current single/total track.
- **Display Off**: switches time display off.

## Special disc features

### Playing a Title (DVD)

- 1 Press **DISC MENU**.  
→ The disc title menu appears on the TV screen.
- 2 Use ◀ ▶ ▲ ▼ or **Numeric Keypad (0-9)** to select a play option.
- 3 Press **OK** to confirm.

## Camera Angle (DVD)

- Press **ANGLE** repeatedly to select different desired angle.

## Changing the Audio Language (for DVD recorded with multiple languages)

- Press **AUDIO** repeatedly to select different audio languages.

## Changing the Audio Channel (for VCD only)

- Press **AUDIO** to select the available audio channels provided by the disc (Mono Left, Mono Right or Stereo).

## Subtitles (DVD)

- Press **SUBTITLE** repeatedly to select different subtitle languages.

## Playing MP3/WMA/JPEG Picture CD

### IMPORTANT!

You have to turn on your TV and set to the correct Video In channel. (See “Setting up the TV”).

## Playing MP3/WMA disc

### IMPORTANT!

For DRM protected WMA files, use Windows Media Player 10 (or later) for CD burning/conversion. Visit [www.microsoft.com](http://www.microsoft.com) for details about Windows Media Player and WM DRM (Windows Media Digital Rights Management).

## General operation

- 1 Load an MP3/WMA disc.  
→ The data disc menu appears on the TV screen.
- 2 Use ▲ ▼ to select an album and press **OK** to open the album.

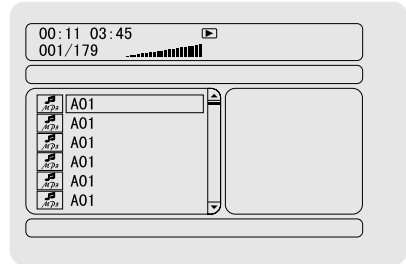

- 3 Press ▲ ▼ or use the **Numeric Keypad (0-9)** to highlight a track.
- 4 Press **OK** to confirm.  
→ The playback will start from the selected track to the end of the album.

### Note:

- The disc reading time may exceed 10 seconds due to large number of songs compiled onto the disc.

## Playback selection

During playback, you can:

- Press the control knob to the left/right (corresponding to ◀◀/▶▶) or press **CH +/-** (◀/▶) on the remote to select another track in the current album.
- Press **PRESET/▶II** (or ▶II on the remote) repeatedly to pause/resume playback.
- Press **DISC MENU** on the remote to switch between Album and Filelist.

## Playing JPEG Picture CD

### General operation

- 1 Load a JPEG Picture CD.  
→ The data disc menu appears on the TV screen.
- 2 Use ▲ ▼ to select a folder and press **OK** to open the folder.
- 3 Press ▲ ▼ or use the **Numeric Keypad (0-9)** to highlight a picture file.
- 4 Press **OK** to confirm.  
→ The playback will start from the selected picture to the end of the folder.

# Disc Operations

## Playback selection

During playback, you can:

- Press the control knob to the left/right (corresponding to ◀▶) or press **CH +/-** (◀▶) on the remote to select another file in the current folder.
- Use ◀▶ ▲ ▼ on the remote to rotate/flip the picture files.
- Press **PRESET/▶II** (or ▶II on the remote) repeatedly to pause/resume playback.
- Press **DISC MENU** on the remote to switch between Folder and Filelist.

## Special JPEG features

### Preview function (JPEG)

This function shows the content of the current folder or the whole disc.

- 1 Press **BAND/■** (or ■ on the remote) during playback.  
→ Thumbnails of 12 pictures appears on the TV screen.

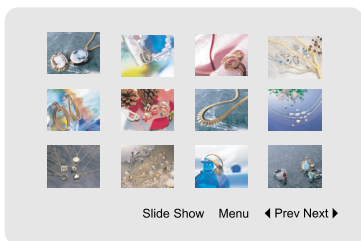

- 2 Use ◀▶ ▲ ▼ to highlight one of the pictures/ "Slide Show" and press **OK** to start playback/ slide show.

### To enter the remote key function menu

- Use ◀▶ ▲ ▼ to highlight "Menu" and press **OK**.

REMOTE KEY FUNCTION	
PROGRAM	TRANSITION EFFECT
STOP	THUMBNAIL MODE
▶▶	NEXT PICTURE
◀◀	PREVIOUS PICTURE
PLAY	PICTURE MODE
^	INVERT
v	MIRROR

**CONTINUE**

### To display the other pictures on the previous/next page

- Press the control knob to the left/right (corresponding to ◀▶) or press **CH +/-** (◀▶) on the remote.
- Use ◀▶ ▲ ▼ to highlight "Prev" or "Next" and press **OK**.

### Zoom picture (JPEG)

- During playback, press **ZOOM** repeatedly to display the picture with different scales.
- Use ◀▶ ▲ ▼ to view the zoomed picture.

### Slide show playback modes (JPEG)

- During playback, press the control knob upward (corresponding to **PROGRAM**) or press **PROG** on the remote repeatedly to select different slide-show playback modes:

- Mode 0: None
- Mode 1: Wipe Top
- Mode 2: Wipe Bottom
- Mode 3: Wipe Left
- Mode 4: Wipe Right
- Mode 5: Diagonal Wipe Left Top
- Mode 6: Diagonal Wipe Right Top
- Mode 7: Diagonal Wipe Left Bottom
- Mode 8: Diagonal Wipe Right Bottom
- Mode 9: Extend From Center H
- Mode 10: Extend From Center V
- Mode 11: Compress To Center H
- Mode 12: Compress To Center V
- Mode 13: Window H
- Mode 14: Window V
- Mode 15: Wipe From Edge To Center
- Mode 16: Move In From Top

### Playback with multi-angles (JPEG)

- During playback, press ◀▶ ▲ ▼ to rotate the picture on the TV screen.
  - ▲: flip the picture vertically.
  - ▼: flip the picture horizontally.
  - ◀: rotate the picture anti-clockwise.
  - ▶: rotate the picture clockwise.



## Basic operations

- 1 Press **SYSTEM** to enter the Setup Menu.
- 2 Press ◀ ▶ to select a page to be set.
- 3 Press ▲ ▼ to highlight an option.
- 4 Enter its submenu by pressing ▶ or **OK**.
- 5 Move the cursor by pressing ▲ ▼ to highlight the selected item.  
→ In cases of value setting, press ◀ ▶ to adjust values.
- 6 Press **OK** to confirm.

### To return to the upper-level menu

- Press ◀ or **OK** (in cases of value adjustment).

### To exit from the menu

- Press **SYSTEM** again.  
→ The settings will be stored in the player's memory even if the player is switched off.

#### Note:

– Some of the features in the System Menu Options are described in "Getting Started".

## General Setup Page

The options included in General Setup page are: "TV Display", "OSD Language", "Closed Captions" and "Screen Saver".

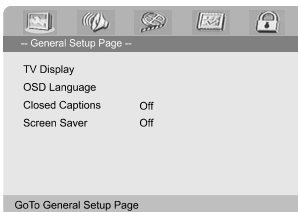

## TV Display

Set the aspect ratio of the DVD Player according to the TV you have connected.

→ **Normal/PS** (panscan): If you have a normal TV and want both sides of the picture to be trimmed or formatted to fit your TV screen.

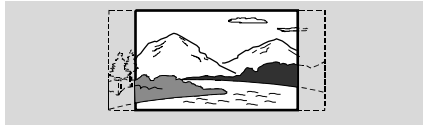

→ **Normal/LB** (letterbox): If you have a normal TV. In this case, a wider picture with black bands on the upper and lower portions of the TV screen will be displayed.



→ **Wide**: If you have a wide-screen TV.

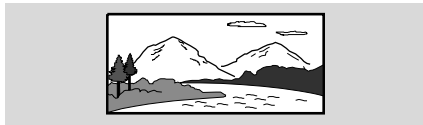

## Closed Captions

Closed captions are data that are hidden in the video signal of some discs. Captions are different from subtitles because captions hearing are impaired by showing the sound effects (e.g. "phone ringing" and "footsteps"), while subtitles do not.

Before you select this function, please ensure that the disc contains closed captions information and your TV set also has this function.

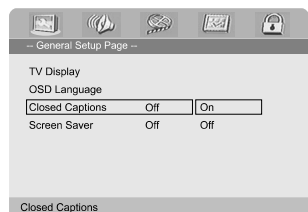

- 1 Press ▲ ▼ to highlight 'Closed Captions'.

# System Menu Options

- 2 Enter its submenu by pressing ►.
- 3 Move the cursor by pressing ▲ ▼ to highlight the selected item.
  - **On**: Enable Closed Captions.
  - **Off**: Disable Closed Captions.

## Screen Saver

This function is used to turn the screen saver on or off.

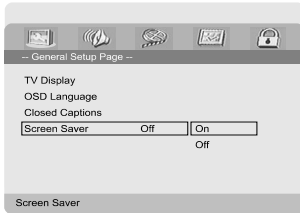

- **On**: In STOP, PAUSE or No DISC mode, if no actions are performed about 3 minutes, the screen saver will be activated.
- **Off**: Screen saver is disabled.

## Audio Setup Page

The options included in Audio Setup page are: "SPDIF Setup", "Dolby Digital Setup", "3D Processing", "HDCCD" and "D.R.C".

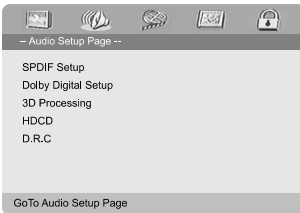

## SPDIF Setup

The options included in SPDIF (Sony/Phillips Digital Interface Format) Setup Page are: "SPDIF Off", "SPDIF/RAW" and "SPDIF/PCM".

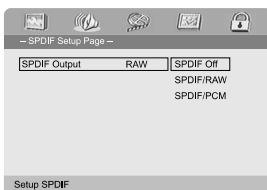

- **SPDIF Off**: Turns off the SPDIF output.
- **SPDIF/RAW**: If you have connected your DIGITAL OUT (COAXIAL or OPTICAL)
- **SPDIF/PCM**: Only if your receiver is not capable of decoding multi-channel audio.

## Dolby Digital Setup

The options included in Digital Audio Setup are: "Dual Mono" and "Dynamic".

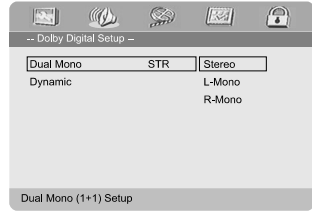

## Dual Mono

Select the setting that matches the number of speakers you have connected.

- **Stereo**: Left mono sound will send output signals to Left speaker and Right mono sound will send output signals to Right speaker.
- **L-Mono**: Left mono sound will send output signals to Left speaker and Right speaker.
- **R-Mono**: Right mono sound will send output signals to Left speaker and Right speaker.

## Dynamic

Optimise the dynamic sound output. High volume outputs are softened, enabling you to watch your favourite movie without disturbing others.

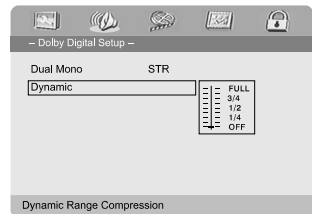

- The levels for dynamic selection: FULL, 3/4, 1/2, 1/4 and OFF.

### Note:

– DTS surround audio output is not available in this DVD player.

## 3D Processing

The option included in 3D Processing is: "Reverb Mode".

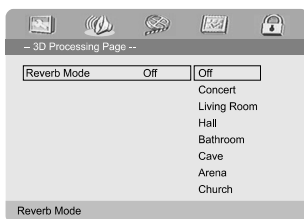

### Reverb Mode

Reverb mode provides a virtual surround sound experience using just two speakers.

→ **Off, Concert, Living Room, Hall, Bathroom, Cave, Arena and Church.**

## HDCD

The option included in HDCD (High Definition Compatible Digital) is: "Filter".

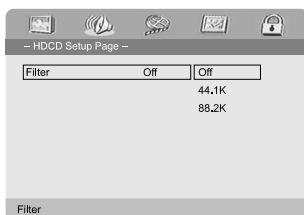

### Filter

Sets the audio output cutoff frequency point when playing an HDCD disc.

→ **Off, 44.1K and 88.2K.**

## D.R.C

Switches on/off analogue sound dynamic range compression.

→ **On:** Audio with fully compressed dynamic range.

→ **Off:** Audio with uncompressed dynamic range.

## Video Setup Page

The options included in Video Setup page are: "Component", "TV Mode" and "Quality".

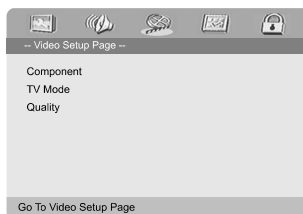

### Component

Sets the video output according to your video connection. This setting is not required if you are using the **VIDEO OUTPUT** jack (yellow) to connect the DVD micro system to your TV.

→ **Ypbpr:** Select this if you have connected the DVD micro system to your TV using Component video jacks.

→ **S-Video:** Select this if you have connected the DVD micro system to your TV using S-Video jack.

### TV Mode

Selects interlace or P-SCAN video output mode when **Ypbpr** is selected.

→ **P-SCAN and Interlace.**

#### Note:

– *P-SCAN is only applicable when you have connected this DVD system to a Progressive Scan TV through the Y Pb/Cb Pr/Cr jacks.*

### Quality

This menu helps you to set the video quality.

- 1 Press ▲ ▼ to highlight "Quality".
- 2 Press ► or **OK** to enter Video Quality Setup.

The options included in Video Quality Setup page are: "Sharpness", "Brightness", "Contrast", "Gamma", "Hue", "Saturation" and "Luma Delay".

# System Menu Options

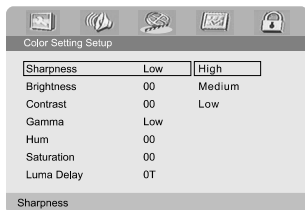

## Sharpness

Adjusts the sharpness level.

→ **High, Medium** and **Low**.

## Brightness

Adjusts the brightness level. Range: -20-+20.

## Contrast

Adjusts the contrast level. Range: -16-+16.

## Gamma

Adjusts the gamma level.

→ **High, Medium, Low** and **None**.

## Hue

Adjusts the hue level. Range: -9-+9.

## Saturation

Adjusts the saturation level. Range: -9-+9.

## Luma Delay

Adjusts the luma delay.

→ **0T** and **1T**.

## Preference Page

The options included in Preference page are: "Audio", "Subtitle", "Disc Menu", "Parental" and "Default".

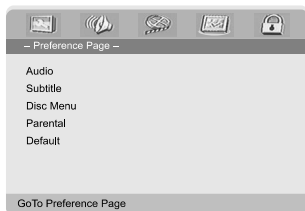

### Note:

– Preference features can be selected only during "No Disc" condition or full STOP mode.

## Parental

Some DVDs may have a parental level assigned to the complete disc or to certain scenes on the disc. This feature lets you set a playback limitation level.

The rating levels are from 1 to 8 and are country dependent. You can prohibit the playing of certain discs that are not suitable for your children or have certain discs played with alternative scenes.

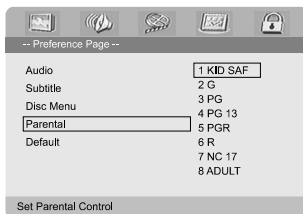

- VCD, SVCD and CD have no level indication, so parental control function has no effect on those kinds of discs. This applies to most illegal DVD discs.

- 1 Press ▲ ▼ to highlight "Parental".
- 2 Enter its submenu by pressing ►.
- 3 Use ▲ ▼ to highlight a rating level for the disc inserted.

→ DVDs that are rated above the level you selected will not play unless you enter your four-digit password and choose a higher level rating.

### Note:

– Some DVDs are not encoded with a rating though the movie rating may be printed on the Disc cover. The rating level feature does not work for such Discs.

## Rating explanations

### 1 KID SAF

– Kids material; recommended especially for children and viewers of all ages.

### 2 G

– General Audience; recommended as acceptable for viewers of all ages.

### 3 PG

– Parental Guidance suggested.

4 PG 13

- Material is unsuitable for children under age 13.

5-6 PGR, R

- Parental Guidance - Restricted; recommended that parents restrict children under 17 from viewing or allow to view only when supervised by a parent or adult guardian.

7 NC-17

- No children under age 17; not recommended viewing for children under age 17.

8 Adult

- Mature materials; should be viewed only by adults due to graphic sexual material, violence or language.

## Default

Setting the “Default” function will reset all options and your personal settings to the factory defaults and all your personal settings will be erased.

### Caution!

- **When this function is activated, all settings will be reset to factory defaults.**

## Password Setup Page

The options included in Password Setup page are: “Password Mode” and “Password”.

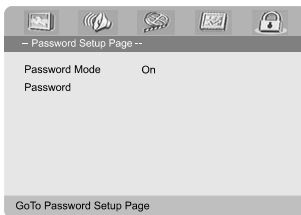

## Password Mode

This feature is used to enable/disable password by selecting “ON”/“OFF”.

## Password

Enter your four digit password when a hint is displayed on the screen. The default password is 1234.

- 1 Press ▲ ▼ to highlight “Password”.
- 2 Enter its submenu by pressing ►.
- 3 Press **OK** to open the page for inputting a new password.



- 4 Enter the existing 4-digit code.
- 5 Enter the new 4-digit code.
- 6 Enter the new 4-digit code a second time to confirm.
  - The new 4-digit code will take effect.
- 7 Press **OK** to exit.

### Notes:

- *If the password has been changed, the parental and disc lock code will also be changed.*
- *The default password (1234) is always active even the password has been changed.*

# Other Functions

## Radio Reception

### Tuning to radio stations

- 1 Press **STANDBY ON** (or  $\odot$  on the remote) to switch on the last selected source.
- 2 Press **SOURCE** (or **TUNER** on the remote) to select TUNER mode.
- 3 Press **BAND/■** (or **TUNER** on the remote) again to select the desired band: FM or AM.
- 4 Press and hold the control knob to the left/right (corresponding to  $\blacktriangleleft/\blacktriangleright$ ) or **TU +/-**  $\blacktriangleleft$   $\blacktriangleright$  on the remote until the frequency indication starts to change, then release.  
→ The system automatically tunes to the next strong radio station.
- To tune to a weak station, press the control knob to the left/right (corresponding to  $\blacktriangleleft/\blacktriangleright$ ) or **TU +/-**  $\blacktriangleleft$   $\blacktriangleright$  on the remote briefly and repeatedly until an optimal reception is found.
- 5 Repeat Step 4 if necessary until you find the desired radio station.

### Presetting radio stations

You can preset up to 40 stations (20 in each band) regardless of the reception.

- 1 Tune to your desired radio station (refer to "Tuning to radio stations").
- 2 Press the control knob upward (corresponding to **PROGRAM**) or press **PROG** on the remote.  
→ "PROG" icon flashes.
- 3 Press **CH +/-** ( $\blacktriangleleft/\blacktriangleright$ ) or use the **Numeric Keypad (0-9)** on the remote to select the desired preset number.  
→ If "PROG" icon goes off before you select the desired preset number, press the control knob upward (corresponding to **PROGRAM**) or press **PROG** on the remote.
- 4 Press the control knob upward (corresponding to **PROGRAM**) or press **PROG** on the remote again to store the radio station.
- Repeat steps 1-4 to store other radio stations.

### Listening to preset radio stations

- In tuner mode, press **PRESET/▶||** (or **CH +/-** ( $\blacktriangleleft/\blacktriangleright$ )) on the remote) or use the **Numeric Keypad (0-9)** to select the desired preset number.  
→ The preset number, radio frequency, and waveband are displayed.

## Setting the clock

- 1 In Standby mode, press and hold **CLOCK** on the remote until the time flashes on the display.  
→ "CLOCK SET" is displayed briefly. Then, the hour digits flash on the display screen.
- 2 Turn **VOLUME +/-** clockwise or anticlockwise or press **VOLUME +/-** on the remote to set the hours.
- 3 Press **CLOCK** to confirm.  
→ The minute digits flash on the display screen.
- 4 Turn **VOLUME +/-** clockwise or anticlockwise or press **VOLUME +/-** on the remote to set the minutes.
- 5 Press **CLOCK** again to confirm the clock setting.

### Notes:

- This system only supports 24-hour mode.
- The clock setting will be erased when the system is disconnected from the power supply.
- The system will exit clock setting mode if no button is pressed within 30 seconds.

## Setting sleep/wake-up timer

### Sleep timer setting

In power-on mode, the sleep setting enables the system to switch to standby mode automatically at a preset time.

- 1 In power-on mode, press **SLEEP/TIMER** on the remote repeatedly to select a preset time.  
→ The selections are as follows (time in minutes):  
00 → 10 → 20 → 30 → 40 → 50 → 60 → 70 → 80 → 90 → 00
- 2 When you reach the desired length of time, stop pressing **SLEEP/TIMER**.  
→ "SLEEP" appears.

**To deactivate the sleep timer**

- Press **SLEEP/TIMER** repeatedly until "00" is displayed, or press **STANDBY ON** (⏻) (⏻ on the remote).

**In standby mode**, the timer setting enables the system to switch on automatically at a set time.

**Wake-up timer setting****IMPORTANT!**

– **Before setting the timer, ensure that the clock is set correctly.**

- 1 Press and hold **SLEEP/TIMER** until the time flashes on the display.  
→ "TIME SET" is displayed briefly. Then, the hour digits flash on the display screen.
- 2 Turn **VOLUME +/-** clockwise or anticlockwise or press **VOLUME +/-** on the remote to set the hours.
- 3 Press **SLEEP/TIMER** to confirm.  
→ The minute digits flash on the display screen.
- 4 Turn **VOLUME +/-** clockwise or anticlockwise or press **VOLUME +/-** on the remote to set the minutes.
- 5 Press **SLEEP/TIMER** to confirm the time setting.  
→ "OFF" flashes on the display screen.
- 6 Turn **VOLUME +/-** clockwise or anticlockwise or press **VOLUME +/-** on the remote to select "ON".  
→ ⏻ icon appears on the display screen.

**To deactivate the timer**

- Select "OFF" at Step 6.

# Specifications

## SYSTEM

AC Power ..... 120 V / 60 Hz  
Rated working power consumption (1/8 rated output power) .....  $\leq 32\text{W}$   
AUX input sensitivity .....  $\leq 350\text{mV}$   
Channel Separation .....  $\geq 40\text{dB}$   
Distortion ..... 0.7%

## DVD

Frequency response ..... 100Hz-20kHz ( $\pm 1\text{dB}$ )  
Video output .....  $1\text{V}_{\text{p-p}}$   
Video system ..... NTSC  
Horizontal definition .....  $\geq 500$  (TV)  
Dimensions 208 (W)  $\times$  61.7 (H)  $\times$  244 (D) mm  
..... 8.2"  $\times$  2.4"  $\times$  9.6" (inch)  
Weight ..... 1.4 kg/3.1 pounds

## AMPLIFIER

Rated output power (THD = 10%) .....  
.....  $22\text{W} \times 2$  ( $8\Omega$  1kHz)  
Frequency response ..... 100Hz-20kHz ( $\pm 1\text{dB}$ )  
S/N Ratio .....  $\geq 60\text{dB}$   
Loaded impedance .....  $8\Omega$   
Dimensions 208 (W)  $\times$  56.9 (H)  $\times$  244 (D) mm  
..... 8.2"  $\times$  2.2"  $\times$  9.6" (inch)  
Weight ..... 2.4 kg/5.3 pounds

## TUNER

FM Frequency range ..... 87.5-108 MHz  
FM Noise limit sensitivity .....  $\leq 20\mu\text{V/M}$   
FM S/N .....  $\geq 46\text{dB}$   
AM wave range ..... 520 - 1710 kHz  
AM Noise limit sensitivity .....  $\leq 3.0\mu\text{V/m}$   
AM S/N .....  $\geq 40\text{dB}$

## SPEAKER

Impedance .....  $8\Omega$   
Input power ..... 35W  
Sensitivity .....  $80 \pm 4\text{dB}$   
Frequency response ..... 80Hz-16kHz  
Dimensions . 145 (W)  $\times$  230 (H)  $\times$  210 (D) mm  
..... 5.7"  $\times$  9.1"  $\times$  8.3" (inch)  
Weight ..... 2.4 kg each/5.3 pounds each

## REMOTE

Distance ..... 6 m  
..... 19.7 feet  
Angle .....  $\pm 30^\circ$





**Specifications and external appearance are subject to change without notice.**

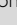
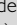

## WARNING

**Under no circumstances should you try to repair the system yourself, as this will invalidate the warranty. Do not open the system as there is a risk of electric shock.**

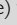
**If a fault occurs, first check the points listed below before taking the system for repair. If you are unable to remedy a problem by following these hints, consult your dealer or Philips for help.**

Problem	Solution
<b>No power.</b>	<ul style="list-style-type: none"> <li>✓ Check if the AC power cord is properly connected.</li> <li>✓ Press STANDBY ON  on the top of the DVD micro system or  on the remote to turn on the power.</li> </ul>
<b>No picture.</b>	<ul style="list-style-type: none"> <li>✓ Check if the TV is switched on.</li> <li>✓ Check the video connection.</li> <li>✓ Press SOURCE on the top of the DVD player repeatedly to select "DVD" or press DISC on the remote.</li> <li>✓ Set your TV to the correct Video In channel. This channel is usually near channel 00. Or, you may have a button on the TV remote control that selects Auxiliary or A/V IN channel. See your TV owner's manual for details. Or, change channels at the TV until you see DVD screen on the TV.</li> <li>✓ Press DISC on the remote to exit progressive scan.</li> </ul>
<b>Distorted or poor picture.</b>	<ul style="list-style-type: none"> <li>✓ Sometimes a small amount of picture distortion may appear. This is not a malfunction.</li> <li>✓ Clean the disc.</li> </ul>
<b>Completely distorted picture or black/white picture.</b>	<ul style="list-style-type: none"> <li>✓ TV has a colour system standard. If the disc's or DVD system's colour system is different than your TV's colour system, the picture may be distorted or colourless.</li> </ul>
<b>The aspect ratio of the screen cannot be changed even though you have set the TV shape.</b>	<ul style="list-style-type: none"> <li>✓ The aspect ratio is fixed on the DVD disc.</li> <li>✓ Depending on the TV, it may not be possible to change the aspect ratio.</li> </ul>
<b>No sound or distorted sound.</b>	<ul style="list-style-type: none"> <li>✓ Adjust the volume.</li> <li>✓ Check that the speakers are connected correctly.</li> <li>✓ Replace the speaker cables.</li> <li>✓ Disconnect the headphones.</li> <li>✓ The system is in pause, slow motion or fast forward/reverse mode, press PRESET/   (or   on the remote) to resume normal play mode.</li> </ul>

**The micro DVD player does not start playback.**

**The DVD micro system does not respond when the buttons are pressed.**

**Cannot activate some features, such as Angles, Subtitles, or multi-language Audio.**

**Considerable noise in radio broadcasts.**

**Sound cannot be heard or is of poor quality.**

**The remote control does not function.**

**The display is dark.**

**Low hum or buzz sound.**

**Low bass response.**

- ✓ Insert a readable disc with the playback side facing down.
- ✓ Check the disc type, colour system and regional code. Check for any scratches or smudges on the disc.
- ✓ Press SYSTEM MENU to turn off the setup menu screen.
- ✓ Cancel the parental control rating function or change the rating level.
- ✓ Moisture has condensed inside the system. Remove the disc and leave the system turned on for about an hour.
- ✓ Disconnect the power plug from the outlet and insert again.
- ✓ Multi-language sound or subtitle is not recorded on the DVD.
- ✓ Changing the language for the sound or subtitle is prohibited on the DVD.
- ✓ The features may not be available on the disc.
- ✓ Tune in to the correct frequency.
- ✓ Connect the antennas.
- ✓ Fully extend the FM wire antenna. Position for best reception and secure to a wall.
- ✓ Connect an outdoor FM or MW antenna.
- ✓ Adjust the direction and position for best reception.
- ✓ Place the antenna farther away from any equipment that may be causing the noise.
- ✓ Increase the distance between the system and your TV or other equipment.
- ✓ Select the correct source (DISC or TUNER, for example) before pressing the function button.
- ✓ Point the remote control at the remote sensor of the unit.
- ✓ Reduce the distance to the player.
- ✓ Remove any possible obstacles.
- ✓ Replace the batteries with new ones.
- ✓ Check that the batteries are loaded correctly.
- ✓ Press DIM again.
- ✓ Place the DVD micro system as far away as possible from electrical devices that may be causing interference.
- ✓ Check all speakers for correct polarity.

**Analog:** Sound that has not been turned into numbers. Analog sound varies, while digital sound has specific numerical values. These jacks send audio through two channels, the left and right.

**Aspect ratio:** The ratio of vertical and horizontal sizes of a displayed image. The horizontal vs. vertical ratio of conventional TVs is 4:3, and that of wide-screens is 16:9.

**AUDIO OUT jacks:** Jacks on the back of the DVD System that send audio to another system (TV set, Stereo, etc.).

**Bit Rate:** The amount of data used to hold a given length of music; measured in kilobits per second, or kbps. Or, the speed at which you record. Generally, the higher the bit rate the better the sound quality. However, higher bit rates use more space on a Disc.

**Chapter:** Sections of a picture or a music piece on a DVD that are smaller than titles. A title is composed of several chapters. Each chapter is assigned a chapter number enabling you to locate the chapter you want.

**Component Video Out Jacks:** Jacks on the back of the DVD System that send high-quality video to a TV set that has Component Video In jacks (R/G/B, Y/Pb/Pr, etc.).

**Disc menu:** A screen display prepared for the selection of images, sound, subtitles, multi-angles, etc recorded on a DVD.

**Digital:** Sound that has been converted into numerical values. Digital sound is available when you use the DIGITAL AUDIO OUT COAXIAL or OPTICAL jacks. These jacks send audio through multiple channels, instead of just two channels as analog does.

**Dolby Digital:** A surround sound system developed by Dolby Laboratories containing up to six channels of digital audio (front left and right, surround left and right and center).

**DTS:** Digital Theater Systems. This is a surround sound system, but different from Dolby Digital. The formats were developed by different companies.

**JPEG:** A still-picture data compression system proposed by the Joint Photographic Expert Group, which features small decrease in image quality in spite of its high compression ratio.

**MP3:** A file format with a sound data compression system, "MPE" is the abbreviation of Motion Picture Experts Group 1 (or MPEG-1) Audio Layer 3. Through the MP3 format, one CD-R or CD-RW can contain about 10 times as much data volume as a regular CD can.

**Multichannel:** DVD is specified to have all sound tracks constitute one sound field. Multichannel refers to a structure of sound tracks having three or more channels.

**Parental control:** A function of the DVD to limit playback of the disc by the age of the users according to the limitation level in each country. The limitation varies from disc to disc; when it is activated, playback will be prohibited if the software's level is higher than the user-set level.

**PCM (Pulse Code Modulation):** A system for converting analog sound signal to digital signal for later processing without data compression.

**Playback control (PBC):** Refers to the signal recorded on video CDs or SVCDs for reproduction control. By using screen menus recorded on a Video CD or SVCD that supports PBC, you can enjoy interactive-type software as well as software having a search function.

**Progressive Scan (P-Scan):** It displays all the horizontal lines of a picture at one time, as a signal frame. This system can convert interlaced video from DVD into progressive format for connection to a progressive display. It dramatically increases the vertical resolution. A progressive scan TV set is needed to receive progressive scan output from the system.

**Region code:** A system allowing discs to be played only in preset regions. This unit will only play discs that have compatible region codes. You can find the region code of your unit from the product label. Some discs are compatible with more than one region (or ALL regions).

**S-Video:** Produces a clear picture by sending separate signals for luminance and the color. You can use S-Video only if your TV set has S-Video In jack.

**Sampling Frequency:** Frequency of data sampling when analog data is converted to digital data. Sampling frequency numerically represents how many times the original analog signal is sampled per second.

**Surround:** A system for users to create realistic three-dimensional sound fields full of realism by arranging multiple speakers around the listener.

**Title:** The longest section of a picture or music feature on DVD, music, etc., in video software, or the entire album in audio software. Each title is assigned a title number enabling you to locate the title you want.

**VIDEO OUT jack:** Jack on the back of the DVD System that sends video to TV.

# PHILIPS LIMITED WARRANTY

## One (1) Year Labor and Parts Repair

**PHILIPS CONSUMER ELECTRONICS** warrants this product against defect in material or workmanship, subject to any conditions set forth as follows:

### PROOF OF PURCHASE:

You must have proof of the date of purchase to receive warranted repair on the product. A sales receipt or other document showing the product and the date that you purchased the product as well as the authorized retailer included, is considered such proof.

### COVERAGE:

(If this product is determined to be defective)

**LABOR:** For a period of one (1) year from the date of purchase, Philips will repair or replace the product, at its option, at no charge, or pay the labor charges to any Philips authorized repair facility. After the period of one (1) year, Philips will no longer be responsible for charges incurred.

**PARTS:** For a period of one (1) year from the date of purchase, Philips will supply, at no charge, new or rebuilt replacement parts in exchange for defective parts, through a Philips authorized service center.

Note: If Philips is unable to provide service in your area, receipt of the paid service can be submitted for consideration of adjustment or full reimbursement at Philips discretion.

### EXCLUDED FROM WARRANTY COVERAGE

Your warranty does not cover:

- Labor charges for installation or setup of the product, adjustment of customer controls on the product, and installation or repair of antenna systems outside of the product.
- Product repair and/or part replacement because of improper installation, connections to improper voltage supply, abuse, neglect, misuse, accident, unauthorized repair or other cause not within the control of Philips.
- A product that requires modification or adaptation to enable it to operate in any country other than the country for which it was designed, manufactured, approved and/or authorized, or repair of products damaged by these modifications.
- Damage occurring to product during shipping when improperly packaged or cost associated with packaging.
- Product lost in shipment and no signature verification of receipt can be provided.
- A product used for commercial or institutional purposes (including but not limited to rental purposes).
- Products sold AS IS or RENEWED.

### CARRY-IN / SHIP-IN WARRANTY

For Carry-In warranty repair, take the product to a Philips authorized service center for repair. When the product has been repaired, you must pick up the unit at the center.

For Ship-In warranty repair, ship the product to a Philips authorized service center for repair in its original carton and packing material. If you do not have the original carton or packing material, have your product professionally packed for shipping. Ship product via a traceable carrier. When it is necessary for you to ship the product to Philips for repair, you will pay the shipping cost for shipment to Philips. Philips will pay the shipping costs when returning the product to you.

### TO OBTAIN WARRANTY SERVICE IN THE U.S.A., PUERTO RICO, OR U.S. VIRGIN ISLANDS...

Contact Philips Customer Care Center at:  
1-888-PHILIPS (1-888-744-5477)

### TO OBTAIN WARRANTY SERVICE IN CANADA...

1-800-661-6162 (French Speaking)  
1-888-PHILIPS (1-888-744-5477) - (English or Spanish Speaking)

REPAIR OR REPLACEMENT AS PROVIDED UNDER THIS WARRANTY IS THE EXCLUSIVE REMEDY FOR THE CONSUMER. PHILIPS SHALL NOT BE LIABLE FOR ANY INCIDENTAL OR CONSEQUENTIAL DAMAGES FOR BREACH OF ANY EXPRESS OR IMPLIED WARRANTY ON THIS PRODUCT. EXCEPT TO THE EXTENT PROHIBITED BY APPLICABLE LAW, ANY IMPLIED WARRANTY OF MERCHANTABILITY OR FITNESS FOR A PARTICULAR PURPOSE ON THIS PRODUCT IS LIMITED IN DURATION TO THE DURATION OF THIS WARRANTY.

Some states do not allow the exclusions or limitation of incidental or consequential damages, or allow limitations on how long an implied warranty lasts, so the above limitations or exclusions may not apply to you. In addition, if you enter into a service contract agreement with the PHILIPS partnership within ninety (90) days of the date of sale, the limitation on how long an implied warranty lasts does not apply.

*This warranty gives you specific legal rights. You may have other rights which vary from state/province to state/province.*

**Philips, P.O. Box 671539, Marietta, GA. 30006-0026**

(Warranty: 4835 710 27175)