

## English

### Overview of parts

These are the supplied parts needed to connect and install this unit.

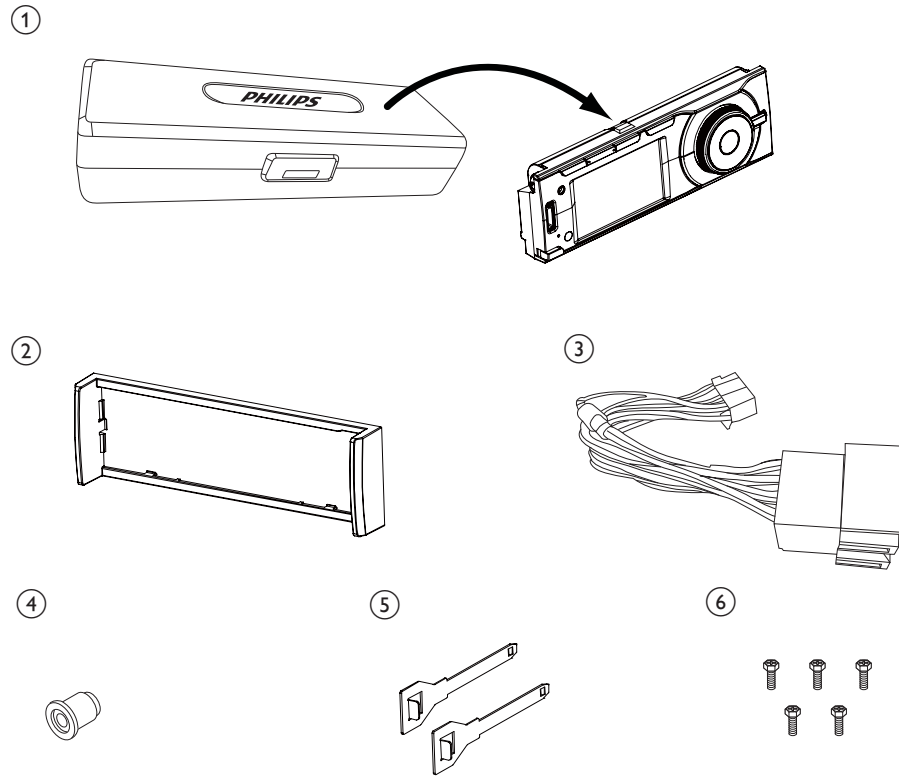

- 1 Carry case with front panel stored inside
- 2 Trim plate
- 3 Standard connector
- 4 Rubber cushion
- 5 Removal keys x 2 pcs
- 6 Screw x 5 pcs

### Connect wires: ISO connectors

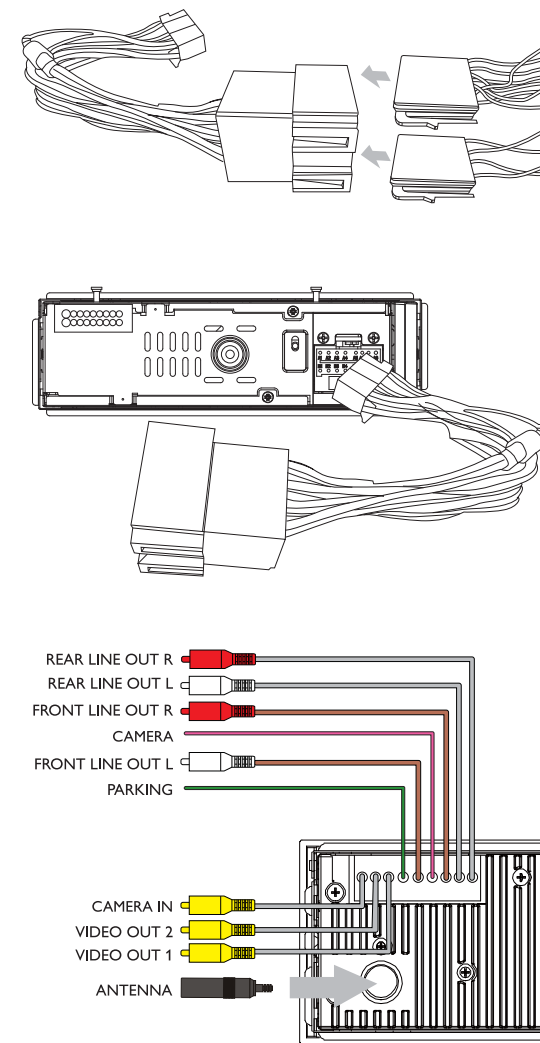

- 1 Pull out the ISO connectors from the car dashboard and connect them to the bigger end of the supplied standard connector.
- 2 Connect the other end of supplied standard connector to the unit.
- 3 Do the other connections, if applicable.

### Connect wires: without ISO connectors

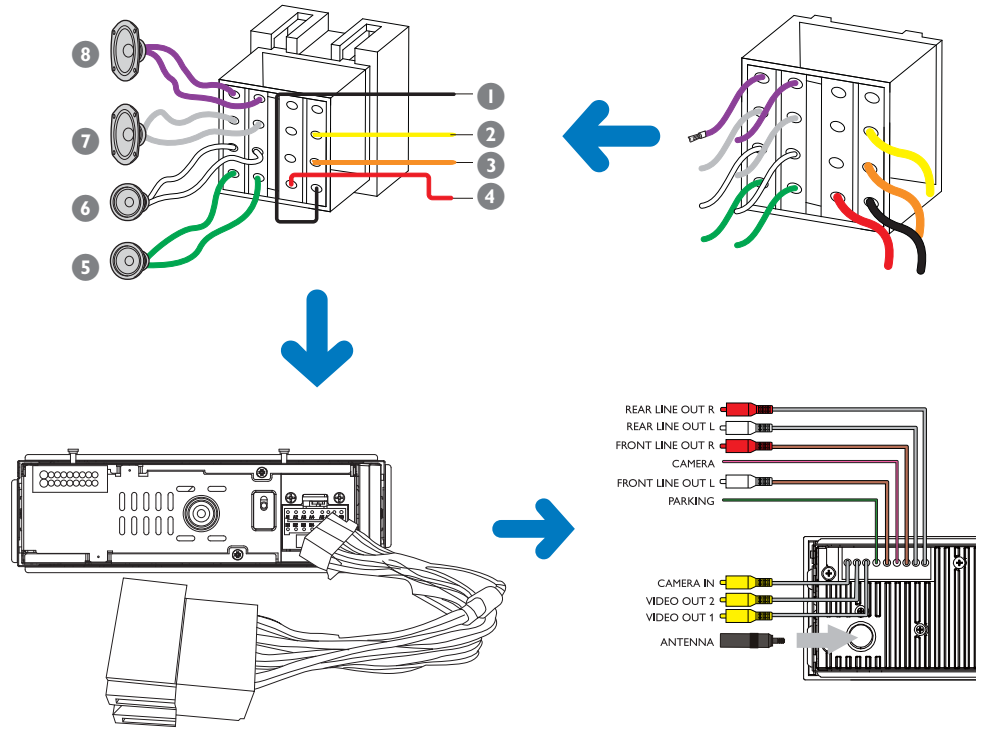

- 1 Cut off the bigger end of the supplied standard connector.
- 2 Check the car's wiring carefully, then connect them to the standard connector.

Connector	Connect to
1 Black wire	A metal surface of the car First connect the black ground (earth) lead, then connect the yellow and red power supply leads.
2 Yellow wire	The +12V car battery which is live at all times.
3 Orange/white wire	Illumination switch
4 Red wire	The +12V power terminal which is live in the accessory (ACC) position of the ignition switch If there is no accessory position, connect to the +12V car battery terminal that is always live. Be sure to connect the black ground (earth) lead to a metal surface of the car first.
5 Green and green/black wires	Left speaker (Rear)
6 White and white/black wires	Left speaker (Front)
7 Gray and gray/black wires	Right speaker (Front)
8 Purple and purple/black wires	Right speaker (Rear)

- 3 Connect the supplied standard connector to the unit.
- 4 Do the other connections, if applicable.

### Connect parking brake cable

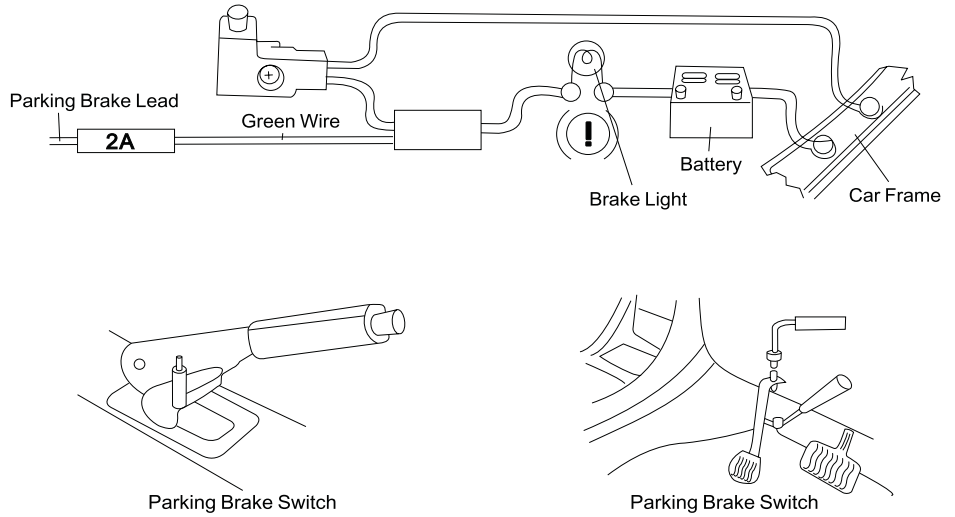

### Connect reverse driving cable

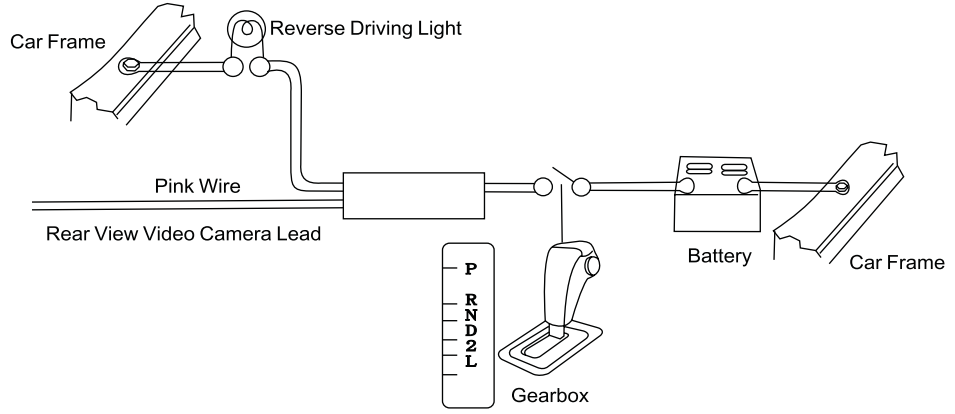

## Attach the front panel

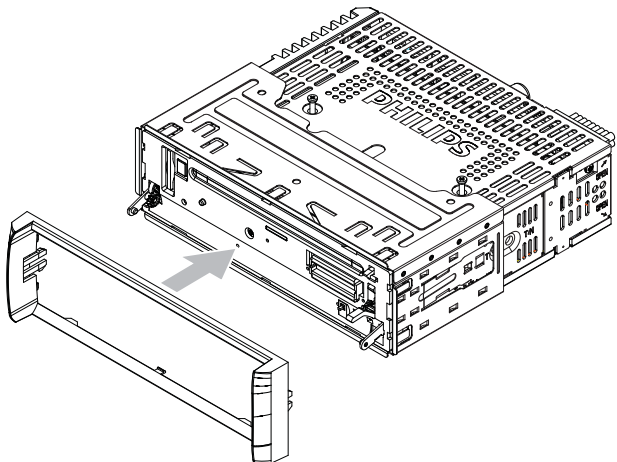

- 1 Attach the trim plate.

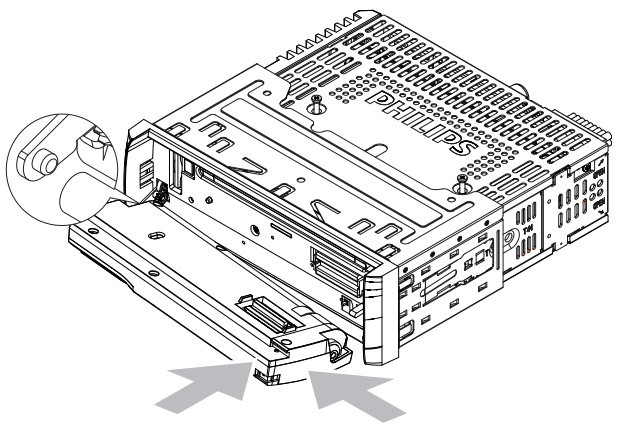

- 2 Insert the left side of the panel in the chassis until it is correctly engaged.

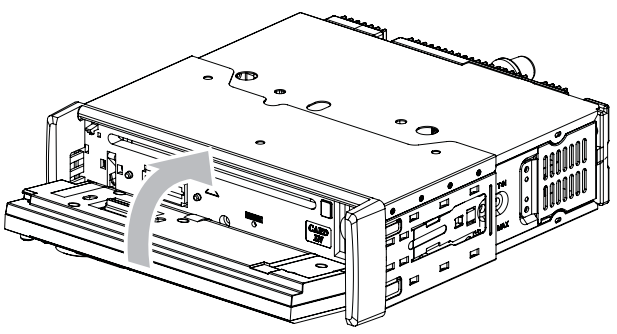

- 3 Press the right side of the panel until the mechanism locks it into place.

- 4 Close the front panel.

## Mount in the dashboard

### Note

- For proper operation of the DVD player, the chassis must be mounted within 20 degree horizontal. Ensure that the unit is mounted within this limitation.
- Check wire connection before you mount the unit into a car.
- If preset radio stations are lost when the ignition key is turned **OFF** and then back **ON**, reconnect the red leads crosswise to the yellow ones.

- 1 If the car does not have an on-board drive or navigation computer, disconnect the negative terminal of the car battery.
  - If you disconnect the car battery in a car that has an on-board drive or navigation computer, the computer may lost its memory.
  - If the car battery is not disconnected, to avoid short-circuit, ensure that bare wires do not touch each other.

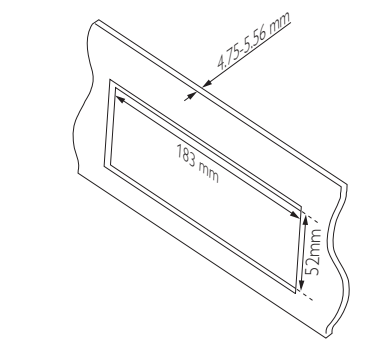

- 2 Ensure that car dashboard opening is within these measurements.

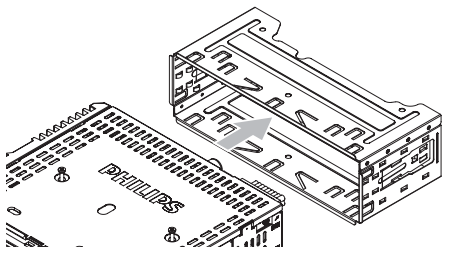

- 3 Remove the two transport screws on the top of the unit.
- 4 Remove the mounting sleeve with the removal keys.

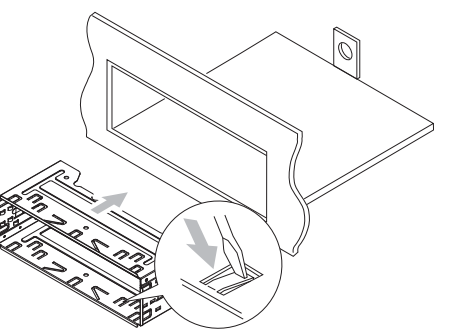

- 5 Install the sleeve into the dashboard and bend the tabs outward to fix the sleeve.
  - If the unit is not fixed by sleeve but by the supplied screws, skip this step.

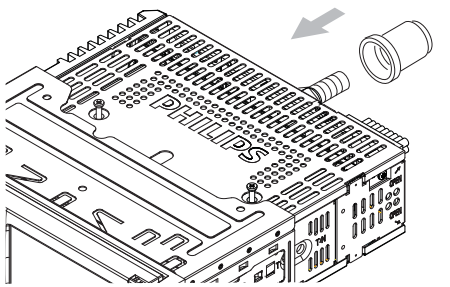

- 6 Place the rubber cushion over the end of the bolt.

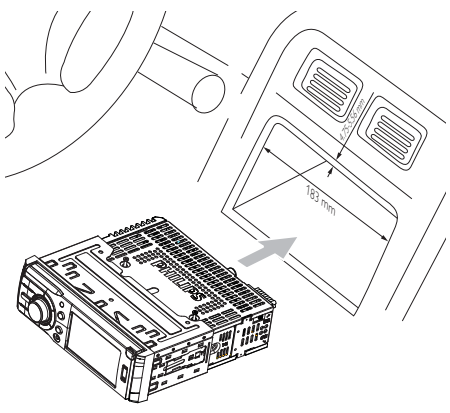

- 7 Slide the unit into the dashboard until a click sound is heard.

- 8 Reconnect the negative terminal of the car battery.

## Detach the front panel

The front panel can be detached and taken with you to deter theft.

### Note

- Before installing the unit, detach the front panel.

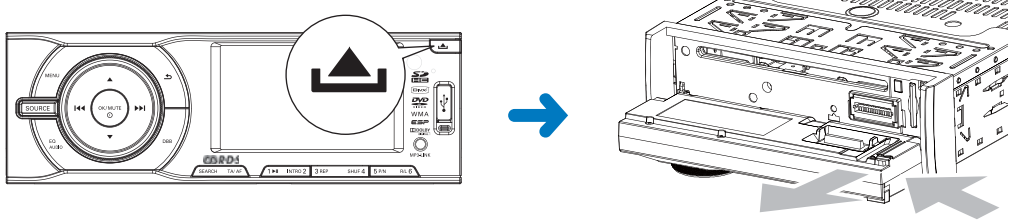

- 1 Press to release the panel.
- 2 Open the panel, then push the right side panel toward the left side to disengage it from the chassis.
- 3 Take off the panel and store it in the supplied carry case to protect it from dirt or damage.

## Turn on

- 1 Press the knob to turn on the unit.
  - ↳ The unit plays the last listened program: DVD, Tuner, USB or SD/MMC Card (if there is USB device or SD/MMC card connected).
- To turn off the unit, press the knob for more than 2 seconds.
- When the unit is idle for over 3 minutes, it goes to standby mode and displays screen saver.

## Set clock

- 1 Press **MENU**.
- 2 Press the navigation buttons to select **[SETTINGS]**, then press **SEL** on the remote control.
- 3 Select **[SYSTEM]**, then press **▶▶**.
- 4 Select **[TIME MODE]**, then press **▶▶**.
  - ↳ The time mode options are displayed:
    - **[12 hour mode]**
    - **[24 hour mode]**
- 5 Select a mode, then press **SEL**.
- 6 Press **◀◀** to return to previous menu and select **[TIME ADJUST]**, then press **▶▶**.
- 7 Press **▲** or **▼** to enter clock, then press **SEL**.

## Tune to a radio station

- 1 Press **SOURCE** to select Tuner.
- 2 Press and hold **▲** or **▼** to select band.
  - ↳ **[FM]** or **[AM]** is displayed.
- 3 Press **◀◀** or **▶▶** to tune to a radio station manually.
  - To search for radio station automatically, press **◀◀** or **▶▶** for 3 seconds.

## Play discs

- 1 Press to open the front panel.
- 2 Insert the disc into the disc slot with label side facing up.
  - ↳ Play resumes from the point where it was last stopped.
- 3 To remove the disc, press the button.
  - ↳ When the disc is ejected, the unit switches to TUNER mode automatically.
- 4 Close the front panel.
  - ↳ After a few seconds, the screen turns on.
    - For video discs, if a menu appears: press **▲** or **▼** to select an item, then press to start play.
    - For discs that contain MP3s, WMAs, or JPEGS: press **▲** or **▼** to select a folder/track/picture, then press to start play.

## Insert USB device

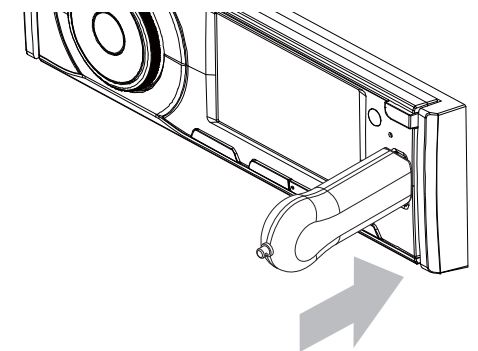

- 1 Slide down the USB socket cover.
- 2 Insert the USB device into the USB socket.
  - ↳ The unit starts playing from the USB device automatically.

## Insert SD/MMC card

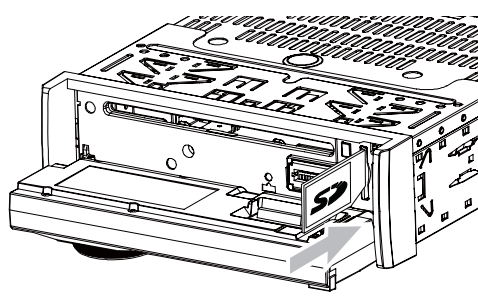

- 1 Press to open the front panel.
- 2 Insert the SD or MMC card into the card slot.
  - ↳ The unit starts playing from the SD/MMC card automatically.

