

# Quick Start Guide



Step A *Connect*

Step B *Setup*

Step C *Enjoy*

## What's in the Box?

You should find these items upon opening the box.

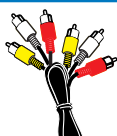

AV cables (Y/W/R)



Component cables (R/G/B)



Remote control with  
battery

Remove the plastic  
protective sheet

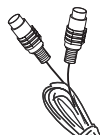
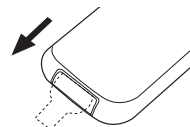

Power adaptor



FM antenna



User Manual



Quick Start Guide

# PHILIPS

## Step A *Connect*

### Important!

This set can only be operated after the supplied DIN cable has been connected.

### Tip

See the User Manual for other TV connection options.

### Notes for the remote control:

- First, select the source you wish to control by pressing one of the source select keys on the remote control (DISC or FM for example).
- Then select the desired function (▶II, ◀I, ▶I for example).

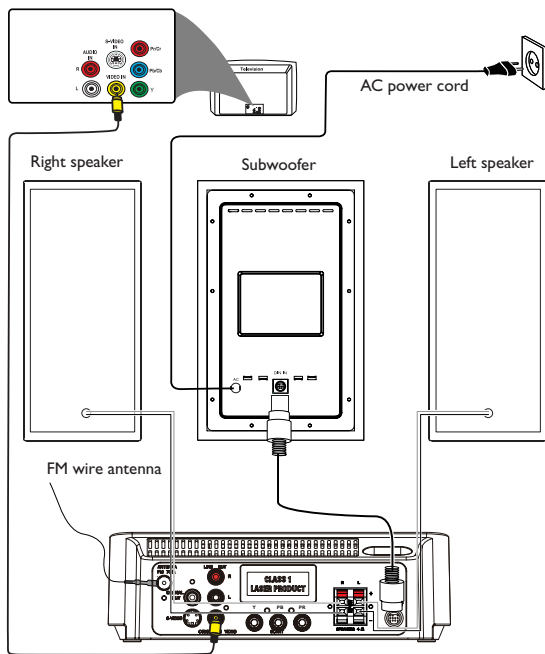

1

Connect the speaker cables.

2

Connect the supplied DIN cable to DVD player's DIN jack and the subwoofer's DIN jack.

3

Connect the FM antenna.

4

Connect the composite video cable (yellow, supplied) to a TV.

5

Connect the power cords of the system and TV.

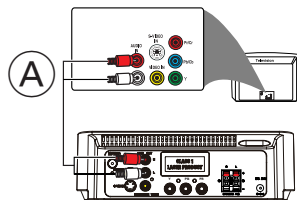

(A) To hear the sound of this DVD Player through your TV, use the audio cables (white/red, supplied) to connect **LINE OUT (L/R)** jacks of the DVD Player to the corresponding **AUDIO IN** jacks on the TV.

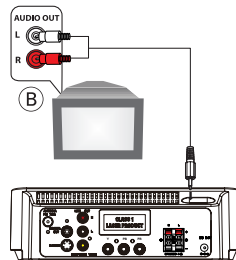

(B) To listen to TV through this system, use a cinch cable (not supplied) to connect **AUX IN** jack (3.5mm) to the corresponding **AUDIO OUT** jacks on the TV set.

## Step B *Setup*

### Setting up the TV

1

Press **SOURCE** (DISC on the remote control) to select disc source.

2

Turn on the TV and set it to the correct Video In channel.

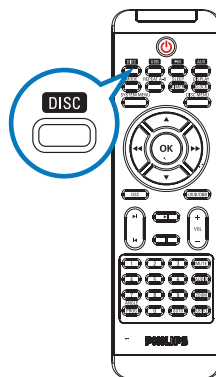

## Step B Setup

### Setting the clock

- 1 In standby mode, press and hold **DISPLAY/CLOCK**. The clock digits flash on the display panel.
- 2 Press **TUNING** **<</>>** (or **<</>>** on the remote control) to set the hours.
- 3 Press **</>** to set the minutes.
- 4 Press **PROG** to select between 12 hour and 24 hour display.
- 5 Press **DISPLAY/CLOCK** again to store the setting.

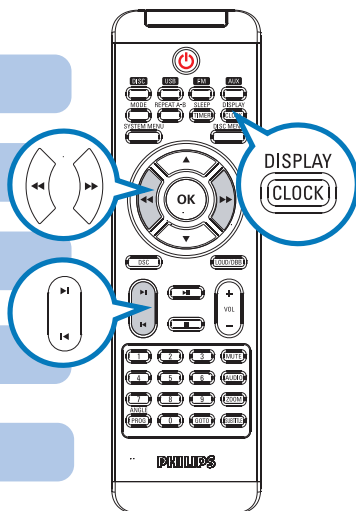

### Setting DVD menu options

#### IMPORTANT!

*If the progressive scan feature is activated but the connected TV does not support progressive signals or the video cables are not connected accordingly, see the user manual for proper progressive scan setup or deactivate the progressive scan feature as below:*

- 1) Turn off your TV progressive scan mode then turn on to interlaced mode.
- 2) Select "OFF" in PROGRESSIVE menu of the system setup menu to turn off progressive scan, then press SYSTEM MENU on the remote to exit the system menu.

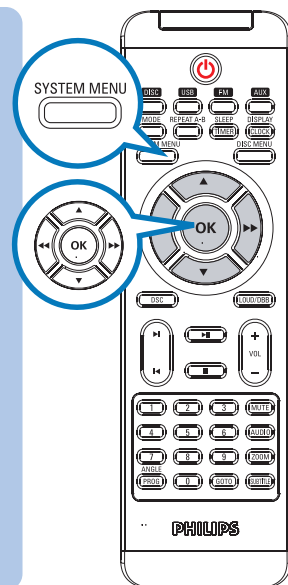
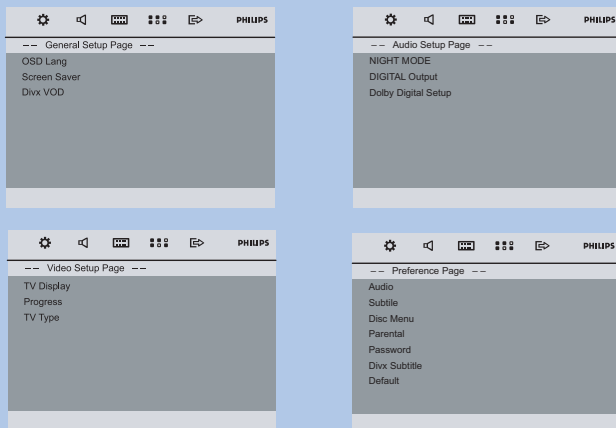

#### Tip

See chapters "Getting Started" and "System Menu Options" in the User Manual for detailed descriptions.

## Playing a disc

- Press **OPEN•CLOSE**  to open the disc door and load in a disc, then press the same button again to close the disc door.
- Make sure the label side of the disc is facing up.



- 2 Playback will start automatically. If not press ►||.

- 3 To stop playback, press ■.

## Programming and tuning to radio stations

- 1 Press **SOURCE** (FM on the remote control) to select tuner source.
- 2 Press **PROG** for more than two seconds to program all available stations in order of waveband.
- 3 Press **◀ / ▶** until the desired preset station is displayed.

**Tip**

Detailed playback features and additional functions are described in the accompany owner's manual.

## Playing a USB mass storage device

With the Hi-Fi system, you can use USB flash memory (USB 2.0 or USB1.1), USB flash players (USB 2.0 or USB1.1), memory cards (requires an additional card reader to work with this Hi-Fi system).

- 1 Insert the USB device's USB plug into the socket  on the front panel of the main set.
- 2 Press **SOURCE** (or **USB** on the remote control) once or more to select **USB**.
- 3 Play the USB's audio files as you do with the albums/tracks on a CD.

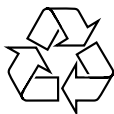

© Royal Philips Electronics N.V. 2008  
All rights reserved.

<http://www.philips.com>