



Philips  
Cordless phone

1.6" display/ amber backlight

D1601B



## Keep it simple

The Philips D160 Cordless Phone packs smart and essential functions in a fresh and engaging design. With excellent sound reproduction and intuitive features, just plug & play to enjoy all your conversations with great clarity and ease.

### Nice and simple

- Ultimate convenience through easy setup
- Textured back cover for non-slip grip
- Easy to read 4.1 cm (1.6") display with backlight
- Up to 10 hours talk time on a single charge
- Caller ID – so you always know who is calling\*

### Crystal clear sound

- Parametric Equalizer delivers pure and clear sound
- Automatic Volume Control offsets unwanted volume variation
- Optimized antenna layout for great reception in any room
- Advanced sound testing & tuning for superb voice quality

### Eco-conscious product

- Low radiation and power consumption

# PHILIPS

Cordless phone  
1.6" display/ amber backlight

# Highlights

## 4.1cm (1.6") display

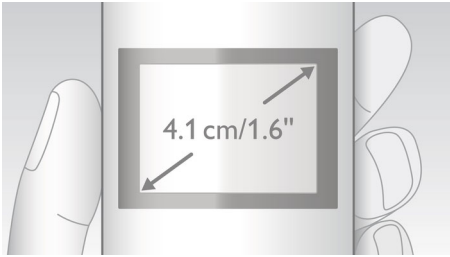

Easy to read 4.1 cm (1.6") display with backlight

## Caller ID\*



Sometimes it is good to know who is calling before you answer. And our Caller ID lets you keep track of who is on the other end of the line.

## Easy setup

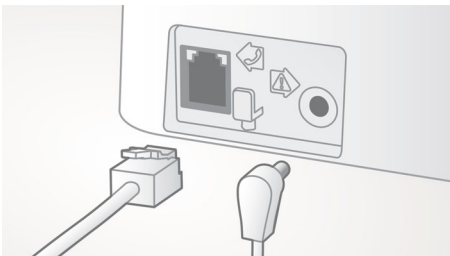

Ultimate convenience through easy set up.  
Simplified installation - Plug & Play product

## Non-slip grip



The rear of the handset is treated with a special texture for added comfort and better grip.

## Up to 10 hours talk time

Up to 10 hours talk time on a single charge

## Advanced sound testing

We test the sound quality of our DECT phones the same way as high-end headphone manufacturers do. Using an advanced ear simulator, we can accurately re-create the way people actually hear. This helps our acoustic engineers to measure and fine-tune things like frequency response, distortion and overall hearing perception, to create perfect voice reproduction.

## Automatic Volume Control



Automatic Volume Control offsets variations in sound signal, which can be caused by distance, signal strength or the caller's phone - so what you hear always remains consistent. Reducing the audio amplification for strong signals, and increasing it for weak ones, it means you can enjoy a smooth conversation without unwanted sound volume variation.

D1601B/01

## Eco-conscious product



Philips phones are energy efficient and designed to be respectful to the environment.

## Optimized antenna layout



Our optimized antenna layout ensures strong and stable reception – even in areas of the house where cordless transmission is difficult. Now you can take a call wherever you are in the house, and enjoy a long, uninterrupted conversation even as you walk around.

## Parametric Equalizer



Our telephones use parametric equalization in the digital sound processing to fine-tune the sound response back to the intended linear frequency response curve, delivering sound that is pure and clear, for each conversation.

# Specifications

## Convenience

- Menu structure in the handset: List Menu
- Signal strength indicator: 3-bar indicator
- Battery level indicator: 3-bar battery icon
- Date / Time display
- Programmable hot keys: Key 1 and 2
- Call Management: Call Waiting\*, Caller ID\*, Microphone mute, Missed Calls, Received Calls, Dialed calls
- Keypad lock
- Key tone on/off
- Auto hang up
- Number of keys: 20
- Base Station keys: Paging key
- Up to 10 hrs talk time
- Charge time: 8 hours
- Line cord length: 1.5m
- Power cord length: 1.5m
- Range: Open field <300m; indoor <50m
- Non-slip grip: Triangular pattern
- Up to 200 hrs standby time

## Sound

- Volume control on handset
- Ringtones on handset: 10 standard
- HQ-Sound

## Picture/Display

- Display size: 4.1cm / 1.6"
- Display type: 12 digits (Alphanumeric) +hard icons
- Backlight: Yes
- Backlight color: Amber

## Memory Capacity

- Phonebook: 50 names and numbers
- Redial List Capacity: 10 last numbers
- Call log entries: 20 entries
- Phonebook store in the base

## Power

- Battery Capacity: 300 mAh
- Battery type: AAA NiMH Rechargeable
- Mains power: AC 100-240V ~50/60Hz
- Power Consumption: < 0.7 W

## Security

- Transmission encryption : Yes

## Network Features

- Compatible: GAP

## SAR Value

- Philips handsets: <0.1 W/kg

## Packaging dimensions

- Packaging type: Carton
- Number of products included: 1
- Type of shelf placement: Laying
- Packaging dimensions (W x H x D):  
18.4 x 13.5 x 5.9 cm
- Gross weight: 0.36 kg
- Nett weight: 0.28 kg
- Tare weight: 0.08 kg
- EAN: 48 95229 10358 0



Issue date 2022-06-22

Version: 6.0.2

12 NC: 8670 001 63665  
EAN: 48 95229 10358 0

© 2022 Koninklijke Philips N.V.  
All Rights reserved.

Specifications are subject to change without notice.  
Trademarks are the property of Koninklijke Philips N.V.  
or their respective owners.

[www.philips.com](http://www.philips.com)

\*\*This feature requires additional subscription of Caller ID service.  
Please check with your local network operator for details.