

Register your product and get support at
www.philips.com/welcome

FWM997/55



EN User manual

PHILIPS

México



Es necesario que lea cuidadosamente su instructivo de manejo.

	PRECAUCIÓN - ADVERTENCIA No abrir, riesgo de choque eléctrico	
	ATENCIÓN Verifique que el voltaje de alimentación sea el requerido para su aparato	
Para evitar el riesgo de choque eléctrico, no quite la tapa. En caso de requerir servicio, dirijase al personal calificado.		

Descripción: **Minisistema de Audio**
Modelo: **FWM406/55**
Alimentación: **110-127 / 220-240V~ ; 50/60 Hz**
Consumo: **100W**
Importador: **Philips Mexicana, S.A. de C.V.**
Domicilio: **Av. La Palma No.6**
Col. San Fernando La Herradura
Huixquilucan
Localidad y Tel: **Edo. de México C.P. 52784**
Tel.52 69 90 00
Exportador: **Philips Electronics HK, Ltd.**
País de Origen: **China**
N° de Serie: _____

**LEA CUIDADOSAMENTE ESTE INSTRUCTIVO
ANTES DE USAR SU APARATO.**

AVISO IMPORTANTE

Philips Mexicana, S.A. de C.V. no se hace responsable por daños o desperfectos causados por:

- *Maltrato, descuido o mal uso, presencia de insectos o roedores (cucarachas, ratones etc.).*
- *Cuando el aparato no haya sido operado de acuerdo con el instructivo del uso, fuera de los valores nominales y tolerancias de las tensiones (voltaje), frecuencia (ciclaje) de alimentación eléctrica y las características que deben reunir las instalaciones auxiliares.*
- *Por fenómenos naturales tales como: temblores, inundaciones, incendios, descargas eléctricas, rayos etc. o delitos causados por terceros (choques asaltos, riñas, etc.).*

Contents

1 Important	4
Safety	4
Notice	5

2 Your Mini Hi-Fi	6
Introduction	6
What's in the box	6
Overview of the main unit	7
Overview of the remote control	8

3 Connect	10
Connect FM antenna	10
Connect AM antenna	10
Connect speakers	10
Connect power	11

4 Get started	12
Prepare the remote control	12
Auto install radio stations	12
Set clock	13
Turn on	13

5 Play	14
Play disc	14
Play from USB	14

6 Play options	15
Repeat and random play	15
Program tracks	15
Display play information	15

7 Adjust volume level and sound effect	16
Adjust volume level	16
Mute sound	16
Boost loudness	16
Select a preset sound effect	16
Enhance bass	16
Virtual surround	16
Customize sound for room acoustics	16

8 Listen to radio	17
Tune to a radio station	17
Program radio stations automatically	17
Program radio stations manually	17
Select a preset radio station	17
Change AM tuning grid	17

9 USB record	18
Record to USB	18
Schedule radio-to-USB record	18

10 Other features	20
Set the alarm timer	20
Set the sleep timer	20
Listen to an external device	20
Delete files in the USB device	21
Karaoke	21
Adjust display brightness	21
Select button light display	21

11 Product information	22
Specifications	22
USB playability information	23
Supported MP3 disc formats	23
Maintenance	23

12 Troubleshooting	24
---------------------------	----

1 Important

Safety

- ① Read these instructions.
- ② Keep these instructions.
- ③ Heed all warnings.
- ④ Follow all instructions.
- ⑤ Do not use this apparatus near water.
- ⑥ Clean only with dry cloth.
- ⑦ Do not block any ventilation openings. Install in accordance with the manufacturer's instructions.
- ⑧ Do not install near any heat sources such as radiators, heat registers, stoves, or other apparatus (including amplifiers) that produce heat.
- ⑨ Protect the power cord from being walked on or pinched, particularly at plugs, convenience receptacles, and the point where they exit from the apparatus.
- ⑩ Only use attachments/accessories specified by the manufacturer.
- ⑪ Use only with the cart, stand, tripod, bracket, or table specified by the manufacturer or sold with the apparatus. When a cart is used, use caution when moving the cart/apparatus combination to avoid injury from tip-over.
- ⑫ Unplug this apparatus during lightning storms or when unused for long periods of time.
- ⑬ Refer all servicing to qualified service personnel. Servicing is required when the apparatus has been damaged in any way, such as power-supply cord or plug is damaged, liquid has been spilled or objects have fallen into the apparatus, the apparatus has been exposed to rain or moisture, does not operate normally, or has been dropped.
- ⑭ Battery usage **CAUTION** – To prevent battery leakage which may result in bodily injury, property damage, or damage to the unit:
 - Install all batteries correctly, + and - as marked on the unit.
 - Do not mix batteries (old and new or carbon and alkaline, etc.).
 - Remove batteries when the unit is not used for a long time.
- ⑮ Apparatus shall not be exposed to dripping or splashing.
- ⑯ Do not place any sources of danger on the apparatus (e.g. liquid filled objects, lighted candles).
- ⑰ This product may contain lead and mercury. Disposal of these materials may be regulated due to environmental considerations. For disposal or recycling information, please contact your local authorities or the Electronic Industries Alliance: www.eiae.org.
- ⑱ Where the MAINS plug or an appliance coupler is used as the disconnect device, the disconnect device shall remain readily operable.



Warning

- Never remove the casing of this Mini Hi-Fi.
- Never lubricate any part of this Mini Hi-Fi.
- Never place this Mini Hi-Fi on other electrical equipment.
- Keep this Mini Hi-Fi away from direct sunlight, naked flames or heat.
- Never look into the laser beam inside the Mini Hi-Fi.
- Ensure that you always have easy access to the power cord, plug or adaptor to disconnect the Mini Hi-Fi from the power.

Caution

- Use of controls or adjustments or performance of procedures other than herein may result in hazardous radiation exposure or other unsafe operation.

packaging materials, exhausted batteries and old equipment.



Windows Media and the Windows logo are trademarks, or registered trademarks of Microsoft Corporation in the United States and/or other countries.

This Mini Hi-Fi includes this label:



Notice

Any changes or modifications made to this device that are not expressly approved by Philips Consumer Lifestyle may void the user's authority to operate the equipment.



The making of unauthorized copies of copy-protected material, including computer programs, files, broadcasts and sound recordings, may be an infringement of copyrights and constitute a criminal offence. This equipment should not be used for such purposes.

Environmental information

All unnecessary packaging has been omitted. We have tried to make the packaging easy to separate into three materials: cardboard (box), polystyrene foam (buffer) and polyethylene (bags, protective foam sheet.)

Your system consists of materials which can be recycled and reused if disassembled by a specialized company. Please observe the local regulations regarding the disposal of

2 Your Mini Hi-Fi

Congratulations on your purchase, and welcome to Philips! To fully benefit from the support that Philips offers, register your product at www.Philips.com/welcome.

Introduction

With this Mini Hi-Fi, you can enjoy audio from discs, USB devices, external devices, or radio stations.

For your convenience, you can load up to 3 discs at once.

To enrich sound, this Mini Hi-Fi offers you these sound effects:

- MAX sound for instant power boost
- Digital Sound Control (DSC)
- Dynamic Bass Boost (DBB)
- Incredible surround (IS)
- Virtual Ambience-based Control (VAC)

The Mini Hi-Fi supports the following media formats:



What's in the box

Check and identify the contents of your package:

- Main unit x 1
- AC power cable x 2
- Power plug adaptor x 1
- Front speakers x 2
- Rear speakers x 2
- Subwoofer x 1
- Remote control (with 2 AAA batteries)
- FM wire antenna x 1
- AM loop antenna x 1
- MP3 link cable x 1
- DIN cable x 1

Overview of the main unit

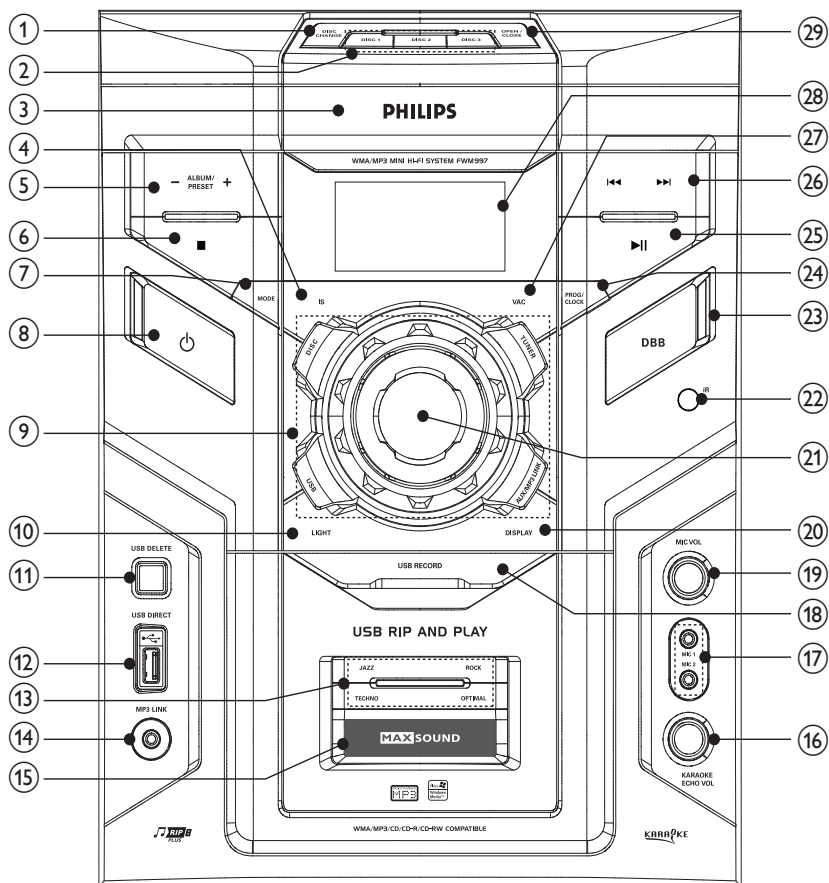





- | | |
|----------------------------------------------------------------------------------------------------------------------------------------------------------------------------------------------------------------------------------------------------------------------------------------------------------------------------------------------------------------------------------------------------------------------------------------------------------------------------------------------------------------------------------------------------------------------------------------------|---------------------------------------------------------------------------------------------------------------------------------------------------------------------------------------------------------------------------------------------------------------------------------------------------------------------------------------------------------------------------------------------------------------------------------------------------------------------------------------------------------------------------------------------------------------|
| <p>① DISC CHANGE</p> <ul style="list-style-type: none"> • Change a disc tray. <p>② DISC 1/2/3</p> <ul style="list-style-type: none"> • Select a disc tray. <p>③ Disc compartment door</p> <p>④ IS</p> <ul style="list-style-type: none"> • Turn on or off incredible surround. <p>⑤ ALBUM/PRESET +/-</p> <ul style="list-style-type: none"> • Skip to the previous/next album. • Select a preset radio station. • Adjust time. • Select 12 hour or 24 hour format. | <p>⑥ ■</p> <ul style="list-style-type: none"> • Stop play or erase a program. <p>⑦ MODE</p> <ul style="list-style-type: none"> • Select repeat play or random play. <p>⑧ ⏻</p> <ul style="list-style-type: none"> • Turn on the system or switch to standby mode. <p>⑨ Source selection keys</p> <ul style="list-style-type: none"> • Select a source. <p>⑩ LIGHT</p> <ul style="list-style-type: none"> • Select a lighting effect for the main unit. |
|----------------------------------------------------------------------------------------------------------------------------------------------------------------------------------------------------------------------------------------------------------------------------------------------------------------------------------------------------------------------------------------------------------------------------------------------------------------------------------------------------------------------------------------------------------------------------------------------|---------------------------------------------------------------------------------------------------------------------------------------------------------------------------------------------------------------------------------------------------------------------------------------------------------------------------------------------------------------------------------------------------------------------------------------------------------------------------------------------------------------------------------------------------------------|

- ⑪ **USB DELETE**
 - Delete audio files stored on a USB device.
- ⑫ **USB DIRECT** 
 - Jack for a USB mass storage device.
- ⑬ **DSC**
 - Select a preset sound equalizer setting.
- ⑭ **MP3 LINK**
 - Audio input jack (3.5mm) for an external audio device.
- ⑮ **MAX SOUND**
 - Turn on or off instant power boost for sound.
- ⑯ **KARAOKE ECHO VOL**
 - Adjust echo level.
- ⑰ **MIC 1/2**
 - Jack for a microphone.
- ⑱ **USB RECORD**
 - Record to a USB device.
- ⑲ **MIC VOL**
 - Adjust microphone volume.
- ⑳ **DISPLAY**
 - Select display information.
- ㉑ **VOLUME**
 - Adjust volume.
- ㉒ **IR**
 - Remote sensor.
- ㉓ **DBB**
 - Turn on or off dynamic bass enhancement.
- ㉔ **PROG/CLOCK**
 - Program tracks.
 - Program radio stations.
 - Set the clock.
- ㉕ **▶||**
 - Start or pause play.
- ㉖ **⏮▶▶**
 - Skip to the previous/next track.
 - Search within a track/disc/USB.
 - Tune to a radio station.
 - Adjust time.

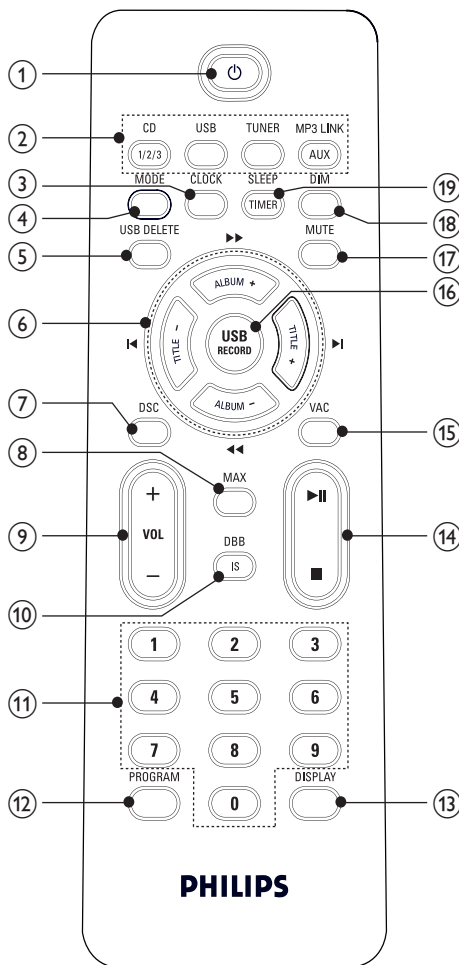
- ㉗ **VAC**
 - Select an ambience-based equaliser setting.
- ㉘ **Display panel**
 - Show current status.
- ㉙ **Open/Close**
 - Open or close the disc compartment.

Overview of the remote control



- ①  • Turn on the Mini Hi-Fi, or switch to standby mode.
- ② **Source selection keys**
- Select a source.
- ③ **CLOCK**
- Set the clock.
- ④ **MODE**
- Select repeat play or random play.
- ⑤ **USB DELETE**
- Delete audio files stored on a USB device.
- ⑥ **TITLE+/-◀/▶**
- Skip to the previous/next track.
 - Select a preset radio station.
 - Adjust time.
- ALBUM +/-◀◀/▶▶**
- Skip to the previous/next album.
 - Search within a track/ disc/USB.
 - Tune to a radio station.
 - Adjust time.
- ⑦ **DSC**
- Select a preset sound equalizer setting.
- ⑧ **MAX**
- Turn on or off instant power boost for sound.
- ⑨ **VOL +/-**
- Adjust volume.
- ⑩ **DBB/IS**
- Turn on or off dynamic bass enhancement.
 - Turn on or off incredible surround.
- ⑪ **Numeric keypad**
- Select a track from a disc directly.
- ⑫ **PROGRAM**
- Program tracks.
 - Program radio stations.
- ⑬ **DISPLAY**
- Select display information.
- ⑭  • Stop play or erase a program.
- 
- Start or pause play.
- ⑮ **VAC**
- Select an ambience-based equaliser setting.
- ⑯ **USB RECORD**
- Record to a USB device.
- ⑰ **MUTE**
- Mute volume.
- ⑱ **DIM**
- Select different levels of display brightness.
- ⑲ **SLEEP/TIMER**
- Set the sleep timer.
 - Set the alarm timer.

3 Connect

Connect FM antenna

- 1 Connect the supplied FM antenna to the FM jack on the back of the main unit.

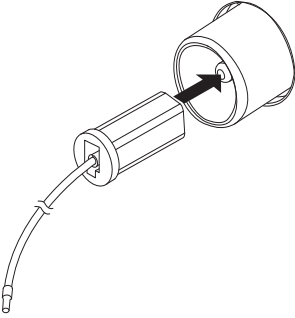

Connect AM antenna

- 1 Assemble the AM loop antenna.

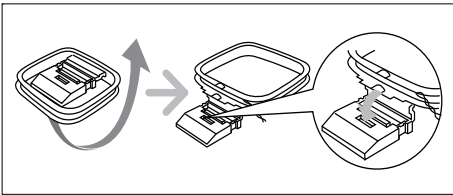

- 2 Connect the AM loop antenna to the AM jack on the back of the main unit.

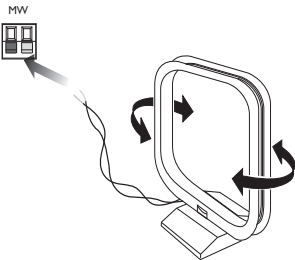

Connect speakers

Note

- For optimal sound, use the supplied speakers only.
- Connect only speakers with impedance that is the same or higher than the supplied speakers. Refer to the Specifications section of this manual.

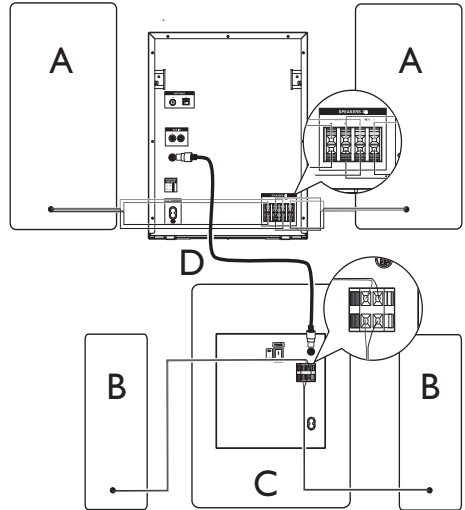

A: front speakers; B: rear speaker; C: subwoofer; D: DIN cable

Connect the front speakers

- 1 For the right front speaker, find the sockets on the main unit marked "R".
- 2 Insert the blue-black wires into a pair of blue-black (+/-) sockets, the blue wire into the blue (+) socket, the black wire into the black (-) socket.
- 3 Insert each speaker wire:
 - ① Hold down the socket flap.
 - ② Insert the stripped part of the wire completely.
 - ③ Release the socket flap.

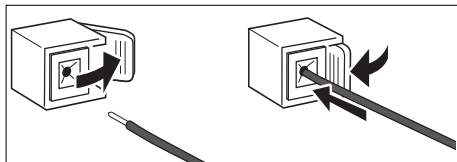

- 4 Insert the white-black wires into a pair of white-black (+/-) sockets, the white wire into the white (+) socket, the black wire into the black (-) socket.
- 5 For the left front speaker, find the sockets on the main unit marked "L".
- 6 Repeat steps 2-4 to connect the left front speaker.

Connect the rear speakers

- 1 For the right rear speaker, find the sockets on the back of the subwoofer marked "R".
- 2 Insert the purple wire into the purple socket (+) and the black wire into the black socket (-).
- 3 For the left rear speaker, find the sockets on the back of the subwoofer marked "L".
- 4 Repeat step 2 to connect the left rear speaker.

Connect the subwoofer

- 1 Connect the DIN cable to **SUBWOOFER** jack on the main unit and **FROM MAIN** jack on the subwoofer.

Connect power

! Caution

- Risk of product damage! Ensure that the power supply voltage corresponds to the voltage set on the voltage selector on the back of the Mini Hi-Fi and the subwoofer.
- Before you connect the AC power cord, ensure that you have completed all other connections.

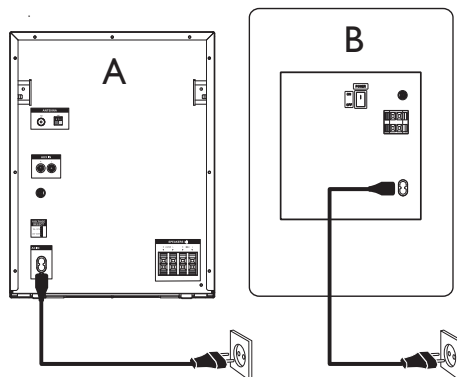

A: main unit; B: subwoofer



Note

- The type plate is located on the back of the main unit.
- The type plate is located on the back of the subwoofer.

- 1 If your power supply voltage is 110V-127V, adjust the voltage selector to 110V-127V for the main unit and the subwoofer.
- 2 Connect one AC power cable to:
 - the main unit.
 - the wall socket.
- 3 Connect one AC power cable to:
 - the subwoofer.
 - the wall socket.

4 Get started

! Caution

- Use the controls only as stated in this user manual.

Always follow the instructions in this chapter in sequence.

If you contact Philips, you will be asked for the model and serial number of your Mini Hi-Fi. The model number and serial number are on the back of your Mini Hi-Fi. Write the numbers here:

Model No. _____

Serial No. _____

Prepare the remote control

! Caution

- Risk of explosion! Keep batteries away from heat, sunshine or fire. Never discard batteries in fire.

To replace the remote control battery:

- 1 Open the battery compartment.
- 2 Insert 2 AAA batteries with correct polarity (+/-) as indicated.
- 3 Close the battery compartment.

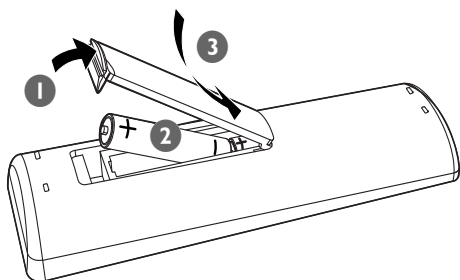

≡ Note

- If you are not going to use the remote control for a long time, remove the batteries.
- Do not use old and new or different types of batteries in combination.
- Batteries contain chemical substances, so they should be disposed of properly.

Auto install radio stations

When you connect power and no radio stations are stored, the Mini Hi-Fi automatically begins to store radio stations.

- 1 Connect the Mini Hi-Fi to the power supply.
 - ↳ [AUTO INSTALL - PRESS PLAY] (auto install - press the PLAY button) is displayed.
- 2 Press ►|| on the main unit to start installation.
 - ↳ [AUTO] (auto) is displayed.
 - ↳ The Mini Hi-Fi automatically stores radio stations with sufficient signal strength.
 - ↳ When all the available radio stations are stored, the first preset radio station is broadcast automatically.

Set clock

- 1 In the standby mode, press **CLOCK** to activate the clock setting mode.
 - ↳ The 12 hour or 24 hour format is displayed.
- 2 Press **ALBUM +/-◀◀/▶▶** repeatedly to select 12 hour or 24 hour format.
- 3 Press **CLOCK** to confirm.
 - ↳ The clock digits are displayed and begin to blink.
- 4 Press **ALBUM +/-◀◀/▶▶** to set the hour.
- 5 Press **TITLE+/-◀/▶** to set the minute.
- 6 Press **CLOCK** to confirm.



Tip

- To view the clock during play, press **CLOCK**.

Turn on

- 1 Press **⏻** to turn on the main unit.
 - ↳ The system switches to the last selected source.
- 2 Press **POWER** switch on the back of the subwoofer to turn on the subwoofer.

Switch to standby

- 1 Press **⏻** to switch the Mini Hi-Fi to standby mode.
 - ↳ The backlight on the display panel turns off.
 - ↳ The clock (if set) appears on the display panel.

5 Play

Play disc

- 1 Press **CD 1/2/3** to select the disc source.
- 2 Press **OPEN/CLOSE** on the main unit to open the disc compartment.
- 3 Load up to two discs on the disc trays, with the printed side facing up
 - To load the third disc, press **DISC CHANGE** on the main unit to rotate to the disc tray.

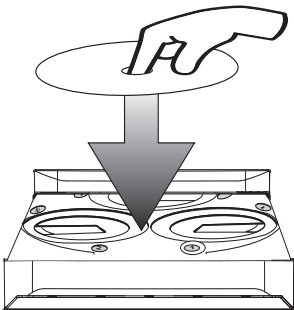

- 4 Press **OPEN/CLOSE** on the main unit to close the disc compartment.
- 5 Press **▶||** to start play.
 - To select a disc, press **CD 1/2/3**.
 - To pause/resume play, press **▶||**.
 - To stop play, press **■**.
 - To select another track, press **TITLE +/- ◀/▶** or press a numeric button.
 - To select an folder, press **ALBUM +/- ◀◀/▶▶**.
 - To search within a track, press and hold **ALBUM +/- ◀◀/▶▶**, then release to resume normal play.

Play from USB

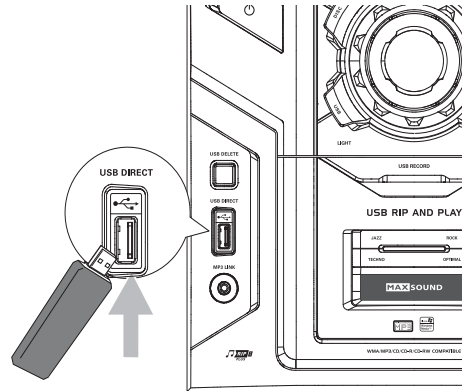





Note

- Ensure that the USB device contains playable audio contents for supported formats.

- 1 Insert the USB plug of the device into the **↔** socket.
- 2 Press **USB** to select the USB source.
- 3 Press **ALBUM +/- ◀◀/▶▶** to select a folder.
- 4 Press **TITLE +/- ◀/▶** to select an audio file.
- 5 Press **▶||** to start play.
 - To pause/resume play, press **▶||**.
 - To stop play, press **■**.
 - To search within an audio file, press and hold **ALBUM +/- ◀◀/▶▶**, then release to resume normal play.

6 Play options

Repeat and random play

- 1 Press **MODE** repeatedly to select:
 - : the current track is played repeatedly.
 - : all tracks are played repeatedly.
 - : all tracks are played randomly and repeatedly.
 - : all tracks are played randomly.
- 2 To return to normal play, press **MODE** repeatedly until play mode is no longer displayed.







Tip

- Shuffle play cannot be selected when you play programmed tracks.

Program tracks

You can program a maximum of 40 tracks.

- 1 At CD/USB mode, in the stop position, press **PROGRAM** to activate the program mode.
 - ↳ [PROG] (program) blinks on the display.
- 2 For MP3/WMA tracks, press **ALBUM +/-**   to select an album.
- 3 Press **TITLE +/-**   to select a track number, then press **PROGRAM** to confirm.
- 4 Repeat steps 2 to 3 to select and store all tracks to program.
- 5 Press **▶||** to play the programmed tracks.
 - ↳ During play, [PROG] (program) is displayed.
 - To erase the program, in the stop position, press **■**.

Display play information

- 1 During play, press **DISPLAY** repeatedly to select different play information.

7 Adjust volume level and sound effect

Note

- MAX sound and DSC (Digital Sound Control) cannot be activated at the same time.

Adjust volume level

- 1 During play, press **VOL +/-** to increase/decrease the volume level.

Mute sound

- 1 During play, press **MUTE** to mute/unmute sound.

Boost loudness

MAX gives an instant boost to the sound power.

- 1 Press **MAX** to turn on or off the instant power boost.
 - ↳ If MAX sound is activated, **MAX** is displayed.

Select a preset sound effect

The DSC (Digital Sound Control) enables you to enjoy special sound effects.

- 1 During play, press **DSC** repeatedly to select:
 - [JAZZ] (jazz)
 - [ROCK] (rock)

- [TECHNO] (techno)
- [OPTIMAL] (optimal)

Enhance bass

The best DBB (Dynamic Bass Enhancement) setting is generated automatically for each DSC selection. You can manually select the DBB setting that best suits your listening environment.

- 1 During play, press **DBB/IS** repeatedly to select:
 - DBB 1
 - DBB 2
 - DBB 3
 - DBB off
 - ↳ If DBB is activated, **DBB** is displayed.

Virtual surround

You can enhance audio with a virtual surround sound effect.

- 1 Press and hold **DBB/IS** to turn on or off the incredible surround.
 - On the main unit, press **IS**.
 - ↳ If the incredible surround is activated, [INC SURR] (incredible surround) is displayed.

Customize sound for room acoustics

- 1 During play, press **VAC** repeatedly to select a type of listening environment:
 - [HALL] (hall)
 - [CONCERT] (concert)
 - [CINEMA] (cinema)

8 Listen to radio

Tune to a radio station

- 1 Press **TUNER** repeatedly to select FM or AM.
- 2 Press and hold **ALBUM +/-◀▶▶▶** for more than 2 seconds.
 - ↳ [SEARCH] (search) is displayed.
 - ↳ The radio tunes to a station with strong reception automatically.
- 3 Repeat step 2 to tune to more stations.
 - To tune to a weak station, press **ALBUM +/-◀▶▶▶** repeatedly until you find optimal reception.

Program radio stations automatically

You can program a maximum of 40 preset radio stations.

- 1 In the tuner mode, press and hold **PROGRAM** for more than 2 seconds to activate automatic program mode.
 - ↳ [AUTO] (auto) is displayed.
 - ↳ All available stations are programmed in the order of waveband reception strength.
 - ↳ The first programmed radio station is broadcast automatically.

Program radio stations manually

You can program a maximum of 40 preset radio stations.

- 1 Tune to a radio station. (see 'Tune to a radio station' on page 17)

- 2 Press **PROGRAM** to activate program mode.
 - ↳ [PROG] (program) blinks on the display.
- 3 Press **TITLE +/-◀▶▶▶** to allocate a number to this radio station, then press **PROGRAM** to confirm.
 - ↳ The preset number and the frequency of the preset station are displayed.
- 4 Repeat the above steps to program other stations.



Tip

- To overwrite a programmed station, store another station in its place.

Select a preset radio station

- 1 In tuner mode, press **TITLE +/-◀▶▶▶** to select a preset number.



Tip

- Position the antenna as far as possible from TV, VCR or other radiation source.
- For optimal reception, fully extend and adjust the position of the antenna.

Change AM tuning grid

In some countries, the AM radio frequency step between adjacent channels is 9 kHz (10 kHz in some areas).

- 1 Select the tuner source.
- 2 Press and hold **■** on the main unit for more than 5 seconds.
 - ↳ The frequency step is changed to 9 kHz or 10 kHz.
 - ↳ All preset stations are erased and need to be re-programmed.

9 USB record

Audio CD tracks, MP3 files, radio and audio from external devices are recorded in .mp3 format, and WMA files are recorded in .wma format. The first time you record to USB, a folder called 'PHILIPS' is automatically created in the USB device. Each time you record to USB, the recorded files are stored in a sub-folder in the 'PHILIPS' folder. Files and sub-folders are named numerically in the order in which they are created.

Record to USB

- 1 Plug the USB device into the  socket of this Mini Hi-Fi.
- 2 Prepare the source to record from.
 - Disc - load a disc (see 'Play disc' on page 14). You can select a track from which a recording starts.
 - Radio - tune to a radio station. (see 'Tune to a radio station' on page 17)
 - MP3 LINK/AUX - connect and start to play an external device. (see 'Listen to an external device' on page 20)
- 3 Press **USB RECORD** to start recording.
 - For discs, press **USB RECORD** repeatedly to select:
 - (A) [REC ONE] (record one): the first/current track is recorded.
 - (B) [REC ALL] (record all): all tracks/the remaining tracks are recorded.
 - ↳ Disc play starts automatically from the beginning of the disc/the selected track, and the recording starts.
 - To stop recording, press **■**.

Note

- If the USB device does not have enough memory to store the audio files, [MEMORY FULL] (memory full) is displayed.

Schedule radio-to-USB record

Schedule radio recordings in advance and you can listen to your favorite programs at your convenience.

Note

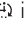

- The maximum length of a recording is 12 hours.

- 1 Ensure that you have set the clock correctly. (see 'Set clock' on page 13)
- 2 Insert the USB plug of the device into the  socket.
- 3 Tune to a radio station. (see 'Tune to a radio station' on page 17)
- 4 Press **⏻** to switch to standby mode.
- 5 Press and hold **SLEEP/TIMER** for more than 2 seconds.
 - ↳ A prompt to select the source is displayed.
- 6 Press **TUNER** to select the tuner source.
- 7 Press **USB RECORD**.
 - ↳ The start timer digits are displayed and begin to blink.
- 8 Press **ALBUM +/-◀▶▶** to set the hour.
- 9 Press **TITLE+/-◀▶▶** to set the minute.
- 10 Press **SLEEP/TIMER** to confirm.
 - ↳ The end timer digits are displayed and begin to blink.
- 11 Press **ALBUM +/-◀▶▶** to set the hour.
- 12 Press **TITLE+/-◀▶▶** to set the minute.
- 13 Press **SLEEP/TIMER** to confirm.
 - ↳  is displayed.
 - ↳ At the scheduled times, the recording begins and ends automatically.
 - ↳ When the recording ends, the Mini Hi-Fi switches to standby mode.

Tip

- A recording is activated only in the standby mode.

To deactivate or re-activate a record timer

- 1 In the standby mode, press **SLEEP/TIMER** repeatedly.
 - ↳ If the timer is activated,  is displayed.
 - ↳ If the timer is deactivated,  disappears.

10 Other features

Set the alarm timer

This Mini Hi-Fi can be used as an alarm clock. The disc, radio or USB is activated to play at a preset time.

Note

- If you have set a record timer and an alarm timer, only the latest timer is activated.

- 1 Ensure that you have set the clock correctly. (see 'Set clock' on page 13)
- 2 Press **⏻** to switch to standby mode.
- 3 Press and hold **SLEEP/TIMER** for more than 2 seconds.
 - ↳ A prompt to select the source is displayed.
- 4 Press **CD 1/2/3**, or **TUNER** or **USB** to select a source.
- 5 Press **SLEEP/TIMER** to confirm.
 - ↳ The clock digits are displayed and begin to blink.
- 6 Press **ALBUM +/-◀▶▶** to set the hour.
- 7 Press **TITLE+/-◀▶▶** to set the minute.
- 8 Press **SLEEP/TIMER** to confirm.
 - ↳ The timer is set and activated.

To deactivate or re-activate a alarm timer

- 1 In the standby mode, press **SLEEP/TIMER** repeatedly.
 - ↳ If the timer is activated, **⌚** is displayed.
 - ↳ If the timer is deactivated, **⌚** disappears.

Tip

- In MP3 link or AUX mode, the alarm timer cannot be set.
- If disc or USB source is selected but no audio file can be played, radio is activated automatically.

Set the sleep timer

This Mini Hi-Fi can switch to standby automatically after a set period of time.

- 1 When the Mini Hi-Fi is turned on, press **SLEEP/TIMER** repeatedly to select a set period of time (in minutes).
 - ↳ When sleep timer is activated, **zZ** is displayed.

To deactivate sleep timer

- 1 Press **SLEEP/TIMER** repeatedly until **[OFF]** (off) is displayed.
 - ↳ When sleep timer is deactivated, **zZ** disappears on the display.

Listen to an external device

You can listen to an external audio device through this Mini Hi-Fi.

For audio players with headphone sockets

- 1 Press **MP3 LINK/AUX** repeatedly to select the MP3 link source.
- 2 Connect the supplied MP3 link cable to:
 - the **MP3 LINK** jack (3.5mm) on the Mini Hi-Fi.
 - the headphone jack on an external device.
- 3 Start to play the device (see the device user manual).

For audio players with red/white audio output sockets

- 1 Press **MP3 LINK/AUX** repeatedly to select the AUX source.
- 2 Connect the audio cables (white/red jacks, not supplied) to:
 - the **AUX IN** jacks on the back of the Mini Hi-Fi.
 - the **AUDIO OUT** jacks on an external device.
- 3 Start to play the device (see the device user manual).

Delete files in the USB device

- 1 During USB play, press **TITLE**+**1/4** to select an audio file.
 - To delete an audio folder, in the stop position, press **ALBUM** +**1/4** to select an audio folder.
- 2 Press **USB DELETE**.
 - ↳ A confirmation message is displayed.
- 3 While the message is displayed, press **USB DELETE** again to confirm.
 - To cancel, press **■**.
 - ↳ After you delete a file or an audio folder, the USB play stops.

Karaoke

You can connect a microphone and sing along with a music source.

- 1 Turn **MIC VOL** to the minimum level.
- 2 Connect a microphone to the **MIC 1/2** jack of the Mini Hi-Fi.
- 3 Press **CD 1/2/3**, or **TUNER**, or **USB**, or **MP3 LINK/AUX** to select the source, and start play.
- 4 Sing through the microphone.
 - To adjust the volume of the source, press **VOL +/-**.
 - To adjust the volume of the microphone, turn **MIC VOL**.
 - To adjust the echo level, turn **KARAOKE ECHO VOL**.

Adjust display brightness

- 1 Press **DIM** repeatedly to select different levels of display brightness.

Select button light display

- 1 Press **LIGHT** repeatedly on the main unit.
 - ↳ Each time you press **LIGHT**, the main unit buttons light up in a different way.

11 Product information



Note

- Product information is subject to change without prior notice.

Specifications

Amplifier

Total output power	800W RMS
Signal-to-noise ratio	67dB A (IEC)
Frequency response	60 - 16000Hz
AUX	1500mV/2000mV

Disc

Laser type	Semiconductor
Disc diameter	12cm/8cm
Support disc	CD-DA, CD-R, CD-RW, MP3-CD, WMA-CD
Audio DAC	24Bits / 44.1kHz
Total harmonic distortion	<1.5%
Frequency response	60Hz -16kHz (44.1kHz)
S/N ratio	>75dBA

Tuner

Tuning range	FM: 87.5 - 108MHz AM: 531 - 1602kHz (9kHz); 530 - 1700kHz (10kHz)
Tuning grid	50KHz (FM); 9KHz/10KHz (AM)
Number of presets	40
FM	75ohm wire
AM	Loop antenna

Front speakers

Impedance	2 x 6ohm
Woofer	2 x 5.25"
Tweeter	2 x 1.75"
Dimensions (W x H x D)	225 x 430 x 275 (mm)
Weight	4.93kg each

Rear speakers

Impedance	3ohm
Speaker driver	4" + 4" (fake)
Frequency response	150Hz - 16kHz
Dimensions (W x H x D)	142.5 x 345 x 171.3 (mm)
Weight	2.1kg each

Subwoofer

AC power	110 - 127/220 - 240V; 50/60Hz
Power consumption	100W
Impedance	6ohm
Subwoofer driver	8"
Dimensions (W x H x D)	274 x 430 x 342.3 (mm)
Weight	11.2kg

General

AC power	110 - 127/220 - 240V; 50/60Hz, Switchable
Power consumption	
- Active	90W
- Standby	≤ 20W
USB direct	Version 2.0/1.1
Dimensions	
Main unit (W x H x D)	265 x 345 x 382 (mm)
Weight	8.67kg

USB playability information

Compatible USB devices:

- USB flash memory (USB 2.0 or USB 1.1)
- USB flash players (USB 2.0 or USB 1.1)
- memory cards (requires an additional card reader to work with this Mini Hi-Fi)

Supported formats:

- USB or memory file format FAT12, FAT16, FAT32 (sector size: 512 bytes)
- MP3 bit rate (data rate): 32-320 Kbps and variable bit rate
- WMA v9 or earlier
- Directory nesting up to a maximum of 8 levels
- Number of albums/ folders: maximum 99
- Number of tracks/titles: maximum 999
- ID3 tag v2.0 or later
- File name in Unicode UTF8 (maximum length: 128 bytes)

Unsupported formats:

- Empty albums: an empty album is an album that does not contain MP3/WMA files, and is not shown in the display.
- Unsupported file formats are skipped. For example, Word documents (.doc) or MP3 files with extension .dlf are ignored and not played.
- AAC, WAV, PCM audio files
- DRM protected WMA files (.wav, .m4a, .m4p, .mp4, .aac)
- WMA files in Lossless format

Supported MP3 disc formats

- ISO9660, Joliet
- Maximum title number: 999 (depending on file name length)
- Maximum album number: 99
- Supported sampling frequencies: 32 kHz, 44.1kHz, 48 kHz
- Supported Bit-rates: 32-320 (kbps), variable bit rates
- ID3 tag v2.0 or later
- Directory nesting up to a maximum of 8 levels

Maintenance

Clean the cabinet

- Use a soft cloth slightly moistened with a mild detergent solution. Do not use a solution containing alcohol, spirits, ammonia or abrasives.

Clean discs

- When a disc becomes dirty, clean it with a cleaning cloth. Wipe the disc from the centre out.



- Do not use solvents such as benzene, thinner, commercially available cleaners, or antistatic spray intended for analogue records.

Clean the disc lens

- After prolonged use, dirt or dust may accumulate at the disc lens. To ensure good play quality, clean the disc lens with Philips CD lens cleaner or any commercially available cleaner. Follow the instructions supplied with cleaner.

12 Troubleshooting



Caution

- Never remove the casing of this Mini Hi-Fi.

To keep the warranty valid, never try to repair the system yourself.

If you encounter problems when using this Mini Hi-Fi, check the following points before requesting service. If the problem remains unsolved, go to the Philips web site (www.Philips.com/support). When you contact Philips, ensure that your Mini Hi-Fi is nearby and the model number and serial number are available.

No power

- Ensure that the AC power plug of the Mini Hi-Fi is connected properly.
- Ensure that there is power at the AC outlet.
- As a power-saving feature, the Mini Hi-Fi switches to standby automatically 15 minutes after disc/USB play reaches the end and no control is operated.

No sound or poor sound

- Adjust the volume.
- Check that the speakers are connected correctly.
- Check if the stripped speaker wires are clamped.

Left and right sound outputs reversed

- Check the speaker connections and location.

No response from the Mini Hi-Fi

- Disconnect and reconnect the AC power plug, then turn on the system again.

Remote control does not work

- Before you press any function button, first select the correct source with the remote control instead of the main unit.
- Reduce the distance between the remote control and the Mini Hi-Fi.

- Insert the batteries with their polarities (+/- signs) aligned as indicated.
- Replace the batteries.
- Aim the remote control directly at the sensor on the front of the Mini Hi-Fi.

No disc detected

- Insert a disc.
- Check if the disc is inserted upside down.
- Wait until the moisture condensation at the lens has cleared.
- Replace or clean the disc.
- Use a finalized CD or correct format disc.

Cannot display some files in USB device

- The number of folders or files in the USB device has exceeded a certain limit. This phenomenon is not a malfunction.
- The formats of these files are not supported.

USB device not supported

- The USB device is incompatible with the Mini Hi-Fi. Try another one.

Poor radio reception

- Increase the distance between the Mini Hi-Fi and your TV or VCR.
- If the signal is too weak, adjust the antenna or connect an external antenna for better reception.

Timer does not work

- Set the clock correctly.
- Switch on the timer.
- If you have set a record timer and an alarm time, only the latest timer is activated.

Clock/timer setting erased

- Power has been interrupted or the power cord has been disconnected.
- Reset the clock/timer.

Validez de la garantía

Todos los productos de la línea de audio y video Philips, se registrarán por un año de garantía internacional (365 días), salvo para Chile donde los productos de las líneas CD Portable y RCR CD, los cuales se rigen por 6 meses de garantía (182 días)

Condiciones de la garantía

Esta garantía perderá su validez si:

- El defecto es causado por uso incorrecto o en desacuerdo con el manual de instrucciones
- El aparato sea modificado, violado por una persona no autorizada por Philips
- El producto esté funcionando con un suministro de energía (red eléctrica, batería, etc.) de características diferentes a las recomendadas en el manual de instrucciones
- El número de serie que identifica el producto se encuentre de forma adulterada.

Están excluidos de garantía,

- Los defectos que se generen debido al incumplimiento del manual de instrucciones del producto
- Los casos fortuitos o de la fuerza mayor, como aquellos causados por agentes de la naturaleza y accidentes, descargas eléctricas, señales de transmisión débiles.
- Los defectos que se generen debido al uso de los productos en servicios no doméstico/residencial regulares o en desacuerdo con el uso recomendado
- Daños ocasionados por fluctuaciones de voltajes, voltaje fuera de norma o por causas fuera de Philips, como cortocircuitos en los bafles o parlantes.
- En las ciudades en donde no existe el taller autorizado del servicio de Philips, los costos del transporte del aparato y/o el técnico autorizado, corren por cuenta del cliente.
- La garantía no será válida si el producto necesita modificaciones o adaptaciones para que funcione en otro país que no es aquél para el cual fue mercadeado.

El único documento válido para hacer efectiva la garantía de los productos, es la Factura o Boleta de compra del consumidor final.

Aquellos productos que hayan sido adquiridos en otros países y que no estén en el rango normal del país donde se efectuará la reparación, dicha prestación de servicio tomará mas tiempo de lo normal ya que es necesario pedir las partes/piezas al centro de producción correspondiente.

Centros de información

Líneas de atención al consumidor

Chile: 600-7445477

Colombia: 01-800-700-7445

Costa Rica: 0800-506-7445

Ecuador: 1-800-10-1045

El Salvador: 800-6024

Guatemala: 1-800-299-0007

Panamá: 800-8300

Peru: 0800-00100

Rep. Dominicana: 1-800-751-2673

Venezuela: 0800-100-4888

POLIZA DE GARANTIA PARA MEXICO

ESTA POLIZA ES GRATUITA

Este aparato ha sido cuidadosamente diseñado y se ha fabricado con los mejores materiales bajo un estricto control de calidad, garantizando su buen funcionamiento por los periodos establecidos según el aparato (ver lista en la parte inferior) **a partir de la entrega del aparato al consumidor.**

Esta póliza incluye la reparación o reposición gratuita de cualquier parte o componente que eventualmente fallase y la mano de obra necesaria para su reparación, así como los gastos de transportación razonablemente erogados dentro de nuestros centros de servicio, misma que se hará efectiva en cualquiera de nuestros centros de servicio autorizados en el país.

Si su aparato llegase a requerir de nuestro servicio de garantía, acuda al centro de servicio más cercano a su domicilio, de tener alguna duda por favor llame a nuestro **CENTRO DE INFORMACIÓN AL CLIENTE LADA** sin costo en toda la republica al **01 800 504 62 00** en donde con gusto le indicaremos el centro de servicio autorizado más cercano a su domicilio.

PHILIPS MEXICANA S.A. de C.V. a través de sus centros de servicio autorizados **reparará y devolverá a usted su aparato en un plazo no mayor a 20 días hábiles,** contados a partir de la fecha de ingreso, impresa en la orden de servicio de cualquiera de nuestros centros de servicio autorizados.

La garantía de esta póliza cubre cualquier desperfecto o daño eventualmente ocasionado por los trabajos de reparación y/o traslado del aparato en el interior de nuestros centros de servicio autorizados.

Esta póliza sólo tendrá validez, si está debidamente requisitada, sellada por la casa vendedora, en caso de extravío de esta póliza, podrá hacer efectiva su garantía con la presentación de su factura de compra.

ESTA POLIZA NO SE HARA EFECTIVA EN LOS SIGUIENTES CASOS:

-Cuando el aparato sea utilizado en condiciones distintas a las normales.

-Cuando el aparato no haya sido operado de acuerdo con el instructivo de uso que se le acompaña.

-Cuando la causa de la falla o mal funcionamiento sea consecuencia de una reparación inadecuada o alteración producida por personas no autorizadas por PHILIPS MEXICANA S.A. de C.V.

PERIODOS DE GARANTIA

36 MESES.- Monitores para computadora.

12 MESES.- Televisores con y sin reproductor de video digital DVD, videocassetteras, reproductores de discos de video digital DVD, reproductores de disco de video digital con pantalla incluida, grabadores reproductores de disco de video digital DVD, grabadores reproductores de disco compacto, video proyectores (excepto la lámpara) , cámaras de video, radiograbadoras con y sin reproductor de disco compacto, reproductores de cassette portátil, reproductores de disco compacto portátil, reproductores de audio digital MP3 (Internet), decodificadores de señal (IRD), televisores para hotel, sistemas de observación, televisores de proyección, teléfonos celulares, pagers, minisistemas de audio, minisistemas de audio con reproductor de disco de video digital integrado, microsistemas de audio, sistemas de cine en casa, equipos modulares, sintonizadores, facsímils, LNB, antenas de recepción de satélite, DVD ROM, CDR ROM y CDRW ROM para computadora.

6 MESES.- radio relojes, radios A.M./F.M., auto estéreos, teléfonos inalámbricos, cámaras digitales.

3 MESES.- Accesorios, controles remotos, bocinas, cintas para fax y para cámaras de videoconferencia, audifonos.

PHILIPS

Philips Mexicana, S.A. de C.V.

Producto Importado por:
Philips Mexicana, S.A. de C.V.
 Av. La Palma No.6
 Col. San Fernando La Herradura
 Huixquilucan, Edo. de México. C.P. 52784
 Tel. 52 69 90 00

Centro de Información al Cliente
Información General
 LADA SIN COSTO PARA TODA LA REPUBLICA
01 800 504 62 00
 CORREO ELECTRONICO
 PHILIPS@TPMEX.COM

MODELO _____ No. DE SERIE _____
 La presente garantía contará a partir de: DIA _____ MES _____ AÑO _____

En caso que en su producto presente alguna falla, acuda al centro de servicio más cercano a su domicilio (según listado de talleres anexo) y en caso de tener alguna duda o pregunta por favor llame a nuestro **Centro de información al Cliente**, en donde con gusto le atenderemos en todo lo relativo a:

- * Servicio de sus aparatos Philips
- * Información de productos y Talleres Autorizados Philips
- * Asesoría en el manejo e instalación de su producto Philips
- * Información en donde puede adquirir productos y accesorios Philips

Para hacer efectiva la garantía de su producto, es necesario presentar esta póliza debidamente requisitada o de lo contrario, presentar su factura de compra.

CENTROS DE SERVICIO AUTORIZADOS PHILIPS EN LAS PRINCIPALES CIUDADES

NOTA: Los Centros que tengan (S) solo proporcionan Servicio y los que tengan (SR) venden refacciones, accesorios y proporcionan Servicio

CIUDAD	LADA	TELEFONO	CORREO ELECTRONICO		CIUDAD	LADA	TELEFONO	CORREO ELECTRONICO	
ACAPULCO, GRO	744	483-32-96	serproa@yahoo.com.mx	S	MEXICO, D. F. ZONA NORTE	55	55-67-19-92 55-67-22-56	chyr_electronica@yahoo.com.mx	S
AGUASCALIENTES, AGS	449	915-51-81	jimsaele@hotmail.com	S	MEXICO, D. F. ZONA ORIENTE	55	57-58-89-37	cnoguedam@terra.com.mx	S
CAMPECHE, CAMP.	981	816 25 75	oreza@hotmail.com	S	MEXICO, D. F. ZONA PONIENTE	55	58 12 44 12	raulmtzm@avantel.net	S
CANCUN, Q. ROO.	998	984 18 74	gammacancun@webtelmex.net.mx	S	MONTERREY, N.L	818	375-16-17 400-54-03	mcesa@prodigy.net.mx	S
CD. JUAREZ, CHIH	656	618-21-28 623-46-20	teleservicio@prodigy.net.mx	S	MORELIA, MICH	443	312-03-17	multiservicios_profesionales_de_zamorara@msn.com	S
CD. OBREGON, SON	644	412-41-51 416-20-93	mena747@prodigy.net.mx	S	NEZAHUALCOYOTL EDO. MEX	55	57-33-34-98	vicentegutierrez@prodigy.net.mx	S
CD. VICTORIA, TAMPS	834	315-66-03 312-51-93	eeil_smiller@yahoo.com.mx	S	OAXACA, OAX	951	516-47-37	elfrancistor@prodigy.net.mx	S
COLIMA, COL	312	314-03-01	tv_antenas@hotmail.com	S	ORIZABA, VER	272	724 38 53	barreda_electronics@hotmail.com	S
CUERNAVACA, MOR	777	313-00-49 313-90-92	centroserviciohertz@hotmail.com	S	PACHUCA, HGO	771	714-15-81	zarateel@hotmail.com	S
CULIACAN, SIN	667	716-15-10	stereovox@cln.megared.net.mx	S	POZA RICA, VER	782	824 47 82	sonydigital@prodigy.net.mx	S
CHIHUAHUA, CHIH	614	421-59-30 421-63-61	comercialdomestica@hotmail.com	S	PUEBLA, PUE	222	249-77-64 231-63-77	rascon12@prodigy.net.mx	S
CHILPANCIINGO, GRO.	747	471 72 73	ingelec_gro@hotmail.com	S	QUERETARO, QRO	442	216-10-09		S
DURANGO, DGO	618	825-00-05	evsurdgo@yahoo.com	S	SALTILLO, COAH	844	415 35 80	electronicadigital_07@hotmail.com	S
GUADALAJARA, JAL	33	36-15-72-62 36-16-83-27	www. Leecom.com.mx	S	SAN LUIS POTOSI, S.L.P	444	815-34-07	centro_servicioslp@prodigy.net.mx	S
HERMOSILLO, SON	662	210-54-95 210-05-86	manuelw@prodigy.net.mx	S	SATELITE, EDO. MEX	55	55 62 59 73	missus_satellite@hotmail.com	S
IRAPUATO, GTO	462	626-51-10	tv_gase@hotmail.com	S	TAMPICO, TAMPS	833	214 13 60	electromovie@prodigy.net.mx	S
LA PAZ, B.C.S	612	122-95-99	cenafila@prodigy.net.mx	S	TEPIC, NAY	311	212-66-93	spe_tn@hotmail.co	S
LEON, GTO	477	770-26-99	tecespecializados@hotmail.com	S	TIJUANA, B.C.N	664	621-22-15	www.weg1@telnor.net	S
MATAMOROS, TAMPS	868	813-50-13	digitalelectronica@comunicable.net	S	TOLUCA, EDO. MEX	722	214-83-09		S
MAZATLAN, SIN	669	982-42-21	e_santel@hotmail.com	S	TOLUCA, EDO. MEX	722	213 62 94		S
MERIDA, YUC	999	928-59-05	evia2@prodigy.net.mx	S	TORREON, COAH	871	732-49-49	jomar02@prodigy.net.mx	S
MEXICALI, B.C.N	686	561-98-08 561-98-18	bajaelectronics@aol.com	S	TUXTLA GUTIERREZ, CHIS	961	618-19-08	kcvideo@prodigy.net.mx	S
MEXICO D.F. ZONA ARAGON	55	57 94 06 34	philipservicio@hotmail.com	S	URUJAPAN, MICH	452	524-08-38 524-37-78	rosallag@mich1.telmex.net.mx	S
MEXICO D.F. ZONA CENTRO	55	55 21 60 07	unitelmex@yahoo.com.mx	SR	VERACRUZ, VER	229	932-78-23 932-44-44	antza@ver.megared.net.mx	S
MEXICO, D. F. ZONA SUR	55	55-36-71-03 55-36-25-75	centroservicioelectronico@hotmail.com	S	VILLAHERMOSA, TAB	993	314-31-36 314-61-67	villatec@intrasur.net.mx	S
MEXICO, D. F. ZONA NORTE	55	53 68 30 21	tissaser@prodigy.net.mx	S	ZACATECAS, ZAC.	492	922 31 63	sertecnur@hotmail.com	S

Para mayor referencia de Talleres de Servicio Autorizados en otras ciudades comunicarse al 01 800 504 62 00 (lada sin costo)

LISTA DE SERVIÇO AUTORIZADO - BRASIL

CABO FRIO	22-26451819	SAO BORJA	55-34311850	BOTUCATU	14-38821081	SAO PAULO	11-32222311
CAMPOS GOYTACAZES	22-27221499	SAO FCO DE PAULA	54-2441466	BOTUCATU	14-38155044	SAO ROQUE	11-47842509
CANTAGALO	22-25553033	SAO GABRIEL	55-2325833	CAMPINAS	19-32361919	SAO VICENTE	13-34628031
DUQUE DE CAMIÁS	21-27111508	SAO JOSE DO OURO	54-3521216	CAMPINAS	19-32548189	SOROCABA	15-32241170
ITACARA	22-38612740	SAO LUIZ GONZAGA	55-33521365	CAMPINAS	19-32336498	SOROCABA	15-32241170
ITAPERUNA	22-38220605	SAO MARCOS	54-2911462	CAMPINAS	19-37372500	STA BARBARA D'OESTE	19-34631211
MACAE	22-27626235	SOBRADINHO	51-37421409	CAMPO LIMPO PAULISTA	11-40392000	TABOAO DA SERRA	11-48781480
MACAE	22-27591358	STA CRUZ DO SUL	51-37155456	CAMPOS DO JORDAO	12-36622142	TAGUATINGA	16-32524039
MAGE	21-26330605	STA CRUZ DO SUL	51-37153048	CATANOVIA	17-35225254	TAUBATE	12-36219080
MITERI	21-26220157	TAPIARA	54-3442353	CERQUEILHO	15-32842121	TUPA	14-34962956
NOVA FRIBURGO	22-25327692	TAPERA	54-3851160	CRUZEIRO	12-31433859	VINHEDO	19-38765310
NOVA IGUAÇU	21-26675663	TAQUARI	51-6531291	DIADEMA	11-40430669	VOTUPORANGA	17-34215726
PETROPOLIS	24-23212737	TORRES	51-6641940	DRACENA	18-38212479		
RESENDE	24-33550101	TRES DE MAJO	55-35352101	FERNANDOPOLIS	17-34423921	SERGIPE	
RIO DE JANEIRO	21-25894622	TRES DE MAJO	55-35358277	FRANCA	16-37232898	ARACAJU	79-32119764
RIO DE JANEIRO	21-25892030	URUGUAIANA	55-34121791	FRANCO DA ROCHA	11-44492608	ARACAJU	79-32176080
RIO DE JANEIRO	21-25097136	VACARIA	54-2311396	GUARUJA	13-33582922	ESTANÇIA	79-52223235
RIO DE JANEIRO	21-24315426	VENANCIO AIRES	51-37411443	GUARULHOS	11-64513576	ITABANIA	79-4313023
RIO DE JANEIRO	21-31579290	VERA CRUZ	51-37181350	GUARULHOS	11-64431153	LAGARTO	79-6312656
RIO DE JANEIRO	21-33916353			IGARAPAVA	16-31724600		
RIO DE JANEIRO	21-23267814	RONDÔNIA		INDAÍATUBA	19-38753831	TOCANTINS	
RIO DE JANEIRO	21-31591871	ARIQUEMES	69-35353941	ITAPETINGA	15-32710936	ARAGUAINA	63-6212857
RIO DE JANEIRO	21-38675252	CACAOAL	69-4431415	ITAPIRA	19-38633802	ARAGUANINHA	63-6111818
RIO DE JANEIRO	21-25714999	CEREJEIRAS	69-33422251	ITARARE	15-35232743	GUARUJÁ	63-36441590
RIO DE JANEIRO	21-24451123	GUAJARA-MIRIM	69-35414430	ITU	11-40230188	GRUPI	63-3511038
SAO GONCALO	21-27013214	JL. PARANA	69-34211891	ITUVERAVA	16-7293365	GRUPI	63-33124470
TERESOPOLIS	21-27349647	PORTO VELHO	69-32273377	JABOTICABAL	16-32021580		
TRES RIOS	24-22556787	ROLIM DE MOURA	69-4421178	JALES	17-36324479		
TRES RIOS	24-22521388	VILHENA	69-33223321	JAU	17-36322117		
				JUNDIAÍ	11-5862182		
RIO GRANDE DO NORTE		RORAIMA		LEME	19-35713528		
CAICÓ	84-4171844	BOA VISTA	95-32249605	LMERA	19-34413179		
MOSSORO	84-33147809	BOA VISTA	95-6233456	MARLIA	14-34547327		
NATAL	84-32231249			MATAO	16-33821046		
NATAL	84-32123245	SANTA CATARINA		MAUA	11-45154233		
PAU DOS FERROS	84-3512334	BLUMENAU	47-3227742	MOGI DAS CRUZES	11-47941814		
		CANOINHAS	47-6223615	MOGI-GUAÇU	19-3818171		
RIO GRANDE DO SUL		CANOINHAS	47-6223615	MOGI-MIRIM	19-38624401		
AGUDO	55-2651036	CAMPINHAL	49-35552266	OLIMPINA	17-2811184		
ALEGRETE	55-34219689	CHAPECO	49-3223304	OSASCO	11-64837343		
BAGE	53-2241295	CHAPECO	49-32221144	OURINHOS	14-32325457		
BENTO GONCALVES	54-6524825	CONCORDIA	49-34423704	PIRACICABA	19-34403454		
CAMAQUA	51-36711686	CRICIUMA	48-34375155	PIRASSUNUNGA	19-35614091		
CAMPINAS DO SUL	54-3661300	CUNHA PORA	49-6460043	PORTO FERREIRA	19-35812441		
CANELA	54-3821551	CURITIBANOS	49-32410851	PRES PRUDENTE	18-2225168		
CAPOA DA CANOIA	51-6652638	DESCANAO	49-36230245	PRES. EPITACIO	18-2814184		
CARAZINHO	54-3302292	FLORIANOPOLIS	48-32254149	PRES.PRUDENTE	18-2217943		
CAXIAS DO SUL	54-32153107	INDAIAL	47-33333275	PROMISSAO	14-35411696		
CAXIAS DO SUL	54-2268020	IPORA DO OESTE	49-26341289	RIBEIRAO PRETO	16-36106989		
CERRO LARGO	55-3351973	ITAPOJOS	476-522282	RIBEIRAO PRETO	16-36381856		
CORONEL BICACO	55-35571397	ITAJAI	47-33444777	RIBEIRAO PRETO	16-36107553		
ERECHIM	54-3211933	JARAGUA DO SUL	47-3372050	RIO CLARO	19-35348543		
ESTANÇIA VELHA	51-35612142	JOACABA	49-35220418	S BERNARDO CAMPO	11-41257000		
FARROUPILHA	54-32683603	JOINVILLE	47-34331146	S BERNARDO CAMPO	11-413681788		
FAXINAL DO SOTURNO	55-32631150	LAGES	49-22332355	S CAETANO DO SUL	11-42214334		
FLORES DA CUNHA	54-2922625	LAGES	49-32244414	S JOAO BOA VISTA	19-36232990		
FREDECIU WESTPHALEN	55-37441850	LAGUNA	48-36462121	S JOSE CAMPOS	12-32939508		
GETULIO VARGAS	54-3411888	LAURO MULLER	48-4643202	S JOSE DO RIO PARDO	19-36085760		
GRUVA	55-33611764	MARAVILHA	49-6460052	S JOSE RIO PRETO	17-32325680		
GRAVATAÍ	51-4882830	PIRALZINHO	497-661014	S JOSE RIO PRETO	17-3232381		
HORIZONTINA	55-3371680	PORTO UNIAO	42-35232839	SALTO	11-40296563		
IBIRAJARAS	54-3551359	RIO DO SUL	47-5211920	SANTO ANDRE	11-49905288		
ILHUI	55-33327766	SAO MIGUEL D'OESTE	49-36220026	SANTOS	13-32272947		
IMBE	51-36272704	SEARA	49-4521034	SANTOS	13-32847339		
LAJEADO	51-37145155	SOMBRIJO	48-5331225	SAO CARLOS	16-33614913		
MARAU	54-33424571	TAIO	478-620576	SAO JOSE DO CAMPOS	12-39122728		
MONTENEGRO	51-6324187	TUBARAO	48-6224448	SAO JOSE RIO PRETO	17-3255241		
NONOAI	54-3621126	TUBARAO	48-6261651	SAO PAULO	11-2964622		
NOVA PRATA	54-2421328	TURVO	48-5250373	SAO PAULO	11-47036116		
NOVO HAMBURGO	51-33823191	URUSANGA	48-6451137	SAO PAULO	11-61979184		
OSORIO	55-36325254	VIDEIRA	49-35660376	SAO PAULO	11-38659897		
PALMEIRA MISSOES	55-37421407	XANXERE	49-4333026	SAO PAULO	11-62156667		
PANAMBI	55-3753488			SAO PAULO	11-69545517		
PASSO FUNDO	54-33111104	SÃO PAULO		SAO PAULO	11-36762766		
PELOTAS	53-32223633	AGUAS DE LINDOIA	19-38241524	SAO PAULO	11-66940101		
PORTO ALEGRE	51-32226941	AMERICANA	19-34062914	SAO PAULO	11-3207711		
PORTO ALEGRE	51-32536563	AMPARO	19-38072674	SAO PAULO	11-39757996		
PORTO ALEGRE	51-32248834	ARACATUBA	19-36218975	SAO PAULO	11-62976464		
RIO GRANDE	53-23232111	ARARAQUARA	16-33368710	SAO PAULO	11-56679695		
SANTA DO LIVRAMENTO	55-23411899	ATIBAIA	11-41181845	SAO PAULO	11-38751333		
SANTA MARIA	55-22222235	AVARE	14-37322142	SAO PAULO	11-55321515		
SANTA ROSA	55-35121991	BARRETOS	17-33222742	SAO PAULO	11-62809411		
SANTA VITORIA DA PALMAR	53-32633992	BATATAIS	16-37614455	SAO PAULO	11-32217317		
SANTO ANGELO	55-33131183	BAURU	14-32239551	SAO PAULO	11-37714709		
SANTO AUGUSTO	55-27811511	BRIGUI	18-36424011	SAO PAULO	11-25770899		

CERTIFICADO DE GARANTIA NO BRASIL

Este aparelho é garantido pela Philips da Amazônia Indústria Eletrônica Ltda., por um período superior ao estabelecido por lei. Porém, para que a garantia tenha validade, é imprescindível que, além deste certificado, seja apresentada a nota fiscal de compra do produto.

A Philips da Amazônia Indústria Eletrônica Ltda. assegura ao proprietário consumidor deste aparelho as seguintes garantias , a partir da data de entrega do produto, conforme expresso na nota fiscal de compra, que passa a fazer parte deste certificado:

**Garantia para rádios e reprodutores de CD portáteis
(sem caixa acústica destacável): 180 dias**

Garantia para os demais produtos da marca Philips: 365 dias.

Esta garantia perderá sua validade se:

- O defeito apresentado for ocasionado por uso indevido ou em desacordo com o seu manual de instruções.
- O produto for alterado, violado ou consertado por pessoa não autorizada pela Philips.
- O produto for ligado a fonte de energia (rede elétrica, pilhas, bateria, etc.) de características diferentes das recomendadas no manual de instruções e/ou no produto.
- O número de série que identifica o produto estiver de alguma forma adulterado ou rasurado.

Estão excluídos desta garantia defeitos decorrentes do descumprimento do manual de instruções do produto, de casos fortuitos ou de força maior; bem como aqueles causados por agentes da natureza e acidentes. Excluem-se igualmente desta garantia defeitos decorrentes do uso dos produtos em serviços não doméstico/residencial regular ou em desacordo com o uso recomendado. **ESTÃO EXCLUÍDAS DA GARANTIA ADICIONAL AS PILHAS OU BATERIAS FORNECIDAS JUNTO COM O CONTROLE REMOTO.**

Nos municípios onde não exista oficina autorizada de serviço Philips, as despesas de transporte do aparelho e/ou do técnico autorizado, correm por conta do Sr: Consumidor requerente do serviço.

A garantia não será válida se o produto necessitar de modificações ou adaptações para habilitá-lo a operar em qualquer outro país que não aquele para o qual foi designado, fabricado, aprovado e/ou autorizado, ou ter sofrido qualquer dano decorrente deste tipo de modificação.

Philips da Amazônia Indústria Eletrônica Ltda.

Dentro do Brasil, para informações adicionais sobre o produto ou para eventual necessidade de utilização da rede de oficinas autorizadas, ligue para o Centro de Informações ao Consumidor (CIC). Em São Paulo - Capital e demais localidades com DDD 011 - tel. 2121-0203, nas demais localidades e estados - tel. 0800 701 02 03 (discagem direta gratuita), ou escreva para Caixa Postal: nº 21.315 - CEP04602-970 - São Paulo - SP, ou envie um e-mail para: cic@philips.com.br
Horário de atendimento: de segunda à sexta-feira, das 08:00 às 20:00 h; aos sábados das 08:00às13:00h.

*Para atendimento fora do Brasil, contate a Philips local ou a:
Philips Consumer Service
Beukenlaan 2
5651 CD Eindhoven
The Netherlands*

Certificado de Garantía en Argentina

Artefacto:

Modelo:

**Fabricante/Importador: Philips Argentina S.A.
y/o Fábrica Austral de Productos Eléctricos S.A.**

Dirección: Vedia 3892 - Buenos Aires

Fecha de Venta:

--

Nro. de serie

Firma y sello de la casa vendedora.

PHILIPS ARGENTINA S.A. en adelante denominada “la empresa”, garantiza al comprador de este artefacto por el término de (6) meses a partir de la fecha de adquisición, el normal funcionamiento contra cualquier defecto de fabricación y/o vicio de material, y se compromete a reparar el mismo —sin cargo alguno para el adquirente— cuando el mismo fallare en situaciones normales de uso y bajo las condiciones que a continuación se detallan:

1. Este certificado de garantía es válido únicamente en la Republica Argentina. El certificado debe ser completado por la casa vendedora y ser presentado por el usuario conjuntamente con la factura original de compra.
2. Serán causas de anulación de esta garantía en los casos que corresponda:
 - 2.1. Uso impropio o distinto del uso doméstico.
 - 2.2. Exceso o caídas de tensión eléctrica que impliquen uso en condiciones anormales.
 - 2.3. Instalación y/o uso en condiciones distintas a las marcadas en el “Manual de instalación y uso” que se adjunta a esta garantía.
 - 2.4. Cualquier intervención al artefacto por terceros no autorizados por la empresa.
3. La garantía carecerá de validez si se observare lo siguiente:
 - 3.1. Enmiendas o raspaduras en los datos del certificado de garantía o factura.
 - 3.2. Falta de factura original de compra que detalle tipo de artefacto, modelo, número de serie y fecha que coincida con los del encabezamiento del presente certificado.
4. No están cubiertos por esta garantía los siguientes casos:
 - 4.1. Los daños ocasionados al exterior del gabinete.
 - 4.2. Las roturas, golpes, caídas o rayaduras causadas por traslados.
 - 4.3. Los daños o fallas ocasionados por deficiencias, sobretensiones, descargas o interrupciones del circuito de alimentación eléctrica o rayos, deficiencias en la instalación eléctrica del domicilio del usuario o conexión del artefacto a redes que no sean las especificadas en el Manual de Uso del mismo.
 - 4.4. Las fallas, daños, roturas o desgastes producidos por el maltrato o uso indebido del artefacto y/o causadas por inundaciones, incendios, terremotos, tormentas eléctricas, golpes o accidentes de cualquier naturaleza.
 - 4.5. Las fallas o daños ocasionados en desperfectos en la línea telefónica.
 - 4.6. Las fallas producidas por una mala recepción ocasionada en el uso de una antena deficiente o en señales de transmisión débiles.
5. Las condiciones de instalación y uso del artefacto se encuentran detalladas en el Manual de Uso del mismo.
6. La empresa no asume responsabilidad alguna por los daños personales o a la propiedad al usuario o a terceros que pudieran causar la mala instalación o uso indebido del artefacto, incluyendo en este último caso a la falta de mantenimiento.
7. En caso de falla, el usuario deberá requerir la reparación a la empresa a través del Service Oficial y/o Talleres Autorizados más próximos a su domicilio y cuyo listado se acompaña al presente. La empresa a segura al usuario la reparación y/o reposición de piezas para su correcto funcionamiento en un plazo no mayor a 30 días contados a partir de la fecha de solicitud de reparación, salvo caso fortuito o fuerza mayor.

8. Toda intervención del servicio técnico realizada a pedido del usuario dentro del plazo de garantía, que no fuera originada por falla o defecto alguno cubierto por este certificado, deberá ser abonado por el interesado de acuerdo a la tarifa vigente.
9. El presente certificado anula cualquier otra garantía implícita o explícita, por la cual y expresamente no autorizamos a ninguna otra persona, sociedad o asociación a asumir por nuestra cuenta ninguna responsabilidad con respecto a nuestros productos.
10. En caso de que durante el período de vigencia de esta garantía el artefacto deba ser trasladado a las Delegaciones Oficiales y/o Talleres Autorizados de Service para su reparación, el transporte será realizado por la empresa y serán a su cargo los gastos de flete y seguros y cualquier otro que deba realizarse para su ejecución.



PHILIPS

Red de Talleres Autorizados en Argentina

CAPITAL FEDERAL

ATTENDANCE S.A.

- Av. Monroe 3351 (C1430BKA) Cap. Fed.
- Tel.: 4545-5574/0704 ó 6775-1300
- Ventas de Repuestos y Accesorios
- Tel.: 4545-0854

DIG TRONIC

- Av. San Martín 1762 (C1416CRS) Cap. Fed.
- Tel.: 4583-1501

ELECTARG S.R.L.

- Av. Córdoba 1357 (C1055AAD) Cap. Fed.
- Ventas de Repuestos y Accesorios
- Tel.: 4811-1050

Caballito Electarg J. M. Moreno 287 4903-6967/6854/8983

BUENOS AIRES

Azul	Herlein Raúl Horacio	Av. 25 de Mayo 1227	(02281) 428719
Bahía Blanca	Neutron	Soler 535	(0291) 4535329
Bragado	Yacovino Juan J.	San Martín 2141	(02342) 424147
Campana	Electricidad Krautor	Lavalle 415	(03489) 432919
Chivilcoy	Fama	Coronel Suárez 110	(02346) 424129
Junín	Junín Service	Alsina 537	(02362) 442754
La Plata	Da Tos e Hijos	Calle 68 N° 1532	(0221) 4516021
La Plata	Service Técnico La Plata	Av. 51 N° 1051 esq. 16	(0221) 4108155
Mar de Ajó	Tauro Electrónica	Catamarca 14	(02257) 421750
Mar del Plata	Central Service	Olazábal 2249	(0223) 4721639/4729367
Mar del Plata	Service Integral	Diag. Pueyrredón 3229	(0223) 4945633
Necochea	Electrónica Camejo	Calle 63 N° 1745	(02262) 426134
Pehuajó	Calcaigni Carlos Alberto	Zubiría 794	(02396) 472665
Pergamino	ACV Sistemas	Dr. Alem 758	(02477) 421177
Pergamino	El Service	Juan B. Justo 1931	(02477) 418000

San Nicolás	Servitec	Bv. Alvarez 148	(03461) 454729/429578
San Pedro	Electrónica Menisale	Mitre 1695	(03329) 425523
Tandil	Lazzarini Oscar Rafael	Pellegrini 524	(02293) 442167
Trenque Lauquen	Labruno Electrónica	Av. San Martín 426	(02392) 423248
Tres Arroyos	Saini Fabián y Sergio	Av. Belgrano 562	(02983) 427369
Zárate	Electrónica Spinozzi	Ituzaingó 1030	(03487) 427353

GRAN BUENOS AIRES

Avellaneda	Casa Torres S.A.	Av. Mitre 2559	4255-5854
Florencio Varela	Casa Torres S.A.	San Martín 2574	4255-5854
Gregorio de Laferrere	Electrónica Alvarez	Honorio Luque 6084	4626-1322
Lomas de Zamora	Attendance S.A. Lomas	Laprida 485	4292-8900
Merlo	Argentónica S.H.	Pte. Cámpora 2175	(0220) 4837177/4829934
Moreno	Argentónica S.H.	Bmé. Mitre 2977 loc.2	(0237) 4639500
Morón	Servotronic	Ntra. Sra. del Buen Viaje 1222	4627-5656
Olivos	Appliance	Av. Libertador 2684	4794-7700
Quilmes	Casa Torres S.A.	E. Ríos esq. Gran Canaria	4255-5854
Ramos Mejía	Electarg S.R.L. Suc.	Belgrano 224	4656-0619
San Miguel	Servotronic San Miguel	Belgrano 999	4664-4131
Villa Ballester	Servotronic	J. Hernández 3101	4767-2515/4768-5249

CATAMARCA

Catamarca	Omicron Central de Serv.	San Martín 225	(03833) 427235
-----------	--------------------------	----------------	----------------

CHACO

Resistencia	Freschi Jorge Oscar	Av. Avalos 320	(03722) 426030
-------------	---------------------	----------------	----------------

CHUBUT

Comodoro Rivadavia	C.A.S. S.R.L.	Alem 145	(0297) 4442629
Trelew	Fagtron Electrónica	Brasil 253	(02965) 427073

CORDOBA

Córdoba Capital	Servelco S.R.L.	Pje. E. Marsilia 635	(0351) 4724008/4732024
Río Cuarto	Maurutto Victor G.	Bv. Almaguer 487	(0358) 4660204
Río Cuarto	Capaldi Abel	Paunero 832	(0358) 4623003
Río Tercero	Service Omega	Homero Manzi 149	(03571) 423330
San Francisco	Acuña Walter Electrónica	M. Moreno 360	(03564) 425367
Villa María	Grasso Electrónica	Bv. Alvear 541	(0353) 4521366
Villa María	Vanguard Sist. Electrónicos	México 421	(0353) 4532951

