



Philips SoClear
Cordless phone with
answering machine

30 min answering machine

1.9" display/ amber backlight
Speakerphone
2 handsets



XL3952S

Comfortable and simple

Easy to see, easy to hear

So comfortable, so user-friendly: this PhilipsXL3952S/DE cordless phone features extra-large buttons and a big screen - to make calls easy. With loud sound capabilities, as well as an inbuilt answering machine, it makes it all so simple.

Hear everything loud and clear

- Extra loud sound for clear voice reproduction
- Handset speakerphone allows you to talk handsfree
- Hearing aid compatible - reduces unwanted noise
- Optimized antenna layout for great reception in any room

Smart, simple and easy to use

- Up to 30 min. message on your answering machine
- Extra loud ringer, so you never miss a call
- Large display and easy to read characters
- Instantly call your loved ones via speed-dial keys
- Ultimate convenience through easy setup
- Up to 17 hours of talk time

Eco-conscious product

- Zero power emission when ECO+ mode is activated
- Low power consumption: < 0.65 W in stand-by mode

Cordless phone with answering machine
30 min answering machine 1.9" display/ amber backlight, Speakerphone, 2 handsets

XL3952S/DE

Highlights

Easy setup

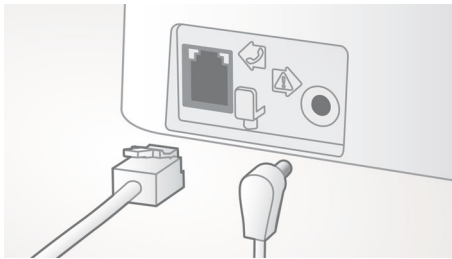

Ultimate convenience through easy set up.
Simplified installation - Plug & Play product

Extra loud ringer

Extra loud ringer, so you never miss a call

Extra loud sound



Extra loud sound for clear voice reproduction

Handset speakerphone



Handsfree mode uses a built-in loud speaker to amplify the voice of the caller, allowing you to speak and listen during a call without holding the phone to your ear. This is especially useful if you want to share the call with others or simply multitask.

Hearing aid compatible



Hearing aid compatible - reduces unwanted noise

Instant calling



Instantly call your loved ones via speed-dial keys

Large, easy to read display



Large display and easy to read characters

Optimized antenna layout



Our optimized antenna layout ensures strong and stable reception – even in areas of the

house where cordless transmission is difficult. Now you can take a call wherever you are in the house, and enjoy a long, uninterrupted conversation even as you walk around.

Up to 17 hours talk time

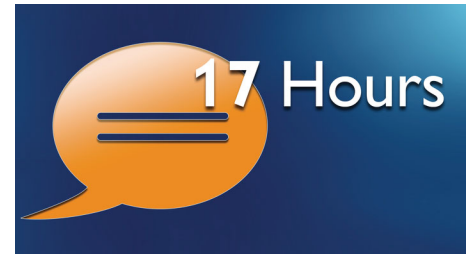

The phone can support up to 17 hours conversation on a single charge.

ECO+ mode

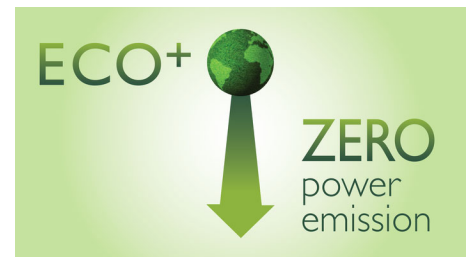

The ultimate mode to save transmitting power.



asimpleswitch.com

Philips Green Logo

Philips Green Products can reduce costs, energy consumption and CO2 emissions. How? They offer a significant environmental improvement in one or more of the Philips Green Focal Areas – Energy efficiency, Packaging, Hazardous substances, Weight, Recycling and disposal and Lifetime reliability.

Specifications

Sound

- Hearing Aid Compatible
- Volume control on handset
- Ringtones on handset: 10 polyphonic

Picture/Display

- Display size: 4.8 cm / 1.9"
- Display type: FSTN - dot matrix
- Backlight: Yes
- Backlight color: Soft Amber

Answering Machine

- Recording time capacity: up to 30 minutes
- Pre-recorded OGM
- Message counter on base: LED (Soft Amber)
- Answering machine control: from base & handset
- Loud speaker on base

Convenience

- Menu structure in the handset: List Menu
- Speakerphone - talk handsfree
- Personalization: Silence mode
- Signal strength indicator: 3- bar indicator
- Battery level indicator: 3- bar battery icon
- Intercom - multiple handsets
- Date / Time display
- Alarm Clock
- Battery charge indication
- Programmable hot keys: Key 1 and 2, and M1/2/3
- Call Management: Call Waiting*, Caller ID*, Microphone mute, Missed Calls, Received Calls
- Key tone on/off
- Auto hang up
- Multi base capability: 1
- Multi handset capability: Up to 4
- Number of keys: 23
- Backlit keypad: Soft Amber
- Base Station keys: Paging key
- Up to 17 hrs talk time
- Up to 300 hrs standby time
- Charge time: 8 hours
- Line cord length: 1.8m

- Power cord length: 1.8m
- Range: Open field <300m; in door <50m

Memory Capacity

- Phonebook: 100 names and numbers + 2 direct access memories
- Redial List Capacity: 20 entries
- Call log entries: 50 entries
- Phonebook store in the base

Power

- Battery Capacity: 650 mAh
- Battery type: AAA NiMH Rechargeable
- Mains power: AC 100-240V ~50/60Hz

Security

- Transmission encryption : Yes

Network Features

- Compatible: GAP

SAR Value

- Philips handsets: <0.1 W/kg

Eco Design

- EcoMode: automatic & manual
- Full ECO Mode (NEMO)

Packaging dimensions

- Packaging type: Carton
- Number of products included: 1
- Type of shelf placement: Laying
- Packaging dimensions (W x H x D):
19.7 x 15.7 x 11.9 cm
- Packaging dimensions (W x H x D):
7.8 x 6.2 x 4.7 inch
- Gross weight: 0.87 kg
- Nett weight: 0.719 kg
- Tare weight: 0.151 kg
- Gross weight: 1.918 lb
- Nett weight: 1.585 lb
- Tare weight: 0.333 lb
- EAN: 87 12581 61259 7



Issue date 2019-05-31

Version: 5.3.4

12 NC: 8670 000 79816
EAN: 87 12581 61259 7

© 2019 Koninklijke Philips N.V.
All Rights reserved.

Specifications are subject to change without notice.
Trademarks are the property of Koninklijke Philips N.V.
or their respective owners.

www.philips.com