

始终如一地为您提供帮助

在以下网站上注册产品并获得支持
www.philips.com/support

AE1500



ZH-CN 简明用户手册
EN Short User Manual

PHILIPS



Specifications are subject to change without notice.
2015 © Gibson Innovations Limited. All rights reserved.
This product has been manufactured by, and is sold under the responsibility of WOOX Innovations (Shanghai) Commercial Company Ltd., and WOOX Innovations (Shanghai) Commercial Company Ltd., is the warrantor in relation to this product.
Philips and the Philips Shield Emblem are registered trademarks of Koninklijke Philips N.V. and are used under license from Koninklijke Philips N.V.

AE1500_93_Short User Manual_V1.0



ZH-CN

1 重要信息



警告

- 切勿拆下本产品的外壳。
 - 切勿润滑本产品的任何部件。
 - 切勿将本装置放在其它电器设备上面。
 - 应让本产品远离阳光直射、明火或高温。
-
- 请确保产品周围有足够的空间进行通风。
 - 仅使用制造商指定的附件或配件。
 - 电池使用警告 – 为防止电池漏液而造成人身伤害、财产损失或产品损坏，请：
 - 按产品上标明的 + 极和 - 极，正确安装电池。
 - 请勿混合使用电池（旧电池与新电池或碳电池与碱性电池，等等）。
 - 若打算长期使用本产品，应取出电池。
 - 不可将电池置于高温环境，如阳光直射处、明火或类似环境。
 - 切勿将产品暴露在漏水或溅水环境下。
 - 不要将任何危险源放在本产品上（例如装有液体的物体、点燃的蜡烛）。

听力安全



以中等音量收听。

- 以高音量使用耳机会损坏您的听力。此产品产生的声音分贝范围可能导致正常人丧失听力，即使收听不到一分钟。较高的分贝范围适用于已经丧失了部分听力的人。
- 声音是具有欺骗性的。随着时间的过去，您听力的“舒适级别”会要求较高的音量。因此，较长时间的收听之后，“正常”的音量实际上可能很大声，对您的听力有害。要防止此情况发生，请在您的听力适应之前，将音量设置到安全级别并保持不变。

要设置安全的音量级别：

- 将音量控制设置为较低设置。
- 慢慢调高声音，直到可以舒适、清晰地听见而不失真即可。

合理的收听时间：

- 较长时间的收听，即使是正常的“安全”级别，也同样会导致听力受损。
- 请确保合理使用设备，并进行适当的休息。

使用耳机时请确保遵循以下准则。

- 在合理时间内以合理音量收听。
- 听力适应后，请勿调节音量。
- 不要将音量调得太高，以致于听不到周围的声音。
- 在有潜在危险的情况下应谨慎使用或暂停使用。请勿在驾驶机动车、骑自行车、进行滑板运动等情况下使用耳机；否则可能会造成交通事故，而且这在许多地区属于非法行为。

注

- 铭牌（铭牌上的信息包括工作电压）位于产品背面，使用前请先了解铭牌上的相关信息。

2 注意

如果用户未经 Gibson Innovations 的明确许可而擅自对此设备进行更改或修改，则可能导致其无权操作此设备。

弃置旧产品



本产品采用可回收利用的高性能材料和组件制造而成。弃置产品时，请不要将其与一般生活垃圾一同丢弃，应将其交给政府指定的回收中心或回收。这样做有利于环保。

环境信息

为使包装尽量简化，已省去所有不必要的包装材料。包装材料分为三类：纸板（盒）、泡沫塑料（缓冲物）和聚乙烯（袋、保护膜）。本系统的所有材料均可回收和再利用（如果由专业公司拆卸）。请遵守当地有关包装材料、废电池和旧设备的处理的规定。

EN

1 Important



Warning

- Never remove the casing of this product.
- Never lubricate any part of this product.
- Never place this product on other electrical equipment.
- Keep this product away from direct sunlight, naked flames or heat.

- Make sure that there is enough free space around the product for ventilation.
- Only use attachments or accessories specified by the manufacturer.
- Battery usage CAUTION – To prevent battery leakage which may result in bodily injury, property damage, or damage to the product:
 - Install the batteries correctly, + and - as marked on the product.
 - Do not mix batteries (old and new or carbon and alkaline, etc.).
 - Remove the batteries when the product is not used for a long time.
 - The batteries shall not be exposed to excessive heat such as sunshine, fire or the like.
- The product shall not be exposed to dripping or splashing.
- Do not place any sources of danger on the product (e.g. liquid filled objects, lighted candles).

Hearing safety



Listen at a moderate volume.

- Using headphones at a high volume can impair your hearing. This product can produce sounds in decibel ranges that may cause hearing loss for a normal person, even for exposure less than a minute. The higher decibel ranges are offered for those that may have already experienced some hearing loss.
- Sound can be deceiving. Over time your hearing 'comfort level' adapts to higher volumes of sound. So after prolonged listening, what sounds 'normal' can actually be loud and harmful to your hearing. To guard against this, set your volume to a safe level before your hearing adapts and leave it there.

To establish a safe volume level:

- Set your volume control at a low setting.
- Slowly increase the sound until you can hear it comfortably and clearly, without distortion.

Listen for reasonable periods of time:

- Prolonged exposure to sound, even at normally 'safe' levels, can also cause hearing loss.
- Be sure to use your equipment reasonably and take appropriate breaks.

Be sure to observe the following guidelines when using your headphones.

- Listen at reasonable volumes for reasonable periods of time.
- Be careful not to adjust the volume as your hearing adapts.
- Do not turn up the volume so high that you can't hear what's around you.
- You should use caution or temporarily discontinue use in potentially hazardous situations. Do not use headphones while operating a motorized vehicle, cycling, skateboarding, etc.; it may create a traffic hazard and is illegal in many areas.

Note

- The type plate is located on the back of the product.

2 Notice

Any changes or modifications made to this device that are not expressly approved by Gibson Innovations may void the user's authority to operate the equipment.

Disposal of your old product



Your product is designed and manufactured with high quality materials and components, which can be recycled and reused.

Do not throw away the product with the normal household waste at the end of its life, but hand it in at an official collection point or recycling. By doing this, you help to preserve the environment.

Environmental information

All unnecessary packaging has been omitted. We have tried to make the packaging easy to separate into three materials: cardboard (box), polystyrene foam (buffer) and polyethylene (bags, protective foam sheet.) Your system consists of materials which can be recycled and reused if disassembled by a specialized company. Please observe the local regulations regarding the disposal of packaging materials, exhausted batteries and old equipment.

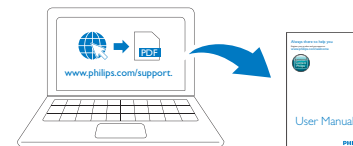

ZH-CN 要下载完整用户手册，请访问 www.philips.com/support。

EN To download the full user manual, visit www.philips.com/support.

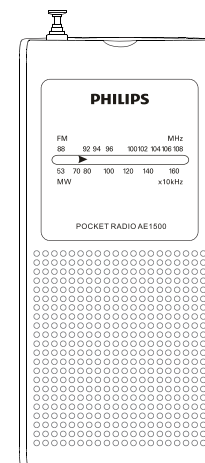

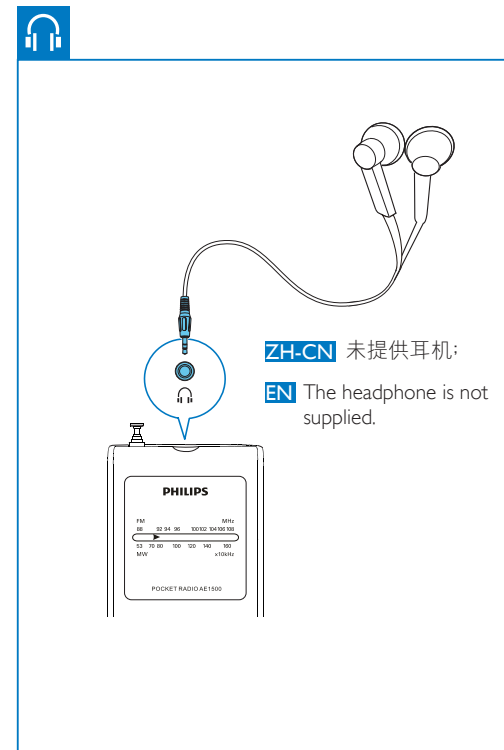
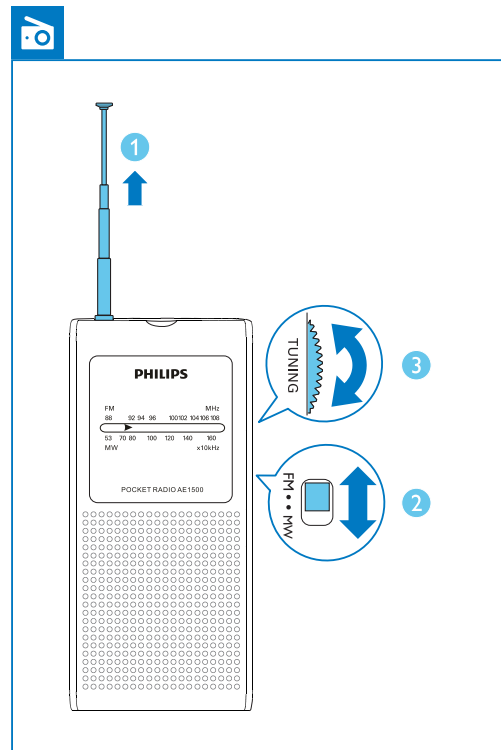
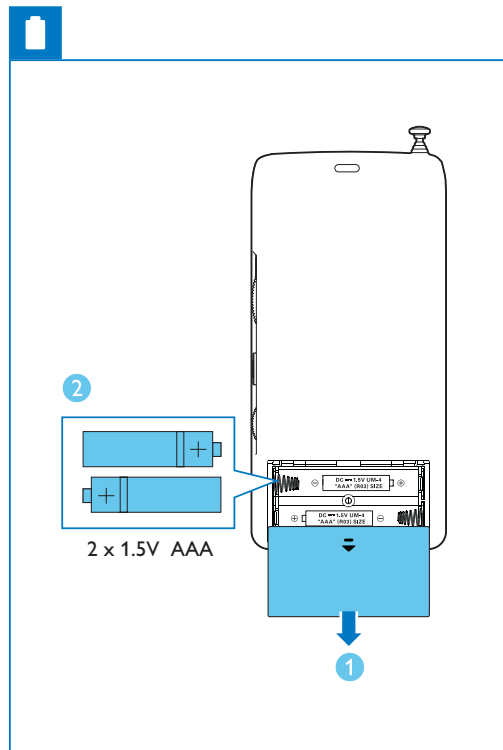

ZH-CN 规格	
总输出功率	0.2 瓦 RMS
调谐范围	FM: 88-108 兆赫 MW: 540-1620 千赫
灵敏度	FM: 26dB 信噪比<22 dBf MW: 26dB 信噪比<70 dBf
总谐波失真	<2%
信噪比 (FM)	>50 dBA
电源	AAA 型: 2 节 R03 或 UM4 电池 (未随附)
尺寸: 主装置 (宽 x 高 x 厚)	57 x 133 x 22 毫米
重量 - 主装置	0.07 千克

EN Specifications	
Total Output Power	0.2W RMS
Tuning Range	FM: 88-108 MHz MW: 540-1620 KHz
Sensitivity	FM: 26dB S/N Ratio<22 dBf MW: 26dB S/N Ratio<70 dBf
Total Harmonic Distortion	<2%
Signal to Noise Ratio (FM)	>50 dBA
Power Supply	Type AAA; R03 or UM4 batteries x 2 pcs (not supplied)
Dimensions: Main Unit (W x H x D)	57 x 133 x 22 mm
Weight - Main Unit	0.07 kg

产品中有害物质的名称及含量 Names and Contents of Hazardous Substances

部件名称 Name of the Parts	有害物质 Hazardous Substances					
	铅 (Pb, Lead)	汞 (Hg, Mercury)	镉 (Cd, cadmium)	六价铬 (Chromium (VI))	多溴联苯 (PBB)	多溴二苯醚 (PBDE)
Housing 外壳	○	○	○	○	○	○
Loudspeakers 喇叭单元	○	○	○	○	○	○
PWBs 电路板组件	X	○	○	○	○	○
Accessories (Cables) 附件 (电源线, 连接线)	X	○	○	○	○	○

本表格依据SJ/T 11364的规定编制。
The table is compiled according to SJ/T 11364.

○: 表示该有害物质在该部件所有均质材料中的含量均在 GB/T 26572 标准规定的限量要求以下。
○: Indicates that this hazardous substance contained in all of the homogeneous materials for this part is below the limit requirement in GB/T 26572.

×: 表示该有害物质至少在该部件的某一均质材料中的含量超出 GB/T 26572 标准规定的限量要求。

X: Indicates that this hazardous substance contained in at least one of the homogeneous materials used for this part is above the limit requirement in GB/T 26572.



环保使用期限 Environmental Protection Use Period

这标志表示的期间 (10年) 是电子电气产品中有害物质在正常使用的条件下不会发生外泄或突变, 电子电气产品用户使用该电子电气产品不会对环境造成严重污染或对其人身、财产造成严重损害的期限。

This logo refers to the period (10 years) during which the hazardous substances in electronic and electrical products will not leak or mutate so that the use of these [substances] will not result in any severe environmental pollution, any bodily injury or damage to any assets.