

# Quick Start Guide



Step A **Connect**

Step B **Setup**

Step C **Enjoy**

## What's in the Box?

You should find these items upon opening the box.

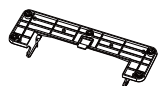
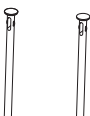

Table stand



Studs (x2) used to attach speakers to main unit



Smart remote control (with battery)

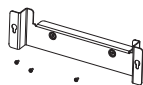

Wall mount bracket and screws (x4)

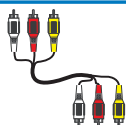

AV cable



Coaxial cable (orange)



SCART adaptor

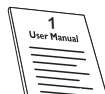

User manual



Quick Start Guide

**PHILIPS**

# Step A **Connect**

## Tips

- See the *User Manual* for how to mount the main unit and speakers onto wall.
- See “Connect AV devices” for more AV connection options.
- For connection and operation of your AV devices, see the respective user manuals.

1

Attach speakers to the main unit.

2

Slide the table stand onto the bottom of the main unit.

3

Place the main unit and speakers.

4

Connect AV devices

5

Connect power.

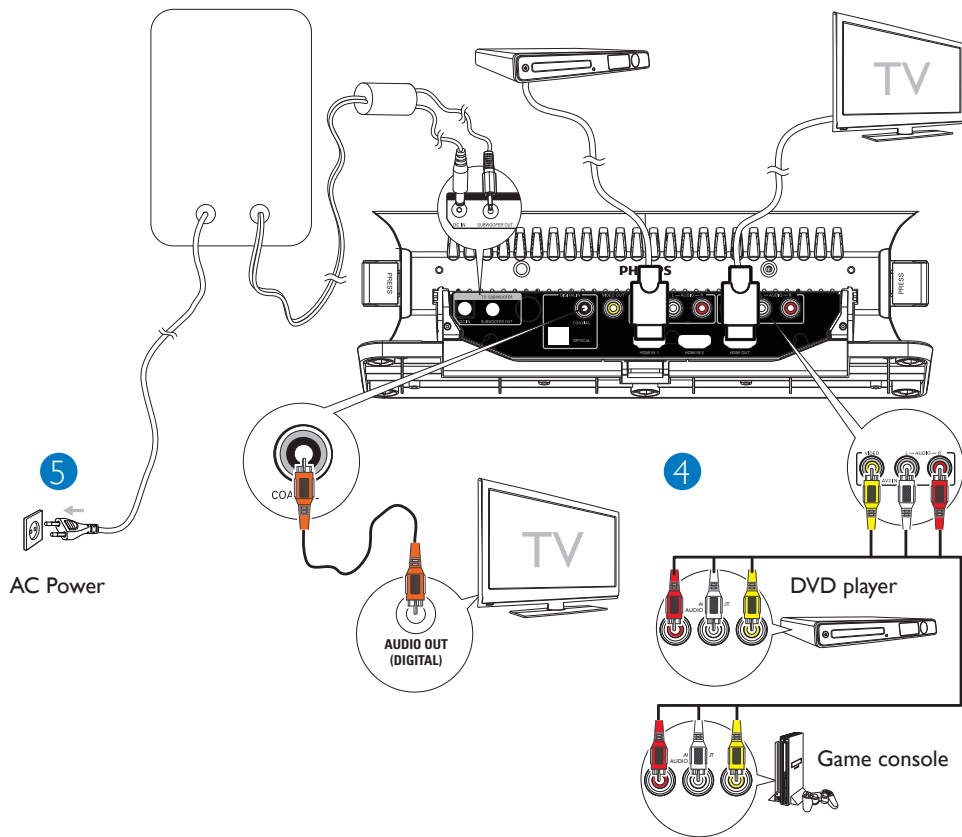
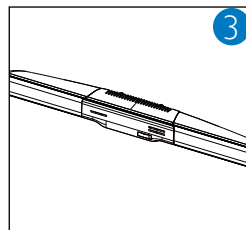
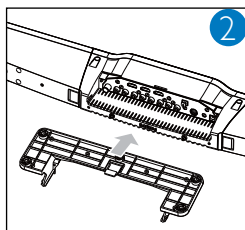
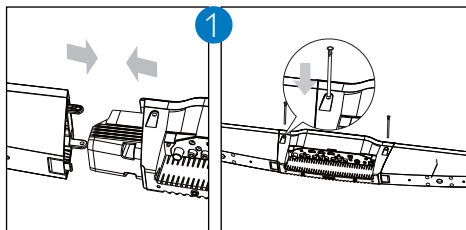

## Step B Setup

### Set clock

#### IMPORTANT!

– To set clock in the Eco Power Standby mode, first press and hold  for more than 2 seconds to switch to the standby mode.

1

In the standby mode, press and hold **CLOCK** to enter the clock setting mode.  
→ **Clock** is displayed and the hour digits begin to blink.

2

Press **+VOL** - to set the hour.

3

Press **CLOCK** to confirm.  
→ The minute digits begin to blink.

4

Press **+VOL** - to set the minute.

5

Press **CLOCK** to confirm the clock setting.

## Step C Enjoy

### Play from USB

1

Flip open the cover on the front panel.

2

Insert the USB plug of a USB device into the  socket.

3

Press **USB** to select the USB source.  
→ The total number of tracks is displayed.

4

Press **ALB/PRESET/▲▼** to select a folder.

5

Press **◀/▶** to select a file.

6

Press **▶||** to start play.

## Play connected AV devices

1

Press **AV**, **HDMI**, or **COAX/OPT** to select an AV source.

### Tip

*Detailed playback features and additional functions are described in the accompany owner's manual.*



© Royal Philips Consumer Lifestyle N.V.  
2008

All rights reserved.

<http://www.philips.com>

