



[www.philips.com](http://www.philips.com)  
[www.philips.com/mobilelink](http://www.philips.com/mobilelink)

© 2012 Koninklijke Philips Electronics N.V.  
All rights reserved. Reproduction in whole or in part is prohibited without the prior written consent of the copyright owner. The information presented in this document does not form part of any quotation or contract, is believed to be accurate and reliable and may be changed without notice. No liability will be accepted by the publisher for any consequence of its use. Publication thereof does not convey nor imply any license under patent or other industrial or intellectual property rights.

Screenshots may not fully reflect latest product software.



All calls – landline and mobile – on one phone

Philips premium cordless phones with MobileLink

**PHILIPS**  
sense and simplicity

# The best of both worlds

Your mobile phone – it's often the number your friends call first and the device to store contacts.

So now wonder they are also increasingly used at home – yet this has its challenges. With batteries often empty after a long day of usage, mobile phones are docked or not close by while being charged. There are also “black spots” without mobile phone coverage inside buildings.

What's more, your mobile phone may contain personal content, which makes it difficult to share your phone with others as a “family phone”.

With this in mind, Philips has launched its series of premium cordless phones, with timeless design and features to enhance both your calls via landline and mobile line. All phones in this range share four key characteristics:

The top of the line S10 features a large capacitive touchscreen, premium design and is crafted for comfort from lightweight aluminium. Also built from premium materials the S9 is a compact yet powerful phone.

The SE888 has an integrated mobile phone charger for professionals working from home, while the S8A is a fully featured entry model of the premium range.

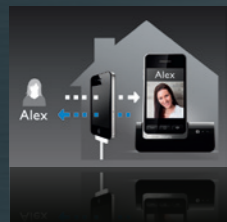

## The ultimate convenience of MobileLink

- All calls – mobile and landline – from one phone
- Easily download your mobile phone contacts
- Clear mobile calls even in weak reception areas while using a mobile connection
- Connect up to 2 mobile phones

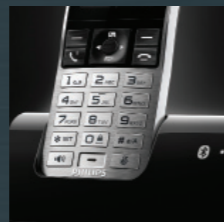

## Outstanding design and finishing

- Sleek modern look
- Crafted for comfort from lightweight aluminium
- Compact yet fully functional and stable base



## Premium user interface

- Enables quick and easy access to the phone functions
- Friendly, graphical and colorful interface
- Easy to customize with photos and ringtones



## Best in class sound quality

- Precise acoustic design for superb, powerful sound
- Digital sound processing for natural voice reproduction
- Advanced testing for pure, undistorted clarity



S10



S9



SE888



S8A

# The ultimate in ease and convenience



All calls – mobile and landline – all on one phone

Easily connect up to 2 mobile phones to your MobileLink-enabled home phone via *Bluetooth*® and enjoy all your fixed and mobile calls on just one smart handset. You'll always know which line an incoming call is coming from and can easily choose which line to use for an outgoing call.

Always charged and ready

You'll discover one of the best benefits is your mobile phone can charge while you use its line on your MobileLink-enabled home phone.

Easy to set up, easy to use

MobileLink's easy transfer feature lets you access your contacts from each of 2 connected mobile phones. Just download all your contacts from your mobile phone, PC, Mac or Google Contacts via *Bluetooth*® and start talking. No more retyping each number again.



Crystal clear calls anywhere, everywhere

Say goodbye to dropped calls due to mobile network black spots. Simply place your mobile phone where reception is strongest and link it up with the base unit of your MobileLink-enabled home phone for crystal clear calls.

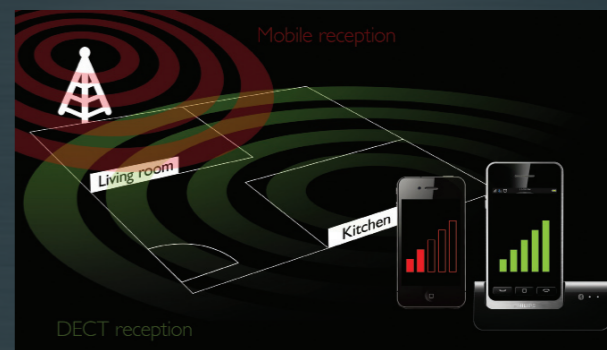

# A personal touch to stay in touch

Philips premium cordless phones are ready to be personalized just the way you want. Give your phone a personal touch by selecting your own ringtones, screensaver- and background pictures.

A new user-friendly visual interface gives you quick and easy access to key functions such as call logs, phonebook, dial pad and

immediate and highly visible notification of missed calls, messages and more.

The S9 and S10 make use of large, high quality screens for vibrant color reproduction and the S10 screen offers accurate, highly sensitive touch recognition. Bright, appealing and intuitive, you'll find the graphical interface a pleasure to use.

## Packed with powerful features

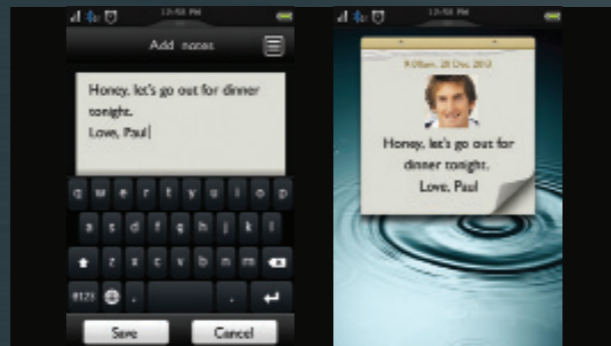

## Family notes

Now there's a handy way to leave messages for family members. The S9 and S10 offer a unique "Family notes" application. Any note can be set so it is displayed when the phone is in idle mode.





## Call barring

Call barring blocks outgoing calls to certain numbers, such as undesirable area codes or phone numbers.

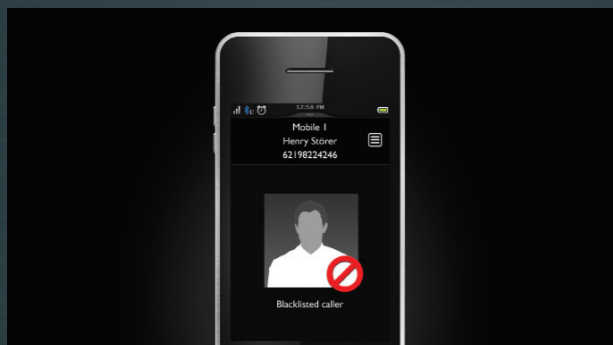

## Call blocking

Call blocking silences the ringtone for callers on a blacklist or, if desired, for any anonymous incoming call. This protects your privacy by preventing calls from telemarketers or people you don't know.

## Silent mode

By switching on silent mode, the ringtone will be disabled during the times you specify, which is ideal when you want to sleep through the night uninterrupted. The silent mode can exclude important contacts such as close family members or friends.

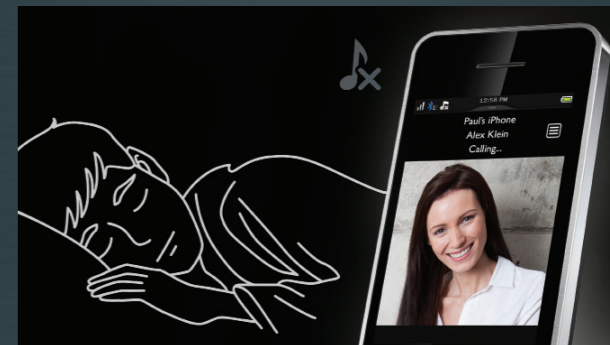

## Personalized ringtone

The S9 and S10 can convert ringtones from any MP3 file and come with 10 high quality ringtones pre-loaded.

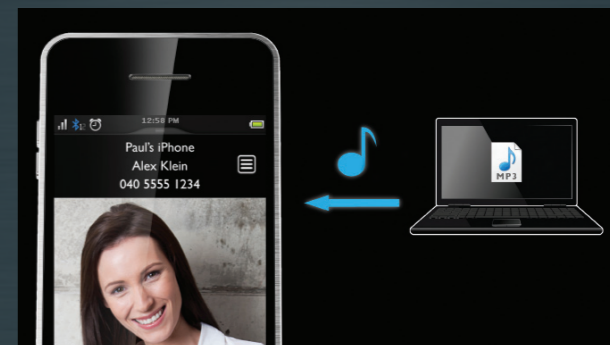

# Style meets substance



## Screensaver

Bring back your favorite memories with the screensaver function on the vibrant screens of the S9 and S10. They can display multiple photos in fullscreen mode, with the option of inserting a clock in the show.



## Handsfree options and the perfect accessory<sup>1</sup>

Now you can enjoy different ways to keep your hands free during your calls. Both the S9 and S10 support *Bluetooth*<sup>®</sup> headsets with a 10m range around the base. For a wider range of up to 300m, simply connect the Philips MT3120 handsfree phone to the base. You can also use corded 3.5mm headsets with microphone for the S10.

<sup>1</sup> Headset and handsfree phone accessory aren't included



Philips premium cordless phones are designed to impress and built to last, crafted from lightweight aluminium and other high quality materials.

More than just aesthetically pleasing, these materials provide superior comfort, structural integrity and reliability.

The S9 and S10 both come with a compact yet fully functional base with built-in cable management, ensuring it looks good from all angles. Integrated ECO and ECO+ features reduce radiation and power emission of the base and make it an environmentally responsible choice.

# HQ-Sound that will blow you away

Best in class audio quality has always been a hallmark of Philips cordless phones and this proud tradition is carried on in our range of premium cordless phones. When we say “best in class”, you’re truly getting the very best there is.



Precise acoustic design for superb, powerful sound

Superb, powerful sound is assured through the precise acoustic design and carefully selected components built into controlled enclosures and housings.



Digital sound processing for natural voice reproduction

With MySound Pro you are in control of how the phone “sounds”. Everyone has different sound preferences, so you can choose if you prefer a “warm / clear / balanced / powerful / bright” sound.

Then there’s digital sound processing for natural voice reproduction, echo cancellation to keep the conversation smooth, and auto volume control to offset unwanted volume variation.

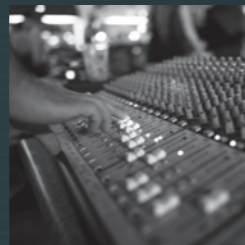

Advanced testing and fine-tuning for undistorted clarity

Our experts take accurate measurements in realistic use environments for precise sound settings refinement.

# The future of home communication is here

By combining the best features of a mobile phone and home phone, Philips premium cordless phones with MobileLink will change the way you communicate at home. Start enjoying the convenience of all calls – landline and mobile – on one phone.



# Specifications



		S10A / S10	S9A / S9	SE888	S8A
MobileLink	All calls – mobile and landline – from one phone	Yes	Yes	Yes	Yes
	Contact download	Mobile phone, Outlook, Outlook Express, Mac, Google	Mobile phone, Outlook, Outlook Express, Mac, Google	Mobile phone, Outlook	Mobile phone
	Bluetooth®	Headset: Yes Phonebook download: Yes	Headset: Yes Phonebook download: Yes	Headset: No Phonebook download: Yes	Headset: No Phonebook download: Yes
	Phonebook	Up to 2000 entries; Optional PIN code or auto-range protection for phonebooks	Up to 2000 entries; Optional PIN code or auto-range protection for phonebooks	Up to 1200 entries, Auto-range protection	Up to 1200 entries Auto-range protection
	Picture caller ID	Yes	Yes	No	No
	Sound enhancement	MySound Pro	MySound Pro	MySound	MySound
	MP3 conversion to ringtone	Yes, via PC / Mac	Yes, via PC / Mac	No	No
	Headset jack	Yes (3.5mm) iPhone headset compatible	No	No	No
	Display size / Technology	3.5", 480 x 320, TFT, 16M colors	2", 176 x 220, TFT, 65000 colors	2.4", 240 x 320, TFT, 65000 colors	1.8", 128 x 160, TFT, 65000 colors
	Touchscreen (Capacitive)	Yes	No	No	No
	Keypad, mobile charger and display on base	No	No	Yes	No
	Answering machine	Yes, 60 minutes (S10A) / No (S10)	Yes, 60 minutes (S9A) / No (S9)	Yes, 60 minutes	Yes, 45 minutes
	Speakerphone on base	No	No	Yes	No
	Talk time / Standby time / Charging time	14 hours / 170 hours / 6.5 hours	14 hours / 230 hours / 5 hours	22 hours / 300 hours / 8 hours	20 hours / 250 hours / 8 hours
	Integrated mobile phone charger	No	No	Yes, micro USB cable and USB port	No
	Silent mode / Call barring / Blacklist	Yes / Yes / Yes	Yes / Yes / Yes	Yes / Yes / Yes	Yes / Yes / Yes
	Dimensions	131.5 x 61.5 x 16.7 mm	125 x 45.5 x 17.6 mm	167.4 x 49.24 x 27.08 mm	161 x 47.3 x 27.5 mm
	Apps	Calendar, , alarm, screensaver, baby monitor, family notes	Calendar, alarm, screensaver, baby monitor, family notes	Alarm, baby monitor	Alarm, baby monitor
	Firmware update	Yes	Yes	No	No



All calls –  
landline and  
mobile – on  
one phone

Philips premium  
cordless phones with  
MobileLink

## Discover new growth – and profit – in DECT

Philips premium cordless phones are more than ordinary DECT phones – and there are clearly more benefits for our trade partners.

With MobileLink technology built in, the range can leverage the growth of the smartphone category by offering a compelling reason to upgrade and creating higher value with each transaction. This is important as replacement cycles for DECT phones are lengthening.

Our MobileLink technology is not only highly attractive to smartphone users but also clearly differentiates the premium range from the core range. That means there is a suitable model for every consumer and maximum value is captured from low to high price points.

Packed with functional features and designed to be aesthetically pleasing, our premium cordless phones appeal to the heart as well as the head to target both rational and emotionally driven consumers. Sell out is further facilitated by a wide variety of marketing support materials.