

Register your product and get support at
www.philips.com/welcome

MCM166



Thank you for choosing Philips.

Need help fast?

Read your Quick Start Guide and/or User Manual first for quick tips that make using your Philips product more enjoyable.

If you have read your instructions and still need assistance, you may access our online help at

www.philips.com/welcome
or call

1-888-PHILIPS (744-5477)
while with your product.
(and Model / Serial number)



Philips vous remercie de
votre confiance.

Besoin d'une aide rapide?

Le Guide rapide de début et Manuel de l'utilisateur regorgent d'astuces destinées à simplifier l'utilisation de votre produit Philips. Toutefois, si vous ne parvenez pas à résoudre votre problème, vous pouvez accéder à notre aide en ligne à l'adresse

www.philips.com/welcome
ou formez le

1-800-661-6162 (Francophone)
1-888-PHILIPS (744-5477) (English speaking)
Veillez à avoir votre produit à
portée de main.
(et model / serial nombre)



Gracias por escoger Philips

Necesita ayuda inmediata?

Lea primero la Guía rápida del comienzo o el Manual del usuario, en donde encontrará consejos que le ayudarán a disfrutar plenamente de su producto Philips. Si después de leerlo aún necesita ayuda, consulte nuestro servicio de asistencia en línea en

www.philips.com/welcome
o llame al teléfono

1-888-PHILIPS (744-5477)
y tenga a mano el producto.
(y número de model / serial)



EN	User manual	3
ES	Manual del usuario	21
FR	Mode d'emploi	43

PHILIPS

Canada

English:

This digital apparatus does not exceed the Class B limits for radio noise emissions from digital apparatus as set out in the Radio Interference Regulations of the Canadian Department of Communications. This Class B digital apparatus complies with Canadian ICES-003.

Français:

Cet appareil numérique n'émet pas de bruits radioélectriques dépassant les limites applicables aux appareils numériques de Classe B prescrites dans le Règlement sur le Brouillage Radioélectrique édicté par le Ministère des Communications du Canada. Cet appareil numérique de la classe B est conforme à la norme NMB-003 du Canada.

The set complies with the FCC-Rules, Part 15 and with 21 CFR 1040.10. Operation is subject to the following two conditions:

1. This device may not cause harmful interference, and
2. This device must accept any interference received, including interference that may cause undesired operation.

L'appareil est conforme à la réglementation FCC, section 15, et à la norme 21 CFR 1040.10. Son utilisation est soumise à deux conditions :

1. L'appareil ne doit pas provoquer d'interférences nuisibles, et
2. L'appareil doit supporter les interférences reçues, y compris les interférences empêchant son fonctionnement correct.

**Return your Product Registration Card or register online at
www.philips.com/welcome today to get the very most from your purchase.**

Registering your model with PHILIPS makes you eligible for all of the valuable benefits listed below, so don't miss out. Complete and return your Product Registration Card at once, **or register online at www.philips.com/welcome** to ensure:

***Proof of Purchase**

Returning the enclosed card guarantees that your date of purchase will be on file, so no additional paperwork will be required from you to obtain warranty service.

***Product Safety Notification**

By registering your product, you'll receive notification - directly from the manufacturer - in the rare case of a product recall or safety defect.

***Additional Benefits**

Registering your product guarantees that you'll receive all of the privileges to which you're entitled, including special money-saving offers.

PHILIPS

Congratulations on your purchase, and welcome to the "family!"

Dear PHILIPS product owner:

Thank you for your confidence in PHILIPS. You've selected one of the best-built, best-backed products available today. We'll do everything in our power to keep you happy with your purchase for many years to come.

As a member of the PHILIPS "family," you're entitled to protection by one of the most comprehensive warranties and outstanding service networks in the industry. What's more, your purchase guarantees you'll receive all the information and special offers for which you qualify, plus easy access to accessories from our convenient home shopping network.

Most importantly, you can count on our uncompromising commitment to your total satisfaction.

All of this is our way of saying welcome - and thanks for investing in a PHILIPS product.

P.S. To get the most from your PHILIPS purchase, be sure to complete and return your Product Registration Card at once, or register online at:

www.philips.com/welcome

Know these
safety symbols



 This "bolt of lightning" indicates uninsulated material within your unit may cause an electrical shock. For the safety of everyone in your household, please do not remove product covering.

 The "exclamation point" calls attention to features for which you should read the enclosed literature closely to prevent operating and maintenance problems.

WARNING: To reduce the risk of fire or electric shock, this apparatus should not be exposed to rain or moisture and objects filled with liquids, such as vases, should not be placed on this apparatus.

CAUTION: To prevent electric shock, match wide blade of plug to wide slot, fully insert.

ATTENTION: Pour éviter les choc électriques, introduire la lame la plus large de la fiche dans la borne correspondante de la prise et pousser jusqu'au fond.

For Customer Use

Enter below the Serial No. which is located on the rear of the cabinet. Retain this information for future reference.

Model No. _____

Serial No. _____

PHILIPS

Visit our World Wide Web Site at <http://www.philips.com/welcome>

PHILIPS LIMITED WARRANTY

ONE (1) YEAR

WARRANTY COVERAGE:

PHILIPS warranty obligation is limited to the terms set forth below.

WHO IS COVERED:

Philips warrants the product to the original purchaser or the person receiving the product as a gift against defects in materials and workmanship as based on the date of original purchase ("Warranty Period") from an Authorized Dealer. The original sales receipt showing the product name and the purchase date from an authorized retailer is considered such proof.

WHAT IS COVERED:

The Philips warranty covers new products if a defect in material or workmanship occurs and a valid claim is received by Philips within the Warranty Period. At its option, Philips will either (1) repair the product at no charge, using new or refurbished replacement parts, or (2) exchange the product with a product that is new or which has been manufactured from new, or serviceable used parts and is at least functionally equivalent or most comparable to the original product in Philips current inventory, or (3) refund the original purchase price of the product. Philips warrants replacement products or parts provided under this warranty against defects in materials and workmanship from the date of the replacement or repair for ninety (90) days or for the remaining portion of the original product's warranty, whichever provides longer coverage for you. When a product or part is exchanged, any replacement item becomes your property and the replaced item becomes Philips' property. When a refund is given, your product becomes Philips' property.

Note: Any product sold and identified as refurbished or renewed carries a ninety (90) day limited warranty.

Replacement product can only be sent if all warranty requirements are met. Failure to follow all requirements can result in delay.

WHAT IS NOT COVERED - EXCLUSIONS AND LIMITATIONS:

This Limited Warranty applies only to the new products manufactured by or for Philips that can be identified by the trademark, trade name, or logo affixed to it. This Limited Warranty does not apply to any non-Philips hardware product or any software, even if packaged or sold with the product. Non-Philips manufacturers, suppliers, or publishers may provide a separate warranty for their own products packaged with the bundled product.

Philips is not liable for any damage to or loss of any programs, data, or other information stored on any media contained within the product, or any non-Philips product or part not covered by this warranty. Recovery or reinstallation of programs, data or other information is not covered under this Limited Warranty.

This warranty does not apply (a) to damage caused by accident, abuse, misuse, neglect, misapplication, or non-Philips product, (b) to damage caused by service performed by anyone other than Philips or Philips Authorized Service Location, (c) to a product or a part that has been modified without the written permission of

Philips, or (d) if any Philips serial number has been removed or defaced, or (e) product, accessories or consumables sold "AS IS" without warranty of any kind by including refurbished Philips product sold "AS IS" by some retailers.

This Limited Warranty does not cover:

- Shipping charges to return defective product to Philips.
- Labor charges for installation or setup of the product, adjustment of customer controls on the product, and installation or repair of antenna/signal source systems outside of the product.
- Product repair and/or part replacement because of improper installation or maintenance, connections to improper voltage supply, power line surge, lightning damage, retained images or screen markings resulting from viewing fixed stationary content for extended periods, product cosmetic appearance items due to normal wear and tear, unauthorized repair or other cause not within the control of Philips.
- Damage or claims for products not being available for use, or for lost data or lost software.
- Damage from mishandled shipments or transit accidents when returning product to Philips.
- A product that requires modification or adaptation to enable it to operate in any country other than the country for which it was designed, manufactured, approved and/or authorized, or repair of products damaged by these modifications.
- A product used for commercial or institutional purposes (including but not limited to rental purposes).
- Product lost in shipment and no signature verification receipt can be provided.
- Failure to operate per Owner's Manual.

TO OBTAIN ASSISTANCE IN THE U.S.A., PUERTO RICO, OR U.S. VIRGIN ISLANDS...

Contact Philips Customer Care Center at:
1-888-PHILIPS (1-888-744-5477)

TO OBTAIN ASSISTANCE IN CANADA...

1-800-661-6162 (French Speaking)
1-888-PHILIPS (1-888-744-5477) - (English or Spanish Speaking)

REPAIR OR REPLACEMENT AS PROVIDED UNDER THIS WARRANTY IS THE EXCLUSIVE REMEDY FOR THE CONSUMER. PHILIPS SHALL NOT BE LIABLE FOR ANY INCIDENTAL OR CONSEQUENTIAL DAMAGES FOR BREACH OF ANY EXPRESS OR IMPLIED WARRANTY ON THIS PRODUCT. EXCEPT TO THE EXTENT PROHIBITED BY APPLICABLE LAW, ANY IMPLIED WARRANTY OF MERCHANTABILITY OR FITNESS FOR A PARTICULAR PURPOSE ON THIS PRODUCT IS LIMITED IN DURATION TO THE DURATION OF THIS WARRANTY.

Some states do not allow the exclusions or limitation of incidental or consequential damages, or allow limitations on how long an implied warranty lasts, so the above limitations or exclusions may not apply to you.

This warranty gives you specific legal rights. You may have other rights which vary from state/province to state/province.

Philips, P.O. Box 671539, Marietta, GA. 30006-0026

3121 233 48802

Contents

1 Important	4	7 Adjust volume level and sound effect	15
Safety	4	Adjust volume level	15
Notice	5	Select a preset sound effect	15
2 Your Micro Hi-Fi	6	Enhance bass	15
Introduction	6	Mute sound	15
What's in the box	6	8 Receive radio	16
Overview of the main unit	7	Tune to a radio station	16
Overview of the remote control	8	Program radio stations automatically	16
3 Connect	10	Program radio stations manually	16
Connect speakers	10	Select a preset radio station	16
Connect power	10	9 Other features	17
4 Get started	11	Set the alarm timer	17
Prepare the remote control	11	Set the sleep timer	17
Auto install radio stations	11	Listen to an external device	17
Set clock	11	10 Product information	18
Turn on	12	Specifications	18
5 Play disc/USB	13	USB playability information	19
Play disc	13	Supported MP3 disc formats	19
Play from USB	13	11 Troubleshooting	20
6 Play options	14		
Skip to a track	14		
Pause/resume play	14		
Search within a track	14		
Display play information	14		
Repeat play	14		
Random play	14		
Program tracks	14		

1 Important

Safety

- ① Read these instructions.
- ② Keep these instructions.
- ③ Heed all warnings.
- ④ Follow all instructions.
- ⑤ Do not use this apparatus near water.
- ⑥ Clean only with dry cloth.
- ⑦ Do not block any ventilation openings. Install in accordance with the manufacturer's instructions.
- ⑧ Do not install near any heat sources such as radiators, heat registers, stoves, or other apparatus (including amplifiers) that produce heat.
- ⑨ Do not defeat the safety purpose of the polarized or grounding-type plug.
A polarized plug has two blades with one wider than the other. A grounding type plug has two blades and a third grounding prong. The wide blade or the third prong are provided for your safety. If the provided plug does not fit into your outlet, consult an electrician for replacement of the obsolete outlet.
- ⑩ Protect the power cord from being walked on or pinched, particularly at plugs, convenience receptacles, and the point where they exit from the apparatus.
- ⑪ Only use attachments/accessories specified by the manufacturer.
- ⑫ Use only with the cart, stand, tripod, bracket, or table specified by the

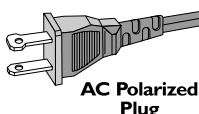

manufacturer or sold with the apparatus. When a cart is used, use caution when moving the cart/apparatus combination to avoid injury from tip-over.

- ⑬ Unplug this apparatus during lightning storms or when unused for long periods of time.
- ⑭ Refer all servicing to qualified service personnel. Servicing is required when the apparatus has been damaged in any way, such as power-supply cord or plug is damaged, liquid has been spilled or objects have fallen into the apparatus, the apparatus has been exposed to rain or moisture, does not operate normally, or has been dropped.
- ⑮ Battery usage **CAUTION** – To prevent battery leakage which may result in bodily injury, property damage, or damage to the unit:
 - Install all batteries correctly, + and - as marked on the unit.
 - Do not mix batteries (old and new or carbon and alkaline, etc.).
 - Remove batteries when the unit is not used for a long time.
- ⑯ Apparatus shall not be exposed to dripping or splashing.
- ⑰ Do not place any sources of danger on the apparatus (e.g. liquid filled objects, lighted candles).
- ⑱ This product may contain lead and mercury. Disposal of these materials may be regulated due to environmental considerations. For disposal or recycling information, please contact your local authorities or the Electronic Industries Alliance: www.eiae.org.
- ⑲ Where the MAINS plug or an appliance coupler is used as the disconnect device, the disconnect device shall remain readily operable.



Warning

- Never remove the casing of this Micro Hi-Fi.
- Never lubricate any part of this Micro Hi-Fi.
- Never place this Micro Hi-Fi on other electrical equipment.
- Keep this Micro Hi-Fi away from direct sunlight, naked flames or heat.
- Never look into the laser beam inside the Micro Hi-Fi.
- Ensure that you always have easy access to the power cord, plug or adaptor to disconnect the Micro Hi-Fi from the power.



Caution

- Use of controls or adjustments or performance of procedures other than herein may result in hazardous radiation exposure or other unsafe operation.

Hearing safety

Listen at a moderate volume.

- Using headphones at a high volume can impair your hearing. This product can produce sounds in decibel ranges that may cause hearing loss for a normal person, even for exposure less than a minute. The higher decibel ranges are offered for those that may have already experienced some hearing loss.
- Sound can be deceiving. Over time your hearing 'comfort level' adapts to higher volumes of sound. So after prolonged listening, what sounds 'normal' can actually be loud and harmful to your hearing. To guard against this, set your volume to a safe level before your hearing adapts and leave it there.

To establish a safe volume level:

- Set your volume control at a low setting.
- Slowly increase the sound until you can hear it comfortably and clearly, without distortion.

Listen for reasonable periods of time:

- Prolonged exposure to sound, even at normally 'safe' levels, can also cause hearing loss.

- Be sure to use your equipment reasonably and take appropriate breaks.

Be sure to observe the following guidelines when using your headphones.

- Listen at reasonable volumes for reasonable periods of time.
- Be careful not to adjust the volume as your hearing adapts.
- Do not turn up the volume so high that you can't hear what's around you.
- You should use caution or temporarily discontinue use in potentially hazardous situations. Do not use headphones while operating a motorized vehicle, cycling, skateboarding, etc.; it may create a traffic hazard and is illegal in many areas.

Notice

Any changes or modifications made to this device that are not expressly approved by Philips Consumer Lifestyle may void the user's authority to operate the equipment.

Environmental information

All unnecessary packaging has been omitted. We have tried to make the packaging easy to separate into three materials: cardboard (box), polystyrene foam (buffer) and polyethylene (bags, protective foam sheet.)

Your system consists of materials which can be recycled and reused if disassembled by a specialized company. Please observe the local regulations regarding the disposal of packaging materials, exhausted batteries and old equipment.

Windows Media and the Windows logo are trademarks, or registered trademarks of Microsoft Corporation in the United States and/or other countries.



This Micro Hi-Fi includes this label:



2 Your Micro Hi-Fi

Congratulations on your purchase, and welcome to Philips! To fully benefit from the support that Philips offers, register your product at www.Philips.com/welcome.

Introduction

With this Micro Hi-Fi, you can enjoy music from audio discs and USB devices directly and other external devices, or listen to radio stations. The Micro Hi-Fi offers you multiple sound effect settings that enrich sound with Digital Sound Control (DSC) and Dynamic Bass Boost (DBB). The Micro Hi-Fi supports the following media formats:



What's in the box

Check and identify the contents of your package:

- Main unit
- Loudspeaker boxes x 2
- Remote control
- MP3 link cable

Overview of the main unit

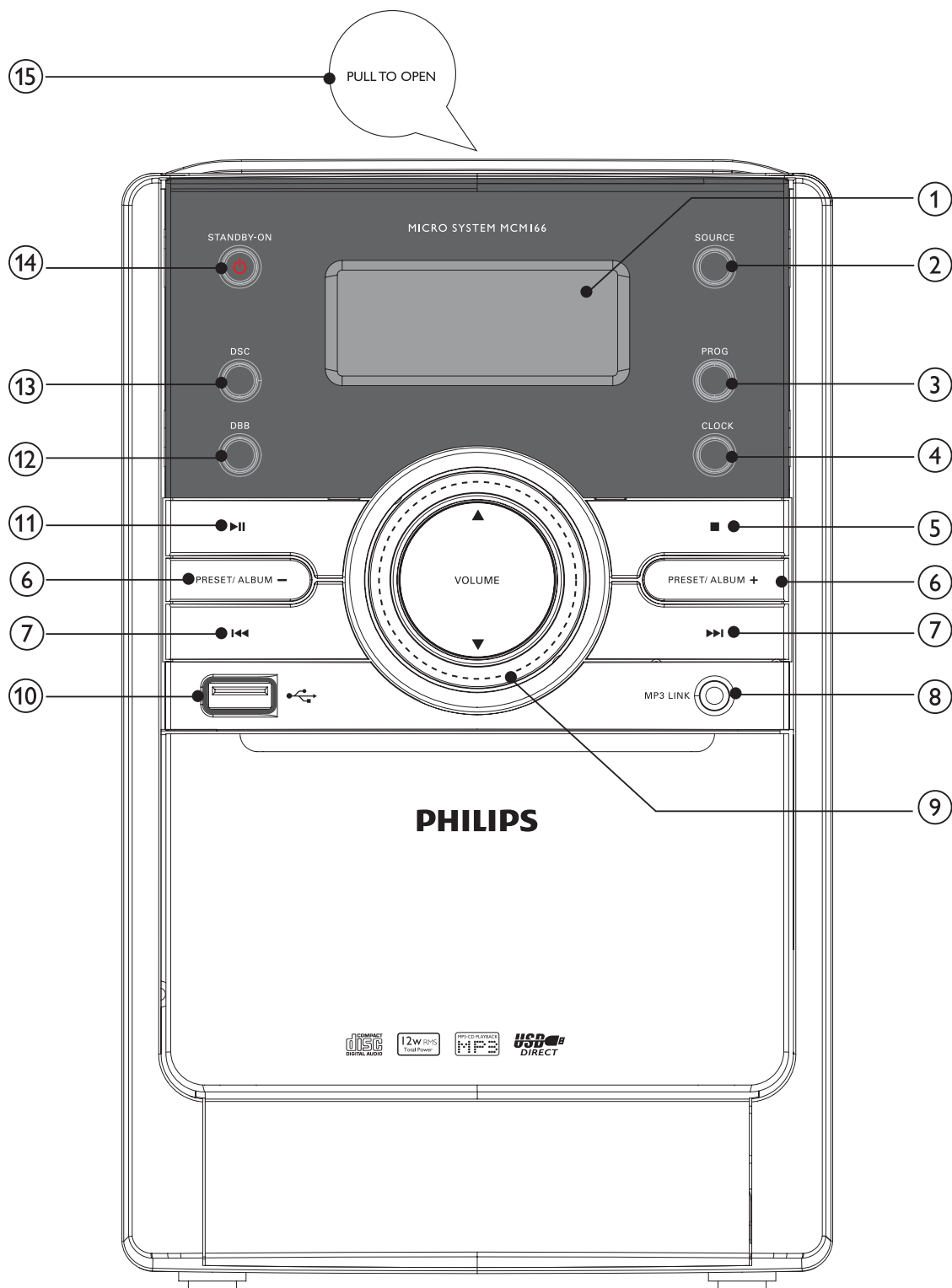

① Display panel

- Show current status.

② SOURCE

- Select a source: Disc, TUNER, USB or MP3 LINK.

③ PROG

- Program tracks.

- Program radio stations.
- Select 12 hour or 24 hour format.

④ CLOCK

- Set the clock.
- View the clock.
- During play, select display information.

- ⑤ ■
 - Stop play or erase a program.
- ⑥ **PRESET/ALBUM+/-**
 - Select a preset radio station.
 - Skip to the previous/next album.
- ⑦ **⏮️/⏭️**
 - Skip to the previous/next track.
 - Search within a track/ disc/USB.
 - Tune to a radio station.
 - Adjust time.
- ⑧ **MP3 LINK**
 - Jack for an external audio device.
- ⑨ **VOLUME▲▼**
 - Adjust volume.
- ⑩ **🔌**
 - Jack for a USB mass storage device.
- ⑪ **▶️⏸️**
 - Start or pause play.
- ⑫ **DBB**
 - Turns on or off dynamic bass enhancement.
- ⑬ **DSC**
 - Select a preset sound setting: POP, JAZZ, CLASSIC or ROCK.
- ⑭ **STANDBY-ON**
 - Turn on the Micro Hi-Fi, switch to standby mode, or switch to Eco Power Standby.
- ⑮ **PULL TO OPEN**
 - Open or close the disc tray.

Overview of the remote control

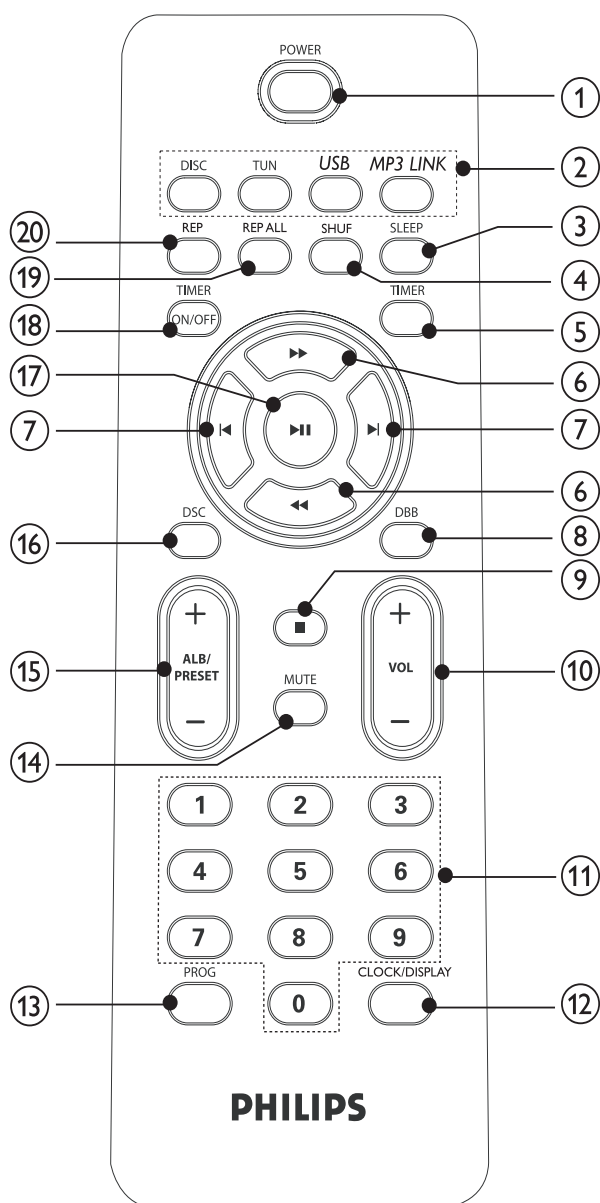

- ① **POWER**
 - Turn on the Micro Hi-Fi, switch to standby mode, or switch to Eco Power Standby.
- ② **Source selection keys (DISC, TUN, USB, MP3 LINK)**
 - Select a source: CD, TUNER, USB or MP3 LINK.
- ③ **SLEEP**
 - Set the sleep timer.
- ④ **SHUF**
 - Play tracks randomly.

⑤ TIMER

- Set the alarm timer.

⑥ ◀◀▶▶

- Search within a track/ disc/USB.
- Tune to a radio station.
- Adjust time.

⑦ ◀▶

- Skip to the previous/next track.

⑧ DBB

- Turns on or off dynamic bass enhancement.

⑨ ■

- Stop play or erase a program.

⑩ VOL +/-

- Adjust volume.

⑪ Numeric keypad

- Select a track from a disc directly.

⑫ CLOCK/DISPLAY

- Set the clock.
- View the clock.
- During play, select display information.

⑬ PROG

- Program tracks.
- Program radio stations.
- Select 12 hour or 24 hour format.

⑭ MUTE

- Mute volume.

⑮ ALB/PRESET +/-

- Skip to the previous/next album.
- Select a preset radio station.

⑯ DSC

- Select a preset sound setting: POP, JAZZ, CLASSIC or ROCK.

⑰ ▶||

- Start or pause play.

⑱ TIMER ON/OFF

- Turn on or off alarm timer.

⑲ REP ALL

- Play all tracks repeatedly.

⑳ REP

- Play a track repeatedly.

3 Connect

Connect speakers

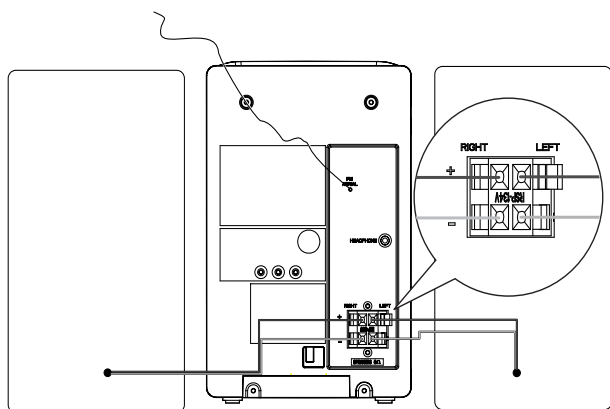

Note

- Insert the stripped portion of each speaker wire into the socket completely.
- For optimal sound, use the supplied speakers only.
- Connect only speakers with impedance that is the same or higher than the supplied speakers. Refer to the Specifications section of this manual.

To insert each speaker wire: Hold down the socket flap. Insert the speaker wire fully. Release the socket flap.

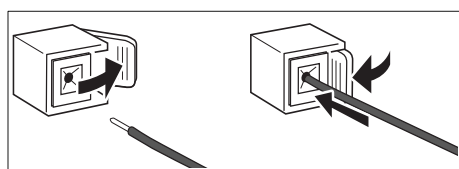

- 1 For the right speaker, find the sockets on the main unit marked 'RIGHT'.
- 2 Insert the red wire to the red (+) socket.
- 3 Insert the black wire into the black (-) socket.
- 4 For the left speaker, find the sockets on the main unit marked 'LEFT'.
- 5 Repeat steps 2-3.

Connect power

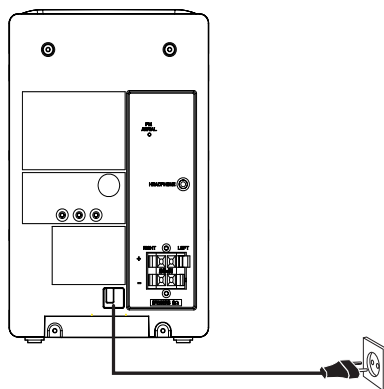

Caution

- Risk of product damage! Ensure that the power supply voltage corresponds to the voltage printed on the back or the underside of the Micro Hi-Fi.
- Before connecting the AC power cord, ensure you have completed all other connections.

- 1 Connect the AC power cord to the wall socket.

4 Get started



Caution

- Use the controls only as stated in this user manual.

Always follow the instructions in this chapter in sequence.

If you contact Philips, you will be asked for the model and serial number of your Micro Hi-Fi. The model number and serial number are on the back of your Micro Hi-Fi. Write the numbers here:

Model No. _____

Serial No. _____

Prepare the remote control



Caution

- Risk of explosion! Keep batteries away from heat, sunshine or fire. Never discard batteries in fire.

To replace the remote control battery:

- 1 Open the battery compartment.
- 2 Insert 2 AAA batteries with correct polarity (+/-) as indicated.
- 3 Close the battery compartment.

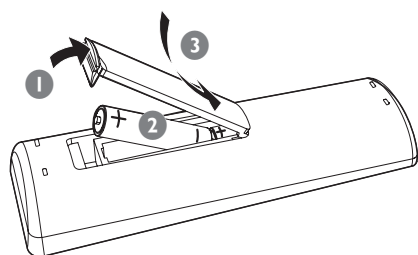

Note

- Before pressing any function button on the remote control, first select the correct source with the remote control instead of the main unit.
- If you are not going to use the remote control for a long time, remove the batteries.

Auto install radio stations

When you connect the Micro Hi-Fi to the power supply for the first time, or no radio station is stored in this Micro Hi-Fi, Plug and Play is activated to store all available radio stations automatically.

- 1 Connect the Micro Hi-Fi to the power supply.
↳ [AUTO INSTALL - PRESS PLAY] (auto install - press the PLAY button) is displayed.
- 2 Press ►|| on the main unit to start installation.
↳ [AUTO] (auto) is displayed.
↳ The Micro Hi-Fi automatically store radio stations with sufficient signal strength.
↳ When all the available radio stations are stored, the first preset radio station is broadcast automatically.

Set clock

- 1 Press and hold **CLOCK/DISPLAY** to activate the clock setting mode.
↳ The 12 hour or 24 hour format is displayed.
- 2 Press **PROG** repeatedly to select 12 hour or 24 hour format.
- 3 Press **CLOCK/DISPLAY** to confirm.
↳ The hour digits are displayed and begin to blink.
- 4 Press ◀▶ to set the hour.
- 5 Press **CLOCK/DISPLAY** to confirm.
↳ The minute digits are displayed and begin to blink.
- 6 Press ◀▶ to set the minute.
- 7 Press **CLOCK/DISPLAY** to confirm.



Tip

- To view the clock during play, press **CLOCK/DISPLAY** repeatedly until the clock is displayed.

Turn on

- 1 Press **POWER**.
 - ↳ The Micro Hi-Fi switches to the last selected source.

Switch to standby

- 1 Press **POWER** to switch the Micro Hi-Fi to standby mode.
 - ↳ The backlight on the display panel is reduced.
 - ↳ The clock (if set) appears on the display panel.

To switch the Micro Hi-Fi to Eco Power Standby mode:

- 1 In the standby mode, press and hold **POWER** for more than 2 seconds.
 - ↳ The backlight on the display panel turns off.

5 Play disc/USB

Play disc

- 1 Press **DISC** to select the disc source.
- 2 Lift the lid of the CD compartment.
- 3 Insert a disc with the printed side facing up, then close the disc tray.
- 4 Press **▶||** to start play.

Play from USB

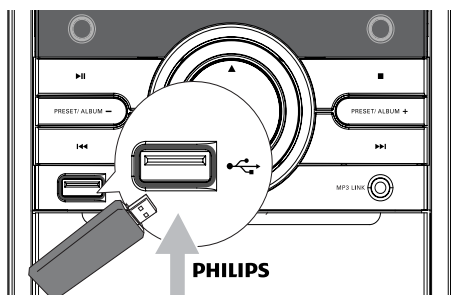

Note

- Ensure that the USB device contains playable audio contents for supported formats.

- 1 Insert the USB plug of a USB device into  the socket.
- 2 Press **USB** to select the USB source.
↳ The total number of tracks is displayed.

- 3 Press **ALB/PRESET+/-** to select a folder.
- 4 Press **◀/▶** to select a file.
- 5 Press **▶||** to start play.

6 Play options

Skip to a track

For CD:

- 1 Press **◀/▶** to select another track.
 - To select a track directly, you can also press a key on the numerical keypad.

For MP3 disc and USB:

- 1 Press **ALB/PRESET+/-** to select an album or folder.
- 2 Press **◀/▶** to select a track or file.

Pause/resume play

- 1 During play, press **▶||** to pause/resume play.

Search within a track

- 1 During play, press and hold **◀◀▶▶**.
- 2 Release to resume normal play.

Display play information

- 1 During play, press **CLOCK/DISPLAY** repeatedly to select different play information.

Repeat play

Play a track repeatedly

- 1 During play, press **REP**.
 - ↳ [REP] (repeat) is displayed: the current track is played repeatedly.
- 2 To return to normal play, press **REP** again.

Play all tracks or an album repeatedly

- 1 During play, press **REP ALL** repeatedly to select:
 - ↳ [REP ALL] (repeat all) is displayed: all tracks are played repeatedly.
 - ↳ [REP ALB] (repeat album) is displayed (for MP3 and USB only): the current album is played repeatedly.
- 2 To return to normal play, press **REP ALL** repeatedly until repeat mode is no longer displayed.

Random play

- 1 Press **SHUF**.
 - ↳ [SHUF] (shuffle) is displayed: all tracks are played randomly.
- 2 To return to normal play, press **SHUF** again.



Tip

- The repeat and shuffle functions cannot be activated at the same time.

Program tracks

You can program a maximum of 40 tracks.

- 1 At CD/USB mode, in the stop position, press **PROG** to activate the program mode.
 - ↳ [PROG] (program) blinks on the display.
- 2 For MP3/WMA tracks, press **ALB/PRESET+/-** to select an album.
- 3 Press **◀/▶** to select a track number; then press **PROG** to confirm.
- 4 Repeat steps 2 to 3 to select and store all tracks to program.
- 5 Press **▶||** to play the programmed tracks.
 - ↳ During play, [PROG] (program) is displayed.
 - To erase the program, in the stop position, press **■**.

7 Adjust volume level and sound effect

Adjust volume level

- 1 During play, press **VOL +/-** to increase/decrease the volume level.

Select a preset sound effect

- 1 During play, press **DSC** repeatedly to select:
 - [POP] (pop)
 - [JAZZ] (jazz)
 - [CLASSIC] (classic)
 - [ROCK] (rock)

Enhance bass

- 1 During play, press **DBB** to turn on or off dynamic bass enhancement.
↳ If DBB is activated, DBB is displayed.

Mute sound

- 1 During play, press **MUTE** to mute/unmute sound.

8 Receive radio

Tune to a radio station

- 1 Press **TUN** repeatedly to select FM or MW.
- 2 Press and hold **◀▶** for more than 2 seconds.
 - ↳ [SEARCH] (search) is displayed.
 - ↳ The radio tunes to a station with strong reception automatically.
- 3 Repeat step 2 to tune to more stations.
 - To tune to a weak station, press **◀▶** repeatedly until you find optimal reception.

Program radio stations automatically

Note

- You can program a maximum of 40 preset radio stations.

- 1 In the tuner mode, press and hold **PROG** for 2 seconds to activate automatic program mode.
 - ↳ [AUTO] (auto) is displayed.
 - ↳ All available stations are programmed in the order of waveband reception strength.
 - ↳ The first programmed radio station is broadcast automatically.

Program radio stations manually

Note

- You can program a maximum of 40 preset radio stations.

- 1 Tune to a radio station.
- 2 Press **PROG** to activate program mode.
 - ↳ [PROG] (program) blinks on the display.
- 3 Press **ALB/PRESET+/-** to allocate a number (1 to 40) to this radio station, then press **PROG** to confirm.
 - ↳ The preset number and the frequency of the preset station are displayed.
- 4 Repeat the above steps to program other stations.

Note

- To overwrite a programmed station, store another station in its place.

Select a preset radio station

- 1 Press **ALB/PRESET+/-** to select a preset number.

Tip

- FM antenna is fixed to the main unit.
- Position the antenna as far as possible from TV, VCR or other radiation source.
- For optimal reception, fully extend and adjust the position of the antenna.

9 Other features

Set the alarm timer

This Micro Hi-Fi can be used as an alarm clock. The DISC, TUNER or USB is activated to play at a preset time.

- 1 Ensure that you have set the clock correctly.
- 2 Press and hold **TIMER**.
- 3 Press **DISC**, **TUN** or **USB** to select a source.
- 4 Press **TIMER** to confirm.
 - ↳ The hour digits are displayed and begin to blink.
- 5 Press **◀▶** to set the hour.
- 6 Press **TIMER** to confirm.
 - ↳ The minute digits are displayed and begin to blink.
- 7 Press **◀▶** to set the minute.
- 8 Press **TIMER** to confirm.
 - ↳ The timer is set and activated.

Activate and deactivate alarm timer

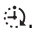
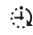
- 1 Press **TIMER ON/OFF** repeatedly to activate or deactivate timer.
 - ↳ If timer is activated, the display shows .
 - ↳ If timer is deactivated,  disappears on the display.



Note

- Alarm timer is not available in MP3 LINK mode.
- If DISC/USB source is selected and the track cannot be played, tuner is activated automatically.

Set the sleep timer

This Micro Hi-Fi can switch to standby automatically after a set period of time.

- 1 When the Micro Hi-Fi is turned on, press **SLEEP** repeatedly to select a set period of time (in minutes).
 - ↳ When sleep timer is activated, the display shows **zz**.

To deactivate sleep timer

- 1 Press **SLEEP** repeatedly until "0" is displayed.
 - ↳ When sleep timer is deactivated, **zz** disappears on the display.

Listen to an external device

You can listen to an MP3 player through this Micro Hi-Fi.

- 1 Press **MP3 LINK** to select AUX source.
- 2 Use an MP3 link cable (supplied) to connect **MP3 LINK** jack (3.5mm) on this Micro Hi-Fi and the headphone jack on an MP3 player.

10 Product information



Note

- Product information is subject to change without prior notice.

Specifications

Amplifier

Rated Output Power	2 × 5 W RMS
Frequency Response	60 - 16 kHz, ±3 dB
Signal to Noise Ratio	> 65 dB
Aux Input	0.5 V RMS 20 kohm

Disc

Laser Type	Semiconductor
Disc Diameter	12 cm / 8 cm
Support Disc	CD-DA, CD-R, CD-RW, MP3-CD, WMA-CD
Audio DAC	24 Bits / 44.1 kHz
Total Harmonic Distortion	< 1%
Frequency Response	60 Hz -16 kHz (44.1 kHz)
S/N Ratio	> 65 dBA

Tuner

Tuning Range	FM: 87.5 - 108 MHz; AM: 530 - 1700 kHz
Tuning grid	100 kHz

FM

Sensitivity	- Mono, 26dB S/N Ratio < 22 dBf - Stereo, 46dB S/N Ratio < 43 dBf
Search Selectivity	> 28 dBf
Total Harmonic Distortion	< 3%
Signal to Noise Ratio	> 55 dB

Speakers

Speaker Impedance	4 ohm
Speaker Driver	3.5" woofer + 0.8" tweeter
Sensitivity	> 82 dB/m/W

General information

AC power	120V, 60 Hz
Operation Power Consumption	20 W
Standby Power Consumption	< 4 W
Eco Standby Power Consumption	< 2 W
USB Direct	Version 2.0/1.1
Dimensions	
- Main Unit (W × H × D)	147 × 231 × 209 mm
- Speaker Box (W × H × D)	134 × 233 × 153 mm
Weight	
- With Packing	4.75 kg
- Main Unit	1.95 kg
- Speaker Box	2 × 1.2 kg

USB playability information

Compatible USB devices:

- USB flash memory (USB 2.0 or USB1.1)
- USB flash players (USB 2.0 or USB1.1)
- memory cards (requires an additional card reader to work with this Micro Hi-Fi)

Supported formats:

- USB or memory file format FAT12, FAT16, FAT32 (sector size: 512 bytes)
- MP3 bit rate (data rate): 32-320 Kbps and variable bit rate
- WMA v9 or earlier
- Directory nesting up to a maximum of 8 levels
- Number of albums/ folders: maximum 99
- Number of tracks/titles: maximum 999
- ID3 tag v2.0 or later
- File name in Unicode UTF8 (maximum length: 128 bytes)

Unsupported formats:

- Empty albums: an empty album is an album that does not contain MP3/WMA files, and is not be shown in the display.
- Unsupported file formats are skipped. For example, Word documents (.doc) or MP3 files with extension .dlf are ignored and not played.
- AAC, WAV, PCM audio files
- DRM protected WMA files (.wav, .m4a, .m4p, .mp4, .aac)
- WMA files in Lossless format

Supported MP3 disc formats

- ISO9660, Joliet
- Maximum title number: 512 (depending on file name length)
- Maximum album number: 255
- Supported sampling frequencies: 32 kHz, 44.1kHz, 48 kHz
- Supported Bit-rates: 32~256 (kbps), variable bit rates

11 Troubleshooting



Caution

- Never remove the casing of this Micro Hi-Fi.

To keep the warranty valid, never try to repair the system yourself.

If you encounter problems when using this Micro Hi-Fi, check the following points before requesting service. If the problem remains unsolved, go to the Philips web site (www.Philips.com/support). When you contact Philips, ensure that your Micro Hi-Fi is nearby and the model number and serial number are available.

No power

- Ensure that the AC power plug of the Micro Hi-Fi is connected properly.
- Ensure that there is power at the AC outlet.
- As a power-saving feature, the Micro Hi-Fi switches to standby automatically 15 minutes after disc/USB play reaches the end and no control is operated.

No sound or poor sound

- Adjust the volume.
- Disconnect the headphones.
- Check that the speakers are connected correctly.
- Check if the stripped speaker wires are clamped.

Left and right sound outputs reversed

- Check the speaker connections and location.

No response from the Micro Hi-Fi

- Disconnect and reconnect the AC power plug, then turn on the system again.

Remote control does not work

- Before pressing any function button, first select the correct source with the remote control instead of the main unit.
- Reduce the distance between the remote control and the Micro Hi-Fi.

- Insert the batteries with its polarities (+/– signs) aligned as indicated.
- Replace the batteries.
- Aim the remote control directly at the sensor on the front of the Micro Hi-Fi.

No disc detected

- Insert a disc.
- Check if the disc is inserted upside down.
- Wait until the moisture condensation at the lens has cleared.
- Replace or clean the disc.
- Use a finalized CD or correct format disc.

Cannot display some files in USB device

- The number of folders or files in the USB device has exceeded a certain limit. This phenomenon is not a malfunction.
- The formats of these files are not supported.

USB device not supported

- The USB device is incompatible with the Micro Hi-Fi. Try another one.

Poor radio reception

- Increase the distance between the Micro Hi-Fi and your TV or VCR.
- Fully extend the FM antenna.

Timer does not work

- Set the clock correctly.
- Switch on the timer.

Clock/timer setting erased

- Power has been interrupted or the power cord has been disconnected.
- Reset the clock/timer.

