

Quick Start Guide



Step A *Connect*

Step B *Setup*

Step C *Enjoy*

What's in the Box?

You should find these items upon opening the box.



FM antenna



Remote Control

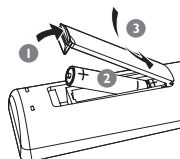

Quick Start Guide



User Manual



Power cord

PHILIPS

Step A **Connect**

1

Connect the speaker cables.

2

Connect the FM antenna.

3

Connect the power cord of the system.

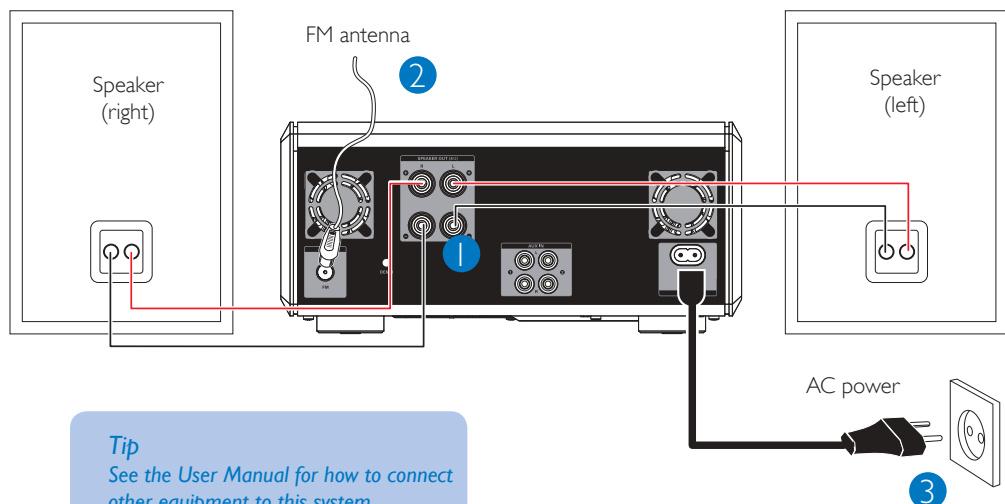

Step B **Setup**

Setting the clock

IMPORTANT!

– To set clock in the Eco Power mode, press and hold **STANDBY-ON** on the set for 3 seconds or more to switch to normal standby mode first before proceeding with the procedures below.

1

In standby mode, press and hold **CLOCK** on the remote control.

2

When the hour digits flash, turn **VOLUME** on the system or press **VOL+/-** on the remote control to set the hours.

3

Press **CLOCK** again and the minute digits flash. Then turn **VOLUME** on the system or press **VOL+/-** on the remote control to set the minutes.

4

Press **CLOCK** again to confirm the time setting.

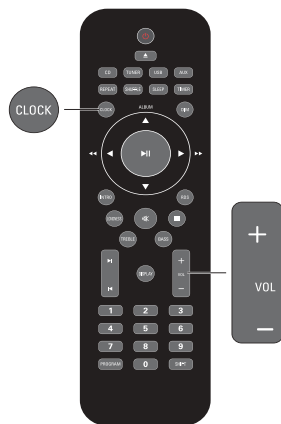

Step C *Enjoy*

Playing a disc

- 1 Press **SOURCE** on the front panel to select DISC or press **CD** on the remote control.
- 2 Press **▲** to open the CD compartment.
- 3 Insert a disc with the printed side facing up. Press **▲** again to close the compartment.
- 4 Playback will start automatically. If not, press **▶||**.
- 5 To stop playback, press **■**.

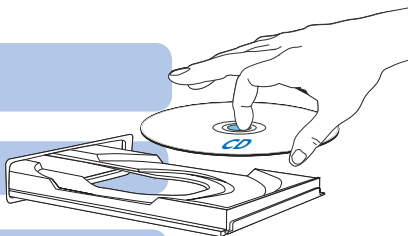

Playing a USB mass storage device

With the Hi-Fi system, you can use USB flash memory (USB 2.0 or USB1.1), USB flash players (USB 2.0 or USB1.1), memory cards (requires an additional card reader to work with this Hi-Fi system).

- 1 Insert the USB device's USB plug into the  socket on the set.
- 2 Press **SOURCE** once or more (or **USB** on the remote control) to select **USB**.
- 3 Play the USB's audio files as you do with the albums/tracks on a CD.

Programming and tuning to radio stations

- 1 Press **SOURCE** (**TUNER** on the remote control) to select tuner source.
- 2 Press **PROGRAM** on the remote control for more than two seconds to program all available stations in order of waveband.
- 3 Press **◀ / ▶** until the desired preset station is displayed.

Tip

Detailed playback features and additional functions are described in the accompany owner's manual.



© Royal Philips Electronics N.V. 2008
All rights reserved.

<http://www.philips.com>

