

2

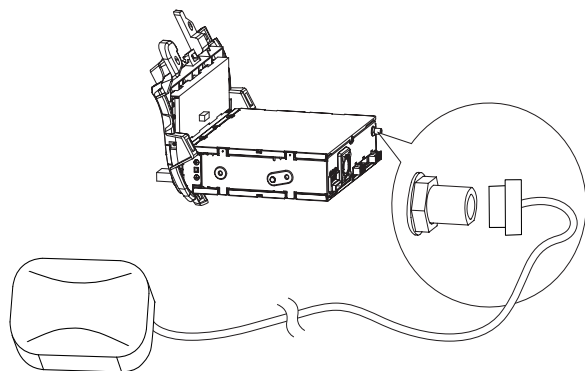

3

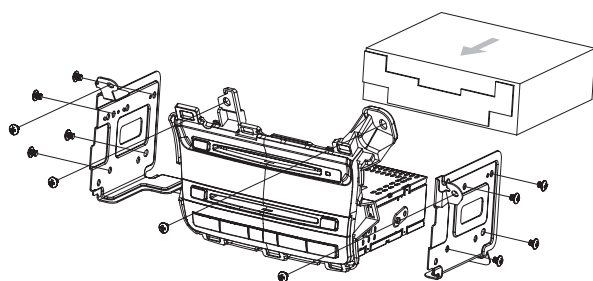

4

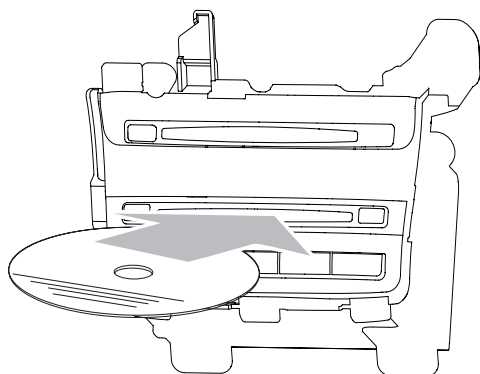

5

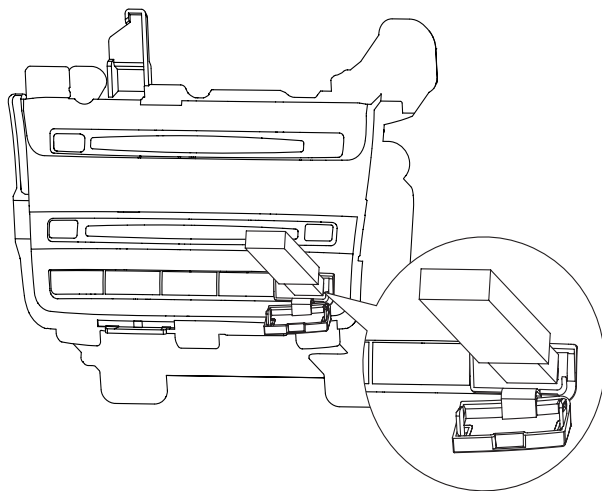

6

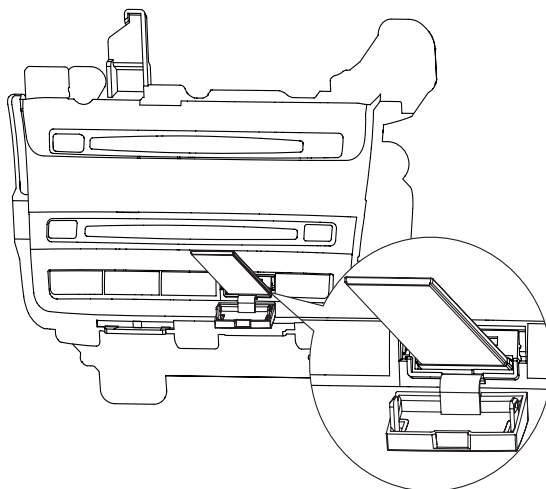

## Install the car audio

### Connect wires 1

#### ! Caution

- Ensure that all loose leads are insulated with electrical tape.

- 1 Check the car's wirings carefully, then make the other connections.

### Connect GPS antenna 2

To receive signal from satellites, connect the supplied GPS antenna to your car and the system.

- 1 Connect the supplier GPS antenna to the system first.
- 2 Stick the other end of the GPS antenna to a metal surface of the car.

### Mount in the dashboard 3

- 1 If the car does not have an on-board drive or navigation computer, disconnect the negative terminal of the car battery.
- 2 Ensure that the horizontal slant of the car dashboard opening is between 0 and 20 degrees. The unit cannot be used if the dashboard opening's slant angle is above 20 degrees.
- 3 Install the supplied screen brackets and fix the screen to the car.
- 4 Remove the disc loader from the host car audio system and then install the disc loader to the unit.
- 5 Install the mounting brackets to the unit with screws.
- 6 Slide the unit into the dashboard and fix it to the car with four screws.
- 7 Reconnect the negative terminal of the car battery.

## Turn on

#### ! Caution

- Risk of road accidents! Never watch video or adjust settings while you drive.

- 1 Press and hold **MUTE** to turn on the unit.
  - ↳ The available OSD (On-Screen Display) languages are displayed.



- 2 Tap a language to select.
  - ↳ The OSD language is changed to the selected language immediately.
- To turn off the unit, press and hold **MUTE**.

## Set date and time

- 1 Tap **Home** to display main menu.



- 2 Tap **[Settings]**.
- 3 Tap **[Time]**.
  - ↳ The date/time setup menu is displayed.

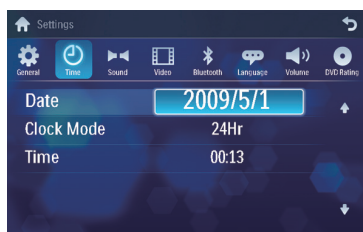

### Set date

- 1 Tap [Date].
- 2 Tap on the displayed date information.  
↳ A submenu is displayed.
- 3 Tap ▲ or ▼ to set year, month and day.

### Set clock mode

- 1 Tap [Clock mode].
- 2 Tap on [12Hr] or [24Hr] to select clock mode.

### Set time

- 1 Tap [Time].
- 2 Tap on the displayed time.  
↳ A submenu is displayed.
- 3 Tap ▲ or ▼ to set hour and minute.

## Use map

### Note

- You may need to upgrade the map (sold separately) before using it (see "Upgrade the map" section)

- 1 Tap the upper left corner to display home menu.
- 2 Tap [Navigation].  
↳ The navigation menu is displayed in a few seconds.
- 3 Refer to the map manual to operate the navigation tool.

## Play disc 4

You can play video, audio or images stored on the following discs:

- DVD video, DVD-R, DVD-RW
- VCD
- Audio CD, CD-R, CD-RW

- 1 Insert a disc into the disc slot with the label side facing up.  
↳ Play starts automatically.  
↳ To remove the disc, press ▲.

## Play USB device 5

- 1 Open the USB socket cover.
- 2 Insert the USB device to the USB socket.  
↳ Play starts automatically.

## Remove the USB device

- 1 Switch to another (non-USB) source.
- 2 Remove the USB device.

## Insert USB or SD/MMC card 6

- 1 Open the USB/SD/MAP socket cover.
- 2 Insert the SD/MMC card into the SD/MMC card slot.  
↳ Play starts automatically.

## Remove the SD/MMC card

- 1 Switch to another source.
- 2 Press the card until you hear a click sound.  
↳ The card is now disengaged.
- 3 Remove the SD or MMC card.

