

Register your product and get support at  
[www.philips.com/welcome](http://www.philips.com/welcome)

CEM2000



---

EN User manual

---

**PHILIPS**

# Contents

<b>1 Important</b>	4	<b>6 Adjust sound</b>	19
Safety	4	Adjust volume	19
Notice	4	Mute	19
		Turn DBB on/off	19
		Turn on/off max sound	19
		Select preset equalizer	19
		Switch music listening zone	19
		Other sound settings	19
<b>2 Your car audio system</b>	6	<b>7 Adjust system settings</b>	21
Introduction	6	Turn beep sound on/off	21
What's in the box	6	Select blackout setting	21
Overview of the main unit	7	Turn demo mode on/off	21
Overview of the remote control	8	Reset	21
<b>3 Get started</b>	10	<b>8 Additional information</b>	22
Install the car audio	10	Detach the front panel	22
Install remote control battery	13	Replace fuse	22
Turn on	13	Remove the unit	22
Select country/region	14	<b>9 Product information</b>	23
Set clock	14	<b>10 Troubleshooting</b>	24
<b>4 Listen to radio</b>	15	<b>11 Glossary</b>	25
Tune to a radio station	15		
Store radio stations in memory	15		
Store stations manually	15		
Tune to a preset station	15		
<b>5 Play audio files</b>	16		
Play a disc	16		
Play from USB	16		
Insert a card	17		
Search for an MP3/WMA track	17		
View play information	17		
Repeat play	17		
Shuffle play	18		
Intro play	18		
Connect external sound source	18		

# 1 Important

## Safety

- Read and understand all instructions before you use your apparatus. If damage is caused by failure to follow instructions, the warranty does not apply.
- This apparatus is designed for negative ground (earth) 12 V DC operation only.
- To ensure safe driving, adjust the volume to a safe and comfortable level.
- Improper fuses can cause damage or fire. When you need to change the fuse, consult a professional.
- Use only the supplied mounting hardware for a safe and secure installation.
- To avoid short circuit, do not expose the apparatus, remote control or remote control batteries to rain or water.
- Never insert objects into the ventilation slots or other openings on the apparatus.
- Clean the apparatus and frame with a soft, damp cloth. Never use substances such as alcohol, chemicals or household cleaners on the apparatus.
- Never place any objects other than discs into the apparatus.
- Never use solvents such as benzene, thinner, cleaners available commercially, or anti-static sprays intended for discs.
- Visible and invisible laser radiation when open. Avoid exposure to beam.
- Risk of damage to the apparatus screen! Never touch, push, rub or strike the screen with any object.

### Caution

- Use of controls or adjustments or performance of procedures other than herein may result in hazardous radiation exposure or other unsafe operation.

## Notice



The making of unauthorized copies of copy-protected material, including computer programs, files, broadcasts and sound recordings, may be an infringement of copyrights and constitute a criminal offence. This equipment should not be used for such purposes.



Windows Media and the Windows logo are trademarks, or registered trademarks of Microsoft Corporation in the United States and/or other countries.

**This apparatus includes this label:**



## Recycling



Your product is designed and manufactured with high quality materials and components, which can be recycled and reused. When you see the crossed-out wheel bin symbol attached to a product, it means the product is covered by the European Directive 2002/96/EC:



Never dispose of your product with other household waste. Please inform yourself about the local rules on the separate collection of electrical and electronic products. The correct disposal of your old product helps prevent potentially negative consequences on the environment and human health.

Your product contains batteries covered by the European Directive 2006/66/EC, which cannot be disposed of with normal household waste.

Please inform yourself about the local rules on separate collection of batteries. The correct disposal of batteries helps prevent potentially negative consequences on the environment and human health.



This product complies with the radio interference requirements of the European Community.

### **Environmental information**

All unnecessary packaging has been omitted. We have tried to make the packaging easy to separate into three materials: cardboard (box), polystyrene foam (buffer) and polyethylene (bags, protective foam sheet.)

Your system consists of materials which can be recycled and reused if disassembled by a specialized company. Please observe the local regulations regarding the disposal of packaging materials, exhausted batteries and old equipment.

Any changes or modifications made to this device that are not expressly approved by Philips Consumer Lifestyle may void the user's authority to operate the equipment.

2010 © Koninklijke Philips Electronics N.V. All rights reserved.

Specifications are subject to change without notice. Trademarks are the property of Koninklijke Philips Electronics N.V. or their respective owners. Philips reserves the right to change products at any time without being obliged to adjust earlier supplies accordingly.

# 2 Your car audio system

Congratulations on your purchase, and welcome to Philips! To fully benefit from the support that Philips offers, register your product at [www.philips.com/welcome](http://www.philips.com/welcome).

## Introduction

With the in-car audio system, you can enjoy your drive while listening to:

- FM or AM (MW) radio
- Audio from CD or MP3 disc
- Audio from USB devices
- Audio from SD/SDHC card
- Audio from other external devices

The unit supports the following media format:



- ④ Trim plate
- ⑤ Carrying case for front panel
- ⑥ Sleeve
- ⑦ Rubber cushion
- ⑧ Screws x 4 pcs
- ⑨ Disassembly tools x 2 pcs
- ⑩ User manual
- ⑪ Quick start guide

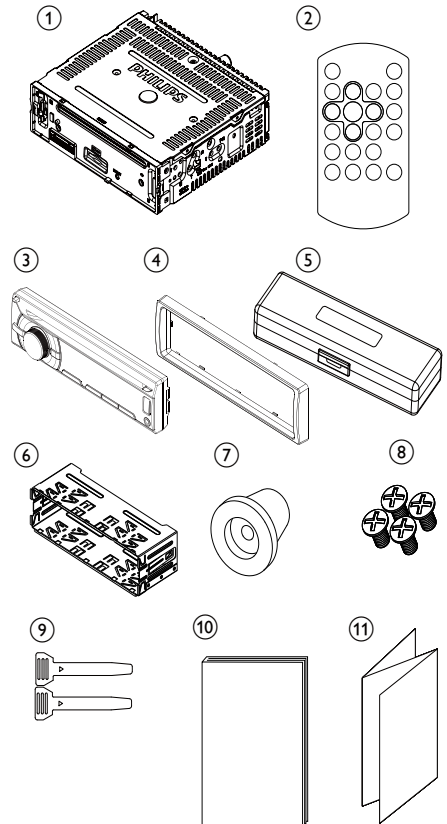

## What's in the box

Check and identify the contents of your package:

- ① Main unit
- ② Remote control
- ③ Front panel

# Overview of the main unit

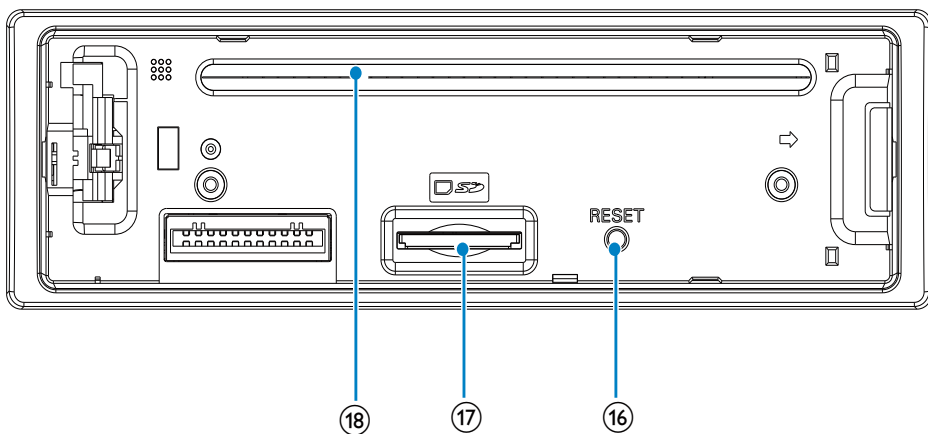
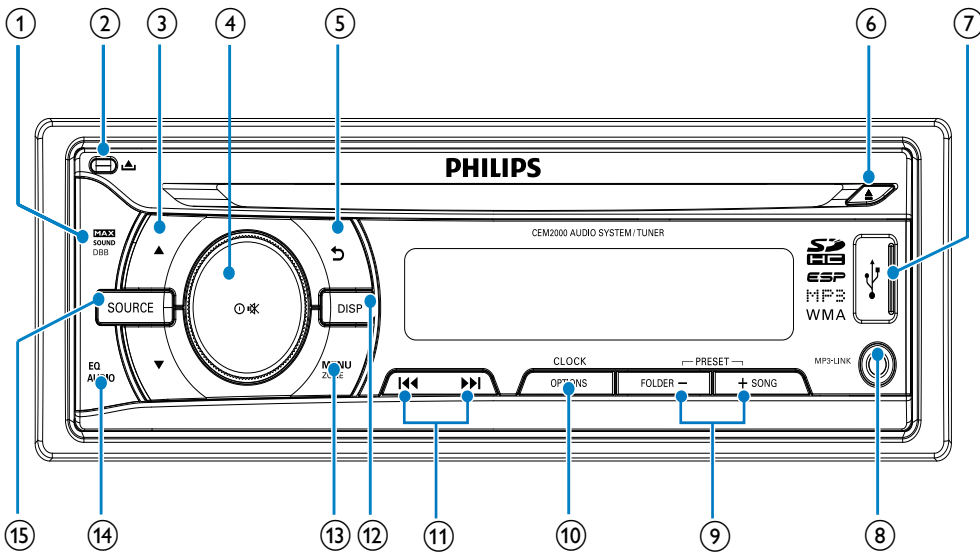

- ① **MAX SOUND/DBB**
- Turn on or off maximum volume.
  - Turn on or off Dynamic Bass Boost (DBB) sound.

- ② **▲**
- Unlock the panel.

- ③ **▲▼**
- Select tuner band.
  - Select MP3/WMA folder.
  - Scroll up/down menu.

## Overview of the remote control

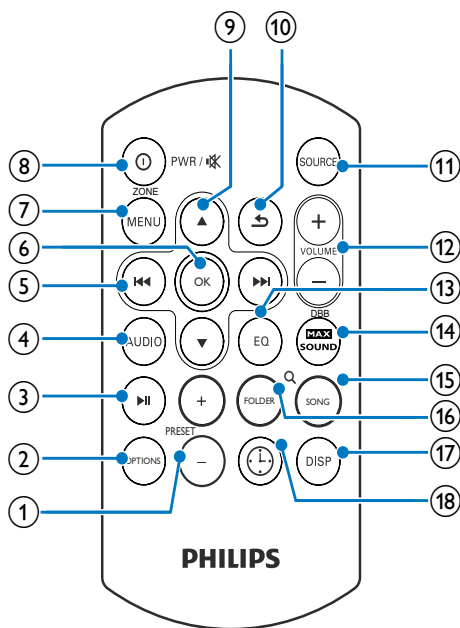

- ④ **⏻/OK/MUTE**
  - Turn the unit on or off.
  - Confirm selection.
  - Mute or unmute sound.
  - Rotate to adjust volume.
- ⑤ **↶**
  - Return to previous menu.
- ⑥ **⏪**
  - Eject disc.
- ⑦ **↷**
  - USB socket.
- ⑧ **MP3 LINK**
  - Connect external audio device.
- ⑨ **+SONG/FOLDER -**
  - Select preset radio station.
  - Search for track/folder.
- ⑩ **OPTIONS/CLOCK**
  - Access option menu.
  - View clock.
- ⑪ **⏮/⏭**
  - Tune for radio station.
  - Skip/search for track.
  - Fast forward/backward playback.
- ⑫ **DISP**
  - Display current status.
- ⑬ **MENU/ZONE**
  - Access system menu.
  - Access menu for switching the music listening zone.
- ⑭ **EQ AUDIO**
  - Select equalizer (EQ) setting.
  - Access audio setting menu.
- ⑮ **SOURCE**
  - Select audio source.
- ⑯ **RESET**
  - Restore default settings.
- ⑰ **Disc slot**

- ① **PRESET +/-**
  - Select preset radio station.
- ② **OPTIONS**
  - Access option menu.
- ③ **⏮**
  - Start play.
  - Pause or resume play.
- ④ **AUDIO**
  - Access audio setting menu.
- ⑤ **⏮/⏭**
  - Tune to a radio station
  - Skip track.
  - Fast backward/forward playback
- ⑥ **OK**
  - Confirm selection.
- ⑦ **MENU/ZONE**
  - Access system menu.
  - Access menu for switching the music listening zone.

- ⑧ **⓪/PWR/Ⓜ**
  - Turn the unit on or off.
  - Mute or restore volume.
- ⑨ **▲/▼**
  - Select tuner band.
  - Scroll up/down menu.
  - Select MP3/WMA folder.
- ⑩ **↶**
  - Return to previous menu.
- ⑪ **SOURCE**
  - Select audio source.
- ⑫ **VOLUME +/-**
  - Adjust volume.
- ⑬ **EQ**
  - Select equalizer (EQ) setting.
- ⑭ **MAX SOUND/DBB**
  - Turn on or off maximum volume
  - Turn on or off Dynamic Bass Boost (DBB) sound.
- ⑮ **SONG**
  - Search for track.
- ⑯ **FOLDER**
  - Search for folder.
- ⑰ **DISP**
  - Display current status.
- ⑱ **CLOCK**
  - View clock.



# 3 Get started

## ! Caution

- Use the controls only as stated in this user manual.

Always follow the instructions in this chapter in sequence.

If you contact Philips, you will be asked for the model and serial number of your apparatus. The model number and serial number are on the bottom of your apparatus. Write the numbers here:

Model No. \_\_\_\_\_

Serial No. \_\_\_\_\_

---

## Install the car audio

These instructions are for a typical installation. However, if your car has different requirements, make the corresponding adjustment. If you have any questions regarding installation kits, consult your Philips car audio dealer.

## ! Caution

- This unit is designed for negative ground (earth) 12 V DC operation only.
- Always install this unit in the car dashboard. Other locations can be dangerous as the rear of the unit heats up during use.
- To avoid short-circuit: before you connect, ensure that the ignition is off.
- Ensure that you connect the yellow and red power supply leads after all other leads are connected.
- Ensure that all loose leads are insulated with electrical tape.
- Ensure that the leads do not get caught under screws or in parts that will move (e.g. seat rail).
- Ensure that all ground (earth) leads are run to a common ground (earth) point.
- Use only the supplied mounting hardware for a safe and secure installation.
- Improper fuses can cause damage or fire. When you need to change the fuse, consult a professional.

## Note on the power supply lead (yellow)

- When you connect other devices to this apparatus, ensure that the rating of the car circuit is higher than the total fuse value of all the connected devices.

## Notes on speaker connection

- Never connect speaker wires to the metal body or chassis of the car.
- Never connect speaker wires with stripes to one another.

---

## Connection: for cars without ISO connectors

## ! Caution

- Ensure that all loose leads are insulated with electrical tape.
- Be sure to connect the black ground (earth) lead first.

- 1 Connect the ISO connectors (not supplied) to the unit.

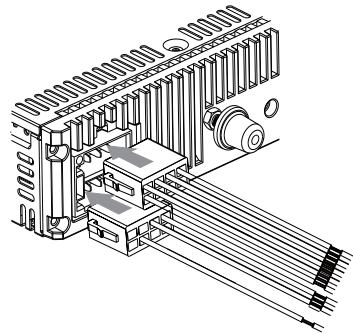

- 2 Check the car's wiring carefully and connect them to the ISO connector.

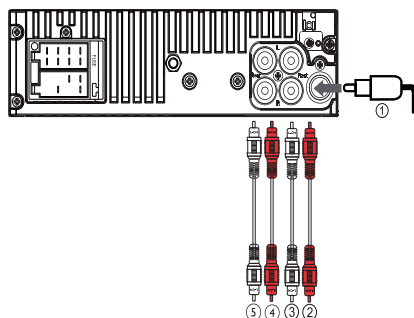
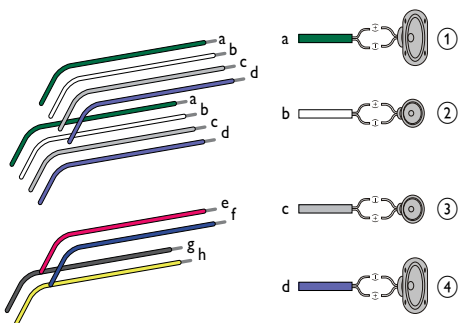

1	Green/black strip	Left speaker (Rear)
2	White/black strip	Left speaker (Front)
3	Gray/black strip	Right speaker (Front)
4	Purple/black strip	Right speaker (Rear)

e	RED	Ignition key +12V DC when ON/ACC
f	BLUE	Motor/electric antenna relay control lead/ Amplifier relay control lead
g	BLACK	Ground
h	YELLOW	To the +12V car battery which is energized at all times

	Connector	Connect to
1	ANTENNA	Antenna
2	FRONT LINE OUT R (Socket)	Front right speaker
3	FRONT LINE OUT L (Socket)	Front left speaker
4	REAR LINE OUT R (Socket)	Rear right speaker
5	REAR LINE OUT L (Socket)	Rear left speaker

#### Tip

- The pin arrangement for the ISO connectors depends on the type of vehicle you drive. Be sure to make proper connections to prevent damage to the unit.

## Mount into the dashboard

- If the car does not have an on-board drive or navigation computer, disconnect the negative terminal of the car battery.
  - If you disconnect the car battery in a car that has an on-board drive or navigation computer, the computer may lose its memory.
  - If the car battery is not disconnected, to avoid short-circuit, ensure that the bare wires do not touch each other.
- Ensure that car dashboard opening is within these measurements:

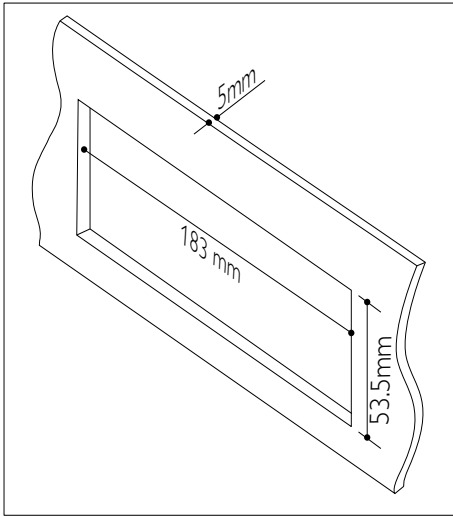

- 3** Remove the two screws on the top of the unit.

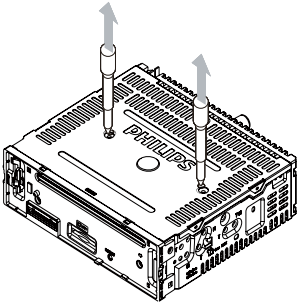

- 4** Remove the mounting sleeve with the supplied disassembly tools.

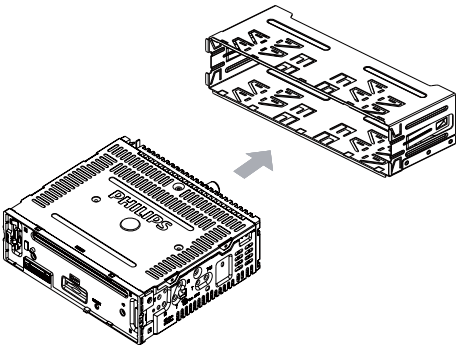

- 5** Install the sleeve into the dashboard and bend the tabs outward to fix the sleeve.

**Note**

- If the unit is not fixed by sleeve but by the supplied screws, skip this step.

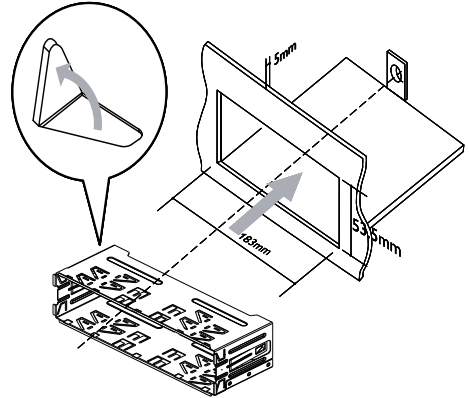

- 6** Place the supplied rubber cushion over the end of the mounting bolt.

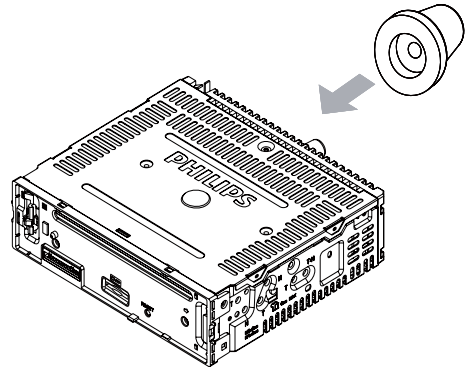

- 7** Slide the unit into the dashboard until you hear a click sound.

## Install remote control battery

### ! Caution

- Risk of explosion! Keep batteries away from heat, sunshine or fire. Never discard batteries in fire.
- Risk of decreased battery life! Never mix different brands or types of batteries.
- Risk of product damage! When the remote control is not used for long periods, remove the batteries.
- Perchlorate Material - special handling may apply. See [www.dts.com/hazardouswaste/perchlorate](http://www.dts.com/hazardouswaste/perchlorate).

### For first-time use:

- 1 Remove the protective tab to activate the remote control battery.

### To replace the remote control battery:

- 1 Open the battery compartment.
- 2 Insert one CR2025 battery with correct polarity (+/-) as indicated.
- 3 Close the battery compartment.

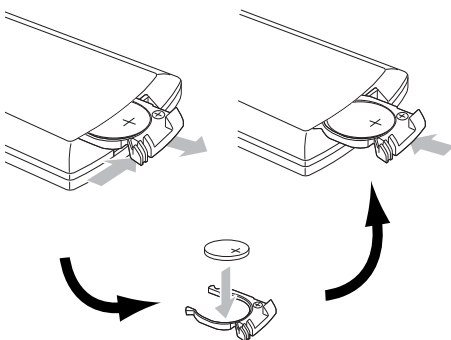

## Turn on

- 1 Press **⏻** to turn on the unit.
  - To turn off the unit, press **⏻** for over 3 seconds.

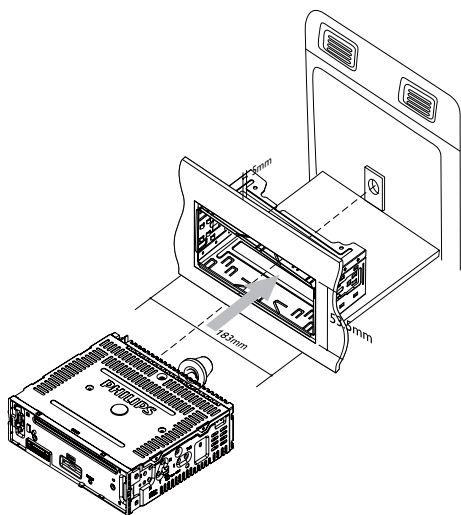

- 8 Reconnect the negative terminal of the car battery.

## Attach the front panel

- 1 Attach the trim plate.

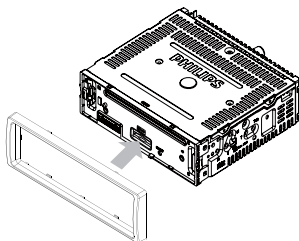

- 2 Insert the right side of the panel in the chassis until it is correctly engaged.
- 3 Press the left side of the panel until the mechanism locks it into place.

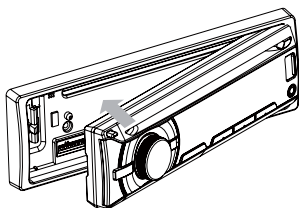

---

## Select country/region

### Note

- Select correct country/region for this unit, otherwise the unit can not work properly.

- 1 Press **⊕** to turn on the unit.  
↳ **[SELECT OPERATING REGION]** is displayed.
- 2 Rotate **⊕** to select an option:
  - **[USA]** (United States)
  - **[Latin]** (Latin America)
  - **[Europe]** (Western Europe)
  - **[ASIA]** (Asia Pacific)
  - **[Mid-East ]** (Middle East)
  - **[Russia]** (Russia)
- 3 Press **⊕** to confirm.

---

## Set clock

- 1 Press **MENU**.
- 2 Press **▲** or **▼** repeatedly until currently time is displayed.
- 3 Turn **⊕** clockwise to set hour.
- 4 Press **⊕** to confirm.
- 5 Turn **⊕** anti-clockwise to set minute.
- 6 Press **⊕** to confirm.

---

## View clock

- 1 Press and hold **OPTIONS** repeatedly until the clock is displayed.

## 4 Listen to radio

### Tune to a radio station

- 1 Press **SOURCE** repeatedly to select Tuner.
- 2 Press ▲ or ▼ to select band: [FM1], [FM2], [FM3], [AM1], or [AM2].
- 3 Press ◀◀ or ▶▶ to tune to a radio station manually.
  - ↳ The radio station is broadcast.
  - ↳ To search for a radio station automatically, press ◀◀ or ▶▶ for over 3 seconds.

### Select tuner sensitivity

To receive more radio stations or only stations with strong signal, you can adjust the tuner sensitivity.

- 1 Press **OPTIONS** repeatedly until [LOCAL SEEK ON] or [LOCAL SEEK OFF (DX)] is displayed.
- 2 Rotate Ⓞ to select a setting:
  - [LOCAL SEEK ON] (local seek on): Only stations with strong signal can be broadcast.
  - [LOCAL SEEK OFF (DX)] (local seek off): Stations with strong and weak signals can be broadcast.

### Store radio stations in memory

You can store up to 6 stations in each band.

### Store stations automatically

- 1 Press **OPTIONS** repeatedly until **AUTO-STORE** is displayed, then press Ⓞ to confirm.

- ↳ The six strongest stations of the selected band are saved in preset channel automatically: FM1,FM2,FM3 1-6,AM1,AM2.

### Store stations manually

- 1 Tune to a station that you want to store. (see 'Tune to a radio station' on page 16)
- 2 Press and hold **PRESET +/-** to enter storing mode.
  - ↳ The preset number on LCD screen blinks..
- 3 Press **PRESET +/-** to select storing location.
- 4 Press Ⓞ to confirm.
  - ↳ The station is saved in the selected channel.
  - ↳ The preset number on LCD screen lights up and remains on.

### Tune to a preset station

- 1 Press ▲ or ▼ to select band.
- 2 Press **PRESET +/-** to select the preset station.

# 5 Play audio files

## Note

- Ensure that the disc or device contains playable files.

## Play a disc

## Note

- You cannot play CDs encoded with copyright protection technologies.

You can play commercially available audio CDs and these discs:

- CD-Recordables (CD-R)
- CD-Re-writables (CD-RW)
- MP3 CDs
- WMA CDs

## Note

- Ensure that the disc contains playable content.

- 1 Insert a CD with the printed side facing up.  
↳ Play starts automatically.
- To pause CD play, press  $\odot$ .
- To resume CD play, press  $\odot$  again.
- To skip to the previous/next track, press  $\lll$  or  $\ggg$ .
- To search backward/forward rapidly within the current track, press  $\lll$  or  $\ggg$  for 3 seconds.

## Remove the CD

To take out the CD, press  $\blacktriangle$  on the front panel.

## Tip

- If the disc is blocked in the disc compartment, press and hold  $\blacktriangle$  until the disc comes out.

## Play from USB

## Note

- Ensure that the USB device contains playable music.

## Insert the USB device

- 1 Slide the USB socket cover marked  $\leftarrow$  to the left.
- 2 Insert the USB device into the USB socket.  
↳ The unit starts playing from the USB device automatically.

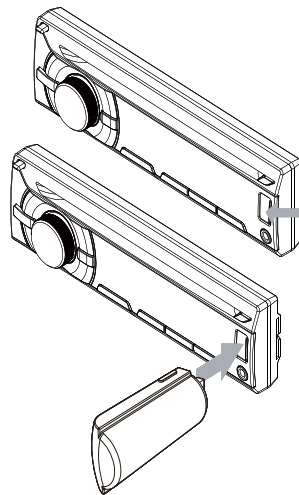

## Remove the USB device

- 1 Press  $\odot$  to turn off the unit.
- 2 Remove the USB device.

## Insert a card

### Note

- This unit supports SD and SDHC cards.

- 1 Press **▲** to release the panel.
- 2 Push the left side of the panel rightward, then pull the panel towards you to disengage it from the chassis.
- 3 Insert the card into the card slot.  
↳ The unit starts playing from the card automatically.

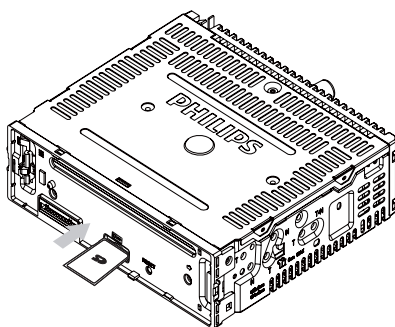

## Remove the card

- 1 Press **⏻** to turn off the unit.
- 2 Press the card until you hear a click sound.  
↳ The card is now disengaged.
- 3 Remove the card.

## Search for an MP3/WMA track

### Search within the current folder

- 1 Press **+SONG**.  
↳ The name of the current track is displayed.

- 2 Turn **⊙** to select another track in current folder.
- 3 Press **⊙** to confirm.

### Search in other folder

- 1 Press **FOLDER -**.  
↳ The name of the current folder is displayed.
- 2 Rotate **⊙** to navigate through all folders.
- 3 Press **⊙** to access the selected folder.
- 4 Rotate **⊙** to select a track in the folder.
- 5 Press **⊙** to start play.

### Tip

- To go back to upper level of a folder, press **↶**.

## View play information

- 1 During playing, press **DISP** repeatedly to view:
  - Track number and elapsed play time
  - Artist
  - Album
  - Title
  - Folder
  - File

## Repeat play

- 1 During play, press **OPTIONS** repeatedly until **[REPEAT]** is displayed.
- 2 Rotate **⊙** to select a setting.
  - **[RPT TRK]** (repeat one track): play current track repeatedly.
  - **[RPT FLD]** (repeat a folder): play all tracks in the current folder repeatedly.
  - **[RPT ALL]** (repeat all tracks): play all tracks repeatedly.



---

## Shuffle play

You can play the tracks in random order:

- 1 During play, press **OPTIONS** repeatedly until **[RANDOM]** is displayed.
- 2 Rotate  $\odot$  to select a setting:
  - **[RDM OFF]**: cancel shuffle play.
  - **[RDM FLD]**: start shuffle within a folder that is being played.
  - **[RDM ALL]**: start shuffle play for all tracks.

---

## Intro play

You can play the first 10 seconds of each track.

- 1 During play, press **OPTIONS** repeatedly until **[INT]** is displayed:
- 2 Rotate  $\odot$  to select a setting:
  - **[INT ON]** : After the first 10 seconds of each track have been played, play stops.
  - **[INT OFF]** : Cancel intro play and start normal play.

---

## Connect external sound source

- 1 Connect the external sound source to **MP3 LINK** socket with a 3.5 mm cable.
- 2 Press **SOURCE** repeatedly until **[MP3 LINK]** is displayed.
- 3 Operate the external component (refer to the instructions supplied with the external component).

## 6 Adjust sound

### Adjust volume

- 1 Turn  $\odot$  clockwise/anticlockwise to increase/decrease volume.

### Mute

You can turn off the sound of your audio.

- 1 During play, press  $\odot$ .
  - To resume sound, press  $\odot$  again.

### Turn DBB on/off

- 1 Press **DBB** for over 3 seconds.
  - ↳ The current DBB setting is displayed.
  - ↳ **[DBB ON]**: The Dynamic Bass Boost (DBB) function is on.
  - ↳ **[DBB OFF]**: The DBB function is off.
- 2 Press **DBB** again to change the DBB setting.

### Turn on/off max sound

- 1 Press **MAX SOUND**.
  - ↳ The current setting displays
  - ↳ **[MAX ON]**: The maximum sound (max sound) function is on.
  - ↳ **[MAX OFF]**: The max sound is off.
- 2 Press **MAX SOUND** again to select an option.

### Select preset equalizer

- 1 Press **EQ/Audio**.
  - ↳ Current Equalizer setting is displayed.

- 2 Press **EQ/Audio** again to select a preset EQ setting:
  - **[OPTIMAL]** (optimal)
  - **[FLAT]** (flat)
  - **[POP]** (pop)
  - **[USER]** (user)
  - **[TECHNO]** (techno)
  - **[ROCK]** (rock)
  - **[CLASSIC]** (classic)
  - **[JAZZ]** (jazz)

### Switch music listening zone

Philips' innovative Zone technology enables driver or passengers to enjoy music with the best speakers balance and experience more vivid spacial effect as the artist is intended to create. You can switch the music listening zone from driver to passengers for the best speaker sound settings in car.

- 1 Press **MENU/ZONE** over 3 seconds.
  - ↳ The current setting displays
- 2 Press  $\blacktriangle/\blacktriangledown$  to switch the zones:
  - **[ZONE ALL]**
  - **[FRONT]**
  - **[F. LEFT]** (Front left)
  - **[F. RIGHT]** (Front right)
- 3 Press **OK** to confirm the selection and exit the menu.

### Other sound settings

You can also adjust the preset **EQ/Audio** settings.

- 1 Press **EQ/Audio** for 3 seconds.
- 2 Press  $\blacktriangle$  or  $\blacktriangledown$  repeatedly to select the item to be adjusted:
  - **[BAS]** (bass) range: -7 to +7.
  - **[TRE]** (treble) range: -7 to +7.
  - **[BAL]** (balance) range: 12L to 12R. (L = left speaker, R = right speaker)

- **[FAD]** (fader) range: 12R to 12F. (R = rear speaker, F = front speaker)

**3** Rotate  $\odot$  to select a value.

# 7 Adjust system settings

## Turn beep sound on/off

Each time you press a button, the unit beeps. You can turn on or off this beep sound.

- 1 Press **MENU**.
- 2 Press **▲** or **▼** repeatedly to until **[BEEP]** is displayed.
- 3 Rotate **⊖** to select a setting:
  - **[BEEP ON]**: Turn on the beep sound.
  - **[BEEP OFF]**: Turn off the beep sound.

## Select blackout setting

You can set the screen to turn off automatically after the unit is idle for 10 or 20 seconds.

- 1 Press **MENU**.
- 2 Rotate **⊖** to select a setting:
  - **[BKO 10 S]**: Turn off the screen automatically 10 seconds after last operation.
  - **[BKO 20 S]**: Turn off the screen automatically 20 seconds after last operation.
  - **[BKO OFF]**: Never turn off the screen.
- 3 Press **⊖** to confirm.

## Turn demo mode on/off

- 1 Press **MENU**.
- 2 Press **▲** or **▼** repeatedly until **[DEMO]** is displayed.
  - ↳ The screen shows current Demo mode setting.

- 3 Rotate **⊖** to select a setting:
  - **[DEMO ON]**: Turn on the demo mode. When the unit is idle for more than 10 seconds, all functions are displayed.
  - **[DEMO OFF]**: Turn off the demo mode.

## Reset

You can reset the unit to its default setting.

- 1 Detach the front panel.
- 2 Press the reset button by using a ball-point pen or a similar tool.
  - ↳ Preset adjustments such as preset channels and sound adjustments are erased.

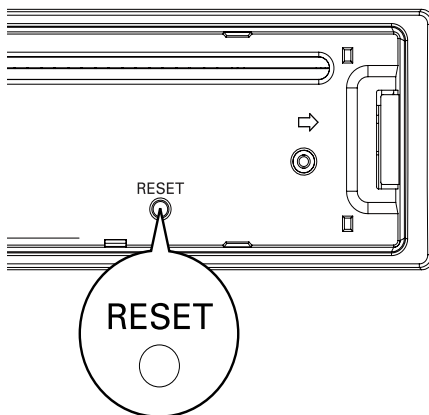

# 8 Additional information

## Detach the front panel

You can detach the front panel to deter theft.

- 1 Press  to release the panel.
- 2 Push the left side of the panel rightward.

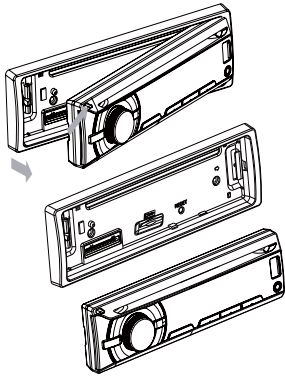

- 3 Pull the panel towards you to disengage it from the chassis.
- 4 Store the panel in the supplied carry case to protect it from dirt or damage.

## Replace fuse

If the fuse is damaged,

- 1 Check the electric connection.
- 2 Buy a fuse that matches the voltage of the damaged fuse.
- 3 Replace the fuse.

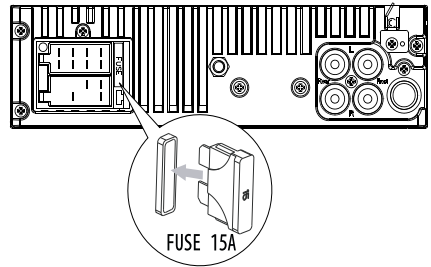

### Note

- If the new fuse gets damaged again, there may be an internal malfunction. Consult your Philips dealer.

## Remove the unit

You can remove the unit from the dashboard.

- 1 Detach the front panel.
- 2 Pull out the unit by using the disassembly tools.

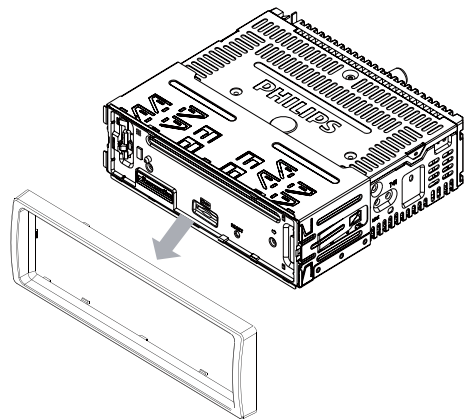

# 9 Product information

## Note

- Product information is subject to change without prior notice.

Power supply	12 V DC (11 V - 16 V), negative ground
Fuse	15 A
Suitable speaker impedance	4 - 8 $\Omega$
Continuous power output	22 W $\times$ 4 RMS (4 $\Omega$ 10% T.H.D.)
Pre-Amp output voltage	1.5 V
Aux-in level	$\geq$ 500 mV
Dimensions (W $\times$ H $\times$ D)	188 $\times$ 58 $\times$ 201 mm
Weight	1.47 kg

## Radio

Frequency range - FM	87.5 - 108.0 MHz (100kHz per step in auto search and 50kHz per step in manual search)
Frequency range - AM(MW)	522 - 1620 KHz (9 kHz) 530 - 1710 kHz (10 kHz)
Usable sensitivity - FM	8 $\mu$ V
Usable sensitivity - AM(MW) (S/N = 20 dB)	30 $\mu$ V

## Compatible USB devices:

- USB flash memory: USB 1.1 host with interface reading all speed support (1.1, 2.0)
- USB flash players: USB 1.1 host with interface reading all speed support (1.1, 2.0)
- Memory cards (SD / SDHC)

## Supported formats:

- USB or memory file format: FAT16, FAT32
- MP3 bit rate (data rate): 32-320 Kbps and variable bit rate
- WMA V4, V7, V8, V9 (L1, L2)
- ISO9660, Joliet
- Maximum title number: 512 (depending on file name length)
- Maximum album number: 255
- Supported sampling frequencies: 2 kHz, 44.1 kHz, 48 kHz
- Supported Bit-rates: 2~256 (kbps), variable bit rates
- Directory nesting up to a maximum of 8 levels
- Number of albums/ folders: CD maximum 99, USB maximum 199
- Number of tracks/titles: maximum 999
- ID3 tag v2.0 to v2.4
- File name in Unicode UTF8 (maximum length 64 bytes)

## Unsupported formats:

- Empty albums: an empty album is an album that does not contain MP3/WMA files, and is not be shown in the display.
- Unsupported file formats are skipped. For example, Word documents (.doc) or MP3 files with extension .dlf are ignored and not played.
- AAC, WAV, PCM audio files
- DRM protected WMA files (.wav, .m4a, .m4p, .mp4, .aac)
- WMA files in Lossless format

# 10 Troubleshooting



## Caution

- Never remove the casing of this apparatus.

To keep the warranty valid, never try to repair the system yourself.

If you encounter problems when using this apparatus, check the following points before requesting service. If the problem remains unsolved, go to the Philips web site ([www.philips.com/support](http://www.philips.com/support)). When you contact Philips, ensure that your apparatus is nearby and the model number and serial number are available.

### No power or no sound.

- Car engine is not on. Turn the car engine on.
- Cable is not correctly connected. Check connections.
- Fuse is burnt. Replace fuse.
- Volume is too low. Adjust volume.
- If the above solutions cannot help, press the RESET button.
- Ensure that the track played is of a compatible format.

### Noise in broadcasts.

- Signals are too weak. Select other stations with stronger signals.
- Check the connection of the car antenna.
- Change broadcast from Stereo to mono.

### Cannot play disc

- Ensure that the disc label is inserted with the printed side facing up.
- Wipe the disc with fibre cleaning cloth from the centre to the edge in a straight line.
- This disc may be defective. Play another disc.
- Ensure that the CD is a finalised CD/CD-R/CD-RW.
- Ensure that the CD is not encoded with copyright protection technologies.

### The CD skips tracks

- Ensure that the CD is not damaged or dirty.
- Ensure that random mode is deactivated.

### Disc cannot be ejected

- Press and hold ▲.

### Preset stations lost.

- Battery cable is not correctly connected. Connect the battery cable to the terminal that is always live.

### Display show ERR-12

- USB data error. Check the USB device.

# 11 Glossary

---

## M

### MP3

A file format with a sound data compression system. MP3 is the abbreviation of Motion Picture Experts Group 1 (or MPEG-1) Audio Layer 3. With the MP3 format, one CD-R or CD-RW can contain about 10 times more data than a regular CD.

---

## S

### SD

Secure Digital. A type of memory card with a flash memory.

### SDHC

Secure Digital High Capacity (SDHC) is a type of flash memory card based on the SDA 2.00 specification. The SDA 2.00 specification enables SD cards to reach higher capacities from 4GB to 32GB, and growing.

---

## W

### WMA (Windows Media Audio)

An audio format owned by Microsoft, is a part of Microsoft Windows Media technology. Includes Microsoft Digital Rights Management tools, Windows Media Video encoding technology, and Windows Media Audio encoding technology.



