



Philips BeNear
Cordless phone

1000-series
Black



CD1962B

Bringing people closer

Talk handsfree

Great sound reproduction, without having to hold the phone to your ear – so you can talk completely handsfree. With simple installation, a user-friendly menu and an inbuilt answering machine, a great chat has never been easier.

Crystal clear sound

- Advanced sound testing & tuning for superb voice quality
- Parametric Equalizer delivers pure and clear sound
- Acoustic echo cancellation keeps your conversation echo-free
- Optimized antenna layout for great reception in any room
- Handset speakerphone allows you to talk handsfree

Nice and simple

- Up to 15 min. message on your answering machine
- Easy to read, 4.1cm (1.6") dot-matrix display
- Ultimate convenience through easy setup
- Save up to 50 favorite contacts in your phonebook
- Up to 16 hours of talk time

Eco-conscious product

- Low power consumption: < 0.65 W in stand-by mode
- Up to 95% reduction of emitted radiation in charging mode



asimpleswitch.com

PHILIPS

Cordless phone
1000-series Black

Highlights

4.1cm(1.6") dot-matrix display

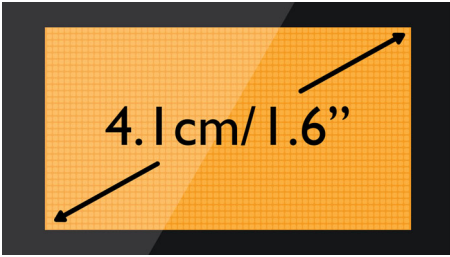

Easy to read, 4.1cm (1.6") dot-matrix display

50-name phone book



Always have the phone numbers of your loved ones available: Save up to 50 names in your phonebook.

Acoustic echo cancellation

No more of those annoying echoes when you are talking on the phone. With our acoustic echo cancellation, you always get a clear, undisturbed connection.

Advanced sound testing



We test the sound quality of our DECT phones the same way as high-end headphone manufacturers do. Using an advanced ear simulator, we can accurately re-create the way people actually hear. This helps our acoustic engineers to measure and fine-tune things like frequency response, distortion and overall hearing perception, to create perfect voice

reproduction for both handset and handsfree modes.

Easy setup

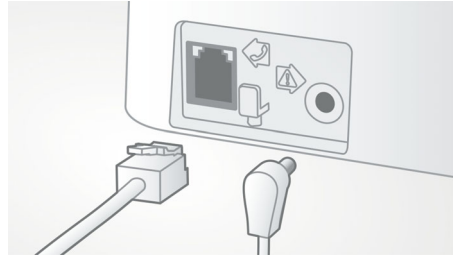

Ultimate convenience through easy set up. Simplified installation - Plug & Play product

Handset speakerphone



Handsfree mode uses a built-in loud speaker to amplify the voice of the caller, allowing you to speak and listen during a call without holding the phone to your ear. This is especially useful if you want to share the call with others or simply multitask.

Less radiation while charging



Up to 95% reduction of emitted radiation in charging mode

CD1962B/51

Low power consumption:< 0.65 W



Philips phones are energy efficient and are designed to be respectful to the environment. Now the power consumed in stand-by mode is less than < 0.65 W.

Optimized antenna layout



Our optimized antenna layout ensures strong and stable reception – even in areas of the house where cordless transmission is difficult. Now you can take a call wherever you are in the house, and enjoy a long, uninterrupted conversation even as you walk around.



Philips Green Logo
Philips Green Products can reduce costs, energy consumption and CO2 emissions. How? They offer a significant environmental improvement in one or more of the Philips Green Focal Areas – Energy efficiency, Packaging, Hazardous substances, Weight, Recycling and disposal and Lifetime reliability.

Specifications

Sound

- Volume control on handset
- Ringtones on handset: 10 polyphonic

Picture/Display

- Display size: 4.1cm / 1.6"
- Backlight: Yes
- Backlight color: Amber
- Display type: 1-line dot matrix + 2 line icons

Answering Machine

- Recording time capacity: up to 15 minutes
- Pre-recorded OGM
- Message counter on base: LED (Soft Amber)
- Loud speaker on base
- Answering Machine control:: from base and handset

Convenience

- Menu structure in the handset: List Menu
- Signal strength indicator: 3- bar indicator
- Battery level indicator: 3- bar battery icon
- Date / Time display
- Base Station keys: Paging key
- Battery charge indication
- Charge time: 8 hours
- Signal strength indication
- Programmable hot keys: Key 1 and 2
- Call Management: Call Waiting*, AOH/ Caller ID, Microphone mute, Missed Calls, Received Calls
- Key tone on/off
- Auto hang up
- Multi base capability: 1
- Multi handset capability: Up to 4
- Speakerphone - talk handsfree
- Range: Open field <300m; in door <50m

- Up to 16 hrs talk time
- Up to 250 hrs standby time
- Line cord length: 1.8m
- Power cord length: 1.8m

Memory Capacity

- Phonebook: 50 names and numbers
- Redial List Capacity: 10 entries
- Call log entries: 20 entries
- Phonebook store in the base

Power

- Battery capacity: 650 mAh
- Battery type: AAA NiMH Rechargeable
- Mains power: AC 100-240V ~50/60Hz
- Power Consumption: < 0.65 W

Network Features

- Compatible: GAP

SAR Value

- Philips handsets: <0.1 W/kg

Eco Design

- EcoMode: automatic

Packaging dimensions

- Packaging dimensions (W x H x D): 18.5 x 13.6 x 10.4 cm
- EAN: 87 12581 61627 4
- Gross weight: 0.779 kg
- Nett weight: 0.646 kg
- Number of products included: 1
- Packaging type: Carton
- Tare weight: 0.133 kg
- Type of shelf placement: Laying



Issue date 2015-02-19

Version: 5.1.5

12 NC: 8670 000 80418
EAN: 87 12581 61627 4

© 2015 Koninklijke Philips N.V.
All Rights reserved.

Specifications are subject to change without notice.
Trademarks are the property of Koninklijke Philips N.V.
or their respective owners.

www.philips.com