

Always there to help you

Register your product and get support at
www.philips.com/support



HTD3510

HTD3540

HTD3570

Quick start guide

PHILIPS



EN Before using your product, read all accompanying safety information

ZH-CN 使用产品前，请阅读所有随附的安全信息



HTD3510

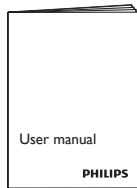
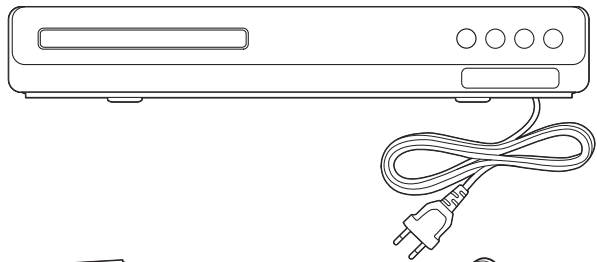
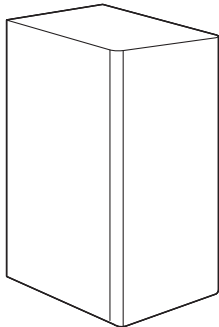
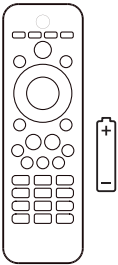

FM Antenna



HDMI



HTD3540

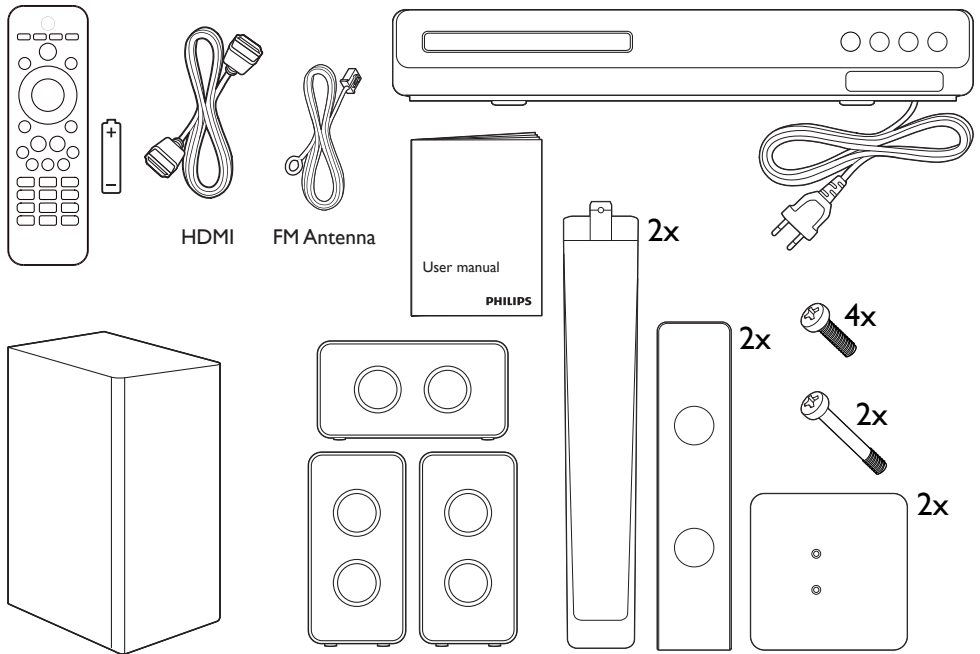

HTD3570

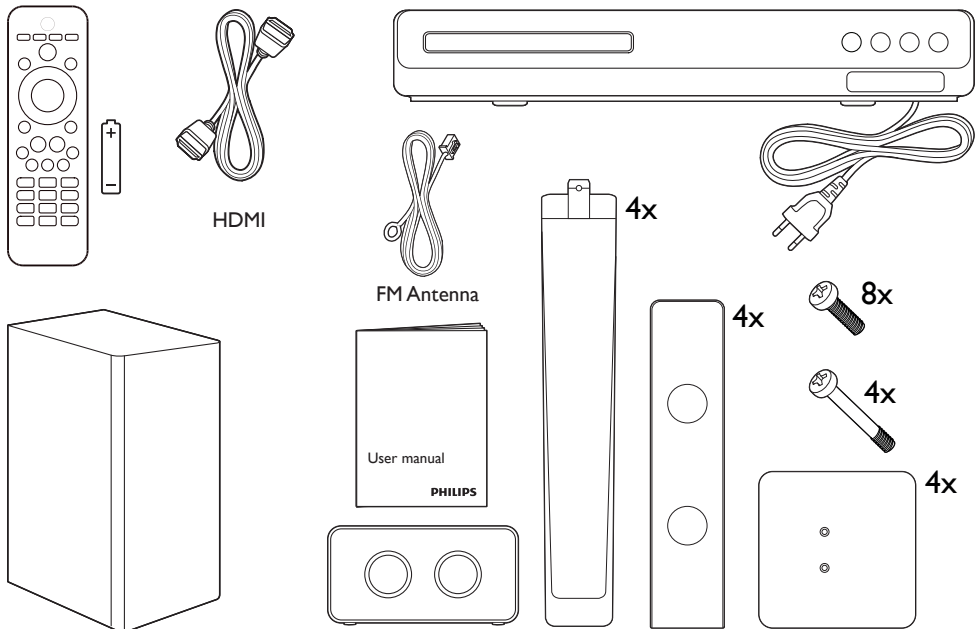

1

EN Stand mount the speakers
Applied to HTD3540 and HTD3570 only

ZH-CN 桌架和扬声器
只适用于 HTD3540 和 HTD3570 的型号。

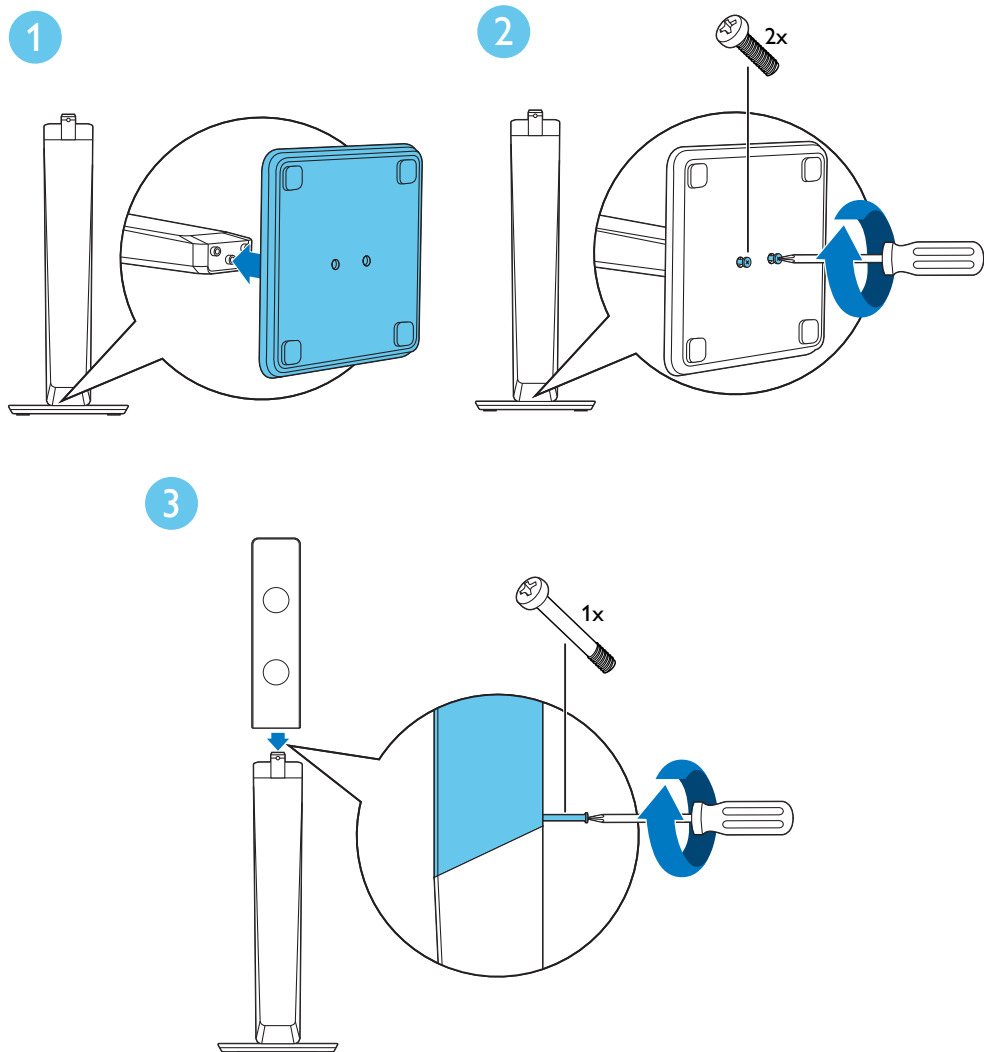

2

EN Connect and position the home theater

ZH-CN 连接和放置家庭影院

HTD3510

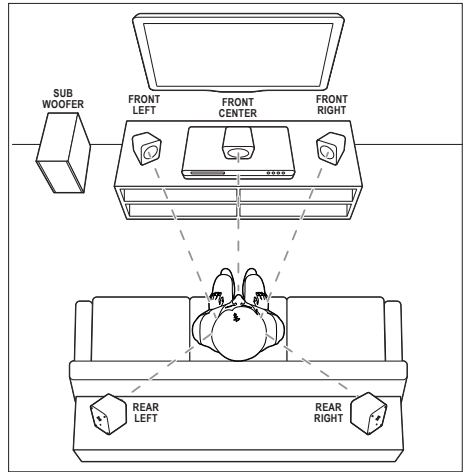
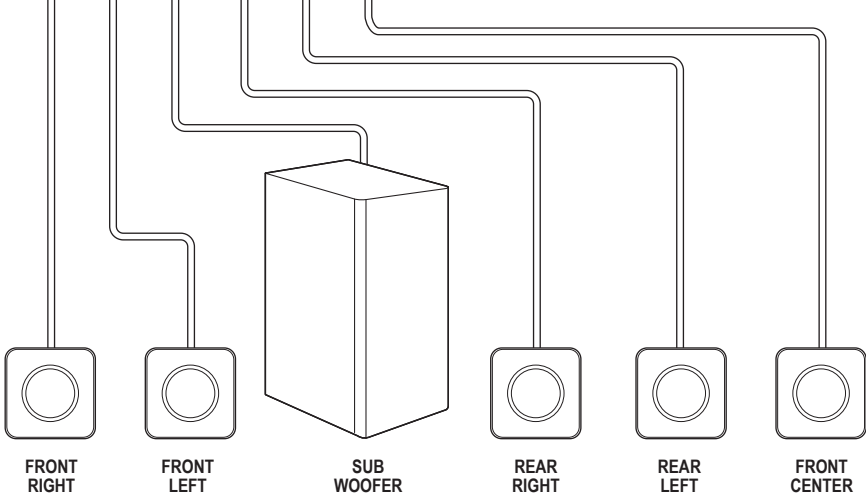
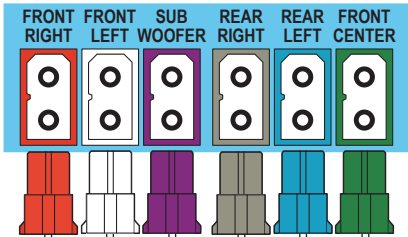
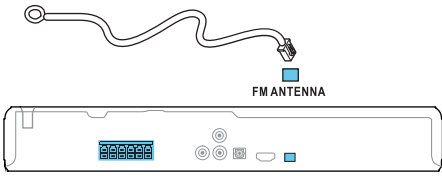

HTD3540

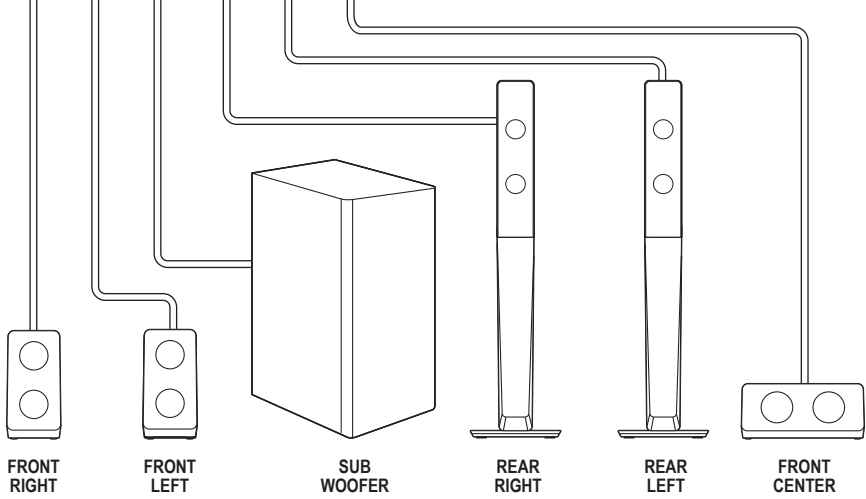
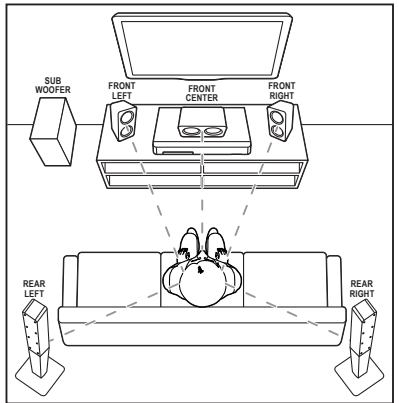
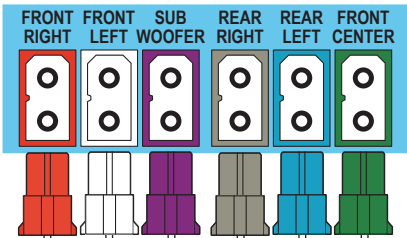
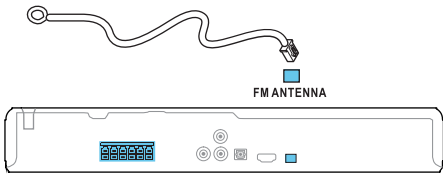

HTD3570

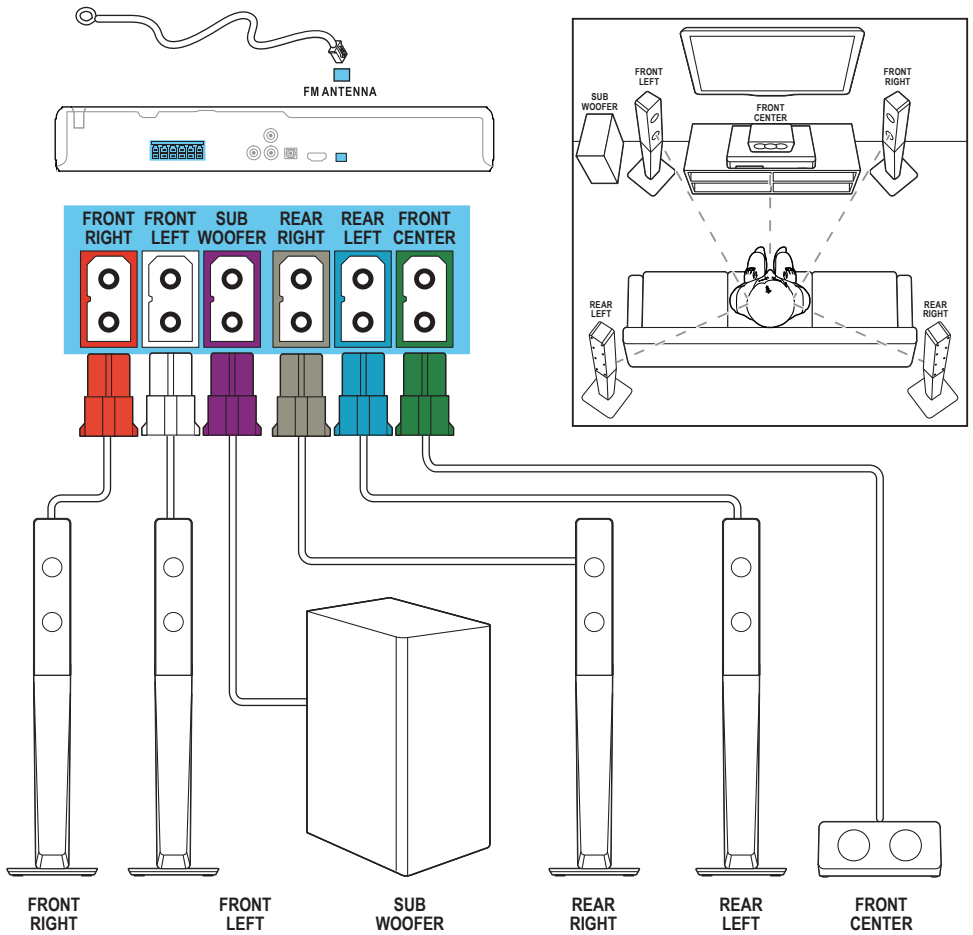

3

EN Connect to TV in one of these ways

ZH-CN 通过这些方式连接至电视

HDMI ARC

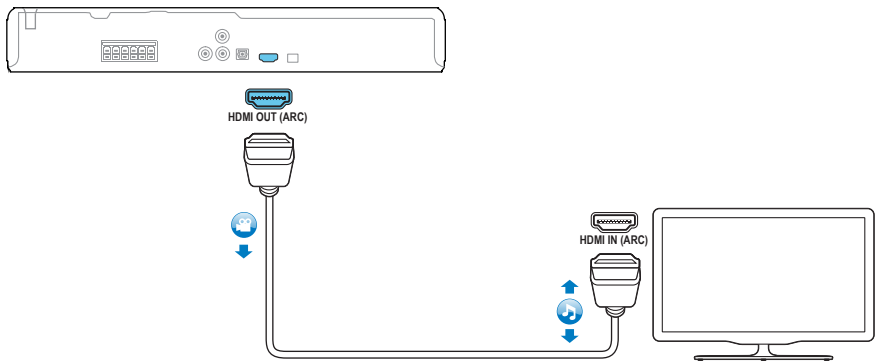

HDMI + OPTICAL

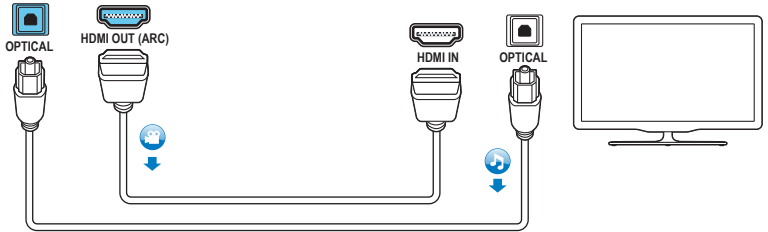
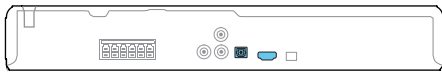

VIDEO + AUDIO L/R

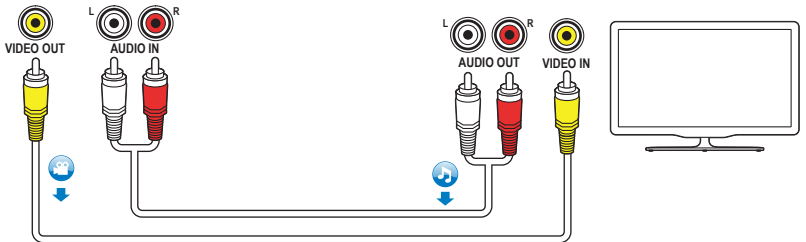

4

EN Switch on the home theater

ZH-CN 打开家庭影院

1

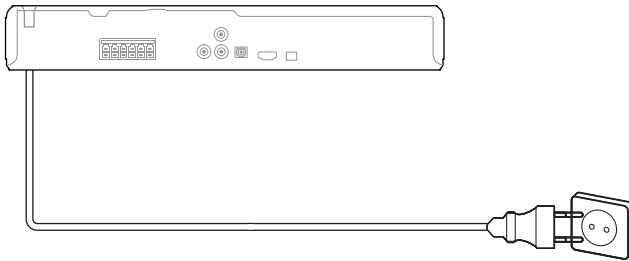

2

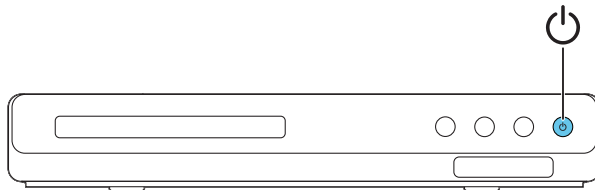

3

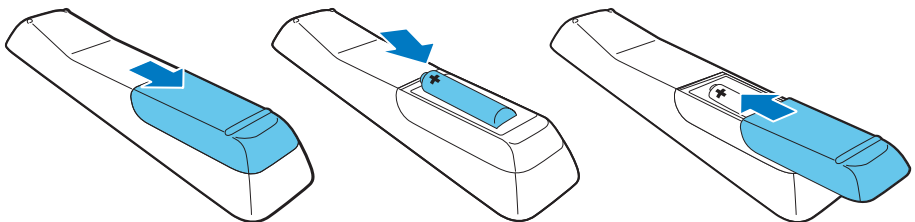

5

EN Complete the first time setup

ZH-CN 完成首次设置

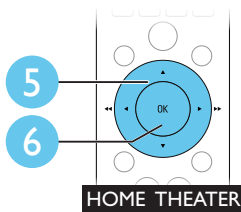
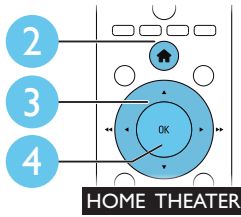
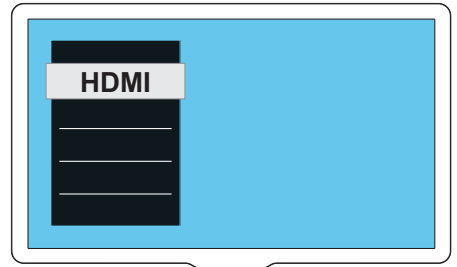
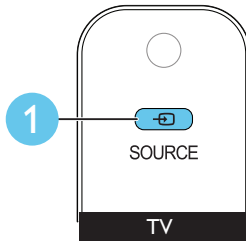

6

EN Use your home theater

ZH-CN 使用家庭影院

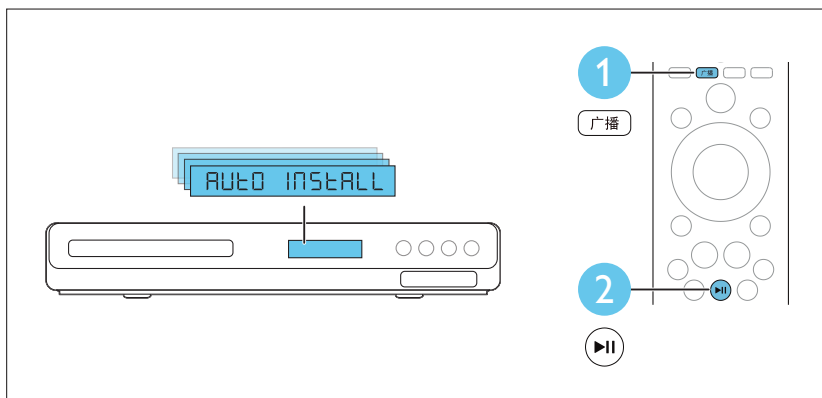
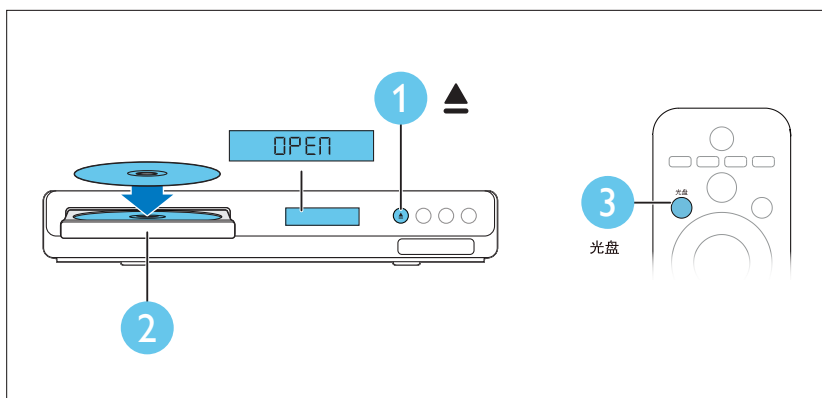

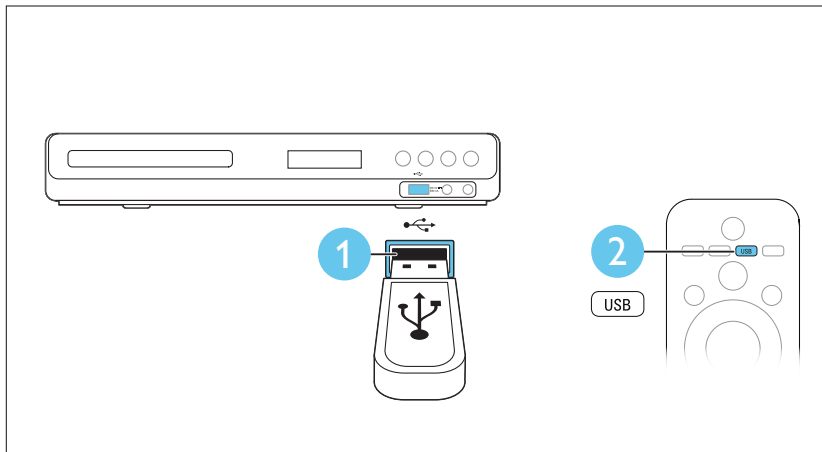
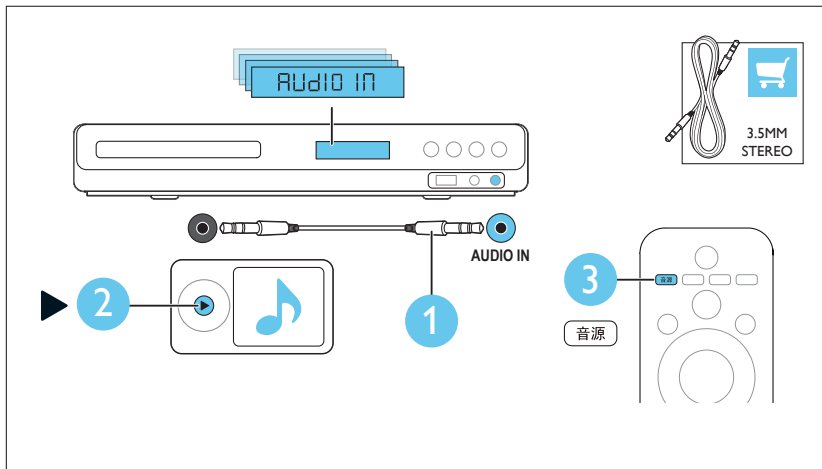



Specifications are subject to change without notice
© 2014 Koninklijke Philips N.V. All rights reserved.
Trademarks are the property of Koninklijke Philips N.V. or their respective owners.

HTD3510/3540/3570_93_QSG_V2.0

