

# Always there to help you

Register your product and get support at  
[www.philips.com/welcome](http://www.philips.com/welcome)



CED380



## User manual

# PHILIPS

# Contents

<b>1</b>	<b>Safety</b>	<b>2</b>
<b>2</b>	<b>Your car entertainment system</b>	<b>3</b>
	Introduction	3
	What's in the box	4
	Overview of the main unit	5
	Overview of the remote control	6
<b>3</b>	<b>Install the car entertainment system</b>	<b>8</b>
	Connect wires	8
	Mount into the dashboard	11
	Attach the front panel	12
<b>4</b>	<b>Get started</b>	<b>14</b>
	Prepare the remote control	14
	Turn on	14
	Use the home menu	14
	Adjust system settings	15
	Disable the video blocking system	15
	Adjust the screen brightness	15
<b>5</b>	<b>Listen to radio</b>	<b>16</b>
	Switch to radio mode	16
	Access the control interface	16
	Use the control interface	16
<b>6</b>	<b>Play from hard media</b>	<b>18</b>
	Load a disc	18
	Connect a USB storage device	18
	Insert an SD/SDHC card	19
	Control play	19
<b>7</b>	<b>Use Bluetooth devices</b>	<b>21</b>
	Pair a device	21
	Play audio from a connected device	22
	Make a call	23
<b>8</b>	<b>Adjust sound</b>	<b>25</b>
	Adjust the volume level	25
	Mute sound	25
	Select a preset sound equalizer	25
	Set the sub-woofer	25
	Enable the MAX Sound effect	25
	Enable the DBB sound effect	25
	Adjust the fader/balance/bass/treble level	25
<b>9</b>	<b>Others</b>	<b>27</b>
	Play external audio/video input	27
	Reset the system	27
	Calibrate the screen	27
	Replace the fuse	27
	Upgrade the firmware	28
<b>10</b>	<b>Product information</b>	<b>29</b>
<b>11</b>	<b>Troubleshooting</b>	<b>30</b>
	General	30
	About the Bluetooth device	30
<b>12</b>	<b>Notice</b>	<b>32</b>
	Compliance	32
	Care of the environment	32
	Trademark notice	32
	Copyright	33

# 1 Safety

Read and understand all instructions before you use the device. If damage is caused by failure to follow instructions, the warranty does not apply.

- Use of controls or adjustments or performance of procedures other than herein may result in hazardous radiation exposure or other unsafe operation.
  - The device is designed for negative ground (earth) 12V DC operation only.
  - To reduce the risk of traffic accidents, do not watch video when driving.
  - To ensure safe driving, adjust the volume to a safe and comfortable level.
  - Improper fuses can cause damage or fire. When you need to change the fuse, consult a professional.
  - Use only the supplied mounting hardware for a safe and secure installation.
  - To avoid short circuits, do not expose the device, remote control or remote control batteries to rain or water.
  - The device shall not be exposed to dripping or splashing.
  - Do not place any sources of danger on the device (e.g. liquid filled objects, lighted candles).
  - Never insert objects into the ventilation slots or other openings on the device.
  - Never place any objects other than discs into the disc tray/slot.
  - To avoid exposure to laser radiation, do not disassemble the device.
  - Risk of damage to the screen! Never push, rub, or strike the screen with any object.
  - Never use solvents such as benzene, thinner, cleaners available commercially, or anti-static sprays intended for discs.
  - Clean the device with soft, damp cloth. Never use substances such as alcohol, chemicals or household cleaners on the device.
- Risk of swallowing coin battery!
    - The product/remote control may contain a coin/button type battery, which can be swallowed. Keep the battery out of reach of children at all times! If swallowed, the battery can cause serious injury or death. Severe internal burns can occur within two hours of ingestion.
    - If you suspect that a battery has been swallowed or placed inside any part of the body, seek immediate medical attention.
    - When you change the batteries, always keep all new and used batteries out of reach of children. Ensure that the battery compartment is completely secure after you replace the battery.
    - If the battery compartment cannot be completely secured, discontinue use of the product. Keep out of reach of children and contact the manufacturer.

## 2 Your car entertainment system

Congratulations on your purchase, and welcome to Philips! To fully benefit from the support that Philips offers, register your product at [www.philips.com/welcome](http://www.philips.com/welcome).

---

### Introduction

With the car entertainment system, you can

- listen to music,
- watch videos,
- view pictures,
- listen to FM and AM/MW radio,
- make phone calls via Bluetooth, and
- navigate your road trip.

---

### Playable media

- Disc
  - DVD, Video CD, SVCD, Audio CD, JPEG Picture CD, MP3-CD, WMA-CD
  - DVD-R, DVD-RW, DVD+R, DVD+RW, CD-R, CD-RW
- USB storage device
  - Compatibility: USB 2.0, USB 1.1
  - Class support: MSC (Mass Storage Class)
  - Maximum capacity: 32 GB
- SD/SDHC card
  - Maximum capacity: 32 GB
- Files
  - File system: FAT16, FAT32
  - Maximum number of folders: 99
  - Maximum number of tracks/files: 999
  - Maximum level of directory: 8
  - Video formats: MPEG1, MPEG2
  - Picture format: jpeg

- .mp3 files  
Sampling frequencies: 32 kHz, 44.1 kHz, 48 kHz  
Bitrates: 8-320 kbps and variable bitrates
- .wma files  
Versions: V4, V7, V8, V9 (L1 and L2)  
Sampling frequencies: 44.1 kHz, 48 kHz  
Bitrates: 64-192 kbps and variable bitrates
- ID3 tag V2.0 or later
- **Unsupported files:**  
AAC, WAV, and PCM files  
DRM protected WMA files (.wav, .m4a, .m4p, .mp4, and .aac)  
WMA files in lossless format

# What's in the box

Check and identify the contents of the package:

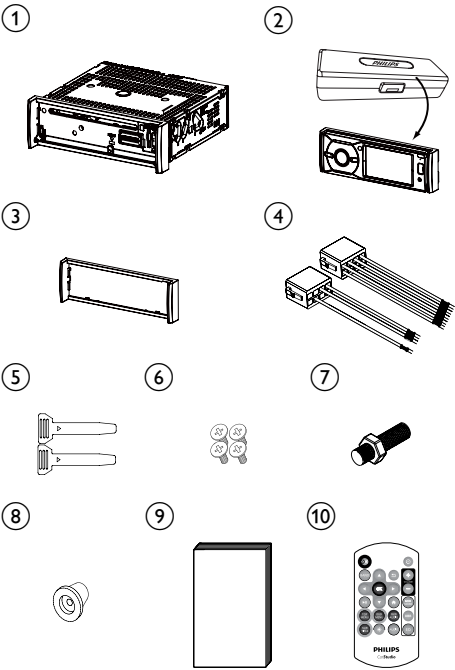

1	Main unit (with a sleeve)	2	Carrying case (with the front panel included)
3	Trim plate	4	ISO male connector X 2
5	Disassembly tool X 2	6	Screw X 4 (M5x8mm)
7	Hexagon head screw	8	Rubber cushion
9	User manual	10	Remote control

## Overview of the main unit

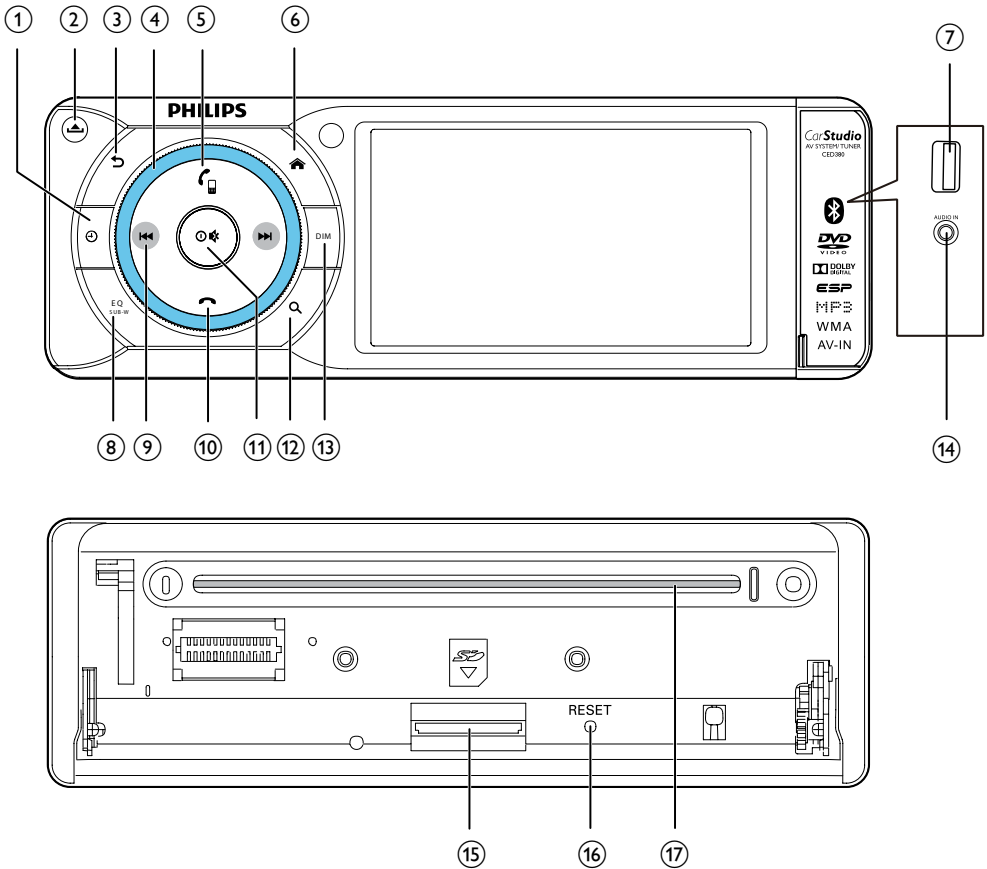

- |  |   |
|--|---|
| <p>① </p> <ul style="list-style-type: none"> <li>• View the time and date.</li> </ul> <p>② </p> <ul style="list-style-type: none"> <li>• Release the front panel.</li> </ul> <p>③ </p> <ul style="list-style-type: none"> <li>• Return to the previous menu or mode.</li> </ul> <p>④ <b>Volume ring</b></p> <ul style="list-style-type: none"> <li>• Rotate to increase or decrease the volume.</li> </ul> | <p>⑤ </p> <ul style="list-style-type: none"> <li>• Send a call.</li> <li>• Press to answer an incoming call.</li> <li>• Press twice to redial the last called number.</li> <li>• During a call, press and hold to mute the speakers and then take the mobile phone for conversation.</li> </ul> <p>⑥ </p> <ul style="list-style-type: none"> <li>• Return to the home menu.</li> </ul> <p>⑦ </p> <ul style="list-style-type: none"> <li>• Connect to a USB storage device.</li> </ul> |
|--|---|

## 8 EQ SUB-W

- Press and hold to enable or disable the audio output to the sub-woofer.
- Press to access the menu for selecting a preset sound equalizer.

## 9 I◀◀/▶▶I

- Tune to a radio station.
- Press to skip to the previous/next chapter; title, track, or file.
- Press and hold to rewind a chapter/ title/track or search forward fast.

## 10 📞

- Reject an incoming call.
- End an ongoing call.

## 11 🔊

- Press to power on the product.
- Press and hold to power off the product.
- Press to mute the speakers or release them from mute status.

## 12 🔍

- Access the list of recorded files and folders.

## 13 DIM

- Adjust the brightness of LCD screen.

## 14 AV IN

- Connect to an external audio and video player through a composite AV cable.

## 15 SD/SDHC card slot

- Insert an SD/SDHC card.

## 16 RESET

- Reset the product.

## 17 Disc slot

# Overview of the remote control

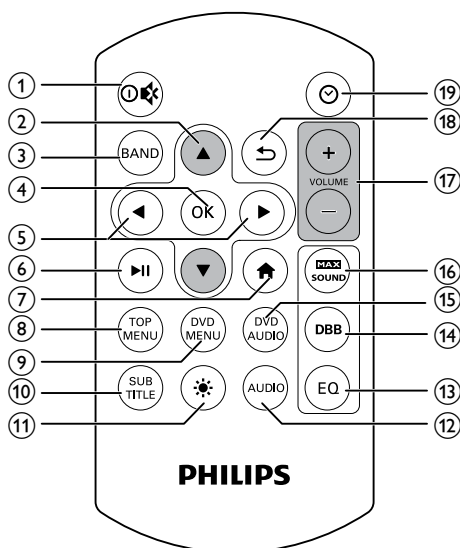

## 1 🔊

- Press to power on the product.
- Press and hold to power off the product.
- Press to mute the speakers or release them from mute status.

## 2 ▲/▼

- Tune to the previous or next preset radio station.
- Skip to the previous or next folder.

## 3 BAND







- Select a tuner band.

## 4 OK

- Confirm an option.

## 5 ◀/▶

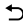
- Skip to the previous or next track, chapter, or file.
- For DVD, press and hold to select a speed for fast backward or forward search.

- ⑥ 
  - Start, pause, or resume play.
- ⑦ 
  - Return to the home menu.
- ⑧ **TOP MENU**
  - Return to the top menu of a DVD.
- ⑨ **DVD MENU**
  - Return to the DVD menu.
- ⑩ **SUBTITLE**
  - Select a subtitle language.
- ⑪ 
  - Adjust the brightness of LCD screen.
- ⑫ **AUDIO**
  - Access the menu for sound setting adjustment.
- ⑬ **EQ**
  - Select a preset sound equalizer.
- ⑭ **DBB**
  - Enable or disable the DBB (dynamic bass boost) sound effect.
- ⑮ **DVD AUDIO**
  - Select an audio language or audio channel.
- ⑯ 
  - Enable or disable the maximum sound.
- ⑰ **VOLUME + / -**
  - Press to increase or decrease the volume.
- ⑱ 
  - Return to the previous menu or mode.
- ⑲ 
  - Display the time and date.



# 3 Install the car entertainment system

Always follow the instructions in this chapter in sequence.  
These instructions are for a typical installation. However, if your car has different requirements, make the adjustment accordingly. If you have any question regarding installation kits, consult your local retailer:

 **Note**

- This system is designed for negative ground (earth) 12V DC operation only.
- Always install this system in the car dashboard. Other locations can be dangerous as the rear of the system heats up during use.
- To avoid short-circuit: before you connect, make sure that the ignition is off.
- Make sure that you connect the yellow and red power supply leads after all other leads are connected.
- Make sure that all loose leads are insulated with electrical tape.
- Make sure that the leads do not get caught under screws iron parts that will move (e.g. seat rail).
- Make sure that all ground (earth) leads are run to a common ground (earth) point.
- Use only the supplied mounting hardware for a safe and secure installation.
- Improper fuses can cause damage or fire. When you need to change the fuse, consult a professional.
- When you connect other devices to this system, make sure that the rating of the car circuit is higher than the total fuse value of all the connected devices.
- Never connect speaker wires to the metal body or chassis of the car.
- Never connect speaker wires with stripes to one another.

## Connect wires

 **Note**

- Consult a professional to connect wires as instructed below.
- Before connection, check the car's wiring carefully.

1 Connect the strips of ISO male connectors.

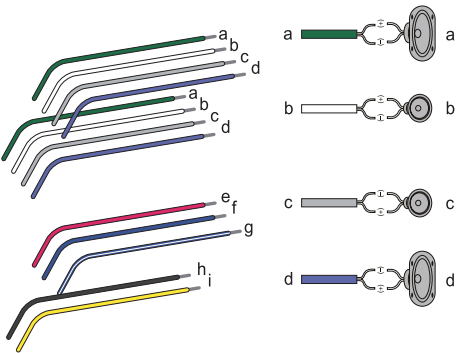

ISO male connectors		Connect to
a	Green strip, black-edged green strip	Rear left speaker
b	White strip, black-edged white strip	Front left speaker
c	Gray strip, black-edged gray strip	Front right speaker
d	Purple strip, black-edged purple strip	Rear right speaker
e	Red strip	Ignition key +12V DC when ON/ ACC
f	Blue strip	Motor/electric antenna relay control lead
g	White-edged blue strip	Amplifier relay control lead
h	Black strip	Ground
i	Yellow strip	The +12V car battery which is energized at all times

- 2 Connect the ISO male connectors and other wires to the rear panel of the main unit if necessary.

### ! Caution

- To avoid an accident, the driver must not watch video while driving. By design, this system disallows watching video during drive. Park your car in a safe place and engage the parking brake before watching video.

### ≡ Note

- When the parking brake of your vehicle is not engaged, the video blocking system is activated. It blocks the display of front video source only.
- If the system is not properly connected with the parking brake control module of your vehicle, video signals will be blocked by the system, with the below message displayed on the screen.

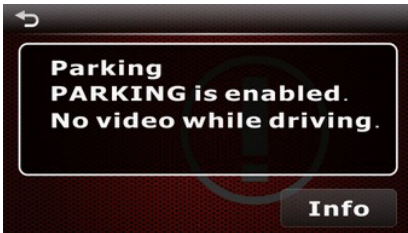

	Connectors and sockets on rear panel	External sockets or connectors
1	<b>SUB-W OUT</b> (Blue socket)	Input socket of a sub-woofer
2	<b>REAR LINE OUT L</b> (White socket)	Rear left speaker
3	<b>REAR LINE OUT R</b> (Red socket)	Rear right speaker
4	For ISO male connectors	As indicated in step 1
5	<b>FRONT LINE OUT L</b> (White connector)	Front left speaker
6	<b>FRONT LINE OUT R</b> (Red connector)	Front right speaker
7	Radio antenna connector	Radio antenna
8	<b>VIDEO IN</b> (Yellow connector)	Video output socket of an external player
9	<b>VIDEO OUT</b> (Yellow connector)	Video input socket of an external display device
10	<b>CAMERA IN</b> (Yellow connector)	Video output socket of an external camera
11	<b>AUDIO IN</b> (White connector)	Left audio channel output socket of an external player
12	<b>AUDIO IN</b> (Red connector)	Right audio channel output socket of an external player
13	Orange wire	Reverse camera (B+)
14	Pink wire	Parking brake (-)
15	Purple wire	OE SWC remote in

### \* Tip

- The pin arrangement for the ISO connectors depends on the type of your vehicle. To avoid damage to the system, connect properly.

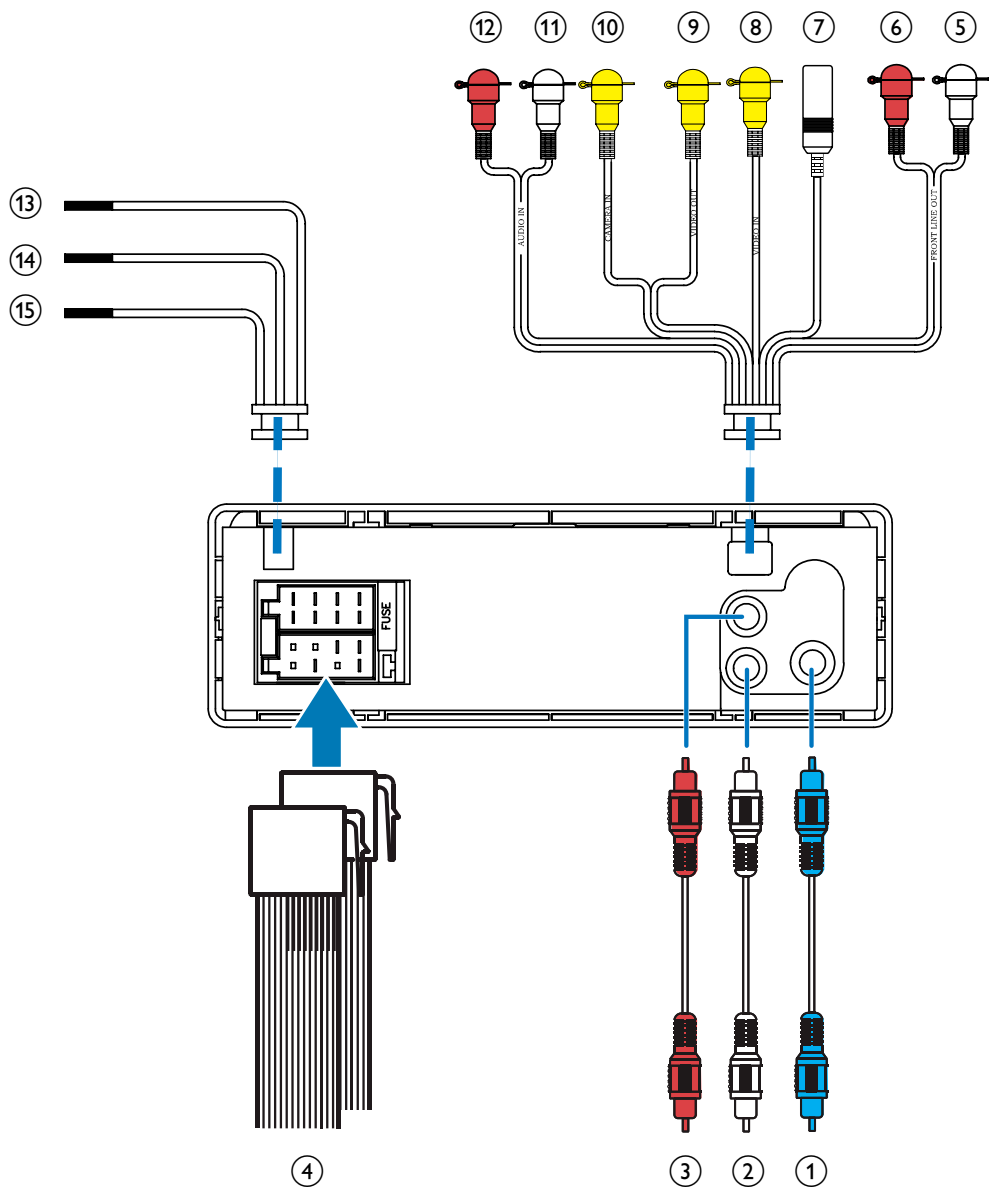

## Mount into the dashboard

### Note

- If your car has no an on-board drive or navigation computer; disconnect the negative terminal of the car battery.
- If your car has an on-board drive or navigation computer; the computer may lose its memory when you disconnect the car battery.
- If the car battery is not disconnected, to avoid short-circuit, make sure that bare wires do not touch each other.

- 1 Make sure that the car dashboard opening is within these measurements.

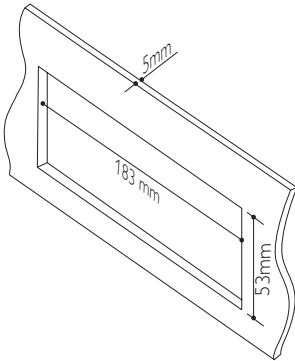

- 2 Remove the two transport screws on the top of the unit.

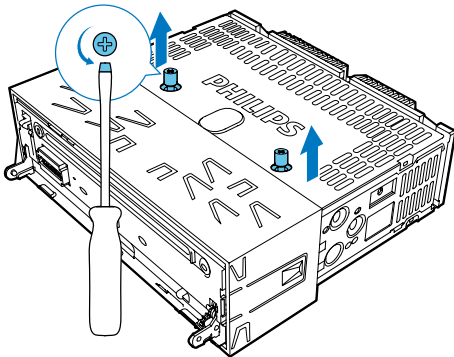

- 3 Remove the sleeve from the unit.

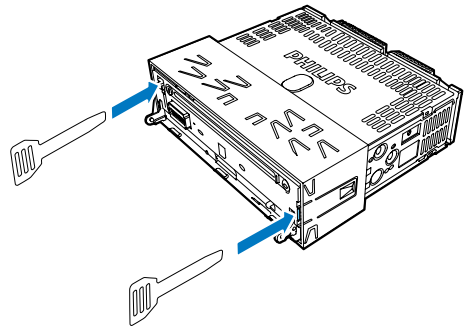

- 4 Install the sleeve into the dashboard and bend the tabs outward to fix the sleeve.

### Note

- If the system is not fixed by sleeve but by the supplied screws, skip this step.

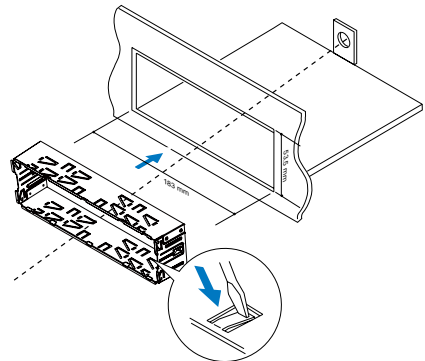

- 5 Place the supplied rubber cushion over the end of the mounting bolt.

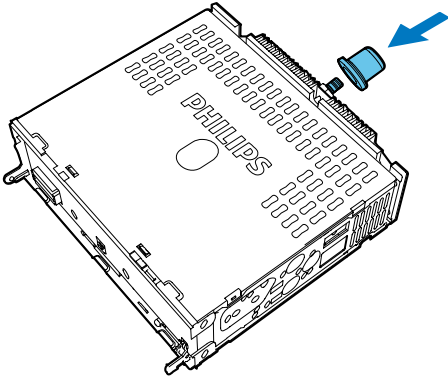

- 6 Slide the system into the dashboard until you hear a "click".

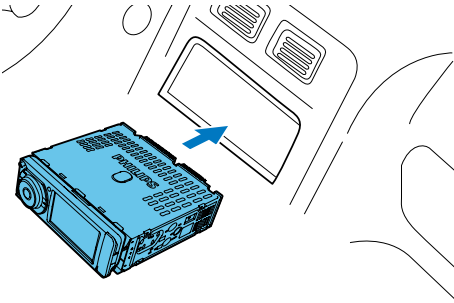

- 7 Attach the trim plate.

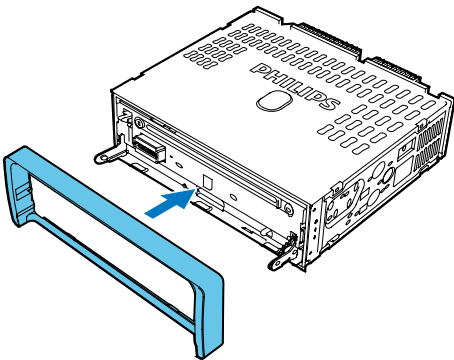

- 8 Reconnect the negative terminal of the car battery.

## Attach the front panel

- 1 Insert the chassis on the left side of the front panel to the left notch on the unit, and align the chassis on the right side with the right notch.

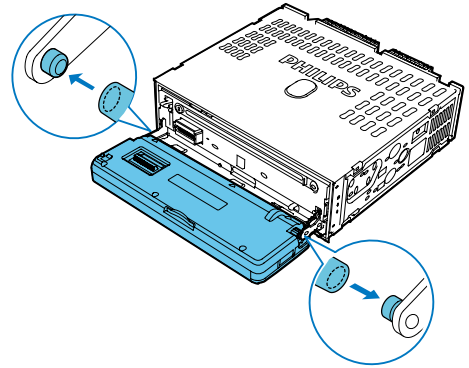

- 2 Push the front panel towards the unit until it is secured.
- 3 Flip the front panel upwards and then push it towards the unit until you hear a "click".
- ↳ The product starts boot-up automatically.

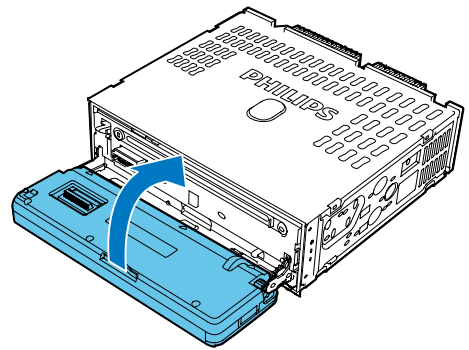

---

## Detach the front panel



### Note

- Before you insert an SD/SDHC card or reset the system, detach the front panel.
- Before you detach the front panel, make sure that the product is turned off.

- 1 Press  to release the front panel.
- 2 Push the right end of the front panel left to disengage it from the right notch on the unit, and then pull it outwards to remove it.

## 4 Get started

### ! Caution

- Risk of car accidents! Never watch video or operate this system while driving.

## Prepare the remote control

### For the first time use

Pull the protective sheet out.

↳ The remote control is ready for use.

## Replace the battery

### ! Caution

- Risk of explosion! Keep batteries away from heat, sunshine or fire. Never discard batteries in fire.

### ≡ Note

- Remove the battery if it is exhausted or if the remote control is not to be used for a long time.
- Batteries contain chemical substances, they should be disposed of properly.
- Perchlorate Material - special handling may apply. See [www.dtsc.ca.gov/hazardouswaste/perchlorate](http://www.dtsc.ca.gov/hazardouswaste/perchlorate).

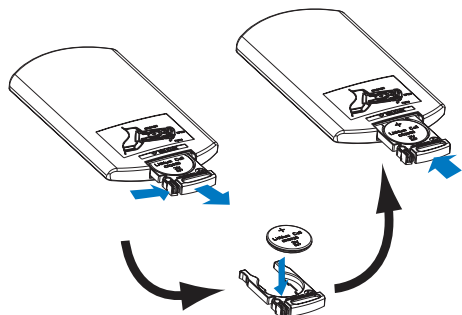

- 1 Pull out the battery tray.
- 2 Insert one CR2025 battery with correct polarity (+/-) as indicated.
- 3 Insert the battery tray.

## Turn on









Press .

- ↳ PHILIPS logo and a progress bar are displayed while boot-up.
- To turn off the system, press and hold  for 3 seconds.

## Use the home menu

- 1 Press  on the front panel to access the home menu.



- 2 Tap an icon to access its interface.
  -  **[RADIO]**: Switch the source to FM/ MW radio.
  -  **[DISC]**: Switch the source to disc.
  -  **[USB]**: Switch the source to USB storage device.
  -  **[SDHC]**: Switch the source to SD/ SDHC card.
  -  **[BT AUDIO]**: Use the Bluetooth feature.
  -  **[AV-IN 1]/[AV-IN 2]**: Switch the source to the audio and video input that is transferred from an external audio/video player.
  -  **[SETTINGS]**: Access the **[SETTINGS]** menu.
  - To return to the home menu, press  on the front panel.

## Adjust system settings

- 1 Tap  on the home menu to access the [SETTINGS] menu.

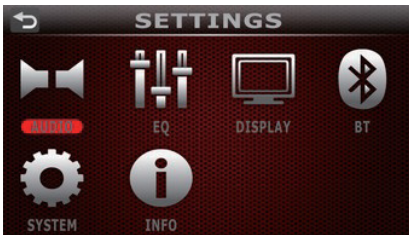

- 2 Tap  to access the [SYSTEM] menu.

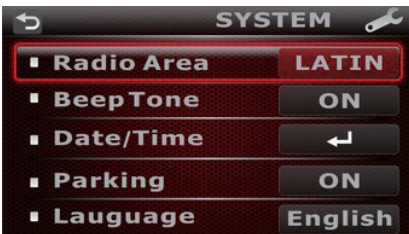

- 3 Tap an item to adjust its setting.

### Select a radio region

You can select a radio region that matches your location.

Tap [Radio Area] repeatedly to select a setting.

- [LATIN] (Latin America)
- [USA] (United States)
- [EURO] (Western Europe)
- [OIRT] (OIRT)

### Mute the button beep

The beep sound of buttons and icons is enabled by default.

Tap [Beep Tone] to change the setting.

- [ON]: Enable the beep sound of buttons.
- [OFF]: Mute the beep sound of buttons.

## Set the date and time

- 1 Tap [Date/Time].



- 2 Tap the field under [YEAR], [MONTH], [DAY], [HOUR], [MINUTE], or [AM/PM] to select a variety.
- 3 Tap + / - to set its value.

## Select an OSD language

Tap [Language] repeatedly to select a language for on-screen display.

## Disable the video blocking system

### Note

- Risk of car accidents! Do not watch video or photo slideshow, nor operate this system while driving.

When the parking brake of your vehicle is not engaged, the video blocking system is activated. It blocks video and photo display on the screen of the main unit. To display image, disable the video blocking system.

- 1 Tap [Parking] to select [OFF].  
↳ The video blocking system is disabled.
- 2 To enable the video blocking system, tap [Parking] to select [ON].

## Adjust the screen brightness

Press DIM repeatedly on the front panel.



## 5 Listen to radio

### Switch to radio mode

After boot-up, the system switches to radio mode automatically.



To switch the source back to radio afterwards, tap [RADIO] on the home menu.

### Access the control interface

Tap the screen to display the control interface.

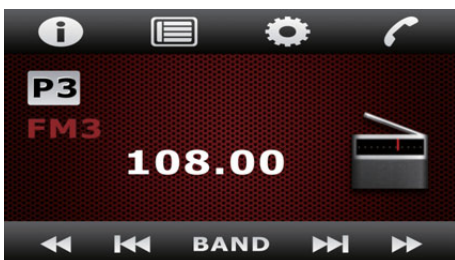

### Use the control interface

- : Tap to display available information.
- : Tap to display the list of stored radio stations.



- To select a stored radio station, tap its sequence number.
- : Tap to display the radio menu.
- : To tune to a radio station manually, tap it repeatedly or tap and hold it until the frequency of target station is displayed.
- : To search for the previous or next strong station automatically, tap it.
- **BAND**: Tap repeatedly to select a radio band.

### Use the radio menu

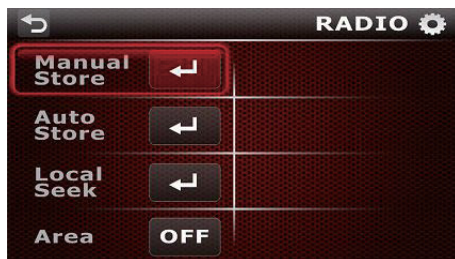

- **[Manual Store]**  
To store a radio station manually,
  - 1) Tune to the radio station that you want to store.
  - 2) Access the radio menu, and then tap **[Manual Store]** to display the list of stored radio stations.
  - 3) Tap a sequence number to store the radio station.

- **[Auto Store]:** Tap it to start the automatic storage of available radio stations.
- **[Local Seek]:** Tap it to change the setting.
  - **[ON]:** Search for radio stations with strong signals only.
  - **[OFF]:** Search for radio stations with either strong signals or weak signals.
- **[Area]:** Tap it to switch to another radio region.
  - **[LATIN]** (Latin America)
  - **[USA]** (United States)
  - **[EURO]** (Western Europe)
  - **[OIRT]** (OIRT)

## 6 Play from hard media

You can use this system to listen to audio, watch videos, and view photos that are stored on a disc, USB storage device, or SD/SDHC card.

### Note

- Before use, check for compatible media.

### Load a disc

### Caution

- Never insert any object other than a disc of 12-cm diameter into the disc slot.

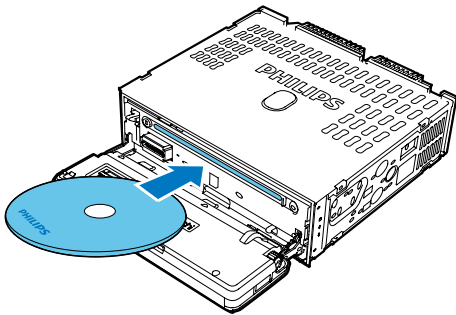

- 1 Press to release the front panel.
- 2 Insert the disc into the disc slot with the label side facing up.
- 3 Flip the front panel upwards, and then push it towards the unit until you hear a "click".
  - ↳ After boot-up, play starts automatically.
  - If play does not start automatically, tap the screen to display the playback interface, and then tap to start play.
  - To remove the disc, press to release the front panel, and then press .

### Tip

- If the disc is blocked, press and hold until it is ejected.

### Region Code

You can play DVD discs marked with the following region code.

DVD region code	Countries
	Latin America

### Connect a USB storage device

### Note

- Make sure that the USB storage device contains compatible files.
- NTFS (New Technology File System) file system is not supported.

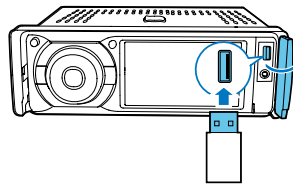

- 1 Flip up the protective cover to open it.
- 2 Connect the USB storage device to the USB socket.
  - ↳ Play starts automatically.
  - ↳ If play does not start automatically, tap the screen to display the playback interface, and then tap to start play.

### Note

- Before pulling out the USB storage device, switch the product to another source first.

## Insert an SD/SDHC card

### Note

- Make sure that the SD/SDHC card contains compatible files.
- NTFS (New Technology File System) file system is not supported.

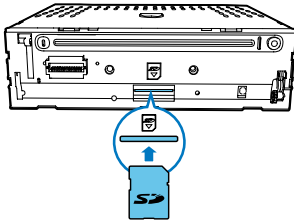

- 1 Detach the front panel.
- 2 Insert the SD/SDHC card into the card slot until you hear a "click".
- 3 Attach the front panel.
  - ↳ After boot-up, play starts automatically.
  - ↳ If play does not start automatically, tap the screen to display the playback interface, and then tap ► to start play.

## Remove the SD/SDHC card

- 1 Detach the front panel.
- 2 Press the card inwards until you hear a "click".
  - ↳ The card is disengaged.
- 3 Pull out the SD/SDHC card.

## Control play

During play, tap the screen to display the play interface, and then tap the icons on the interface to control play or change settings.



- ► / || : Start, pause, or resume play.
- ◀◀ / ▶▶ : Tap repeatedly to select a speed for rewind or fast forward search.
- ◀◀◀ / ▶▶▶ : Skip to the previous or next title, chapter, track, or file.
- ⓘ : Display the information about the current media.
- 📁 : Access the list of folder, files, or tracks.
- ⚙️ : For a video DVD, tap to access the quick menu.

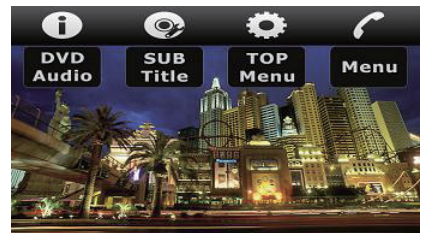

- [DVD Audio]: Tap repeatedly to select an audio language.
- [Subtitle]: Tap repeatedly to select a subtitle language.
- [Top Menu]: Return to the top menu.
- [Menu]: Return to the DVD menu.
- ⚙️ : During playing audio, tap ⚙️ to access the interface for selecting a play mode.



**[Repeat]:** Tap repeatedly to select a repeat mode.

**[Random]:** Tap repeatedly to switch between **[ON]** (play randomly) and **[OFF]** (play in sequence).

- During playing video or displaying photos, tap  to access the interface for image settings.



**[Repeat]:** Tap repeatedly to select a repeat mode.

**[Disc Audio]:** Tap repeatedly to select an audio language or audio channel.

**[Video Setting]:** Adjust the value of brightness, contrast, or color.

- 1) Tap to access the **Video Setting** menu.
- 2) On the menu, tap the field under **[BRIGHT]**, **[CONTRAST]**, or **[COLOR]**.
- 3) Tap **+** / **-** to set its value. To restore the settings, tap **[RESET]**.

**[Aspect Ratio]:** Tap repeatedly to select a color system.

**[TV Signal]:** Tap repeatedly to select a color system: **[NTSC]**, **[PAL]**, or **[AUTO]**.

**[Slideshow]:** Tap repeatedly to start or stop the photo slideshow: **[ON]** (display photos as a slideshow) or **[OFF]** (display the current photo as the screen background).

**[Goto]:** Skip to a title, chapter, track, or time point.

- 1) Tap **[Goto]** to display the interface.

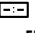

2) Tap  repeatedly to switch between **[Enter Title Number]**, **[Enter Chapter Number]**, **[Enter Track Number]**, and **[Enter Time]**.

3) Tap numeric icons to enter the digits. To clear the last entry, tap **X**. To clear all entry, tap **C**.





4) Tap  to confirm.

## Browse recorded files

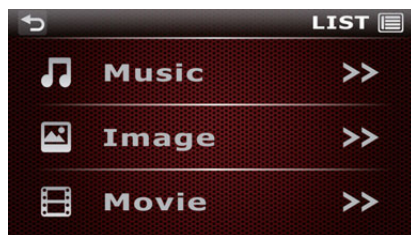
During play, you can access the file list and select files from the list.

- 1 Press **Q** to access the list of files or folders.



- 2 Tap an icon to select a file category.
  -  **[Music]**: Display the list of audio tracks or folders.
  -  **[Image]**: Display the list of picture files or folders.
  -  **[Movie]**: Display the list of video files or folders.
- 3 Tap the name of a folder to display the list of files under it.
  - To view the previous or next page, tap  / .
- 4 Tap a file to start play.

# 7 Use Bluetooth devices

With this system, you can listen to audio from a player and make a call through Bluetooth.

## Pair a device

### Note

- Philips does not guarantee the compatibility with all Bluetooth devices.
- Before pairing a device with this system, read its user manual for Bluetooth compatibility.
- Make sure that Bluetooth function is enabled on your device, and your device is set as visible to all other Bluetooth devices.
- The operational range between this system and a Bluetooth device is approximately 8 meters (24 feet).
- Any obstacle between this system and a Bluetooth device can reduce the operational range.
- Keep away from any other electronic device that may cause interference.

## Access the Bluetooth menu

- 1 Tap  on the home menu to access the [SETTINGS] menu.

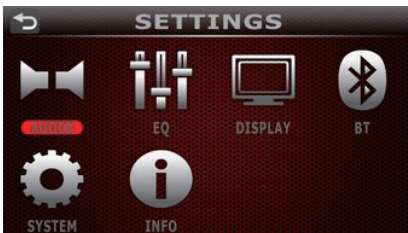

- 2 Tap  on the [SETTINGS] menu to access the [BLUETOOTH] menu.



## Connect a device

- 1 Access the [BLUETOOTH] menu.

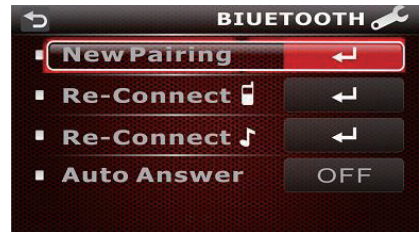

- 2 Tap [New Pairing].  
↳ The product starts searching for other Bluetooth devices.

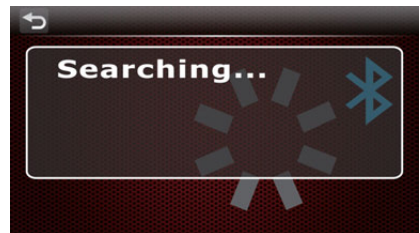



- 3 In the device list, tap the name of your Bluetooth device.
  - To view the previous or next page, tap **▲ / ▼**.



➞ The pairing starts, and then a pairing request from CED380 is displayed on your device.

- 4 On your device, accept the pairing request from CED380, enter the default password '0000', and then confirm the password entry.

➞ **[Paired OK!]** is displayed on this product.

- 5 On your device, enable or permit the connection with CED380.

## Manage paired devices

- 1 Access the **[BLUETOOTH]** menu.



- 2 Tap **[Re-Connect 📞]** to display the list of paired mobile phones. Tap **[Re-Connect 🎵]** to display the list of paired audio players.
  - To disconnect a device, tap its name and then tap **—/—** (in red).
  - To re-connect a device, tap its name and then tap **—/—** (in green).

- To remove a device from the list, tap its name, tap **X**, and then tap **[Yes]** on the prompt interface.

## Play audio from a connected device

If the connected Bluetooth device supports Advanced Audio Distribution Profile (A2DP), you can listen to tracks that are stored on the device through the system. If the device also supports AudioVideo Remote Control Profile (AVRCP) profile, you can control play on the system or with its remote control.

- 1 Play a track on the connected device.
- 2 On this product, tap **Ⓢ** on the home menu to display the music playback interface.
- 3 Tap the screen to display the control interface.

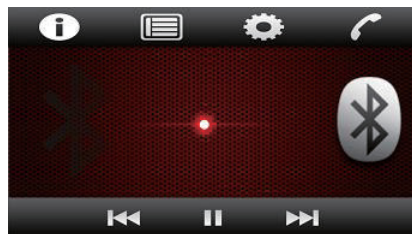

- 4 Tap icons on the interface to control play.
  - **▶||**: Pause or resume play.
  - **◀◀ / ▶▶**: Play the previous or next track.

### Note

- If the connected device does not support the AVRCP profile, control play on the connected device.

## Make a call

### Note

- Keep the Bluetooth connection active between the system and your mobile phone.
- By default, the conversation voice comes from the loudspeakers during a call.

## Call a number

You can make phone calls with the product.

- 1 Tap the screen to display the control interface.

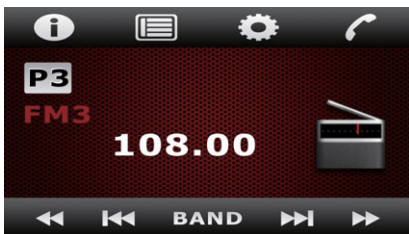

- 2 Tap .  
↳ The keypad is displayed.



- 3 Tap number icons to enter the phone number:
  - To redial the last called number, tap .

- 4 Tap to send the call.

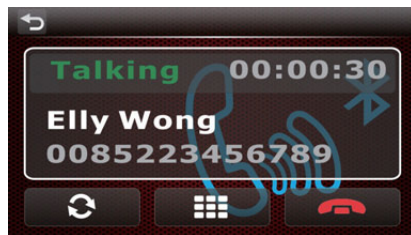

- To end the call, tap .
- To enter numbers during the call, tap to display the keypad first.
- To mute the loudspeakers and use your mobile phone for the conversation, tap .

## Answer a call

### Note

- By default, all incoming calls are picked up automatically. You can disable the function of automatic answer: (see 'Disable the automatic answer' on page 24)

- 1 When there is an incoming call, [Incoming Call?] is displayed on the screen.



- 2 Tap to answer the call.
  - To reject or end the call, tap .



---

## Disable the automatic answer

- 1 Access the **[BLUETOOTH]** menu.

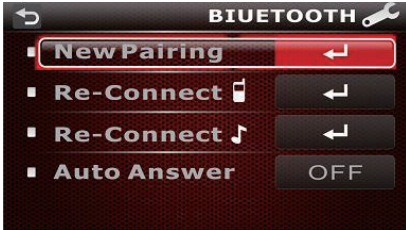

- 2 Tap **[Auto Answer]** to enable or disable the automatic answer of incoming calls.
  - **[ON]**: Enable the automatic answer.
  - **[OFF]**: Disable the automatic answer.

## 8 Adjust sound

When you listen to radio, enjoy music, or watch video, follow the instructions below to adjust sound.

### Adjust the volume level

Rotate the volume ring on the left of the front panel.

### Mute sound

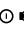
Press  on the front panel.

- To release the speakers from mute status, press  again.

### Select a preset sound equalizer

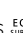
- 1 Press  on the front panel.  
↳ The list of preset sound equalizers is displayed.
- 2 Tap the name of a sound equalizer to select it.

### Set the sub-woofer

Press and hold  to enable or disable the audio output to the sub-woofer.

### Enable the MAX Sound effect



Tap **MAX** on the playback interface.

- **MAX** (highlighted): The **MAX Sound** effect is enabled.
- **MAX** (in gray): The **MAX Sound** effect is disabled.

### Enable the DBB sound effect

When DBB (Dynamic Bass Boost) is enabled, low tones are enhanced electronically.

Tap  on the playback interface.

-  (highlighted): DBB sound effect is enabled.
-  (in gray): DBB sound effect is disabled.

### Adjust the fader/balance/bass/treble level

To adjust the level of fader, balance, bass, or treble, do as follows.

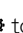
- 1 On the home menu, tap  to access the [SETTINGS] menu.

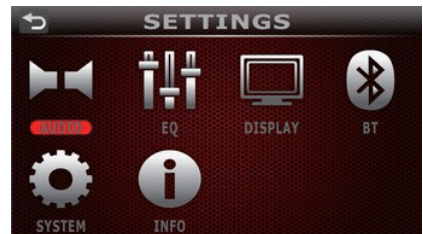

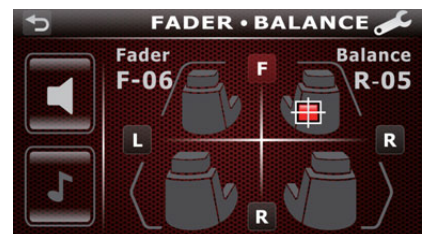

- 2 On the [SETTINGS] menu, tap .  
↳ The [FADER • BALANCE] interface is displayed.



- 3 Tap **F**, **R**, **L**, and **R** to adjust the levels of fader and balance.

- 4 Tap  to display the **[BASS • TREBLE]** interface.



- 5 Tap   to adjust the levels of bass and treble.
- To switch back to the **[FADER • BALANCE]** interface, tap .

## 9 Others

### Play external audio/video input

You can connect an external audio/video player to this system.

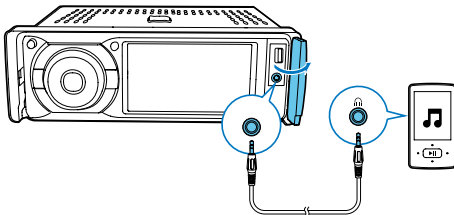

- 1 Flip up the protective cover.
- 2 Connect a composite AV cable to
  - the audio and video input socket on the front panel, and
  - the audio and video output sockets of the external player.
- 3 On the home menu, tap [AV-IN 1] to display the playback interface.
- 4 Operate on the external player to start play (see the user manual of the external device).

#### Tip

- If you connect this system to an external player through the **VIDEO IN** and **AUDIO IN** sockets on the rear panel, tap [AV-IN 2] to switch the source instead of [AV-IN 1].

### Reset the system

If the system hangs up, reset it.

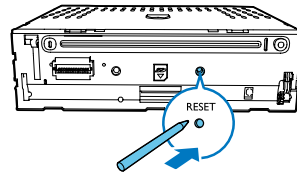

- 1 Detach the front panel.
- 2 Press **RESET** with the tip of a ball-point pen or toothpick.

### Calibrate the screen

- 1 Tap on the home menu to access the [SETTINGS] menu.
- 2 Tap .
- 3 Tap [Calibration].
- 4 Follow the on-screen instructions to complete the calibration.

### Replace the fuse

If there is no power, check the fuse and replace it if it is damaged.

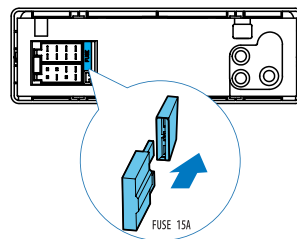

- 1 Detach the main unit from dashboard.
- 2 Check the electric connection.
- 3 Remove the damaged fuse from the rear panel.
- 4 Insert a new fuse with the same specifications (15 A).



#### Tip

- If the fuse gets damaged immediately after it is replaced, an internal malfunction may occur. In this case, consult your Philips retailer.

## Upgrade the firmware



#### Note

- Power supply must not be interrupted during the upgrade.
- When the firmware upgrade succeeds, all settings are restored to the factory default status.

### Register your product

- 1 Go to [www.philips.com/welcome](http://www.philips.com/welcome).
- 2 Click the link of **"Register my product"** (the exact wording of this link name may vary in different languages).
- 3 Log in with your account on the prompt Web page.
  - If you have no account for Club Philips, create one first on this Web page.
- 4 Search your product with **"CED380/55"** as the keyword.
- 5 Click the link of search result to access the Web page for registering your product.
- 6 Fill in necessary information about this product to complete the registration.
  - ➔ With the registration, you can get information about software update and product support at this Web page or via your mailbox that is registered as the account for Club Philips.

### Check the firmware version

- 1 On the home menu, tap  to access the [SETTINGS] menu.

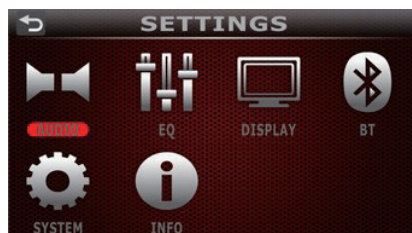

- 2 Tap .
  - ➔ The current firmware version is displayed.

### Perform the upgrade

- 1 Check the current firmware version of this product. (see 'Check the firmware version' on page 28)
- 2 Go to [www.philips.com/support](http://www.philips.com/support).
- 3 Log in with your account for Club Philips.
  - ➔ Support information about your registered product is displayed.
- 4 Click the link of **"Firmware Upgrade Readme File"** (the exact wording of this link name may vary in different languages).
- 5 Read and understand the instructions on firmware upgrade.
- 6 Follow the instructions to download the upgrade packet and complete the upgrade.
  - If the upgrade fails, reboot this system, and then perform the upgrade again.

# 10 Product information

## Note

- Product information is subject to change without prior notice.

## General

Power supply	12 V DC (11 V - 16 V), negative ground
Fuse	15 A
Suitable speaker impedance	4 - 8 $\Omega$
Maximum power output	50 W x 4 channels
Continuous power output	21 W x 4 channels (4 $\Omega$ 10% T.H.D.)
Pre-Amp output voltage	2.0 V (CD play mode; 1 kHz, 0 dB, 10 k $\Omega$ load)
Sub-woofer output voltage	2.0 V (CD play mode, 61 Hz, 0 dB, 10 k $\Omega$ load)
Aux-in level	$\geq$ 500 mV
Dimensions (W x H x D)	178 x 50 x 160 mm
Weight (main unit)	2.5 kg

## Disc player

System	DVD / CD audio / MP3 system
Frequency response	20 Hz - 20 kHz
Signal/noise ratio	>75 dB
Total harmonic distortion	Less than 1%
Channel separation	> 55 dB
Video signal format	NTSC/PAL
Video output	1 +/- 0.2V

## Tuner

Frequency range (FM)	87.5 - 108.0 MHz
Frequency range (AM/MW)	522 - 1620 kHz (9 kHz), 530 - 1710 kHz (10 kHz)
Usable sensitivity (FM)	5 $\mu$ V
Usable sensitivity (AM/MW)	50 $\mu$ V

## LCD screen

Screen size	3.5 inches (16:9)
Display resolution	320 x 240 dots
Contrast ratio	300
Brightness	350 cd/m <sup>2</sup>

## Bluetooth

Communication system	Bluetooth Standard version 2.0
Output	Bluetooth Standard Power Class 2
Maximum communication range	Line of sight approx. 8m
Frequency band	2.4 GHz band (2.4000 GHz - 2.4835 GHz)
Compatible Bluetooth profiles	Hands-Free Profile (HFP) Handset Profile (HSP) Advanced Audio Distribution Profile (A2DP) Audio Video Remote Control Profile (AVRCP)
Supported codecs	SBC (Sub Band Codec)
Receive	SBC (Sub Band Codec)
Transmit	

# 11 Troubleshooting



## Warning

- Never remove the casing of this product.

To keep the warranty valid, never try to repair the product yourself.

If you encounter problems when using this product, check the following points before requesting service. If the problem remains unsolved, go to the Philips Web page ([www.philips.com/support](http://www.philips.com/support)). When you contact Philips, make sure that the product is nearby and the model number and serial number are available.

---

## General

### No power

- Car engine has not been started. Start the car engine.
- Connections are incorrect.
- The fuse has been damaged. Replace the fuse.

### No sound

- Volume is too low. Adjust the volume.
- Speaker connections are incorrect.

### No response to the remote control

- Make sure that the path between the remote control and the unit is clear from obstacles.
- Move the remote control close to the unit, and point it at the iR sensor.
- The function is not applicable to the current media.
- Replace the remote control battery.

### The disc does not play.

- The disc is upside down. Make sure that the printed side is upwards.
- The disc is dirty. Clean the disc with a clean, soft, lint-free cloth. Wipe the disc outwards from the center.

- The disc is defective. Try another disc.
- The disc is incompatible. Try another disc.
- The recordable disc is not finalized.
- The region code of DVD disc is not supported. Use a disc with proper region code.

### No image

- Parking wire connection is incorrect. Check the wiring.

### Image flashes or is distorted.

- Video connection is improper. Check the connections.

### Noise in broadcasts

- Signals are too weak. Select another station with stronger signals.
- Check the connection of the car antenna.

### Preset stations are lost.

- Battery cable is not correctly connected. Connect the battery cable to the terminal that is always live.

### The fuse is broken.

- The fuse type is incorrect. Replace it with a 15 A fuse.
- Speaker wire or power wire is grounded. Check the connections.

---

## About the Bluetooth device

### Music playback is unavailable on the system even after successful Bluetooth connection.

- The device cannot be used with the system to play music.

### The audio quality is poor after connection with a Bluetooth-enabled device.

- The Bluetooth reception is poor. Move the device closer to the system or remove any obstacle between the device and the system.

**Cannot connect with the system.**

- The device does not support the profiles required for the system.
- The Bluetooth function of the device is not enabled. Refer to the user manual of the device to find out how to enable the function.
- The system is not in the pairing mode.
- The system is already connected with another Bluetooth-enabled device. Disconnect that device or all other connected devices and then try again.

**The paired mobile phone connects and disconnects constantly.**

- The Bluetooth reception is poor. Move the mobile phone closer to the system or remove any obstacle between the mobile phone and the system.
- Some mobile phones may connect and disconnect constantly when you make or end calls. This does not indicate any malfunction of the system.
- For some mobile phones, the Bluetooth connection may be deactivated automatically as a power-saving feature. This does not indicate any malfunction of the system.



# 12 Notice

Any changes or modifications made to this device that are not expressly approved by Philips Consumer Lifestyle may void the user's authority to operate the equipment.

---

## Compliance

This apparatus includes this label:

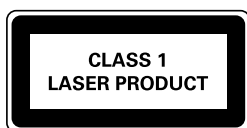

---

## Care of the environment



Your product is designed and manufactured with high quality materials and components, which can be recycled and reused. Never dispose of your product with other household waste. Please inform yourself about the local rules on the separate collection of electrical and electronic products and batteries. The correct disposal of these products helps prevent potentially negative consequences on the environment and human health. Your product contains batteries, which cannot be disposed of with normal household waste. Please inform yourself about the local rules on separate collection of batteries. The correct disposal of batteries helps prevent potentially negative consequences on the environment and human health.

Please visit [www.recycle.philips.com](http://www.recycle.philips.com) for additional information on a recycling center in your area.

### Environmental information

All unnecessary packaging has been omitted. We have tried to make the packaging easy to separate into three materials: cardboard (box), polystyrene foam (buffer) and polyethylene (bags, protective foam sheet.)

Your system consists of materials which can be recycled and reused if disassembled by a specialized company. Please observe the local regulations regarding the disposal of packaging materials, exhausted batteries and old equipment.

---

## Trademark notice



'DVD Video' is a trademark of DVD Format/Logo Licensing Corporation.



Manufactured under license from Dolby Laboratories. Dolby and the double-D symbol are trademarks of Dolby Laboratories.



Windows Media and the Windows logo are trademarks, or registered trademarks of Microsoft Corporation in the United States and/or other countries.

The Bluetooth® word mark and logos are registered trademarks owned by Bluetooth SIG, Inc. and any use of such marks by Philips is under license.

Other trademarks and trade names are those of their respective owners.

---

## Copyright



**Be responsible**  
**Respect copyrights**

This item incorporates copy protection technology that is protected by U.S. patents and other intellectual property rights of Rovi Corporation. Reverse engineering and disassembly are prohibited.

2013 © Koninklijke Philips Electronics N.V.  
Specifications are subject to change without notice. Trademarks are the property of Koninklijke Philips Electronics N.V or their respective owners. Philips reserves the right to change products at any time without being obliged to adjust earlier supplies accordingly.



Specifications are subject to change without notice  
© 2013 Koninklijke Philips Electronics N.V.  
All rights reserved.

CED380\_55\_UM\_V2.0

