

DVD VIDEO PLAYER

DVP3180K

Thank you for choosing Philips.

Need help fast?

Read your User's Manual first for quick tips that make using your Philips product more enjoyable.

If you have read your instructions and still need assistance, you may access our online help at www.philips.com/support



PHILIPS

General Information

Environmental Information

All unnecessary packaging has been omitted. The packaging has been made easy to separate into two materials; cardboard (box) and polyethylene (bags, protective foam sheet).

Your DVD player consists of materials which can be recycled and reused if disassembled by a specialised company. Please observe the local regulations regarding the disposal of packaging materials, exhausted batteries and old equipment.

Laser Safety

This unit employs a laser. Due to possible eye injury, only a qualified service person should remove the cover or attempt to service this device.

NOTE:

Pictures shown maybe different between countries.

CAUTION:

WARNING LOCATION: ON THE BACKPLATE OF THE SET

NEVER MAKE OR CHANGE CONNECTIONS WITH THE POWER SWITCHED ON.

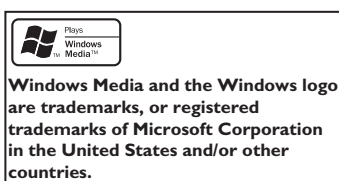
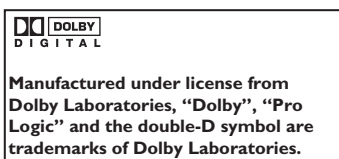

The apparatus shall not be exposed to dripping or splashing and that no objects filled with liquids, such as vases, shall be placed on apparatus.

Due to the inconsistency of disc formats provided by various disc manufacturers, your DVD system may require a playability enhancement or upgrade. As DVD technology advances, these enhancements will become common and will be easy to complete.
Go to www.philips.com/support for software upgrade.

"DTS", and "DTS Digital Out" are trademarks of Digital Theater Systems, Inc.

This product incorporates copyright protection technology that is protected by method claims of certain U.S. patents and other intellectual property rights owned by Macrovision Corporation and other rights owners. Use of this copyright protection technology must be authorized by Macrovision Corporation, and is intended for home and other limited viewing uses only unless otherwise authorized by Macrovision Corporation. Reverse engineering or disassembly is prohibited.

CONSUMERS SHOULD NOTE THAT NOT ALL HIGH DEFINITION TELEVISION SETS ARE FULLY COMPATIBLE WITH THIS PRODUCT AND MAY CAUSE ARTIFACTS TO BE DISPLAYED IN THE PICTURE. IN CASE OF 525 OR 625 PROGRESSIVE SCAN PICTURE PROBLEMS, IT IS RECOMMENDED THAT THE USER SWITCH THE CONNECTION TO THE 'STANDARD DEFINITION' OUTPUT. IF THERE ARE QUESTIONS REGARDING TV SET COMPATIBILITY WITH THIS MODEL 525p AND 625p DVD PLAYER, PLEASE CONTACT OUR CUSTOMER SERVICE CENTER.

Index

English 6

中文(简体) 34

English

中文(简体)

Specifications are subject to change without notice. Trademarks are the property of Koninklijke Philips Electronics N.V. or their respective owners.

For Customer Use:
Read carefully the information located at the bottom or rear of your DVD Video player and enter below the Serial No. Retain this information for future reference.

Model No. DVP3180K
Serial No. _____

LASER

Type	Semiconductor laser InGaAlP (DVD) AlGaAs (CD)
Wave length	650 nm (DVD) 790 nm (CD)
Output Power	10.0 mW (DVD) 5.0 mW (VCD/CD)
Beam divergence	60 degrees

Contents

Care and Safety Information	
Setup	6
Cleaning discs	6
General Information	
Accessories supplied	7
Region codes	7
Connections	
Connecting to television	8~9
Using Composite Video sockets (CVBS)	8
Using Component Video sockets (YPbPr)	8
Using an accessory RF modulator	9
Connecting the power cord	9
Optional connections	
Connecting to an stereo system	10
Stereo system has Right/Left Audio In sockets	10
Connecting to a digital AV receiver	10
Receiver has a PCM, Dolby Digital or MPEG decoder	10
Product Overview	
Front and Rear panels	11
Remote Control	12
Getting Started	
Step 1: Inserting Batteries	13
Using the remote control to operate the system	13
Step 2: Finding your viewing channel	13
Step 3: Setting up Progressive Scan feature	14
Step 4: Selecting the matching colour system	15
Step 5: Setting the language	16
On-screen display (OSD) language	16
Audio, Subtitle and Disc menu languages	16
Playback from Disc	
Playable discs	17
Supported formats	17
Playback Features	
Starting disc playback	18
Basic playback control	18
Pausing playback	18
Selecting title/chapter/track	18
Stopping playback	18
Operations for video playback (DVD/VCD/SVCD)	19
Using the Disc Menu	19
Zooming in	19
OSD (On-Screen Display)	19
Title/Chapter/Track/Time Selection	19
Selecting various repeat / shuffle functions	20
Repeat play mode	20
Repeating a section within a chapter/track	20

Contents

Special DVD Features	21
Playing a Title.....	21
Camera Angle.....	21
Changing the Audio Language.....	21
Subtitle	21
Special VCD and SVCD Feature.....	21
Playback Control (PBC)	21
Playing MP3/JPEG/Kodak Picture CD.....	22
General Operation	22
Playback selection	22
Repeat	22
Karaoke Operations	
Playing Karaoke discs	23
General Operations	23
Vocal	23
Karaoke.....	23
DVD Menu Options	
Using the System setup menu	24~26
TV System	24
TV Type.....	24
Password	25
Rating.....	25~26
Default.....	26
Using the Language setup menu	27
OSD Language.....	27
Audio, Subtitle and Disc Menu Language.....	27
Using the Audio setup menu.....	27~28
Digital Out	27
Down Sample	28
Downmix.....	28
Using the Video setup menu	29
Video Out.....	29
Brightness / Contrast.....	29
Hue/Saturation.....	29
Sharpness.....	29
Others	
Troubleshooting.....	30~31
Specifications	32
Glossary.....	33

Care and Safety Information

DANGER!

High voltage! Do not open the device. You run the risk of getting an electric shock.

The machine does not contain any user-serviceable parts. Please leave all maintenance work to qualified personnel.

Setup

Finding a suitable location

- Place the set on a flat, hard and stable surface. Do not place the set on a carpet.
- Do not position the set on top of other equipment that might heat it up (e.g., receiver or amplifier).
- Do not put anything under the set (e.g., CDs, magazines).
- Install this unit near the AC outlet and where the AC power plug can be reached easily.

Space for ventilation

- Place the apparatus in a location with adequate ventilation to prevent internal heat build up. Allow at least 10 cm (4.0") clearance from the rear and the top of the set and 5cm (2.0") from the left and right to prevent overheating.

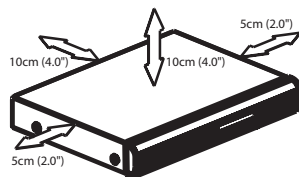

Avoid high temperatures, moisture, water and dust

- Apparatus shall not be exposed to dripping or splashing.
- Do not place any sources of danger on the apparatus (e.g., liquid filled objects, lighted candles).

Cleaning discs

Some problems occur because the disc inside the recorder is dirty (frozen picture, sound disruptions, picture distortions). To avoid these problems, discs should be cleaned on a regular basis.

To clean a disc, use a micro fibre cleaning cloth and wipe the disc from the center to the edge in a straight line.

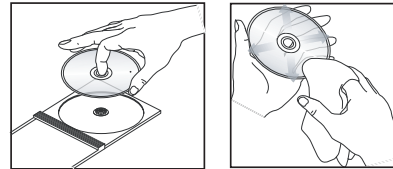

CAUTION!

Do not use solvents such as benzene, thinner, commercially available cleaners, or anti-static sprays intended for analog discs. Since the optical unit (laser) of the DVD player operates at a higher power than regular DVD or CD players, cleaning CDs intended for DVD or CD players may damage the optical unit (laser). Therefore, refrain from using a cleaning CD.

General Information

Accessories supplied

Video cable
(yellow)



Audio cable
(white, red)

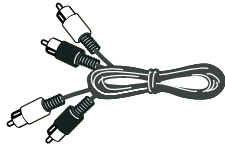

Remote control and two AAA batteries

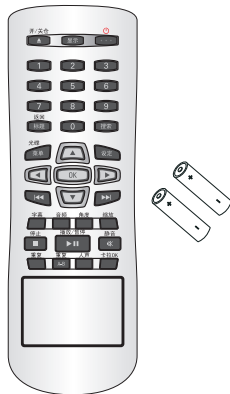

Region codes

This DVD player is designed to support the Region Management System. Check the regional code number on the disc package. If the number does not match the player's region number (see table below), the player may be unable to playback the disc.

Tips:

- It may not be possible to play CD-R/RW or DVD-R/RW in all cases due to the type of disc or condition of the recording.
- If you are having trouble playing a certain disc, remove the disc and try a different one. Improper formatted disc will not played on the DVD player.

Region	Discs that can be played	
U.S.A. and Canada regions		
U.K and Europe regions		
Asia Pacific, Taiwan, Korea		
Australia, New Zealand, Latin America		
Russia and India regions		
China, Calcos Islands, Walls and Futuna Islands		

Connections

Connecting to television

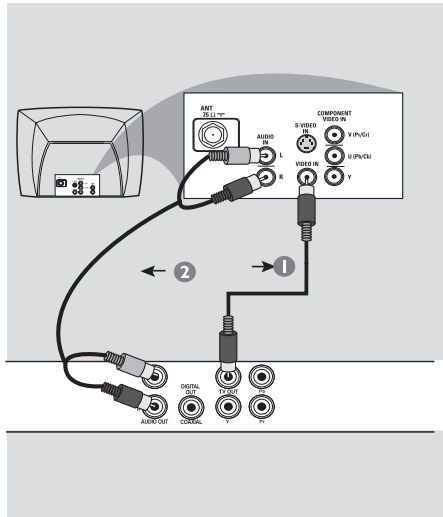

IMPORTANT!

- You only need to make one video connection from the following options, depending on the capabilities of your television.
- Connect the DVD player directly to the television.

Using Composite Video sockets (CVBS)

- 1 Use the composite video cable (yellow) to connect the DVD player's TV OUT (CVBS) socket to the video input jack (or labeled as A/V In, Video In, Composite or Baseband) on the television (cable supplied).
- 2 To hear sound of this DVD player through your TV, use the audio cables (white/red) to connect AUDIO OUT (L/R) sockets of the DVD player to the corresponding AUDIO IN sockets on the television (cable supplied).

TIPS: Before making or changing any connections, make sure that all the devices are disconnected from the power outlet.

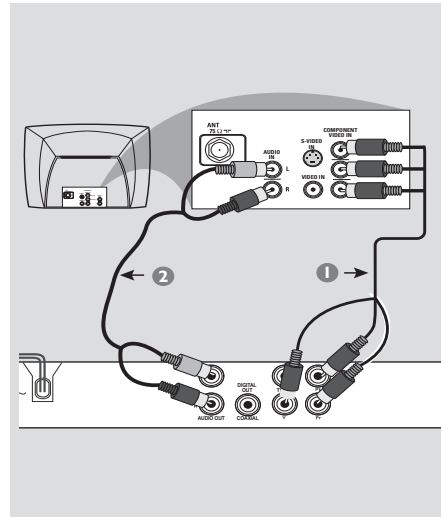

IMPORTANT!

- The progressive scan video quality is only possible when using YPbPr and a progressive scan television is required.

Using Component Video sockets (YPbPr)

- 1 Use the component video cables (red/blue/green) to connect the DVD player's YPbPr sockets to the component video input sockets (or labeled as YPbPr) on the television (cable not supplied).
- 2 To hear sound of this DVD player through your TV, use the audio cables (white/red) to connect AUDIO OUT (L/R) sockets of the DVD player to the corresponding AUDIO IN sockets on the television (cable supplied).
- 3 Proceed to page 14 for detailed progressive scan setup.

Connections (continued)

Connecting the power cord

English

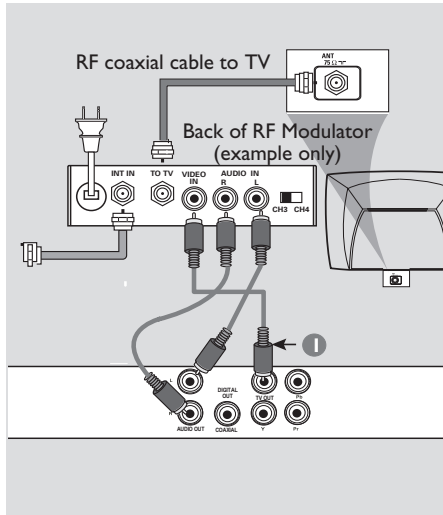

IMPORTANT!

– If your television only has a single Antenna In jack (or labeled as 75 ohm or RF In,) you will need an RF modulator in order to view the DVD playback on the television. See your electronics retailer for details on RF modulator availability and operations.

Using an accessory RF modulator

- 1 Use the composite video cable (yellow) to connect the DVD player's TV OUT jack to the video input jack on the RF modulator.
- 2 Use the RF coaxial cable (not supplied) to connect the RF modulator to your television's RF jack.
- 3 To hear sound of this DVD player through your TV, use the audio cables (white/red) to connect AUDIO OUT (L/R) sockets of the DVD player to the corresponding AUDIO IN sockets on the RF modulator (cable supplied).

TIPS: Before making or changing any connections, make sure that all the devices are disconnected from the power outlet.

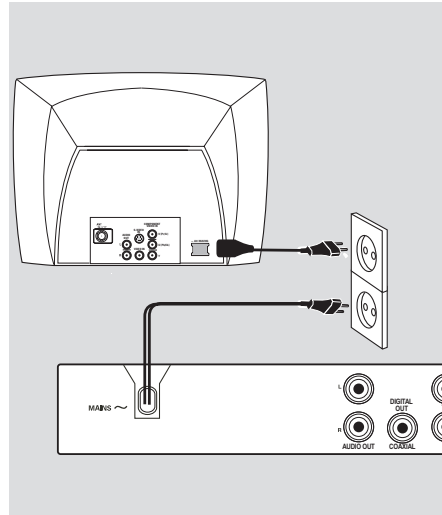

After everything is connected properly, plug in the AC power cord to the power outlet.

Never make or change any connections with the power switched on.

When no disc is loaded, press **STANDBY ON** on the DVD player front panel. "NO DISC" may appear on the display panel.

Optional connections

Connecting to an stereo system

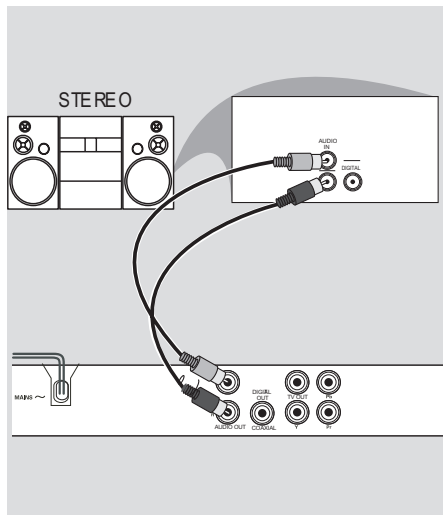

Stereo system has right/ left Audio In sockets

- 1 Select one of the video connections (CVBS VIDEO IN, COMPONENT VIDEO IN) depending on the options available on your TV.
- 2 Use the audio cables (white/red) to connect AUDIO OUT (L/R) sockets of the DVD Player to the corresponding AUDIO IN sockets on the stereo system (cable supplied).

Connecting to a digital AV receiver

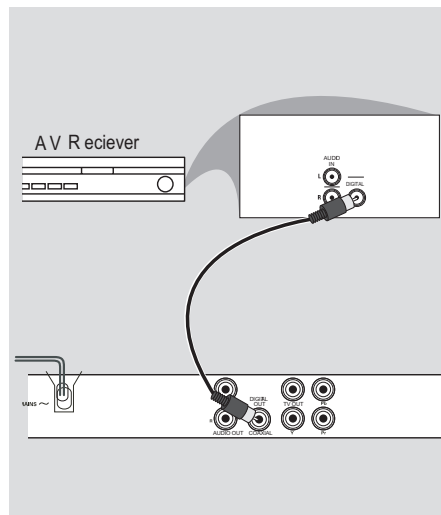

Receiver has a PCM, Dolby Digital or MPEG decoder

- 1 Select one of the video connections (CVBS VIDEO IN, COMPONENT VIDEO IN) depending on the options available on your TV.
- 2 Connect the COAXIAL jack of the DVD player to the corresponding Digital Audio In socket on your receiver (cable not supplied).
- 3 Set the DVD player's digital output to PCM or ALL depending on the capabilities of your receiver (see page 27 {Digital Out}).

Tip:

– If the audio format of the Digital Output does not match the capabilities of your receiver, the receiver will produce a strong, distorted sound or no sound at all.

TIPS: Before making or changing any connections, make sure that all the devices are disconnected from the power outlet.

Product Overview

English

Front and Rear Panels

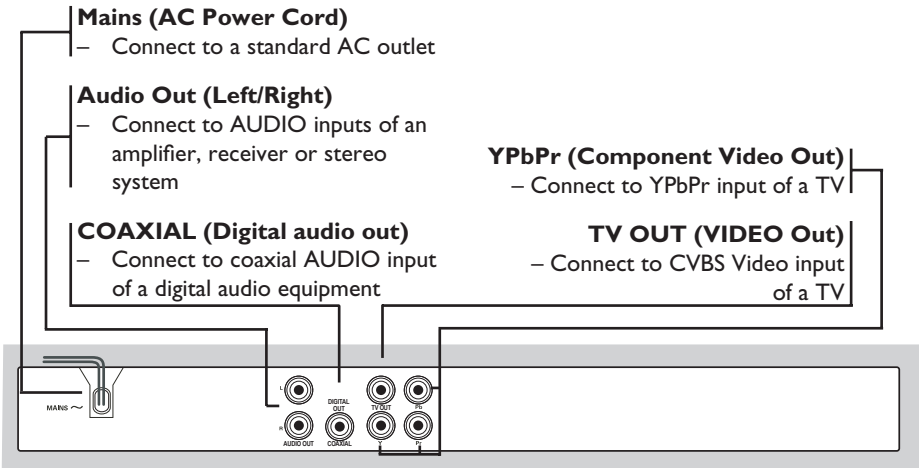
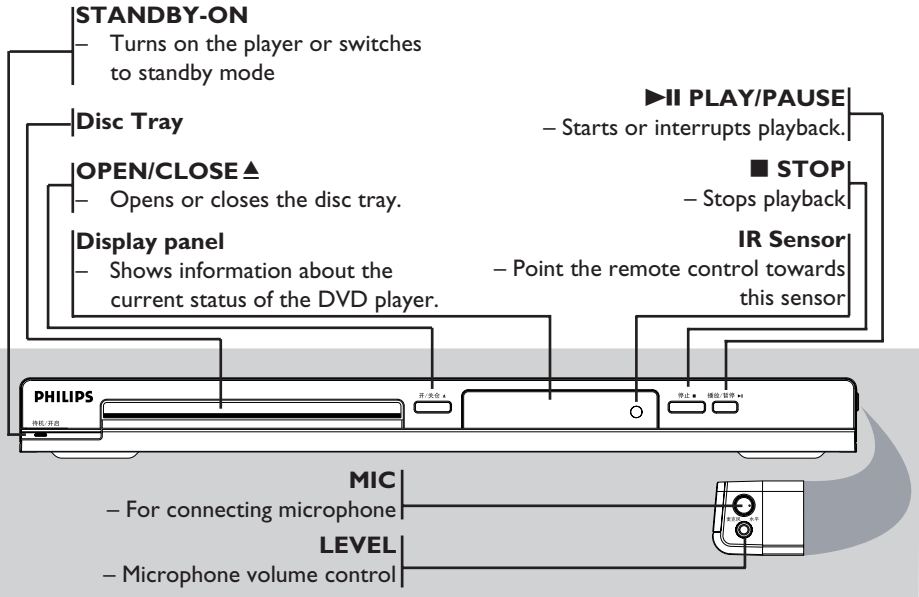

TIPS: Before making or changing any connections, make sure that all the devices are disconnected from the power outlet.

Product Overview (continued)

English

Remote Control

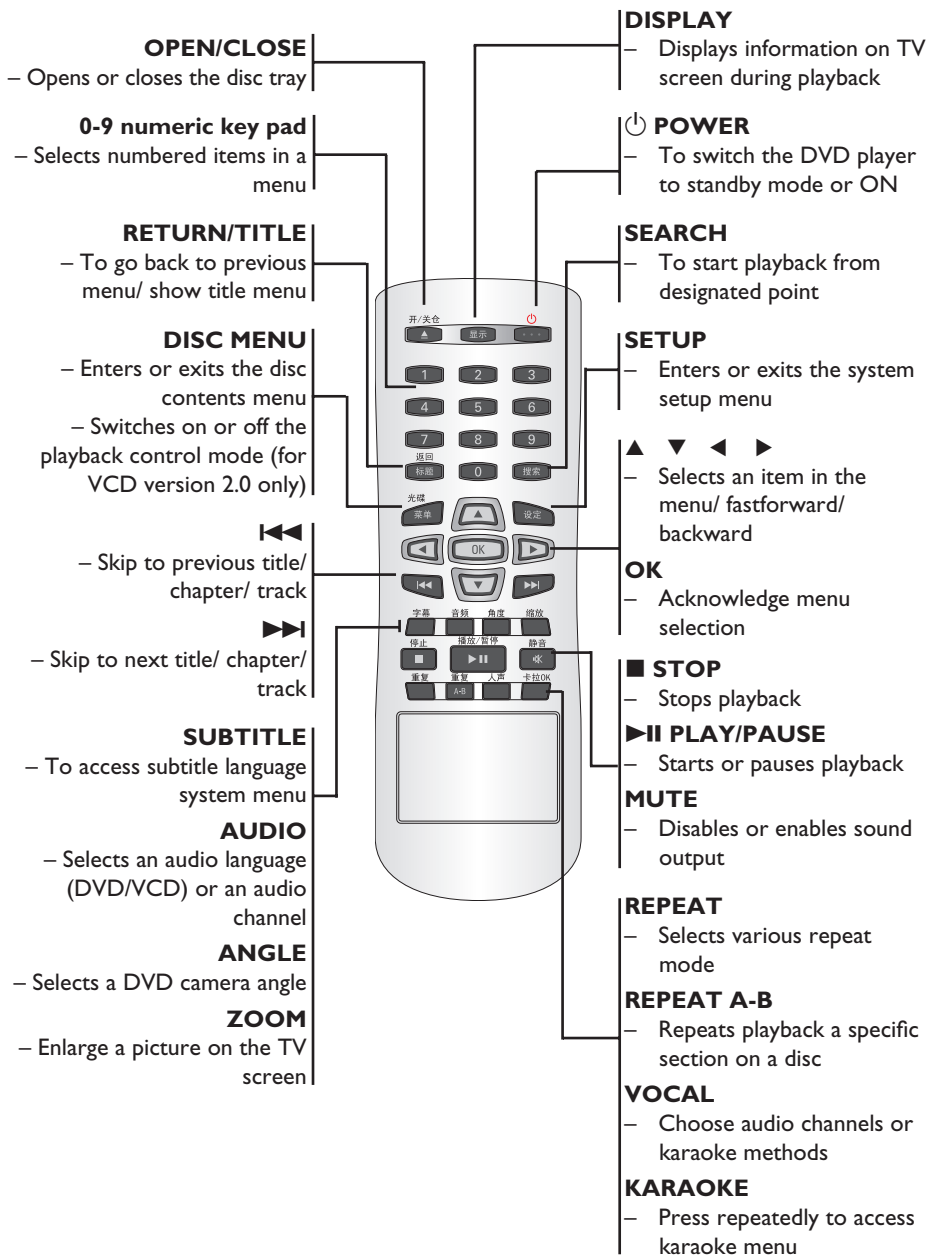

Getting Started

Step 1 : Inserting Batteries

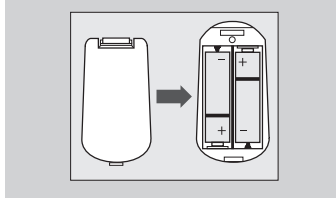

- 1 Open the battery compartment.
- 2 Insert two batteries type R03 or AAA, following the indications (+ -) inside the compartment.
- 3 Close the cover.

CAUTION!

- Remove batteries if they are exhausted or if the remote is not to be used for a long time.
- Do not use old and new or different types of batteries in combination.
- Batteries contain chemical substances, so they should be disposed of properly.

Using the remote control to operate the system

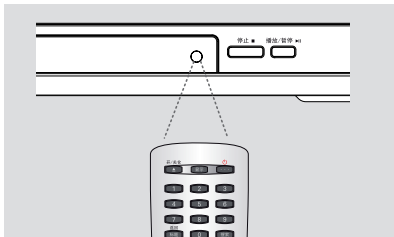

- 1 Aim the remote control directly at the remote sensor (IR) on the front panel.
- 2 Do not put any objects between the remote control and the DVD player while operating the DVD player.

Step 2 : Finding your viewing channel

- 1 Press **STANDBY-ON**  on the DVD player to turn it on.
- 2 Turn on the TV and set it to the correct video-in channel. You should see the blue DVD background screen.
 - Usually these channel are between the lowest and highest channels and may be called FRONT, A/V IN, VIDEO. See your TV's manual for more details.
 - Or, you may go to channel 1 on your TV, then press the Channel down button repeatedly until you see the Video In channel.
 - Or, the TV remote control may have a button or switch that chooses different video modes.
 - Or, set the TV to channel 3 or 4 if you are using an RF modulator.
- 3 If you are using external equipment, (e.g. audio system or receiver), turn it on and select the appropriate input source for the DVD player output. Refer to the equipment user's manual for detail.

Getting Started (continued)

Step 3 : Setting up Progressive Scan feature

(for Progressive Scan TV only)

The progressive scan displays twice the number of frames per seconds than interlaced scanning (ordinary normal TV system). With nearly double the number of lines, progressive scan offers higher picture resolution and quality.

Before you start...

- Ensure that you have connected this DVD player to a progressive scan TV using the Y Pb Pr connection (see page 8).
- Ensure that you have completed the basic installation and set-up.

- 1 Turn on your TV and set to interlace mode (refer to your TV user manual).
- 2 Press **POWER**  on the remote control to turn on the DVD player.
- 3 Select the correct video-in channel.
→ The DVD background menu appears.
- 4 Press **SETUP**.
- 5 Press **◀ ▶** to select { **VIDEO SETUP** }.
- 6 Press **▲ ▼** repeatedly to select { **VIDEO OUT** }, then press **▶**.

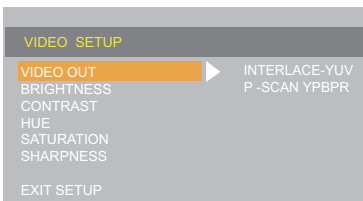

- 7 Press **▲ ▼** to select { **P-SCAN YPBPR** }, then press **OK**.
→ The menu will appear on the TV.

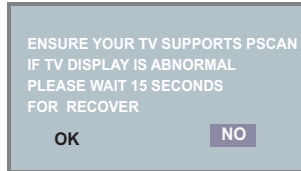

- 8 Press **◀** to select { **OK** } and press **OK** to confirm.

There will be a distorted picture on the TV at this state until you turn on the progressive scan mode on your TV.

- 9 Turn on your TV progressive scan mode (refer to your TV user manual).
→ The menu will appear on the TV.

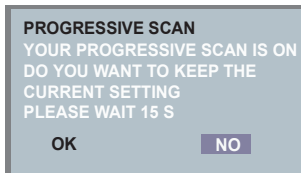

- 10 Press **◀** to select { **OK** } and press **OK** to confirm.
→ The setup is now completed and you can start enjoy the high quality picture.

To deactivate Progressive Scan manually:

- Wait for 15 seconds for auto recovery.

Tip:

– There are some progressive scan TVs and High-Definition TVs that are not fully compatible with this unit, resulting in the unnatural picture when playing back a DVD VIDEO disc in the progressive scan mode. In such a case, turn off the progressive scan feature on both the DVD player and your TV.

TIPS: The underlined option is the factory default setting.
Press **◀** to go back to previous menu item. Press **SETUP** to exit the menu item.

Getting Started (continued)

Step 4 : Selecting the matching colour system

The colour system of the DVD player, disc and TV should match in order for the disc to play. Before changing the TV system, determine the colour system of your TV.

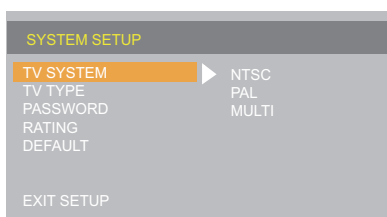

- 1 Press **SETUP**.
- 2 Press ◀ ▶ to select { **SYSTEM SETUP** }.
- 3 Press ▲ ▼ to select { **TV SYSTEM** }, then press ▶.
- 4 Use ▲ ▼ to select one of the options below:

{ **PAL** }

Select this if the connected TV has the PAL colour system. It will change the video signal of an NTSC disc and output it to PAL format.

{ **NTSC** }

Select this if the connected TV has the NTSC colour system. It will change the video signal of a PAL disc and output it to NTSC format.

{ **MULTI** }

Select this if the connected TV is compatible with both NTSC and PAL (multi-system). The output format will be in accordance with the video signal of the disc.

- 5 Select an item and press **OK**.

Tip:

– Before changing the current TV colour setting, ensure that your TV supports the 'selected TV System'.

CHANGING PAL TO NTSC:
1. ENSURE THAT YOUR TV SUPPORTS NTSC STANDARD.
2. IF THERE IS DISTORTED PICTURE DISPLAY ON THE TV
WAIT 15S FOR AUTO RECOVERY.
OK **NO**

CONFIRM AGAIN TO USE NEW TV TYPE SETTING.
PLEASE WAIT 15 S
OK **NO**

TIPS: The underlined option is the factory default setting.
Press ◀ to go back to previous menu item. Press **SETUP** to exit the menu item.

Getting Started (continued)

Step 5 : Setting the language

The language options are different depending on your country or region. It may not correspond to the illustrations shown on the user manual.

On-screen display (OSD) language

Select this to change the language of this DVD player screen display menu.

The menu language (on-screen display) for the system will remain as you set it.



- 1 Press **SETUP**.
- 2 Press **◀ ▶** to select { **LANGUAGE SETUP** }.
- 3 Press **▲ ▼** to highlight { **OSD LANGUAGE** }, then press **▶**.
- 4 Use **▲ ▼** to select a language and press **OK**.

Audio, Subtitle and Disc menu languages

You can choose your preferred language or soundtrack from audio, subtitles and DVD menu languages. If the selected language is not available on the disc, the disc's default language will be used instead.

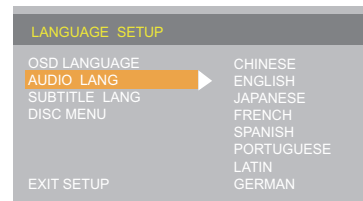

- 1 Press **SETUP**.
- 2 Press **◀ ▶** to select { **LANGUAGE SETUP** }.
- 3 Press **▲ ▼** to highlight one of the options below, then press **▶**.
 - { **AUDIO LANG** }
Select this to change disc soundtrack language.
 - { **SUBTITLE LANG** }
Select this to change the subtitle language.
 - { **DISC MENU** }
Select this to change the language of the disc menu.
- 4 Use **▲ ▼** to select a language and press **OK** to confirm.
- 5 Repeat steps 3 - 4 for other language settings.

Tip:

– Audio Lang and Subtitle Lang can only be activated during disc ejecting or no disc mode.

TIPS: The underlined option is the factory default setting.
Press **◀** to go back to previous menu item. Press **SETUP** to exit the menu item.

Playback from Disc

IMPORTANT!

– If the **INVALID ENTRY** appears on the TV screen when a button is pressed, it means the function is not available on the current disc or at the current time.

– **DVD discs and players are designed with regional restrictions. Before playing a disc, make sure the disc is for the same zone as your player.**

Playable discs

Using this DVD player, you can playback on the following discs:

DVD Video (Digital Versatile Disc)



DVD±RW (DVD Rewritable) Audio/Video format or MP3/JPEG files.



DVD±R (DVD Recordable) Audio/Video format or MP3/JPEG files.



CD-R (CD-Recordable) Audio/Video format or MP3/JPEG files.



CD-RW (CD-Rewritable) Audio/Video format or MP3/JPEG files.



Audio CD (Compact Disc Digital Audio)



Video CD
(Formats 1.0, 1.1, 2.0)



Super Video CD



MP3-Disc



Supported formats

MP3 tracks

- The file extensions has to be '.mp3.'
- JPEG/ISO format
- Maximum 10 characters display.
- Supported sampling frequencies;
(MPEG-1) 32kHz, 44.1kHz, 48kHz
(MPEG-2) 16kHz, 22.05kHz, 24kHz
- Supported bit-rates;
(MPEG-1) 32 ~ 256 kbps
(MPEG-2) 16 ~ 160 kbps

JPEG pictures

- The file extensions has to be '.JPG' and not '.JPEG.'
- JPEG/ISO format
- It can only display DCF-standard still pictures or JPEG pictures e.g. TIFF.

TIPS: Some discs cannot be played on this DVD player due to the configuration and characteristics of the disc, or due to the condition of recording and authoring software that was used.

Playback Features

Starting disc playback

- ① Turn on the TV to the correct programme number for the DVD player (e.g. 'EXT', '0', 'AV').
- ② Press **STANDBY-ON** to turn on the DVD player.
- ③ Press **OPEN/CLOSE ▲** on the front of the DVD player.
- ④ Place a disc into the disc tray with the label facing up, then press **OPEN CLOSE ▲**.
→ For double-sided discs, load the side which you want to play facing up.
- ⑤ Playback may start automatically. If not, press **PLAY/PAUSE ▶ II**.
- If a disc menu appears on the TV, see page 19 'Using the Disc Menu'.
- If the child lock was activated for the inserted disc, you have to enter your four-digit password (see page 25).
- For more playback features, see pages 18~22.

Basic playback controls

Unless otherwise stated, all operations described are based on Remote Control use.

Pausing playback

- ① During playback, press **PLAY/PAUSE ▶ II** to pause playback and display a still picture.
→ Sound will be muted.
- ② To resume normal playback, press **PLAY/PAUSE ▶ II** again.

Selecting title/chapter/track

- Press **◀◀ / ▶▶** to go to the previous or next title/chapter/track.
- In STOP mode, press **DISPLAY** to display the disc information text line for title/chapter/track (example - 00/08).
- Use **alphanumeric keypad (0-9)** to enter valid title/chapter/track number.
→ The playback skips to the selected title/chapter/track.

Stopping playback

- Press **STOP ■**.

Tips:

- Screen saver will start automatically if the disc playback is stopped for 5 minutes.
- The player will automatically switch to Power Standby mode if you do not press any buttons for 10 minutes after the disc has stopped playing.

TIPS: The operating features described here might not be possible for certain discs. Always refer to the instructions supplied with the discs.

Playback Features (continued)

Operations for video playback (DVD/VCD/SVCD)

Using the Disc Menu

Depending on the disc, a menu may appear on the TV screen once you load in the disc.

To select a playback feature or item

- Use ▲ ▼ ◀ ▶ keys or numeric keypad (0-9) on the remote, then press **OK** to start playback.

To access or remove the menu

- Press **DISC MENU** on the remote.

Zooming in

This function allows you to enlarge the picture on the TV screen and to pan through the enlarged picture.

- ① During playback, press **ZOOM** repeatedly to display the picture with different scales.
 - Use ▲ ▼ ◀ ▶ keys to pan through the enlarged picture.
 - Playback will continue.
- ② Press **ZOOM** repeatedly to return to the original size.

OSD (On-Screen Display)

This function display disc information on the TV screen during playback.

- During playback, press **DISPLAY** repeatedly.
 - The current disc information appears on the TV screen.

Title/Chapter/Time (DVD)

TT 0/2 CH 0/29 ⏱ 00:00:13

Audio/Subtitle/Angle (DVD)

⓪) 1/1 D5.1CH [] OFF [] OFF

Track/Mute/PBC/Repeat/Time (VCD)

TRK5/18 [] PBC [] [] 00:00:13

Title/Chapter/Track/Time selection

- ① Press **SEARCH**, then use ◀ ▶ keys to select an option.
- ② Use **numeric keypad (0-9)** to input a valid number.
 - The playback will change to the selected title/chapter/track or the chosen time.

TIPS: The operating features described here might not be possible for certain discs. Always refer to the instructions supplied with the discs.

Playback Features (continued)

Selecting various repeat/shuffle functions

Repeat play mode

The repeat play options vary depending on the disc type.

- 1 While playing a disc, press **REPEAT** continuously to choose a repeat options.

CHAPTER (DVD)

- to repeat playback of the current chapter.

REP I (CD/ SVCD/VCD) /

TITLE (DVD)

- to repeat playback of the current track (CD/ SVCD/VCD) / title.

REP ALL

- to repeat playback of the disc.

RANDOM (DVD/CD/VCD)

- the tracks and chapters being played in random order.

OFF

- to cancel the repeat mode.

Tip:

- For VCD, repeat playback is not possible if the PBC mode is switched on.

Repeating a section within a chapter/track

You can repeat the playback of a specific segment within a title/chapter track. To do this, you must mark the start and end of the segment you want.

- 1 While playing a disc, press **REPEAT A-B** at your chosen starting point.
- 2 Press **REPEAT A-B** again at your chosen end point.
 - The section A and B can be set only within the same chapter/track.
 - The section will now repeat continuously.
- 3 To exit the sequence, press **REPEAT A-B**.

TIPS: The operating features described here might not be possible for certain discs. Always refer to the instructions supplied with the discs.

Playback Features (continued)

Special DVD Features

Playing a Title

- 1 Press **DISC MENU**.
→ The disc title menu appears on the TV screen.
- 2 Use **▲ ▼ ◀ ▶** keys or **alphanumeric keypad 0-9** to select a play option.
- 3 Press **OK** key to confirm.

Camera Angle

- Press **ANGLE** repeatedly to select different desired angle.

Changing the Audio Language

For DVD

- Press **AUDIO** repeatedly to select different audio languages.

Changing the Audio Channel For VCD

- Press **AUDIO** to select the available audio channels provided by the disc (MONOL, MONOR, STEREO).

Subtitles

- Press **SUBTITLE** repeatedly to select different subtitle languages.

Special VCD and SVCD Feature

Playback Control (PBC)

For VCD with Playback Control (PBC) feature (version 2.0 only)

- Press **DISC MENU** to toggle between 'PBC ON' and 'PBC OFF'.
→ If you select 'PBC ON', the disc menu (if available) will appear on the TV.
→ Use the **◀◀ / ▶▶** or the **alphanumeric keypad 0-9** to select a play option.
- During playback, pressing **RETURN/TITLE** will return to the menu screen (if PBC is on).

If you want to skip the index menu and playback directly from the beginning,

- Press **DISC MENU** key on the remote control to switch to PBC off.

TIPS: The operating features described here might not be possible for certain discs. Always refer to the instructions supplied with the discs.

Playback Features (continued)

Playing MP3/JPEG/Kodak Picture CD

IMPORTANT!

You have to turn on your TV and set to the correct Video In channel. (See page 13 'Finding your viewing channel').

- Load a picture disc (Kodak Picture CD, JPEG)
 - For Kodak disc, the slide show will begin.
 - For JPEG disc, the picture menu appears on the TV screen.
- Press **PLAY/PAUSE ► II** to start the slide-show playback.

General Operation

- 1 Load a MP3/JPEG Picture CD disc.
 - The data disc menu appears on the TV screen
- 2 Press **▲▼** to select the folder and press **OK** to open the folder, then press **►**.



- 3 Press **▲▼** or use the numeric keypad (0-9) to highlight an option.
 - 4 Press **OK** to confirm.
 - Playback will start from the selected file to the end of the folder.
- MP3 track will automatically playback if a disc contains music and picture is loaded.
 - To play JPEG file, press **►** repeatedly to highlight the photo icon and press **OK** to confirm.

TIPS: The operating features described here might not be possible for certain discs. Always refer to the instructions supplied with the discs.

Playback selection

During playback, you can;

- Press **◀◀ / ▶▶** to select another track/file in the current folder.
- Press **PLAY/PAUSE ► II** repeatedly to pause/resume playback.

Repeat

- Press **REPEAT** continuously to access different 'Play Mode'.

REPEAT I

– keep a JPEG image still on the screen or play an MP3 file repeatedly.

REPEAT DIR

– play all files in the selected folder repeatedly.

REPEAT ALL

– play all files in the discs.

RANDOM

– to repeat playback in random order.

OFF

– turn off REPEAT Mode.

Karaoke Operations

Playing Karaoke discs

IMPORTANT!

You have to turn on your TV and set to the correct Video In channel. (See page 13 'Finding your viewing channel').

General Operation

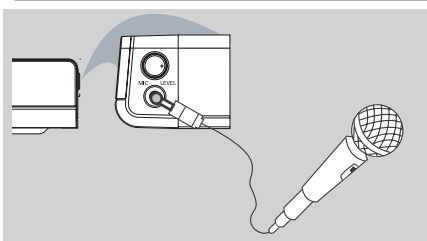

- ① Connect a microphone (not supplied) to **MIC** on the side panel of the DVD player.
- ② Press **KARAOKE** repeatedly to access karaoke menu.
 - 'MIC Setup: [Off]' appears on the TV screen.
 - Press **▶** to turn 'On' or 'Off' the karaoke mode.
- ③ Load a karaoke disc and press **PLAY ▶ II**.
- ④ Adjust the microphone volume using **MIC LEVEL** button on the side of the panel of the DVD player.

Tip:

– Before connecting the microphone, set the microphone volume to the minimum level to prevent howling.

Vocal

- You can fade out the original vocal from a karaoke disc.
- Press **VOCAL** repeatedly to choose different audio modes.

Tip:

– This function and on-screen display depends on the availability of the disc.

Karaoke

- ① Press **KARAOKE** to access to the karaoke menu.
- ② Press **▶** to select 'MIC Setup' to 'On'.
- ③ Press **KARAOKE** repeatedly to toggle between 'MIC Setup', 'MIC Vol', 'Echo' and 'Key'.
 - When 'MIC Setup' is selected, press **◀▶** to set MIC On or Off.
 - When 'MIC Vol' is selected, press **◀▶** to adjust the vocal value between 0 and 8.
 - When 'Echo' is selected, press **◀▶** to adjust the echo level between 0 and 8.
 - When 'Key' is selected, press **◀▶** to adjust the pitch value between -6 and 6. This function allows you to adjust the key tone level to match your vocal.

DVD Menu Options

This DVD Player setup is carried out via the TV, enabling you to customise the DVD player to suit your particular requirement.

Using the System Setup menu

- 1 In disc mode, press **SETUP**.
- 2 Press **◀▶** to select { **SYSTEM SETUP** }.

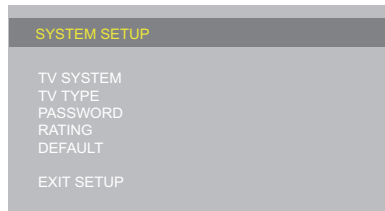

TV System

This menu contains the options for selecting the colour system that matches the connected TV. For details, see page 15.

TV Type

Set the TV TYPE of the DVD player according to the TV you have connected. The format you select must be available on the disc. If it is not, the setting for TV display will not affect the picture during playback.

- 1 In 'System Setup', press **▲▼** to select { **TV TYPE** }, then press **▶**.
- 2 Press **▲▼** to highlight one of the options below:

{ **4.3 PANSCAN** }

Select this if you have a normal TV and want both sides of the picture to be trimmed or formatted to fit your TV screen.

{ **4.3 LETTER BOX** }

Select this if you have a normal TV. In this case a wide picture with black bands on the upper and lower portions of the TV screen will be displayed.

{ **16:9** }

Select this if you have a wide screen TV.

- 3 Select an item and press **OK**.

TIPS: The underlined option is the factory default setting.
Press **◀** to go back to previous menu item. Press **SETUP** to exit the menu item.

DVD Menu Options (continued)

Password

You need to enter the four-digit password to play a prohibited disc or if prompted for a password. If the disc is locked, set the Rating to (8 Adult) to have all disc play.

- 1 In 'System Setup', press ▲ ▼ to select { **PASSWORD** }, then press **OK**.
- 2 Use the **numeric keypad (0-9)** to enter your default four-digit password.
- If you forget your old four-digit password, key in '0000'.
- 3 Press **OK** to confirm.
- If you need to change the password, press ► and use the **numeric keypad (0-9)** to enter the new four-digit password, then press **OK** to confirm.

Rating

This feature lets you set a playback limitation level. The rating levels are from 1 to 8 and are country dependent. You can prohibit the playing of certain discs that are not suitable for your children or have certain discs played with alternative scenes.

- Unlock the disc by entering the four-digit password before you can access into the {RATING} menu.
- 1 In 'System Setup' press ▲ ▼ to highlight { **RATING** }, then press ►.
 - 2 Press ▲ ▼ to highlight a rating level for the DVD player and press **OK**.
→ To disable parental controls and have all Disc play, select 8 { **Adult** }.

TIPS: The underlined option is the factory default setting.
Press ◀ to go back to previous menu item. Press **SETUP** to exit the menu item.

DVD Menu Options (continued)

- DVDs that are rated above the level you selected will not play unless you enter your four-digit password.

Tips:

- *This feature will not limit viewing if the disc manufacturer did not code the disc.*
- *VCD, SVCD, CD have no level indication, so parental control has no effect on these type of discs. This also applies to most illegal DVDs.*
- *Some DVDs are not coded with a rating though the movie rating may be printed on the disc cover. The rating level feature does not prohibit play of such discs.*

Default

Setting the DEFAULT function will reset all options and your personal settings to the factory defaults, except your password for rating.

- ① In 'System Setup' menu, press ▲▼ to highlight { **DEFAULT** }, then press ► to select { **RESTORE** }.
- ② Press **OK** to confirm.
→ All settings will now reset to factory defaults.

TIPS: The underlined option is the factory default setting.
Press ◀ to go back to previous menu item. Press **SETUP** to exit the menu item.

DVD Menu Options (continued)

Using the Language setup menu

- 1 In disc mode, press **SETUP**.
- 2 Press ◀▶ select { **LANGUAGE SETUP** }.

OSD Language

This menu contains various language options for the language displayed on the screen. For details, see page 16.

Subtitle/Audio/Disc Menu Language

These menus contain various language options for audio, subtitle and disc menu which may be recorded on the DVD. For details, see page 16.

Using the Audio setup menu

- 1 In disc mode, press **SETUP**.
- 2 Press ◀▶ select { **AUDIO SETUP** }.

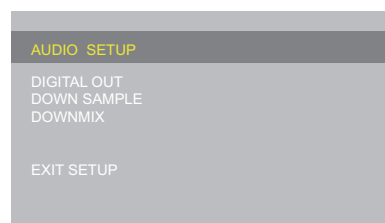

Digital Out

The options included in 'Digital Out' are: {ALL}, {PCM}.

- 1 In 'Audio Setup', press ▲▼ to highlight { **DIGITAL OUT** }, then press ▶.
{ ALL }
Select this if the connected device has a built-in multichannel decoder that supports one of the multichannel audio format (Dolby Digital, MPEG-2).
{ PCM }
Select this if the connected device is not capable of decoding multichannel audio. The DVD player will convert the Dolby Digital and MPEG-2 multichannel signals to PCM (Pulse Code Modulation).
- 2 Press ▲▼ to select a setting, then press **OK** to confirm your selection.

TIPS: The underlined option is the factory default setting.
Press ◀ to go back to previous menu item. Press **SETUP** to exit the menu item.

DVD Menu Options (continued)

Down Sample

You can enable and disable the digital signal for better sound output quality.

- 1 In 'Audio Setup', press ▲▼ to highlight { **DOWN SAMPLE** }, then press ►.

{ 48K }

Playback a disc recorded at the sampling rate of 48kHz.

{ **96K** }

Playback a disc recorded at the sampling rate of 96kHz. This rate can only be achieved in Stereo-Classic (Flat) mode.

- 2 Press ▲▼ to select a setting, then press **OK** to confirm your selection.

Downmix

This option allows you to set the stereo analog output of your DVD Player.

- 1 In 'Audio Setup', press ▲▼ to highlight { **DOWNMIX** }, then press ►.

{ LT/RT }

Select this option if your DVD Player is connected to a Dolby decoder.

{ **STEREO** }

Select this to change channel output to stereo which delivers sound from only the two front speakers.

{ **VSURR** }

Allows the DVD player to use virtual surround sound effects.

- 2 Press ▲▼ to select a setting, then press **OK** to confirm your selection.

TIPS: The underlined option is the factory default setting.
Press ◀ to go back to previous menu item. Press **SETUP** to exit the menu item.

DVD Menu Options (continued)

Using the Video setup menu

- 1 In disc mode, press **SETUP**.
- 2 Press ◀ ▶ select { **VIDEO SETUP** }.

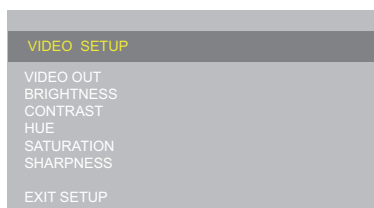

Video Out

- 1 In 'Video Setup', press ▲ ▼ to select { **VIDEO OUT** }, then press ▶.
- 2 Press ▲ ▼ to highlight one of the options below,
{ INTERLACE - YUV }
use component video cables (Y/Pb/Pr) to connect the appliance to the TV set, and the TV set is set to INTERLACE - YUV.
{ P-SCAN YPBPR }
use component video cables (Y/Pb/Pr) to connect the appliance to the TV set, and the TV set is set to progressive scan.
- 3 Press ▲ ▼ to select a setting and press **OK** to confirm.

Brightness/ Contrast

Increasing the value will brighten the picture or vice versa. Choose six (6) for average setting.

- 1 In 'Video Setup', press ▲ ▼ to highlight { **BRIGHTNESS** } or { **CONTRAST** }, then press ▶.
→ The menu appears.
- 2 Press ▲ ▼ to adjust the setting that best suit your personal preference.
- 3 Press **OK** to confirm.

Hue/Saturation

You can adjust your picture color by adjusting the hue and saturation values.

- 1 In 'Video Setup', press ▲ ▼ to highlight { **HUE** } or { **SHARPNESS** } then press ▶.
- 2 Press ▲ ▼ to adjust the setting that best suit your personal preference.
- 2 Press **OK** to confirm.

Sharpness

You can personalize your picture color by adjusting sharpness.

- 1 In 'Video Setup', press ▲ ▼ to highlight { **SHARPNESS** } then press ▶.
- 2 Press ▲ ▼ to adjust a setting, then press **OK** to confirm your selection.

TIPS: The underlined option is the factory default setting.
Press ◀ to go back to previous menu item. Press **SETUP** to exit the menu item.

Troubleshooting

WARNING

Under no circumstances should you try to repair the system yourself, as this will invalidate the warranty. Do not open the system as there is a risk of electric shock.

If a fault occurs, first check the points listed below before taking the system for repair. If you are unable to remedy a problem by following these hints, consult your dealer for help.

Problem	Solution
No power.	<ul style="list-style-type: none"> – Press STANDBY-ON button on the front of the DVD player to switch on the system. – Make sure the AC outlet has power.
Remote control does not work.	<ul style="list-style-type: none"> – Aim the remote control directly at the sensor on the front of the DVD player (not towards TV). – Remove any obstacles between DVD player and the remote control. – Batteries are weak, replace the batteries. – Check the polarities of the batteries are as indicated on the remote control (± signs).
No picture.	<ul style="list-style-type: none"> – Switch on your TV and set to the correct Video In channel for the DVD player. You may go to Channel 1 on your TV, then press the channel down button on your TV's remote control until you see the TV programme. – Check the video connection between the DVD player and the TV.
The picture is distorted or black & white during playback.	<ul style="list-style-type: none"> – The disc does not match with the TV colour system standard (PAL/NTSC). – The disc is dirty, clean the disc. – Sometimes a small amount of picture distortion may appear. This is not a malfunction. – To deactivate progressive scan function manually; <ol style="list-style-type: none"> 1) Turn off your TV progressive scan mode (or set to interlace mode) 2) Press OPEN/CLOSE to open the DVD player disc tray.
No sound.	<ul style="list-style-type: none"> – Check the audio connections, the red and white jacks are connected correctly. – Set the Digital output correctly, based on the equipment you connected to the DVD player.
Disc does not play.	<ul style="list-style-type: none"> – Insert the disc with the label facing up. – Wrong region code. – Wrong disc type. Read chapter "Playback - Playable discs" for details. – Make sure the disc is not scratched or warped. Clean the disc or replace a new one. – Check if the disc is defective by trying another disc.
The aspect ratio of the screen cannot be changed.	<ul style="list-style-type: none"> – The aspect ratio is fixed on the DVD disc. – Depending on the TV, it may not be possible to change the aspect ratio.

Need help? Visit us at www.philips.com/support

Troubleshooting (continued)

Problem	Solution
Not able to select some items in the setup/system menu.	<ul style="list-style-type: none">– Press STOP button twice before selecting the setup/system menu.– Depending on the disc availability, some menu items cannot be selected.
The DVD player does not start playback.	<ul style="list-style-type: none">– Insert a readable disc with the playback side facing down.– Check the disc type, colour system (PAL/NTSC) and region code.– Check for any scratches or smudges on the disc.– Press SETUP to turn off the setup menu screen.– You may need to enter the password in order to change the parental rating level or to unlock the disc for playback.– Moisture may have condensed inside the system. Remove the disc and leave the system turned on for about an hour.– Disconnect the power cord from the power outlet for a few minutes. Reconnect the power cord and try to operate again as usual.
Picture freezes momentarily during playback.	<ul style="list-style-type: none">– Check the disc for fingerprint/scratches and clean with a soft cloth wiping from centre to edge.
Unable to select Progressive Scan on/off.	<ul style="list-style-type: none">– Check that the output of the video signal is switch to { YPbPr }.

Need help? Visit us at www.philips.com/support

Specifications

TV STANDARD (PAL/50Hz) (NTSC/60Hz)

Number of lines	625	525
Playback	Multistandard (PAL/NTSC)	

VIDEO PERFORMANCE

Video DAC	10 bit, 108 MHz	
YPbPr	0.7 Vpp ~ 75 ohm	
Video Output	1Vpp ~ 75 ohm	

VIDEO FORMAT

Digital	MPEG 2 for DVD,SVCD	
Compression	MPEG 1 for VCD	

DVD	50Hz	60Hz
Horiz. resolution	720 pixels	720 pixels
Vertical resolution	576 lines	480 lines

VCD	50Hz	60Hz
Horiz. resolution	352 pixels	352 pixels
Vertical resolution	288 lines	240 lines

AUDIO FORMAT

Digital	MPEG/ AC-3/ PCM	compressed Digital 16, 20, 24 bits fs, 44.1, 48, 96 kHz
	MP3(ISO 9660)	96, 112, 128, 256 kbps & variable bit rate fs, 32, 44.1, 48 kHz

Analog Sound Stereo
Dolby Surround compatible downmix from Dolby
Digital multi-channel sound

AUDIO PERFORMANCE

DA Converter	24 bit, 192 kHz	
DVD	fs 96 kHz	4Hz- 44kHz
	fs 48 kHz	4Hz- 22kHz
SVCD	fs 48 kHz	4Hz- 22kHz
	fs 44.1kHz	4Hz- 20kHz
CD/VCD	fs 44.1kHz	4Hz- 20kHz
Signal-Noise (1kHz)	> 95 dB	
Dynamic range(1kHz)	> 85 dB	
Crosstalk (1kHz)	> 85 dB	
Distortion/noise (1kHz)	> 75 dB	
MPEG MP3	MPEG Audio L3	

CONNECTIONS

YPbPr Output	Cinch 3x
Video Output	Cinch (yellow)
Audio Output(L+R)	Cinch (white/red)
Digital Output	1 coaxial IEC60958 for CDDA / LPCM IEC61937 for MPEG 1/2, Dolby Digital

CABINET

Dimensions (w x h x d)	360 x 37 x 235 mm
Weight	Approximately 2.0 kg

POWER CONSUMPTION

Power Supply Rating	110-240V; 50/60Hz
Power consumption	< 10 W
Power consumption in Standby mode	< 1 W

Analog: Sound that has not been turned into numbers. Analog sound varies, while digital sound has specific numerical values. These jacks send audio through two channels, the left and right.

Aspect ratio: The ratio of vertical and horizontal sizes of a displayed image. The horizontal vs. vertical ratio of conventional TVs. is 4:3, and that of wide-screens is 16:9.

AUDIO OUT Jacks: Jacks on the back of the DVD System that send audio to another system (TV, Stereo, etc.).

Bit Rate: The amount of data used to hold a given length of music; measured in kilobits per seconds, or kbps. Or, the speed at which you record. Generally, the higher the bit rate, or the higher the recording speed, the better the sound quality. However, higher bit rates use more space on a Disc.

Chapter: Sections of a picture or a music piece on a DVD that are smaller than titles. A title is composed of several chapters. Each chapter is assigned a chapter number enabling you to locate the chapter you want.

Component Video Out Jacks: Jacks on the back of the DVD System that send high-quality video to a TV that has Component Video In jacks (R/G/B, Y/Pb/Pr, etc.).

Disc menu: A screen display prepared for allowing selection of images, sounds, subtitles, multi-angles, etc recorded on a DVD.

Digital: Sound that has been converted into numerical values. Digital sound is available when you use the DIGITAL AUDIO OUT COAXIAL or OPTICAL jacks. These jacks send audio through multiple channels, instead of just two channels as analog does.

Dolby Digital: A surround sound system developed by Dolby Laboratories containing up to six channels of digital audio (front left and right, surround left and right, center and subwoofer).

JPEG: A very common digital still picture format. A still-picture data compression system proposed by the Joint Photographic Expert Group, which features small decrease in image quality in spite of its high compression ratio.

MP3: A file format with a sound data compression system. 'MP3' is the abbreviation of Motion Picture Experts Group 1 (or MPEG-1) Audio Layer 3. By using MP3 format, one CD-R or CD-RW can contain about 10 times as much data volume as a regular CD can.

Multichannel: DVD is specified to have each sound track constitute one sound field. Multichannel refers to a structure of sound tracks having three or more channels.

Parental Control: A function of the DVD to limit playback of the disc by the age of the users according to the limitation level in each country. The limitation varies from disc to disc; when it is activated, playback will be prohibited if the software's level is higher than the user-set level.

PCM (Pulse Code Modulation): A system for converting analog sound signal to digital signal for later processing, with no data compression used in conversion.

Playback control (PBC): Refers to the signal recorded on video CDs or SVCDs for controlling reproduction. By using menu screens recorded on a Video CD or SVCD that supports PBC, you can enjoy interactive-type software as well as software having a search function.

Progressive Scan: It displays all the horizontal lines of a picture at one time, as a signal frame. This system can convert the interlaced video from DVD into progressive format for connection to a progressive display. It dramatically increases the vertical resolution.

Region code: A system for allowing discs to be played back only in the region designated beforehand. This unit will only play discs that have compatible region codes. You can find the region code of your unit by looking on the product label. Some discs are compatible with more than one region (or ALL regions).

Title: The longest section of a picture or music feature on DVD, music, etc., in video software, or the entire album in audio software. Each title is assigned a title number enabling you to locate the title you want.

TV OUT jack: Jack on the back of the DVD System that sends video to a TV.