

Register your product and get support at
www.philips.com/welcome

MCM166



EN User manual

PHILIPS

Contents

1 Important	4
Safety	4
Notice	6
2 Your Micro Hi-Fi System	7
Introduction	7
What's in the box	7
Overview of the main unit	8
Overview of the remote control	9
3 Connect	11
Connect speakers	11
Connect power	11
4 Get started	12
Prepare the remote control	12
Auto install radio stations	12
Set clock	12
Turn on	13
5 Play disc/USB	14
Play disc	14
Play from USB	14
6 Play options	15
Skip to a track	15
Search within a track	15
Display play information	15
Repeat play	15
Random play	15
Program tracks	15
7 Adjust volume level and sound effect	16
Adjust volume level	16
Select a preset sound effect	16
Enhance bass	16
Mute sound	16
8 Listen to radio	17
Tune to a radio station	17
Program radio stations automatically	17
Program radio stations manually	17
Select a preset radio station	17
Change MW tuning grid	17
9 Other features	18
Set the alarm timer	18
Set the sleep timer	18
Listen to an external device	18
Listen through headphone	18
10 Product information	19
Specifications	19
USB playability information	20
Supported MP3 disc formats	20
11 Troubleshooting	21

1 Important

Safety



Know these safety symbols

This 'bolt of lightning' indicates uninsulated material within your unit may cause an electrical shock. For the safety of everyone in your household, please do not remove product covering.

The 'exclamation mark' calls attention to features for which you should read the enclosed literature closely to prevent operating and maintenance problems.

WARNING: To reduce the risk of fire or electric shock, this apparatus should not be exposed to rain or moisture and objects filled with liquids, such as vases, should not be placed on this apparatus.

CAUTION: To prevent electric shock, fully insert the plug. (For regions with polarized plugs: To prevent electric shock, match wide blade to wide slot.)

Important Safety Instructions

- 1 Read these instructions.
- 2 Keep these instructions.
- 3 Heed all warnings.
- 4 Follow all instructions.
- 5 Do not use this apparatus near water.
- 6 Clean only with dry cloth.
- 7 Do not block any ventilation openings. Install in accordance with the manufacturer's instructions.

- 8 Do not install near any heat sources such as radiators, heat registers, stoves, or other apparatus (including amplifiers) that produce heat.
- 9 Protect the power cord from being walked on or pinched, particularly at plugs, convenience receptacles, and the point where they exit from the apparatus.
- 10 Only use attachments/accessories specified by the manufacturer.
- 11 Use only with the cart, stand, tripod, bracket, or table specified by the manufacturer or sold with the apparatus. When a cart is used, use caution when moving the cart/apparatus combination to avoid injury from tip-over.



- 12 Unplug this apparatus during lightning storms or when unused for long periods of time.
- 13 Refer all servicing to qualified service personnel. Servicing is required when the apparatus has been damaged in any way, such as power-supply cord or plug is damaged, liquid has been spilled or objects have fallen into the apparatus, the apparatus has been exposed to rain or moisture, does not operate normally, or has been dropped.
- 14 Battery usage **CAUTION** – To prevent battery leakage which may result in bodily injury, property damage, or damage to the unit:
 - Install all batteries correctly, + and - as marked on the unit.
 - Do not mix batteries (old and new or carbon and alkaline, etc.).

- Remove batteries when the unit is not used for a long time.
 - Batteries (battery pack or batteries installed) shall not be exposed to excessive heat such as sunshine, fire or the like.
- ⑮ **Apparatus shall not be exposed to dripping or splashing.**
- ⑯ **Do not place any sources of danger on the apparatus (e.g. liquid filled objects, lighted candles).**
- ⑰ **This product may contain lead and mercury. Disposal of these materials may be regulated due to environmental considerations. For disposal or recycling information, please contact your local authorities or the Electronic Industries Alliance: www.eiae.org.**
- Where the MAINS plug or an appliance coupler is used as the disconnect device, the disconnect device shall remain readily operable.



Warning

- Never remove the casing of this apparatus.
- Never lubricate any part of this apparatus.
- Never place this apparatus on other electrical equipment.
- Keep this apparatus away from direct sunlight, naked flames or heat.
- Never look into the laser beam inside the apparatus.
- Ensure that you always have easy access to the power cord, plug or adaptor to disconnect the apparatus from the power.



Caution

- Use of controls or adjustments or performance of procedures other than herein may result in hazardous radiation exposure or other unsafe operation.

Hearing safety

Listen at a moderate volume.

- Using headphones at a high volume can impair your hearing. This product can produce sounds in decibel ranges that may cause hearing loss for a normal person, even for exposure less than a minute. The higher decibel ranges are offered for those that may have already experienced some hearing loss.
- Sound can be deceiving. Over time your hearing 'comfort level' adapts to higher volumes of sound. So after prolonged listening, what sounds 'normal' can actually be loud and harmful to your hearing. To guard against this, set your volume to a safe level before your hearing adapts and leave it there.

To establish a safe volume level:

- Set your volume control at a low setting.
- Slowly increase the sound until you can hear it comfortably and clearly, without distortion.

Listen for reasonable periods of time:

- Prolonged exposure to sound, even at normally 'safe' levels, can also cause hearing loss.
- Be sure to use your equipment reasonably and take appropriate breaks.

Be sure to observe the following guidelines when using your headphones.

- Listen at reasonable volumes for reasonable periods of time.
- Be careful not to adjust the volume as your hearing adapts.
- Do not turn up the volume so high that you can't hear what's around you.
- You should use caution or temporarily discontinue use in potentially hazardous situations. Do not use headphones while operating a motorized vehicle, cycling, skateboarding, etc.; it may create a traffic hazard and is illegal in many areas.

Notice

Any changes or modifications made to this device that are not expressly approved by Philips Consumer Lifestyle may void the user's authority to operate the equipment.

Environmental information

All unnecessary packaging has been omitted. We have tried to make the packaging easy to separate into three materials: cardboard (box), polystyrene foam (buffer) and polyethylene (bags, protective foam sheet.) Your system consists of materials which can be recycled and reused if disassembled by a specialized company. Please observe the local regulations regarding the disposal of packaging materials, exhausted batteries and old equipment.



Windows Media and the Windows logo are trademarks, or registered trademarks of Microsoft Corporation in the United States and/or other countries.

Class II equipment symbol



This symbol indicates that the unit has a double insulation system.

2 Your Micro Hi-Fi System

Congratulations on your purchase, and welcome to Philips! To fully benefit from the support that Philips offers, register your product at www.Philips.com/welcome.

Introduction

With this unit, you can enjoy music from audio discs, USB devices and other external devices, or radio stations.

To enrich sound, the unit offers you multiple sound effects:

- Digital Sound Control (DSC)
- Dynamic Bass Boost (DBB)

The unit supports the following media formats:



What's in the box

Check and identify the contents of your package:

- Main unit
- Loudspeaker boxes x 2
- Remote control
- AC plug adaptor x 1
- User manual
- Quick start guide

Overview of the main unit

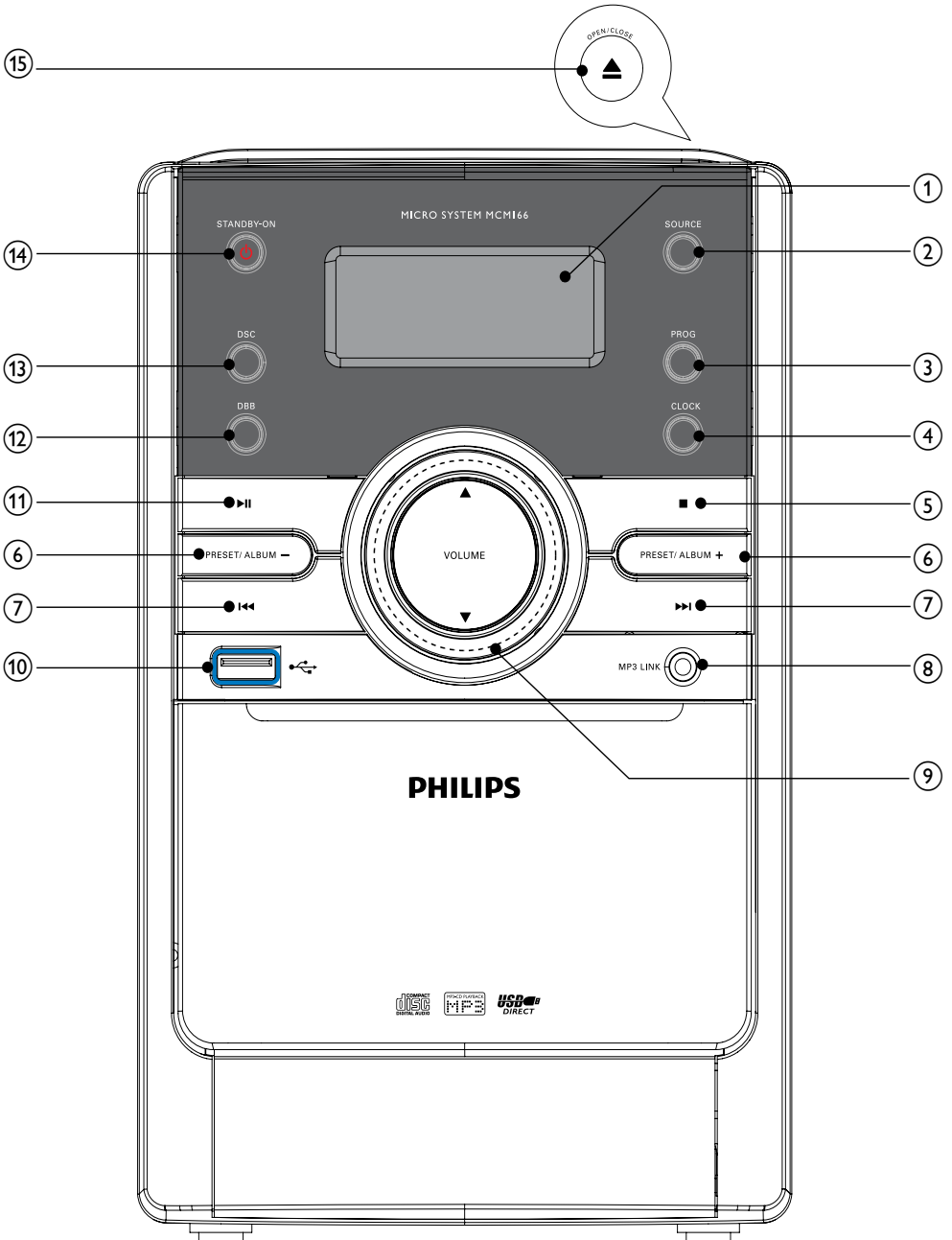

- ① **Display panel**
 - Show current status.
- ② **SOURCE**
 - Select a source: Disc, TUNER, USB or MP3 LINK.
- ③ **PROG**
 - Program tracks.
 - Program radio stations.
 - Select 12 hour or 24 hour format.
- ④ **CLOCK**
 - Set the clock.
 - View the clock.
 - During play, select display information.
- ⑤ **■**
 - Stop play or erase a program.
- ⑥ **PRESET/ALBUM+/-**
 - Select a preset radio station.
 - Skip to the previous/next album.
- ⑦ **⏮️/⏪️/⏩️/⏭️**
 - Skip to the previous/next track.
 - Search within a track/ disc/USB.
 - Tune to a radio station.
 - Adjust time.
- ⑧ **MP3 LINK**
 - Jack for an external audio device.
- ⑨ **VOLUME▲▼**
 - Adjust volume.
- ⑩ **🔌**
 - Jack for a USB mass storage device.
- ⑪ **▶️||**
 - Start or pause play.
- ⑫ **DBB**
 - Turns on or off dynamic bass enhancement.
- ⑬ **DSC**
 - Select a preset sound setting: POP, JAZZ, CLASSIC or ROCK.
- ⑭ **STANDBY-ON**
 - Turn on the unit, switch to standby mode.

- ⑮ **OPEN/CLOSE▲**
 - Open or close the disc tray.

Overview of the remote control

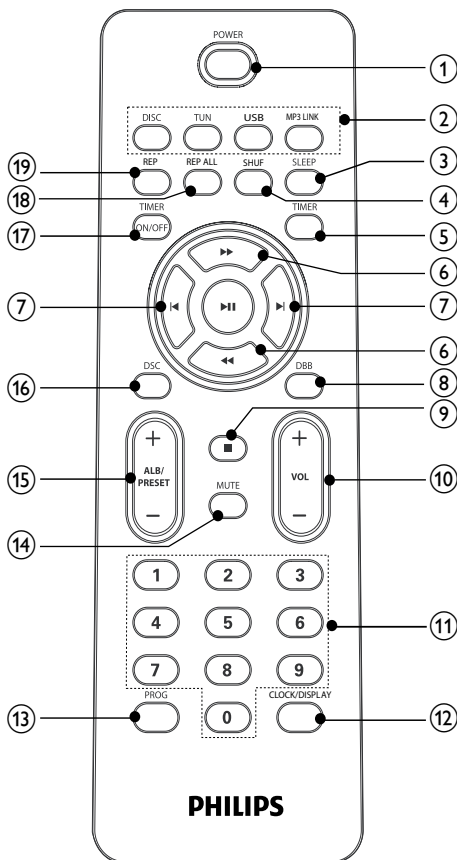

- ① **POWER**
 - Turn on the unit, switch to standby mode.
- ② **Source selection keys (DISC, TUN, USB,MP3 LINK)**
 - Select a source: CD, TUNER, USB or MP3 LINK.

- ③ **SLEEP**
 - Set the sleep timer.
- ④ **SHUF**
 - Play tracks randomly.
- ⑤ **TIMER**
 - Set the alarm timer.
- ⑥ **◀◀▶▶**
 - Search within a track/ disc/USB.
 - Tune to a radio station.
 - Adjust time.
- ⑦ **⏮▶**
 - Skip to the previous/next track.
- ⑧ **DBB**
 - Turns on or off dynamic bass enhancement.
- ⑨ **■**
 - Stop play or erase a program.
- ⑩ **VOL +/-**
 - Adjust volume.
- ⑪ **Numeric keypad**
 - Select a track from a disc directly.
- ⑫ **CLOCK/DISPLAY**
 - Set the clock.
 - View the clock.
 - During play, select display information.
- ⑬ **PROG**
 - Program tracks.
 - Program radio stations.
 - Select 12 hour or 24 hour format.
- ⑭ **MUTE**
 - Mute volume.
- ⑮ **ALB/PRESET+/-**
 - Skip to the previous/next album.
 - Select a preset radio station.
- ⑯ **DSC**
 - Select a preset sound setting: POP, JAZZ, CLASSIC or ROCK.
- ⑰ **TIMER ON/OFF**
 - Turn on or off alarm timer.
- ⑱ **REP ALL**
 - Play all tracks repeatedly.
- ⑲ **REP**
 - Play a track repeatedly.

3 Connect

Connect speakers

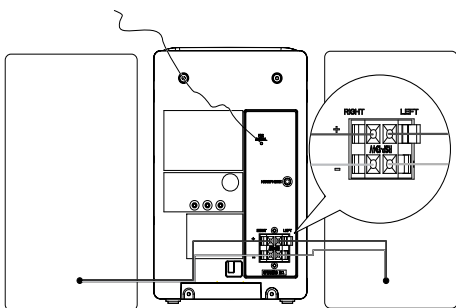

Note

- Insert the stripped portion of each speaker wire into the socket completely.
- For optimal sound, use the supplied speakers only.
- Connect only speakers with impedance that is the same or higher than the supplied speakers. Refer to the Specifications section of this manual.

- 1 For the right speaker, find the sockets on the main unit marked 'RIGHT'.
- 2 Insert the red wire to the red (+) socket. To insert each speaker wire:
 - ① Hold down the socket flap.
 - ② Insert the speaker wire fully.
 - ③ Release the socket flap.

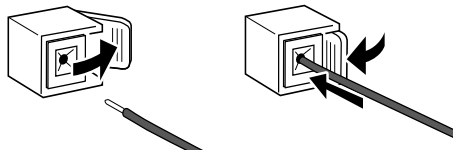

- 3 Insert the black wire into the black (-) socket.
- 4 For the left speaker, find the sockets on the main unit marked 'LEFT'.

- 5 Repeat steps 2-3.

Connect power

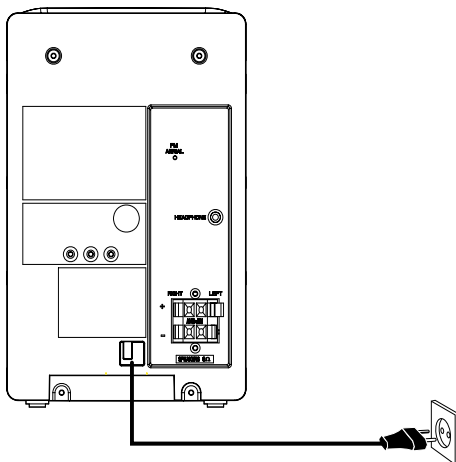

! Caution

- Risk of product damage! Make sure that the power supply voltage corresponds to the voltage printed on the back or the underside of the unit.
- The unit is equipped with a voltage selector on the back panel. It is preset at 220V from the factory. For areas that operate at 110V-127V, change the voltage selector to 110V-127V before connecting the AC power supply.
- Before connecting the AC power cord, ensure you have completed all other connections.

Note

- The type plate is located on the back of the main unit.

- 1 Connect the AC power cord to the power outlet.

4 Get started

! Caution

- Use the controls only as stated in this user manual.
- Always follow the instructions in this chapter in sequence.

If you contact Philips, you will be asked for the model and serial number of your apparatus. The model number and serial number are on the back of the apparatus. Write the numbers here:
Model No. _____
Serial No. _____

Prepare the remote control

! Caution

- Risk of explosion! Keep batteries away from heat, sunshine or fire. Never discard batteries in fire.

To insert the remote control battery:

- 1 Open the battery compartment.
- 2 Insert 2 AAA batteries (not supplied) with correct polarity (+/-) as indicated.
- 3 Close the battery compartment.

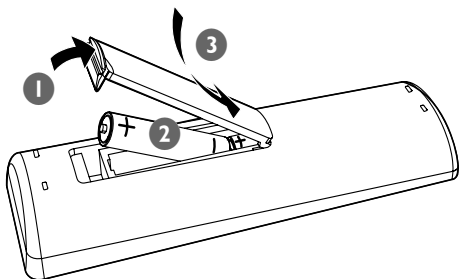

≡ Note

- If you are not going to use the remote control for a long time, remove the batteries.
- Do not use old and new or different types of batteries in combination.
- Batteries contain chemical substances, so they should be disposed of properly.

Auto install radio stations

When you connect the unit to the power supply for the first time, or no radio station is stored in this unit, Plug and Play is activated to store all available radio stations automatically.

- 1 Connect the unit to the power supply.
↳ [AUTO INSTALL - PLEASE PRESS PLAY, STOP CANCEL] (press the PLAY button to auto install; to cancel, press ■) displays.
- 2 Press ►|| on the main unit to start installation.
↳ [AUTO] displays.
↳ The unit automatically store radio stations with sufficient signal strength.
↳ When all the available radio stations are stored, the first preset radio station is broadcast automatically.

Set clock

- 1 Press and hold **CLOCK/DISPLAY** to activate the clock setting mode.
↳ The 12 hour or 24 hour format is displayed.
- 2 Press **PROG** repeatedly to select 12 hour or 24 hour format.
- 3 Press **CLOCK/DISPLAY** to confirm.
↳ The hour digits are displayed and begin to blink.
- 4 Press ◀▶ to set the hour.

- 5 Press **CLOCK/DISPLAY** to confirm.
↳ The minute digits are displayed and begin to blink.
- 6 Press **◀▶** to set the minute.
- 7 Press **CLOCK/DISPLAY** to confirm.

**Tip**

- To view the clock during play, press **CLOCK/DISPLAY** repeatedly until the clock is displayed.

Turn on

- 1 Press **POWER**.
↳ The product switches to the last selected source.

Switch to standby

- 1 Press **POWER** to switch the unit to standby mode.
↳ The backlight on the display panel is dimmed.
↳ The clock (if set) appears on the display panel.

5 Play disc/USB

Play disc

- 1 Press **DISC** to select the disc source.
- 2 Press **OPEN/CLOSE▲** on the top panel to open the disc tray.
- 3 Insert a disc with the printed side facing up, then close the disc tray.
- 4 Press **▶||** to start play.
 - To pause/resume play, press **▶||**.
 - To stop play, press **■**.

Play from USB

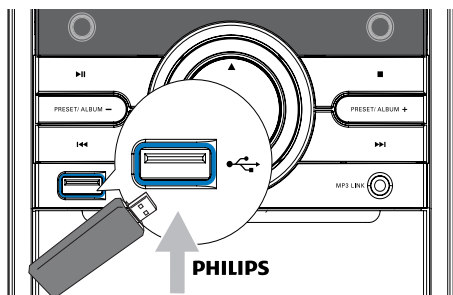

Note

- Ensure that the USB device contains playable audio contents for supported formats.

- 1 Insert the USB plug of a USB device into **↔** the socket.
- 2 Press **USB** to select the USB source.
↳ The total number of tracks is displayed.
- 3 Press **ALB/PRESET+/-** to select a folder.
- 4 Press **◀▶** to select a file.
- 5 Press **▶||** to start play.

6 Play options

Skip to a track

For CD:

- 1 Press **◀▶** to select another track.
 - To select a track, you can also press a numeric button.

For MP3 disc and USB:

- 1 Press **ALB/PRESET+/-** to select an album or folder.
- 2 Press **◀▶** to select a track or file.

Search within a track

- 1 During play, press and hold **◀▶**.
- 2 Release to resume normal play.

Display play information

- 1 During play, press **CLOCK/DISPLAY** repeatedly to select different play information.

Repeat play

Play a track repeatedly

- 1 During play, press **REP**.
 - ↳ [REP] (repeat) is displayed: the current track is played repeatedly.
- 2 To return to normal play, press **REP** again.

Play all tracks or an album repeatedly

- 1 During play, press **REP ALL** repeatedly to select:
 - ↳ [REP ALL] (repeat all) is displayed: all tracks are played repeatedly.

↳ [REP ALB] (repeat album) is displayed (for MP3 and USB only); the current album is played repeatedly.

- 2 To return to normal play, press **REP ALL** repeatedly until repeat mode is no longer displayed.

Random play

- 1 Press **SHUF**.
 - ↳ [SHUF] (shuffle) is displayed: all tracks are played randomly.
- 2 To return to normal play, press **SHUF** again.

Note

- The repeat and shuffle functions cannot be activated at the same time.
- Shuffle play cannot be selected when you play programmed tracks.

Program tracks

You can program a maximum of 40 tracks.

- 1 At CD/USB mode, in the stop position, press **PROG** to activate the program mode.
 - ↳ [PROG] (program) blinks on the display.
- 2 For MP3/WMA tracks, press **ALB/PRESET+/-** to select an album.
- 3 Press **◀▶** to select a track number, then press **PROG** to confirm.
- 4 Repeat steps 2 to 3 to select and store all tracks to program.
- 5 Press **▶||** to play the programmed tracks.
 - ↳ During play, [PROG] (program) is displayed.
 - To erase the program, in the stop position, press **■**.

7 Adjust volume level and sound effect

Adjust volume level

- 1 During play, press **VOL +/-** to increase/decrease the volume level.

Select a preset sound effect

- 1 During play, press **DSC** repeatedly to select:
 - [POP] (pop)
 - [JAZZ] (jazz)
 - [CLASSIC] (classic)
 - [ROCK] (rock)

Enhance bass

- 1 During play, press **DBB** to turn on or off dynamic bass enhancement.
↳ If DBB is activated, DBB is displayed.

Mute sound

- 1 During play, press **MUTE** to mute/unmute sound.

8 Listen to radio

Tune to a radio station

- 1 Press **TUN** repeatedly to select FM or MW.
- 2 Press and hold **◀▶** for more than 2 seconds.
 - ↳ [SEARCH] (search) is displayed.
 - ↳ The radio tunes to a station with strong reception automatically.
- 3 Repeat step 2 to tune to more stations.
 - To tune to a weak station, press **◀▶** repeatedly until you find optimal reception.

Program radio stations automatically

You can program a maximum of 40 preset radio stations (30 FM, 10 MW).

- 1 In the tuner mode, press and hold **PROG** for 2 seconds to activate automatic program mode.
 - ↳ [AUTO] (auto) is displayed.
 - ↳ All available stations are programmed in the order of waveband reception strength.
 - ↳ The first programmed radio station is broadcast automatically.

Program radio stations manually

You can program a maximum of 40 preset radio stations (30 FM, 10 MW).

- 1 Tune to a radio station. (See "Tune to a radio station" section.)
- 2 Press **PROG** to activate program mode.

↳ [PROG] (program) blinks on the display.

- 3 Press **ALB/PRESET+/-** to allocate a number to this radio station, then press **PROG** to confirm.
 - ↳ The preset number and the frequency of the preset station are displayed.
- 4 Repeat the above steps to program other stations.

Tip

- To overwrite a programmed station, store another station in its place.

Select a preset radio station

- 1 In tuner mode, press **ALB/PRESET+/-** to select a preset number.

Tip

- Position the antenna as far as possible from TV, VCR or other radiation source.
- For optimal reception, fully extend and adjust the position of the antenna.

Change MW tuning grid

In some countries, the MW radio frequency step between adjacent channels is 9 kHz (10 kHz in some areas). The preset frequency step is 9 kHz.

- 1 Select the tuner source.
- 2 Press and hold **■** on the main unit for more than 2 seconds.
 - ↳ The frequency step is changed to 9 kHz or 10 kHz.
 - ↳ All preset stations are erased and need to be re-programmed.

9 Other features

Set the alarm timer

This unit can be used as an alarm clock. The DISC, TUNER or USB is activated to play at a preset time.

- 1 Ensure that you have set the clock correctly.
- 2 Press and hold **TIMER**.
- 3 Press **DISC**, **TUN** or **USB** to select a source.
- 4 Press **TIMER** to confirm.
↳ The hour digits are displayed and begin to blink.
- 5 Press **◀▶** to set the hour.
- 6 Press **TIMER** to confirm.
↳ The minute digits are displayed and begin to blink.
- 7 Press **◀▶** to set the minute.
- 8 Press **TIMER** to confirm.
↳ The timer is set and activated.

Activate and deactivate alarm timer

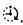
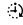
- 1 Press **TIMER ON/OFF** repeatedly to activate or deactivate timer.
↳ If timer is activated, the display shows 
↳ If timer is deactivated,  disappears on the display.

Note

- Alarm timer is not available in MP3 LINK mode.
- If DISC/USB source is selected and the track cannot be played, tuner is activated automatically.

Set the sleep timer

This unit can switch to standby automatically after a set period of time.

- 1 When the unit is turned on, press **SLEEP** repeatedly to select a set period of time (in minutes).
↳ When sleep timer is activated, the display shows **zzz**.

To deactivate sleep timer

- 1 Press **SLEEP** repeatedly until "0" is displayed.
↳ When sleep timer is deactivated, **zzz** disappears.

Listen to an external device

You can listen to an MP3 player through this unit.

- 1 Press **MP3 LINK** to select MP3 LINK source.
- 2 Connect the supplied MP3 link cable to:
 - **MP3 LINK** jack (3.5 mm) on the unit
 - the headphone jack on an external device
- 3 Start to play the device (see the device user manual).

Listen through headphone

- 1 Plug a headphone into the **HEADPHONE** socket on the unit.

10 Product information

Note

- Product information is subject to change without prior notice.

Specifications

Amplifier

Rated Output Power	2X5W RMS
Frequency Response	60 - 16kHz, ± 3 dB
Signal to Noise Ratio	>65dB
Aux Input	0.5 V RMS 20kohm

Disc

Laser Type	Semiconductor
Disc Diameter	12cm/8cm
Support Disc	CD-DA, CD-R, CD-RW, MP3-CD, WMA-CD
Audio DAC	24Bits / 44.1kHz
Total Harmonic Distortion	<1%
Frequency Response	60Hz -16kHz (44.1kHz)
S/N Ratio	>65dBA

Tuner

Tuning Range	FM: 87.5 - 108MHz; MW: 531 - 1602kHz (9KHz); 530 - 1700KHz (10KHz)
Tuning grid	50KHz (FM); 9KHz/10KHz (MW)

FM

Sensitivity	
- Mono, 26dB S/N Ratio	<22 dBf
- Stereo, 46dB S/N Ratio	<43 dBf
Search Selectivity	>28dBf
Total Harmonic Distortion	<3%
Signal to Noise Ratio	>55dB

Speakers

Speaker Impedance	4ohm
Speaker Driver	3.5"woofer+0.8" tweeter
Sensitivity	>82dB/m/W

General information

AC power Consumption	110-127/220-240V~ 50/60Hz
Operation Power Consumption	20W
Standby Power Consumption	<2W
USB Direct	Version 2.0/1.1
Dimensions	
- Main Unit (W x H x D)	209 x 231 x 147mm
- Speaker Box (W x H x D)	146 x 228 x 160mm
Weight	
- With Packing	6.6 kg
- Main Unit	1.95 kg
- Speaker Box	2 x 1.2 kg

USB playability information

Compatible USB devices:

- USB flash memory (USB 2.0 or USB 1.1)
- USB flash players (USB 2.0 or USB 1.1)
- memory cards (requires an additional card reader to work with this unit)

Supported formats:

- USB or memory file format FAT12, FAT16, FAT32 (sector size: 512 bytes)
- MP3 bit rate (data rate): 32-320 Kbps and variable bit rate
- WMA v9 or earlier
- Directory nesting up to a maximum of 8 levels
- Number of albums/ folders: maximum 99
- Number of tracks/titles: maximum 999
- ID3 tag v2.0 to v2.4
- File name in Unicode UTF8 (maximum length: 128 bytes)

Supported MP3 disc formats

- ISO9660, Joliet
- Maximum title number: 512 (depending on file name length)
- Maximum album number: 255
- Supported sampling frequencies: 32 kHz, 44.1kHz, 48 kHz
- Supported Bit-rates: 32~256 (kbps), variable bit rates

11 Troubleshooting

Caution

- Never remove the casing of this apparatus.

To keep the warranty valid, never try to repair the system yourself.

If you encounter problems when using this apparatus, check the following points before requesting service. If the problem remains unsolved, go to the Philips web site (www.philips.com/welcome). When you contact Philips, ensure that the apparatus is nearby and the model number and serial number are available.

No power

- Ensure that the AC power cord of the unit is connected properly.
- Ensure that there is power at the AC outlet.
- As a power-saving feature, the system switches off automatically 15 minutes after track play reaches the end and no control is operated.

No sound or poor sound

- Adjust the volume.
- Disconnect the headphones.
- Check that the speakers are connected correctly.
- Check if the stripped speaker wires are clamped.

Left and right sound outputs reversed

- Check the speaker connections and location.

No response from the unit

- Disconnect and reconnect the AC power plug, then turn on the system again.

Remote control does not work

- Before you press any function button, first select the correct source with the remote control instead of the main unit.
- Reduce the distance between the remote control and the unit.
- Insert the battery with its polarities (+/- signs) aligned as indicated.
- Replace the battery.
- Aim the remote control directly at the sensor on the front of the unit.

No disc detected

- Insert a disc.
- Check if the disc is inserted upside down.
- Wait until the moisture condensation at the lens has cleared.
- Replace or clean the disc.
- Use a finalized CD or correct format disc.

Cannot display some files in USB device

- The number of folders or files in the USB device has exceeded a certain limit. This phenomenon is not a malfunction.
- The formats of these files are not supported.

USB device not supported

The USB device is incompatible with the unit. Try another one.

Poor radio reception

- Increase the distance between the unit and your TV or VCR.
- Fully extend the antenna.

Timer does not work

- Set the clock correctly.
- Switch on the timer.

Clock/timer setting erased

- Power has been interrupted or the power cord has been disconnected.
- Reset the clock/timer.