

Register your product and get support at
www.philips.com/welcome

Docking Speaker
DCM580



Quick start guide

- 1 Connect
- 2 Setup
- 3 Enjoy

PHILIPS

What's in the box

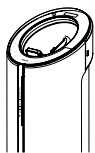

Main unit

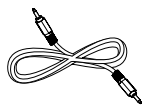

MP3 link cable

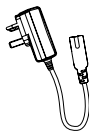

Power cord



Remote control
with battery



FM antenna



Quick start guide



User manual

1

Connect

A

Remove the protective tab

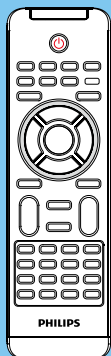

- 1 Remove the protective tab to activate the remote control battery.

1 Connect

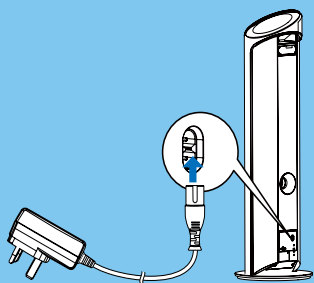

B Connect power

- 1 Connect the power cord to the **AC~MAINS** jack on the main unit.

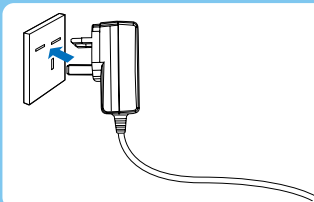

- 2 Connect the power plug to the wall outlet.

* Tip

- See the User Manual for how to connect other equipment to this system.

2 Setup

A Set the clock

- 1 In standby mode, press **PROG/CLOCK** on the remote control to activate the clock setting mode.
 - The 12 hour or 24 hour format is displayed.
- 2 Press **◀/▶** to select 12 hour or 24 hour format.
- 3 Press **PROG/CLOCK**.
 - The hour digits are displayed and begin to blink.
- 4 Press **◀/▶** to set the hour.

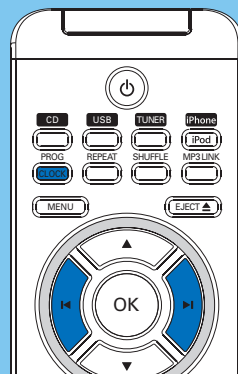

2 Setup

- 5 Press **PROG/CLOCK**.
↳ The minute digits are displayed and begin to blink.
- 6 Press **◀/▶** to set the minute.
- 7 Press **PROG/CLOCK** to confirm.

3 Enjoy

A Play disc

- 1 Press **CD** to select the disc source.
- 2 Insert a disc into the disc compartment with the printed side facing right.
↳ Play starts automatically.
 - To pause/resume play, press **▶||**.
 - To stop play, press **■**.

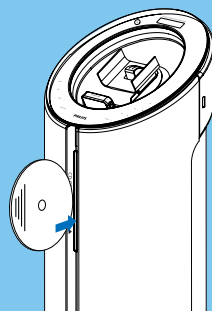

B Play from USB

≡ Note

- Ensure that the USB device contains playable audio content.
- 1 Connect the USB device into the **↔** socket.
 - 2 Press **USB** to select the USB source.
↳ The total number of tracks is displayed.
↳ Play starts automatically.
 - 3 Press **▲▼** to select a folder.
 - 4 Press **◀/▶** to select a file.

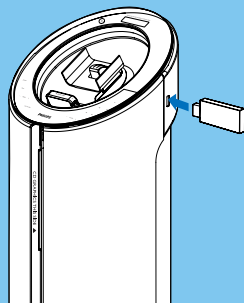

3 Enjoy

C Tune to a radio station

- 1 Press **TUNER** to select the tuner source.
- 2 Press and hold ◀▶ for more than 2 seconds.
 - ↳ [SEARCH] (search) is displayed.
 - ↳ The radio tunes to a station with strong reception automatically.
- 3 Repeat step 2 to tune to more stations.

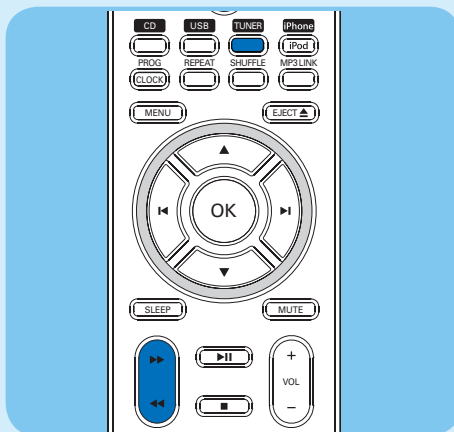

D Play iPhone/iPod

- 1 Load the iPhone/iPod in the dock.
- 2 Press **iPhone/iPod** to select iPhone/iPod source.
 - ↳ The connected iPhone/iPod plays automatically.
 - To pause/resume play, press ►||.
 - To skip to a track, press ◀▶.
 - To search during play: press and hold ◀▶, then release to resume normal play.
 - To navigate the menu: press **MENU**, press ▲/▼/◀▶ to select, then press **OK** to confirm.

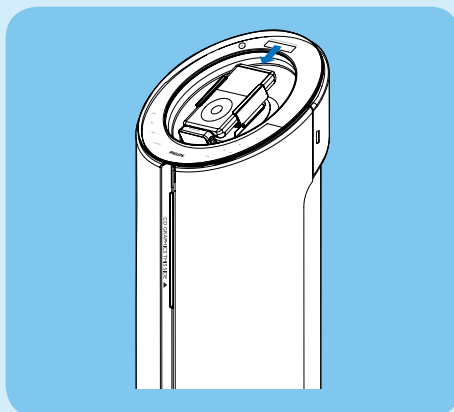

* Tip

- Detailed features and additional functions are described in the user manual.



© 2010 Koninklijke Philips Electronics N.V.
All rights reserved.

Specifications are subject to change without notice.
Trademarks are the property of Koninklijke Philips
Electronics N.V. or their respective owners.

Printed in China
DCM580_05_QSG_V1.0

