

Register your product and get support at  
[www.philips.com/welcome](http://www.philips.com/welcome)

**Immersive**  
5000 series



# Quick start guide

**PHILIPS**



**EN** Before using your product, read all accompanying safety information

**ES** Antes de usar el producto, consulte la información de seguridad que se encuentra adjunta.

**PT** Antes de usar o produto, leia todas as informações de segurança em anexo.

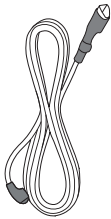
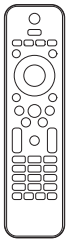

FM Antenna

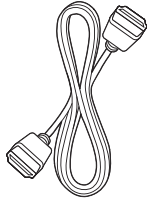

HDMI

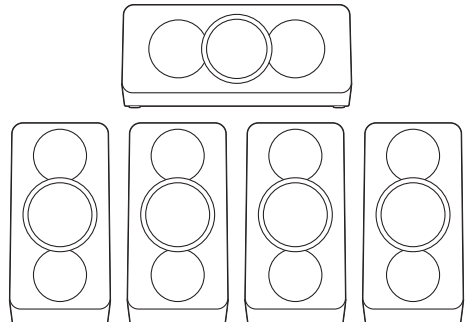
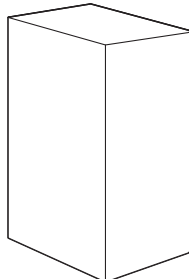
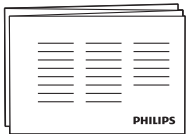
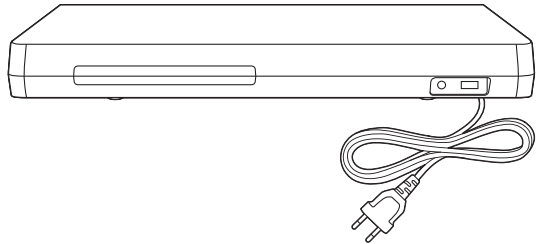

# 1

- EN** Connect the home theater
- ES** Conexión del Home Theater
- PT** Conectar o Home Theater

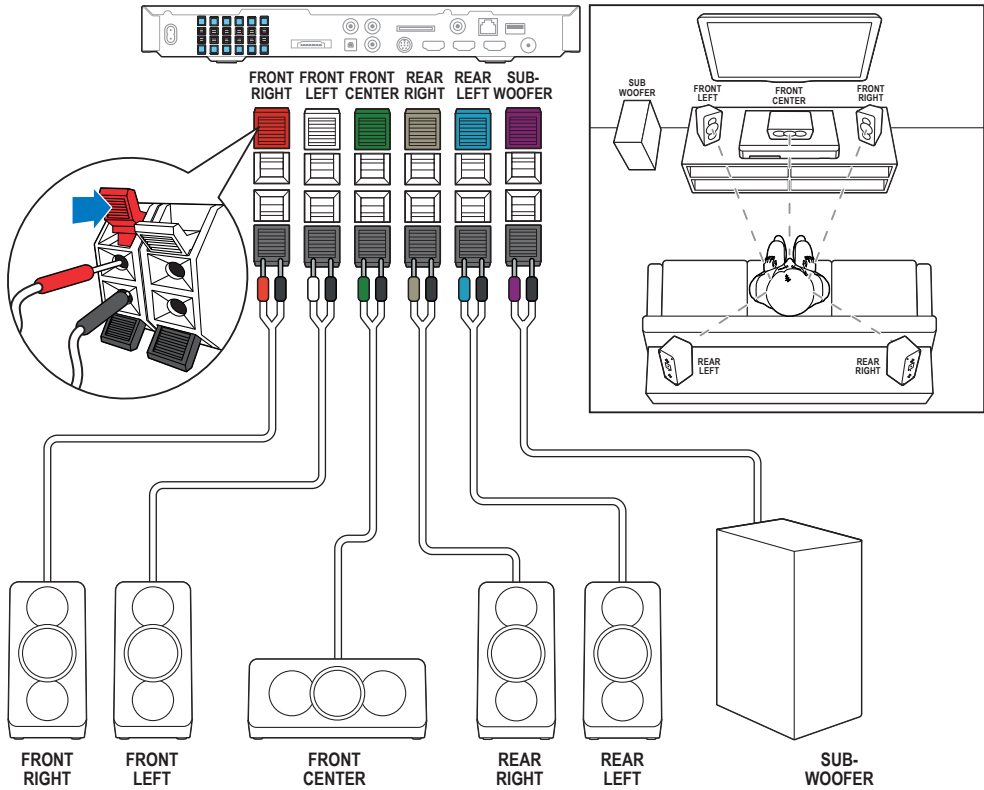

# 2

- EN** Connect to TV in one of these ways
- ES** Conecte al TV de alguna de las siguientes maneras
- PT** Conecte à TV de uma destas maneiras

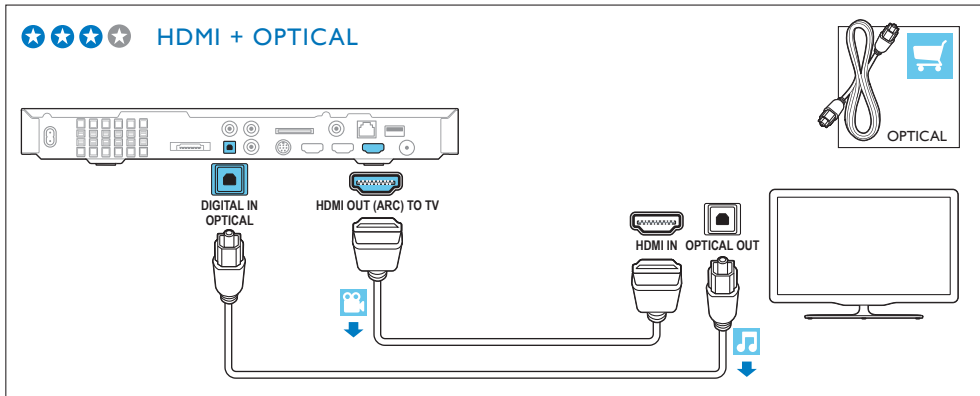
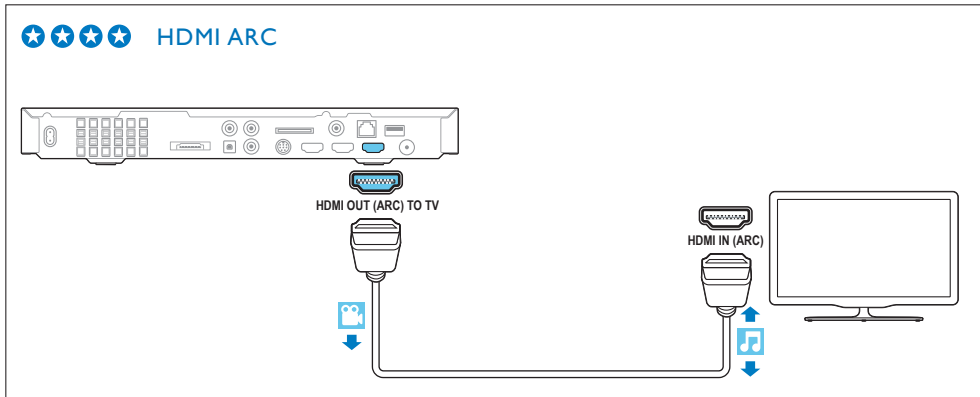

★ ★ ★ ★ HDMI + COAXIAL



DIGITAL IN  
COAXIAL

HDMI OUT (ARC) TO TV



HDMI IN

COAXIAL OUT

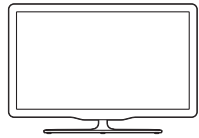

★ ★ ★ ★ HDMI + AUDIO L/R



L  
R  
AUDIO IN

HDMI OUT (ARC) TO TV

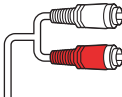

L  
R  
HDMI IN

L  
R  
AUDIO OUT

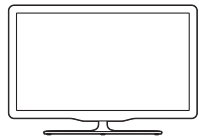

# 3

- EN** Switch on the home theater
- ES** Encendido del Home Theater
- PT** Ligar o Home Theater

1

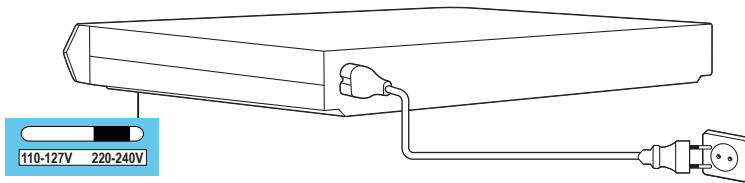

2

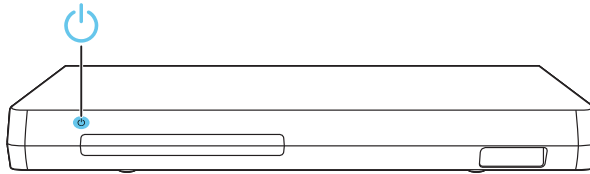

3

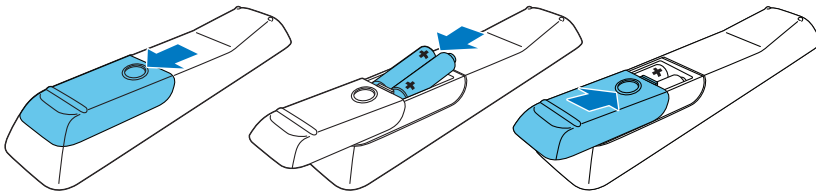

# 4

- EN** Complete the first time setup
- ES** Proceso de configuración inicial
- PT** Fazer a configuração inicial

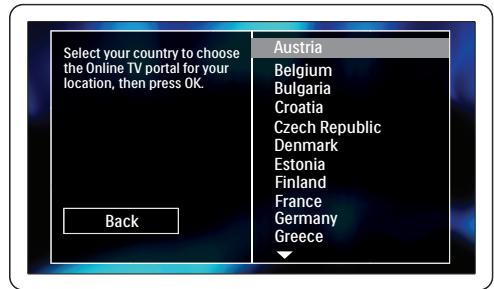
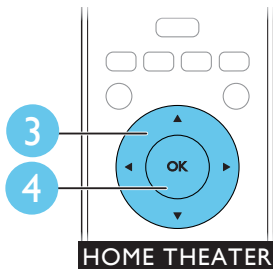
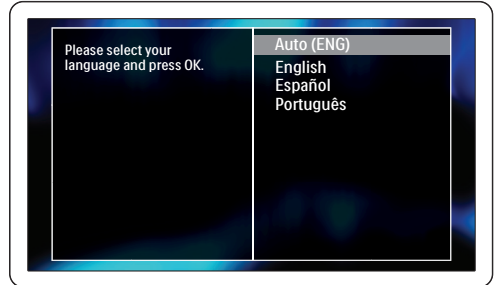
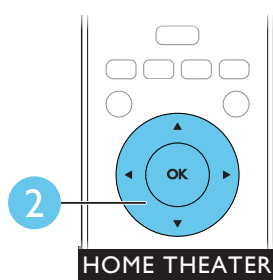
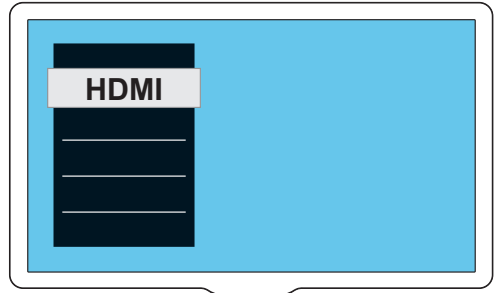
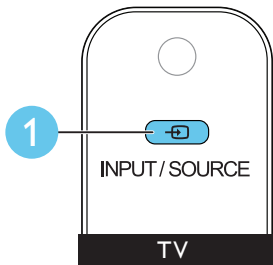

# 5

**EN** Need help with your product? Select Help to access the onscreen user manual

**ES** ¿Necesita ayuda con su producto? Seleccione Ayuda para acceder al manual del usuario en pantalla

**PT** Precisa de ajuda com o produto? Clique na ajuda para ter acesso ao manual do usuário na tela

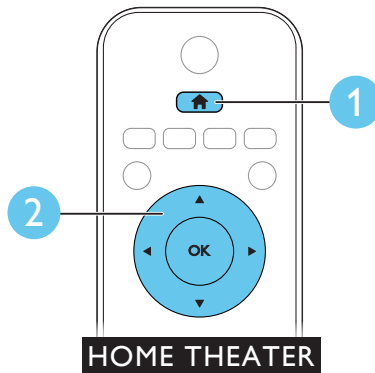



# 6

**EN** Use your home theater

**ES** Uso del sistema de Home Theater

**PT** Usar o Home Theater

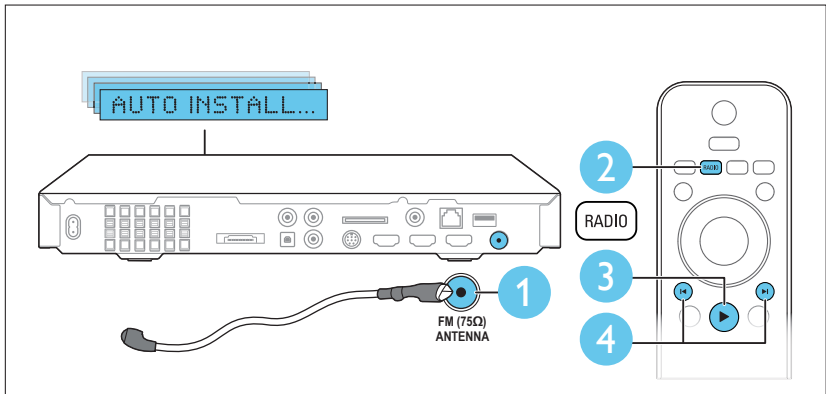
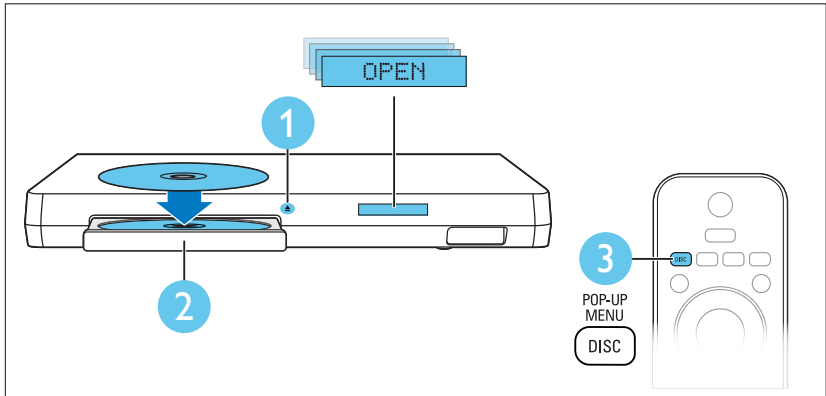

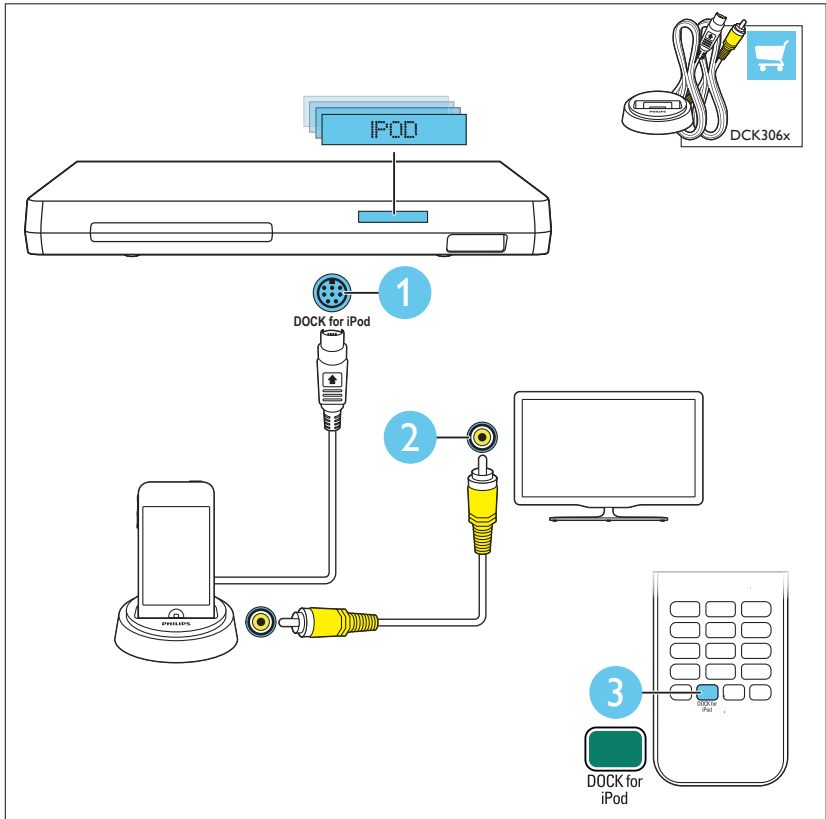
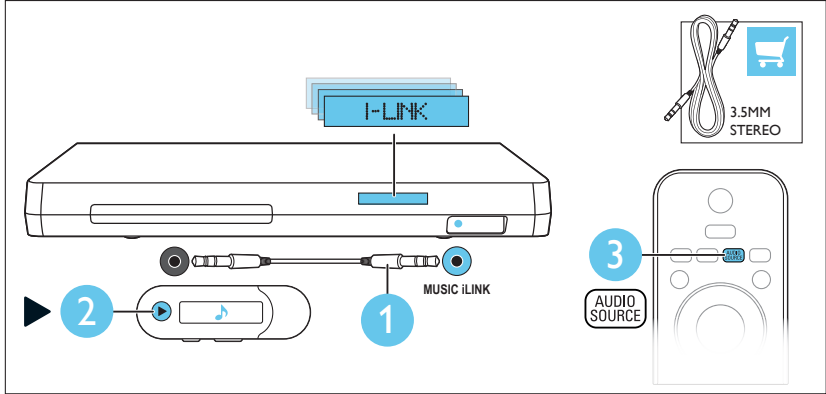

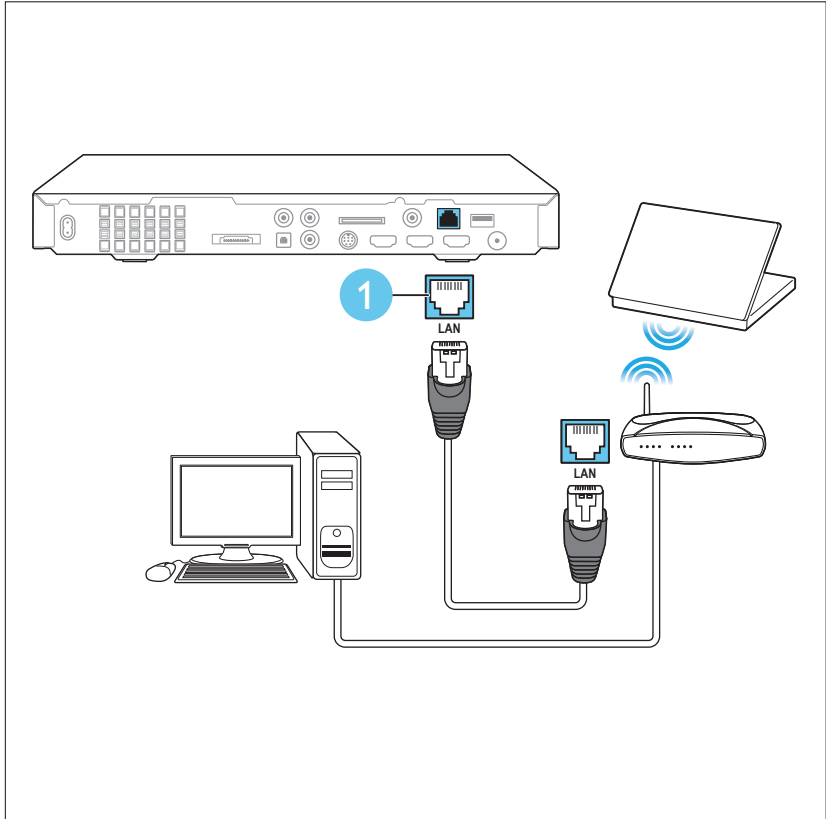
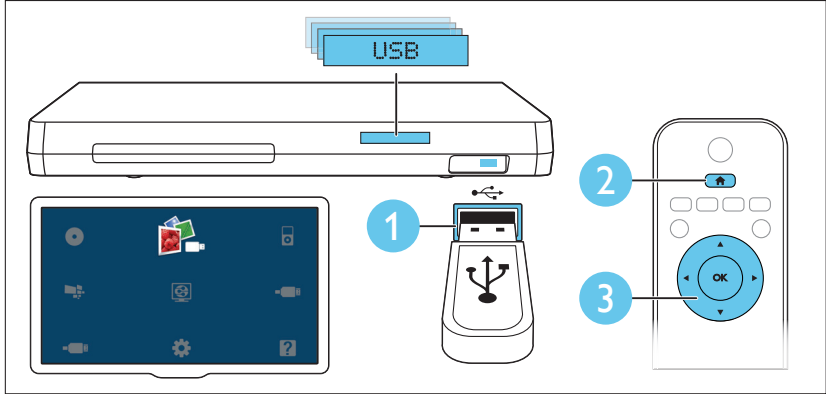
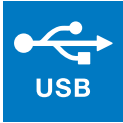



- EN** For sustainability, the user manual is not printed and available in your product as onscreen help. A printable user manual as well as product updates is available from [www.philips.com/support](http://www.philips.com/support).
- ES** Por motivos de sostenibilidad, el manual de usuario no está en formato impreso, aunque puede verlo en formato de ayuda en pantalla en el propio producto. En [www.philips.com/support](http://www.philips.com/support), puede acceder a un manual de usuario en formato preparado para impresión y también a actualizaciones del producto.

- PT** Por motivos de sustentabilidade, o manual de utilizador não está disponível na versão impressa, mas sim como ajuda no ecrã. Um manual de utilizador imprimível, bem como actualizações do produto, encontra-se disponível a partir do site [www.philips.com/support](http://www.philips.com/support).



[www.philips.com/support](http://www.philips.com/support)



Non-contractual images. / Images non contractuelles. / Außervertragliche Bilder.

All registered and unregistered trademarks are property of their respective owners.

Specifications are subject to change without notice  
Trademarks are the property of Koninklijke Philips Electronics N.V. or their respective owners  
2012 © Koninklijke Philips Electronics N.V. All rights reserved  
[www.philips.com](http://www.philips.com)  
sgsn\_1152/78\_v2

Evite o uso prolongado do aparelho com volume superior a 85 decibéis, pois isto poderá prejudicar a sua audição.  
Potência total de saída de 800W RMS, (+/- 0.5 dB, 10% THD)



Be responsible  
Respect copyrights

