

Always there to help you

Register your product and get support at
www.philips.com/welcome



CVR500



User manual

1

用户手册

13

使用手册

27

PHILIPS

Contents

1 Important	2
Safety	2
Notice	2

2 Your car driving recorder	4
Introduction	4
What's in the box	4
Overview of the main unit	5

3 Get started	6
Install the driving recorder	6
Insert Micro SD card	7
Turn on the driving recorder	7
For the first time use	7
Mode switch	7

4 Video Recording	8
Loop recording	8
Secure record	8

5 Photo capture	9
------------------------	---

6 Playback	9
Video playback	9
Photo playback	10

7 Settings	10
Video/Photo Settings	10
Other settings	11
Connect the driving recorder to a computer	11

8 Product information	12
General	12

1 Important

Safety

- Read and understand all instructions before you use your apparatus. If damage is caused by failure to follow instructions, the warranty does not apply.
- Use only the supplied mounting hardware for a safe and secure installation.
- Only use attachments/accessories specified by the manufacturer.
- To avoid short circuit, do not expose the apparatus to rain or water.
- Never insert objects into the ventilation slots or other openings on the apparatus.
- Clean the apparatus and frame with a soft, damp cloth. Never use substances such as alcohol, chemicals or household cleaners on the apparatus.
- Risk of damage to the apparatus screen! Never touch, push, rub or strike the screen with any object.
- Batteries (battery pack or batteries installed) shall not be exposed to excessive heat such as sunshine, fire or the like.
- Danger of explosion if battery is incorrectly replaced. Replace only with the same or equivalent type.
- For your own safety, do not operate the device while driving.
- Do not install the device in the position that blocks the driver's sight or affects the work of the airbags.
- To void accident caused by exhaust of car battery, disconnect the car charger before leaving the car for the users whose car cigarette lighter keeps power supplying after the engine is stopped.
- When the car engine is stopped or the power is shut down, the device still can save the recording files with its built-in battery power; do not remove the micro

SD card during the period to prevent data loss.

- The apparatus shall not be exposed to dripping or splashing.
- Do not place any sources of danger on the apparatus (e.g. liquid filled objects, lighted candles).

Notice

Any changes or modifications made to this device that are not expressly approved by WOOX Innovations may void the user's authority to operate the equipment.

Environmental information

All unnecessary packaging has been omitted. We have tried to make the packaging easy to separate into three materials: cardboard (box), polystyrene foam (buffer) and polyethylene (bags, protective foam sheet.)

Your system consists of materials which can be recycled and reused if disassembled by a specialized company. Please observe the local regulations regarding the disposal of packaging materials, exhausted batteries and old equipment.

Disposal of your old product and batteries

Your product is designed and manufactured with high quality materials and components, which can be recycled and reused.

Never dispose of your product with other household waste. Please inform yourself about the local rules on the separate collection of electrical and electronic products and batteries. The correct disposal of these products helps prevent potentially negative consequences on the environment and human health.

Your product contains batteries, which cannot be disposed of with normal household waste.

Please inform yourself about the local rules on separate collection of batteries. The correct

disposal of batteries helps prevent potentially negative consequences on the environment and human health.

Please visit www.recycle.philips.com for additional information on a recycling center in your area.

Always bring your product to a professional to remove the built-in battery.

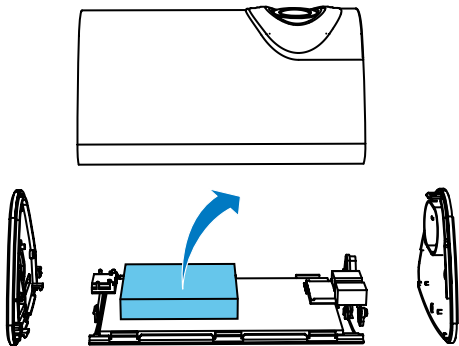

2013 © WOOX Innovations Limited. All rights reserved.

Specifications are subject to change without notice. WOOX reserves the right to change products at any time without being obliged to adjust earlier supplies accordingly.

2 Your car driving recorder

Congratulations on your purchase, and welcome to Philips! To fully benefit from the support that Philips offers, register your product at www.philips.com/welcome.

Introduction

With the car driving recorder, you can:

- Record videos automatically when you are driving
- Take photos
- Play back videos/photos

What's in the box

Check and identify the contents of your package:

- ① Driving recorder
- ② Suction bracket
- ③ Car charger
- ④ mini USB cable
- ⑤ User Manual

Overview of the main unit

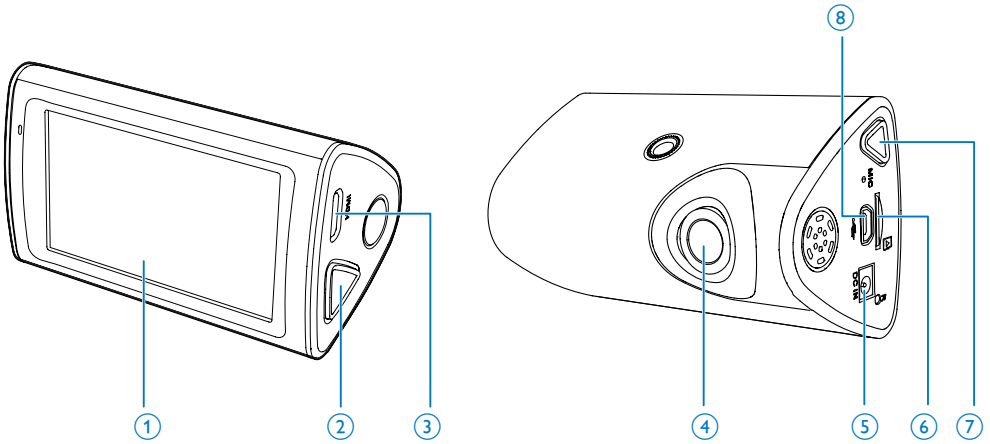

- ① LCD touch screen
- ② Secure Record
- ③ mini HDMI socket
- ④ Camera Lens
- ⑤ DC socket
- ⑥ Micro SD card slot
- ⑦  Power key
- ⑧ Mini USB socket

3 Get started

Install the driving recorder

! Caution

- Do not place the driving recorder in locations where it may block the driver's view or affect the operation of airbags.

☰ Note

- In order to get clear images, if there is any smudginess on the windshield, please clean it before installing.

- 1 Connect the driving recorder with the suction bracket as below:

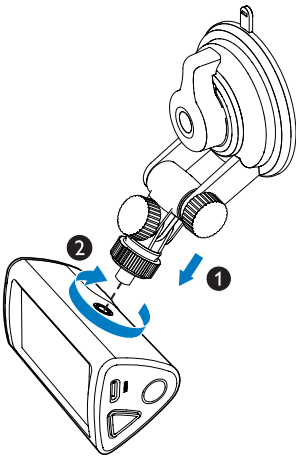

- 2 Wipe clean the windshield.

- 3 Remove the protective cover of the suction bracket and rotate the fix button of suction.

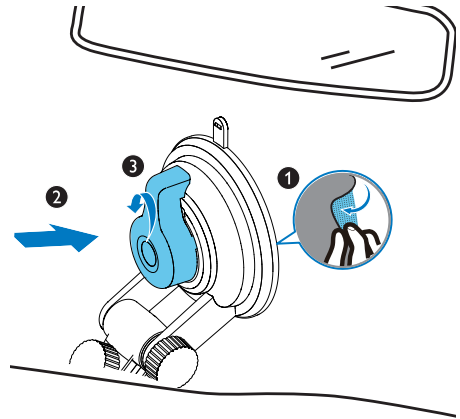

- 4 Connect the USB cable to:
 - The mini USB socket of the driving recorder
 - The cigarette lighter socket of the car

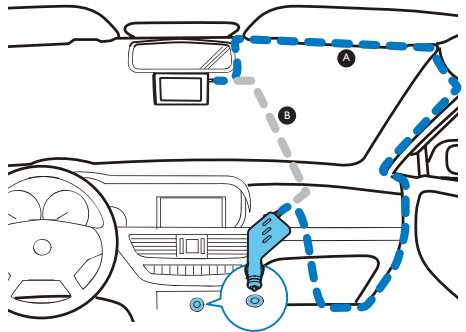

Insert Micro SD card

! Caution

- Insert the micro SD card before using the driving recorder.
- Insert the micro SD card with the right direction. Wrong direction may damage the driving recorder and the card.

☰ Note

- When using for the first time, please format the micro SD card by tapping "Settings" - "Format" to ensure videos are recorded normally.

Insert a micro SD card into the card slot until you hear a "click".

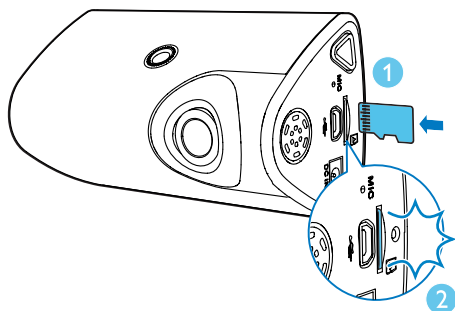

- **To remove the micro SD card**

Push the card inwards until you hear a "click".

↳ The card is disengaged.

Turn on the driving recorder

Press \odot to turn on the driving recorder.

- To turn off the driving recorder, press and hold \odot for more than 3 seconds.

☰ Note

- When using for the first time, please set the date/time by tapping **Settings** - **Clock**.

For the first time use

After the driving recorder is turned on, set the language and format the micro SD card.

Select language

- 1 Tap **[Settings]** to enter the setting menu.
- 2 Tap \blacktriangle / \blacktriangledown to select the language setting menu.
- 3 Tap **OK** to enter the menu.

Format SD card

- 1 Tap **[Settings]** to enter the setting menu.
- 2 Tap \blacktriangle / \blacktriangledown to select the format SD card menu.
- 3 Tap **OK** to enter the menu, and tap **YES** to format the micro SD card.

Mode switch

Tap \square to switch mode: Video recording mode and photo capture mode.

4 Video Recording

When the driving recording is turned on, video recording starts automatically.

Video recording screen:



- ① Secure Record
- ② Playback mode: view emergency record, view last record, view photos
- ③ System settings
- ④ Turn off the LCD screen
- ⑤ Switch between video recording mode and photo capture mode
- ⑥ Recorded emergency video numbers/ total emergency video numbers

Loop recording

When the driving recorder is powered on or you enter the video recording mode, video recording starts automatically. When the recording starts, ● blinks and recording time is displayed on screen.

The driving recorder can record video files in a specified time frame (You can set the record time by tapping **[Settings]** - **[Record Time]**). The number of files is dependant on the size of the

memory card. The first recorded video will be overwritten when the micro SD card is full.

Note

- The driving recorder will continue running for a while after the engine is shut down to protect last recorded file.
- When recording videos, you can turn the sound record on or off in **[Settings]** - **[Voice Recorder]**.
- For safety reasons the built-in battery will stop charging if the device remains at a high-temperature for period of time. If the built-in battery runs out of power you will need to reset the date and time.

Secure record



When there is an important file to be recorded, tap ▲ to enter secure recording mode to prevent file from being overwritten.

- ↳ The present file and the previous file are recorded to the secure recording file.
- ↳ When saving the file, on the screen will become 📷.

Note

- You can save a maximum of five groups (ten files) in the secure recording files.

5 Photo capture

In photo capture mode, tap  or press  to take photos.



6 Playback

Tap **[Play]** to enter playback mode.

Video playback

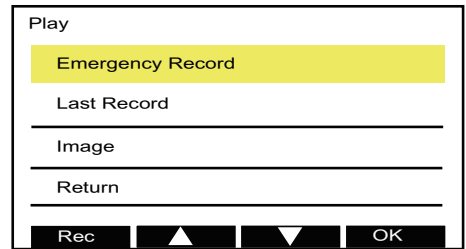
- 1 In video recording mode or photo capture mode, tap **[Play]**.



- 2 Tap  /  to select **[Emergency Record]** or **[Last Record]**.

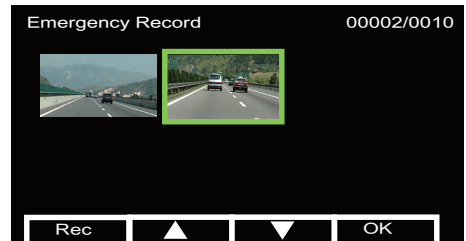



- 3 Tap  /  to select a video and tap **[OK]** to start video playback.
 - Tap **[REC]** to return to the video recording mode.
 - During playback, you can pause/restart the video, or delete the video.

Photo playback

- 1 In video recording mode or photo capture mode, tap **[Play]**.



- 2 Tap ▲ / ▼ to select **[Image]**.

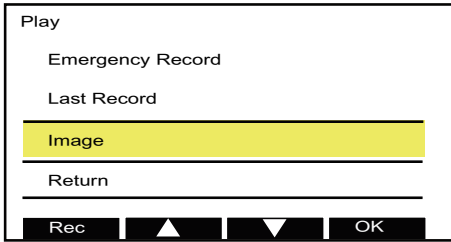
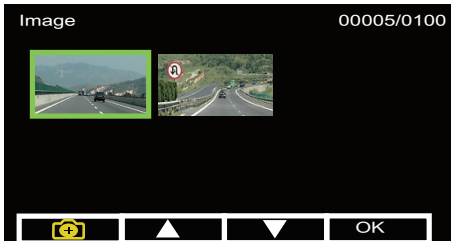

- 3 Tap ▲ / ▼ to select a photo and tap **[OK]** to view the photo.



- Tap **[+]** to return to photo capture mode.
- During photo playback, you can view the photo, or delete the photo.

7 Settings

- 1 In video recording mode for photo capture mode, tap **[Settings]** to enter the system setting menu.
- 2 Tap ▲ / ▼ to select the menu you want to set.
- 3 Tap **[OK]** to enter the menu.

Video/Photo Settings

In video recording mode:

- **[Video Resolution]**
 - **[FHD 1080P (30FPS)]**
 - **[HD 720P (60fps)]**
- **[Record Time]**
 - **[Off]**
 - **[3 Min]**
 - **[5 Min]**
 - **[10 Min]**
- **[Motion Detection]**
 - **[Enable]**
 - **[Disable]**

In photo capture mode:

- **[Video Resolution]**
 - **[16M (4608X3456)]**
 - **[12M (4032X3024)]**
 - **[8M (3264X2448)]**
 - **[5M (2560X1920)]**
 - **[3M (2048X1536)]**

Other settings

Trough the system setting menu, you can adjust language ,date/time, and other settings.

[Date Stamp]

- [On]
- [Off]

[Clock]

[Voice Recorder]

- [On]
- [Off]

[LCD Off]

- [1 Min]
- [3 Min]
- [5 Min]
- [Always ON]

[Warning Beep]

- [On]
- [Off]

[Language]

- [English]
- [Simplified Chinese]
- [Traditional Chinese]

[Volume]

- [Off]
- [20%]
- [40%]
- [60%]
- [80%]
- [100%]

[Default]

- [Yes]
- [No]

[Format]

- [Yes]
- [No]

[FW Upgrade]

- [Yes]
- [No]

Connect the driving recorder to a computer

When the driving recorder is connected to a computer, the micro SD card will be automatically recognized. You can then copy videos or photos from the micro SD card to your computer.

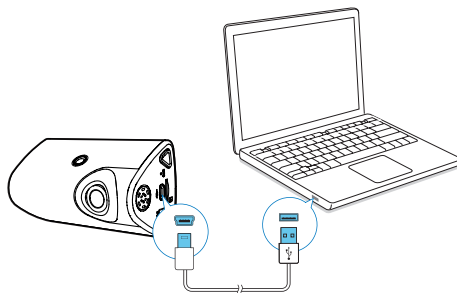

8 Product information



Note

- Product information is subject to change without prior notice.

General

Battery	Rechargeable lithium battery (Designed for last data backup purpose only, not for normally video recording)
Power supply	Car charger (input: DC 12V - 24V, output: DC 5.5V)
LCD screen	3.0 inch touch screen
Lens	115° wide angle
Video	Full HD (1920 × 1080p) 30FPS HD (1280 × 720p) 60FPS
Video format	MP4 (H.264)
External memory	Micro SD card class 6, or higher (up to 32GB)
Connection socket	USB 2.0/mini HDMI
Microphone/Speaker	Built-in
Storage humidity	20 % - 85%
Storage temperature	-20 °C - 70 °C
Working temperature	-20 °C - 60 °C
Dimensions	
- Driving recorder (W × H × D)	88.8 × 54.0 × 46.0 mm
- Suction bracket (Diameter × Height)	70.0 × 86.0 mm
Weight	
- Driving recorder (W × H × D)	111.0 g
- Suction bracket (Diameter × Height)	73.0 g



Specifications are subject to change without notice

2013 © WOOX Innovations Limited. All rights reserved.

This product was brought to the market by WOOX Innovations Limited or one of its affiliates, further referred to in this document as WOOX Innovations, and is the manufacturer of the product. WOOX Innovations is the warrantor in relation to the product with which this booklet was packaged. Philips and the Philips Shield Emblem are registered trademarks of Koninklijke Philips N.V.™

CVR500_93_UM_V1.0

