

Register your product and get support at

www.philips.com/welcome

User manual

คู่มือผู้ใช้



PHILIPS



Manufactured under license from Dolby Laboratories. Dolby and the double-D symbol are trademarks of Dolby Laboratories.

This product incorporates copyright protection technology that is protected by method claims of certain U.S. patents and other intellectual property rights owned by Macrovision Corporation and other rights owners. Use of this copyright protection technology must be authorized by Macrovision Corporation, and is intended for home and other limited viewing uses only unless otherwise authorized by Macrovision Corporation. Reverse engineering or disassembly is prohibited.

English 7

ไทย 25

English

ไทย

CAUTION

Use of controls or adjustments or performance of procedures other than herein may result in hazardous radiation exposure or other unsafe operation.

General Information

Supplied accessories	4
Safety information	4
Maintenance	4
Environment information	4

Connections

Step 1: Placing speakers and subwoofer	5
Step 2: Connecting speakers and subwoofer ..	5
Step 3: Connecting TV set	6
Using Video in jack (CVBS)	
Using an accessory RF modulator	
Step 4: Connecting the power cord	7

Functional Overview

Controls on the system	8
Remote control	9

Getting Started

Step 1: Using the Remote Control	10
Step 2: Setting up the TV	10~11
Selecting the color system that matches your TV set	
Step 3: Setting language preference	11
Setting the Language	

Disc Operations

Playable Discs	12
Region Codes	12
Playing discs	12
Using the Disc Menu	12~13
Using PBC feature (available for 2.0 version VCD only)	
Resuming playback.....	13
Selecting and searching	13
Selecting a different track/chapter	
Fast forwarding/reversing	
Slow forwarding/reversing	
Volume control	13
Display Dim	13
Different play modes:	14
REPEAT	
REPEAT A-B	
Viewing the disc playback information	14
Viewing from another angle	15
ZOOM	15
AUDIO	15

SUBTITLE	15
Playing MP3/Picture disc(JPEG, Kodak) ...	15~16
Playing an MP3 disc	
Playing a JPEG file (slide show)	
Playing a Kodak picture CD	

DVD MENU Operations

Using the System Setup menu options ...	17~18
Setting the TV TYPE	
Changing the password	
restricting playback by setting rating level	
Default	
Using the Audio Setup menu option	19
Dynamic Range	
Using the Speaker Setup menu option	19

Specifications 20

Troubleshooting 21~22

Glossary 23

Congratulations on your purchase and welcome to Philips!

To fully benefit from the support that Philips offers, register your product at www.philips.com/welcome.

Supplied accessories

- Remote control
- Composite video cable (yellow)
- Audio cables (white/red)
- User Manual and Quick Start Guide

Safety information

- The standby switch does not disconnect the apparatus from mains.
- Where the MAINS plug or an appliance coupler is used as the disconnect device, the disconnect device shall remain readily operable.
- Place the system on a flat, hard and stable surface.
- The apparatus shall not be exposed to dripping or splashing.
- Install the unit near the AC outlet and where the AC power plug can be easily reached.
- Place the system in a location with adequate ventilation to prevent internal heat build-up in your system. Allow at least 10 cm (4 inches) clearance from the rear and the top of the unit and 5 cm (2 inches) from each side.
- The ventilation should not be impeded by covering the ventilation openings with items, such as newspapers, table-cloths, curtains, etc.
- Do not expose the system, batteries or discs to excessive moisture, rain, sand or heat sources caused by heating equipment or direct sunlight.
- No naked flame sources, such as lighted candles, should be placed on the apparatus.
- No objects filled with liquids, such as vases, shall be placed on the apparatus.
- If the system is brought directly from a cold to a warm location, or is placed in a very damp room, moisture may condense on the lens of the disc unit inside the system. Should this occur, the CD player would not operate normally. Leave the power on for about one hour with no disc in the system until normal playback is possible.

- The mechanical parts of the set contain self-lubricating bearings and must not be oiled or lubricated.
- **When the system is switched to Standby mode, it is still consuming some power. To disconnect the system from the power supply completely, remove the AC power plug from the wall socket.**

Maintenance

- When a disc becomes dirty, clean it with a cleaning cloth. Wipe the disc from the center out, in a straight line.
- Do not expose the player, batteries or discs to humidity, rain, sand or excessive heat (caused by heating equipment or direct sunlight). Always keep the disc tray closed to avoid dust on the lens.
- Do not use solvents such as benzene, thinner, commercially available cleaners, or anti-static spray intended for colour discs.
- The lens may cloud over when the player is suddenly moved from cold to warm surroundings, making it impossible to play a disc. Leave the player in the warm environment until the moisture evaporates.

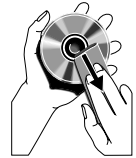

Environmental information

All unnecessary packaging has been omitted. We have tried to make the packaging easy to separate into three materials: cardboard (box), polystyrene foam (buffer) and polyethylene (bags, protective foam sheet).

Your system consists of materials which can be recycled and reused if disassembled by a specialised company. Please observe the local regulations regarding the disposal of packaging materials, exhausted batteries and old equipment.

IMPORTANT!

- The type plate is located at the bottom of the system.
- The voltage selector located on the rear of the subwoofer is preset at 220V-240V from the factory. For countries that operate at 110V-127V, please adjust to 110V-127V before you switch on the system.
- Before connecting the AC power cord to the wall outlet, ensure that all other connections have been made.
- Never make or change any connections with the power switched on.
- A separate power switch is provided on the front of the subwoofer. Please switch it on after completing all connections in order to enjoy 2.1-channel sound output.

Step 1: Placing speakers and subwoofer

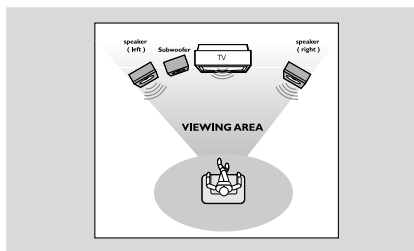

For best possible surround sound, locate your speakers and subwoofer as follows:

- Place the left and right speakers at equal distances from the TV set and at an angle of approximately 45 degrees from the listening position.
- Place the subwoofer on the floor near the TV.

Notes:

- To avoid magnetic interference, do not position the front speakers too close to your TV set.
- Allow adequate ventilation around the DVD System.

Step 2: Connecting speakers and subwoofer

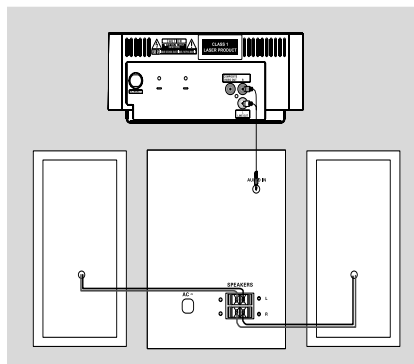

- 1 Connect the supplied audio cables to DVD player's **LINE OUT (L/R)** jacks and the Subwoofer's **AUDIO IN** jack.
- 2 Connect the speaker wires to the **SPEAKER** terminals on the subwoofer; right speaker to "R" and left speaker to "L", coloured (marked) wire to "+" and black (unmarked) wire to "-".

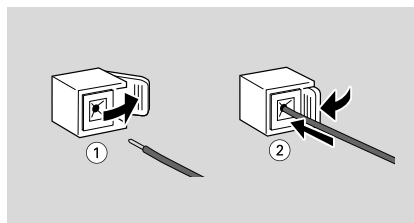

- Fully insert the stripped portion of the speaker wire into the terminal as shown.

Notes:

- Ensure that the speaker cables are correctly connected. Improper connections may damage the system due to short-circuit.
- For optimal sound performance, use the supplied speakers.
- Do not connect more than one speaker to any one pair of +/- speaker terminals.
- Do not connect speakers with an impedance lower than the speakers supplied. Please refer to the SPECIFICATIONS section of this manual.

Step 3: Connecting TV set

IMPORTANT!

- You only need to make one video connection from the following options, according to the capabilities of your TV system.
- Connect the system directly to the TV set.

Using Video In jack (CVBS)

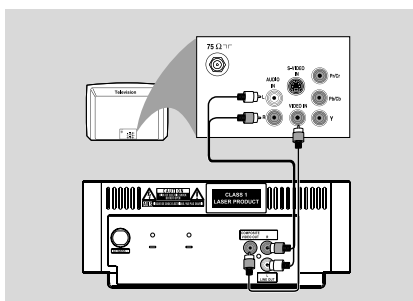

- Use the supplied composite video cable (yellow) to connect the system's COMPOSITE VIDEO jack to the video input jack (or labeled as A/V In, Video In, Composite or Baseband) on the TV set.
- To listen to disc playback of the system through the TV, use the audio cables (white/red) to connect **LINE OUT (L/R)** jacks to the corresponding **AUDIO IN** jacks on the TV set.

Using an accessory RF modulator

IMPORTANT!

- If your TV set only has a single Antenna In jack (or labeled as 75 ohm or RF In), you will need a RF modulator in order to view the DVD playback via TV. See your electronics retailer or contact Philips for details on RF modulator availability and operations.

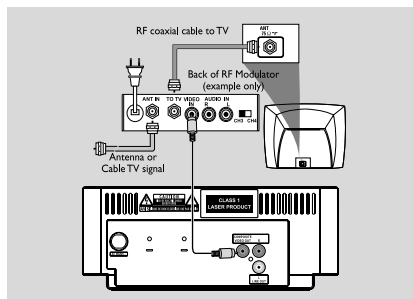

- Use the supplied composite cable (yellow) to connect the system's COMPOSITE VIDEO jack to the video input jack on the RF modulator.
- Use the RF coaxial cable (not supplied) to connect the RF modulator to your TV's RF jack.

Step 4: Connecting the power cord

IMPORTANT!

- Never make or change any connection with the power switched on.

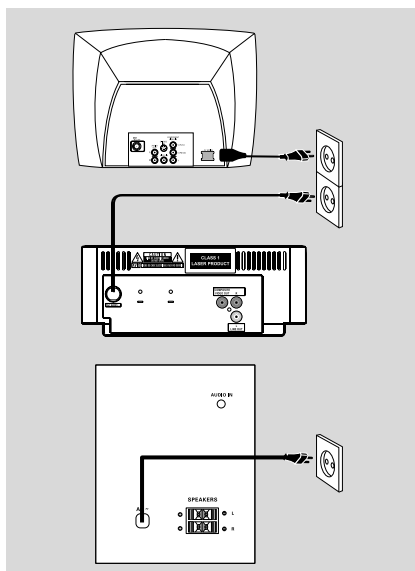

- After everything is connected properly, plug in the AC power cords of the main set, subwoofer and TV set to the power outlet.
- Make sure to turn on the power switch on the front of the subwoofer in order to enjoy 2.1-channel output.

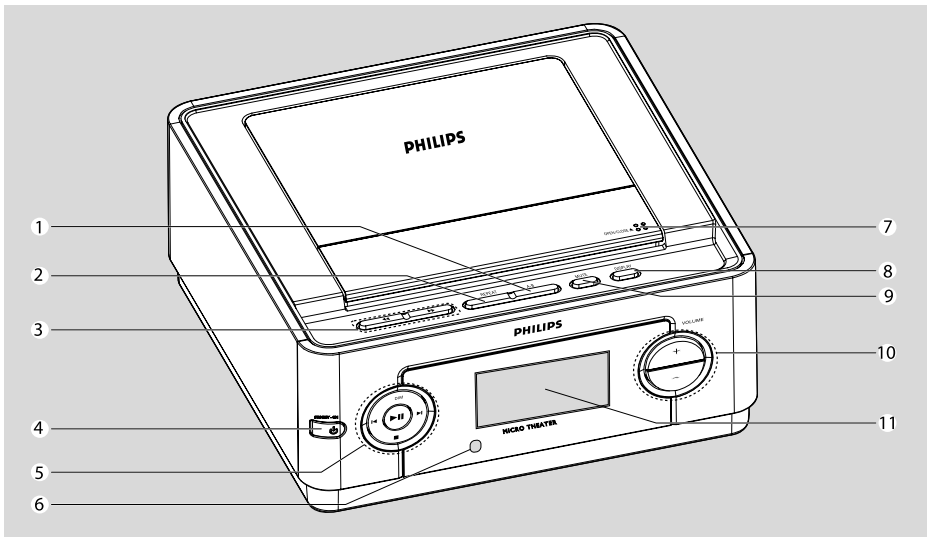

Controls on the system

1 A-B

- repeats playback of a specific section within a chapter or a track.

2 REPEAT

- selects various repeat modes.

3 ◀◀ / ▶▶

- fast searches backward/forward in a disc at different speeds.

4 STANDBY-ON ⏻

- switches the system on or to standby mode.

5 ▶||

- starts or interrupts disc playback

DIM

- selects different levels of brightness for display panel.

◀ / ▶

- press to skip to the previous/next chapter/title/track.



- stops disc playback.

6 iR Sensor

- point the remote control towards this sensor.

7 OPEN/CLOSE ▲

- opens or closes the disc door.

8 DISPLAY

- displays the current status and or disc information.

9 MUTE

- disables or enables sound output.

10 VOLUME +/-

- adjusts the volume upward/downward.

11 Display panel

- shows the current status of the DVD player.

Functional Overview

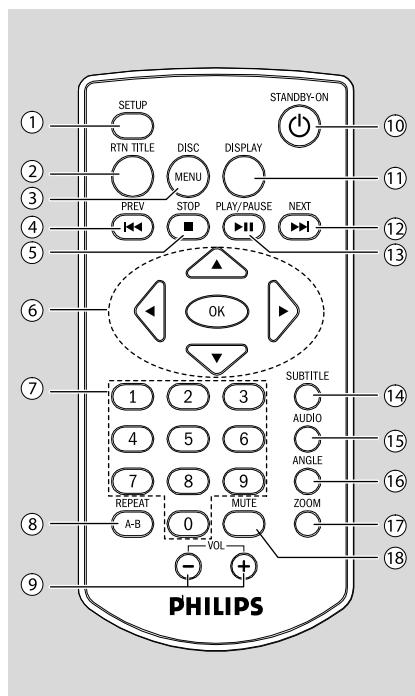

- ⑦ **Numeric Keypad (0-9)**
 - inputs a track/title/chapter number of the disc.
- ⑧ **REPEAT A-B**
 - selects various repeat mode, or
 - repeats playback of a specific section within a chapter or a track.
- ⑨ **VOL +/-**
 - adjusts the volume upward/downward.
- ⑩ **STANDBY-ON**
 - switches the system on or to standby mode.
- ⑪ **DISPLAY**
 - displays the current status and or disc information.
- ⑫ **NEXT**
 - skips to the next chapter/title/track.
 - hold to fast searches forward in a disc at different speeds.
- ⑬ **PLAY/PAUSE**
 - starts or interrupts disc playback.
- ⑭ **SUBTITLE**
 - for DVD, selects a subtitle language.
- ⑮ **AUDIO**
 - selects an audio language(DVD/VCD) or an audio channel
- ⑯ **ANGLE**
 - for DVD, view the same scene from different angels.
- ⑰ **ZOOM**
 - zoom in or out the picture.
- ⑱ **MUTE**
 - disables or enables sound output.

Remote Control

- ① **SETUP**
 - enters or exits the system menu.
- ② **RTN TITLE**
 - to go back to previous menu/show title menu.
- ③ **DISC MENU**
 - for DVD, enters or exits disc contents menu.
 - for VCD/SVCD, toggle between PBC ON or OFF.
- ④ **PREV**
 - skips to the previous chapter/title/track.
 - hold to fast searches backward in a disc at different speeds.
- ⑤ **STOP**
 - stops disc playback.
- ⑥ **OK**
 - confirms a selection.
 - selects an item in a menu.
 - moves an enlarged picture down/up/left/right.
 - select the slow speed.

Step 1: Using the Remote Control

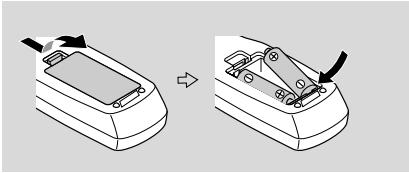

1. Open the battery compartment.
2. Insert two batteries type AAA (not supplied), following the indications (+/-) inside the compartment.
3. Close the cover.

CAUTION!

- Remove batteries if they are exhausted or if the remote is not to be used for a long time.
- Do not use old and new or different types of batteries in combination.
- Batteries contain chemical substances, so they should be disposed of properly.

Using the Remote Control to operate the Player

1. Aim the Remote Control directly at the remote sensor (IR) on the front panel.
2. Do not put any objects between the remote control and the DVD player while operating the DVD player:

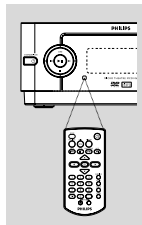

Step 2: Setting up the TV

IMPORTANT!

Make sure you have completed all the necessary connections. (See “Connecting TV”).

1. Press **STANDBY-ON**  on the DVD player to turn it on.
2. Turn on the TV and set to the correct video-in channel. You should see the blue Philips DVD background screen on the TV.
 - Usually these channels are between the lowest and highest channels and may be called FRONT, A/V IN, or VIDEO. See your TV manual for more details.
 - Or, you may go to channel 1 on your TV, then press the Channel up button repeatedly until you see the Video In channel.
 - Or, set the TV to channel 3 or 4 if you are using an RF modulator.

Getting Started

Selecting the color system that matches your TV set

This DVD player is compatible with both NTSC and PAL. For the playback of a DVD disc on this DVD player, the color systems of the DVD, TV set and DVD player should match.

1. Press **SETUP**.
2. Press **▼** to select **TV SYSTEM** in System Setup Page, then press **►**.

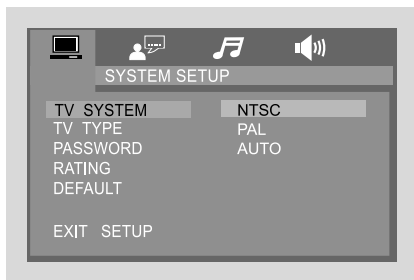

3. Press **▼** / **▲** to select one of the options below:

NTSC

– Select this if the connected TV set is NTSC system. It will change the video signal of a PAL video disc and output to NTSC system.

PAL

– Select this if the connected TV set is PAL system. It will change the video signal of an NTSC disc and output to PAL format.

AUTO

– Select this if the connected TV set is compatible with both NTSC and PAL (multi system). The output format will be consistent with the video signal of the disc.

4. Select an item and press **OK**.

To remove the menu

Press **SETUP**.

Step 3: Setting language preference

You can select your own preferred language settings. This DVD player will automatically switch to the selected language whenever you load a disc. If the language selected is not available on the disc, the disc's default language will be used instead. The OSD language in the system menu will remain once selected.

Setting the Language

1. Press **SETUP**.
2. Press **◀** / **▶** keys on the remote control to select Language Setup page, then press **▼**.



3. Press **▼** / **▲** keys to highlight one of the options below, then press **►**.

OSD LANGUAGE

– Select this to change the language of this DVD player screen display menu. The menu language (on-screen display) for the system will remain as you set it.

AUDIO LANG

– Select this to change disc soundtrack language (also see page 16)

SUBTITLE LANG

– Select this to change the subtitle language (also see page 16)

MENU LANG

– Select this to change the language of the disc menu.

4. Press **▼** / **▲** keys to select a language and press **OK**.
5. Repeat step 3 - 4 for other language settings.

To remove the menu

Press **SETUP**.

IMPORTANT!

- Depending on the DVD or VIDEO CD, some operations may be different or restricted.
- If the “INVALID KEY” appears on the TV screen when a button is pressed, it means the function is not available on the current disc or at the current time.
- Do not push on the disc tray or put any objects other than disc on the disc tray. Doing so may cause the disc player malfunction.

Playable Discs

Your DVD Player will play:

- Digital Versatile Discs (DVDs)
- Video CDs (VCDs)
- SuperVideo CDs (SVCDs)
- Finalised DVD recordable (DVD±R)
- Digital Versatile Discs + Rewritable (DVD±RW)
- Audio Compact Discs (CDs)
- MP3 discs, picture (Kodak, JPEG) files on CD-R (W)
- ISO 9660/UDF format
- JPEG resolution support up to 3073 × 2048
- Supported sampling frequencies: 32kHz, 44.1kHz, 48kHz.
- Supported Bit-rates: 32~256 (kbps), variable bit rates (average 128 kbps)



Region Codes

DVD discs and players are designed with regional restrictions. Before playing a disc, make sure the disc is for the same region as your player. The regional code for this unit is indicated at the bottom panel.



Note:

- If you are having trouble playing a certain disc, remove the disc and try a different one. Improper formatted disc will not play on this DVD Player.

Playing discs

1. Press **STANDBY-ON** to turn on the DVD player.
2. Push **OPEN/CLOSE** on the top of the system to open the disc tray.
3. Insert a disc with the print side facing up and close the disc tray.
4. Playback will start automatically (depending on the disc type).
 - If a disc menu appears on the TV, see “Using the Disc Menu”.
 - If the disc is locked by parental control, you must enter your four-digit password. (See “Changing the password”).

To interrupt playback

- Press **PLAY/PAUSE** .
- To resume playback, press **PLAY/PAUSE** again.

To stop playback

- Press **STOP** twice.

Note:

- As a power-saving feature, the system will automatically switch to Standby mode if you don't press any button within 15 minutes in the stop mode.

Using the Disc Menu

1. During playback, press **DISC MENU** on the remote control to return to disc menu or press **RTN TITLE** to return to title menu.
 - If the current disc/title has a menu, the menu will appear on the screen. Otherwise, the disc menu will be displayed.
2. Press **▼ / ▲ / ◀ / ▶** to select the desired title or chapter; and then press **PLAY/PAUSE** or **OK**.
 - Playback start from the selected title or chapter.

Using PBC feature (available for 2.0-version VCD only)

PBC playback allows you to play Video CD interactively, following the menu on the display.

- Press **DISC MENU** to toggle between PBC ON and PBC OFF.

Playing a disc with PBC function

- If PBC OFF, the system will start playback automatically.
- If PBC ON, the PBC menu (if available) will appear on the TV screen for selection. Use the **numeric keys (0-9)** to enter your choice.
→ To return to the previous menu, press **RTN TITLE** on the remote control.

Resuming playback

- During playback, press **STOP ■** once to stop the playback in resume mode, then press **PLAY/PAUSE ►II** to start playback from where you have stopped.

To cancel the resume mode

- In the stop position, press **STOP ■** again to fully stop the playback. Or open the disc door; or switch the system to standby mode.

Selecting and searching

Selecting a different track/chapter

For DVD/VCD/CD/MP3:

- During playback, briefly press **|◀/▶|** on front panel or press **PREV ◀◀/NEXT ▶▶** on remote control to select previous or next track/chapter.

Or,

use the **Numeric Keypad (0-9)** on the remote control to directly input your track number.

→ After selecting, playback will automatically start from the beginning of the selected track.

Helpful hints:

- Some VCDs have a single track, so track selecting or an invalid input value for the current disc will be ignored.
- If the player has been set to repeat chapter (track), pressing this button will replay the same chapter (track) from its beginning.

Fast forwarding/reversing

For DVD/VCD/CD/MP3:

- During playback, press **◀◀/▶▶** repeatedly on front panel or press and hold **PREV ◀◀/NEXT ▶▶** to select fast search speed in forward (FF) or reverse (FR) playback.
- To resume to normal playback, press **►II**. Or, press **◀◀/▶▶** repeatedly on front panel or press and hold **PREV ◀◀/NEXT ▶▶** until "PLAY" is displayed on the TV screen.

Helpful hints:

- Fast searching forward/backward is available only within the same track.

Slow forwarding/reversing

For DVD/VCD:

- During playback, press **▲** repeatedly to select slow motion speed.
- To resume to normal playback, press **PLAY/PAUSE ►II**.

Volume control

Press **VOLUME +/-** or **VOL +/-** on the remote to increase or decrease the volume level.

→ The volume value from "00" to "32".

To switch off the volume temporarily

- Press **MUTE** or Volume level set to 0.
→ Playback will continue without sound and "MUTE" is displayed on TV screen.
- To activate sound reproduction, you can:
 - press **MUTE** again;
 - press **VOLUME +** or **VOL +** to release the mute;

Display dim

- Press **DIM** repeatedly on the front panel to select different levels of brightness for the display.

Different play modes: REPEAT and REPEAT A-B

REPEAT

For DVDs/VCD/CD/CDG/MP3

- During playback, press **REPEAT A-B** on the remote control or press **REPEAT** button on the front panel repeatedly to choose desired repeat play modes.
→ For VCD with PBC feature, PBC must be turned off first.

For DVDs

REPEAT CHAPTER: Repeats the current chapter

REPEAT TITLE: Repeats the current title

REPEAT OFF: Switchs off repeat play mode

For CDs/CDGs/VCDs/SVCDs with PBC OFF

REPEAT ONE: Repeats the current track

REPEAT ALL: Plays all the tracks repeatedly

REPEAT OFF: Switchs off repeat play mode

For MP3/JPEG

REPEAT ONE: Repeats the current track

REPEAT DIR: Plays all the tracks in the directory repeatedly

REPEAT ALL: Plays all the content repeatedly

REPEAT OFF: Switchs off repeat play mode

- To return to normal playback, press **REPEAT A-B** on the remote control or press **REPEAT** button on the front panel repeatedly until "REPEAT OFF" is displayed.

Repeat A-B

You can play a specific section in a chapter/track repeatedly.

- Press **REPEAT A-B** on the remote control repeatedly or press **A-B** on the front panel to choose start point.
- Press **REPEAT A-B** on the remote control repeatedly or press **A-B** on the front panel to choose end point.
→ The passage will now repeat continuously.
- To resume normal play, press **REPEAT A-B** on the remote control repeatedly or press **A-B** on the front panel again.

Note:

- The A-B function can only be set within the same chapter or track.

Viewing the disc playback information

You can view the disc information (e.g., current title / chapter / track number; total playing time or remaining time on the disc) without interrupting the disc playback.

- During playback, press **DISPLAY** on the remote control or front panel.
→ The available disc information appears.

For DVDs:

TT xx/xx CH xx/xx xx : xx : xx

For CDs / CDGs / MP3 / VCDs with PBC OFF

TRK xx/xx (Play mode) xx : xx : xx

For VCDs with PBC ON

TRK xx/xx PBC (Play mode) xx : xx : xx

- Press / to select an item.
- Use the **numeric keys (0-9)** to input the number/time, and press **OK** to confirm.
→ The playback skips to the chosen time or selected title/chapter/track.

Note:

- For CDG discs, it only can select track number.

Viewing from another angle

If the playing DVD disc is recorded with multiple camera angles. This allows you to view the picture from different angles. Angle selection is determined by the disc format.

- During playback, press **ANGLE** button to select the different angle.

Note:

- If the playing DVD disc is single-angle type, this button is useless.
- The maximum number of angle stipulated by the manufacturers is 9/9.

Disc Operations

ZOOM

Zooming allows you to enlarge the video/ JPEG image during playback.

- During playback, press **ZOOM** repeatedly to change the zooming scale.
ZOOM 2 → ZOOM 3 → ZOOM 4 → ZOOM 1/2 → ZOOM 1/3 → ZOOM 1/4 → ZOOM: OFF
- To pan through the enlarged image, press ▼/▲ / ◀/▶ buttons.
- Press **ZOOM** repeatedly to exit ZOOM mode. (ZOOM OFF)

AUDIO

This operation works only on DVDs with multiple soundtrack language or VCDs with multiple audio channel.

For DVDs

- On the remote control, press **AUDIO** repeatedly to select the desired language for sound track.
→ The feature is disc dependant.

For VCDs

- Press **AUDIO** repeatedly to select the audio channel for sound output displayed on the TV screen.

STEREO → MONO L → MONO R → MIX MONO

SUBTITLE (DVD only)

- Press repeatedly **SUBTITLE** on the remote control to select different subtitle languages.
→ The feature is disc dependant.

Playing MP3/picture disc (JPEG, Kodak)

IMPORTANT!

- You have to turn on your TV set and set to the correct Video In channel.

Playing an MP3 disc

1. Load an MP3 disc.
→ The disc reading time may exceed 30 seconds due to complexity of the directory/file configuration.
→ Playback starts automatically and content menu appears.



2. Use ▼/▲ / ◀/▶ keys to select the album and then press OK.
3. Use ▼/▲ / ◀/▶ keys to select a track in the album, then press **OK** to start playback from the selected file to the end of the album.
- During playback, use the **numeric keys (0-9)** to select a desired file from the disc menu and press **OK**.
4. Press ◀/▶ on front panel or **PREV** ◀◀/ **NEXT** ▶▶ on remote control to select previous/next track.
5. To stop playback, press **STOP** ■ twice.

Playing a JPEG file (slide show)

You can display JPEG pictures in the selected folder to roll automatically one after the other.

1. Insert a JPEG photo CD (CD, DVD±RW, DVD±R)

→ The content menu appears.



2. Use ▼/▲/◀/▶ keys to select the folder and file, then press **OK** to start the slide show playback.

During playback, you can

- Press ◀/▶ on front panel or **PREV** ◀◀/ **NEXT** ▶▶ on remote control to select previous/next file.
- Press ◀/▶ to rotate the picture 90° anticlockwise or clockwise.
- Press ▼/▲ to flip the picture vertically or horizontally.

Note:

— It may require longer time for the DVD player to display the disc content on the TV due to the large number of picture compiled into one disc.

Playing a Kodak picture CD

1. Insert a Kodak picture disc.
→ Playback will start automatically.
2. To stop playback, press **STOP** ■ .
→ 6 thumbnail pictures will appear on the TV.

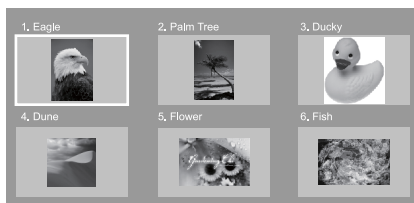

3. Use ▼/▲/◀/▶ to navigate within the menu and press **OK** to start playback.

DVD Menu Operations

Using the System Setup menu options

This DVD setup is carried out via your TV set, enabling you to customize the DVD player to suit your particular requirements.

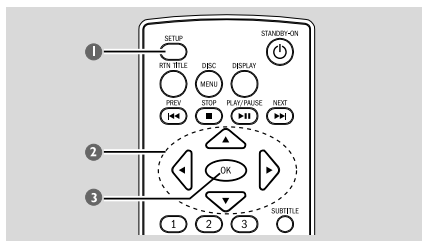

1. Press **SETUP**.

→ The setup will appear across the TV screen.

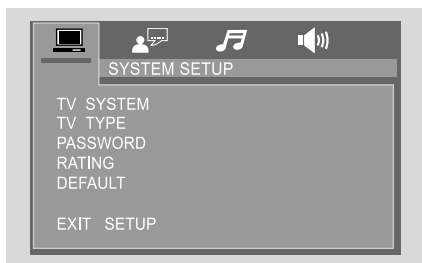

2. Press **▼/▲ / ◀ / ▶** on the remote control to navigate in the menu.

3. Press **OK** to confirm your setting.

To remove the menu

- Press **SETUP** to exit the menu.

Note:

— Some of the features in the DVD Menu Options are described in “Getting Started”.

Setting the TV TYPE

Set the aspect ratio of the DVD Player according to the TV you have connected.

→ **4:3PS(pan scan)**: If you have a normal TV and want both sides of the picture to be trimmed or formatted to fit your TV screen.



→ **4:3LB (letter box)**: If you have a normal TV. In this case, a wide picture with black bands on the upper and lower portions of the TV screen will be displayed.



→ **16:9:(wide screen)**: If you have a wide-screen TV.



Changing the password

You can change the four-digit code used as Password.

1. Press **SETUP**.

2. Press **▼/▲ / ◀ / ▶** on the remote control to select **PASSWORD** and press **▶**.

3. Use the **numeric keys (0-9)** to enter your current four-digit code, then press **OK**.

→ The password supplied by default is **0000**.

4. Press **►**, then enter the new four-digit password.
5. Press **OK** to confirm.

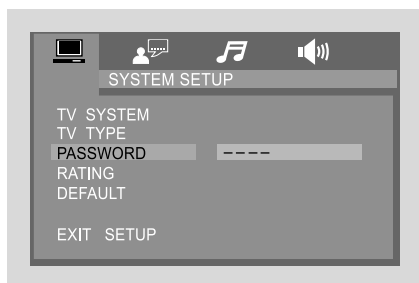

Restricting playback by setting rating level

Some DVDs may have a parental level assigned to the complete disc or to certain scenes on the disc. This feature lets you set a playback limitation level. The rating levels are from 1 to 8 and are country specific. You can prohibit the playing of certain discs that are not suitable for your children or have certain discs played with alternative scenes.

1. Press **SETUP**.
2. Press **▼/▲ / ◀ / ▶** on the remote control to select **RATING** and press **►**.
→ You need to enter the password at first.
3. Press **▼/▲** to select a rating level and press **OK**.
→ DVDs rated above the level you select will not play unless you enter your four-digit password or choose a higher level rating.
4. Use the **numeric keys (0-9)** to enter your current four-digit code.

Rating explanations

1 KID SAFE – Kids material; recommended especially for children and viewers of all ages.

2 G – General Audience; recommended as acceptable for viewers of all ages.

3 PG – Parental Guidance suggested.

4 PG 13 – Material is unsuitable for children under age 13.

5~6 PG-R – Parental Guidance – Restricted; recommended that parents restrict children under 17 from viewing or allow them to view only when supervised by a parent or adult guardian.

7 NC-17 – No children under age 17; not recommended for children under age 17.

8 ADULT – material for adults only; viewed only by adults due to graphic sexual scenes, violence, or language.

Default

If **DEFAULT** is selected, all the items in the setup menu will be reset to default setting, except Rating Setting and Password.

DVD Menu Operations

Using the Audio Setup menu options

1. Press **SETUP**.
2. Press ◀ / ▶ to select **AUDIO SETUP**, then press ▼.
- The system setup menu appears.
3. Press ▼/▲ / ◀ / ▶ on the remote control to navigate in the menu.
4. Press **OK** to confirm your setting.

Dynamic Range

Select the Dynamic Range to fit the individual listening situation of the audience.

1. Press ▼ to select **DYNAMIC RANGE** in AUDIO SETUP page, then press ▶ to access.
2. Press ▼/▲ to select a setting and press **OK** to confirm.
- The variable range is from FULL, 6/8~2/8 or OFF

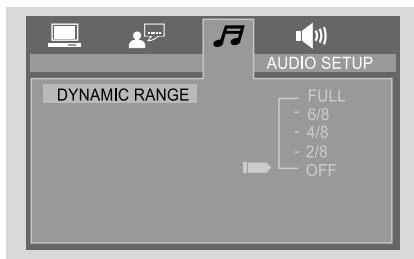

FULL: Audio with fully compressed Dynamic Range.

6/8~2/8: Audio with partially compressed Dynamic Range.

OFF: Audio with uncompressed Dynamic Range.

Using the Speaker Setup menu option

1. In disc mode, press **SETUP**.
2. Press ◀ / ▶ to select **SPEAKER SETUP**, then press ▼.
- The system setup menu appears.



3. Press ▼ to select the **DOWNMIX**, then press ▶ to access.
4. Press ▼/▲ to select a setting and press **OK** to confirm.

LT/RT: Select this option if your DVD player is connected to a Dolby Pro Logic decoder.

STEREO: Select this when output delivers sound from only the two front speakers.

SYSTEM

Power supply 110-240V / 60-50Hz
 Rated working power consumption (1/8 rated output power) ≤ 40 W
 Output power $2 \times 5W + 10W$ RMS
 (L/R speakers + subwoofer)

DVD

Frequency response 20Hz-20kHz (± 3 dB)
 Video output 1 V_{P,P}
 Horizontal definition ≥ 500 (TV)
 Dimensions 215(W) x 90 (H) x 217(D) mm
 Weight 1.14 kg

L/R SPEAKER

System 1-way system
 Impedance 8 Ω
 Dimensions (w x h x d)
 115mm x 120mm x 198mm
 Weight
 0.78 kg (each)

SUBWOOFER

System bass reflex system
 Impedance 4 Ω
 Dimensions (w x h x d)
 289mm x 167mm x 198mm
 Weight 3.1 kg

REMOTE

Distance 6m
 Angle $\pm 30^\circ$





**Specifications and external appearance
 are subject to change without notice.**

Troubleshooting

WARNING

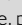
Under no circumstances should you try to repair the system yourself, as this will invalidate the warranty. Do not open the system as there is a risk of electric shock.

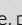
If a fault occurs, first check the points listed below before taking the system for repair. If you are unable to remedy a problem by following these hints, consult your dealer or Philips for help.

Problem	Solution
No power.	<ul style="list-style-type: none">✓ Check if the AC power cord is properly connected.✓ Press STANDBY ON  on the DVD System.
No picture.	<ul style="list-style-type: none">✓ Check if the TV is switched on.✓ Check the video connection.✓ Set your TV to the correct Video In channel. This channel is usually near channel 00. Or; you may have a button on the TV remote control that selects Auxiliary or A/V IN channel. See your TV owner's manual for details. Or; change channels at the TV until you see DVD screen on the TV.
Distorted or poor picture.	<ul style="list-style-type: none">✓ Sometimes a small amount of picture distortion may appear. This is not a malfunction.✓ Clean the disc.
Completely distorted picture or black/white picture.	<ul style="list-style-type: none">✓ TV has a colour system standard. If the disc's or DVD system's colour system is different than your TV's colour system, the picture may be distorted or colourless.
The aspect ratio of the screen cannot be changed even though you have set the TV shape.	<ul style="list-style-type: none">✓ The aspect ratio is fixed on the DVD disc.✓ Depending on the TV, it may not be possible to change the aspect ratio.
No sound or distorted sound.	<ul style="list-style-type: none">✓ Adjust the volume.✓ Check that the speakers are connected correctly.✓ Check that the speaker system is switched on.✓ Replace the speaker cables.✓ The system is in pause, slow motion or fast forward/reverse mode, press   (or   on the remote) to resume normal play mode.

The micro DVD player does not start playback.

- ✓ Insert a readable disc with the playback side facing down.
- ✓ Check the disc type, colour system and regional code. Check for any scratches or smudges on the disc.
- ✓ Press SETUP to turn off the setup menu screen.
- ✓ Cancel the parental control rating function or change the rating level.
- ✓ Moisture has condensed inside the system. Remove the disc and leave the system turned on for about an hour.

The DVD micro system does not respond when the buttons are pressed.

- ✓ Disconnect the power plug from the outlet and insert again.

Cannot activate some features, such as Subtitles, or multi-language Audio.

- ✓ Multi-language sound or subtitle is not recorded on the DVD.
- ✓ Changing the language for the sound or subtitle is prohibited on the DVD.
- ✓ The features may not be available on the disc.

The remote control does not function.

- ✓ Point the remote control at the remote sensor of the unit.
- ✓ Reduce the distance to the player.
- ✓ Remove any possible obstacles.
- ✓ Replace the battery with new one.
- ✓ Check that the battery is loaded correctly.

The display is dark.

- ✓ Press DIM again.

Low hum or buzz sound.

- ✓ Place the DVD micro system as far away as possible from electrical devices that may be causing interference.

Low bass response.

- ✓ Check all speakers for correct polarity.

Analog: Sound that has not been turned into numbers. Analog sound varies, while digital sound has specific numerical values. These jacks send audio through two channels, the left and right.

Aspect ratio: The ratio of vertical and horizontal sizes of a displayed image. The horizontal vs. vertical ratio of conventional TVs is 4:3, and that of wide-screens is 16:9.

AUDIO OUT Jacks: Jacks on the back of the DVD System that send audio to another system (TV set, Stereo, etc.).

Bit Rate: The amount of data used to hold a given length of music; measured in kilobits per second, or kbps. Or, the speed at which you record. Generally, the higher the bit rate the better the sound quality. However, higher bit rates use more space on a Disc.

Chapter: Sections of a picture or a music piece on a DVD that are smaller than titles. A title is composed of several chapters. Each chapter is assigned a chapter number enabling you to locate the chapter you want.

Disc menu: A screen display prepared for the selection of images, sound, subtitles, multi-angles, etc recorded on a DVD.

Dolby Digital: A surround sound system developed by Dolby Laboratories containing up to six channels of digital audio (front left and right, surround left and right and center).

JPEG: A still-picture data compression system proposed by the Joint Photographic Expert Group, which features small decrease in image quality in spite of its high compression ratio.

MP3: A file format with a sound data compression system, "MPE" is the abbreviation of Motion Picture Experts Group 1 (or MPEG-1) Audio Layer 3. Through the MP3 format, one CD-R or CD-RW can contain about 10 times as much data volume as a regular CD can.

Multichannel: DVD is specified to have all sound tracks constitute one sound field. Multichannel refers to a structure of sound tracks having three or more channels.

Rating: A function of the DVD to limit playback of the disc by the age of the users according to the limitation level in each country. The limitation varies from disc to disc; when it is activated, playback will be prohibited if the software's level is higher than the user-set level.

PCM (Pulse Code Modulation): A system for converting analog sound signal to digital signal for later processing without data compression.

Playback control (PBC): Refers to the signal recorded on video CDs or SVCDs for reproduction control. By using screen menus recorded on a Video CD or SVCD that supports PBC, you can enjoy interactive-type software as well as software having a search function.

Region code: A system allowing discs to be played only in preset regions. This unit will only play discs that have compatible region codes. You can find the region code of your unit from the product label. Some discs are compatible with more than one region (or ALL regions).

Title: The longest section of a picture or music feature on DVD, music, etc., in video software, or the entire album in audio software. Each title is assigned a title number enabling you to locate the title you want.

VIDEO OUT jack: Jack on the back of the DVD System that sends video to TV.

Meet Philips at the Internet
<http://www.philips.com>

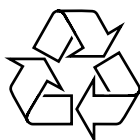

MCD137

**CLASS 1
LASER PRODUCT**

