

Quick Start Guide



Step A *Connect*

Step B *Setup*

Step C *Enjoy*

What's in the Box?

You should find these items upon opening the box.

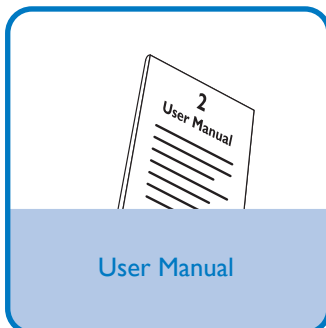
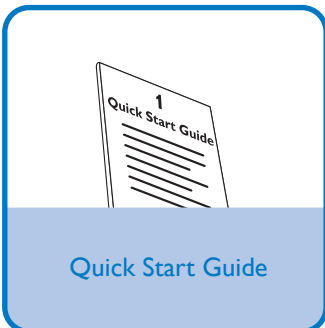
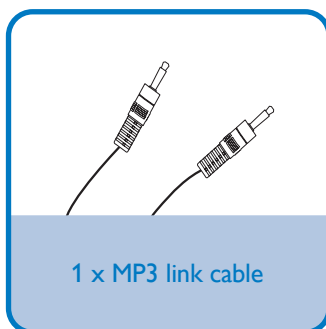
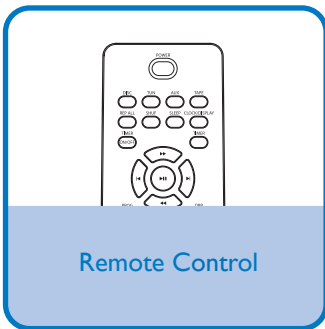

Step A *Connect*

1 Connect the speaker cables.

2 Connect the AC power cord to the wall socket.

Tip
See the User Manual on how to connect other equipment to this system.

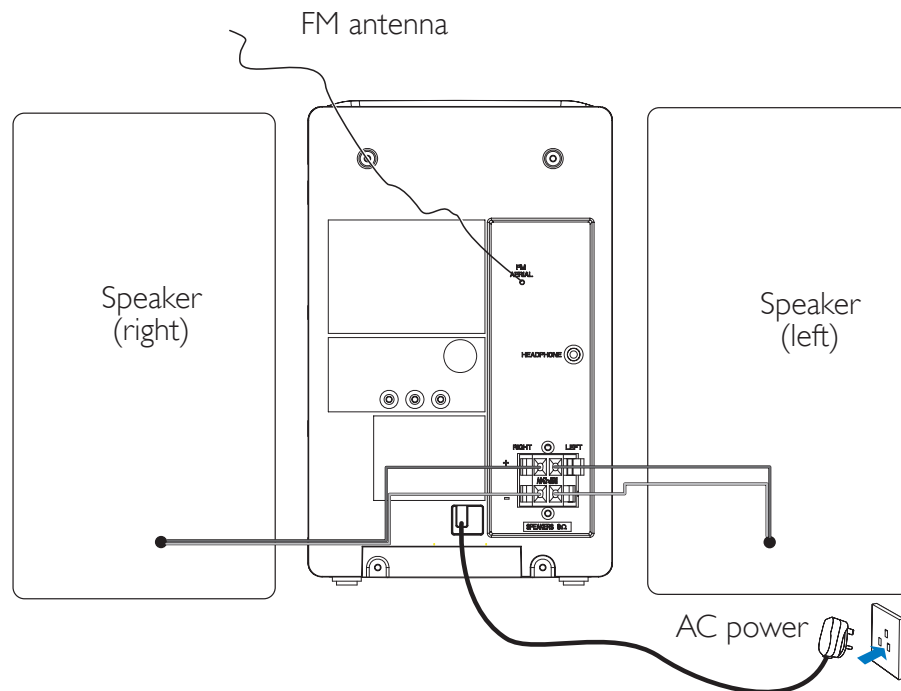

Step B *Setup*

Set clock

1 Press and hold **CLOCK/DISPLAY** to activate the clock setting mode.
→ The 12 hour or 24 hour format is displayed.

2 Press **PROG** repeatedly to select 12 hour or 24 hour format.

3 Press **CLOCK/DISPLAY** to confirm.
→ The hour digits are displayed and begin to blink.

4 Press **◀▶** to set the hour.

5 Press **CLOCK/DISPLAY** to confirm.
→ The minute digits are displayed and begin to blink.

6 Press **◀▶** to set the minute.

7 Press **CLOCK/DISPLAY** to confirm.

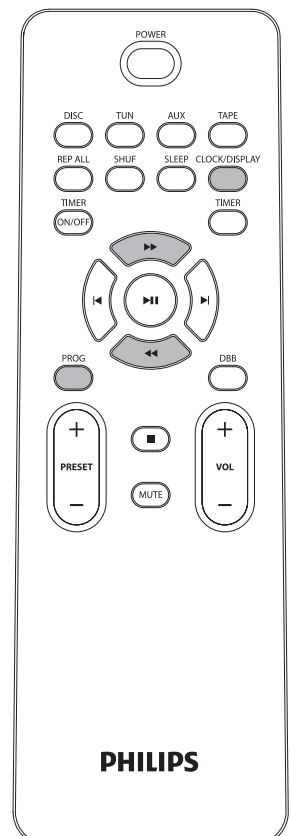

Step C *Enjoy*

Play disc

1

Press **DISC** to select the disc source.

2

Press **OPEN/CLOSE** on the top panel to open the disc tray.

3

Insert a disc with the printed side facing up, then close the disc tray.

4

Press **▶||** to start play.

5

To stop play, press **■**.

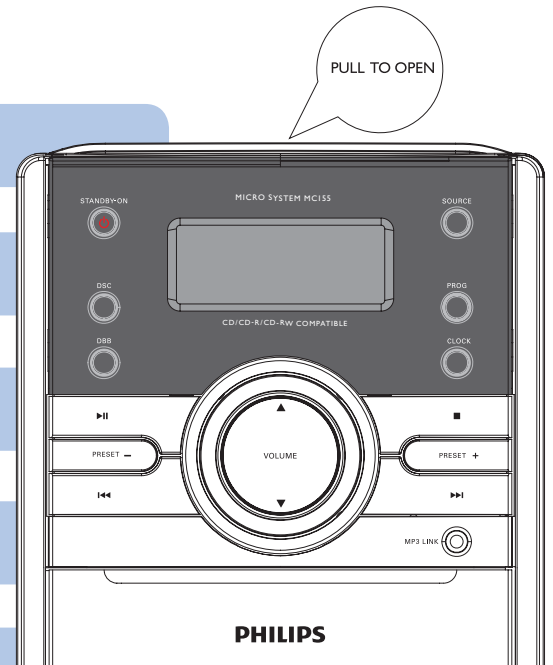

Listen to radio

1

Press **TUN** to select radio source.

2

Press and hold **◀▶** for more than 2 seconds.

3

Repeat step 2 to tune to more stations.

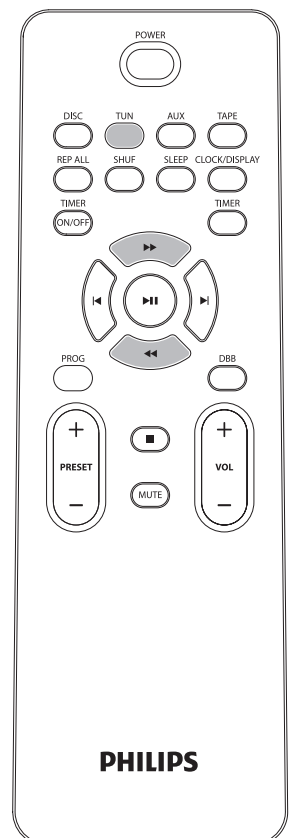



Tip

Detailed play features and additional functions are described in the supplied user manual.

© 2010 Koninklijke Philips Electronics N.V.
All rights reserved.

<http://www.philips.com>

