

# Quick Start Guide

Step A *Setup*

Step B *Enjoy*

## What's in the Box?

You should find these items upon opening the box.

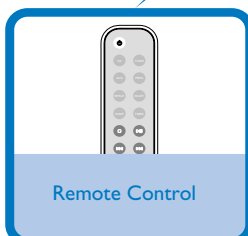
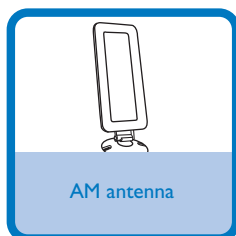
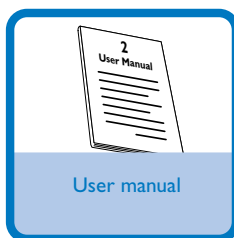
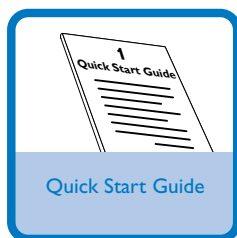

Pull out the insulation plastic sheet.

**PHILIPS**

# Step A

## Setup

### Connection

- 1 For radio reception, connect the supplied AM antenna to the **AM aerial** terminal.
- 2 Connect the speaker wires to the **SPEAKERS** terminals.
- 3 Connect the power cord of the system to the AC power outlet.

#### Tip

It is unnecessary to connect the FM pigtail antenna since it is fixed to the main unit.

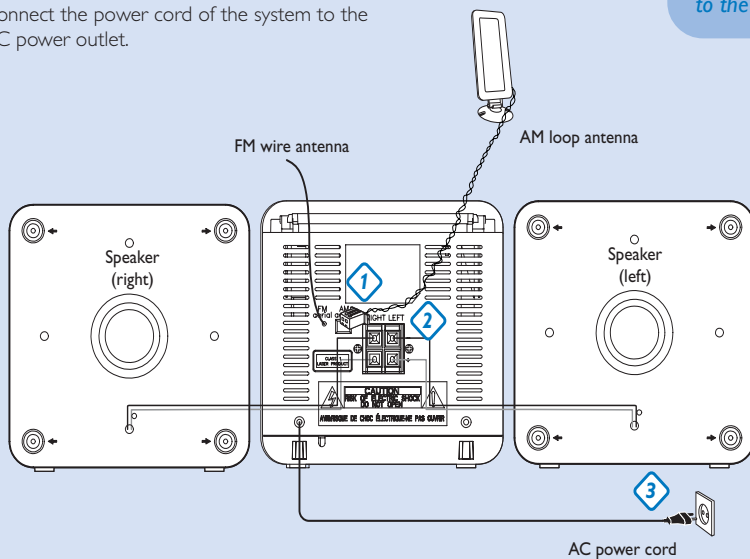

### Setting the clock

- 1 In standby mode, press **PROG/CLOCK** button. The clock digits for the hours flash.
- 2 Press **◀◀/▶▶** to set the hours.
- 3 Press **PROG/CLOCK** again. The clock digits for the minutes flash.
- 4 Press **◀◀/▶▶** to set the minutes.
- 5 Press **PROG/CLOCK** to confirm the time.

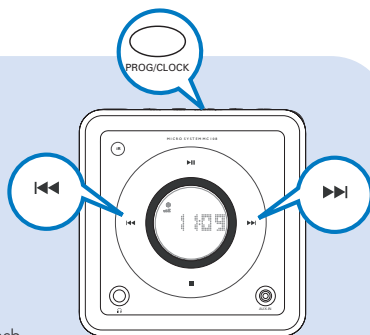

## Step B

## Enjoy

### Playing a disc

- 1 Select **CD** source.
- 2 Press **OPEN•CLOSE** on the top of the system to open the CD door.
- 3 Insert a disc with the printed side facing up and press down on **OPEN•CLOSE** to close the CD door.
- 4 Press **▶ ||** to start playback.
- 5 Press **■** to stop playback.

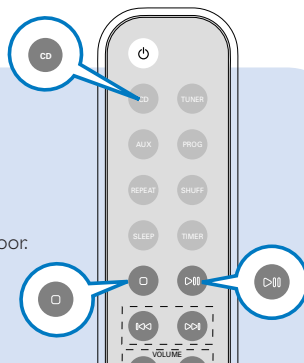

### Listening to radio

- 1 Select **TUNER** source.
- 2 Press **BAND (TUNER)** on the remote control) to select your waveband.
- 3 Turn **TUNING ●** to tune to a station.

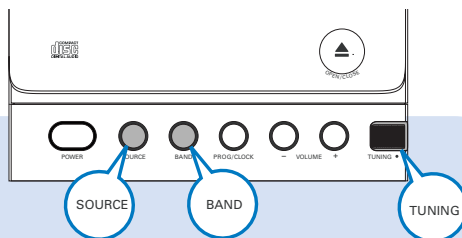

#### Tip

Detailed playback features and additional functions are described in the accompanied owner's manual.

