

Quick start guide



Step A *Connect*

Step B *Setup*

Step C *Enjoy*

What's in the Box?

You should find these items upon opening the box.

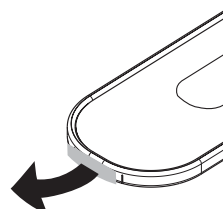
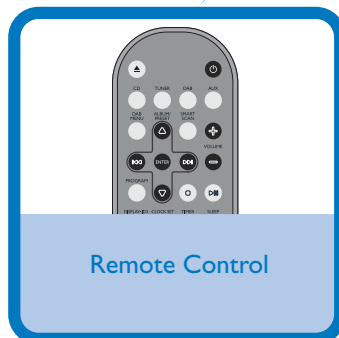
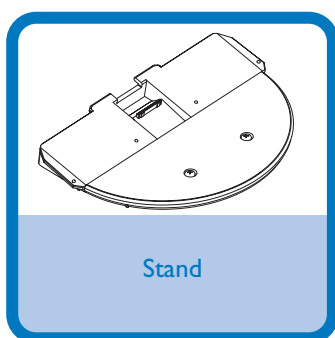

Pull out the plastic protective sheet before use.

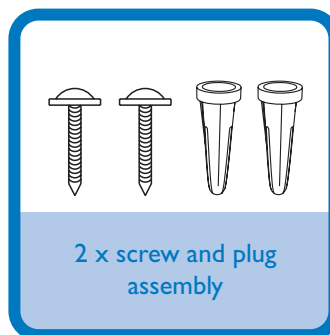
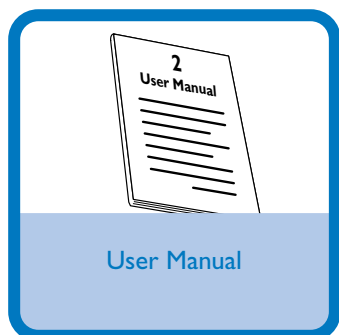
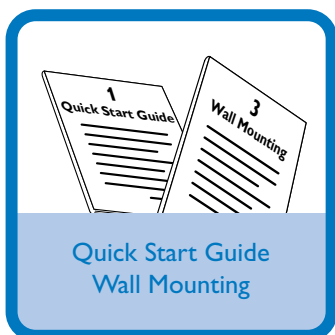

PHILIPS

Step A *Connect*

- 1** To position the unit on a flat surface, slide the stand into the slot in the main unit as shown.

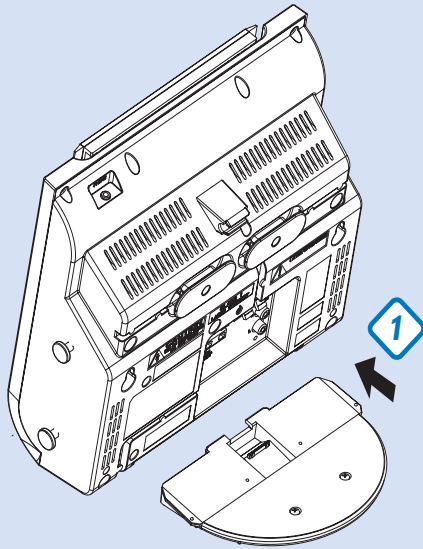

Tip
See *Wall Mounting* for detailed instructions if you want to mount the system on the wall.

- 2** Connect the speaker wires to the **Speakers** terminals, right speaker to "**R**" and left speaker to "**L**", colored (marked) wire to "+" and black (unmarked) wire to "-".
- 3** After ensuring all the above connections have been made, connect the AC power cord to the wall outlet.

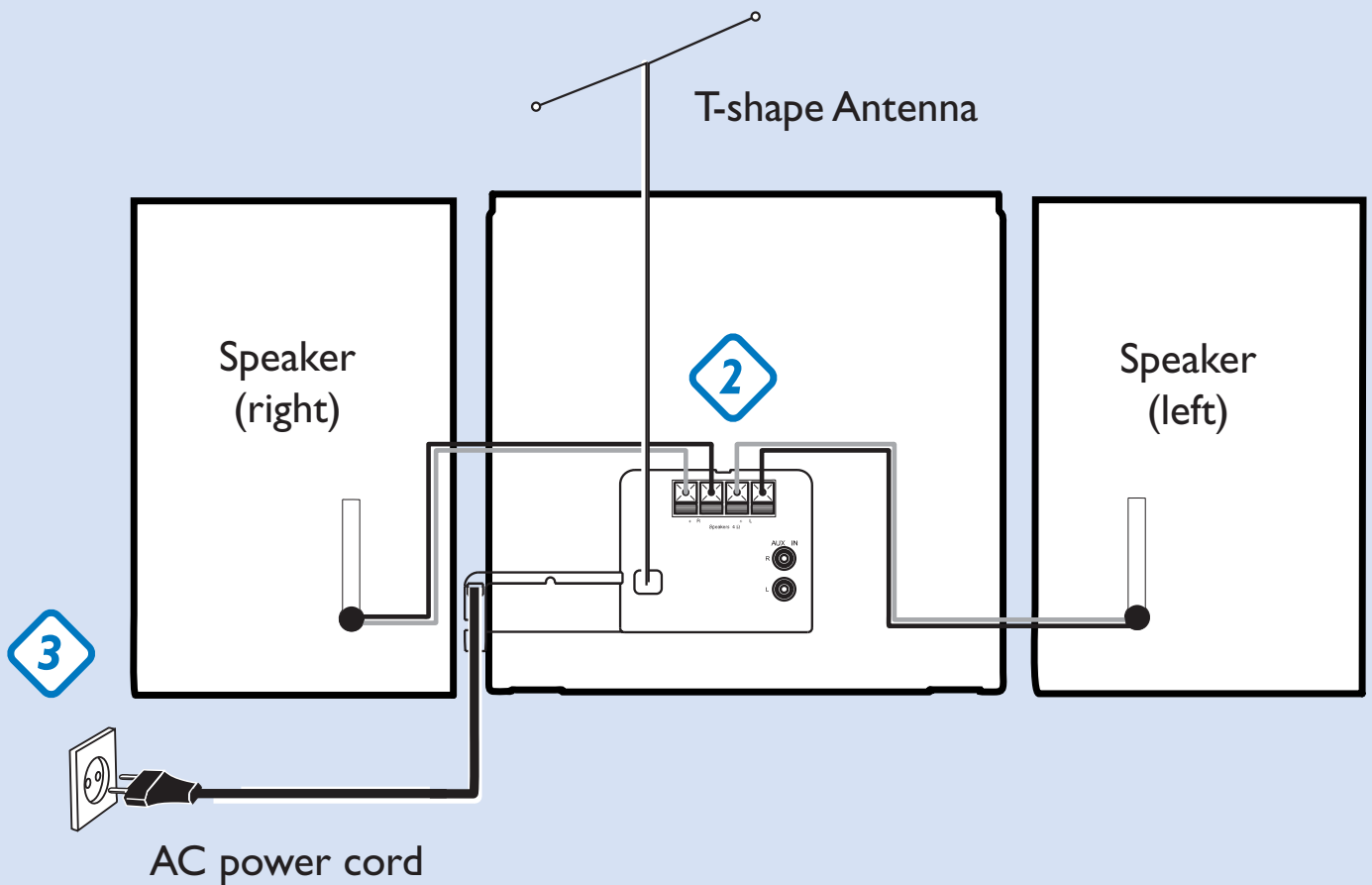

Step B Setup

Setting the clock

The clock can be set in either 12-hour or 24-hour mode ("AM 12:00" or "00:00", for example).

- 1** If the Eco power indicator is on, press and hold **STANDBY-ON/ECO POWER** (or  on the remote) until "--:--" flashes on the display screen to switch to the normal standby mode.
- 2** Press and hold **CLOCK SET** until the clock digits for the hours flash.
- 3** Press **PROGRAM** on the set repeatedly to select the clock mode.
→ "AM 12:00" or "00:00" is displayed with "AM 12" or "00" flashing.
- 4** Press **VOLUME (▲/▼) (+/-)** to set the hours.
- 5** Press **CLOCK SET** again.
→ The clock digits for the minutes flash.
- 6** Press **VOLUME (▲/▼) (+/-)** to set the minutes.
- 7** Press **CLOCK SET** to confirm the time.

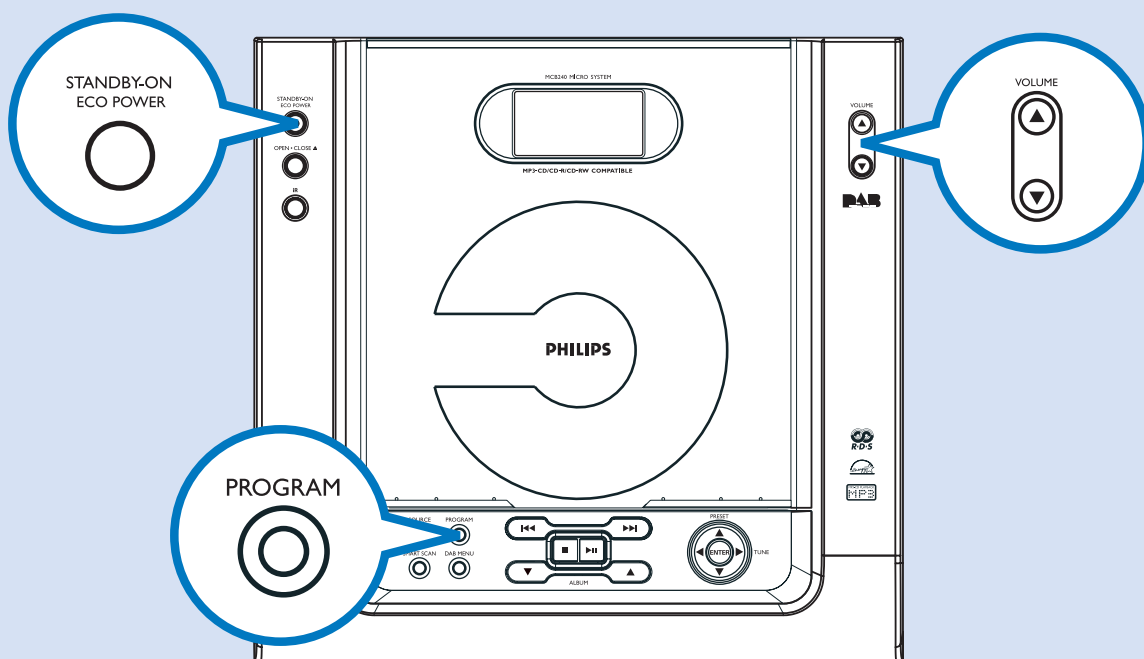
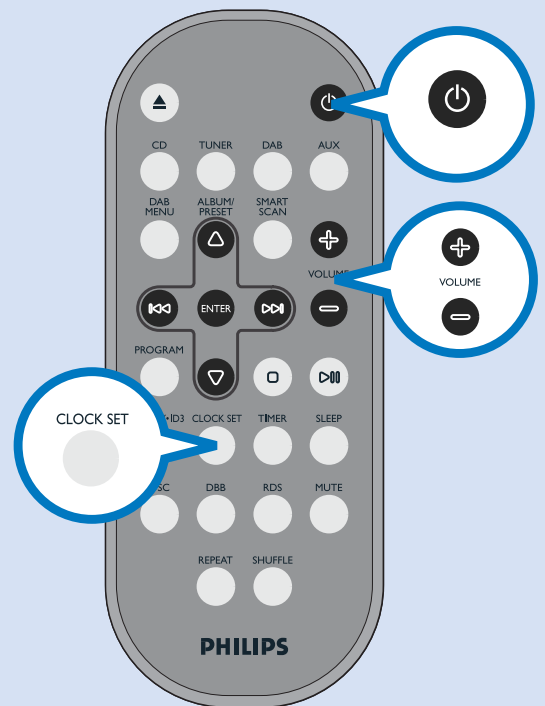

Playing a disc

- 1 Press **SOURCE** on the front panel of the system to select CD or press **CD** on the remote.
- 2 Press **OPEN•CLOSE ▲** to open the CD compartment.
- 3 Insert a disc with the printed side facing up. Press **OPEN•CLOSE ▲** again to close the compartment.
- 4 Press **▶ ||** to start playback.

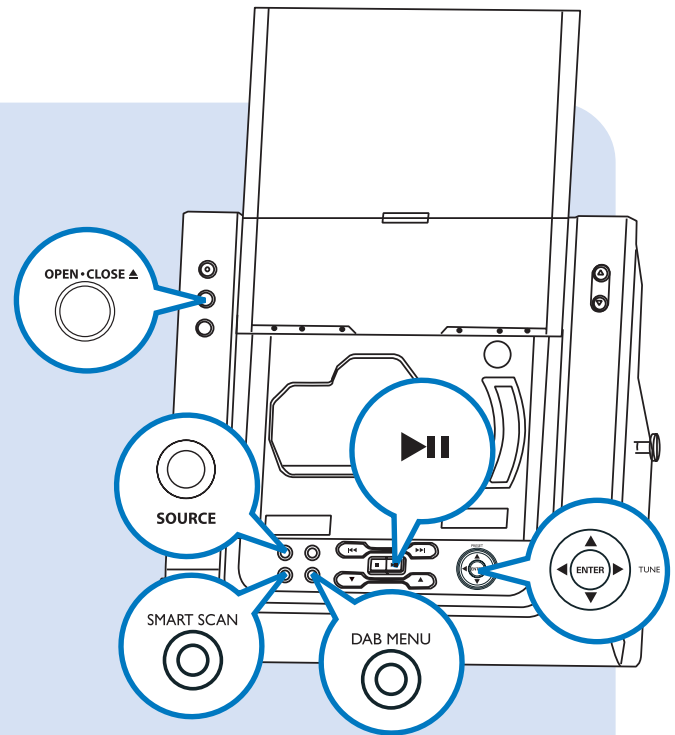

Tip

See the User Manual for detailed playback operations.

Tuning to DAB stations

- 1 Press **SOURCE** to select DAB (or press **DAB** on the remote) to start automatic search for available DAB stations.
- 2 Press and hold **SMART SCAN** to scan all band III and band L frequencies.
- 3 Push **TUNE◀ / ▶** once or more (or **◀◀ / ▶▶** on the remote) to scroll the list of stored stations and when your desired station appears, press **ENTER** to select the station.
- 4 Press **DAB MENU** and then use the navigation control buttons for more features.

Tips

- If the reception is poor, hang up one end of the T-shape antenna and keep the other end at horizontal angle to it.
- See the User Manuals for detailed instructions on DAB operations.