

DVD Micro Theatre

MCD510

User manual

Manuel d'utilisation

Manual del usuario

使用説明



PHILIPS

México



Es necesario que lea cuidadosamente su instructivo de manejo.

	PRECAUCIÓN - ADVERTENCIA	
	No abrir, riesgo de choque eléctrico	
	ATENCIÓN	
	Verifique que el voltaje de alimentación sea el requerido para su aparato	
Para evitar el riesgo de choque eléctrico, no quite la tapa. En caso de requerir servicio, dirijase al personal calificado.		

Descripción: **Minisistema de Audio**
Modelo : **MCD510/21**
Alimentación: **110-127 / 220-240 V; ~50/60 Hz**
Consumo: **60 W**
Importador: **Philips Mexicana, S.A. de C.V.**
Domicilio: **Av. La Palma No.6**
Col. San Fernando La Herradura
Huixquilucan
Localidad y Tel: **Edo. de México C.P. 52784**
Tel. 52 69 90 00
Exportador: **Philips Electronics HK, Ltd.**
País de Origen: **China**
N° de Serie: _____

**LEA CUIDADOSAMENTE ESTE INSTRUCTIVO
ANTES DE USAR SU APARATO.**

AVISO IMPORTANTE

Philips Mexicana, S.A. de C.V. no se hace responsable por daños o desperfectos causados por:

- Maltrato, descuido o mal uso, presencia de insectos o roedores (cucarachas, ratones etc.).*
- Cuando el aparato no haya sido operado de acuerdo con el instructivo del uso, fuera de los valores nominales y tolerancias de las tensiones (voltaje), frecuencia (ciclaje) de alimentación eléctrica y las características que deben reunir las instalaciones auxiliares.*
- Por fenómenos naturales tales como: temblores, inundaciones, incendios, descargas eléctricas, rayos etc. o delitos causados por terceros (choques asaltos, riñas, etc.).*

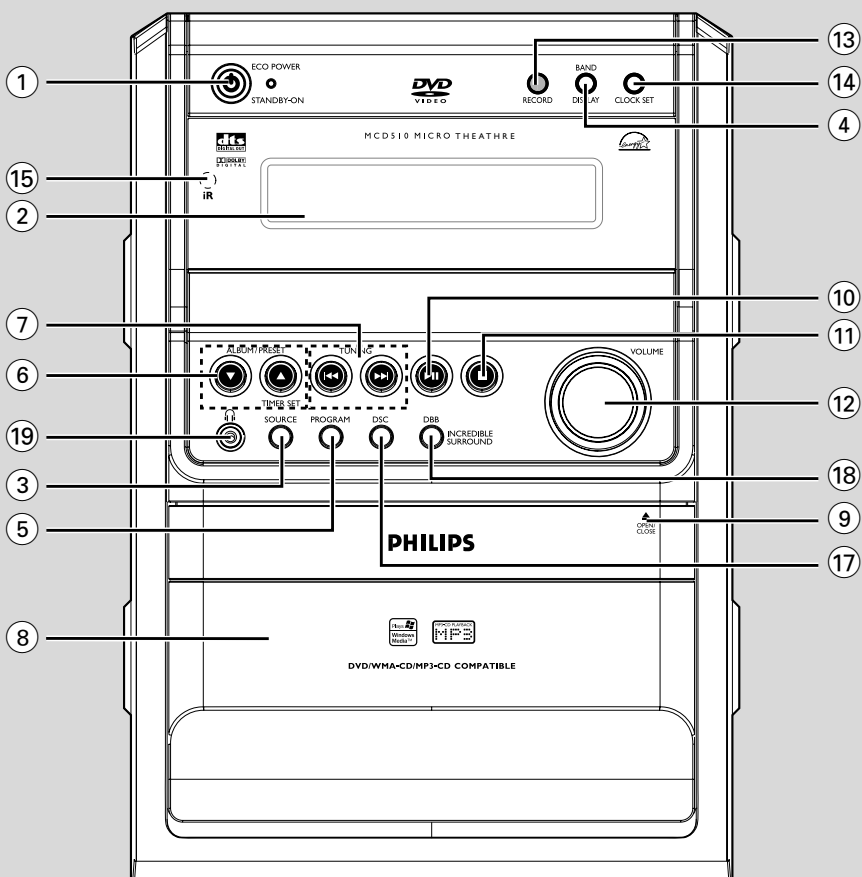
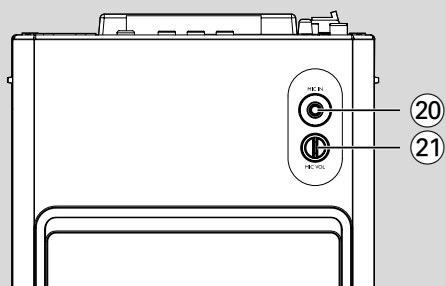
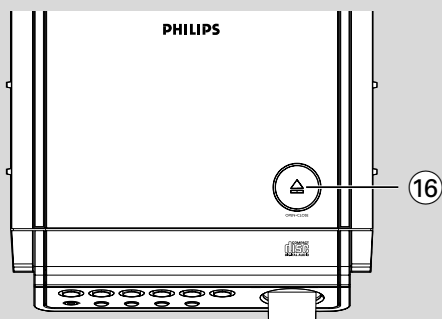

Manufactured under license from Dolby Laboratories. "Dolby", "Pro-logic" and the double-D symbol are trademarks of dolby Laboratories.

MANUFACTURED UNDER LICENSE FROM DIGITAL THEATER SYSTEMS, INC. US PAT. NO 5,451,942, 5,956,674, 5,974,380, 5,978,762 AND OTHER WORLD-WIDE PATENTS ISSUED AND PENDING. "DTS" AND "DTS DIGITAL SURROUND" ARE REGISTERED TRADEMARKS OF DIGITAL THEATER SYSTEMS, INC. COPYRIGHT 1996, 2000 DIGITAL THEATER SYSTEMS, INC. ALL RIGHTS RESERVED.

This product incorporates copyright protection technology that is protected by method claims of certain U.S. patents and other intellectual property rights owned by Macrovision Corporation and other rights owners. Use of this copyright protection technology must be authorized by Macrovision Corporation, and is intended for home and other limited viewing uses only unless otherwise authorized by Macrovision Corporation. Reserve engineering or disassembly is prohibited.

Windows Media is a trademark of Microsoft Corporation.

CAUTION

Use of controls or adjustments or performance of procedures other than herein may result in hazardous radiation exposure or other unsafe operation.

English 6

Français 41

Español 76

中文 111

English

Français

Español

中文

General Information

Features	8
Discs for playback	8
Region codes	
Supplied accessories	8
Environmental information	9
Care and safety information	9~10

Connections

Step 1: Placing speakers	11
Step 2: Connecting speakers	12
Step 3: Antennas Connection	12
Step 4: Connecting TV	13
Using component Video In jack (Cr CbY)	
Using Composite Video jacks (CVBS)	
Using S-Video In jack	
Using an accessory RF modulator	
Step 5: Connecting the power cord	15
Optional: Connecting additional equipment	15

Controls

Controls on the system	17
Controls on the remote control	17-18

Basic Functions

Switching the system on	19
Switching the system to Eco Power Standby mode	19
Power-saving automatic standby	19
Volume control	19
Listening through headphones	19
Sound control	19
Microphone Mixing	20
Key Control	20
Echo	20

Preparations

Step 1: Inserting batteries into the remote control	21
Using the remote control to operate the system	
Step 2: Setting the clock	21
Step 3: Setting language preference	22
Step 4: Setting video preference	22

Disc Operations

Playing discs	24
Using the disc menu	24
Basic playback controls	25
Pausing playback	
Skipping to another title (track)/chapter	
Resuming playback from the last stopped point	
Repeat play mode	
Shuffle play mode	
Repeating a section within a chapter/track	
Fast search	
Programming favorite tracks	
GOTO	
Zoom	
Special disc features	27
Playing in slow motion mode	
Playing a Title	
Camera Angle	
Changing the Audio Language	
Changing the Audio Channel	
Subtitles	
Playing MP3/ WMA/picture disc	27
MP3/WMA/picture disc	
Mixed-mode disc	28

DVD Menu Operations

Using the system menu	29
Setting language preference	
Setting video preference	
Setting audio	
Night Mode	
Setting Rating	

Radio Reception

Tuning to radio stations	32
Programming radio stations	32
Automatic programming	
Manual programming	
Tuning to preset radio stations	32
Changing tuning grid	33

Tape Operation/Recording

Tape playback	34
Rewinding / Fast forwarding	34
General information on recording	34
Preparation for recording	35
Synchro start CD recording	35
One touch recording	35
Recording timer	35

Clock/Timer

Clock setting	36
Timer setting	36
Activating and deactivating timer	
Sleep timer setting	36

Specifications 37

Troubleshooting 38-39

Glossary 40

General Information

Features

Your DVD Micro System with 2-channel full digital amplifier creates the same dynamic sound qualities that you find in full-fledged cinemas and incorporates some of the best features in home theater technology.

Additional Component Connections

Lets you connect other audio and audio/visual components to the system so you can use the system's surround sound speakers.

Parental control (rating level)

Lets you set a rating level so that your children cannot watch a DVD that has a rating higher than you set.

Sleep timer

Enables the system to switch to standby mode automatically at a preset time.

Night Mode

Lets you compress the dynamic range, reducing the difference in loudness between different sounds in Dolby Digital mode.

Discs for playback

Your DVD System will play:

- DigitalVideo Discs (DVDs)
- Video CDs (VCDs)
- SuperVideo CDs (SVCDs)
- Windows Media Audio (WMA)
- DigitalVideo Discs + Rewritable (DVD+RW)
- Compact Discs (CDs)
- Picture (Kodak, JPEG) files on CDR(W)
- Supported MP3-CD format.
- ISO 9660 format
- Max. title/album name –12 characters
- Max. title number plus album is 255.
- Max. nested directory is 8 levels.
- The max. album number is 32.
- The max. MP3 track number is 999.
- Supported sampling frequencies for MP3 disc: 32 kHz, 44.1 kHz, 48 kHz.
- Supported Bit-rates of MP3 disc are: 32, 64, 96, 128, 192, 256 (kbps).



The following formats can't be supported

- The files like *.VMA, *.AAC, *.DLF, *.M3U, *.PLS, *.WAV,
- Non-English Album/Title name
- The discs recorded under Joliet format

Region codes

DVDs must be labeled for **ALL** regions or **Region 3** (for Asia Pacific) or **4** (for Latin America) in order to play on this DVD system. You cannot play discs that are labeled for other regions.



Notes:

- For mixed mode discs, only one mode will be selected for playback according to the recording format.
- If you are having trouble playing a certain disc, remove the disc and try a different one. Improperly formatted discs will not play on this system.

Supplied accessories

- Composite video cable (yellow)
- Audio cables (white, red)
- FM wire antenna
- MW loop antenna
- Plug adapter (not for all versions)
- Remote Control and two AA batteries



- This instruction booklet and a Quick Use Guide

Environmental information

Any unnecessary packaging has been omitted. We have tried to make the packaging easy to separate into three materials: cardboard (box), polystyrene foam (buffer) and polyethylene (bags, protective foam sheet).

Your system consists of materials which can be recycled and reused if disassembled by a specialised company. Please observe the local regulations regarding the disposal of packaging materials, exhausted batteries and old equipment.

Care and safety information

Avoid high temperatures, moisture, water and dust

- Do not expose the system, batteries or discs to humidity, rain, sand or excessive heat (caused by heating equipment or direct sunlight). Always keep disc trays closed to avoid dust buildup on the lens.
- No objects filled with liquids, such as vases, shall be placed on the apparatus.
- No naked flame sources, such as lighted candles, should be placed on the apparatus.
- The apparatus shall not be exposed to dripping or splashing.
- Install this unit near the AC outlet and where the AC power plug can be reached easily.

Avoid condensation problem

- The lens may cloud over when the player is suddenly moved from cold to warm surroundings, making it impossible to play a disc. Leave the player in the warm environment until the moisture evaporates.

Do not block the vents

- Do not operate the system in an enclosed cabinet and allow about 10 cm (4 inches) of free space all around the player for adequate ventilation.

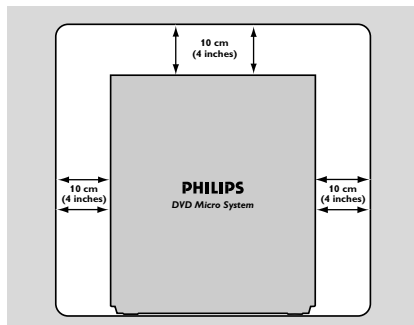

- The ventilation should not be impeded by covering the ventilation openings with items, such as newspapers, table-cloths, curtains, etc.

Cleaning the cabinet

- Use soft cloth slightly moistened with a mild detergent solution. Do not use a solution containing alcohol, spirits, ammonia or abrasives.

Cleaning discs

- To clean a CD, wipe it in a straight line from the center towards the edge using soft and lint-free cloth. A cleaning agent may damage the disc.
- Write only on the printed side of a CDR(W) and only with a soft felt-tipped pen.
- Handle the disc by its edge. Do not touch the surface.

General Information

Cleaning the disc lens

- After prolonged use, dirt or dust may accumulate at the disc lens. To ensure good playback quality, clean the disc lens with Philips CD Lens Cleaner or any commercially available cleaner. Follow the instructions supplied with cleaner.

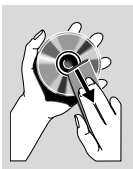

Finding a suitable location

- Place the player on a flat, hard, stable surface.

Cleaning the head and the tape paths

- To ensure good recording and playback quality, clean the head (A), the capstan(s) (B), and pressure roller(s) (C) after every 50 hours of tape operation.
- Use a cotton swab slightly moistened with cleaning fluid or alcohol.
- You also can clean the head by playing a cleaning tape once.

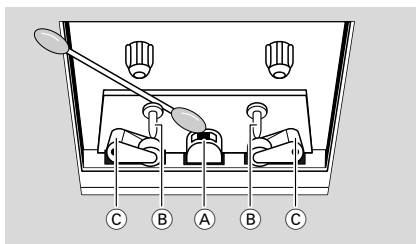

Demagnetising the head

- Use a demagnetising tape available at your dealer.

The making of unauthorized copies of copy-protected material, including computer programmes, files, broadcasts and sound recordings, may be an infringement of copyrights and constitute a criminal offence. This equipment should not be used for such purposes.



**Be responsible
Respect copyrights**

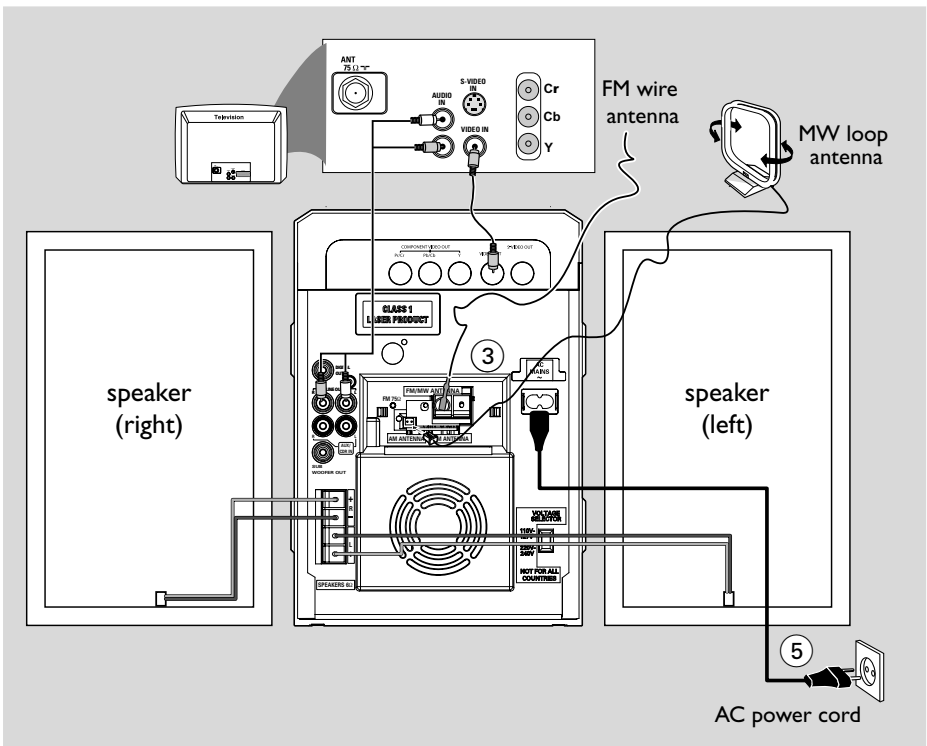

IMPORTANT!

- The type plate is located at the rear of the system.
- Before connecting the AC power cord to the wall outlet, ensure that all other connections have been made.
- Never make or change any connections with the power switched on.
- The voltage selector located at the bottom of this system is preset at 220V-240V from the factory. For countries that operate at 110V-127V, please adjust to 110V-127V before you switch on the system.

To avoid overheating of the system, a safety circuit has been built in. Therefore, your system may switch to Standby mode automatically under extreme conditions. If this happens, let the system cool down before reusing it (not available for all versions).

Step 1: Placing speakers

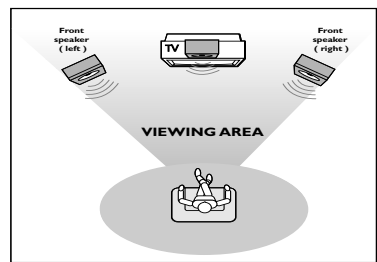

Place the front left and right speakers at equal distances from the TV set and at an angle of approximately 45 degrees from the listening position.

Notes:

- To avoid magnetic interference, do not position the front speakers too close to your TV set.
- Allow adequate ventilation around the DVD System.

Connections

Step 2: Connecting speakers

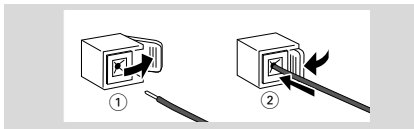

Connect the speaker wires to the **SPEAKERS** terminals, right speaker to "R" and left speaker to "L", coloured (marked) wire to "+" and black (unmarked) wire to "-". Fully insert the stripped portion of the speaker wire into the terminal as shown.

Notes:

- Ensure that the speaker cables are correctly connected. Improper connections may damage the system due to short-circuit.
- For optimal sound performance, use the supplied speakers.
- Do not connect more than one speaker to any one pair of +/- speaker terminals.
- Do not connect speakers with an impedance lower than the speakers supplied. Please refer to the SPECIFICATIONS section of this manual.

Step 3: Antennas Connection

Connect the supplied MW loop antenna and FM antenna to the respective terminals. Adjust the position of the antenna for optimal reception.

MW Antenna

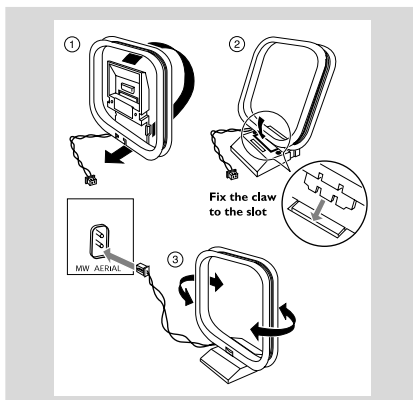

- Position the antenna as far as possible from a TV, VCR or other radiation source.

FM Antenna

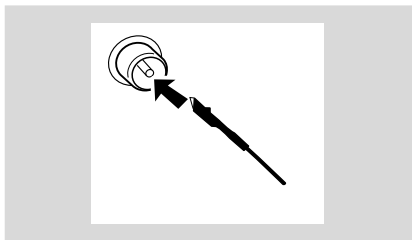

- For better FM stereo reception, connect an outdoor FM antenna to the FM AERIAL (FM ANTENNA) terminal.

Step 4: Connecting TV

IMPORTANT!

- You only need to make one video connection from the following options, depending on the capabilities of your TV system.
- Connect the DVD system directly to the TV.

Using component Video In jack (Cr Cb Y)

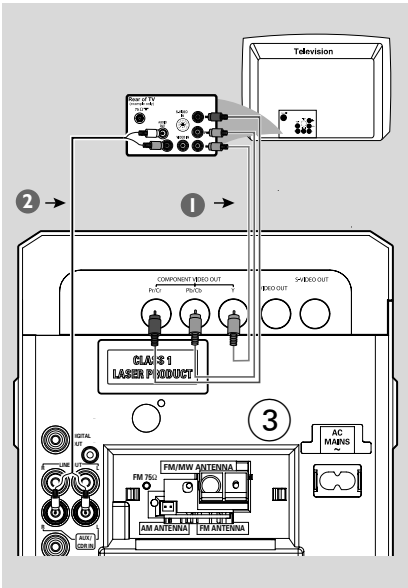

- 1 Use the component video cables (red/blue/green) to connect the system's **Cr Cb Y** jacks to the corresponding Component video input jacks on the TV set.
- 2 To hear the sound of this DVD Player through your TV, use the audio cables (white/red) to connect LINE OUT (L/R) jacks of the DVD Player to the corresponding AUDIO IN jacks on the TV.

Using Composite Video jacks (CVBS)

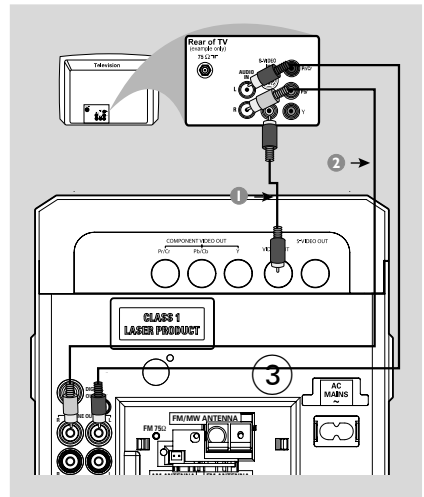

- 1 Use the composite video cable (yellow) to connect the DVD Player's CVBS (VIDEO OUT) jack to the video input jack (or labeled as AV In, Video In, Composite or Baseband) on the TV.
- 2 To hear the sound of this DVD Player through your TV, use the audio cables (white/red) to connect LINE OUT (L/R) jacks of the DVD Player to the corresponding AUDIO IN jacks on the TV.

Connections

Using S-Video In jack

IMPORTANT!

– If the picture is distorted, check the **Video Output** setting. Make sure it is set to 'S-Video'. (See Setting video preference).

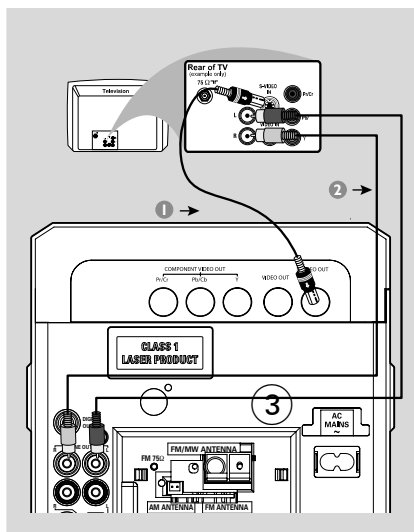

- 1 Use the S-Video cable (not supplied) to connect the system's **S-VIDEO OUT** jack to the S-Video input jack (or labeled as Y/C or S-VHS) on the TV set.
- 2 To hear the sound of this DVD Player through your TV, use the audio cables (white/red) to connect LINE OUT (L/R) jacks of the DVD Player to the corresponding AUDIO IN jacks on the TV.

Using an accessory RF modulator

IMPORTANT!

– If your TV set only has a single **Antenna In** jack (or labeled as 75 ohm or RF In), you will need a RF modulator in order to view the DVD playback via TV. See your electronics retailer or contact Philips for details on RF modulator availability and operations.

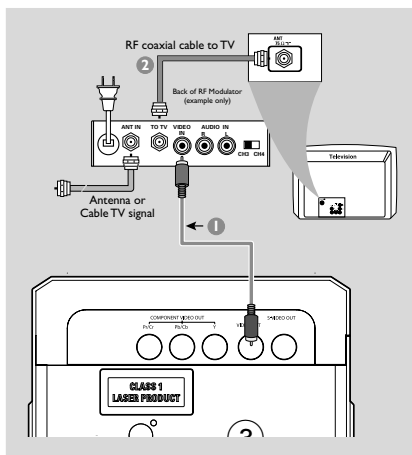

- Use the composite cable (yellow) to connect the system's **CVBS** jack to the video input jack on the RF modulator.
- Use the RF coaxial cable (not supplied) to connect the RF modulator to your TV's RF jack.

Step 5: Connecting the power cord

IMPORTANT!

– **Never make or change any connection with the power switched on.**

"AUTO INSTALL – PRESS PLAY TO START" may appear on the display panel when the AC power cord is plugged into the power outlet for the first time.

Press ►|| on the main unit to store all available radio stations or press ■ to exit (refer to "Tuner Reception").

After everything is connected properly, plug in the AC power cord to the power outlet.

Optional: Connecting additional equipment

IMPORTANT!

- Some discs are copy-protected. You cannot record the disc through a VCR or digital recording device.
- When making connections, make sure the colour of cables matches the colour of jacks.
- Always refer to the owner's manual of the other equipment for complete connection and usage details.

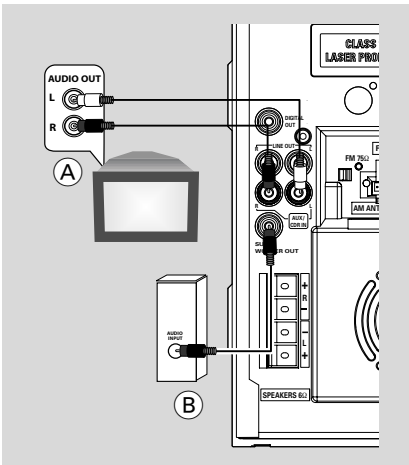

Viewing and listening to the playback of other equipment (A)

Connect the system's **AUX** (R/L) jacks to the AUDIO OUT jacks on the other audio/visual device (such as a TV, VCR, Laser Disc player or cassette deck).

Before starting operation, press **SOURCE** on the front panel to select AUX or press **AUX** on the remote in order to activate the input source.

Connecting an active subwoofer (B)

Connect the DVD micro system's **SUBWOOFER OUT** jack to the AUDIO INPUT jack on an active subwoofer (not supplied).

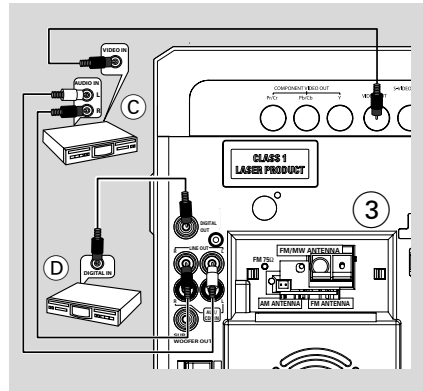

Using the VCR for recording DVDs (C)

Connect one of the system's **VIDEO OUT** jacks to the corresponding VIDEO IN jack and **LINE OUT (R/L)** jacks to the AUDIO IN jacks on the VCR. This will allow you to make analogue stereo (two channel, right and left) recordings.



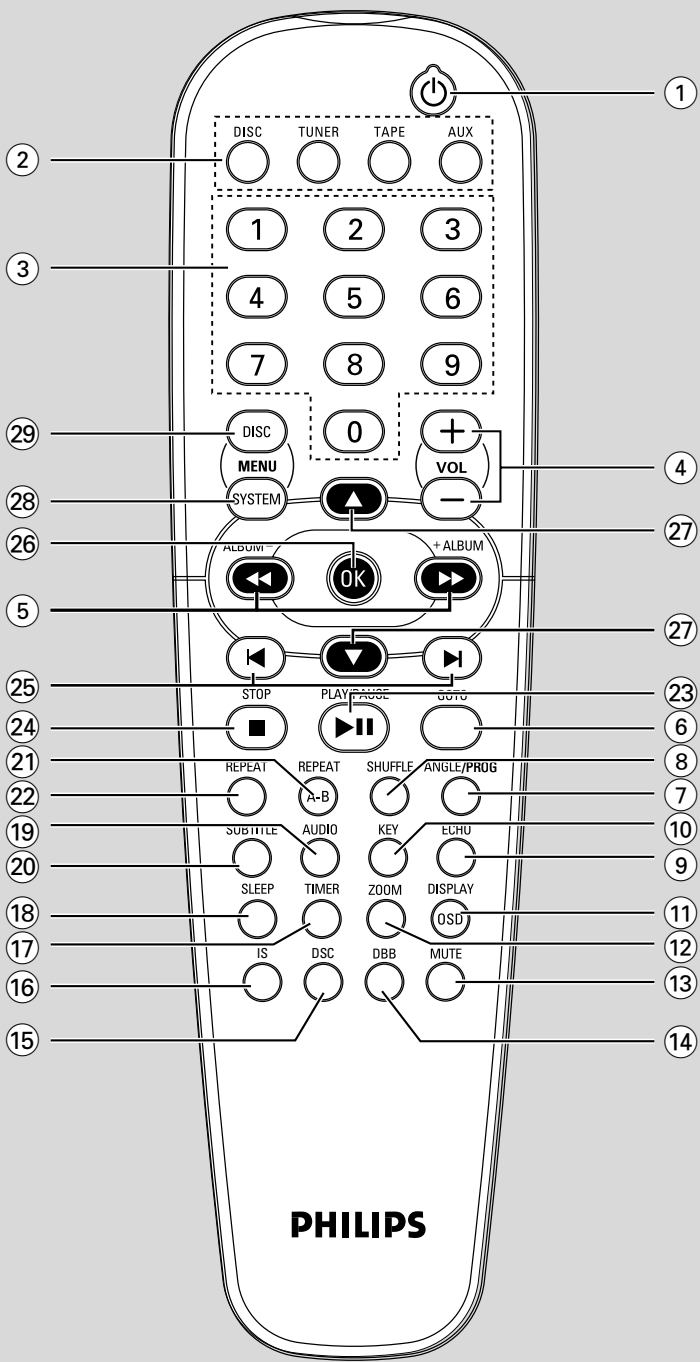

Recording (digital) (D)

Connect the system's **DIGITAL OUT** jack to the DIGITAL IN jack on a digital recording device (such as DTS-Digital Theatre compatible, with Dolby Digital decoder).

Before starting operation, set the DIGITAL OUT according to the audio connection. (See page 29)



Controls on the system

- ① **ECO POWER/STANDBY-ON** 
 - to switch the system on or to Eco power/normal standby mode.
- ② **Display screen**
 - to view the current status of the system.
- ③ **SOURCE**
 - to select the respective sound source : DISC, TUNER, TAPE or AUX.
- ④ **BAND / DISPLAY**
 - for Tunerto select waveband : FM or MW.
 - for DVD/VCD/CD/MP3-CD displays disc information on the TV screen and system display panel during playback.
- ⑤ **PROGRAM**
 - for VCD/CD/MP3-CD...to program disc tracks.
 - for Tunerto program preset radio stations.
- ⑥ **▲▼ ALBUM/PRESET/TIMER SET**
 - for MP3-CDto select previous/next album.
 - for Tunerto select a preset radio station.
 - *for Timer (▲)...to set the timer function
- ⑦ **TUNING**    
 - *for DVD/VCD/CD.....to fast reverse / forward the disc. (It is impossible to fast reverse / forward for MP3-CD)
 - for DVD/VCD/CD/MP3 CD... to select a desired track.
 - for Tuner to tune to a lower or higher radio frequency.
 - for Tape to rewind or fast forward.
 - for clock/timer settingto adjust the hours and minutes for the clock/timer functions.

⑧ Tape deck

- ⑨ **OPEN/CLOSE** 
 - to open the tape compartment.
- ⑩ **▶ II**
 - to start or interrupt playback.
- ⑪ **■**
 - for DVD/VCD/CD/MP3-CD...to stop playback or to clear a program.
 - for Tapeto stop playback or recording.

⑫ VOLUME

- to increase or decrease the volume.

⑬ RECORD

- to start recording.

⑭ CLOCK SET

- *for Clock..... (on the system only) to set the clock function.

⑮ iR sensor

- infrared sensor for remote control.

⑯ OPEN-CLOSE

- to open or close the disc tray.

⑰ DSC

- selects different types of preset sound equalizer settings (JAZZ, ROCK, POP or OPTIMAL).

⑱ DBB/INCREDIBLE SURROUND

- to create a super-enhanced stereo effect.
- to enhance the bass.

⑲

- to connect headphones.



⑳ MIC IN

- to connect microphone

㉑ MIC VOL

- to adjust the mixing level for Karaoke

Controls on the remote control

- ① 
 - to switch the system on or to Eco power/normal standby mode.
- ② **SOURCE**
 - to select the respective sound source : DISC, TUNER, TAPE or AUX.
- ③ **Numeric Keypad (0-9)**
 - to enter a track/title number of the disc.
- ④ **VOL + / -**
 - to increase or decrease the volume.
- ⑤ **ALBUM-/ +  **
 - to select a fast playback speed forward and backward.
 - in the tuner mode, to tune to a higher or lower radio frequency.
 - to select a movement direction in the disc menu or system menu bar.

Controls

- for MP3, to select an album up or down.
- for VCD/DVD, to move an enlarged picture left or right.

⑥ GOTO

- to start playback at any chosen time on the disc (for VCD operation with PBC off).

⑦ ANGLE/PROG

- for VCD/CD/MP3-CD...to program disc tracks.
- for Tunerto program preset radio stations.
- for DVDto view the same scene from different angles if the DVD is recorded with multi-angles.

⑧ SHUFFLE

- to play tracks in a random order

⑨ ECHO

- to select MIC ON or OFF.
- to select Echo On or Off in the karaoke mode.

⑩ KEY

- to select MIC ON or OFF.
- to change the VCD key tone level to suit your vocal range

⑪ DISPLAY (OSD)

- displays disc information on the TV screen and system display panel during playback.

⑫ ZOOM

- to zoom in picture.

⑬ MUTE

- to interrupt or resume sound reproduction.

⑭ DBB (Dynamic Bass Boost)

- Enhances the bass

⑮ DSC

- to select various sound effect: JAZZ, ROCK, POP or OPTIMAL.

⑯ IS

- to switch incredible surround on or off.

⑰ TIMER

- * – to set the timer.
- to select TIMER ON or TIMER OFF.

⑱ SLEEP

- to set the sleep (auto-off) timer function.

⑲ AUDIO

- For VCD...sets Stereo, Mono-Left or Mono-Right sound mode.
- For DVD...selects an audio language.

⑳ SUBTITLE

- to select the preferred language for subtitle.

㉑ REPEAT A-B

- for CD: to repeat a specific section within the same track.
- for DVD/VCD: to repeat a specific section in a disc.

㉒ REPEAT

- to repeat a track/disc.

㉓ PLAY/PAUSE ►►

- to start or interrupt disc playback.

㉔ STOP ■ - for CD/DVD/VCD (with PBC off)

- press it once to stop playback and press ►► to resume.
- press it twice to stop playback completely.

㉕ ◀, ▶

- In disc mode, to select the previous or next chapter or track.

㉖ OK

- to exit or confirm the selection.

㉗ ▲, ▼

- to select a movement direction in the disc menu or system menu bar.
- (for DVD/VCD only) to select a desired slow playback speed forward or backward.

㉘ SYSTEM MENU (disc mode only)

- to enter or exit the system menu bar.

㉙ DISC MENU (disc mode only)

- to enter or exit the disc contents menu.

Notes for remote control:

- First, select the source you wish to control by pressing one of the source select keys on the remote control (DISC or TUNER, for example).
- Then select the desired function (►►, ◀, ▶ for example).

* = Press and hold the button for more than two seconds.

IMPORTANT!

Before you operate the system, complete the preparation procedures.

Switching the system on

- Press **ECO POWER/STANDBY-ON**  or **SOURCE**.
→ The system will switch to the last selected source.
- Press **DISC, TUNER, TAPE** or **AUX** on the remote control.
→ The system will switch to the selected source.

Switching the system to Eco Power Standby mode

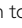
- Press **ECO POWER/STANDBY-ON**  in the active mode.
→ The system enters Eco power standby (the ECO POWER LED is on) or normal standby with clock display.
- The volume level (up to a maximum volume level of 18), interactive sound settings, last selected mode, source and tuner presets will be retained in the player's memory.
- If the system is normal standby with clock display, press and hold **ECO POWER/STANDBY-ON**  for 3 seconds or more to switch to Eco power standby or vice versa.

Power-saving automatic standby

As a power-saving feature, the system will automatically switch to Standby mode if you do not press any buttons within 30 minutes after a disc or tape has stopped playing.

Volume control

Adjust **VOLUME (VOL + / -)** to increase or decrease the volume level.
→ Display shows the volume level "VOL" and a number from 1-31. "MIN" denotes the minimum volume level and "MAX" denotes the maximum volume level.

To switch off the volume temporarily

- Press **MUTE** on the remote control.
→ Playback will continue without sound and "MUTE" is displayed.
- To restore the volume, press **MUTE** again or increase/decrease the volume level.

Listening through headphones

Connecting headphones to  will switch off the speakers. The system will switch STEREO and the surround sound will be reduced to a stereo signal which is reproducible by standard headphones.

Disconnecting the headphones will switch on the speakers again. If you wish to enjoy surround sound again, switch the system back to surround sound.

Sound control

- Press **DSC** repeatedly to select the desired sound effect : **ROCK, JAZZ, POP** or **OPTIMAL**.
- Press **DBB/INCREDIBLE SURROUND** on the system to switch on or off the surround sound effect or bass enhancement.
→ The sequences are as follows :
DBB OFF, IS ON → DBB ON, IS OFF → DBB ON, IS ON → DBB OFF, IS OFF
- You can also press **DBB** or **IS** on the remote to turn on or off the DBB or IS function respectively.

Note:

– The effect of **INCREDIBLE SURROUND** may vary with different types of music.

Basic Functions

Microphone Mixing

Connect microphones (not supplied) to the system to sing along with the music source.

- ① Connect microphones to **MIC** jack.
- Before connecting the microphone, set the microphone level with VOL to the lower level to prevent howling sound by turning the MIC VOL knob.
- ② Select **DISC** to start playback.
- Press **ECHO** to select MIC ON.
- ③ Adjust the volume level of the source with **VOLUME +/-** control.
- ④ Press **ECHO** again to select ECHO ON or OFF. Press **OK** to confirm.
- ⑤ Start singing or talking through the microphone.
- ⑥ Press **KEY** to select key tone if necessary.

Note:

– *Keep the microphones away from the speakers to prevent howling.*

Key Control

This feature allows you to change the key tone of your vocal range.

- Press **KEY** on the remote control.
→ "--KEY SHIFT+" appears on the TV screen.
- Press **ALBUM +/- << / >>** on the remote control to decrease or increase the vocal key level between -7 and +7.

Echo

This feature allows you to add echo while singing or talking through a microphone.

- Press **ECHO** on the remote control to select ECHO ON or ECHO OFF.

IMPORTANT!

- Make sure to complete the preparation procedures before operating the system.

Step 1: Inserting batteries into the remote control

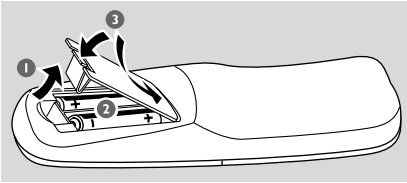

- 1 Open the battery compartment.
- 2 Place two batteries (Type R06 or AA) in the compartment with the correct polarity as indicated by "+" and "-" symbols.
- 3 Close the cover.

Using the remote control to operate the system

- 1 Point the remote control directly at the remote sensor (iR) on the front panel.
- 2 Select the source you wish to control by pressing one of the source select buttons on the remote control (for example TAPE, TUNER).
- 3 Then select the desired function (for example ►II, I◀, ►I).

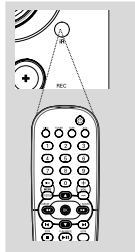

CAUTION!

- Remove batteries if they are exhausted or will not be used for a long time.
- Do not use old and new or different types of batteries in combination.
- Batteries contain chemical substances, so they should be disposed of properly.

Step 2: Setting the clock

- 1 In standby mode, press and hold **CLOCK SET** on the system.
→ "SET CLOCK" appears. Then, the clock digits for the hours flash.
- 2 Press **TUNING** |◀◀▶▶| on the system to set the hours.
- 3 Press **CLOCK SET** again.
→ The clock digits for the minutes flash.
- 4 Press **TUNING** |◀◀▶▶| on the system to set the minutes.
- 5 Press **CLOCK SET** to confirm your setting.
The system will store the setting automatically.
→ The time setting becomes effective.

Note:

- The clock will be cancelled when the power cord is disconnected or if a power failure occurs.
- During setting, if no button is pressed within 30 seconds, the system will exit clock setting mode automatically.

Preparations

Step 3: Setting language preference

You can select your preferred language settings so that this DVD Micro System will automatically switch to the language for you whenever you load a disc. If the language selected is not available on the disc, the language set by default will be used instead. But the menu language of the DVD Micro System cannot be changed once selected.

Language	Video	Audio	Rating
OSD Menu	English	English	
Subtitle	English	Français	
Audio	English	Español	
Menu	English	Português	
		中文	

- 1 In stop mode, press **SYSTEM MENU**.
- 2 Press ◀◀/▶▶/▲/▼ on the remote control to select your preferred option.
 - Move to **Language** and press **OK** or ▼.
 - Move to one of the following and press **OK** or ▶▶.

OSD Menu (On-Screen Display)

Switches the display language on the TV screen. Select the language from the displayed list.

Subtitle (DVD only)

Switches the display language of the subtitle. Select the language from the displayed list.

Audio (DVD only)

Switches the display language of the sound track. Select the language from the displayed list.

Menu (DVD only)

Select the language for the DVD menu.

When the selected language is not recorded in the DVD, one of the recorded languages will be selected automatically (except for OSD). You can reset all the DVD settings except for Rating.

If the language selected is not available on the disc, the original language designated by each disc will be selected.

- 3 Press ▲/▼ to select a language and press **OK**.
- 4 Repeat **steps 2~3** for other settings.

To remove the menu

Press **SYSTEM MENU**.

IMPORTANT!

- **Make sure you have completed all the necessary connections. (See Connections**
- **Connecting TV.)**

Step 4: Setting video preference

Turn on the TV set and set it to the correct Video-In channel.

- You may go to channel 1 on your TV set, then press the channel button repeatedly until you see the Video In channel.
- Or, you can use the TV remote control to select different video modes.
- Or, set TV to channel 3 or 4 if you are using an RF modulator.

Language	Video	Audio	Rating
TV Shape	4:3 LB		4:3 PS
TV System	Auto		4:3 LB
Video Out	S-VIDEO		16:9

- 1 In the disc mode, stop playback and press **SYSTEM MENU**.
- 2 Press ◀◀/▶▶/▲/▼ on the remote control to toggle through the functions and select your preferential option.
 - Move to **Video** and press **OK** or ▼.
 - Move to one of the following and press **OK** or ▶▶.

– TV Shape

Selects the aspect ratio of the TV to be connected.

4:3 PS (Pan and Scan mode)

– If you have a conventional TV set and your DVD is not formatted for widescreen viewing, use this setting. A wide picture is displayed on the whole TV screen with a portion automatically cut off.

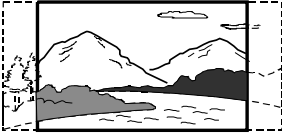

4:3 LB (Letterbox mode)

– If you have a conventional TV set and your DVD is formatted for widescreen viewing, use this setting. A wide picture with bands displayed on the upper and lower portions of the TV screen.



16:9 (Wide screen mode)

– If you have a widescreen TV set, use this setting (you must also set your widescreen TV to “full size”) available on a disc, then the disc’s own preference will be used.

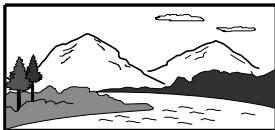

Note:

The format you select must be available on the disc. If it is not, the setting for TV Shape will not affect the picture during playback.

– TV System

Allows you to select the color system matching the connected TV set.

NTSC

– If the connected TV is NTSC system, select this mode. It will change the video signal of a PAL disc and output in NTSC format.

PAL

– If the connected TV is PAL system, select this mode. It will change the video signal of an NTSC disc and output in PAL format.

AUTO

– If the connected TV is multi system, select this mode. The output format will be in accordance with the video signal of the disc.

– Video Out

– Video out selection enables you to choose the type of video output suitable for your DVD system.

S-VIDEO

– Select **S-VIDEO** if you have connected the S-VIDEO output to your TV using S-VIDEO jack.

Pr/Cr Pb/Cb Y

– Select **Pr/Cr Pb/Cb Y** if you have connected the video output to your TV using Pr/Cr Pb/Cb Y jack.

To remove the menu

Press **SYSTEM MENU**.

To resume playback

Press **▶II** (**PLAY/PAUSE ▶II** on the remote).

Disc Operations

IMPORTANT!

- This system is designed for regular discs. Therefore, do not use any accessories such as disc stabiliser rings or disc treatment sheets, etc., as offered on the market, because they may jam the disc mechanism.
- Do not move the system during playback. Doing so may damage the system.
- DVD discs and players are designed with regional restrictions. Before playing a disc, make sure the disc matches the regional code of your player.
- According to the format requirement of DVD or VCD, some operations may be different or restricted.
- Do not push on the disc tray or put any objects other than disc on the disc tray. Doing so may cause the disc player malfunction.
- If \emptyset appears on the TV screen when a button is pressed, it means the function is not available on the current disc at the current time.

Playing discs

- 1 Connect the power cords of the DVD Player and TV (and any optional stereo or AV receiver) to a power outlet.
- 2 Turn on the TV power and set to the correct Video In channel. (See "Preparations: Step 4: Setting video preference").
- 3 Press **ECO POWER/STANDBY-ON** ϕ (ϕ on the remote).
→ You should see the Philips DVD background screen on the TV.
- 4 Press **OPEN •CLOSE** \blacktriangle to open the disc door and load in a disc, then press the same button again to close the disc door.
→ Make sure the label side is facing up. For double-sided discs, load the side you want to play facing down.

- 5 Playback will start automatically. If not press **▶II** (**PLAY/PAUSE ▶II** on the remote).
→ If a disc menu appears on the TV, see "Using the Disc Menu".
→ If the disc is locked by parental control, you must enter your four-digit password. (See page 30).

Note:

- To ensure good system performance, wait until disc reading is completed before proceeding.

Using the disc menu

For disc with Table Of Contents, a menu may appear on the TV screen once you load the disc.

To select a playback feature or item

- Use \blacktriangle / \blacktriangledown / \blacktriangleleft / \blacktriangleright and **OK** or **Numeric Keypad (0-9)** on the remote.
→ Playback will start automatically.

To access or exit the menu

- Press **DISC MENU** on the remote.

For VCD with Playback Control (PBC) feature (version 2.0 only)

PBC playback allows you to play Video CDs interactively, following the menu on the display.

- In stop mode, press **DISC MENU**.
→ If PBC was ON, it will switch to OFF and continue playback.
→ If PBC was OFF, it will switch to ON and return to menu screen.

Basic playback controls

Pausing playback

- 1 During playback, press **▶II** (**PLAY/PAUSE** **▶II** on the remote).
→ Playback will pause and sound will be muted.
- 2 To resume normal playback, press **▶II** (**PLAY/PAUSE** **▶II** on the remote) again.

Skipping to another title (track)/chapter

- Press **TUNING** **◀◀/▶▶** (**◀/▶** on the remote) repeatedly during playback to skip backward or forward. Each press will take the disc to the beginning of the previous or next title (track)/chapter.

Note:

– If the player has been set to repeat chapter (track), pressing this button will replay the same chapter (track) from its beginning.

To go directly to any title (track)/chapter (Not for DVD)

- Use the **Numeric Keypad (0-9)** to enter the number of the desired title (track)/chapter.

Resuming playback from the last stopped point

- In stop mode and when a disc has not been removed, press **▶II** (**PLAY/PAUSE** **▶II** on the remote).

To cancel resume mode

- In stop mode, press **■** (**STOP** **■** on the remote) again.

Repeat play mode

In this mode, all tracks in the current directory will be played repeatedly.

For DVD - repeat chapter/title.

- 1 Press **REPEAT** repeatedly to select Repeat Chapter → Repeat Title → Repeat Off.

For SVCD, VCD (with PBC off)/CD/MP3/WMA-CD - repeat track or disc.

- Press **REPEAT** repeatedly to select the following: Repeat Track → Repeat All → Repeat Off.

Shuffle play mode

In this mode, all tracks in the current directory will be played once in a random order.

- 1 Press **SHUFFLE** to play in a shuffle order.
- 2 Press **SHUFFLE** repeatedly to select the following: Shuffle On → Shuffle Off
- 3 Playback starts automatically.

In shuffle playback mode:

- Press **TUNING** **▶▶** (**▶** on the remote) to select another track in a shuffle order.
- 4 Press **■** (**STOP** **■** on the remote) to stop shuffle playback.

To cancel Shuffle mode:

- Press **SHUFFLE** repeatedly to select Shuffle Off.

Notes:

– In Tuner, Tape or AUX mode, this button does not function.

– When the disc tray is opened, the Shuffle function will be cancelled automatically.

– The Shuffle playback mode is not available for DVD and VCD 2.0 when PCB is on.

Repeating a section within a chapter/track

You can play a specific section in a chapter/track repeatedly.

- 1 Press **REPEAT A-B** at your chosen start point.
- 2 Press **REPEAT A-B** again at your chosen end point.
→ The passage will now repeat continuously.
- 3 To resume normal playback, press **REPEAT A-B** again.

Disc Operations

Fast search

- Press and hold **TUNING** (◀◀/▶▶) (◀◀/▶▶) on the remote) to fast reverse or forward the disc.

For DVD/VCD

(reverse): ◀◀ X2 → ◀◀ X4 → ◀◀ X8 →
◀◀ X20 → PLAY ▶
(forward): ▶▶ X2 → ▶▶ X4 → ▶▶ X8 →
▶▶ X20 → PLAY ▶

For CD

(reverse): ◀◀ X2 → PLAY ▶
(forward): ▶▶ X2 → PLAY ▶

- 3 To resume normal play, press ▶▶ (PLAY/PAUSE) ▶▶ on the remote).

Note:

– This function is not available for MP3/WMA discs.

Programming favorite tracks

You can play the contents of the disc in the order you want. At most 20 tracks can be stored.

- 1 Load the desired disc on the disc tray.
- 2 While playback is stopped, press **PROGRAM** (ANGLE/PROG on the remote) to enter program mode.
→ The following menu is displayed on the TV screen.

Program Input			
1---	6---	11---	16---
2---	7---	12---	17---
3---	8---	13---	18---
4---	9---	14---	19---
5---	10---	15---	20---

- 3 Use the **Numeric Keypad (0-9)** to input the track number in the order you want.
- 4 Press **OK** to store the track.
- Repeat step 3 to store other tracks.
- 5 Press ▶▶ (PLAY/PAUSE) ▶▶ on the remote) to play the program.
- 6 To exit the program mode, press ■ (STOP) on the remote).

Notes:

- This function is not available for DVD discs and VCD 2.0 when PCB is on.
- If you open the disc compartment, the program will be cleared.

GOTO

This function allows you to start playback at any chosen time on the disc.

- 1 Press **GOTO** during playback.
→ A window appears on the TV for you to input time and title/chapter number.

For DVD

Search	
Time	--:--:--
Title/Chapter	--/--

For CD/VCD/SVCD

Search	
Time	--:--:--
Track	---

- 2 Use the **Numeric Keypad (0-9)** to input the time, from which playback will start.
OR
Press ▼ on the remote and then use the **Numeric Keypad (0-9)** to input the desired track number.
- 3 Press **OK** to confirm.

Notes:

- In the repeat all mode, you can search a desired time point.
- This function is not available for MP3/WMA.
- It is impossible to set time and track number at the same time.

Zoom

Zooming allows you to enlarge the video image during playback.

- 1 Press **ZOOM** repeatedly to enlarge the playback video image.
- 2 Press **<<|>>|▲/▼** to pan across the TV screen.

Special disc features

Playing in slow motion mode (for DVD/VCD/SVCD)

- 1 Press **▲/▼** on the remote control repeatedly to select the required slow motion speed:
Press **▼** repeatedly to select:
▶1/2 → ▶1/4 → ▶1/6 → ▶1/8 → PLAY▶
Press **▲** repeatedly to select:
◀1/2 → ◀1/4 → ◀1/6 → ◀1/8 → PLAY▶
▶ =slow forward
◀ =slow reverse

Playing a Title (for DVD)

- 1 Press **DISC MENU**.
→ The disc title menu appears on the TV screen.
- 2 Use **<<|>>|▲/▼** on the remote to select a play option.
- 3 Press **OK** to confirm.

Camera Angle (for DVD)

- Press **ANGLE/PROG** on the remote to view the same scene from different angles if the DVD is recorded with multiple angles.

Changing the Audio Language (for DVD recorded with multiple languages)

- Press **AUDIO** repeatedly to select different audio languages.

Changing the Audio Channel (for VCD only)

- Press **AUDIO** to select the available audio channels provided by the disc (Mono Left, Mono Right or Stereo).

Subtitles (DVD)

- Press **SUBTITLE** repeatedly to select different subtitle languages.

Playing MP3/WMA/picture disc (Kodak, JPEG)

IMPORTANT!

- You have to turn on your TV set and set to the correct Video In channel.

MP3/WMA/picture disc

- 1 Load an MP3/WMA/Picture disc.
- 2 Playback will start automatically.
→ The album menu will appear on the TV screen.

CD-R		1/196 0:00:00	
cd01			
1	♫ 001	6	♫ 006
2	♫ 002	7	♫ 007
3	♫ 003	8	♫ 008
4	♫ 004	9	♫ 009
5	♫ 005	10	♫ 010

- 3 Press **ALBUM/PRESET ▲/▼ (ALBUM-/+ <<|>>|)** on the remote) to select a desired album, then press **OK** to confirm (for MP3/WMA disc only).
- 4 Press **TUNING <<|>>| (▲/▼ or <|>|)** on the remote) to select a desired track, then press **OK** to start playback.
- You can also use the **Numeric Keypad (0-9)** to enter your choice and then press **OK** to start playback.
- 5 To stop playback, press **■ (STOP■)** on the remote).

To show the menu for a picture disc

Press **■ (STOP■)** on the remote).

Mixed-mode disc

To play a mixed-mode disc, you need to select the playback priority for CD or data files through the system menu.

Language	Video	Audio	Rating
Digital Out	PCM	PCM	
PCM 48KHz	Off		
Priority	CD	CD	
Night Mode	Off		

- 1 Press **SYSTEM MENU** in the stop mode.
- 2 Press **◀◀/▶▶** to select **Audio** and press **▼** to move to "Priority". Then, press **OK** or **▶▶** to enter its submenu and press **▲/▼** to select **CD** or **Data**.

→ The contents in the CD format or data contents will be played.

The contents may be MP3 files, Kodak pictures or JPEG pictures.

The default setting is CD.
MP3:

If an MP3 file exists in the disc, the system recognizes the disc as an "MP3 Disc". If only JPEG files exist in the disc, the system recognizes the disc as a "JPEG Disc".

JPEG:

If a JPEG file exists in the disc, the system recognizes the disc as a "JPEG Disc". If only MP3 files exist in the disc, the system recognizes the disc as an "MP3 Disc".

Using the system menu

To enter the system menu, you should stop playback first.

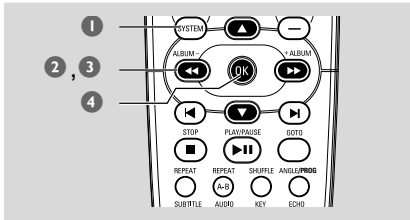

- 1 In stop mode, press **SYSTEM MENU**.
→ The menu bar will appear across the top of the TV set screen.

Language	Video	Audio	Rating
OSD Menu	English	English	
Subtitle	English	Français	
Audio	English	Español	
Menu	English	Português	
		Deutsch	

- 2 Press ◀◀ / ▶▶ / ▲/▼ on the remote control to navigate in the menu.
→ Press ◀◀ / ▶▶ to move through the menu bar.
→ Press ▼ to enter the selection.
- 3 Press **OK** to confirm the selection.
- 4 Press ▶▶ (PLAY/PAUSE ▶▶ on the remote) to resume playback.

Setting language preference

Please see Page 22.

To select preferred language (DVD only)

When you press **AUDIO** on the remote control, the channels being played will be displayed on the TV screen.

For example, in the Dolby Digital format, multiple signals ranging from monoral to 5.1 channel can be recorded on a DVD. The number of channels may vary depending on the actual DVD.

To display the subtitle (DVD only)

For DVDs recorded in multiple languages, you can change the subtitle language during playback, or turn on or off the subtitle display whenever you want.

For example, you can select the language you understand and turn the subtitle on for better understanding.

Press **SUBTITLE** repeatedly on the remote control during playback.

Each time you press the button, the language will change.

Notes:

- For some DVDs, you may not be able to change the subtitle languages even if multilingual subtitles are recorded in the disc.
- If your desired language is not set in the disc, you cannot select the languages via this function.

Setting video preference (DVD only)

Please see Pages 22-23.

Setting audio

To set Priority, please see page 28.

To set Digital Out and PCM 48 KHz

Language	Video	Audio	Rating
Digital Out	PCM		
PCM 48KHz	Off		
Priority	CD		CD
Night Mode	Off		
	On		

- 1 In stop mode, select **Audio** from the menu bar, and then press **OK**.
- 2 Press ▶▶ and ▲/▼ to select PCM or ALL.
Select **ALL** if you have connected the digital output to a multifunctional decoder receiver.
Select **On** for **PCM 48K** if the external component is incapable of processing 96KHz digital signal input, and then convert the standard signal with the sampling rate of 48KHz.

DVD Menu Operations

Night Mode - turning On / Off

Off

Select this when you want to enjoy the surround sound with its full dynamic range.

On

Select this to level out the volume. High volume output will be softened and low volume output will be brought upward to an audible level. This feature is only available for movies with Dolby Digital mode.

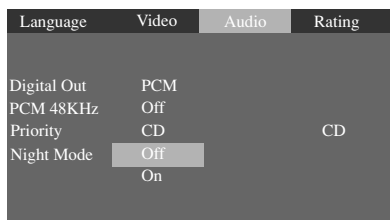

To remove the menu

Press **SYSTEM MENU**.

IMPORTANT!

– Some operations may be different or restricted according to the disc format. Refer to the jacket or care of the disc you are playing.

Setting Rating

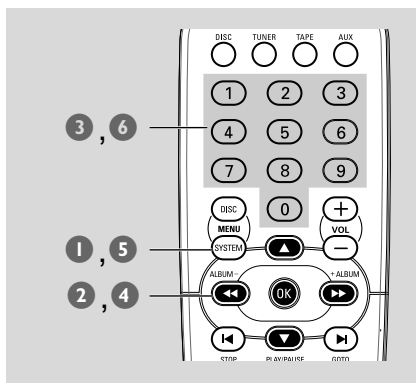

Some DVDs may have a parental level assigned to the complete disc or to certain scenes on the disc. This feature lets you set a playback limitation level. The rating levels are from 1 to 8 and are country specific. You can prohibit the playing of certain discs that are not suitable for your children or have certain discs played with alternative scenes.

- 1 In stop mode, press **SYSTEM MENU**.
- 2 Use ◀▶ / ▲▼ on the remote control to navigate in the menu.
→ Move to **RATING** and press **OK** or ▶▶.

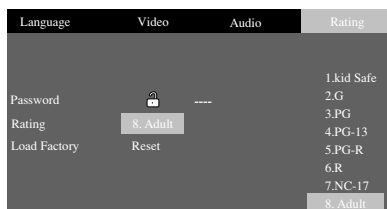

- 3 Use the **Numeric Keypad (0-9)** to enter the four-digit code.
- 4 Press ▲▼ to select a rating level between 1-8 and press **OK**.
→ DVDs rated above the level you select will not play unless you enter your four-digit password or choose a lower level rating.
- 5 Press **SYSTEM MENU** again to cancel the menu.

Rating explanations

8 ADULT – material for adults only; viewed only by adults due to graphic sexual scenes, violence, or language.

7 NC-17 – No children under age 17; not recommended for children under age 17.

5-6 PG-R, R – Parental Guidance – Restricted; recommended that parents restrict children under 17 from viewing or allow them to view only when supervised by a parent or adult guardian.

4 PG 13 – Material is unsuitable for children under age 13.

3 PG – Parental Guidance suggested.

2 G – General Audience; recommended as acceptable for viewers of all ages.

1 KID SAFE – Suitable for children.

- 6 Enter or re-enter your 4-digit password using the **Numeric Keypad (0-9)**, and then press **OK**.
The lock icon is closed and the parental control setting is completed.

To deactivate the rating control function

Enter your 4-digit password using the **Numeric Keypad (0-9)**, and then press **OK**.

The lock icon is opened and the parental control setting is turned off.

- 1 At step 6, enter your 4-digit password using the **Numeric Keypad (0-9)**, and then press **OK**.
- 2 Enter a new 4-digit password using the **Numeric Keypad (0-9)**, and then press **OK**.

To play discs of rating control (DVD only)

- 1 Insert the disc and press **DISC** to enter the disc mode.
→The rating display appears.
- 2 Enter a new 4-digit password using the **Numeric Keypad (0-9)**, and then press **OK**.
→Playback starts.

To change the password

You can change the four-digit code used as Password.

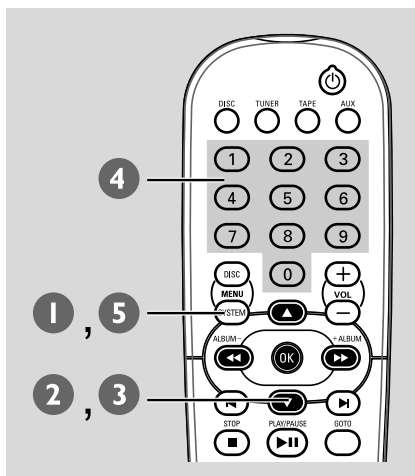

- 1 In the stop mode, press **SYSTEM MENU**.
- 2 Select **RATING** and then press **OK**.
- 3 Press **◀◀ / ▶▶** / **▲/▼** on the remote control to navigate in the menu.

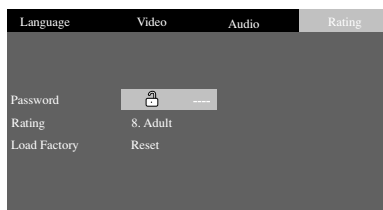

- 4 Use the **Numeric Keypad (0-9)** to enter your four-digit code, and then press **OK**.
→The password supplied by default is 1234.
→ If you forget the four-digit code, press **■** four times, the system will change back to the default password.
- 5 Go to "Password" and enter your new code. Then, enter the same code again to confirm.

To remove the menu

Press **SYSTEM MENU** again.

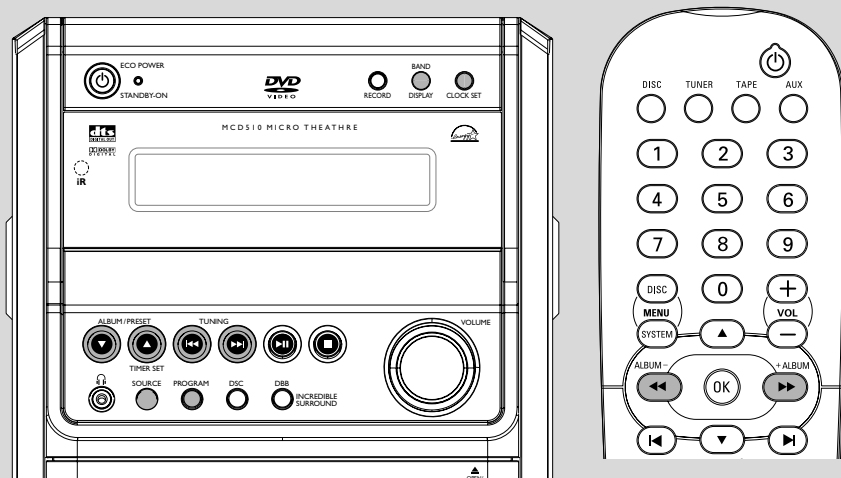

Tuning to radio stations

- 1 Select **TUNER** source.
→ "FM" or "MW" is displayed briefly.
- 2 Press **BAND** to select the desired waveband : FM or MW.
- 3 Press and hold **TUNING** **◀◀** or **▶▶** (**ALBUM-/+** **◀◀** / **▶▶** on the remote) and then release it.
→ The display will show "SEARCH" until a radio station with sufficient signal strength is found.
- 4 Repeat step 3 if necessary until you find the desired station.
- To tune to a weak station, press **TUNING** **◀◀** or **▶▶** (**ALBUM-/+** **◀◀** / **▶▶** on the remote) briefly and repeatedly until you have found optimal reception.

Programming radio stations

You can store up to 40 radio stations in the memory (20 for FM and 20 for MW).

Automatic programming

Press **PROGRAM (ANGLE/PROG)** on the remote) for more than three seconds to activate programming.

→ All available stations are programmed.

→ **AUTO** is displayed and available stations are programmed in order of waveband.

Manual programming

- 1 Tune to your desired station (refer to "Tuning to radio stations").
- 2 Press **PROGRAM (ANGLE/PROG)** on the remote) to activate programming.
→ **PX** flashes on the display, in which X stands for the programme number.
- 3 Press **ALBUM/PRESET** **▼/▲** to allocate a number from 1 to 20 for this station.
- 4 Press **PROGRAM (ANGLE/PROG)** on the remote) again to confirm the setting.
→ The frequency of the preset station is shown.
- 5 Repeat the above four steps to store other stations.
- You can override a preset station by storing another frequency in its place.

Note:

– During setting, if no button is pressed within 30 seconds, the system will exit manual programming automatically.

Tuning to preset radio stations

- Press **ALBUM/PRESET ▼/▲** until the desired preset station is displayed.

Changing tuning grid *(not available for all versions)*

In North and South America, the frequency step between adjacent channels in the MW band is 10 kHz (9 kHz in some areas). The preset frequency step in the factory is 9 kHz.

Changing the tuning grid will erase all previously stored preset radio stations.

Press and hold ■ on the system in the tuner mode.

→ The display will show "GRID 9" or "GRID 10".

Notes:

- GRID 9 and GRID 10 indicate that the tuning grid is in step of 9 kHz and 10 kHz respectively.
- The FM tuning grid also will be changed from 50 kHz to 100 kHz or vice versa.

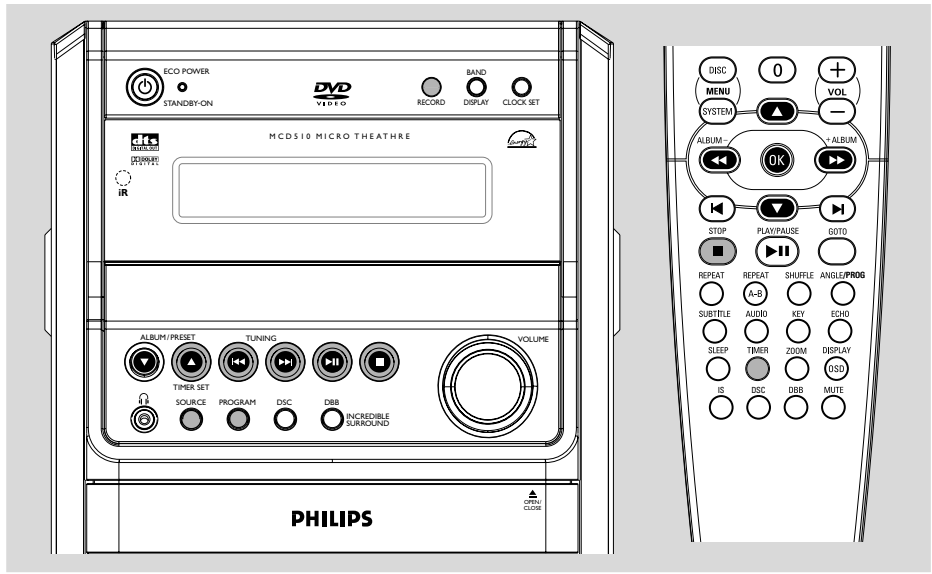

Tape playback

- 1 Select **TAPE** source.
→ The display shows "TAPE" briefly.
- 2 Press **OPEN/CLOSE**  to open the tape door:
- 3 Insert a recorded tape and close the tape door:
- 4 Load the tape with the open side downward and the full spool to the left.
- 5 Press **▶||** on the system to start playback.



To stop playback

- Press ■ (**STOP**■ on the remote).

To reset the tape counter display

- In stop mode, press **■ (STOP■** on the remote) **once**.

Rewinding / Fast forwarding

- 1 Stop playback, press **TUNING** .
→ The tape will stop automatically at the end of rewinding or fast forwarding.
→ During fast winding, you can monitor the tape message with the tape counter.
- 2 Press  (**STOP** on the remote) to stop rewinding or fast forwarding.

General information on recording

- For recording, use only NORMAL (IEC type I) tapes on which the tabs have not yet been broken. This deck is not suitable for recording on METAL (IEC IV) type tapes.
- The best recording level is set automatically. Altering the VOLUME, INCREDIBLE SURROUND or DBB will not affect the recording in progress.
- At the very beginning and end of the tape, no recording will take place during the 7 seconds when the leader tape passes the recorder heads.
- To protect a tape from accidental erasure, have the tape in front of you and break out the left tab. Recording on this side is no longer possible. If, however, you wish to record over this side again, cover the tabs with a piece of adhesive tape.

IMPORTANT!

Recording is permissible if copyright or other rights of third parties are not infringed upon.

Preparation for recording

- 1 Select **TAPE** source.
- 2 Load a recordable tape into the tape deck with the full spool to the left.
- 3 Prepare the source to be recorded.
DISC – load the disc.
TUNER – tune to the desired radio station.
AUX – connect external equipment.

When recording is in progress

- To stop recording, press **■ (STOP■)** on the remote).
- It is not possible to activate the timer function.

Synchro start CD recording (for CD only)

- 1 Select **DISC** source.
- You can programme the tracks in the order you want them to be recorded (refer to "Disc Operations - Programming favorite tracks").
- 2 Press **RECORD** to start recording.
 → Playing of the disc programme starts automatically. It is not necessary to start the DVD player separately.

One touch recording

- 1 Select **DISC, TUNER** or **AUX** source.
- 2 If necessary, start playback of the selected source.
- 3 Press **RECORD** to start recording.

Recording timer

To record from the radio, you will need to use a preset radio station and to set a start (ON) and finish (OFF) time.

- 1 Select the preset radio station to record from (refer to "Radio Reception - Tuning to preset radio stations").
- 2 In standby mode, press **TIMER SET▲ (TIMER)** on the remote) for more than two seconds.
 → "SELECT SOURCE" scrolls.
- 3 Press **SOURCE** repeatedly to select **TUNER REC.**
- 4 Press **TIMER SET▲ (TIMER)** on the remote) to confirm the source.
 → "SET ON TIME" is displayed and the clock digits for the hours flash.
- 5 Press **TUNING |◀◀▶▶|** to set the hours.
- 6 Press **TIMER SET▲ (TIMER)** on the remote) again.
 → The clock digits for the minutes flash.
- 7 Press **TUNING |◀◀▶▶|** to set the minutes.
- 8 Press **TIMER SET▲ (TIMER)** on the remote) to confirm the recording start time.
 → "SET OFF TIME" is displayed and the clock digits for the hours flash.
- 9 Repeat steps 5-7 to set the finish time.
- 10 Press **TIMER SET▲ (TIMER)** on the remote) to confirm the timer settings.
 →  is shown and the recording timer is now set.

Note:

- The recording timer will not be activated if the system is in tape play mode.

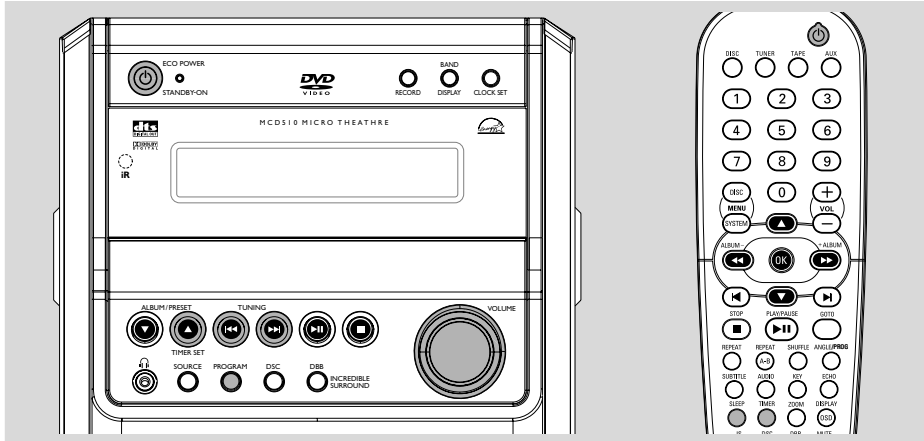

Clock setting

See page 21.

Timer setting

- The system can be used as an alarm clock, whereby the DISC, TUNER or TAPE is switched on at a set time (one time operation). The clock time needs to be set first before the timer can be used.
- ① In standby mode, press and hold **TIMER SET▲** (TIMER on the remote) for more than two seconds.
→ "SELECT SOURCE" scrolls followed by the last selected source.
- ② Press **SOURCE** to select your desired source and press **TIMER SET▲** (TIMER on the remote) to confirm.
→ "SET ON TIME" scrolls followed by "ON 0 : 00".
- ③ Press **TUNING ◀◀▶▶** to set the hours and press **TIMER SET** to confirm.
- ④ Press **TUNING ◀◀▶▶** to set the minutes and press **TIMER SET** to complete the setting.
→ The timer is now set and activated.

Activating and deactivating timer

- In standby or during playback, press **TIMER SET▲** (TIMER on the remote) **once**.
→ Display shows  if activated, and disappears if deactivated.

Sleep timer setting

The sleep timer enables the system to switch off by itself after a set period of time.

- ① Press **SLEEP** on the remote control repeatedly to select a preset time.
→ The selections are as follows (time in minutes):
90 → 80 → 70 → 60 → 50 → 40 → 30 → 20 → 10 → OFF
→ "SLEEP xx" or "OFF" is displayed. "xx" is the time in minutes.
- ② When you reach the desired length of time, stop pressing the **SLEEP** button.

To deactivate the sleep timer

- Press **SLEEP** repeatedly until "OFF" is displayed, or press **ECO POWER/STANDBY-ON** .

AMPLIFIER

Output power	2 x 25 W RMS*
.....	1000 W PMPO
Signal-to-noise ratio	≥ 62 dBA
Frequency response	63 – 16000 Hz, ± 3 dB
Input sensitivity AUX	0.5 V (max. 2 V)
Impedance loudspeakers	6 Ω
Impedance headphones	32 Ω

DVD PLAYER

Laser Type	Semiconductor
Disc Diameter	12cm / 8cm
Video Decoding	MPEG-2 / MPEG-1
Video DAC	10 Bits
Signal System	PAL / NTSC
Video Format	4:3 / 16:9
Video S/N	56 dB (minimum)
Composite Video Output	1.0Vp-p, 75 Ω
S-Video Output	Y - 1.0Vp-p, 75 Ω
.....	C - 0.286Vp-p, 75 Ω
Audio DAC	24 Bits / 96 kHz
Frequency Response	4 Hz - 20 kHz (44.1kHz)
.....	4 Hz - 22 kHz (48kHz)
.....	4 Hz - 44 kHz (96kHz)
Digital Output
..... SPDIF (Sony Philips digital interface) Coaxial	
Number of programmable tracks	20
Signal-to-noise ratio	≥ 65 dBA
Channel separation	≥ 40 dB (1 kHz)
Total harmonic distortion	< 0.02% (1 kHz)

TUNER

FM wave range	87.5 – 108 MHz
MW wave range (9 kHz)	531 – 1602 kHz
MW wave range (10 kHz)	530 – 1700 kHz
Tuning grid	9/10 kHz
Sensitivity at 75 Ω	
– mono, 26 dB signal-to-noise ratio	2.8 μV
– stereo, 46 dB signal-to-noise ratio	61.4 μV
Selectivity	≥ 28 dB
Total harmonic distortion	≤ 5%
Frequency response	63 – 12500 Hz (± 3 dB)
Signal-to-noise-ratio	≥ 50 dBA

TAPE DECK

Frequency response	
Normal tape (type I)	80 – 12500 Hz (8 dB)
Signal-to-noise ratio	
Normal tape (type I)	50 dBA
Wow and flutter	≤ 0.4% DIN

SPEAKERS

2-way bass reflex system	
Dimensions (w x h x d) ..	170 x 252 x 214 (mm)

GENERAL INFORMATION

AC Power	
For Version /21-21M ..	110 – 127 / 220 – 240V;
.....	50/60 Hz Switchable
For Version /30	230 – 240V; 50 Hz
Dimensions (w x h x d) ..	175 x 252 x 305 (mm)
Weight (with/without speakers)	8.96 / 4.84 kg
Standby	< 15W
Eco power Standby	< 1W

Specifications and external appearance are subject to change without notice.

Troubleshooting

WARNING

Under no circumstances should you try to repair the system yourself, as this will invalidate the warranty. Do not open the system as there is a risk of electric shock.

If a fault occurs, first check the points listed below before taking the system for repair. If you are unable to remedy a problem by following these hints, consult your dealer or Philips for help.

Problem	Solution
No power.	<ul style="list-style-type: none"> ✓ Check if the AC power cord is properly connected.
"NO DISC" is displayed.	<ul style="list-style-type: none"> ✓ Check if the disc is inserted upside down. ✓ Wait until the moisture condensed at the lens has cleared. ✓ Replace or clean the disc, see "Maintenance". ✓ Use a readable disc or correctly recorded format MP3-CD.
No picture.	<ul style="list-style-type: none"> ✓ Select the appropriate video input mode on the TV set. ✓ Check if the TV set is switched on. ✓ Check the video connection. ✓ Check if the system is securely connected.
Distorted or poor picture.	<ul style="list-style-type: none"> ✓ Sometimes a slight picture distortion may appear. This is not a malfunction. ✓ Clean the disc. ✓ Connect the system to the S-video input of your TV set.
The aspect ratio of the screen cannot be changed even though you have set the TV shape.	<ul style="list-style-type: none"> ✓ The aspect ratio is fixed on the DVD disc. ✓ The aspect ratio may not be changed for some TV systems.
The DVD player does not start playback.	<ul style="list-style-type: none"> ✓ Insert a readable disc. ✓ Check the disc type, color system and region code. ✓ Clean the disc. ✓ Place the disc with the playback side down. ✓ Press SYSTEM MENU to turn off the setup menu. ✓ Cancel the parental control rating function or change the rating level. ✓ Moisture has condensed inside the system. Remove the disc and leave the system turned on for about an hour.
The DVD player does not respond when buttons are pressed.	<ul style="list-style-type: none"> ✓ Disconnect the power plug from the jack, and insert again.

Problem	Solution
The language for the sound or subtitle cannot be changed when playing a DVD.	<ul style="list-style-type: none"> ✓ Multi-language sound or subtitle is not recorded on the DVD. ✓ Changing the language for the sound or subtitle is prohibited on the DVD.
No image is output when a function is selected.	<ul style="list-style-type: none"> ✓ Make sure the component is connected correctly. ✓ Press the correct function button for the input source.
Sound cannot be heard or is of poor quality	<ul style="list-style-type: none"> ✓ Adjust the volume. ✓ Disconnect the headphones. ✓ Check that the speakers are connected correctly. ✓ Check if the stripped speaker wire is clamped. ✓ If the system is in pause, slow motion or fast forward/reverse mode, press ► to resume the normal play mode. ✓ Make sure the MP3-CD was recorded within 32-256 kbps bit rate with sampling frequencies at 48 kHz, 44.1 kHz or 32 kHz.
Poor radio reception.	<ul style="list-style-type: none"> ✓ If the signal is too weak, adjust the antenna or connect an external antenna for better reception. ✓ Increase the distance between the System and your TV set or VCR.
Recording or playback cannot be made	<ul style="list-style-type: none"> ✓ Clean deck parts, see "Maintenance". ✓ Use only NORMAL tape. ✓ Apply a piece of adhesive tape over the missing tab space.
The tape deck door cannot open	<ul style="list-style-type: none"> ✓ Remove and reconnect the AC power plug and switch on the system again.
Left and right sound outputs are reversed.	<ul style="list-style-type: none"> ✓ Check the speaker connections and location.
The remote control does not function.	<ul style="list-style-type: none"> ✓ Point the remote control at the remote control sensor of the unit. ✓ Reduce the distance to the player. ✓ Remove any possible obstacles. ✓ Replace the batteries with new ones. ✓ Check that the batteries are loaded correctly.
The timer is not working	<ul style="list-style-type: none"> ✓ Set the clock correctly. ✓ If recording is in progress, stop it
The Clock/Timer setting is erased	<ul style="list-style-type: none"> ✓ Power has been interrupted or the power cord has been disconnected. Reset the clock/timer.

Analog: Sound that has not been turned into numbers. Analog sound varies, while digital sound has specific numerical values. These jacks send audio through two channels, the left and right.

Aspect ratio: The ratio of vertical and horizontal sizes of a displayed image. The horizontal vs. vertical ratio of conventional TVs is 4:3, and that of wide-screens is 16:9.

AUDIO OUT Jacks: Jacks on the back of the DVD System that send audio to another system (TV set, Stereo, etc.).

Bit Rate: The amount of data used to hold a given length of music; measured in kilobits per second, or kbps. Or, the speed at which you record. Generally, the higher the bit rate better the sound quality. However, higher bit rates use more space on a Disc.

Chapter: Sections of a picture or a music piece on a DVD that are smaller than titles. A title is composed of several chapters. Each chapter is assigned a chapter number enabling you to locate the chapter you want.

Component Video Out Jacks: Jacks on the back of the DVD System that sends high-quality video to a TV set that has Component Video In jacks (R/G/B, Y/Pb/Pr, etc.).

Disc menu: A screen display prepared for the selection of images, sound, subtitles, multi-angles, etc recorded on a DVD.

Digital: Sound that has been converted into numerical values. Digital sound is available when you use the DIGITAL AUDIO OUT COAXIAL or OPTICAL jacks. These jacks send audio through multiple channels, instead of just two channels as analog does.

Dolby Digital: A surround sound system developed by Dolby Laboratories containing up to six channels of digital audio (front left and right, surround left and right and center).

DTS: Digital Theater Systems. This is a surround sound system, but different from Dolby Digital. The formats were developed by different companies.

JPEG: A still-picture data compression system proposed by the Joint Photographic Expert Group, which features small decrease in image quality in spite of its high compression ratio.

MP3: A file format with a sound data compression system. "MPE" is the abbreviation of Motion Picture Experts Group 1 (or MPEG-1) Audio Layer 3. Through the MP3 format, one CD-R or CD-RW can contain about 10 times as much data volume as a regular CD can.

Multichannel: DVD is specified to have all sound tracks constitute one sound field. Multichannel refers to a structure of sound tracks having three or more channels.

Parental control: A function of the DVD to limit playback of the disc by the age of the users according to the limitation level in each country. The limitation varies from disc to disc; when it is activated, playback will be prohibited if the software's level is higher than the user-set level.

PCM (Pulse Code Modulation): A system for converting analog sound signal to digital signal for later processing without data compression.

Playback control (PBC): Refers to the signal recorded on video CDs or SVCDs for reproduction control. By using screen menus recorded on a Video CD or SVCD that supports PBC, you can enjoy interactive-type software as well as software having a search function.

Region code: A system allowing discs to be played only in preset regions. This unit will only play discs that have compatible region codes. You can find the region code of your unit from the product label. Some discs are compatible with more than one region (or ALL regions).

S-Video: Produces a clear picture by sending separate signals for luminance and the color. You can use S-Video only if your TV set has S-Video In jack.

Sampling Frequency: Frequency of data sampling when analog data is converted to digital data. Sampling frequency numerically represents how many times the original analog signal is sampled per second.

Surround: A system for users to create realistic three-dimensional sound fields full of realism by arranging multiple speakers around the listener.

Title: The longest section of a picture or music feature on DVD, music, etc., in video software, or the entire album in audio software. Each title is assigned a title number enabling you to locate the title you want.

VIDEO OUT jack: Jack on the back of the DVD System that sends video to TV.