

Wall mounting instructions

Drill holes on wall at hole positions marked.*

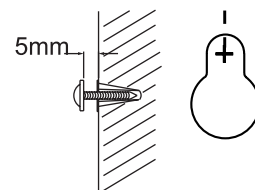

ENGLISH

①

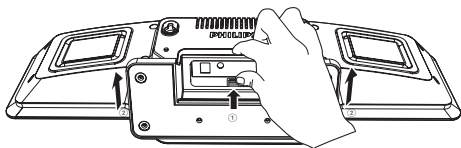

Remove the detachable stand before mounting

- As shown in figure 1, locate the latch on the bottom panel, and press the latch to unlatch the stand, then take it out.

Attach the stand back for desktop placement

- As shown in figure 2, align 2 slots of the main unit with 2 latches of the stand, then push the stand in to latch.

Note for mounting

- To secure the mounting on wall, concrete wall is required.

Use screws to mount the main unit on the wall

- Use this sheet as a template. Mark the position where you want to hang the unit on the wall (as shown above) and then drill two 6mm diameter holes.
- Secure the 2 dowels and 2 screws (both supplied) in the holes respectively. Leave the screws 5mm proud of the wall.
- Hang the unit on the fastening screws.

②

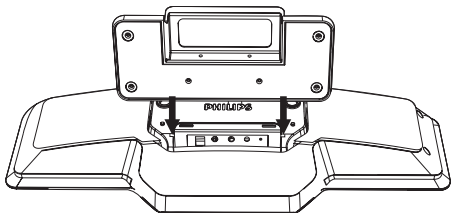

中文

安裝前須卸下本機的支座

- 如圖 1 所示，在本機的底部找到支座鎖扣按下鎖扣解鎖並取出支座。

將本機支座裝回本機

- 如圖 2 所示，將本機底部的 2 個鎖槽和支座的 2 個鎖扣對準然後將支座推入鎖住。

牆上安裝注意事項

- 為確保牆上安裝的牢固性，須將本機安裝在水泥牆面上。

用螺絲釘將本機安裝到牆上

- 將本單頁說明紙為安裝模板，按上圖中 2 孔的位置，在牆上鑽 2 個孔（直徑為 6 毫米）確定本機掛牆的位置。
- 將隨送的 2 個螺絲釘套釘入鑽孔，再將隨送的螺絲釘釘入套裏面，螺絲釘帽與牆面須有 5 毫米的距離。
- 將本機掛到 2 個螺絲釘上。

* 牆上安裝說明

按圖上所示的 2 孔的位置距離，在牆上畫出 2 孔並在其位置上鑽個孔洞。