

PHILIPS

5000 series

5.1影院扬声器
CSS5530G

用户手册

User manual



在以下网站上注册产品并获得支持
www.philips.com/support

目录

1 重要信息	2	8 故障种类和处理方法	15
帮助和支持	2		
安全	2		
爱护产品	3		
爱护环境	3		

2 您的产品	3		
主装置	3		
遥控器	4		
接口	5		
无线低音扬声器	5		
无线盒（接收器）	6		

3 连接和设置	6		
摆放扬声器	6		
与后置扬声器进行配对	7		
对低音扬声器进行配对	7		
连接至电视	8		
连接电视或其他设备的音频	8		
通过 HDMI 连接数字设备	9		
设置扬声器	9		

4 使用您的产品	10		
调节音量	10		
选择声音	10		
MP3 播放器	10		
通过蓝牙播放音乐	11		
通过 NFC 连接蓝牙	11		
USB 存储设备	11		
自动待机	12		
应用出厂设置	12		

5 更新软件	12		
检查软件版本	12		
通过 USB 设备更新软件	12		

6 壁挂安装	13		
---------------	----	--	--

7 产品规格	14		
---------------	----	--	--

1 重要信息

请在使用本产品之前阅读并理解所有说明。因未遵守说明而造成的损坏不在保修范围内。

帮助和支持

有关广泛的在线支持，请访问 www.philips.com/support 以：

- 下载用户手册和快速入门指南
- 观看视频教程（仅限于选定的型号）
- 查找常见问题 (FAQ) 的答案
- 通过电子邮件向我们发送问题
- 与支持代表聊天。

请按照网站上的说明选择您的语言，然后输入您的产品型号。

或者，您可以联系所在国家/地区的客户服务。联系之前，请记住产品的型号和序列号。您可在产品的背面或底部找到此信息。

安全

小心触电或发生火灾！

- 在建立或更改任何连接之前，请确保所有设备均已与电源插座断开连接。
- 切勿让本产品及配件与雨或水接触。切勿将液体容器（如花瓶）置于产品旁边。如果有液体溅到本产品表面或内部，请立即断开其电源。请与客户服务联系，对产品进行检查后再使用。
- 切勿将本产品和附件放置在靠近明火或其他热源的地方，包括阳光直射处。
- 切勿将物体插入本产品的通风槽或其他开口。
- 将电源插头或设备耦合器用作断电设备时，该断电设备应可以随时使用。
- 不可将电池（电池组或安装的电池）置于高温环境，如阳光直射处、明火或类似环境。

- 在雷电天气之前，应断开本产品的电源。
- 断开电源线时，应始终握住插头，而不能拉电缆。

小心短路或起火！

- 有关标识和电源功率，请参阅产品背面或底部的型号铭牌。
- 在将本产品连接到电源插座上之前，请确保电源电压与产品背面或底部印刷的电压值相匹配。如果电压不同，切勿将产品连接到电源插座上。

小心受伤或损坏本产品！

- 若要进行壁挂安装，则必须按照安装说明将本产品稳固地安装在墙上。只能使用随附的挂架（如果可用）。若壁挂安装不当，则可能造成事故、人身伤害或损坏。如果您有任何疑问，请联系您所在国家/地区的客户服务。
- 切勿将本产品或任何物体放在电源线或其他电子设备上面。
- 如果在低于 5°C 的温度下运送了本产品，请先拆开产品的包装并等待其温度达到室温，再将其连接至电源插座。
- 本产品的部件可能由玻璃制造。请小心处理，以免受到伤害或造成损坏。

小心过热！

- 切勿将本产品安装在封闭的空间内。务必在产品周围留出至少 4 英寸的空间以便通风。确保窗帘或其他物体不会遮挡产品上的通风槽。

小心污染！

- 请勿混合使用电池（旧电池与新电池或碳电池与碱性电池等等）。
- 电池安装不正确会有爆炸危险。只能用相同或相当的型号更换。
- 如果电池电量耗尽或遥控器长时间不用，请取下电池。
- 电池含有化学物质，因此应适当地进行处理。

吞咽电池的危险！

- 产品/遥控器可能包含纽扣式/按钮式电池，容易被吞咽。始终将电池放在儿童接触不到的地方！如不慎吞咽，电

池可能导致严重受伤或死亡。摄入后 2 小时内可能发生严重的内部烧伤。

- 如果您怀疑电池不慎被吞咽或位于体内的任何部位，请立即就医。
- 更换电池时，请务必将所有新旧电池放在儿童接触不到的地方。更换电池后，确保电池仓完全紧闭。
- 如果电池仓无法完全紧闭，请不要继续使用产品。放在儿童接触不到的地方并联系制造商。



此款 II 类设备具有双重绝缘，不提供保护接地。

爱护产品

只能用微细纤维清洁布清洁本产品。

爱护环境

弃置旧产品



本产品采用可回收利用的高性能材料和组件制造而成。

弃置产品时，请不要将其与一般生活垃圾一同丢弃，应将其交给政府指定的回收中心或回收。这样做有利于环保。

2 您的产品

感谢您的惠顾，欢迎光临飞利浦！为了您能充分享受飞利浦提供的支持，请在 www.philips.com/welcome 上注册您的产品。

主装置

本节包括主装置的概述。

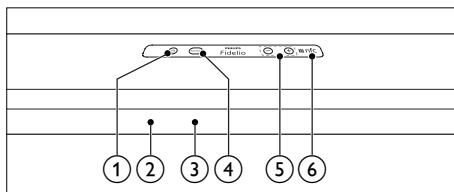

- ① 启动本产品或切换到待机模式。
- ② **显示面板**
- ③ **待机指示灯**
当本产品处于待机状态时，待机指示灯变成红色。
- ④ **SOURCE**
选择本产品的输入源。
- ⑤ **音量 +/-**
增大或减小音量。
- ⑥ **NFC 标签**
用 NFC 设备轻击标签可实现蓝牙连接。

遥控器

本部分包括遥控器的概述。

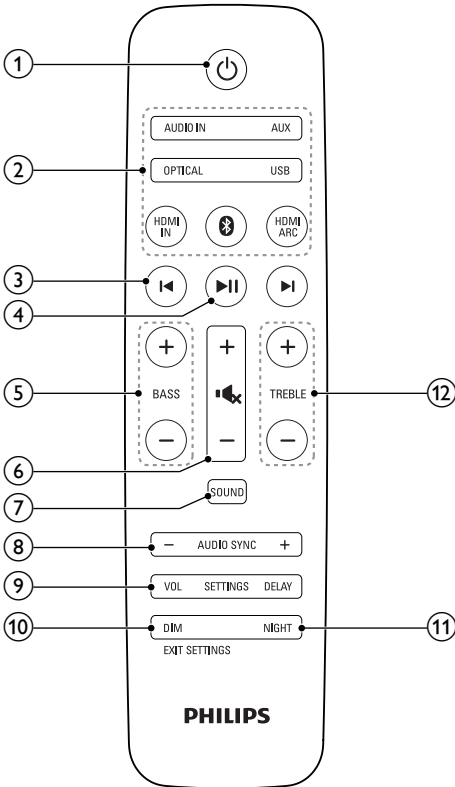

① (待机-开机)

- 打开主装置或将其切换为待机模式。

② 来源按钮

AUDIO IN：将音频来源切换至带 3.5 毫米插孔的外部设备（例如 MP3 播放器）的接口。

AUX：将音频来源切换至带红色/白色音频插孔的外部设备的接口。

OPTICAL：将音频来源切换至光纤连接。

USB：将音频源切换至 USB 连接。

HDMI IN：将来源切换至 HDMI IN 连接。

⓪：切换至蓝牙模式；按住 3 秒钟可断开当前蓝牙连接。

HDMI ARC：将来源切换至 HDMI ARC 连接。

③ ◀/▶

在 USB 和蓝牙模式下，跳至上一首或下一首曲目（仅适用于支持 AVRCP 的蓝牙设备）。

④ ▶||

在 USB 和蓝牙模式下，播放、暂停或继续播放（仅适用于支持 AVRCP 的蓝牙设备）。

⑤ BASS +/-

增大或减小低音。

⑥ 音量控制

- +/-：增大或减小音量。
- 📢：静音或恢复音量。

⑦ SOUND

选择声音模式。

⑧ AUDIO SYNC +/-

增大或减小音频延迟。

⑨ 扬声器设置按钮

VOL：进入扬声器的音量设置模式。

DELAY：进入扬声器的距离设置模式。

⑩ DIM / EXIT SETTINGS

- 设置本产品的显示面板亮度。
- 退出扬声器设置模式。

⑪ NIGHT

打开或关闭夜间模式。

⑫ TREBLE +/-

增大或减小高音。

接口

本节概述了本产品上的可用接口。

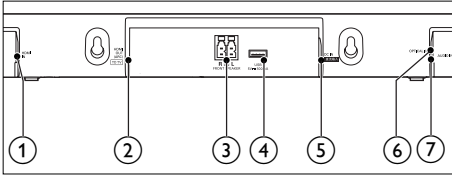

- ① **HDMI IN**
连接至数字设备上的 HDMI 输出。
- ② **TO TV - HDMI OUT (ARC)**
连接至电视的 HDMI (ARC) 输入。
- ③ **FRONT SPEAKER L/R**
连接至前置扬声器。
- ④ **USB**
 - 连接 USB 存储设备播放音乐。
 - 升级本产品的软件。
- ⑤ **DC IN**
连接至电源。
- ⑥ **OPTICAL IN**
连接至电视或数字设备的光学音频输出插孔。
- ⑦ **AUDIO IN**
音频输入来自带 3.5 毫米插孔的外部设备（例如 MP3 播放器）或带红色/白色音频插孔的外部设备。

无线低音扬声器

本产品附有无线低音扬声器。

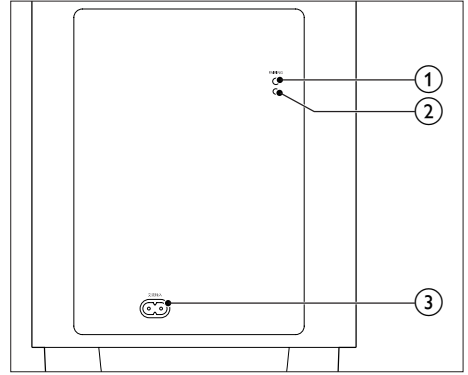

- ① **PAIRING（配对）**
按下可进入低音扬声器配对模式。
- ② **低音扬声器指示灯**
 - 低音扬声器和主装置之间进行无线配对时，指示器会呈白色快速闪烁。
 - 配对成功后，指示灯会呈白色亮起。
 - 配对失败后，指示灯呈白色缓慢闪烁。
 - 无线连接断开 1 分钟后，指示灯会熄灭。
- ③ **交流输入 ~**
连接至电源。

无线盒（接收器）

本产品随附一个无线盒（接收器），使后置扬声器以无线方式与主装置配合使用。

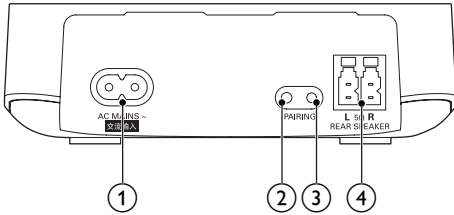

① AC MAINS

连接至电源。

② PAIRING（配对）

按下以进入后置扬声器和主装置的配对模式。

③ 无线指示器

- 当后置扬声器和主装置之间进行无线配对时，指示灯会快速闪烁。
- 配对成功时，指示灯会亮起。
- 配对失败时，指示灯会缓慢闪烁。

④ 后置扬声器接口

连接至后置扬声器。

3 连接和设置

本节将帮助您将本产品连接至电视和其他设备，然后进行设置。

有关本产品及配件的基本连接详细信息，请参阅快速入门指南。

注

- 有关标识和电源功率，请参阅产品背面或底部的型号铭牌。
- 在建立或更改任何连接之前，请确保所有设备均已与电源插座断开连接。

摆放扬声器

扬声器的定位在营造环绕音效中起着关键的作用。为了获得最佳效果，请将所有扬声器朝向座位并将其置于接近耳朵高度的位置（坐着时）。

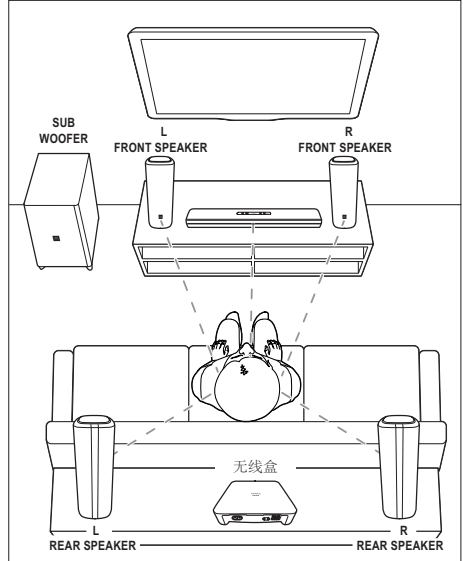

注

- 环绕音效取决于房间形状和大小、墙壁和天花板类型、窗户和反射面以及扬声器声学特性等诸多因素。试验不同的扬声器定位以找出适合您的最佳摆放。

按照以下一般原则摆放扬声器。

- 1 座位：**
这是您聆听区域的中心。
- 2 主装置（充当中置扬声器）：**
将主装置直接摆放在在座位前面，可以在电视的上面，也可以在下面。
- 3 FRONT SPEAKER L（前置左）和 FRONT SPEAKER R（前置右）扬声器：**
将左右扬声器分摆于前面，使其与主装置的距离相等。确保左、右扬声器和主装置与您的座位距离相等。
- 4 REAR SPEAKER L（后置左）和 REAR SPEAKER R（后置右）扬声器：**
将后部环绕扬声器摆放在于您座位的左右两侧，要么齐平，要么稍后一点。
- 5 SUBWOOFER（低音扬声器）：**
将低音扬声器放置在电视左侧或右侧至少一米远。与墙壁之间留出大约 10 厘米间隙。
- 6 无线盒（接收器）：**
将无线盒放在后置扬声器之间，以便于连接线缆。

与后置扬声器进行配对

将后置扬声器设置为以无线方式与主装置配合使用。打开主装置和无线盒时，后置扬声器会自动与主装置配对以建立无线连接。

所需组件

- 将后置扬声器连接至随附的无线盒（确保左、右扬声器与无线盒上的接口相匹配）。
- 将无线盒连接到交流电源，使其接通电源。

如未听到后置扬声器的音频，请执行以下操作进行配对。

- 1 按无线盒上的 PAIRING（配对）按钮进入配对模式。**
↳ 无线盒上的白色 LED 指示灯会迅速闪烁。
- 2 在 OPTICAL 模式（按 OPTICAL）下，6 秒钟内按 2 次遥控器上的 ，再按 1 次 音量 +，然后按住 BASS +。**
↳ 如果配对成功，则无线盒上的白色 LED 指示灯会亮起。
↳ 如果配对失败，则无线盒上的白色 LED 指示灯会缓慢闪烁。
- 3 如果配对失败，请重复上述步骤。**

对低音扬声器进行配对

打开主装置和低音扬声器时，无线低音扬声器会自动与主装置配对以建立无线连接。

如未听到无线低音扬声器的音频，请执行以下操作进行配对。

- 1 打开主装置及低音扬声器。**
↳ 如果与主装置的连接断开，则低音扬声器上的白色 LED 指示灯会缓慢闪烁。
- 2 按低音扬声器上的 PAIRING（配对）按钮进入配对模式。**
↳ 低音扬声器上的白色 LED 指示灯会迅速闪烁。
- 3 在 OPTICAL 模式（按 OPTICAL）下，6 秒钟内按 2 次遥控器上的 ，再按 1 次 音量 +，然后按住 BASS +。**
↳ 如果配对成功，则低音扬声器上的白色 LED 指示灯会亮起。
↳ 如果配对失败，则低音扬声器上的白色 LED 指示灯会缓慢闪烁。
- 4 如果配对失败，请重复上述步骤。**

连接至电视

将本产品连接至电视。您可以通过本产品的扬声器收听电视节目的音频。

通过 HDMI (ARC) 连接电视

最佳质量音频

本产品支持带音频回传通道 (ARC) 功能的 HDMI。如果电视兼容 HDMI ARC，则可使用一根 HDMI 线缆通过扬声器收听电视音频。

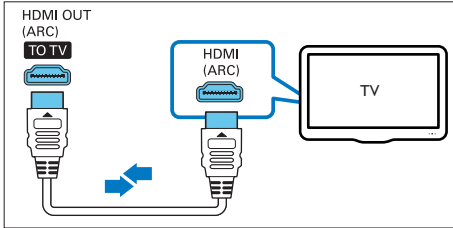

- 1 使用高速 HDMI 线缆，将本产品上的 **HDMI OUT (ARC)** 接口连接至电视上的 **HDMI ARC** 接口。
 - 电视上的 **HDMI ARC** 接口的标记可能有所不同。有关详细信息，请参阅电视用户手册。
- 2 在电视上，请打开 **HDMI-CEC** 操作。有关详细信息，请参阅电视用户手册。
 - 如果电视上出现 **HDMI-CEC** 问题，请参阅电视的用户手册，确保 **HDMI-CEC** 设置正确无误；或联系电视制造商。
- 3 按下本产品遥控器上的 **HDMI ARC**，启用 **HDMI ARC** 连接。

注

- 如果电视不兼容 **HDMI ARC**，则连接音频线缆，以便通过本产品收听电视音频。
- 如果您的电视具有 **DVI** 接口，则可使用 **HDMI/DVI** 适配器连接至电视。但是，某些功能可能不可用。

连接电视或其他设备的音频

通过本产品的扬声器播放电视或其他设备的音频。

使用本产品、电视和其他设备提供的最佳品质连接。

注

- 通过 **HDMI ARC** 连接本产品和电视时，无需使用音频连接。

方案 1: 通过数字光纤线缆连接音频

最佳质量视频

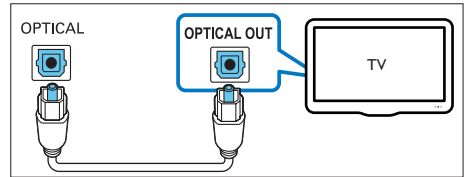

- 1 使用光纤线缆，将本产品上的 **OPTICAL IN** 接口连接至电视或其他设备上的 **OPTICAL OUT** 接口。
 - 数字光纤连接器可能标记为 **SPDIF** 或 **SPDIF OUT**。
- 2 按下本产品遥控器上的 **OPTICAL**，启用光纤连接。

选项 2: 通过模拟音频线缆连接音频

基本质量音频

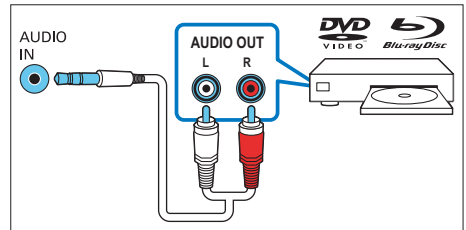

- 1 使用模拟线缆，将本产品上的 **AUDIO IN**（3.5 毫米插孔）连接至电视或其他设备上的 **AUDIO OUT** 接口（红色和白色）。
- 2 按遥控器上的 **AUX** 切换至 **AUX** 模式。

通过 HDMI 连接数字设备

通过单一 HDMI 接口将机顶盒、DVD/蓝光光盘播放机或游戏控制台等数字设备连接至产品。使用此方法连接设备并播放文件或玩游戏时，

- 电视会自动显示视频，并且
 - 本产品会自动播放音频。
- 1 使用高速 HDMI 线缆，将本产品上的 **HDMI IN** 接口连接至数字设备上的 **HDMI OUT** 接口。
 - 2 使用高速 HDMI 线缆，将本产品上的 **HDMI OUT (ARC) - TO TV** 接口连接至电视上的 HDMI 接口。
 - 打开电视和数字设备上的 **HDMI-CEC** 功能（若有此功能）。有关详情，请参阅电视和数字设备的用户手册。
 - 3 按下本产品遥控器上的 **HDMI IN**，启用 **HDMI IN** 连接。
 - 如果电视与 **HDMI CEC** 不兼容，需在电视上手动选择正确的视频输入源。

设置扬声器

手动设置扬声器，以体验定制环绕音效。

开始之前

根据快速入门指南中所述，建立必要连接。

设置扬声器距离

后置扬声器的无线连接会导致音频延迟。设置扬声器距离能在前置扬声器、后置扬声器和低音扬声器之间实现同步音频的输出。

- 1 按 **DELAY** 进入设置模式。
 - ↳ 显示面板将滚动显示 **DELAY ADJ**（延迟调节）。
 - 要退出设置模式，请按 **EXIT SETTINGS**，或 3 秒钟不按按钮。
- 2 再按 **DELAY** 选择一个扬声器进行距离调节。
- 3 按 **音量 +/-** 调节选定扬声器的距离。
 - 要退出设置模式而不保存，请按 **EXIT SETTINGS**，或 3 秒钟不按按钮。
- 4 重复执行步骤 2 和 3 设置其他扬声器的距离。
- 5 设置完成后按 **EXIT SETTINGS** 退出。
 - ↳ 已保存设置值。

设置扬声器音量

设置扬声器的音量获得最佳的环绕音效。

- 1 按 **VOL** 进入设置模式。
 - ↳ 显示面板将滚动显示 **SPKR VOL**（扬声器音量）。
 - 要退出设置模式，请按 **EXIT SETTINGS**，或 3 秒钟不按按钮。
- 2 再按 **VOL** 播放扬声器的测试音。
- 3 再按 **VOL** 选择一个扬声器进行音量调节。
- 4 按 **音量 +/-** 调节选定扬声器的音量。
 - 要退出设置模式而不保存，请按 **EXIT SETTINGS**，或 3 秒钟不按按钮。
- 5 重复执行步骤 3 和 4 设置其他扬声器的音量。
- 6 设置完成后按 **EXIT SETTINGS** 退出。
 - ↳ 已保存设置值。

4 使用您的产品

本节旨在帮助您使用本产品播放连接设备中的音频。

开始之前

- 根据快速入门指南和本用户手册中所述，建立必要连接。
- 选择正确的与连接设备对应的声音输入源。

调节音量

- 1 按 **音量 +/-** 增大或减小音量。
 - 要静音，按 **静音**。
 - 要恢复声音，再按 **静音** 或按 **音量 +/-**。

选择声音

本节将帮助您选择适合于视频或音乐的声音。

声音模式

根据您的视频或音乐需求选择预定义的声音模式。

- 1 按 **SOUND** 从显示面板中选择预定义声音选项。
 - **AUTO**：基于声音流自动选择声音设置。
 - **M-CH**：营造多声道环绕声听觉体验。适合观赏电影。
 - **PARTY**：营造增强的立体声音效。派对音乐的理想之选。
 - **STEREO**：营造双声道立体声音效。非常适合于聆听音乐。

均衡器

更改本产品的高频（高音）和低频（低音）设置。

- 1 按 **TREBLE +/-** 或 **BASS +/-** 更改频率。

同步视频和音频

如果音频和视频不同步，请延迟音频以匹配视频。

- 1 按 **AUDIO SYNC +/-** 同步音频与视频。

夜间模式

在播放音频时，夜间模式可降低响亮声音的音量，达到安静聆听的效果。夜间模式仅适用于杜比数字音轨。

- 1 按 **NIGHT** 开启或关闭夜间模式。
 - 打开夜间模式时，**ON NIGHT**（夜间打开）会在显示面板上滚动显示一次。
 - 关闭夜间模式时，**OFF NIGHT**（夜间关闭）会在显示面板上滚动显示一次。

MP3 播放器

连接 MP3 播放器以播放您的音频文件或音乐。

所需组件

- 一个 MP3 播放器。
- 一根 3.5 毫米立体声音频线缆。

- 1 使用 3.5 毫米立体声音频线缆，将 MP3 播放器连接至本产品上的 **AUDIO IN** 接口。
- 2 按 **AUDIO IN**。
- 3 按 MP3 播放器上的按钮选择和播放音频文件或音乐。
 - 在 MP3 播放器上，建议将音量设置在最大音量的 80% 范围内。

通过蓝牙播放音乐

通过蓝牙，将产品与蓝牙设备（如 iPad、iPhone、iPod touch、Android 手机或笔记本电脑）相连接，然后便可以通过本产品的扬声器聆听存储在设备上的音频文件。

所需组件

- 支持 A2DP 蓝牙规格并具有蓝牙版本 4.1 的蓝牙设备。
- 主装置与蓝牙设备之间的操作范围约为 10 米（30 英尺）。

- 1 按遥控器上的 **Ⓚ** 可将本产品切换至蓝牙模式。
↳ 显示面板上显示闪烁的 **BT**。
- 2 在蓝牙设备上，开启蓝牙，搜索并选择 **Philips CSS5530** 以开始连接（有关如何启用蓝牙功能，请参阅蓝牙设备用户手册）。
 - 首次连接时，某些移动设备会出现配对提示，选择“是”进行连接。↳ 设备连接时，显示面板上的 **BT** 会闪烁。
- 3 等待本产品发出蜂鸣音。
↳ 蓝牙连接成功时，**BT** 将显示在显示面板上。
↳ 如果连接失败，显示面板上的 **BT** 会持续闪烁。
- 4 选择并播放蓝牙设备上的音频文件或音乐。
 - 播放期间，如有通话接入，音乐播放会暂停。
 - 如果蓝牙设备支持 AVRCP 规格，您可以按遥控器上的 **◀/▶** 跳至某首曲目，或按 **▶||** 暂停/继续播放。
- 5 要退出蓝牙功能，请选择其他来源。
 - 切换回蓝牙模式后，蓝牙连接仍会处于可启用状态。

注

- 音乐传输可能因设备与本产品之间的障碍物而中断，如墙壁、设备的金属外壳或附近以相同频率工作的其他设备。
- 如果要将本产品与其他蓝牙设备相连，请按住遥控器上的 **Ⓚ** 以断开当前蓝牙连接。

通过 NFC 连接蓝牙

NFC（近场通信）是一种用于手机等 NFC 设备之间进行短距离无线通信的技术。

所需组件

- 具有 NFC 功能的蓝牙设备。
- 要进行配对，请用 NFC 设备轻击本产品的 **NFC** 标签。

- 1 在蓝牙设备上启用 NFC（有关详细信息，请参阅设备用户手册）。
- 2 请用 NFC 设备轻击本产品的 **NFC** 标签，直到本产品发出蜂鸣音。
 - 首次连接时，某些移动设备会出现配对提示，选择“是”进行连接。↳ 蓝牙连接成功时，**BT** 将显示在显示面板上。
↳ 如果连接失败，显示面板上的 **BT** 会持续闪烁。
- 3 选择并播放 NFC 设备上的音频文件或音乐。
 - 如要断开连接，请再次用 NFC 设备轻击本产品的 **NFC** 标签。

USB 存储设备

欣赏音乐 USB 存储设备中音乐，例如 MP3 播放器和 USB 闪存等等。

所需组件

- 格式为 FAT 或 NTFS 文件系统，并符合海量存储类的 USB 存储设备。
- USB 存储设备中的 MP3 文件。

- 1 将 USB 存储设备连接至本产品。
- 2 按遥控器上的 **USB**。
- 3 使用遥控器控制播放。
 - 按下 **▶||** 可开始、暂停或继续播放。
 - 按下 **◀** 或 **▶** 可跳至上一个或下一个曲目。
 - 在 USB 播放期间，按 **USB** 可切换：重复播放一个文件夹中的所有曲目和关闭重复播放。
 - 打开重复播放模式时，**ALL RPT** 会在显示面板上滚动一次。
 - 关闭重复播放模式时，**OFF RPT** 会在显示面板上滚动一次。

注

- 如果 USB 存储设备的媒体库较大，则加载这些内容需要较长时间。
- 本产品可能不兼容某些类型的 USB 存储设备。
- 如果您使用 USB 延长线、USB 集线器或 USB 多功能阅读器，则可能无法识别 USB 存储设备。
- 不支持数码相机 PTP 和 MTP 协议。
- 不要在读取文件时移除 USB 存储设备。
- 支持 USB 端口：5 伏 = 500 毫安。

自动待机

播放所连接设备中的媒体时，如果按钮处于不活动状态 15 分钟，并且未播放所连接设备中的音频/视频，则本产品会自动切换至待机模式。

应用出厂设置

您可以将本产品重置为出厂时设定的默认设置。

- 1 在 **AUX** 模式下，在 3 秒钟内依次按遥控器上的 **音量 -**、**BASS -** 和 **TREBLE -**。
 - ↳ 恢复出厂设置完成后，产品将自动关闭并重启。

5 更新软件

为了获得最佳功能及支持，请使用最新软件更新您的产品。

检查软件版本

在 HDMI ARC 来源模式下，在 3 秒钟内依次按遥控器上的 **TREBLE -**、**BASS -** 和 **音量 -**。

↳ 软件版本号将显示在显示面板上。

通过 USB 设备更新软件

注意

- 在软件更新过程中，请勿关闭电源或移除 USB 闪存盘，因为这样做可能会损坏本产品。

- 1 在 www.philips.com/support 上检查最新的软件版本。
 - 搜索您的型号，然后单击“软件和驱动程序”。
- 2 将软件下载到 USB 闪存盘中。
 - ① 将下载的文件解压缩（如果已压缩），并确保解压缩的文件包含以下两个文件：“CSS5530.bin”和“RPT5530.bin”。
 - ② 将这两个文件（“CSS5530.bin”和“RPT5530.bin”）放在 USB 闪存盘的根目录中。
- 3 将 USB 闪存盘连接至本产品上的 **USB** 接口。
- 4 将本产品切换至 HDMI ARC 来源（按 **HDMI ARC**）。

- 5 在遥控器上，在 6 秒钟内按 2 次 **音量**，再按 1 次 **音量 +**，然后按下 **SOUND**。
- ↳ 然后，显示面板上会闪烁“UPG”（升级）。
 - ↳ 如果未连接 USB 闪存盘或发现无效的升级文件，则显示面板上会显示“ERROR”（错误）。
- 6 按遥控器上的 **音量** 开始升级。
- 7 等待更新完成。
- ↳ 更新完成后，本产品将自动关闭并重新打开。

注

- 升级可能需要约 3 分钟。

6 壁挂安装

在将本产品安装到墙壁之前，请阅读所有安全防范措施。

注

- 若壁挂安装不当，则可能造成事故、人身伤害或损坏。如果您有任何疑问，请联系您所在国家/地区的客户服务。
- 将挂架固定到可承受本产品 and 挂架总重量的墙壁上。

螺钉长度/直径

根据支撑本产品的墙壁类型，请确保使用具有合适长度和直径的螺钉。

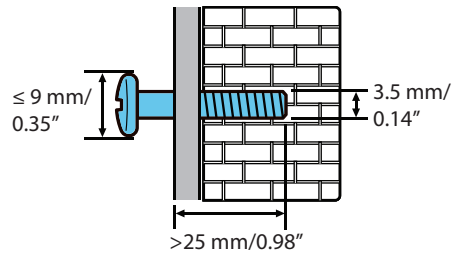

有关如何挂墙安装本产品的信息，请参阅快速入门指南中的图解。

安装前置和后置扬声器

- 1) 使用随附的挂架在墙上标记两个孔，然后按照两个孔的指示将两个合适的螺丝固定在墙上。
- 2) 将随附的挂架固定在扬声器上。
- 3) 将扬声器挂在墙上固定的螺丝上。

7 产品规格

注

- 规格和设计如有更改，恕不另行通知。

功放器

- 总输出功率：420W RMS (+/- 0.5 dB, 10% THD)
- 频率响应：20 赫兹 - 20 千赫 / ± 3 dB
- 信噪比：> 65 dB (CCIR) / (A 加权)
- 输入灵敏度：
 - AUX: 500 毫伏
 - AUDIO IN: 200 毫伏

音频

- S/PDIF 数字音频输入：
 - 光纤：TOSLINK

USB

- 兼容性：高速 USB (2.0)
- 类别支持：USB 海量存储类 (MSC)
- 文件系统：FAT16、FAT32、NTFS
- 支持 MP3 文件格式
- 采样频率：
 - MP3: 8 千赫、11 千赫、12 千赫、16 千赫、22 千赫、24 千赫、32 千赫、44.1 千赫、48 千赫
- 固定比特率：
 - MP3: 8 kbps-320 kbps

蓝牙

- 蓝牙规格：A2DP
- 蓝牙版本：4.1

主装置

- 电源：
 - 型号（飞利浦品牌的交流电源适配器）：DYS602-210309W；AS650-210-AA309
 - 输入：约 100-240 伏，50/60 赫兹，1.5 安
 - 输出：21 伏 \equiv ，3.09 安
- 待机功耗：≤ 0.5 瓦
- 尺寸（宽 × 高 × 厚）：580 × 51.5 × 98 毫米
- 重量：1.2 千克
- 内置扬声器**
 - 2 个中音扬声器（90 毫米/3.5 英寸 × 34 毫米/1.3 英寸，8 欧姆）
 - 1 个高音扬声器（25.4 毫米/1 英寸，8 欧姆）

前置/后置扬声器

- 扬声器驱动器：
 - 2 个中频扬声器（76.2 毫米/3 英寸，10 欧姆）
 - 1 个高音扬声器（25.4 毫米/1 英寸，8 欧姆）
- 尺寸（宽 × 高 × 厚）：110 × 301 × 110 毫米
- 重量：1.3 千克/个
- 线缆长度：5 米/个

低音扬声器

- 电源：约 220-240 伏，50-60 赫兹
- 功耗：60 瓦
- 待机功耗：≤ 0.5 瓦
- 阻抗：3 欧姆
- 扬声器驱动器：1 × 165 毫米（6.5 英寸）低音扬声器
- 尺寸（宽 × 高 × 厚）：228 × 406 × 265 毫米
- 重量：5.7 千克

无线盒/接收器

- 电源：约 110-240 伏；50-60 赫兹
- 功耗：20 瓦
- 待机功耗：≤ 0.5 瓦
- 尺寸（宽 × 高 × 厚）：
150 × 44.5 × 126 毫米；
- 重量：0.4 千克

遥控器电池

- 1 节 1.5 伏 AAA-R03

待机电源管理

- 本产品保持不活动状态 15 分钟后，将自动切换至待机或联网待机模式。
- 待机或联网待机模式下的功耗低于 0.5 瓦。
- 要禁用蓝牙连接，请按住遥控器上的蓝牙按钮。
- 要启用蓝牙连接，请启用蓝牙设备上的蓝牙连接，或通过 NFC 标签（如果可用）启用蓝牙连接。

8 故障种类和处理方法



警告

- 存在触电危险。切勿拆下本产品的外壳。

为保证保修的有效性，切勿尝试自行维修本产品。

如果在使用本产品时遇到问题，请在申请服务之前检查以下事项。如果仍遇到问题，请在 www.philips.com/support 页面上获得支持。

主装置

本产品上的按钮不起作用。

- 将本产品的电源断开几分钟，然后重新连接。

声音

本产品的扬声器没有声音。

- 用音频线缆将本产品连接至电视或其他设备。然而，在以下情况下，您无需单独的音频连接：
 - 本产品和电视通过 HDMI ARC 进行连接，或
 - 当设备连接至本产品的 HDMI IN 接口时。
- 将本产品重置为出厂设置。
- 在遥控器上，选择正确的音频输入。
- 确保本产品未静音。

无线低音扬声器没有声音。

- 以无线方式将低音扬声器连接至主装置。

后置扬声器无声音。

- 设置后置扬声器，并以无线方式将后置扬声器连接到主装置。

声音失真或有回声。

- 如果通过本产品播放电视的音频，确保将电视静音。

音频和视频不同步。

- 按 **AUDIO SYNC +/-** 将音频与视频同步。

蓝牙

设备无法与本产品连接。

- 设备不支持本产品所需的兼容规格。
- 您尚未启用设备的蓝牙功能。有关如何启用该功能，请参阅设备的用户手册。
- 设备未正确连接。正确连接设备。
- 本产品已连接其他蓝牙设备。断开连接的设备，然后重试。

播放所连接蓝牙设备中的音频时音质较差。

- 蓝牙接收质量较差。将设备移近本产品，或移除设备与本产品之间的任何障碍物。

所连接的蓝牙设备时断时续。

- 蓝牙接收质量较差。将设备移近本产品，或移除设备与本产品之间的任何障碍物。
- 关闭蓝牙设备的 Wi-Fi 功能以避免干扰。
- 对于某些蓝牙设备，为节省电量可能会自动禁用蓝牙连接。这并不表示本产品存在故障。

NFC

设备无法通过 NFC 与本产品连接。

- 确保设备支持 NFC。
- 确保设备已启用 NFC（有关详细信息，请参阅设备用户手册）。
- 要进行配对，请用 NFC 设备轻击本产品的 **NFC** 标签。

Contents

1 Important	2		
Help and support	2		
Safety	2		
Care for your product	3		
Care of the environment	3		

2 Your product	4		
Main unit	4		
Remote control	4		
Connectors	5		
Wireless subwoofer	6		
Wireless box (receiver)	6		

3 Connect and set up	7		
Place speakers	7		
Pair up with the rear speakers	8		
Pair up with the subwoofer	8		
Connect to TV	9		
Connect audio from TV and other devices	9		
Connect digital devices through HDMI	10		
Set up speakers	10		

4 Use your product	11		
Adjust the volume	11		
Choose your sound	11		
MP3 player	12		
Play music via Bluetooth	12		
Connect Bluetooth via NFC	13		
USB storage devices	13		
Auto standby	14		
Apply factory settings	14		

5 Update software	15		
Check software version	15		
Update software via USB	15		

6 Wall mount	16		
---------------------	----	--	--

7 Product specifications	16		
---------------------------------	----	--	--

8 Troubleshooting	18		
--------------------------	----	--	--

1 Important

Read and understand all instructions before you use your product. If damage is caused by failure to follow instructions, the warranty does not apply.

Help and support

For extensive online support, visit www.philips.com/support to:

- download the user manual and the quick start guide
- watch video tutorials (available only for selected models)
- find answers to frequently answered questions (FAQs)
- email us a question
- chat with our support representative.

Follow the instructions on the website to select your language, and then enter your product model number.

Alternatively, you can contact Consumer Care in your country. Before you contact, note down the model number and serial number of your product. You can find this information on the back or bottom of your product.

Safety

Risk of electric shock or fire!

- Before you make or change any connections, make sure that all devices are disconnected from the power outlet.
- Never expose the product and accessories to rain or water. Never place liquid containers, such as vases, near the product. If liquids are spilt on or into the product,

disconnect it from the power outlet immediately. Contact Consumer Care to have the product checked before use.

- Never place the product and accessories near naked flames or other heat sources, including direct sunlight.
- Never insert objects into the ventilation slots or other openings on the product.
- Where the mains plug or an appliance coupler is used as the disconnect device, the disconnect device shall remain readily operable.
- Batteries (battery pack or batteries installed) shall not be exposed to excessive heat such as sunshine, fire or the like.
- Disconnect the product from the power outlet before lightning storms.
- When you disconnect the power cord, always pull the plug, never the cable.

Risk of short circuit or fire!

- For identification and supply ratings, see the type plate at the back or bottom of the product.
- Before you connect the product to the power outlet, ensure that the power voltage matches the value printed on the back or bottom of the product. Never connect the product to the power outlet if the voltage is different.

Risk of injury or damage to this product!

- For wall mounting, this product must be securely attached to the wall in accordance with the installation instructions. Use only the supplied wall mount bracket (if available). Improper wall mounting may result in accident, injury or damage. If you have any query, contact Consumer Care in your country.

- Never place the product or any objects on power cords or on other electrical equipment.
- If the product is transported in temperatures below 5°C, unpack the product and wait until its temperature matches room temperature before connecting it to the power outlet.
- Parts of this product can be made of glass. Handle with care to avoid injury and damage.
- When you change the batteries, always keep all new and used batteries out of reach of children. Ensure that the battery compartment is completely secure after you replace the battery.
- If the battery compartment cannot be completely secured, discontinue use of the product. Keep out of reach of children and contact the manufacturer.

Risk of overheating!

- Never install this product in a confined space. Always leave a space of at least four inches around the product for ventilation. Ensure curtains or other objects never cover the ventilation slots on the product.

Risk of contamination!

- Do not mix batteries (old and new or carbon and alkaline, etc.).
- Danger of explosion if batteries are incorrectly replaced. Replace only with the same or equivalent type.
- Remove batteries if they are exhausted or if the remote control is not to be used for a long time.
- Batteries contain chemical substances, they should be disposed of properly.

Risk of swallowing batteries!

- The product/remote control may contain a coin/button type battery, which can be swallowed. Keep the battery out of reach of children at all times! If swallowed, the battery can cause serious injury or death. Severe internal burns can occur within two hours of ingestion.
- If you suspect that a battery has been swallowed or placed inside any part of the body, seek immediate medical attention.



This is CLASS II apparatus with double insulation, and no protective earth provided.

Care for your product

Use only microfiber cloth to clean the product.

Care of the environment

Disposal of your old product



Your product is designed and manufactured with high quality materials and components, which can be recycled and reused. Do not throw away the product with the normal household waste at the end of its life, but hand it in at an official collection point or recycling. By doing this, you help to preserve the environment.

2 Your product

Congratulations on your purchase, and welcome to Philips! To fully benefit from the support that Philips offers, register your product at www.philips.com/welcome.

Main unit

This section includes an overview of the main unit.

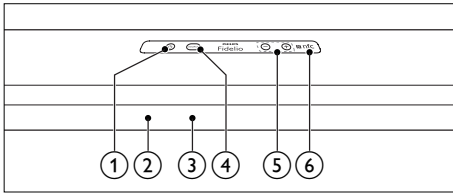

- ① Switch this product on or to standby.
- ② **Display panel**
- ③ **Standby indicator**
When this product is in standby, the standby indicator turns red.
- ④ **SOURCE**
Select an input source for this product.
- ⑤ **Volume +/-**
Increase or decrease volume.
- ⑥ **NFC tag**
Tap the NFC-enabled device on the tag for Bluetooth connection.

Remote control

This section includes an overview of the remote control.

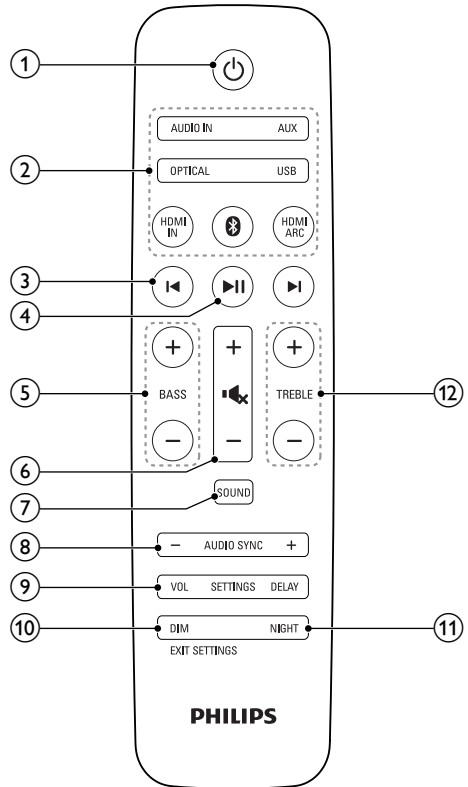

- ① **(Standby-On)**
 - Switch the main unit on or to standby.
- ② **Source buttons**
AUDIO IN: Switch your audio source to the connection of an external device with 3.5mm jack (such as MP3).
AUX: Switch your audio source to the connection of an external device with red/white audio jacks.
OPTICAL: Switch your audio source to the optical connection.

USB: Switch your audio source to the USB connection.

HDMI IN: Switch your source to the HDMI IN connection.

⏪ / ⏩ : Switch to Bluetooth mode; Press and hold three seconds to break the current Bluetooth connection.

HDMI ARC: Switch your source to HDMI ARC connection.

③ **⏪ / ⏩**

Skip to the previous or next track in USB mode and Bluetooth mode (only for AVRCP-supported Bluetooth devices).

④ **▶ ||**

Start, pause or resume play in USB mode and Bluetooth mode (only for AVRCP-supported Bluetooth devices).

⑤ **BASS +/-**

Increase or decrease bass.

⑥ **Volume control**

- +/-: Increase or decrease volume.
- 🔇: Mute or restore volume.

⑦ **SOUND**

Select a sound mode.

⑧ **AUDIO SYNC +/-**

Increase or decrease audio delay.

⑨ **Speaker setup buttons**

VOL: Enter volume setup mode for the speakers.

DELAY: Enter distance setup mode for the speakers.

⑩ **DIM / EXIT SETTINGS**

- Set the brightness of the display panel for this product.
- Exit speaker setup mode.

⑪ **NIGHT**

Turn night mode on or off.

⑫ **TREBLE +/-**

Increase or decrease treble.

Connectors

This section includes an overview of the connectors available on this product.

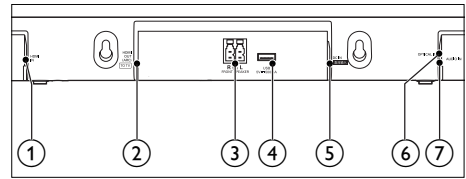

① **HDMI IN**

Connect to the HDMI output on a digital device.

② **TO TV - HDMI OUT (ARC)**

Connect to the HDMI (ARC) input on the TV.

③ **FRONT SPEAKER L/R**

Connect to the front speakers.

④ **USB**

- Connect to a USB storage device for audio media play.
- Upgrade software of this product.

⑤ **DC IN**

Connect to the power supply.

⑥ **OPTICAL IN**

Connect to an optical audio output on the TV or a digital device.

⑦ **AUDIO IN**

Audio input from an external device with 3.5 mm jack (such as MP3 player), or with red/white audio jacks.

Wireless subwoofer

This product comes with a wireless subwoofer.

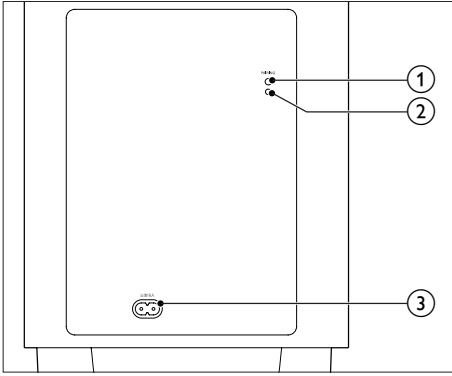

- ① **PAIRING (pairing)**
Press to enter the pairing mode for the subwoofer.
- ② **Subwoofer indicator**
 - During wireless pairing between the subwoofer and the main unit, the indicator blinks white quickly.
 - When the pairing succeeds, the indicator lights up white.
 - When the pairing fails, the indicator blinks white slowly.
 - When wireless connection is disconnected for 1 minute, the indicator turns off.
- ③ **交流输入 ~**
Connect to the power supply.

Wireless box (receiver)

This product comes with a wireless box (receiver) to make the rear speakers work with the main unit wirelessly.

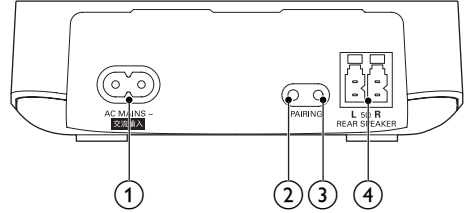

- ① **AC MAINS**
Connect to the power supply.
- ② **PAIRING (pairing)**
Press to enter the pairing mode for the rear speakers and the main unit.
- ③ **Wireless indicator**
 - During wireless pairing between the rear speakers and the main unit, the indicator blinks quickly.
 - When the pairing succeeds, the indicator lights up.
 - When the pairing fails, the indicator blinks slowly.
- ④ **Rear speaker connectors**
Connect to the rear speakers.

3 Connect and set up

This section helps you connect this product to a TV and other devices, and then set it up.

For information about the basic connections of this product and accessories, see the quick start guide.

Note

- For identification and supply ratings, see the type plate at the back or bottom of the product.
- Before you make or change any connections, make sure that all devices are disconnected from the power outlet.

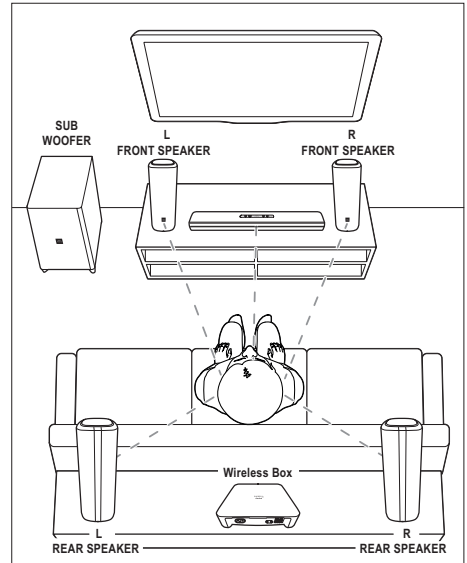

Place speakers

Speaker position plays a critical role in setting up a surround sound effect. For best effect, position all the speakers towards the seating position and place them close to your ear level (seated).

Note

- Surround sound depends on factors such as room shape and size, type of wall and ceiling, windows and reflective surfaces, and speaker acoustics. Experiment with the speaker positions to find the optimum setting for you.

Follow these general guidelines for speakers placement.

- 1 Seating position:**
This is the center of your listening area.
- 2 Main unit** (function as center speaker):
Place the main unit directly in front of the seating position, either above or below your TV.
- 3 FRONT SPEAKER L** (front left) and **FRONT SPEAKER R** (front right) speakers:
Place the left and right speakers in the front, and at equal distance

from the main unit. Make sure that the left, right, and the main unit are at equal distance from your seating position.

4 **REAR SPEAKER L** (rear left) and **REAR SPEAKER R** (rear right) speakers:

Place the rear surround speakers to the left and right side of your seating position, either in line with it or slightly behind it.

5 **SUBWOOFER** (subwoofer):

Place the subwoofer at least one meter to the left or right of the TV. Leave about 10-centimeter clearance from the wall.

6 **Wireless box (receiver):**

Place the wireless box in between the rear speakers for easy cable connection.

Pair up with the rear speakers

Set up the rear speakers to work with the main unit wirelessly. The rear speakers automatically pair up with the main unit for wireless connection when you turn on the main unit, and the wireless box.

What you need

- Connect the rear speakers to the supplied wireless box (make sure that the left and right speakers match the connectors on the wireless box).
- Connect the wireless box to AC power to power on.

If no audio from the rear speakers can be heard, do the following for pairing.

- 1 Press the **PAIRING** (PAIRING) button on the wireless box to enter the pairing mode.

↳ The white LED on the wireless box blinks quickly.

- 2 In **OPTICAL** mode (press **OPTICAL**), within six seconds, on the remote control, press **⏪** twice then **Volume +** once, and then hold down **BASS +**.

↳ If the pairing succeeds, the white LED on the wireless box lights up.

↳ If the pairing fails, the white LED on the wireless box blinks slowly.

- 3 If the pairing fails, repeat the steps above.

Pair up with the subwoofer

The wireless subwoofer automatically pair up with the main unit for wireless connection when you turn on the main unit, and the subwoofer.

If no audio from the wireless subwoofer can be heard, do the following for pairing.

- 1 Turn on the main unit, and the subwoofer.

↳ If the connection to the main unit is lost, the white LED on the subwoofer blinks slowly.

- 2 Press the **PAIRING** (PAIRING) button on the subwoofer to enter the pairing mode.

↳ The white LED on the subwoofer blinks quickly.

- 3 In **OPTICAL** mode (press **OPTICAL**), within six seconds, on the remote control, press **⏪** twice then **Volume +** once, and then hold down **BASS +**.

↳ If the pairing succeeds, the white LED on the subwoofer lights up.

↳ If the pairing fails, the white LED on the subwoofer blinks slowly.

4 If the pairing fails, repeat the steps above.

Connect to TV

Connect this product to a TV. You can listen to audio from TV programs through the speakers of this product.

Connect to TV through HDMI (ARC)

Best quality audio

This product supports HDMI with Audio Return Channel (ARC). If your TV is HDMI ARC compliant, you can hear the TV audio through the speakers of this product by using a single HDMI cable.

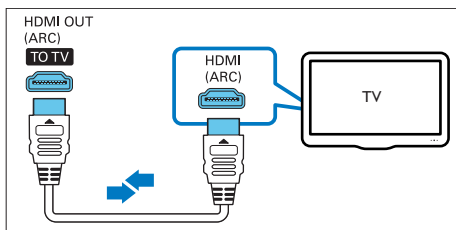

1 Using a High Speed HDMI cable, connect the **HDMI OUT (ARC)** connector on this product to the **HDMI ARC** connector on the TV.

- The **HDMI ARC** connector on the TV might be labeled differently. For details, see the TV user manual.

2 On your TV, turn on HDMI-CEC operations. For details, see the TV user manual.

- For HDMI-CEC issues on your TV, see the TV user manual to make sure that the HDMI-CEC

setup is correct, or contact the TV manufacturer if needed.

3 Press **HDMI ARC** on the remote control of this product to enable the HDMI ARC connection.

Note

- If your TV is not HDMI ARC compliant, connect an audio cable to hear the TV audio through this product.
- If your TV has a DVI connector, you can use an HDMI/DVI adapter to connect to TV. However, some of the features may not be available.

Connect audio from TV and other devices

Play audio from TV or other devices through the speakers of this product. Use the best quality connection available on this product, TV, and other devices.

Note

- When this product and TV are connected through **HDMI ARC**, an audio connection is not required.

Option 1: Connect audio through a digital optical cable

Best quality audio

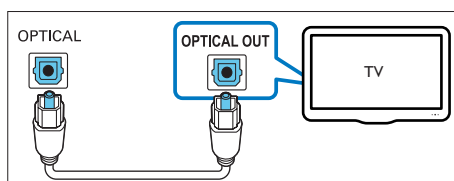

- 1 Using an optical cable, connect the **OPTICAL IN** connector on this product to the **OPTICAL OUT** connector on the TV or other device.
 - The digital optical connector might be labeled **SPDIF** or **SPDIF OUT**.
- 2 Press **OPTICAL** on the remote control of this product to enable the optical connection.

Option 2: Connect audio through analog audio cables

Basic quality audio

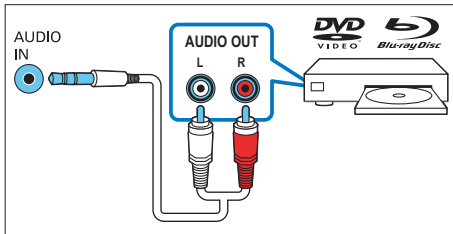

- 1 Using an analog cable, connect the **AUDIO IN** (3.5mm jack) on this product to the **AUDIO OUT** connectors (red and white) on the TV or other device.
- 2 Press **AUX** on the remote control to switch to AUX mode.

Connect digital devices through HDMI

Connect a digital device such as a set-top box, DVD/Blu-ray player, or games console to this product through a single HDMI connection. When you connect the devices in this way and play a file or game, the

- video is automatically displayed on your TV, and

- audio is automatically played on this product.

- 1 Using a High Speed HDMI cable, connect the **HDMI OUT** connector on your digital device to the **HDMI IN** on this product.
- 2 Using a High Speed HDMI cable, connect the **HDMI OUT (ARC) - TO TV** connector on this product to the **HDMI** connector on the TV.
 - On your TV and the connected device, turn on HDMI-CEC controls (if available). For details, see the user manual of the TV and the device.
- 3 Press **HDMI IN** on the remote control of this product to enable the HDMI IN connection.
 - If the TV is not HDMI-CEC compliant, select the correct video input on your TV.

Set up speakers

Set up the speakers manually to experience customized surround sound.

Before you start

Make the necessary connections described in the quick start guide.

Set up speaker distance

Wireless connection causes audio delay latency. Set up the speaker distance to synchronize audio output among the front speakers, rear speakers and subwoofer.

- 1 Press **DELAY** to enter setup mode.
 - ↳ The display panel scrolls **DELAY ADJ** (delay adjustment).
 - To exit setup mode, press **EXIT SETTINGS**, or 3 seconds of button inactivity occurs.

- 2 Press **DELAY** again to select a speaker for distance adjustment.
- 3 Press **Volume +/-** to adjust distance for the selected speaker.
 - To exit setup mode without save, press **EXIT SETTINGS**, or 3 seconds of button inactivity occurs.
- 4 Repeat step 2 and 3 to set up the distance for other speakers.
- 5 After the setup is complete, press **EXIT SETTINGS** to exit.
 - ↳ The value is saved and applied.

Set up speaker volume

Set up the speaker volume for optimal surround sound.

- 1 Press **VOL** to enter setup mode.
 - ↳ The display panel scrolls **SPKR VOL** (speaker volume).
 - To exit setup mode, press **EXIT SETTINGS**, or 3 seconds of button inactivity occurs.
- 2 Press **VOL** again to play test tone from the speakers.
- 3 Then press **VOL** to select a speaker for volume adjustment.
- 4 Press **Volume +/-** to adjust volume for the selected speaker.
 - To exit setup mode without save, press **EXIT SETTINGS**, or 3 seconds of button inactivity occurs.
- 5 Repeat step 3 and 4 to set up the volume for other speakers.
- 6 After the setup is complete, press **EXIT SETTINGS** to exit.
 - ↳ The value is saved and applied.

4 Use your product

This section helps you use this product to play audio from connected devices.

Before you start

- Make the necessary connections described in the quick start guide and the user manual.
- Switch this product to the correct source for other devices.

Adjust the volume

- 1 Press **Volume +/-** to increase or decrease a volume level.
 - To mute sound, press **MUTE**.
 - To restore the sound, press **MUTE** again or press **Volume +/-**.

Choose your sound

This section helps you choose the ideal sound for your video or music.

Sound mode

Select predefined sound modes to suit your video or music.

- 1 Press **SOUND** to select a sound option from the display panel.
 - **AUTO**: Automatically select a sound setting based on the sound stream.
 - **M-CH**: Create multi-channel surround listening experience. Ideal for watching movie.
 - **PARTY**: Create enhanced stereo. Ideal for party music.
 - **STEREO**: Create two-channel stereo. Ideal for listening to music.

Equalizer

Change the high frequency (treble) and low frequency (bass) settings of this product.

- 1 Press **TREBLE +/-** or **BASS +/-** to change the frequency.

Synchronize video and sound

If the audio and video are not synchronized, delay the audio to match the video.

- 1 Press **AUDIO SYNC +/-** to synchronize the audio with the video.

Night mode

For quiet listening, night mode decreases the volume of loud sounds when audio is played. Night mode is only available for Dolby Digital soundtracks.

- 1 Press **NIGHT** to turn night mode on or off.
 - When night mode is turned on, **ON NIGHT** (night on) scrolls once on the display panel.
 - When night mode is turned off, **OFF NIGHT** (night off) scrolls once on the display panel.

MP3 player

Connect your MP3 player to play your audio files or music.

What you need

- An MP3 player.
- A 3.5mm stereo audio cable.

- 1 Using the 3.5mm stereo audio cable, connect the MP3 player to the **AUDIO IN** connector on this product.

- 2 Press **AUDIO IN**.
- 3 Press the buttons on the MP3 player to select and play audio files or music.
 - On the MP3 player, it is recommended to set the volume in the range of 80% maximum volume.

Play music via Bluetooth

Through Bluetooth, connect your product with a Bluetooth device (such as an iPad, iPhone, iPod touch, Android phone, or laptop), and then you can listen to the audio files stored on the device through the speakers of this product.

What you need

- A Bluetooth device which supports Bluetooth profile A2DP, and with Bluetooth version as 4.1.
- The operational range between the main unit and a Bluetooth device is approximately 10 meters (30 feet).

- 1 Press **0** on the remote control to switch this product to Bluetooth mode.
 - ↳ **BT** is displayed on the display panel, blinking.
- 2 On the Bluetooth device, switch on Bluetooth, search for and select **Philips CSS5530** to start connection (see the user manual of the Bluetooth device on how to enable Bluetooth).
 - For first time connection, on some mobile devices prompt for pair-up appears, select "YES" for connection.
 - ↳ During connection, **BT** on the display panel blinks.

- 3 Wait until this product beeps.
 - ↳ When the Bluetooth connection succeeds, **BT** is displayed on the display panel.
 - ↳ If the connection fails, **BT** on the display panel blinks continuously.
- 4 Select and play audio files or music on your Bluetooth device.
 - During play, if a call is coming, music play is paused.
 - If your Bluetooth device supports AVRCP profile, on the remote control you can press **◀** / **▶** to skip to a track, or press **⏸** to pause/resume play.
- 5 To exit Bluetooth, select other source.
 - When your switch back to Bluetooth mode, Bluetooth connection remains active.



Note

- The music streaming may be interrupted by obstacles between the device and this product, such as wall, metallic casing that covers the device, or other devices nearby that operate in the same frequency.
- If you want to connect this product with another Bluetooth device, press and hold **ⓧ** on the remote control to break the current Bluetooth connection.

Connect Bluetooth via NFC

NFC (Near Field Communication) is a technology that enables short-range wireless communication between NFC-enabled devices, such as mobile phones.

What you need

- A Bluetooth device with NFC function.
 - For pairing, tap the NFC device on the **NFC** tag of this product.
- 1 Enable NFC on the Bluetooth device (see the device's user manual for details).
 - 2 Tap the NFC device onto the **NFC** tag of this product until this product beeps.
 - For first time connection, on some mobile devices prompt for pair-up appears, select "YES" for connection.
 - ↳ When the Bluetooth connection succeeds, **BT** is displayed on the display panel.
 - ↳ If the connection fails, **BT** on the display panel blinks continuously.
 - 3 Select and play audio files or music on your NFC device.
 - To break the connection, tap again the NFC device onto the **NFC** tag on this product.

USB storage devices

Enjoy audio on a USB storage device, such as an MP3 player and USB flash memory, etc.

What you need

- A USB storage device that is formatted for FAT or NTFS file systems, and complies with the Mass Storage Class.
 - An MP3 file on a USB storage device.
- 1 Connect a USB storage device to this product.
 - 2 Press **USB** on the remote control.

- 3 Use the remote control to control play.
- Press ►|| to start, pause or resume play.
 - Press ◀/▶ to skip to the previous or next track.
 - During USB play, press **USB** to toggle: repeat all tracks in one folder and repeat off.
 - When repeat mode is turned on, **ALL RPT** scrolls once on the display panel.
 - When repeat mode is turned off, **OFF RPT** scrolls once on the display panel.



Note

- If a USB storage device has a large media library, it takes some time to load those contents.
- This product may not be compatible with certain types of USB storage device.
- If you use a USB extension cable, USB HUB, or USB multi-reader, the USB storage device may not be recognized.
- Digital camera PTP and MTP protocols are not supported.
- Do not remove the USB storage device while it is being read.
- Support a USB port: 5V === 500mA.

Apply factory settings

You can reset this product to the default settings programmed at the factory.

- 1 In AUX mode, on the remote control press **Volume -**, **BASS -**, and **TREBLE -** in sequence within three seconds.
 - ↳ When the factory settings restore is complete, the product automatically switches off and restarts.

Auto standby

When playing media from a connected device, this product automatically switches to standby after 15 minutes of button inactivity and no audio/video play from a connected device.

5 Update software

To get the best features and support, update your product with the latest software.

Check software version

In HDMI ARC source, on the remote control press **TREBLE -**, **BASS -**, and **Volume -** in sequence within three seconds.

↳ The software version number is displayed on the display panel.

Update software via USB

Caution

- Do not turn off the power or remove the USB flash drive when the software update is in progress because you might damage this product.

- 1 Check the latest software version on www.philips.com/support.
 - Search for your model and click on "Software and drivers".
- 2 Download the software into a USB flash drive.
 - ① Unzip the download if zipped, and make sure that the unzipped file contains two files: "CSS5530.bin" and "RPT5530.bin".
 - ② Put the two files ("CSS5530.bin" and "RPT5530.bin") in the root directory of the USB flash drive.

- 3 Connect the USB flash drive to the **USB** connector on this product.
- 4 Switch this product to HDMI ARC source (press **HDMI ARC**).
- 5 On the remote control, within 6 seconds press **⏻** twice then **Volume +** once, and then hold down **SOUND**.
 - ↳ Then "UPG" (upgrade) blinks on the display panel.
 - ↳ If a USB flash drive is not connected or invalid upgrade file is found, "ERROR" (error) is displayed on the display panel.
- 6 Press **⏻** on the remote control to start the upgrade.
- 7 Wait until the upgrade is completed.
 - ↳ If the upgrade is complete, this product automatically turns off and on again.

Note

- The upgrade time may take around 3 minutes.

6 Wall mount

Before you mount this product on the wall, read all safety precautions.

Note

- Improper wall mounting may result in accident, injury or damage. If you have any query, contact Consumer Care in your country.
- Secure the wall mount to a wall that can support the combined weight of the product and the wall mount.

Screw length/diameter

Depending on the type of wall supporting this product, make sure that you use screws of a suitable length and diameter.

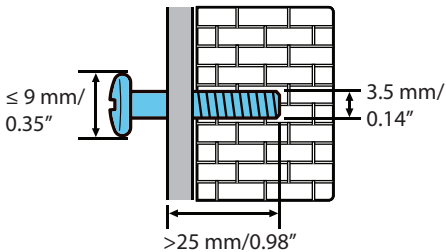

See the illustration in the quick start guide on how to wall mount this product.

Mount front and rear speakers

- 1) Mark two holes on the wall using a supplied wall bracket, then secure two suitable screws on the wall as indicated by two holes.
- 2) Fix a supplied wall bracket onto a speaker.
- 3) Hang the speaker on the screws which are secured on the wall.

7 Product specifications

Note

- Specifications and design are subject to change without notice.

Amplifier

- Total output power: 420W RMS (+/- 0.5 dB, 10% THD)
- Frequency response: 20 Hz-20 kHz / ± 3 dB
- Signal-to-noise ratio: > 65 dB (CCIR) / (A-weighted)
- Input sensitivity:
 - AUX: 500 mV
 - AUDIO IN: 200 mV

Audio

- S/PDIF Digital audio input:
 - Optical: TOSLINK

USB

- Compatibility: Hi-Speed USB (2.0)
- Class support: USB Mass Storage Class (MSC)
- File system: FAT16, FAT32, NTFS
- Supports MP3 file format
- Sampling frequency:
 - MP3: 8 kHz, 11 kHz, 12 kHz, 16 kHz, 22 kHz, 24 kHz, 32 kHz, 44.1 kHz, 48 kHz
- Constant bit rate:
 - MP3: 8 kbps-320 kbps

Bluetooth

- Bluetooth profiles: A2DP
- Bluetooth version: 4.1

Main unit

- Power supply:
 - Model (Philips branded AC power adapter): DYS602-210309W; AS650-210-AA309
 - Input: 100–240 V~, 50/60 Hz 1.5 A
 - Output: 21V $\overline{=}$, 3.09A
- Standby power consumption: ≤ 0.5 W
- Dimensions (W x H x D): 580 x 51.5 x 98 mm
- Weight: 1.2 kg
- **Built-in speakers**
 - 2 x midrange (90mm/3.5" x 34mm/1.3", 8 ohm)
 - 1 x tweeter (25.4mm/1", 8 ohm)

Front/rear speakers

- Speaker drivers:
 - 2 x midrange (76.2 mm/3", 10 ohm)
 - 1 x tweeter (25.4 mm/1", 8 ohm)
- Dimensions (W x H x D): 110 x 301 x 110 mm
- Weight: 1.3 kg/each
- Cable length: 5 m/each

Subwoofer

- Power supply: 220–240 V~, 50–60 Hz
- Power consumption: 60 W
- Standby power consumption: ≤ 0.5 W
- Impedance: 3 ohm
- Speaker drivers: 1 x 165 mm (6.5") woofer
- Dimensions (W x H x D): 228 x 406 x 265 mm
- Weight: 5.7 kg

Wireless box/receiver

- Power supply: 110–240 V~, 50–60 Hz
- Power consumption: 20 W
- Standby power consumption: ≤ 0.5 W
- Dimensions (W x H x D): 150 x 44.5 x 126 mm;
- Weight: 0.4 kg

Remote control batteries

- 1 x AAA-R03-1.5 V

Standby power management

- When the product remains inactive for 15 minutes, it automatically switches to standby or networked standby.
- The power consumption in standby or networked standby is less than 0.5W.
- To deactivate Bluetooth connection, press and hold the Bluetooth button on the remote control.
- To activate Bluetooth connection, enable Bluetooth connection on your Bluetooth device, or enable Bluetooth connection via the NFC tag (if available).

8 Troubleshooting



Warning

- Risk of electric shock. Never remove the casing of the product.

To keep the warranty valid, never try to repair the product yourself.

If you have problems using this product, check the following points before you request service. If you still have a problem, get support at www.philips.com/support.

Main unit

The buttons on this product do not work.

- Disconnect this product from the power supply for a few minutes, then reconnect.

Sound

No sound from the speakers of this product.

- Connect the audio cable from this product to your TV or other devices. However, you do not need a separate audio connection when:
 - the product and TV are connected through **HDMI ARC** connection, or
 - a device is connected to the **HDMI IN** connector on this product.
- Reset this product to its factory settings.
- On the remote control, select the correct audio input.
- Make sure that this product is not muted.

No sound from the wireless subwoofer.

- Wirelessly connect the subwoofer to the main unit.

No sound from the rear speakers.

- Set up the rear speakers, and connect the rear speakers to the main unit wirelessly.

Distorted sound or echo.

- If you play audio from the TV through this product, make sure that the TV is muted.

Audio and video are not synchronized.

- Press **AUDIO SYNC +/-** to synchronize the audio with the video.

Bluetooth

A device cannot connect with this product.

- The device does not support the compatible profiles required for this product.
- You have not enabled the Bluetooth function of the device. See the user manual of the device on how to enable the function.
- The device is not correctly connected. Connect the device correctly.
- This product is already connected with another Bluetooth device. Disconnect the connected device, then try again.

Quality of audio play from a connected Bluetooth device is poor.

- The Bluetooth reception is poor. Move the device closer to this product, or remove any obstacle between the device and this product.

The connected Bluetooth device connects and disconnects constantly.

- The Bluetooth reception is poor. Move the device closer to this product, or remove any obstacle between the device and this product.

- Turn off Wi-Fi function on the Bluetooth device to avoid interference.
- For some Bluetooth, the Bluetooth connection can be deactivated automatically to save power. This does not indicate any malfunction of this product.

NFC

A device cannot connect with this product via NFC.

- Make sure that the device is supported by NFC.
- Make sure that NFC is enabled on the device (see the device' s user manual for details).
- For pairing, tap the NFC device on the **NFC** tag of this product.



Manufactured under license from Dolby Laboratories. Dolby, Pro Logic, and the double-D symbol are trademarks of Dolby Laboratories.



The terms HDMI and HDMI High-Definition Multimedia Interface, and the HDMI Logo are trademarks or registered trademarks of HDMI Licensing LLC in the United States and other countries.



The Bluetooth[®] word mark and logos are registered trademarks owned by Bluetooth SIG, Inc. and any use of such marks by Gibson Innovations Limited is under license. Other trademarks and trade names are those of their respective owners.



The N Mark is a trademark or registered trademark of NFC Forum, Inc. in the United States and in other countries.

产品中有害物质的名称及含量
Names and Contents of Hazardous Substances

部件名称 Name of the parts	有害物质 Hazardous Substance					
	铅 (Pb)	汞 (Hg)	镉 (Cd)	六价铬 (Cr (VI))	多溴联苯 (PBB)	多溴二苯醚 (PBDE)
Housing 外壳	○	○	○	○	○	○
Subwoofer 超重低音箱	×	○	○	○	○	○
Loudspeakers 喇叭单元	○	○	○	○	○	○
PWBs 电路板组件	×	○	○	○	○	○
Accessories (Remote control & cables) 附件 (遥控器, 电源线, 连接线)	×	○	○	○	○	○
Batteries in Remote Control (ZnC) 遥控器电池	×	○	○	○	○	○

本表格依据 SJ/T 11364 的规定编制。

The table is formulated according to SJ/T 11364.

- : 表示该有害物质在该部件所有均质材料中的含量均在 GB/T 26572 规定的限量要求以下。
- : Indicates that this hazardous substance contained in all of the homogeneous materials for this part is below the limit requirement in GB/T 26572.
- ×: 表示该有害物质至少在该部件的某一均质材料中的含量超出 GB/T 26572 规定的限量要求。
- ×: Indicates that this hazardous substance contained in at least one of the homogeneous materials used for this part is above the limit requirement in GB/T 26572.



环保使用期限 Environmental Protection Use Period

此标识指期限（十年），电子电气产品中的有害物质在正常使用的条件下不会发生外泄或突变，用户使用该电子电气产品不会对环境造成严重污染或对其人身、财产造成严重损害的期限。

This logo refers to the period (10 years) during which the hazardous substances in electronic and electrical products will not leak or mutate so that the use of these [substances] will not result in any severe environmental pollution, any bodily injury or damage to any assets.



Specifications are subject to change without notice

Copyright © 2017 Gibson Innovations Limited.

This product has been manufactured by, and is sold under the responsibility of WOOX Innovations (Shanghai) Commercial Company Ltd., and WOOX Innovations (Shanghai) Commercial Company Ltd., is the warrantor in relation to this product.

Philips and the Philips Shield Emblem are registered trademarks of Koninklijke Philips N.V. and are used under license from Koninklijke Philips N.V.

CSS5530B_93_UM_V1.0

