



Philips izzy  
wireless multiroom  
speaker

**Bluetooth®**  
30 W RMS power  
NFC  
izzylink™ for multiroom

**BM7B**

## One tap to play music in every room

The Philips izzy wireless multiroom speaker BM7 plays music wirelessly via Bluetooth. With a tap of a button, up to 5 izzy speakers play music in every room at the same time, effortlessly. Easy setup: no router, password or apps.

### **Philips izzylink™ for multiroom music**

- Play music in one room wirelessly via Bluetooth
- One tap to set up izzylink™, no router, no password, no apps
- Group up to 5 izzy with izzylink™ for multiroom enjoyment
- Change the master speaker in the group with just one tap

### **Enrich your sound experience**

- Wide, rich and clear room-filling sound
- Dedicated tweeters offer detailed high-frequency sound
- Twin passive radiators give rich extended bass
- 2 x 15 W RMS maximum output power

### **Simplicity in use**

- Stream all your music via izzylink™
- Wireless music streaming via Bluetooth
- One-Touch with NFC-enabled smartphones for Bluetooth pairing
- Swap music instantly between 2 devices with MULTIPAIR

# PHILIPS

# Highlights

## Play music in one room

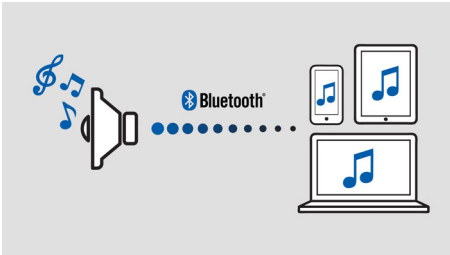

Philips izzy speaker lets you stream all your favourite music from your phone, tablet or computer, no matter which music or radio app you use.

## izzylink™

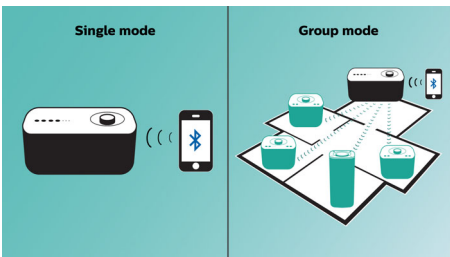

izzylink™ is a wireless technology that uses the IEEE 802.11n standard to enable the link-up of multiple speakers to form a wireless network. The network connects up to five speakers without the need of a router, Wi-Fi password, or any smart device mobile app to set it up. You can add izzy speakers to the network easily to enjoy music playing at the same time in different rooms. Each speaker can still be switched between single mode for individual use or group mode for multiroom music with one tap.

## One tap to set up izzylink™

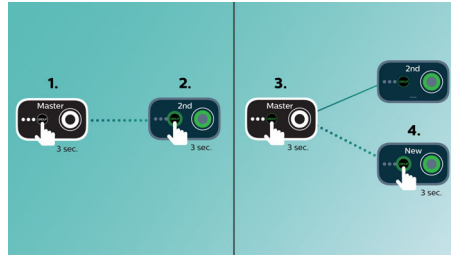

No router, no password, no apps needed for set up. Just long press the "GROUP" button on two speakers to set up for the first time. Repeat to add a 3rd, 4th, or 5th speaker. Each long press of the "Group" button adds one new speaker at a time. Multiroom music has never been easier. Once complete, the izzylink™ network will be stored even when the speaker is unplugged.

## Switch the lead speaker easily

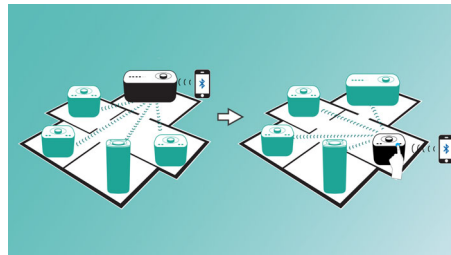

In each izzylink™ group, any individual speaker can be the master, streaming music to the others. When you want to take the lead to share your own music, press the Bluetooth button on the speaker in your room and share that music from your device instantly. Other speakers in the same izzylink™ group will play the same music at the same time, in sync. Sharing music with each other is that easy.

## Room-filling sound

This stereo speaker features powerful 2-way speakers with large passive radiators for wide

and deep stereo sound. The advanced sound processing technology enhances the reproduction of the music so that each note resonates with crystal-clear accuracy, and each pause is sealed with pristine silence. Philips' proprietary Digital Sound Processing technology optimises the performance of compact speaker boxes, delivering rich room-filling sound that is balanced and dynamic, without any distortion.

## Swap music between 2 devices

Pair with 2 smart devices simultaneously so you can stream music from whichever device you want, without the hassle of un-pairing and re-pairing. To play a song on a different device, pause the song on the original device first and then play the new song on a different device to take over. It's perfect for sharing music with friends, at parties, or just playing different songs stored on different devices. Let friends and family pair at the same time, so you can swap between each other's music easily.

## NFC technology

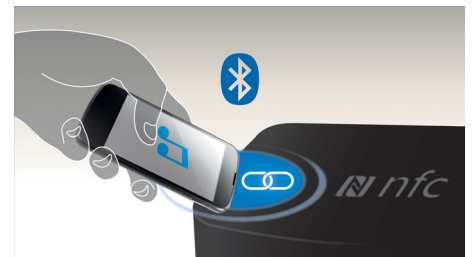

Pair Bluetooth devices easily with one-touch NFC (Near Field Communications) technology. Just tap the NFC-enabled smartphone or tablet on the NFC area of a speaker to turn the speaker on, start Bluetooth pairing and begin streaming music.

# Specifications

## Compatibility

- Android tablets and smartphones: with Android 2.1 and Bluetooth 2.1 or above
- iPad: iPad 1, iPad 2, iPad Air, iPad Air 2, iPad mini, iPad mini 2, iPad mini 3, iPad with Retina display, new iPad
- iPhone: iPhone 3, iPhone 3GS, iPhone 4, iPhone 4S, iPhone 5, iPhone 5C, iPhone 5S, iPhone 6, iPhone 6 Plus, iPhone 6S
- iPod touch: 3rd generation or later
- other music devices: with Bluetooth 2.1 or above
- works with: most Bluetooth smartphones, music devices, tablets

## Sound

- Output power (RMS): 2 x 15 W (maximum)
- Sound System: Stereo
- Speakers: 2 x 3.5" full-range drivers; 2 x 1"

- tweeters; 2 x passive radiators
- Volume Control: rotary

## Connectivity

- NFC: Tap-to-pair Bluetooth; works with Android 4.0 or above, and Windows phone 8 or above
- Audio in (3.5 mm)

## Accessories

- Included accessories: AC/DC Adapter, World Wide Warranty leaflet, Quick install guide

## Dimensions

- Product dimensions (WxDxH): 280 x 165 x 130 mm
- Packaging dimensions (WxDxH): 355 x 165 x 200 mm
- Product weight: 1.4 kg
- Weight incl. Packaging: 2.35 kg



Issue date 2017-10-28

Version: 1.0.8

12 NC: 8670 001 34428  
EAN: 48 95185 62039 8

© 2017 Koninklijke Philips N.V.  
All Rights reserved.

Specifications are subject to change without notice.  
Trademarks are the property of Koninklijke Philips N.V.  
or their respective owners.

[www.philips.com](http://www.philips.com)