

Always there to help you

Register your product and get support at
www.philips.com/welcome



DS3480



User manual

PHILIPS

Contents

1	Safety	2
2	Notice	2
	Care of the environment	2
	Trademark notice	3
	Compliance	3
3	Your Docking Speaker	4
	What's in the box	4
	Overview	4
4	Get started	5
	Charge DS3480	5
	Switch on or off	5
5	Play	6
	Play through the lightning dock	6
	Play through Bluetooth	6
	Play through an audio cable	8
	Adjust the volume	8
6	Charge	9
	Charge through the lightning dock	9
	Charge through the USB connector	9
7	Update the firmware	9
8	Specifications	10
	Amplifier	10
	General information	10
	Bluetooth	10

1 Safety

- Only use attachments/accessories specified by the manufacturer.
- Use only power supplies listed in the user manual.
- The product shall not be exposed to dripping or splashing.
- Do not place any sources of danger on the product (e.g. liquid filled objects, lighted candles).
- Batteries (battery pack or batteries installed) shall not be exposed to excessive heat such as sunshine, fire or the like.
- Danger of explosion if battery is incorrectly replaced. Replace only with the same or equivalent type.
- Where the plug of the Direct Plug-in Adapter is used as the disconnect device, the disconnect device shall remain readily operable.



Warning

- Never remove the casing of this apparatus.
- Never lubricate any part of this apparatus.
- Never place this apparatus on other electrical equipment.
- Keep this apparatus away from direct sunlight, naked flames or heat.
- Ensure that you always have easy access to the power cord, plug or adaptor to disconnect the apparatus from the power.

2 Notice

Any changes or modifications made to this device that are not expressly approved by Philips Consumer Lifestyle may void the user's authority to operate the equipment.

Care of the environment



Your product is designed and manufactured with high quality materials and components, which can be recycled and reused.



When this crossed-out wheeled bin symbol is attached to a product it means that the product is covered by the European Directive 2002/96/EC.

Please inform yourself about the local separate collection system for electrical and electronic products.

Please act according to your local rules and do not dispose of your old products with your normal household waste. Correct disposal of your old product helps to prevent potential negative consequences for the environment and human health.



Your product contains batteries covered by the European Directive 2006/66/EC, which cannot be disposed with normal household waste. Please inform yourself about the local rules on separate collection of batteries because correct disposal helps to prevent negative consequences for the environmental and human health.

Always bring your product to a professional to remove the built-in battery.

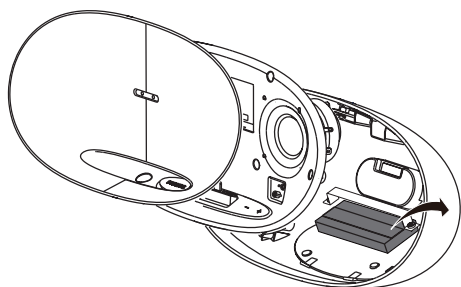

Environmental information

All unnecessary packaging has been omitted. We have tried to make the packaging easy to separate into three materials: cardboard (box), polystyrene foam (buffer) and polyethylene (bags, protective foam sheet.)

Your system consists of materials which can be recycled and reused if disassembled by a specialized company. Please observe the local regulations regarding the disposal of packaging materials, and old equipment.

Trademark notice



“Made for iPod” and “Made for iPhone” mean that an electronic accessory has been designed to connect specifically to iPod or iPhone respectively, and has been certified by the developer to meet Apple performance standards. Apple is not responsible for the operation of this device or its compliance with safety and regulatory standards. Please note that the use of this accessory with iPod or iPhone may affect wireless performance. iPod and iPhone are trademarks of Apple Inc., registered in the U.S. and other countries.

Bluetooth

The Bluetooth® word mark and logos are registered trademarks owned by Bluetooth SIG, Inc. and any use of such marks by Philips is under license.

Compliance

CE 0560

This product complies with the radio interference requirements of the European Community.

Hereby, Philips Consumer Lifestyle, declares that this product is in compliance with the essential requirements and other relevant provisions of Directive 1999/5/EC.

A copy of the EC declaration of Conformity is available in the Portable Document Format (PDF) version of the user manual at www.philips.com/support.

Class II equipment symbol:



CLASS II apparatus with double insulation, and no protective earth provided.



Note

- The type plate is located in the battery compartment.

3 Your Docking Speaker

What's in the box

Check and identify the contents of your package:

- Main unit
- AC/DC power adapter
- Quick start guide

iOS app for the dock

With the lightning dock on **DS3480**, your iPhone/ iPod can work with the following app:



- **ClockStudio**app (allows you to select sound settings, listen to the Internet radio, set clock and alarm and update firmware)

Tip

- You can get the **ClockStudio** app from the **App Store** on your iPhone/ iPod.

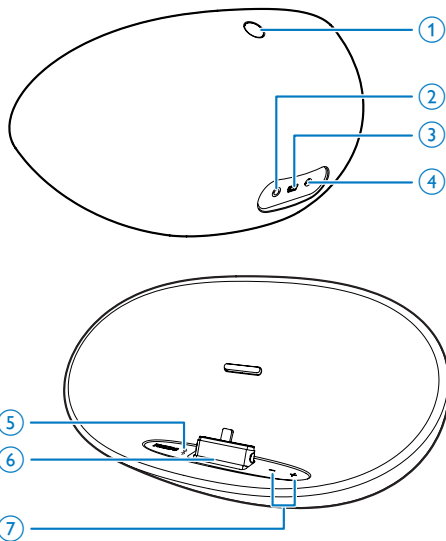
Overview



- ① 
 - Press to switch on or off; Press and hold for 5 seconds to reset Bluetooth
 - Battery level indicator
- ② **DC IN**
 - AC power connector for the supplied AC/DC power adapter
- ③ 
 - Power charging connector for an external device
- ④ **AUDIO IN**
 - Audio input connector for an external audio device
- ⑤ 
 - Bluetooth status indicator
- ⑥ **Dock with the Lightning connector for the iPod/iPhone**
- ⑦ **+, -**
 - Increase or decrease the volume
 - Power on/off indicators

4 Get started

Charge DS3480

DS3480 has a built-in battery that can be charged through the supplied AC/DC power adapter:

- Connect **DS3480** to AC power through the supplied AC/DC power adapter:

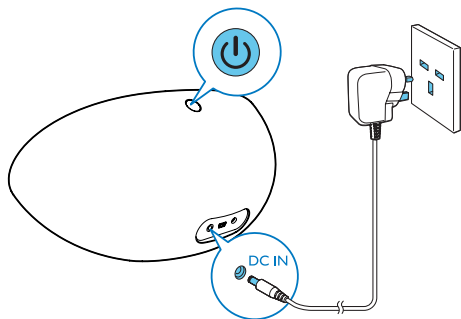

- ↳ During power charging,
 - ⏻ flashes in green if you have switched on **DS3480**.
 - ⏻ is always on in red if you have switched off **DS3480**.
- ↳ When the battery is full, the ⏻ is always on in green if **DS3480** is on; the ⏻ turns off if **DS3480** is off.

Tip

- When the battery level is low, ⏻ flashes in red.
- Rechargeable batteries have a limited number of charge cycles. Battery life and number of charge cycles vary by use and settings.

Switch on or off

- Press ⏻ to switch on.
 - ↳ +, - lights up amber.
 - ↳ The Bluetooth status indicator flashes. **DS3480** starts to pair or reconnect through Bluetooth.

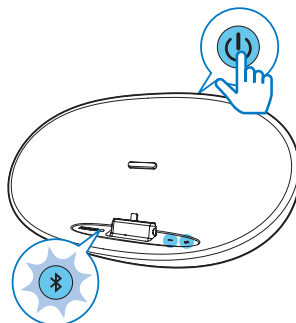

- To switch off, press ⏻ again.

Automatic standby

After 15 minutes in idle mode (no play, no button is pressed), the player switches off.

5 Play

Play through the lightning dock

With the lightning dock on **DS3480**, you can play from the following iPhone/ iPod:

- iPhone 5
- iPod touch (5th generation)
- iPod nano (7th generation)

- 1 Make sure that you have switched on **DS3480**.
- 2 Mount your iPhone/ iPod onto the dock.

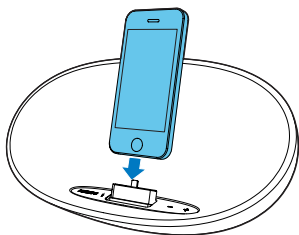

- The first time you mount your iPhone/ iPod onto **DS3480**, install the **ClockStudio** app on your iPhone/iPod as prompted:

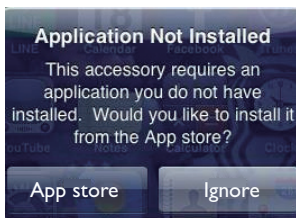

- 3 On your iPhone/ iPod, start music play.



Tip

- To remove the iPhone/ iPod, pull it out of the dock.

Play through Bluetooth

Through Bluetooth, you can play on **DS3480** from a Bluetooth device, such as an iPad, iPhone, Android phone, or laptop.

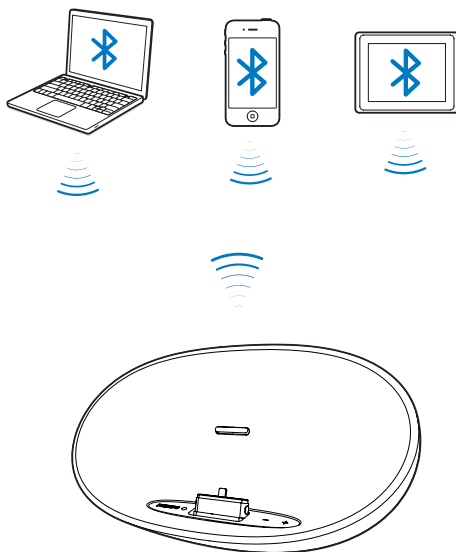

Connect through Bluetooth

- 1 On **DS3480**, press  to switch on.
 ↳ The Bluetooth status indicator flashes.
DS3480 starts to pair or reconnect through Bluetooth.

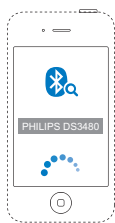
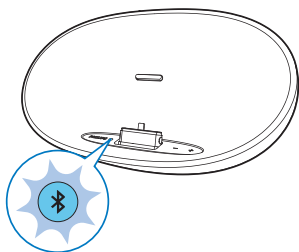

- 2 On your Bluetooth device, activate Bluetooth and search for **Philips DS3480**.
 - For the first-time connection, select **Philips DS3480** to start pairing.
 ↳ When the connection is complete, the Bluetooth indicator is always on in blue and two beeps sound.

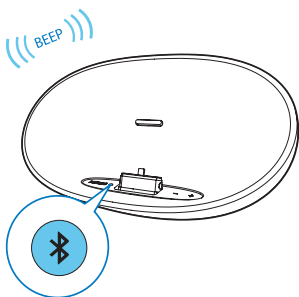

- ↳ Next time you switch on **DS3480**, the speaker connects to the last paired device automatically.



Tip

- To connect **DS3480** to another Bluetooth device, switch off Bluetooth on current Bluetooth device.
- To clear paired devices from **DS3480**, press and hold  for five seconds.

Play from a Bluetooth device

- 1 Make sure that you have removed your iPhone/ iPod from the lightning dock.
- 2 After successful connection, start music play on **DS3480**.

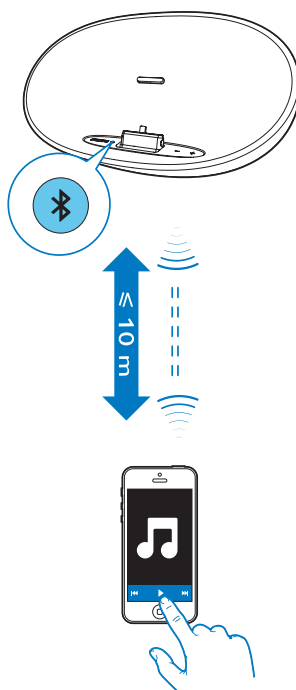

Note

- Make sure the distance between **DS3480** and the Bluetooth device is within 10 meters.
- The music streaming may be interrupted by obstacles between the device and **DS3480**, such as walls, or other devices nearby that operate in the same frequency.

Play through an audio cable

Through an MP3 link cable, you can also play on **DS3480** from an external audio device, such as an MP3 player:

- 1 Use an MP3 link cable to connect **DS3480** with an external audio device.

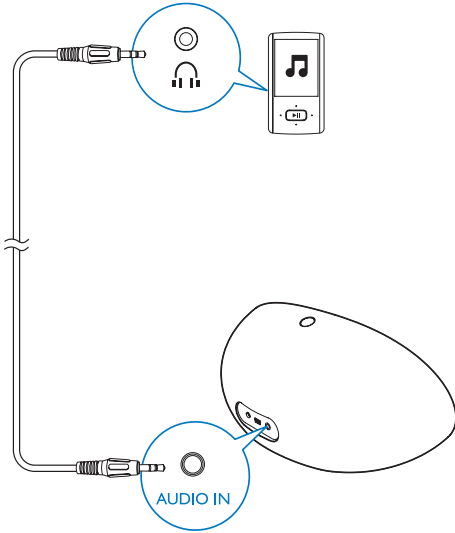

- 2 On **DS3480**, do the following:
 - Make sure that you have paused the music on your iPhone/ iPod docked on **DS3480**;
 - Switch off Bluetooth on the Bluetooth device that is connected to **DS3480**.
- 3 On the external audio device, start music play and change the volume.

Adjust the volume

- Press **+**, **-** repeatedly; or
- Press and hold **+**, **-** to increase or decrease the volume quickly.
 - ↳ When you reach the maximum or minimum level, **+**, **-** flashes in amber.

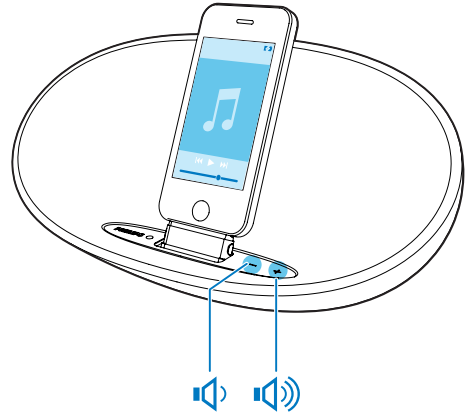

6 Charge

Charge through the lightning dock

With the lightning dock on **DS3480**, you can charge your iPhone/ iPod when music play is on or off.

- 1 Mount your iPhone/ iPod onto the lightning dock on **DS3480**.
- 2 Connect **DS3480** to power:

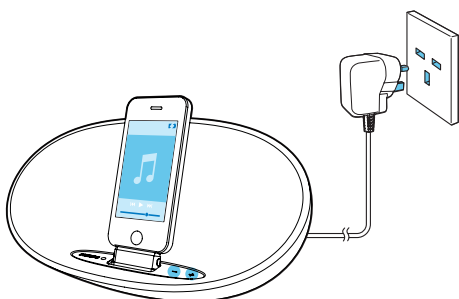

Charge through the USB connector

With the USB connector on **DS3480**, you can charge your mobile phone.

- 1 Use a USB cable to connect **DS3480** with the external device.
- 2 Connect **DS3480** to power:

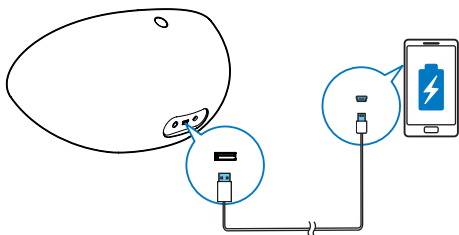

7 Update the firmware

With the **ClockStudio** app on your iPhone/ iPod, you can update the firmware of **DS3480**.

- 1 Make sure that your iPhone/ iPod is connected to the Internet.
- 2 Mount the iPhone/ iPod onto the lightning dock of **DS3480**.
 - ↳ **ClockStudio** starts to search for available firmware update.
 - ↳ When the firmware update is available, a message is displayed.

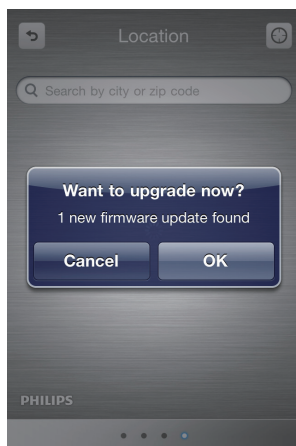

- 3 Follow onscreen instructions to complete firmware updating.

Note

- During the firmware updating, keep the iPhone/ iPod powered on and docked on **DS3480**.

8 Specifications

Amplifier

Rated Output Power	2 X 5 W RMS
--------------------	-------------

General information

Power supply	Model: KSASB0241200200HK (Philips) and KSASB0241200200D5 (Philips);
- AC Power	Input: 100-240 V ~, 50/60Hz, 0.6A; Output: 12 V == 2 A
- Battery	Li-ion battery
Operation Power Consumption	<18 W
Standby Power Consumption	<0.5 W
Max. load for iPod/iPhone	5 V == 1 A
Dimensions	
- Main Unit	274 x 143 x 109 mm (W x H x D)
Weight	
- Main Unit	1.2 kg
Operating temperature and humidity:	0°C to 45°C, 5% to 90% Humidity for all climates.
Storage temperature and humidity:	-40 °C to 70 °C, 5% to 95%

Bluetooth	
Bluetooth version	V2.1+ EDR
Frequency band	2.402-2.480 GHzISM Band
Rang	10m (free space)

Philips Consumer Lifestyle B.V.

PHILIPS

HK-1321- DS3480

2013/05

(Document No. / Numéro du document)

(Year, Month (yyyy/mm) in which the CE mark is affixed /
Année/mois (aaaa/mm) au cours de laquelle le marquage
CE a été apposé)

EUROPEAN DECLARATION OF CONFORMITY

(DECLARATION DE CONFORMITE CE)

We / Nous, PHILIPS CONSUMER LIFESTYLE B.V.

(Company name / Nom de l'entreprise)

TUSSENDIEPEN 4, 9206 AD DRACHTEN, THE NETHERLANDS

(address / adresse)

declare under our responsibility that the product(s):

(déclarons sous notre propre responsabilité que le(s) produit(s))

Philips

DS3480/12./05

(brand name, nom de la marque)

(Type version or model, référence ou modèle)

Docking Speaker

(product description, description du produit)

to which this declaration relates is in conformity with the following harmonized standards:

(auquel cette déclaration se rapporte, est conforme aux normes harmonisées suivantes)

(title, number and date of issue of the standard / titre, numéro et date de parution de la norme)

EN 60065:2006+A1:2006+A11:2008+A2:2010+A12:2011

EN 55013:2001+A1:2003+A2:2006

EN 55020:2007+A11:2011

EN 61000-3-2:2006 + A1:2009+A2:2009

EN 61000-3-3:2008

EN300328 V1.7.1:2006

EN 301489-1 V1.9.2:2011

EN301489-17 V2.2.1:2012

EN 62479:2010

EN 50564:2011

EN50581:2012

following the provisions of :

(conformément aux exigences essentielles et autres dispositions pertinentes de:)

2006/95/EC (Low Voltage Directive)

1999/5/EC (R&TTE Directive)

2004/108/EC (EMC Directive)

2011/65/EU (RoHS Directive)

2009/125/EC (Eco Design) - EC/1275/2008;EC/278/2009

And are produced under a quality scheme at least in conformity with ISO 9001 or CENELEC Permanent Documents

(Et sont fabriqués conformément à une qualité au moins conforme à la norme ISO 9001 ou aux Documents Permanents CENELEC)

Only for Medical Devices and R&TTE products:

The Notified Body:

Telefication/CE0560

performed:

NB

(L'Organisme Notifié)

(Name and number/ nom et numéro)

(a effectué)

(description of intervention / description de l'intervention)

and issued the certificate:

13214079/AA/00

(et a délivré le certificat)

(certificate number / numéro du certificat)

Remarks:

Drachten, Netherlands, May 22, 2013

(place, date / lieu, date)

A.Speelman, CL Compliance Manager

(signature, name and function / signature, nom et fonction)

Philips Consumer Lifestyle B.V.

template AMB 544-9056



Specifications are subject to change without notice
© 2013 Koninklijke Philips Electronics N.V.
All rights reserved.

DS3480_05_UM_V1.0

