

Quick Start Guide



Step A *Connect*

Step B *Setup*

Step C *Enjoy*

What's in the Box?

You should find these items upon opening the box.

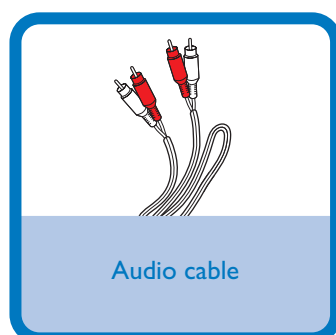
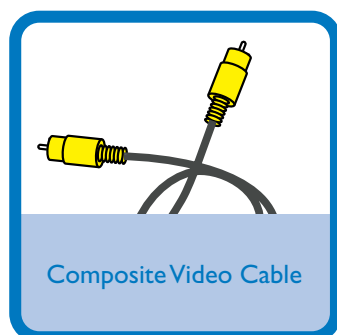

Remove the plastic protective sheet

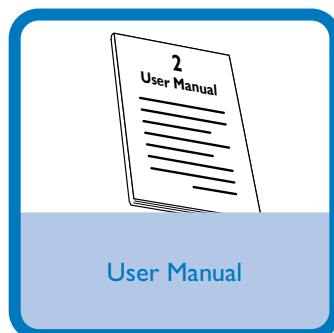
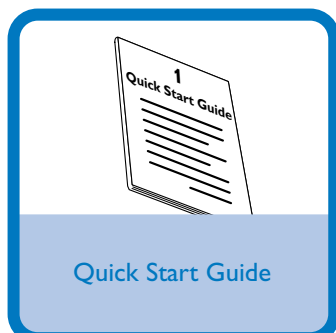
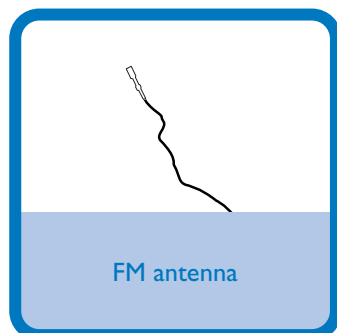
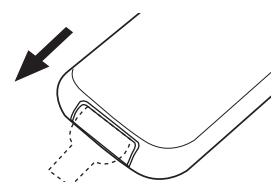

PHILIPS

Step A Connect

Tip

See the User Manual for other TV connection options.

1

Connect the speaker cables.

2

Connect the FM antenna.

3

Connect the composite video cable to a TV.

4

Connect the power supplies of the system and TV.

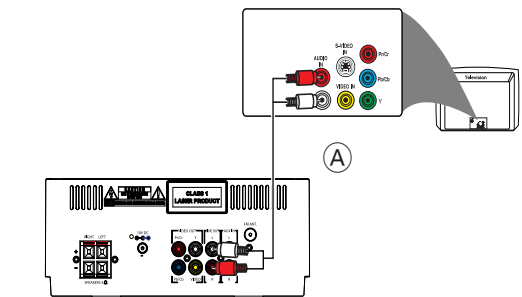
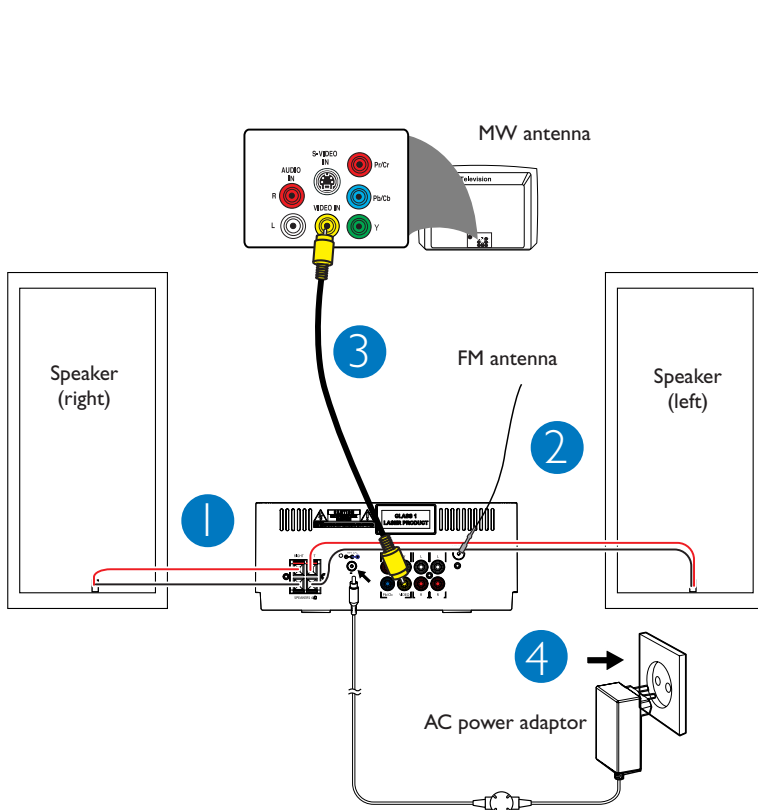

Ⓐ To listen to the sound of this DVD Player through your TV, use the audio cables (white/red) to connect **LINE OUT (L/R)** jacks of the DVD Player to the corresponding **AUDIO IN** jacks on the TV.

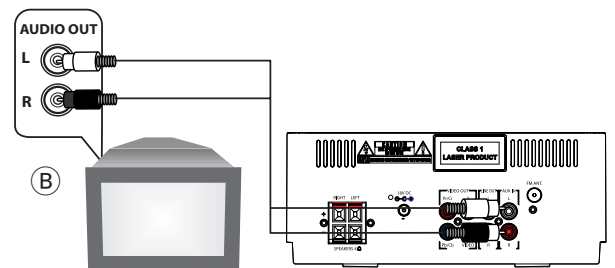

Ⓑ To listen to the sound of your TV through this DVD player, use a cinch cable to connect **AUX IN** on the rear panel of the DVD player to the corresponding **AUDIO OUT** jacks on the TV.

Tip

The USB feature is not available for this product.

Step B Setup

Setting up the TV

1

Press **SOURCE** (**DISC** on the remote) to select disc source.

2

Turn on the TV and set it to the correct Video In channel.

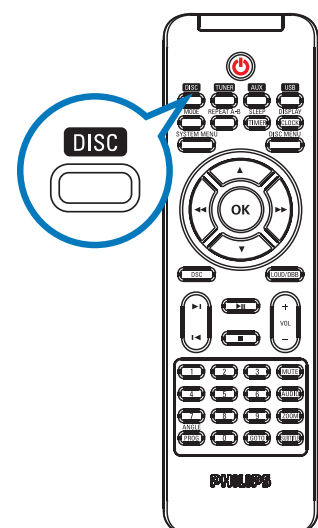

Step B Setup

Setting the clock

- 1 In standby mode, press and hold **DISPLAY/CLOCK** on the remote control.
- 2 When the hour digits flash, press **VOLUME +/-** on the front panel or **VOL +/-** on the remote to set the hours.
- 3 Press **DISPLAY/CLOCK** again and the minute digits flash. Then press **VOLUME +/-** on the front panel or **VOL +/-** on the remote to set the minutes.
- 4 Press **DISPLAY/CLOCK** again to confirm the time setting.

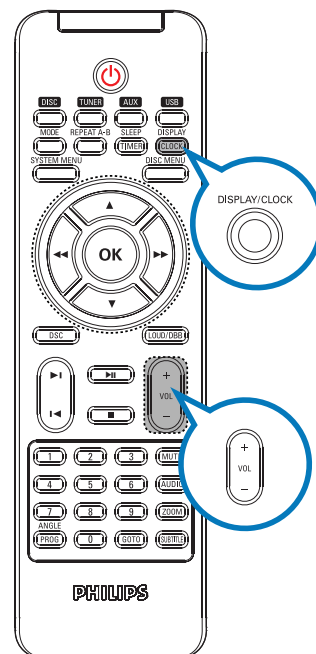

Setting system menu options

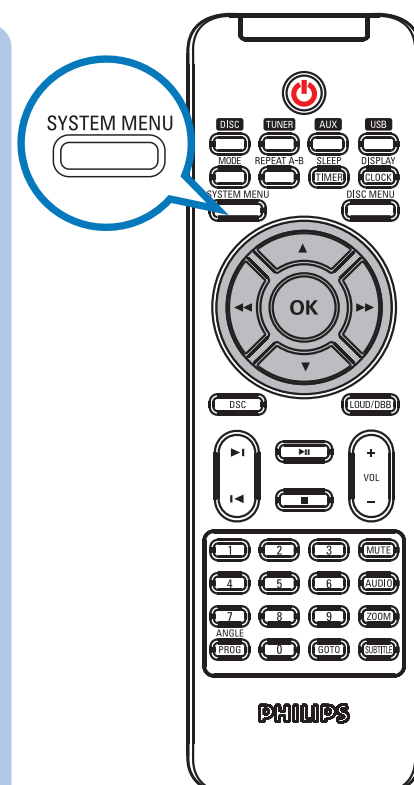
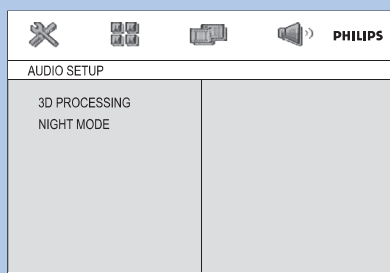
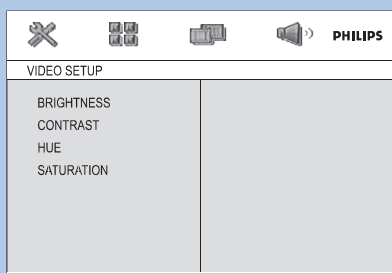
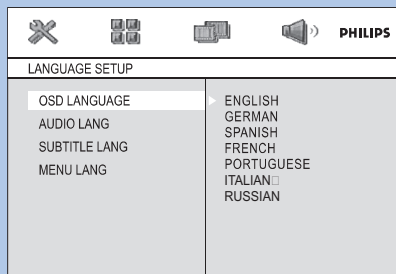
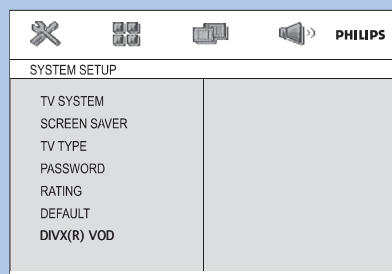

Tip

See chapters "Preparations" and "System Menu Options" in the User Manual for detailed descriptions.

Playing a disc

1 Push **OPEN•CLOSE**  on the top of the system to open the disc door.

2 Insert a disc with the print side facing up and close the disc door.

3 Playback will start automatically. If not press **▶||**.

4 To stop playback, press **■**.

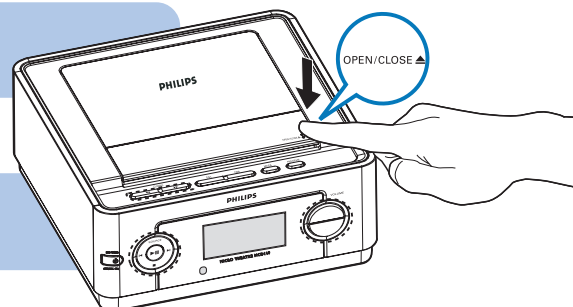

Programming and tuning to radio stations

1 Press **SOURCE** (**TUNER** on the remote) to select tuner source.

2 Press **PROG/ANGLE** for more than two seconds to program all available stations in order of waveband.

3 Press **◀/▶** until the desired preset station is displayed.

Tip

Detailed playback features and additional functions are described in the accompany owner's manual.

