

# Always there to help you

Register your product and get support at  
[www.philips.com/support](http://www.philips.com/support)



NTRX100



## User manual

# PHILIPS



# Contents

<b>1 Important</b>	<b>2</b>
Safety	2
Notice	3

<b>2 Your Mini Hi-Fi System</b>	<b>5</b>
Introduction	5
What's in the box	5
Overview of the main unit	6
Overview of the remote control	8

<b>3 Get started</b>	<b>10</b>
Prepare the remote control	10
Connect power	10
Turn on	10

<b>4 Play</b>	<b>12</b>
Basic play operations	12
Play from Bluetooth-enabled devices	12
Play through USB	14
Play options	14

<b>5 Listen to radio</b>	<b>15</b>
Tune to radio stations	15
Store radio stations	15
Select a preset radio station	15
Select stereo/mono broadcast	15

<b>6 Adjust sound</b>	<b>16</b>
Adjust speaker volume	16
Select a sound effect	16
Mute sound	16
Select an audio output mode	16

<b>7 Additional features</b>	<b>17</b>
Play audio from an external device	17
Speak or sing through the Hi-Fi system	17
Enjoy simultaneous play	18
Adjust decoration light	18

<b>8 Product information</b>	<b>19</b>
Specifications	19
USB playability information	19

<b>9 Troubleshooting</b>	<b>21</b>
About Bluetooth device	21

# 1 Important

---

## Safety

---

### Important Safety Instructions

- ① Read these instructions.
- ② Keep these instructions.
- ③ Heed all warnings.
- ④ Follow all instructions.
- ⑤ Do not use this apparatus near water.
- ⑥ Clean only with dry cloth.
- ⑦ Do not block any ventilation openings. Install in accordance with the manufacturer's instructions.
- ⑧ Do not install near any heat sources such as radiators, heat registers, stoves, or other apparatus (including amplifiers) that produce heat.
- ⑨ Protect the power cord from being walked on or pinched, particularly at plugs, convenience receptacles, and the point where they exit from the apparatus.
- ⑩ Only use attachments/accessories specified by the manufacturer.
- ⑪ Use only with the cart, stand, tripod, bracket, or table specified by the manufacturer or sold with the apparatus. When a cart is used, use caution when moving the cart/apparatus combination to avoid injury from tip-over.
- ⑫ Unplug this apparatus during lightning storms or when unused for long periods of time.
- ⑬ Refer all servicing to qualified service personnel. Servicing is required when the apparatus has been damaged in any way, such as power-supply cord or plug is damaged, liquid has been spilled or objects have fallen into the apparatus, the apparatus has been exposed to rain or moisture, does not operate normally, or has been dropped.
- ⑭ **Battery usage CAUTION – To prevent battery leakage which may result in bodily injury, property damage, or damage to the unit:**
  - Install all batteries correctly, + and - as marked on the unit.
  - Do not mix batteries (old and new or carbon and alkaline, etc.).
  - Remove batteries when the unit is not used for a long time.
- ⑮ Apparatus shall not be exposed to dripping or splashing.
- ⑯ Do not place any sources of danger on the apparatus (e.g. liquid filled objects, lighted candles).
- ⑰ Where the MAINS plug or an appliance coupler is used as the disconnect device, the disconnect device shall remain readily operable.

---

### Mains fuse

This information applies only to products with a UK mains plug.

This product is fitted with an approved molded plug. If you replace the fuse, use one with:

- the ratings shown on the plug,
- a BS 1362 approval, and
- the ASTA approval mark.



Contact your dealer if you are not sure about what type of fuse to use.

**Caution:** To conform with the EMC directive (2004/108/EC), do not detach the plug from the power cord.

**Risk of overheating!** Never install this apparatus in a confined space. Always leave a space of at least four inches around this apparatus for ventilation. Ensure curtains or other objects never cover the ventilation slots on this apparatus.



### Warning

- Never remove the casing of this unit.
- Never lubricate any part of this unit.
- Place this unit on a flat, hard and stable surface.
- Never place this unit on other electrical equipment.
- Only use this unit indoors. Keep this unit away from water, moisture and liquid-filled objects.
- Keep this unit away from direct sunlight, naked flames or heat.

## Hearing safety



### Listen at a moderate volume.

- Using headphones at a high volume can impair your hearing. This product can produce sounds in decibel ranges that may cause hearing loss for a normal person, even for exposure less than a minute. The higher decibel ranges are offered for those that may have already experienced some hearing loss.
- Sound can be deceiving. Over time your hearing 'comfort level' adapts to higher volumes of sound. So after prolonged listening, what sounds 'normal' can actually be loud and harmful to your hearing. To guard against this, set your volume to a safe level before your hearing adapts and leave it there.

### To establish a safe volume level:

- Set your volume control at a low setting.
- Slowly increase the sound until you can hear it comfortably and clearly, without distortion.

### Listen for reasonable periods of time:

- Prolonged exposure to sound, even at normally 'safe' levels, can also cause hearing loss.
- Be sure to use your equipment reasonably and take appropriate breaks.

### Be sure to observe the following guidelines when using your headphones.

- Listen at reasonable volumes for reasonable periods of time.
- Be careful not to adjust the volume as your hearing adapts.
- Do not turn up the volume so high that you can't hear what's around you.
- You should use caution or temporarily discontinue use in potentially hazardous situations.

## Notice

# CE 0560

Hereby, Gibson Innovations declares that this product is in compliance with the essential requirements and other relevant provisions of Directive 1999/5/EC. You can find the Declaration of Conformity on [www.philips.com/support](http://www.philips.com/support).

Any changes or modifications made to this device that are not expressly approved by Gibson Innovations may void the user's authority to operate the equipment.

Philips and the Philips' Shield Emblem are registered trademarks of Koninklijke Philips N.V.

and are used by Gibson Innovations Limited under license from Koninklijke Philips N.V."

Specifications are subject to change without notice. Gibson reserves the right to change products at any time without being obliged to adjust earlier supplies accordingly.



Your product is designed and manufactured with high quality materials and components, which can be recycled and reused.



When this crossed-out wheeled bin symbol is attached to a product it means that the product is covered by the European Directive 2002/96/EC.

Please inform yourself about the local separate collection system for electrical and electronic products.

Please act according to your local rules and do not dispose of your old products with your normal household waste. Correct disposal of your old product helps to prevent potential negative consequences for the environment and human health.



Your product contains batteries covered by the European Directive 2006/66/EC, which cannot be disposed with normal household waste. Please inform yourself about the local rules on separate collection of batteries because correct disposal helps to prevent negative consequences for the environmental and human health.



**Be responsible  
Respect copyrights**

The making of unauthorized copies of copy-protected material, including computer programs, files, broadcasts and sound recordings, may be an infringement of copyrights and constitute a criminal offence. This equipment should not be used for such purposes.

### **Environmental information**

All unnecessary packaging has been omitted. We have tried to make the packaging easy to separate into three materials: cardboard (box), polystyrene foam (buffer) and polyethylene (bags, protective foam sheet.)

Your system consists of materials which can be recycled and reused if disassembled by a specialized company. Please observe the local regulations regarding the disposal of packaging materials, exhausted batteries and old equipment.

### **Bluetooth**

The Bluetooth® word mark and logos are registered trademarks owned by Bluetooth SIG, Inc. and any use of such marks by Gibson is under license. Other trademarks and trade names are those of their respective owners



The N Mark is a trademark or registered trademark of NFC Forum, Inc. in the United States and in other countries.



This is CLASS II apparatus with double insulation, and no protective earth provided.

## 2 Your Mini Hi-Fi System

Congratulations on your purchase, and welcome to Philips! To fully benefit from the support that Philips offers, register your product at [www.philips.com/welcome](http://www.philips.com/welcome).

---

### Introduction

**With this Hi-Fi system, you can:**

- enjoy audio from your USB storage devices, Bluetooth enabled devices, or other external devices
- swap play between the dual audio sources with the cross fader
- listen to FM radio stations
- speak or sing with microphones through the loudspeakers of the unit

**To enrich sound, this Hi-Fi system offers you these sound effects:**

- Dynamic Bass Boost (DBB)
- Max Sound for instant power boost

---

### What's in the box

Check and identify the contents of your package:

- Main unit
- Remote control (with batteries)
- Power cord
- Printed materials

## Overview of the main unit

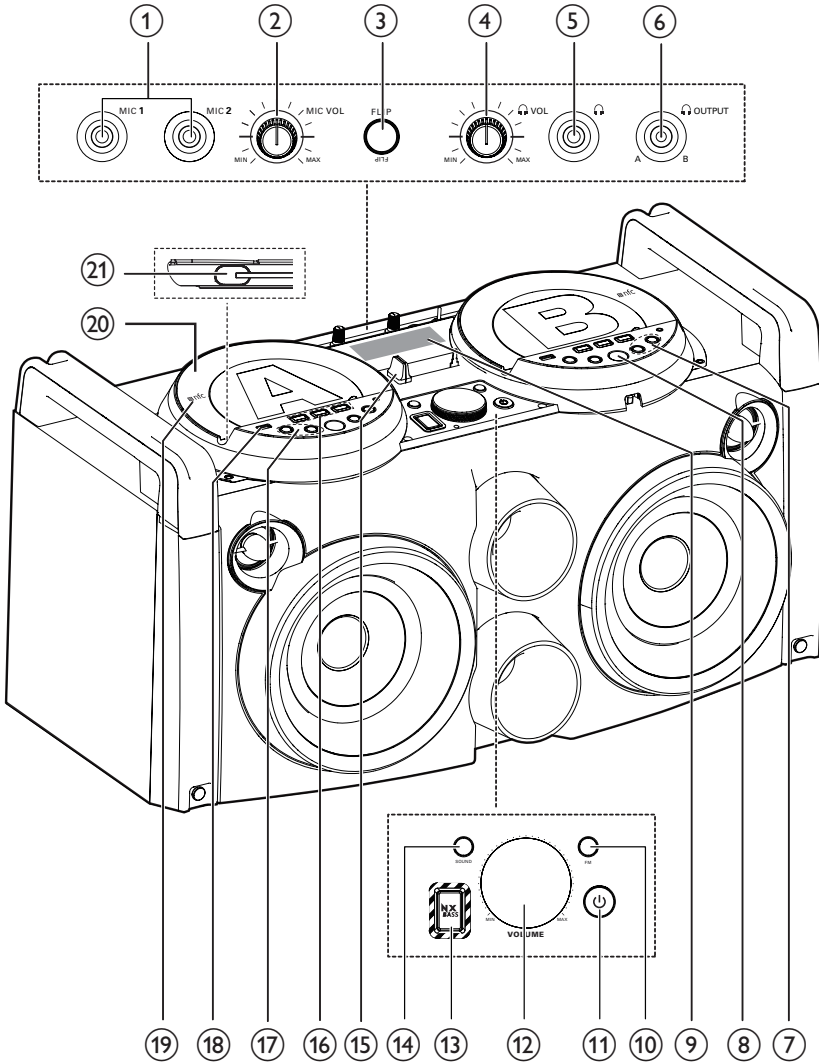

### ① MIC 1/MIC 2

- Connect microphones.

### ② MICVOL

- Adjust volume of the connected microphone(s).







### ③ FLIP

- Reverse the text displayed on the screen.

### ④ VOL

- Adjust headphone volume.



- ⑤ 
  - Connect a headphone for monitoring.
- ⑥  **OUTPUTA/B**
  - Switch headphone output between audio source A and B.
- ⑦  /  **(A/B)**
  - Skip to the previous/next track.
  - (Press and hold) fast backward/forward.
- ⑧  **(A/B)**
  - Start or pause play.
- ⑨ **Display panel**
  - Show current status.
- ⑩ **FM**
  - Select the tuner source.
- ⑪ 
  - Turn on the unit or switch to standby mode.
- ⑫ **Volume knob**
  - Adjust speaker volume.
- ⑬ **NX BASS**
  - Enable instant power boost.
- ⑭ **SOUND**
  - Select a preset sound setting.
- ⑮ **CROSS FADER**
  - Swap play between audio source A and B.
- ⑯ **Source selection keys (A/B)**
  - Select a source (A/B): USB, BLUETOOTH, or AUDIO IN.
- ⑰ **PRESET +/- ◀▶ (A/B)**
  - Select a preset radio station.
- ⑱  **(A/B)**
  - Connect a USB mass storage device.
- ⑲ **NFC area (A/B)**
  - Touch with an NFC compatible device to set up Bluetooth connection automatically.
- ⑳ **Turntable (A/B)**
  - Turn clockwise by 180 degrees to reverse button display for easy operation even from the back.
  - To operate from the front again, turn unclockwise by 180 degrees.
- ㉑ **Attached 3.5mm audio cable(A/B)**
  - Connect an external audio device.

## Overview of the remote control

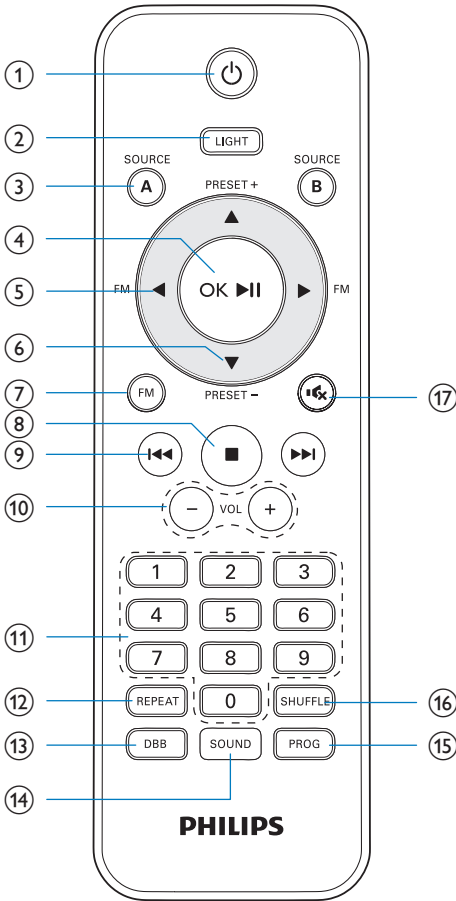

- ① **Power**
- Turn on the unit or switch to standby mode.
- ② **LIGHT**
- Adjust the decoration light around the speakers.
- ③ **SOURCE/A/B**
- Select a source (A/B): USB, BLUETOOTH, or AUDIO IN.

- ④ **OK / Play/Pause**
- Start or pause play.
  - confirm selection.
- ⑤ **◀▶ (FM)**
- In tuner mode, press to tune to a radio station step by step.
  - In tuner mode, press and hold to search for a radio station with sufficient signal strength automatically.
- ⑥ **▲▼ (PRESET +/-)**
- Select a preset radio station.
- ⑦ **FM**
- Select the tuner source.
  - In FM mode, switch between mono and stereo broadcast.
- ⑧ **■**
- Stop play.
  - Exit search for FM radio stations.
- ⑨ **◀◀ / ▶▶**
- Skip to the previous/next track.
  - Search within a track.
- ⑩ **VOL +/-**
- Adjust speaker volume.
- ⑪ **Numeric keypad (0 to 9)**
- In USB mode, select a track directly.
  - In tuner mode, select a preset radio station directly.
- ⑫ **REPEAT**
- Select repeat play modes.
- ⑬ **DBB**
- Press repeatedly to select a dynamic bass enhancement effect: DBB 1, DBB 2, DBB3, DBB OFF.
- ⑭ **SOUND**
- Select a preset sound setting.

**⑮ PROG**

- Press briefly to save the current radio station.
- Press and hold to start automatic programming of radio stations.

**⑯ SHUFFLE**

- In USB mode, turn on/off shuffle play.

**⑰ 静音**

- Mute or restore sound output.

# 3 Get started

## ! Caution

- Use of controls or adjustments or performance of procedures other than herein may result in hazardous radiation exposure or other unsafe operation.

Always follow the instructions in this chapter in sequence.

If you contact Philips, you will be asked for the model and serial number of this apparatus. The model number and serial number are on the back of the apparatus. Write the numbers here:

Model No. \_\_\_\_\_

Serial No. \_\_\_\_\_

## Prepare the remote control

- 1 Press and push the battery compartment to slide it open (see “1” in the illustration).
- 2 Insert two AAA batteries with correct polarity (+/-) as indicated.
- 3 Push and slide back the battery compartment (see “3” in the illustration).

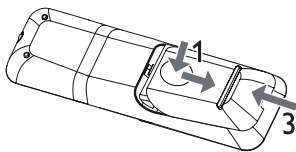

## ≡ Note

- The batteries shall not be exposed to excessive heat such as sunshine, fire or the like.
- If you are not going to use the remote control for a long time, remove the batteries.
- Do not mix batteries (old and new or carbon and alkaline, etc.).
- Batteries contain chemical substances, so they should be disposed of properly.

## Connect power

### ! Caution

- Risk of product damage! Make sure that the power supply voltage corresponds to the voltage printed on the head of the AC power cord.
- Risk of electric shock! When you unplug the power cord, always pull the plug from the socket. Never pull the cord.

### ≡ Note

- Before you connect the AC power cord, make sure that you have completed all the other connections.

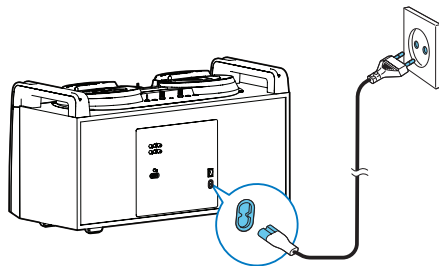

- Connect the AC power cord to
  - the ~AC IN socket on this unit.
  - the wall power socket.

## Turn on

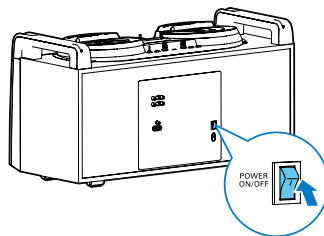

- 1 Turn the **POWER ON/OFF** switch on the back panel to the **I** position.
- 2 Press **⏻**.
  - ↳ The unit switches to the last selected source.

---

## Switch to standby mode

- Press **⏻** to switch the unit to standby mode.
  - ↳ The backlight on the display panel turns off.

# 4 Play

## Basic play operations

You can control play through the following operations.

Function	Action
To stop play	press <b>■</b> .
To pause/ resume play	press <b>▶  </b> .
To skip to a track	press <b>◀◀ / ▶▶</b> .
To search during play	press and hold <b>◀◀ / ▶▶</b> , then release to resume normal play.
To swap play between audio source A and B	<ul style="list-style-type: none"><li>• Press <b>SOURCE A</b> or <b>SOURCE B</b> repeatedly.</li><li>• * On the top panel, move the cross fader to the left (A) or right (B) to fade in and fade out.</li></ul>

\* When you use the cross fader to swap play between source A and B, the music play will not be interrupted. For example, when you move the cross fader from the left to the right, the song played from source A will gradually reduce to silence (fade-out), while at the same time, the song played from source B will gradually increase from silence (fade-in).

## Play from Bluetooth-enabled devices



### Note

- The effective operation range between the unit and your Bluetooth enabled device is approximately 10 meters (30 feet).
- Any obstacle between the unit and the Bluetooth enabled device can reduce the operational range.
- Compatibility with all Bluetooth devices is not guaranteed.
- The unit can memorize up to 4 previously connected Bluetooth devices for either A or B.

To enjoy music through the unit wirelessly, you need to pair your Bluetooth enabled device with the unit.

Choose your best Bluetooth pairing method based on the preconditions listed below.

Precondition	Pairing method
Your Bluetooth device supports both NFC (Near Field Communication) and A2DP (Advanced Audio Distribution Profile).	Choose Option 1 (recommended) or Option 2.
Your Bluetooth device only supports A2DP (Advanced Audio Distribution Profile).	Choose Option 2.

- Before pairing and connection, you need to:
  - ① **press SOURCE A/B repeatedly to select the Bluetooth source.**
    - ↳ **[BT]** (Bluetooth) is displayed.
    - ↳ The LED indicator on the **BLUETOOTH** button on the top of the unit flashes white.
  - ② **enable the Bluetooth feature on your external device.**

## Pair and connect

### Option 1: Pair and connect through NFC

Near Field Communication (NFC) is a technology that enables short-range wireless communication between various NFC compatible devices, such as mobile phones and IC tags.

With the NFC function, data communication can be achieved easily just by touching the relevant symbol or designated location on NFC compatible devices.

#### Note

- Compatibility with all NFC devices is not guaranteed.

- 1 Enable the NFC feature on your Bluetooth enabled device (see the user manual of the device for details).
- 2 Touch the NFC area of the external device with the NFC area (A/B) on the top of the unit until you hear a beep.
  - ↳ After successful pairing and connection, the LED indicator on the **BLUETOOTH** button turns solid white.

### Option 2: Pair and connect manually

- 1 On the Bluetooth enabled device, search for Bluetooth devices that can be paired (see the user manual of the device).
- 2 Select '**Philips NTRX100A**' or '**Philips NTRX100B**' on your Bluetooth enabled device and if necessary input '0000' as the pairing password.
  - ↳ After successful pairing and connection, the LED indicator on the **BLUETOOTH** button turns solid white, and the unit beeps.

## Stream music through Bluetooth

- Play audio on the Bluetooth device connected to the unit.
  - ↳ Audio streams from your Bluetooth enabled device to the unit.



#### Tip

- If the Bluetooth enabled device also supports AVRCP (Audio Video Remote Control Profile), you can use some basic operation buttons of the unit (such as the play/pause, stop and previous/next buttons) to control music play.

### To disconnect the Bluetooth-enabled device:

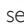
- Press and hold  for three seconds.
- Deactivate Bluetooth on your device; or
- Move the device beyond the communication range.

### To clear Bluetooth pairing history:

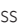
- Press and hold both  and  (A/B) on the unit for three seconds.
  - ↳ The current Bluetooth connection is disconnected.

## Play through USB

### Note

- Make sure that the USB device contains playable audio content.

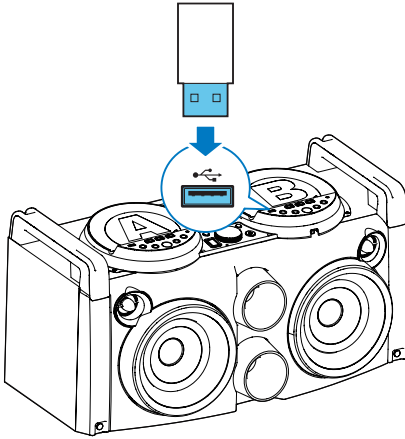

- 1 Insert a USB mass storage device into the  socket on either the left (A) or the right (B).
- 2 Press **SOURCE** (A/B) repeatedly to select the USB source.  
↳ Play starts automatically.







### Tip

- You can also charge your mobile device through the USB socket.

## Play options

### Repeat and shuffle play

- During play, press **REPEAT** repeatedly to select:



-  -1 (repeat one): play the current track repeatedly.
  -  (repeat all): play all tracks repeatedly.
  - None: resume normal play.
- During play, press **SHUFFLE** repeatedly to select:
-  (shuffle): play all tracks randomly.
  - None: resume normal play.
- To play all tracks repeatedly in random order, press **REPEAT** repeatedly until  is displayed, then press **SHUFFLE**.  
↳ Both  and  are displayed.

### Listen through headphone

### Note

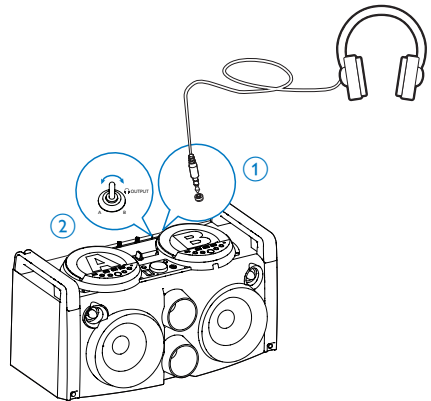
- When you listen and monitor through a headphone, the loudspeaker of the unit will be not muted.

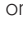

- 1 Plug a headphone into the  socket on the top panel.
- 2 Depending on which audio source you want to listen to, switch  **OUTPUT** to the left (A) or right (B).
- 3 Use  **VOL** to adjust the monitor headphone volume.



## 5 Listen to radio

### Tune to radio stations

#### Note

- To improve FM reception, fully extend and adjust the position of the FM antenna attached to the back panel.

- 1 Press **FM** to select the FM tuner source.
- 2 Press and hold **◀▶ (FM)** for three seconds.  
↳ The unit tunes to a station with strong reception automatically.
- 3 Repeat step 2 to tune to more stations.

#### To tune to a weak station:

- Press **◀▶ (FM)** repeatedly until you find optimal reception.

### Store radio stations

#### Note

- You can store a maximum of 20 FM radio stations.

- 1 Tune to a radio station.
- 2 Press **PROG** to activate programming.
- 3 Press **▲▼ (PRESET +/-)** to allocate a number from 1 to 20 to this radio station, then press **PROG** to confirm.  
↳ The preset number and the frequency of the preset station are displayed.
- 4 Repeat the previous steps to program other stations.

#### Note

- You can also use the numeric keypad directly to allocate a preset number. To allocate a 2-digit number, press the number corresponding to the first digit, and then press the number corresponding to the second digit within 2 seconds.
- To overwrite a programmed station, store another station in its place.

You can also store radio stations automatically.

- In FM tuner mode, press and hold **PROG** to start automatic programming.  
↳ All available stations are programmed in the order of waveband reception strength.  
↳ The first programmed radio station is broadcast automatically.

### Select a preset radio station

- In tuner mode, press **▲▼ (PRESET +/-)** repeatedly to select a preset radio station.

#### Tip

- You can also use the numeric keypad directly to select a preset number. To select a 2-digit number, press the number corresponding to the first digit, and then press the number corresponding to the second digit within 2 seconds.

### Select stereo/mono broadcast

#### Note

- Stereo broadcast is the default setting for tuner mode.
- For stations with weak signals: to improve the reception, change to monaural sound.

- In FM tuner mode, press **FM** to switch between mono and stereo broadcast.

## 6 Adjust sound

### Adjust speaker volume

- During play, press **VOL +/-** to increase/decrease speaker volume.

### Select a sound effect



Note

- You cannot use different sound effects at the same time.

### Boost sound power

This feature allows you to give an instant boost to the sound power.

- Press **NX BASS** on the front panel to turn on instant power boost.

### Select a preset sound effect

The DSC (Digital Sound Control) feature allows you to enjoy special sound effects.

- During play, press **SOUND** repeatedly to select:
  - **[SAMBA]** (samba)
  - **[ROCK]** (rock)
  - **[JUNGLE]** (jungle)
  - **[POP]** (pop)

### Enhance bass

The best DBB (Dynamic Bass Enhancement) setting is generated automatically for each DSC selection. You can manually select the DBB setting that best suits your listening environment.

- During play, press **DBB** repeatedly to select:
  - DBB 1
  - DBB 2
  - DBB 3
  - DBB OFF

### Mute sound

- During play, press **M** to mute or restore sound output.

### Select an audio output mode

- Switch **CHANNEL CONTROL** at the back panel to one of the following positions:
  - **RR**: Audio output to the right channel only;
  - **RL**: Audio output to both the left and right channels;
  - **LL**: Audio output to the left channel only.

## 7 Additional features

### Play audio from an external device

With this Hi-Fi system, you can play audio from an external audio device.

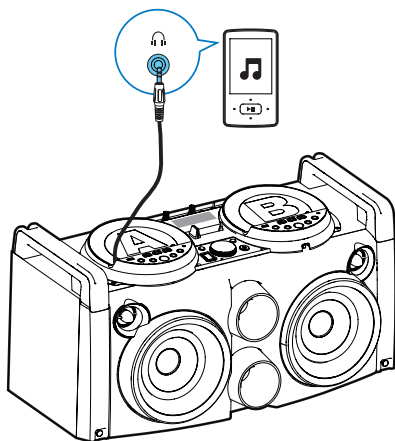

- 1 Connect the attached 3.5mm audio cable (A/B) to the headphone socket on an external device.
- 2 Press **SOURCE A** or **SOURCE B** repeatedly to select the **AUDIO IN** source.
- 3 Play the external device (see the device's user manual).

### Speak or sing through the Hi-Fi system

You can speak or sing through this Hi-Fi system with a microphone.

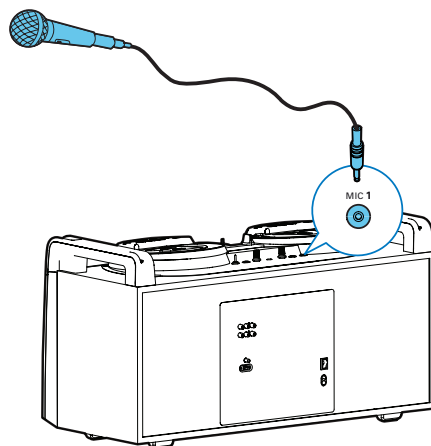

- 1 Connect a microphone (not supplied) to the **MIC 1** or **MIC 2** socket on the top panel.
- 2 Use the **MICVOL** knob on the top panel to adjust the microphone volume.

## Enjoy simultaneous play

You can output audio to multiple compatible Hi-Fi systems (FWP1000) to enjoy simultaneous play.

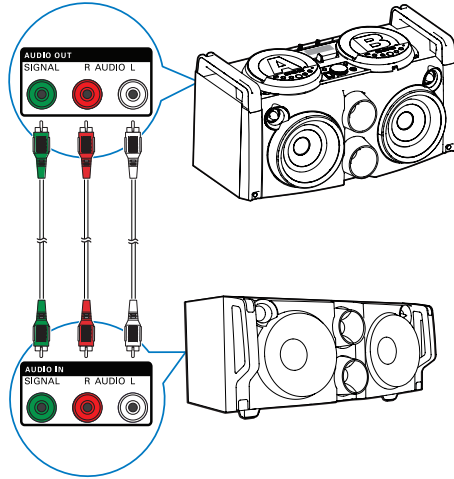

- 1 Connect audio cables (white/red) to:
  - the **AUDIO OUT (AUDIO L/R)** sockets on the back panel of this unit.
  - the **AUDIO IN (AUDIO L/R)** sockets on a compatible Hi-Fi system (FWP1000).
- 2 Connect a signal cable (green) to:
  - the **AUDIO OUT (SIGNAL)** socket on the back panel of the unit.
  - the **AUDIO IN (SIGNAL)** socket on a compatible Hi-Fi system (FWP1000).
- 3 If you like, connect more compatible Hi-Fi systems (FWP1000) together in the same way.
- 4 Start play on this unit (NTRX100).
  - ↳ You can hear music from the loudspeakers of all the Hi-Fi systems connected to each other.

## Adjust decoration light

- In power-on mode, press **LIGHT** repeatedly to adjust the decoration light around the loudspeakers.
  - Blue (default, blinking blue with the music beat)
  - Orange (blinking orange with the music beat)
  - Blue, purple, orange (blinking blue, purple and orange simultaneously with the music beat)
  - Off



### Tip

- The light blinks as the music beat changes.

# 8 Product information



## Note

- Product information is subject to change without prior notice.

## Specifications

### Amplifier

Rated Output Power	300W RMS at 10%THD
Frequency Response	40 - 20000 Hz, $\pm 3$ dB
Signal to Noise Ratio	>65dBA
AUDIO IN	600mV RMS

### Tuner (FM)

Tuning Range	87.5 - 108MHz
Tuning grid	50KHz
Sensitivity	<22dBf
- Mono, 26dB S/N Ratio	<49.5dBf
- Stereo, 46dB S/N Ratio	
Search Selectivity	<35dBf
Signal to Noise Ratio	>50dB

### Speakers

Speaker Impedance	4 ohm
Speaker Driver	2 x 160 mm (6.5") woofer + 2 x 50 mm (2") tweeter
Sensitivity	84dB/m/W $\pm$ 4dB/m/W

## Bluetooth

Bluetooth version	V2.1 + EDR
Frequency band	2.4GHz ~ 2.48GHz ISM Band
Range	10m (free space)
Bluetooth Secure Simple Pairing Using NFC	Yes

## General information

AC power	110 - 240V~, 50 - 60Hz
Operation power consumption	65W
Eco Standby Power Consumption	<0.5W
Headphone Output	25mW 32ohm
USB direct	Version 2.0/1.1
Dimensions (W x H x D)	704 X 385 X 364mm

### Weight

- With Packing	17.6kg
- Main Unit	14.5kg

## USB playability information

### Compatible USB devices:

- USB flash memory (USB 2.0 or USB1.1)
- USB flash players (USB 2.0 or USB1.1)
- Memory cards (requires an additional card reader to work with this unit)

### Supported formats:

- USB or memory file format FAT16, FAT32 (sector size: 512 bytes)
- MP3 bit rate (data rate): 32-320 Kbps and variable bit rate
- Directory nesting up to a maximum of 8 levels

- Number of albums/ folders:  
maximum 255
- Number of tracks/titles: maximum 999
- ID3 tag v2.0 or later
- File name in Unicode UTF8  
(maximum length: 128 bytes)

#### **Unsupported formats:**

- Empty albums: an empty album is an album that does not contain MP3/WMA files, and will not be shown in the display.
- Unsupported file formats are skipped. For example, Word documents (.doc) are ignored and not played.
- AAC, WAV, PCM audio files
- WMA files

## 9 Troubleshooting



### Warning

- Never remove the casing of this apparatus.

To keep the warranty valid, never try to repair the system yourself.

If you encounter problems when using this apparatus, check the following points before requesting service. If the problem remains unsolved, go to the Philips web site ([www.philips.com/welcome](http://www.philips.com/welcome)). When you contact Philips, ensure that the apparatus is nearby and the model number and serial number are available.

### No power

- Make sure that the AC power plug of the unit is connected properly.
- Make sure that there is power at the AC outlet.
- Make sure that the **POWER ON/OFF** switch on the back panel is turned to the | position.
- To save power, the system switches off automatically after 30 minutes of inactivity (for example, in pause or stop mode).

### No sound or poor sound

- Adjust the volume.
- The speaker may be mute. Press **M** to restore sound output.

### No response from the Hi-Fi system

- Disconnect and reconnect the AC power plug, then turn on the system again.
- As a power-saving feature, the unit switches off automatically 30 minutes after track play reaches the end and no control is operated.

### Remote control does not work

- Before you press any function button, first select the correct source with the remote control instead of the main unit.

- Reduce the distance between the remote control and the unit.
- Insert the batteries with its polarities (+/- signs) aligned as indicated.
- Replace the batteries.
- Aim the remote control directly at the sensor on the front of the unit.

### Poor radio reception

- Increase the distance between the unit and your TV or VCR.
- Fully extend the FM antenna.

### USB device not supported

- The USB device is incompatible with the unit. Try another one.

## About Bluetooth device

### Music playback is unavailable on the system even after successful Bluetooth connection.

- The device cannot be used with the unit to play music.

### The audio quality is poor after connection with a Bluetooth-enabled device.

- The Bluetooth reception is poor. Move the device closer to the unit or remove any obstacle between the device and the unit.

### Cannot connect with the unit.

- The device does not support the profiles required for the unit.
- The Bluetooth function of the device is not enabled. Refer to the user manual of the device for how to enable the function.
- The unit is not in pairing mode.
- The unit is already connected with another Bluetooth-enabled device. Disconnect that device or all other connected devices and then try again.
- The unit provides dual Bluetooth audio sources (A/B). Make sure that you have selected the correct source.

**The paired mobile phone connects and disconnects constantly.**

- The Bluetooth reception is poor. Move the mobile phone closer to the unit or remove any obstacle between the mobile phone and the unit.
- Some mobile phones may connect and disconnect constantly when you make or end calls. This does not indicate any malfunction of the unit.
- For some mobile phones, the Bluetooth connection may be deactivated automatically as a power-saving feature. This does not indicate any malfunction of the unit.







2015 © Gibson Innovations Limited. All rights reserved.  
This product has been manufactured by, and is sold under  
the responsibility of Gibson Innovations Ltd., and Gibson  
Innovations Ltd. is the warrantor in relation to this product.  
Philips and the Philips Shield Emblem are registered trademarks  
of Koninklijke Philips N.V. and are used under license from  
Koninklijke Philips N.V.

NTRX100\_UM\_12\_V3.0