

Philips BeNear
Cordless phone

- 1000-series
- Black



CD1964B

Bringing people closer

Talk hands-free

Great sound reproduction, without having to hold the phone to your ear – so you can talk completely hands-free. With simple installation, a user-friendly menu and an inbuilt answering machine, a great chat has never been easier.

Crystal clear sound

- Advanced sound testing and tuning for superb voice quality
- The Parametric Equaliser delivers pure and clear sound
- Acoustic echo cancellation keeps your conversation echo-free
- Optimised antenna layout for great reception in any room
- Handset speakerphone allows you to talk hands-free

Nice and simple

- Up to 15 min. message on your answering machine
- Easy to read, 4.1 cm (1.6") dot-matrix display
- Ultimate convenience through easy setup
- Save up to 50 of your favourite contacts in your phonebook
- Up to 16 hours of talk time

Eco-conscious product

- Low power consumption: < 0.65 W in standby mode
- Up to 95% reduction of emitted radiation in charging mode

PHILIPS

Highlights

4.1 cm (1.6") dot-matrix display

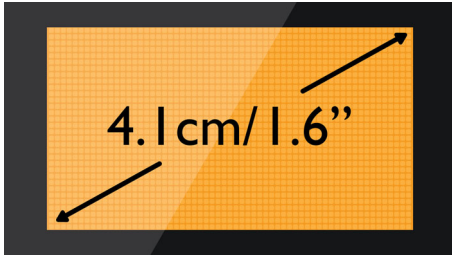

Easy to read, 4.1 cm (1.6") dot-matrix display

50-name phone book



Always have the phone numbers of your loved ones available: Save up to 50 names in your phonebook.

Acoustic echo cancellation

No more of those annoying echoes when you are talking on the phone. With our acoustic echo cancellation, you always get a clear, undisturbed connection.

Advanced sound testing



We test the sound quality of our DECT phones the same way as high-end headphone manufacturers do. Using an advanced ear simulator, we can accurately re-create the way people actually hear. This helps our acoustic engineers to measure and fine-tune things like frequency response, distortion and overall hearing perception, to create perfect voice

reproduction for both handset and hands-free modes.

Easy setup

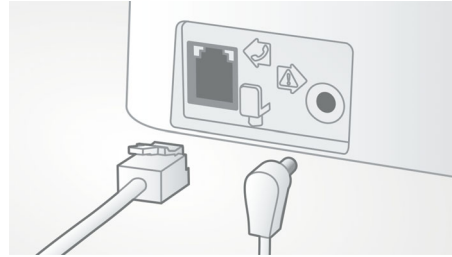

Ultimate convenience through easy set up. Simplified installation - Plug and Play product

Handset speakerphone



Hands-free mode uses a built-in loudspeaker to amplify the voice of the caller, allowing you to speak and listen during a call without holding the phone to your ear. This is especially useful if you want to share the call with others or simply multitask.

Less radiation while charging



Up to 95% reduction of emitted radiation in charging mode

Low power consumption: < 0.65 W



Philips phones are energy efficient and are designed to be respectful to the environment. Now the power consumed in standby mode is less than < 0.65 W.

Optimised antenna layout



Our optimised antenna layout ensures strong and stable reception, even in areas of the house where cordless transmission is difficult. Now you can take a call wherever you are in the house, and enjoy a long, uninterrupted conversation even as you walk around.

Parametric Equaliser

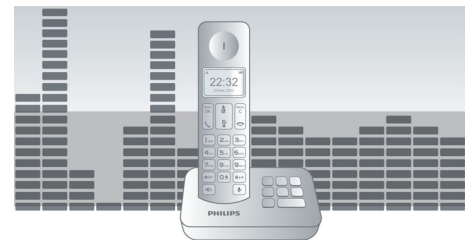

Our telephones use parametric equalisation in the digital sound processing to fine tune the sound response back to the intended linear frequency response curve, delivering sound that is pure and clear, for each conversation.

Specifications

Sound

- Volume control on handset
- Ringtones on handset: 10 polyphonic

Picture/Display

- Display size: 4.1 cm/1.6"
- Backlight: Yes
- Backlight colour: Amber
- Display type: 1-line dot matrix + 2 line icons

Answering Machine

- Recording time capacity: up to 15 minutes
- Pre-recorded OGM
- Message counter on base: LED (Soft Amber)
- Loud speaker on base
- Answering Machine control: from base and handset

Convenience

- Menu structure in the handset: List Menu
- Signal strength indicator: 3- bar indicator
- Battery level indicator: 3- bar battery icon
- Date/Time display
- Base Station keys: Paging key
- Battery charge indication
- Charge time: 8 hours
- Signal strength indication
- Programmable hot keys: Key 1 and 2
- Call Management: Call Waiting, Caller ID, Microphone mute, Missed Calls, Received Calls
- Key tone on/off
- Auto hang up
- Multi-base capability: 1

- Multi-handset capability: Up to 4
- Speakerphone — talk hands-free
- Range: Open field <300 m; indoor <50 m
- Intercom — multiple handsets
- Up to 16 hrs talk time
- Up to 250 hrs standby time
- Line cord length: 1.8 m
- Power cord length: 1.8 m

Memory Capacity

- Phonebook: 50 names and numbers
- Redial List Capacity: 10 entries
- Call log entries: 20 entries
- Phonebook store in the base

Power

- Battery capacity: 650 mAh
- Battery type: AAA NiMH Rechargeable
- Mains power: AC 100-240 V ~50/60 Hz
- Power Consumption: < 0.65 W

Security

- Transmission encryption: Yes

Network Features

- Compatible: GAP

SAR Value

- Philips handsets: <0.1 W/kg

Eco Design

- EcoMode: automatic



Issue date 2013-07-29

Version: 2.1.4

12 NC: 8670 000 80431
EAN: 87 12581 61638 0

© 2013 Koninklijke Philips N.V.
All Rights reserved.

Specifications are subject to change without notice.
Trademarks are the property of Koninklijke Philips N.V.
or their respective owners.

www.philips.com