



Philips
Wireless stereo speaker

Bluetooth® and NFC

Built-in microphone for calls
USB port for charging
20W



BT4000W

Stream tunes wirelessly in seconds

Let music flow wirelessly through Bluetooth® to powerful 20W bass-reflex speakers for big sound. Pair devices instantly with NFC or charge fast with a built-in USB. All in one stylish design.

Impressive sound

- Bass Reflex Speaker System delivers a powerful, deeper bass
- 20W RMS total output power
- Anti-clipping function for loud, distortion free music

Simplicity in use

- Wireless music streaming via Bluetooth
- Built-in microphone for hands-free phone calls
- Audio-in for easy portable music playback

Advanced versatility

- One-Touch with NFC-enabled smartphones for Bluetooth pairing
- USB port to charge any mobile device

PHILIPS

Wireless stereo speaker

Bluetooth® and NFC Built-in microphone for calls, USB port for charging, 20W

BT4000W/12

Highlights

Bass Reflex Speaker System



Bass Reflex Speaker System delivers a deep bass experience from a compact loudspeaker box system. It differs from a conventional loudspeaker box system in the addition of a bass pipe that is acoustically aligned to the woofer to optimize the low frequency roll-off of the system. The result is deeper controlled bass and lower distortion. The system works by resonating the air mass in the bass pipe to vibrate like a conventional woofer. Combined with the response of the woofer, the system extends the overall low frequency sounds to create a whole new dimension of deep bass.

Anti-clipping function

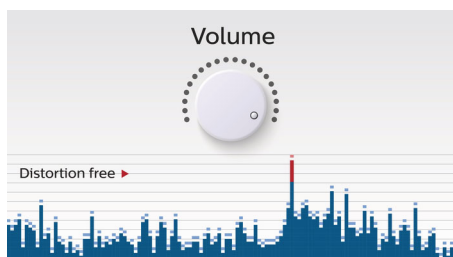

Anti-Clipping lets you play music louder and keeps it high quality, even when the battery is low. It accepts a range of input signals, from 300mV to 1000mV and keeps your speakers

safe from damage by distortion. This built-in function monitors the musical signal as it goes through the amplifier and keeps peaks within the amplifier's range, preventing the audio distortion caused by clipping without affecting loudness. A portable speaker's ability to reproduce musical peaks decreases along with battery power, yet anti-clipping reduces peaks caused by low battery, keeping music distortion free.

Wireless music streaming

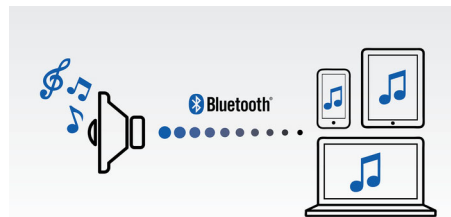

Bluetooth is a short range wireless communication technology that is both robust and energy-efficient. The technology allows easy wireless connection to iPod/iPhone/iPad or other Bluetooth devices, such as smartphones, tablets or even laptops. So you can enjoy your favorite music, sound from video or game wireless on this speaker easily.

Built-in microphone

With its built-in microphone, this speaker also works as a speaker phone. When a call comes in, the music is put on pause and you can talk via the speaker. Call for a business meeting. Or, call your friend from a party. Either way, it works great.

AUDIO-IN (3.5mm)



Make one easy connection and enjoy all your music from portable devices and computers. Simply plug your device to the AUDIO-IN (3.5 mm) port on your Philips set. With computers, the connection is typically made from the headset output. Once linked, you can enjoy your entire music collection directly, on a set of superior speakers. Philips simply delivers better sound.

NFC technology

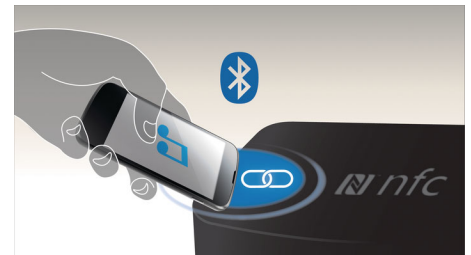

Pair Bluetooth devices easily with one-touch NFC (Near Field Communications) technology. Just tap the NFC enabled smartphone or tablet on the NFC area of a speaker to turn the speaker on, start Bluetooth pairing, and begin streaming music.

Specifications

Compatibility

- iPad: iPad 4, iPad mini, new iPad, iPad 2, iPad 1
- iPhone: iPhone 5S, iPhone 5C, iPhone 5, iPhone 4S, iPhone 4, iPhone 3GS, iPhone 3
- iPod touch: 3rd generation or later
- Android tablets & smartphones: with Android 2.1 and Bluetooth 2.1 or above
- other music devices: with Bluetooth 2.1 or above
- other Bluetooth-enabled device
- work with: Bluetooth 4.0 or below

Connectivity

- Bluetooth profiles: A2DP, AVRCP, HFP, HSP
- Bluetooth range: Line of sight, 10M or 30FT
- Audio in (3.5mm)

Convenience

- USB port: for charging (5V, 1A)
- Built-in microphone: for speaker conference

Sound

- Sound System: Stereo
- Output power (RMS): 20W

Loudspeakers

- Bass reflex speaker system
- Speaker drivers: 2 x 2.75"

Power

- Power supply: 100-240VAC, 50/60Hz

Accessories

- AC/DC adaptor
- Quick start guide
- World Wide Warranty leaflet

Product dimensions

- Product dimensions (W x H x D):
30 x 16.25 x 9.6 cm
- Weight: 1.66 kg

Packaging dimensions

- Packaging dimensions (W x H x D):
38.1 x 20.5 x 13.3 cm
- Gross weight: 2.22 kg
- Nett weight: 1.89 kg
- Number of products included: 1
- Packaging type: Display
- Tare weight: 0.33 kg
- Type of shelf placement: Laying
- EAN: 87 12581 72088 9

Outer Carton

- GTIN: 1 87 12581 72088 6
- Number of consumer packagings: 2
- Gross weight: 4.88 kg
- Outer carton (L x W x H): 39.5 x 28 x 22.5 cm
- Nett weight: 3.78 kg
- Tare weight: 1.1 kg



Issue date 2020-07-08

Version: 2.0.5

12 NC: 8670 001 14712
EAN: 87 12581 72088 9

© 2020 Koninklijke Philips N.V.
All Rights reserved.

Specifications are subject to change without notice.
Trademarks are the property of Koninklijke Philips N.V.
or their respective owners.

www.philips.com