



Philips
Cordless phone

1.6" display/ blue backlight
Handset speakerphone

D1211B



Simply Handsfree

A compact phone with excellent sound reproduction for you to talk completely handsfree. Ergonomically designed to have all the essential functions at your finger tips, this plug & play device makes calling your loved ones truly enjoyable.

Nice and simple

- Freestanding handset with a speaker for easy handsfree calls
- Ultimate convenience through easy setup
- Textured back cover for non-slip grip
- Menu in multiple local languages
- Easy to read 4.1 cm (1.6") display with backlight
- Up to 10 hours talk time on a single charge
- Caller ID – so you always know who is calling*

Crystal clear sound

- Parametric Equalizer delivers pure and clear sound
- Automatic Volume Control offsets unwanted volume variation
- Optimized antenna layout for great reception in any room
- Advanced sound testing & tuning for superb voice quality

Eco-conscious product

- Low radiation and power consumption

PHILIPS

Cordless phone
1.6" display/ blue backlight Handset speakerphone

D1211B/23

Highlights

4.1cm (1.6") display



Easy to read 4.1 cm (1.6") display with backlight

Advanced sound testing



We test the sound quality of our DECT phones the same way as high-end headphone manufacturers do. Using an advanced ear simulator, we can accurately re-create the way people actually hear. This helps our acoustic engineers to measure and fine-tune things like frequency response, distortion and overall hearing perception, to create perfect voice reproduction for both handset and handsfree modes.

Automatic Volume Control



Automatic Volume Control offsets variations in sound signal, which can be caused by distance, signal strength or the caller's phone - so what you hear always remains consistent. Reducing the audio amplification for strong signals, and increasing it for weak ones, it means you can enjoy a smooth conversation without unwanted sound volume variation.

Caller ID*



Sometimes it is good to know who is calling before you answer. And our Caller ID lets you keep track of who is on the other end of the line.

Easy setup

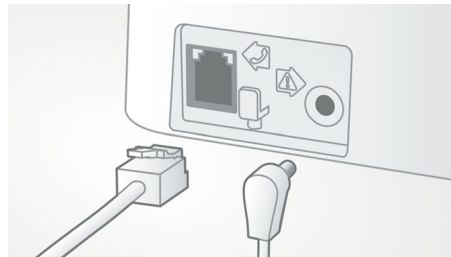

Ultimate convenience through easy set up. Simplified installation - Plug & Play product

Eco-conscious product



Philips phones are energy efficient and designed to be respectful to the environment.

Menu in local languages



Enjoy easy set-up, navigation and control with intuitive menu available in local languages.

Non-slip grip

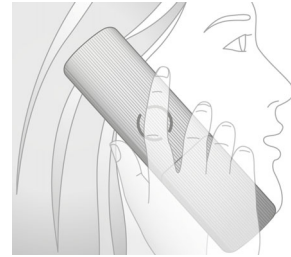

The rear of the handset is treated with a special texture for added comfort and better grip.

Optimized antenna layout



Our optimized antenna layout ensures strong and stable reception – even in areas of the house where cordless transmission is difficult. Now you can take a call wherever you are in the house, and enjoy a long, uninterrupted conversation even as you walk around.

Parametric Equalizer



Our telephones use parametric equalization in the digital sound processing to fine-tune the sound response back to the intended linear frequency response curve, delivering sound that is pure and clear, for each conversation.

Up to 10 hours talk time

Up to 10 hours talk time on a single charge

Specifications

Convenience

- Menu structure in the handset: List Menu
- Speakerphone - talk handsfree
- Signal strength indicator: 3-bar indicator
- Battery level indicator: 3-bar battery icon
- Intercom - multiple handsets
- Date / Time display
- Battery charge indication
- Signal strength indication
- Programmable hot keys: None
- Call Management: Call Waiting*, Caller ID*, Microphone mute, Missed Calls, Received Calls
- Keypad lock
- Key tone on/off
- Auto hang up
- Multi base capability: 1
- Multi handset capability: Up to 4
- Base Station keys: Paging key
- Up to 10 hrs talk time
- Up to 180 hrs standby time
- Charge time: 8 hours
- Line cord length: 1.5m
- Power cord length: 1.5m
- Range: Open field <300m; indoor <50m
- Non-slip grip: Circular texture

Sound

- Volume control on handset
- Ringtones on handset: 10 polyphonic

Picture/Display

- Display size: 4.1cm / 1.6"
- Display type: 12 digits (Alphanumeric) +hard icons

- Backlight: Yes
- Backlight color: Blue

Memory Capacity

- Phonebook: 50 names and numbers
- Redial List Capacity: 10 last numbers
- Call log entries: 20 entries

Power

- Battery capacity: 300 mAh
- Battery type: AAA NiMH Rechargeable
- Mains power: AC 100-240V ~50/60Hz
- Power Consumption: <0.7 W

Security

- Transmission encryption : Yes

Network Features

- Compatible: GAP

SAR Value

- Philips handsets: <0.1 W/kg

Packaging dimensions

- Packaging type: Carton
- Number of products included: 1
- Type of shelf placement: Laying
- Packaging dimensions (W x H x D): 18.4 x 13.5 x 5.9 cm
- Gross weight: 0.327 kg
- Nett weight: 0.245 kg
- Tare weight: 0.082 kg
- EAN: 87 12581 70761 3



Issue date 2015-03-24

Version: 3.0.4

12 NC: 8670 001 10948
EAN: 87 12581 70761 3

© 2015 Koninklijke Philips N.V.
All Rights reserved.

Specifications are subject to change without notice.
Trademarks are the property of Koninklijke Philips N.V.
or their respective owners.

www.philips.com

**This feature requires additional subscription of Caller ID service.
Please check with your local network operator for details.