

# Always there to help you

Register your product and get support at  
[www.philips.com/support](http://www.philips.com/support)



AE1500X



# User manual

# PHILIPS



# Contents

---

<b>1</b>	<b>Important</b>	2
	Hearing safety	2

---

<b>2</b>	<b>Your pocket radio</b>	3
	Introduction	3
	What's in the box	3
	Overview of the radio	4

---

<b>3</b>	<b>Get started</b>	6
	Install batteries	6
	Turn on or off	6

---

<b>4</b>	<b>Use the portable radio</b>	7
	Listen to radio	7
	Listen through a headphone	7

---

<b>5</b>	<b>Product information</b>	8
	Specifications	8

---

<b>6</b>	<b>Troubleshooting</b>	9
----------	------------------------	---

---

<b>7</b>	<b>Notice</b>	10
----------	---------------	----

# 1 Important



## Warning

- Never remove the casing of this product.
  - Never lubricate any part of this product.
  - Never place this product on other electrical equipment.
  - Keep this product away from direct sunlight, naked flames or heat.
- 
- Make sure that there is enough free space around the product for ventilation.
  - Only use attachments or accessories specified by the manufacturer.
  - Battery usage CAUTION – To prevent battery leakage which may result in bodily injury, property damage, or damage to the product:
    - Install the batteries correctly, + and - as marked on the product.
    - Do not mix batteries (old and new or carbon and alkaline, etc.).
    - Remove the batteries when the product is not used for a long time.
    - The batteries shall not be exposed to excessive heat such as sunshine, fire or the like.
  - The product shall not be exposed to dripping or splashing.
  - Do not place any sources of danger on the product (e.g. liquid filled objects, lighted candles).

cause hearing loss for a normal person, even for exposure less than a minute. The higher decibel ranges are offered for those that may have already experienced some hearing loss.

- Sound can be deceiving. Over time your hearing 'comfort level' adapts to higher volumes of sound. So after prolonged listening, what sounds 'normal' can actually be loud and harmful to your hearing. To guard against this, set your volume to a safe level before your hearing adapts and leave it there.

### To establish a safe volume level:

- Set your volume control at a low setting.
- Slowly increase the sound until you can hear it comfortably and clearly, without distortion.

### Listen for reasonable periods of time:

- Prolonged exposure to sound, even at normally 'safe' levels, can also cause hearing loss.
- Be sure to use your equipment reasonably and take appropriate breaks.

### Be sure to observe the following guidelines when using your headphones.

- Listen at reasonable volumes for reasonable periods of time.
- Be careful not to adjust the volume as your hearing adapts.
- Do not turn up the volume so high that you can't hear what's around you.
- You should use caution or temporarily discontinue use in potentially hazardous situations. Do not use headphones while operating a motorized vehicle, cycling, skateboarding, etc.; it may create a traffic hazard and is illegal in many areas.



## Note

- The type plate is located on the back of the product.

---

## Hearing safety



### Listen at a moderate volume.

- Using headphones at a high volume can impair your hearing. This product can produce sounds in decibel ranges that may

## 2 Your pocket radio

Congratulations on your purchase, and welcome to Philips! To fully benefit from the support that Philips offers, register your product at [www.philips.com/welcome](http://www.philips.com/welcome).

---

### Introduction

With this pocket radio, you can listen to FM or MW radio.

---



### What's in the box

Check and identify the contents of your package.

- Main unit
- User manual

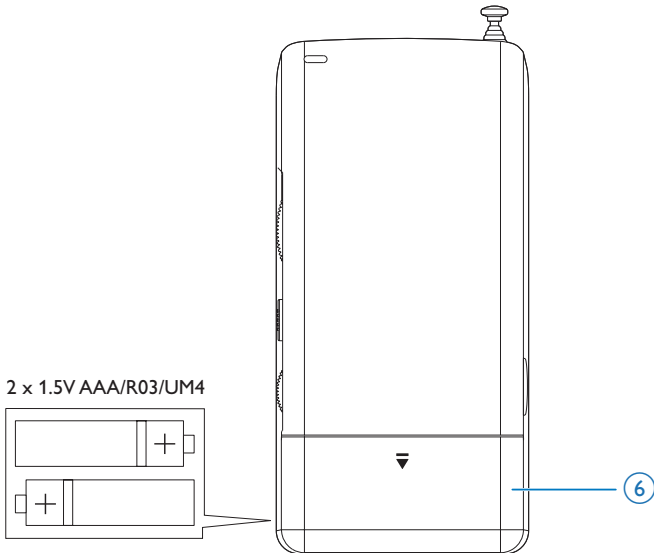
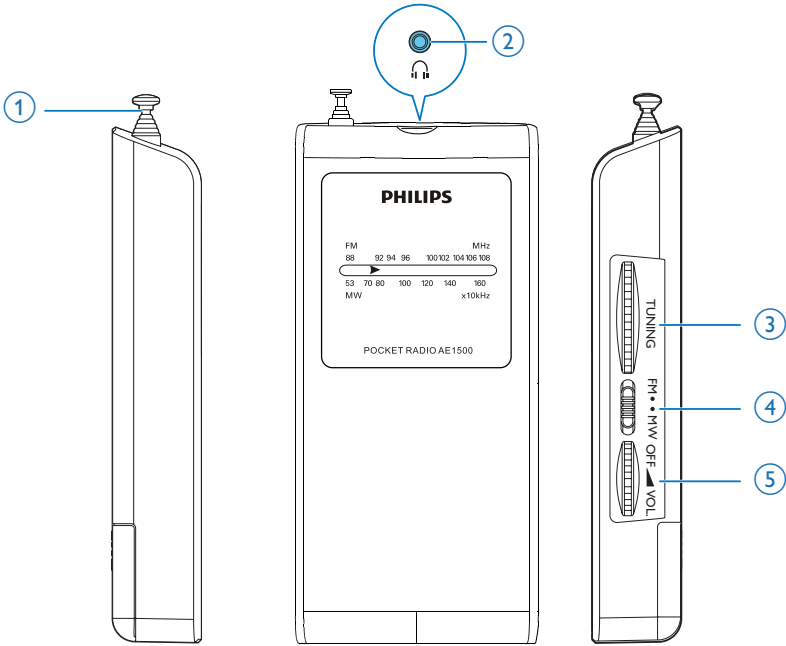
# Overview of the radio



- ① **Telescopic antenna**
  - Improve FM reception.
- ②  **Headphones**
  - Connect a headphone.
- ③ **TUNING**
  - Tune to FM or MW radio stations.
- ④ **Band selector**
  - Select the waveband: FM or MW.
- ⑤ **OFF  VOL**
  - Turn the product on or off.
  - Adjust volume.
- ⑥ **Battery compartment**

# 3 Get started

Always follow the instructions in this chapter in sequence.

---

## Turn on or off

Turn the **OFF**  **VOL** wheel to turn the product on or off.

---

## Install batteries

- 1 Open the battery compartment.

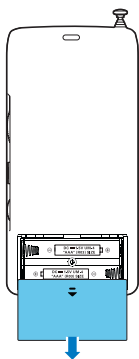

- 2 Insert 2 AAA batteries (not supplied) with correct polarity (+/-) as indicated.

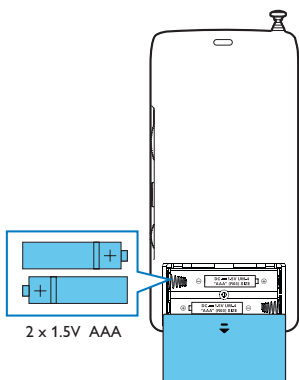

- 3 Close the battery compartment.



# 4 Use the portable radio

---

## Listen to radio



### Note

- For optimal reception, fully extend the antenna or adjust the position of the antenna or this product.

- 1 Adjust the band selector to select **FM** or **MW** radio.
- 2 Turn the **TUNING** wheel to tune to a radio station.
  - To increase or decrease volume, turn the **OFF**  **VOL** wheel.

---

## Listen through a headphone

Plug a headphone (not supplied) into the  socket on the product.

# 5 Product information

## Note

- Product information is subject to change without prior notice.

## Specifications

Total Output Power	0,2W RMS
Tuning Range	FM: 87.5-108 MHz MW: 540-1620 KHz
Sensitivity	FM: 26dB S/N Ratio<22 dBf MW: 26dB S/N Ratio<70 dBf
Total Harmonic Distortion	<2%
Signal to Noise Ratio (FM)	>50 dBA
Power Supply	Type AAA; R03 or UM4 batteries x 2 pcs (not supplied)
Dimensions: Main Unit (W x H x D)	57 x 133 x 20 mm
Weight - Main unit	0.07 kg

# 6 Troubleshooting



## Warning

- Never remove the casing of this product.

To keep the warranty valid, never try to repair the product yourself.

If you encounter problems when using this device, check the following points before requesting service. If the problem remains unsolved, go to the Philips Web page ([www.philips.com/support](http://www.philips.com/support)). When you contact the Consumer Care, make sure that the product is nearby and the model number and serial number are available.

### No power

- The batteries are not installed correctly. Insert the batteries correctly as indicated on the battery compartment.
- The batteries are out of energy. Replace with new ones.

### No sound

- Adjust volume.
- Disconnect the headphone from the product.

### Poor radio reception

- For FM radio, fully extend the telescopic antenna and adjust its position for better reception.
- For MW radio, a built-in antenna works. Adjust the position of the unit for better reception.

# 7 Notice

Any changes or modifications made to this device that are not expressly approved by Gibson Innovations may void the user's authority to operate the equipment.

## **Disposal of your old product**



Your product is designed and manufactured with high quality materials and components, which can be recycled and reused.

Do not throw away the product with the normal household waste at the end of its life, but hand it in at an official collection point or recycling. By doing this, you help to preserve the environment.

## **Environmental information**

All unnecessary packaging has been omitted. We have tried to make the packaging easy to separate into three materials: cardboard (box), polystyrene foam (buffer) and polyethylene (bags, protective foam sheet.)

Your system consists of materials which can be recycled and reused if disassembled by a specialized company. Please observe the local regulations regarding the disposal of packaging materials, exhausted batteries and old equipment.





Specifications are subject to change without notice.

2015 © Gibson Innovations Limited. All rights reserved.

This product was brought to the market by Gibson Innovations Limited or one of its affiliates, further referred to in this document as Gibson Innovations, and is the manufacturer of the product. Gibson Innovations is the warrantor in relation to the product with which this booklet was packaged. Philips and the Philips Shield Emblem are registered trademarks of Koninklijke Philips N.V.

AE1500X\_78\_UM\_V1.0

