

# Quick start guide

- 1 Connect
- 2 Enjoy

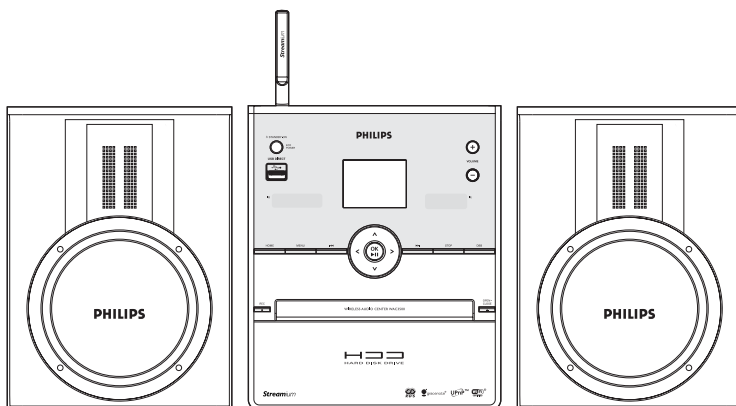

# What's in the box



Wireless Music Center WAC3500

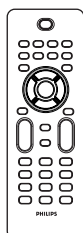

Remote control  
2 x AAA batteries



Quick start guide

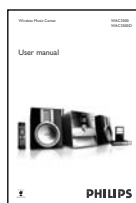

User manual



Connect to your PC



PC Suite CD



1 x Ethernet cable



1 x FM wire antenna

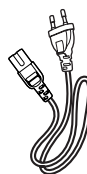

1 x AC Power cord

## Before using the remote control:

- Insert batteries into the remote control as shown

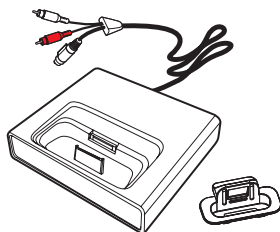

iPod docking cradle + 8 x iPod dock adaptor  
(for WAC3500D)

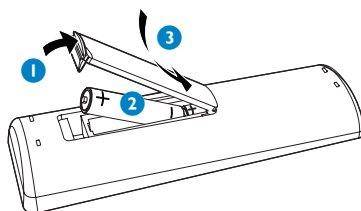



# Connect

## Rear connections

1

Connect the speaker cables

2

Connect the FM antenna

3

Connect the AC power cord of the Center

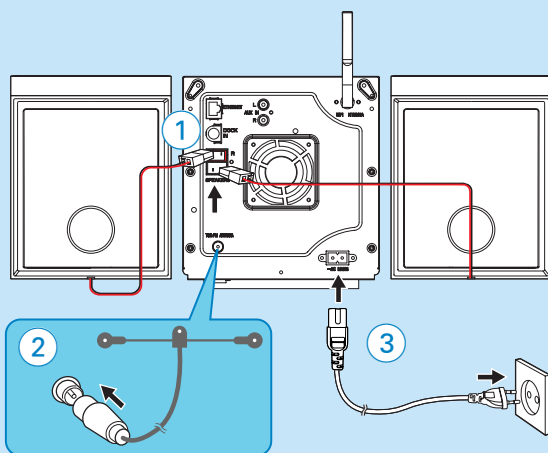

Connect the iPod dock (for WAC3500D)

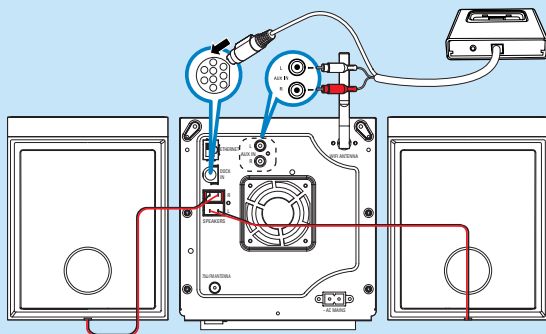

### Tip:

- See the User Manual for how to connect other equipment to the Center

# B<sub>1</sub>

## Enjoy Playing CDs



For playback on the Center, you can use:

- All pre-recorded audio CDs
- All finalized audio CDR and CDRW discs
- MP3/WMA/M4A-CDs (CD-R/CD-RW with MP3/WMA/M4A files)

1

To switch on the Center, press **STANDBY-ON/ECO POWER** 

2

- a. Press **OPEN • CLOSE**  on the set to open the CD compartment
- b. Insert a disc with the printed side facing up
- c. Press **OPEN • CLOSE**  again to close the compartment

- Display shows **Reading CD**

- List of CD tracks appears

*(For CD recorded with MP3/WMA/M4A music files:*

To enter a track list, press  on a highlighted file folder)

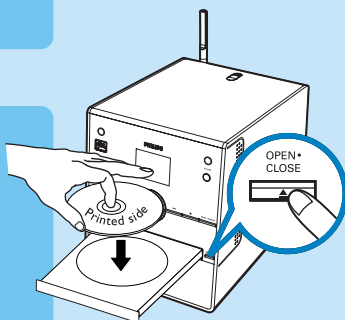

3

Use the navigation controls     to select a track or album

4

Press **OK / ** to start playback

5

To stop playback, press **STOP** 

6

To remove the CD, press **OPEN • CLOSE** 

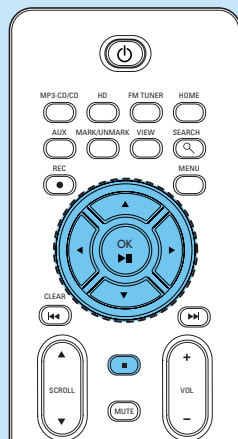

### Tip:

- WAC3500 allows you to check if the current CD information can be found in the latest Gracenote® music recognition service database via the Internet. For details, see **User Manual 12 Gracenote CD Information**

Build your music library on the hard disk in the Center by Recording from CDs, Importing MP3/WMA/M4A files from PC or Recording from Radio or external source.

## Recording from CDs

1

Insert a CD into the CD loader on the Center  
(For details, see Section B1)

- Display shows **Reading CD**
- List of CD tracks appears

(For CD recorded with MP3/WMA/M4A music files: To enter a track list, press ► on a highlighted file folder)

2

In the track list screen, press **REC** ●

- List of tracks with checkboxes ☒ appears

3

To start recording the whole CD, press **REC** ●.

(To rip part of the CD, press ► or **MARK-UNMARK** to select/deselect the tracks to be recorded, and then press **REC** ●. To select/deselect all tracks, press and hold **MARK-UNMARK**)

- **CD-Rec** appears. Display shows the album name of the track being recorded
- Center will return to **CD** mode when recording is complete

4

To record from another CD, repeat Steps 1 to 3 above

### IMPORTANT!

- It takes some time to convert the recorded CD music to MP3 files. Always press and hold **STANDBY-ON** to switch the set to ECO POWER (power-saving mode) before removing its power plug to avoid losing tracks.
- To import MP3/WMA/M4A files from PC, see the manual **Connect to your PC**.
- To record from Radio or external source, see **User Manual 6.5 Building music library on the Center**.

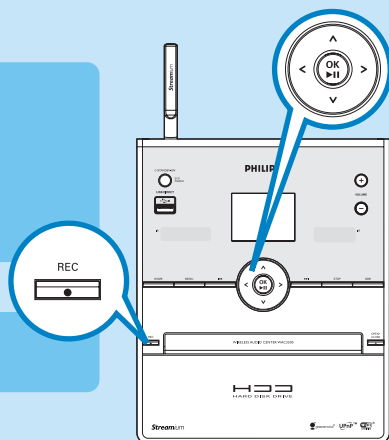

# B<sub>3</sub>

# Enjoy

## Playing Harddisk (HD)

You can centrally store up to 1500 audio CDs in the 80GB hard disk on the Center

1

To switch on the Center, press **STANDBY-ON/ECO POWER** 

2

Press **HOME** and use the navigation controls **▲ ▼ ◀ ▶** to select **HD** source (or press **HD** on the remote control)

3

Use the navigation controls **▲ ▼ ◀ ▶** to select your playback options (Demo tracks are stored under **All tracks**)

4

Press **OK / ▶||** to start playback

5

To change your playback option,  
a. Press **◀** once or more to enter previous option lists  
b. Use the navigation controls **▲ ▼ ◀ ▶** to select  
c. Press **OK / ▶||** or **▶** to confirm

6

To stop playback, press **STOP ■**

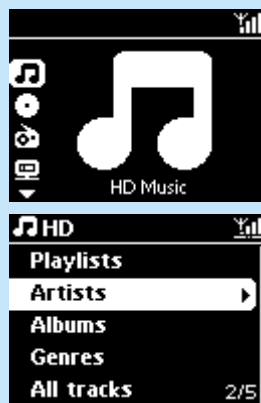
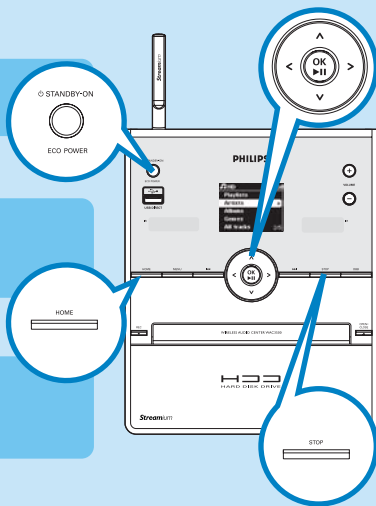

### Tip:

- Available storage space for music is around 75GB, due to capacity reserved for system purpose

## Search by keywords

The keyword should be the first letter or first word of the title of the track you wish to search for. By inputting a keyword, you can quickly find all the items containing the word.

1

Use the navigation controls ▲ ▼ ◀ ▶ to enter the desired option list under tracks, albums, artists or playlists

2

Press **SEARCH** on the remote control

- A text box appears

3

- Press the alphanumeric keys repeatedly to input the keywords (maximum 8 characters)
- To delete the entry before cursor, press ◀◀ (CLEAR)
- Press ◀ or ▶ to move the cursor backward / forward

4

Press **OK** / ▶▶ to start searching

- Display shows: **Searching ....** Searching starts from the beginning of the current option list
- The matched items appear at the front of the list

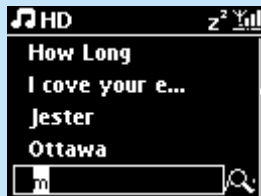
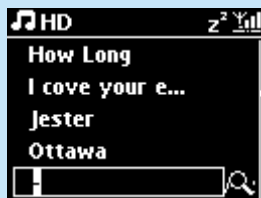
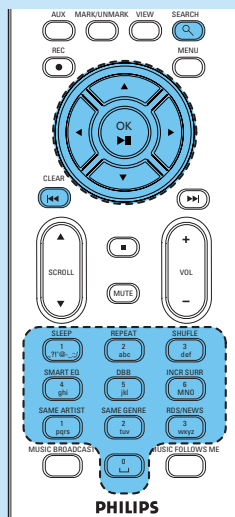



## Play music from USB devices

You can use USB flash memory (USB 2.0 or USB1.1) and USB flash players (USB 2.0 or USB1.1) with the Center.

1

Insert the USB plug of the USB device into the socket  on the Center.

2

Press **HOME** and use the navigation controls     to select **Portable > USB**

- The icon  appears
- List of music tracks appears

3

Use the navigation controls     to select your playback options

4

Press **OK** /  to start playback

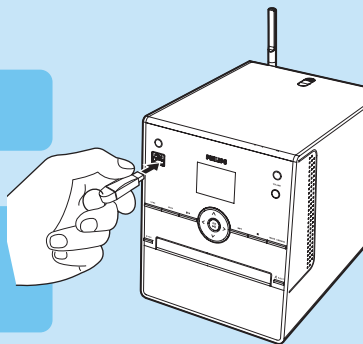



## Transfer music to USB devices

1

Check that the USB device is properly connected to the Center. Press **HOME** to enter **HD** mode

2

Press the navigation controls  or  and  to select your option and enter its corresponding list of tracks (if necessary)

3

Press **REC** , then press **MARK-UNMARK** to select or deselect the tracks to be recorded. (To select/deselect all tracks, press and hold **MARK-UNMARK**)

4

Press **REC**  to start recording.

- The display shows **transferring ...**. The number of tracks transferred/to be transferred appears
- Transferred tracks are saved under MUSIC in the USB device



# B<sub>6</sub> Enjoy

## Playing iPod player

1

Check that your iPod player is properly connected to the Center (See **Section A**)

2

Check that the Center is switched on or is already in standby mode

3

Press **HOME** to enter the main menu and use the navigation controls ▲ or ▼ and ► to select **Portable > iPod**

4

iPod player:  
a. turn down the volume to avoid noise distortion  
b. press the PLAY key to start playback

5

To adjust the volume, press **VOL+/-** or use the sound controls on your iPod

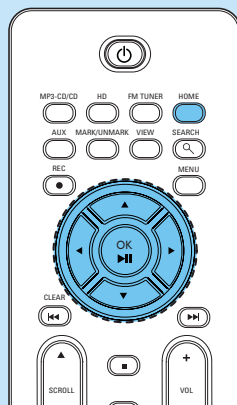

# B<sub>7</sub> Enjoy

## Listening to Radio

### Listen to FM Radio

1

Press **HOME** and use the navigation controls ▲ ▼ ◀ ▶ to select **Radio > FM Tuner** (or press **FM TUNER** on the remote control)

2

a. Press **MENU**

b. Press ▲ or ▼ and ▶ to select **Autostore radio**

- The display shows: **Autostore Please wait...**

After all available stations are stored, the first autostored preset station will play automatically

- You can store up to 60 preset radio stations in the memory (including a maximum of 10 RDS stations).

3

a. Press ▶ to enter the list of preset stations

b. Use the navigation controls ▲ or ▼ followed by ▶ to select the desired station

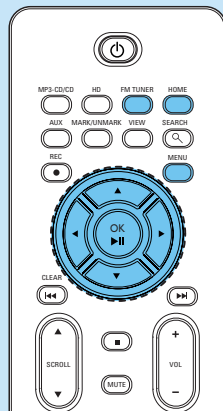

# B<sub>8</sub> Enjoy

## Expandable features

You can add up to 5 Philips Wireless Music Stations (sold separately) to the center to build up your wireless music system. With this system, you will have the freedom to enjoy your favorite music anywhere at home.



My room, my music

### My Room, My Music

Anyone - or everyone - can have access to the entire CD collection and enjoy what they want, when they want - in the room of their choice



Music follows me

### Music Follows Me

This feature allows you to enjoy music as you move from room to room, without having to navigate and start playback of your chosen tracks all over again. (For details, see **User Manual 15. Expandable features**)



Music broadcast

### Music Broadcast

This feature lets you send your choice of music to every Wireless Music Station in your home simultaneously - at the touch of a button. (For details, see **User Manual 15. Expandable features**)



Need help?

[www.philips.com/support](http://www.philips.com/support)

or

call our helpdesk

Country	Helpdesk	Tariff / min	Keep ready
österreich	0820 901115	€0,20	Das Kaufdatum, Modellnummer und Seriennummer
Belgique	070 253 010	€0,17	La date d'achat la référence et le numéro de série du produit
Canada	1-800-661-6162 (Francophone) 1-888-744-5477 (English / Spanish)	Free	Date of Purchase, Model number and Serial number
Danmark	3525 8761	Local tariff	Forbrugeren's indkøbsdato, type/model-og serienummer
Suomi	09 2290 1908	Local tariff	Ostopaivä ja tarkka mallinnumero ja sarjanumero
France	08 9165 0006	€0,23	La date d'achat la référence et le numéro de série du produit
Deutschland	0180 5 007 532	€0,20	Das Kaufdatum, Modellnummer und Serial nummer
Ελλάδα	0 0800 3122 1223	Free	Την ημερομηνία αγοράς και Τον ακριβή κωδικό μοντέλου και Τον αριθμό σειράς του προϊόντος σας
Ireland	01 601 1161	Local tariff	Date of Purchase, Model number and Serial number
Italia	199 404 042	€0,21	La data di acquisto, numero di modello e numero di serie
Luxembourg	26 84 30 00	Local tariff	La data d'achat, la référence et le numéro de série du produit
Nederland	0900 0400 063	€0,20	De datum van aankoop, modelnummer en serienummer
Norge	2270 8250	Local tariff	Datoen da du kjøpte produktet & modellnummer & serienummeret
Portugal	2 1359 1440	Local tariff	A data de compra, número do modelo e número de série
España	902 888 785	€0,15	Fecha de compra e número del modelo e número de serie
Sweden	08 632 0016	Local tariff	Inköpsdatum, modellnummer och serienummer
Schweiz	02 2310 2116		Das Kaufdatum und Modellnummer und Seriennummer
UK	0906 1010 017	£0.15	Date of Purchase, Model number and Serial number
USA	1-888-744-5477	Free	Date of Purchase, Model number and Serial number



Be responsible  
Respect copyrights

© Royal Philips Electronics N.V. 2007  
All rights reserved.

3141 075 22121  
[www.philips.com](http://www.philips.com)

